

CITY PLAN REVIEW INFORMATION

DESCRIPTION OF BUILDING USE:
THE BUILDING WILL SERVE AS A VENUE FOR ASSEMBLY AND VIEWING OF BASKETBALL AND OTHER SPORTING EVENTS ALONG WITH OTHER ENTERTAINMENT ACTS.

DESCRIPTION OF BUILDING HEIGHT:
THE BUILDING HEIGHT IS DESIGNED TO BE 126-FEET, 1-1/2-INCHES TALL FROM ITS GRADE LEVEL TO THE TOP OF THE ROOF.

PEDESTRIAN AND VEHICULAR CIRCULATION SYSTEMS:
REFER TO SHEET A1-14 FOR INFORMATION.

HATCH LEGEND

- AREAS DISTURBED BY CONSTRUCTION (NOT SPECIFICALLY CALLED OUT ON THE LANDSCAPE PLANS) TO BE RESTORED WITH MINIMUM 18" TOPSOIL AND 3" OF DECORATIVE STONE MULCH WITH WEED BARRIER(TYP).
- NEW ASPHALTIC CONCRETE (HEAVY DUTY) INSTALL PER CITY OF MILWAUKEE SPECIFICATIONS SEE DETAIL 4/C1-1C/H
- NEW CONCRETE SLAB SEE DETAIL 5/C1-1C/H
- INTEGRAL CONCRETE BANDING COLOR TO BE KALLUA FROM DAVIS COLOR SEE DETAIL 5/C1-1C/H
- NEW HEAVY DUTY CONCRETE SLAB SEE DETAIL 5/C1-1C/H
- CITY LINE BRICK PAVERS, COLOR WHEATFIELD FROM BELDEN. SEE DETAIL 7/C1-1C/H
- SPANCRETE REPLENISH SEE DETAIL 8/C1-1C/H
- PAVEDRAIN SEE DETAIL 9/C1-1C/H
- K-4/K-12 SECURITY BOLLARDS, AS NOTED ON PLAN, BY AMERISTAR SECURITY PRODUCTS FITTED WITH TRIO BOLLARD SLEEVE BY FORMS+SURFACES. INSTALL PER MANUFACTURER SPECIFICATIONS. SEE DETAIL 25/C1-1C/J AND SITE FURNISHING SPECIFICATIONS.
- TREE GRATE SEE DETAIL 27 & 28/C1-1C/J
- WISCONSIN DOLOMITIC LIMESTONE BUFF/GRAY IN COLOR. INSTALL PRIOR TO POURING CONCRETE SEE DETAIL 22 & 23/C1-1C/J
- (2) SLAPX-36J, APEX RECEPTACLE, 36-GALLON, SPLIT-STREAM, FSC 100% JATOPA HARDWOOD, WITH RAIN COVER, LITTER AND RECYCLING GRAPHICS. SURFACE MOUNT. INCLUDE (1) SUBUT-MDR-MOD, MEDIUM SQUARE BUTTLER, MOUNTED TO SIDE OF RECEPTACLE. INSTALL PER MANUFACTURER SPECIFICATIONS.
- (X) SLAPX-136J, APEX RECEPTACLE, 36-GALLON, SINGLE-STREAM, FSC 100% JATOPA HARDWOOD, WITH RAIN COVER, LITTER GRAPHICS, SURFACE MOUNT. INSTALL PER MANUFACTURER SPECIFICATIONS.
- (X) SLAPX-136J, APEX RECEPTACLE, 36-GALLON, SINGLE-STREAM, FSC 100% JATOPA HARDWOOD, WITH RAIN COVER, RECYCLING GRAPHICS, SURFACE MOUNT. INCLUDE (1) SUBUT-MDR-MOD, MEDIUM SQUARE BUTTLER, MOUNTED TO SIDE OF RECEPTACLE. INSTALL PER MANUFACTURER SPECIFICATIONS.
- NEW HIGH-SIDE CURB & GUTTER SEE DETAIL 10/C1-1C/H
- NEW LOW-SIDE CURB & GUTTER SEE DETAIL 10/C1-1C/H

Scale: 1" = 20'

DIGGERS HOTLINE
Dial 811 or (800)242-8511
www.DiggersHotline.com

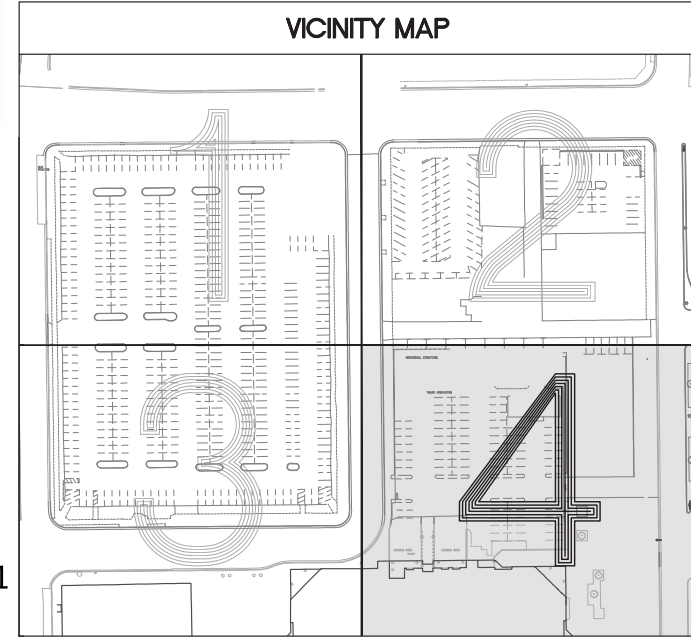

WISCONSIN ENTERTAINMENT & SPORTS CENTER
1111 N. 4TH STREET
MILWAUKEE WI

DPD - MINOR MODIFICATION

REVISIONS

| NO. | DATE | DESCRIPTION |
|-----|------------|-------------|
| 1 | 03.17.2016 | ISSUED |
| 2 | 04.04.2016 | REVISED |
| 3 | 05.09.2016 | REVISED |
| 4 | 01.27.2017 | REVISED |

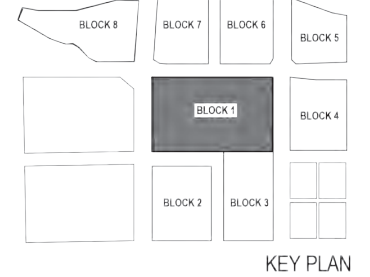

PROJECT NUMBER: 15.4017
ISSUE DATE: 01.27.2017

ENLARGED SITE PLAN -
4TH & HIGHLAND

POPULOUS HNTB eua

SHEET
A1 - 7



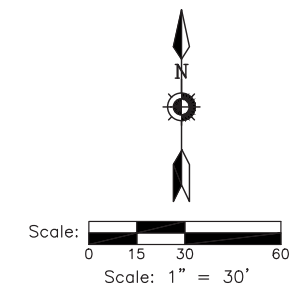
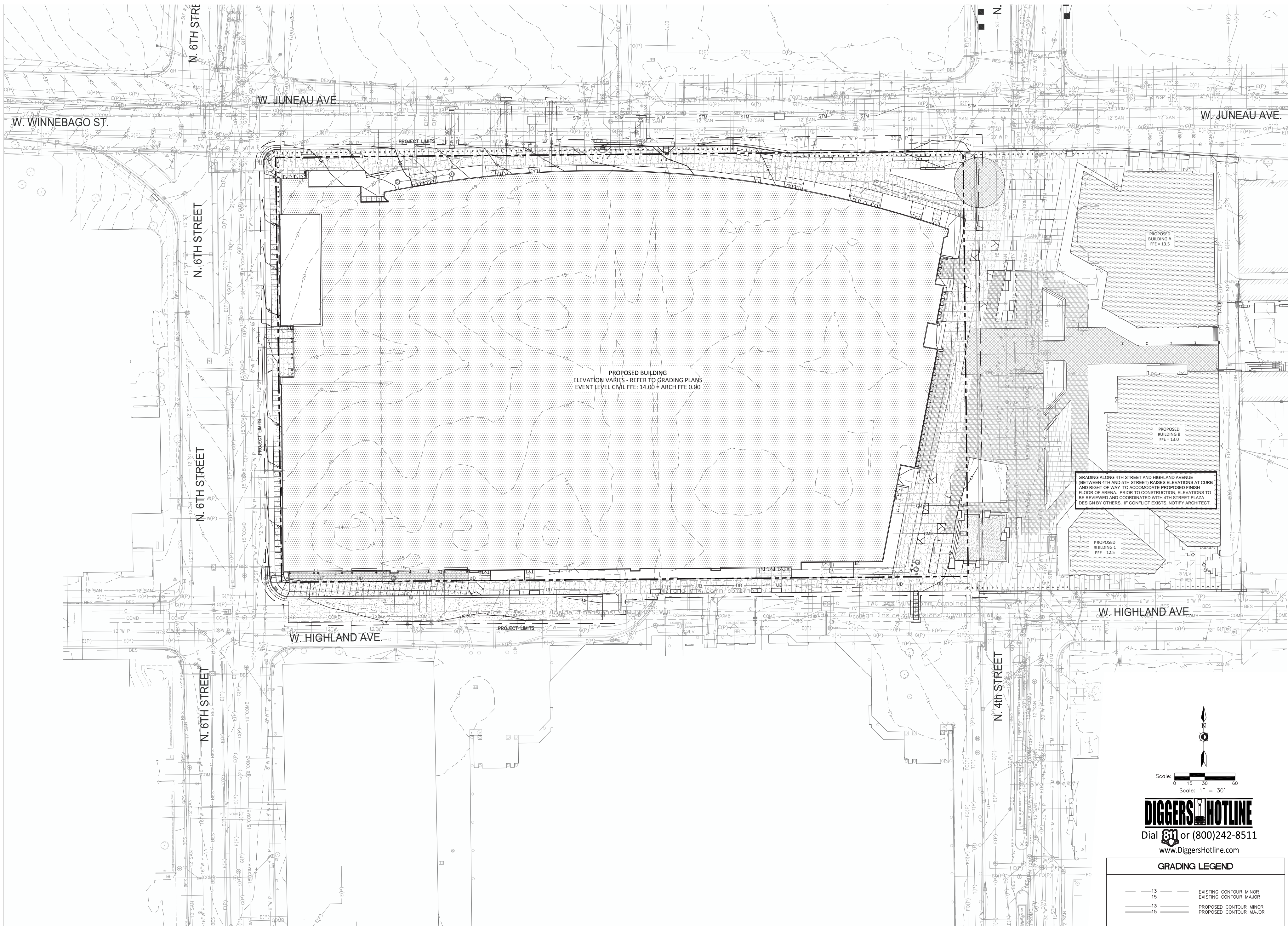

DIGGERS HOTLINE
 Dial 811 or (800)242-8511
 www.DiggersHotline.com

GRADING LEGEND

| | |
|------------|------------------------|
| --- 13 --- | EXISTING CONTOUR MINOR |
| --- 15 --- | EXISTING CONTOUR MAJOR |
| --- 13 --- | PROPOSED CONTOUR MINOR |
| --- 15 --- | PROPOSED CONTOUR MAJOR |



WISCONSIN ENTERTAINMENT & SPORTS CENTER
1111 N. 4TH STREET
MILWAUKEE WI

DPD - MINOR MODIFICATION

REVISIONS

| NO. | DATE | DESCRIPTION |
|-----|------------|-------------|
| 1 | 03.17.2016 | ISSUED |
| 2 | 04.04.2016 | REVISED |
| 3 | 05.09.2016 | REVISED |
| 4 | 01.27.2017 | REVISED |

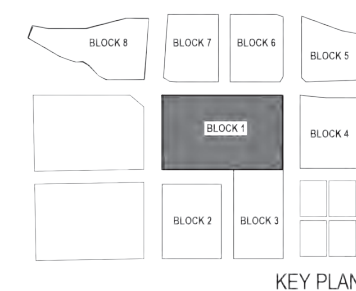

PROJECT NUMBER: 15.4017
 ISSUE DATE: 01.27.2017

OVERALL GRADING PLAN

POPULOUS HNTB eua

SHEET
A1 - 8

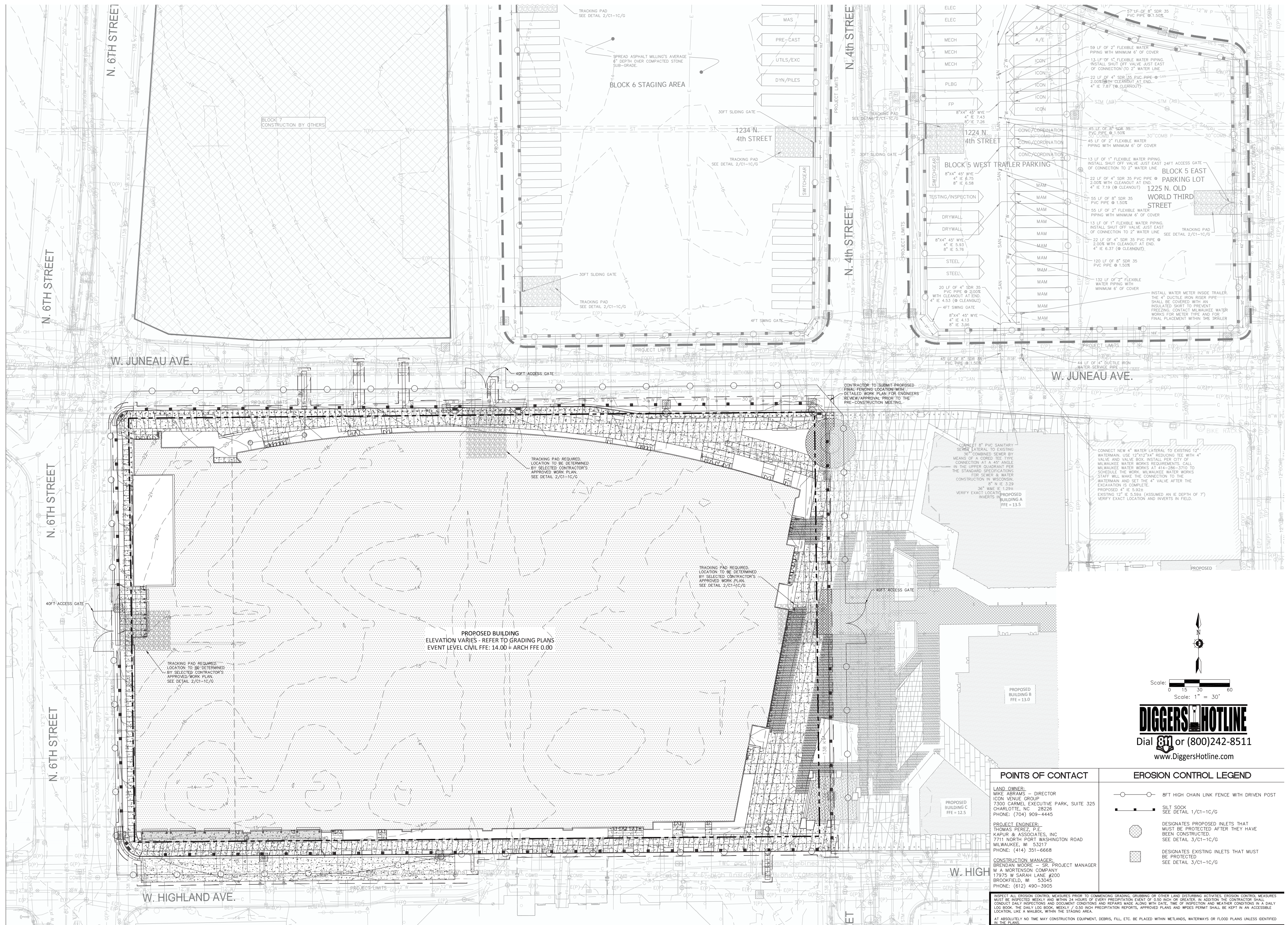

POINTS OF CONTACT

LAND OWNER:
MIKE ABRAMS - DIRECTOR
ICON VENUE GROUP
7300 CARMEL EXECUTIVE PARK, SUITE 325
CHARLOTTE, NC 28226
PHONE: (704) 909-4445

PROJECT ENGINEER:
THOMAS PEREZ, P.E.
KAPUR & ASSOCIATES, INC.
7711 NORTH PORT WASHINGTON ROAD
MILWAUKEE, WI 53217
PHONE: (414) 351-6668

CONSTRUCTION MANAGER:
BRENDAN MOORE, SR., PROJECT MANAGER
M. A. MORETSON COMPANY
17975 W SARAH LANE #200
BROOKFIELD, WI 53045
PHONE: (912) 490-3905

EROSION CONTROL LEGEND

- 8FT HIGH CHAIN LINK FENCE WITH DRIVEN POST
- SILT SOCK
SEE DETAIL 2/C1-1C/G
- DESIGNATES PROPOSED INLETS THAT MUST BE PROTECTED AFTER THEY HAVE BEEN CONSTRUCTED.
SEE DETAIL 3/C1-1C/G
- DESIGNATES EXISTING INLETS THAT MUST BE PROTECTED
SEE DETAIL 3/C1-1C/G

INSPECT ALL EROSION CONTROL MEASURES PRIOR TO COMMENCING GRADING, DRILLING OR OTHER LAND DISTURBING ACTIVITIES. EROSION CONTROL MEASURES MUST BE INSPECTED WEEKLY AND WITHIN 24 HOURS OF EVERY PRECIPITATION EVENT OF 0.50 INCH OR GREATER. IN ADDITION THE CONTRACTOR SHALL CONDUCT DAILY INSPECTIONS AND DOCUMENT CONDITIONS AND REPAIRS MADE ALONG WITH DATE, TIME OF INSPECTION AND WEATHER CONDITIONS IN A DAILY LOG BOOK. THE DAILY LOG BOOK, WEEKLY / 0.50 INCH PRECIPITATION REPORTS, APPROVED PLANS AND WPDES PERMIT SHALL BE KEPT IN AN ACCESSIBLE LOCATION LIKE A HARBOR, WITHIN THE STAGING AREA.

AT ABSOLUTELY NO TIME MAY CONSTRUCTION EQUIPMENT, DEBRIS, FILL, ETC. BE PLACED WITHIN WETLANDS, WATERWAYS OR FLOOD PLAINS UNLESS IDENTIFIED IN THE PLANS.

WISCONSIN ENTERTAINMENT & SPORTS CENTER
1111 N. 4TH STREET
MILWAUKEE WI

DPD - MINOR MODIFICATION

REVISIONS

| NO. | DATE | DESCRIPTION |
|-----|------------|-------------|
| 1 | 03.17.2016 | ISSUED |
| 2 | 04.04.2016 | REVISED |
| 3 | 05.09.2016 | REVISED |
| 4 | 01.27.2017 | REVISED |

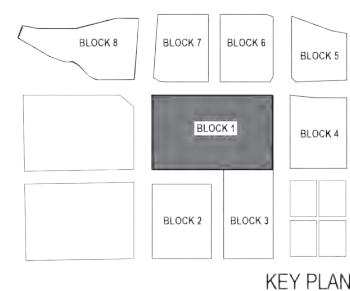

PROJECT NUMBER: 15.4017
ISSUE DATE: 01.27.2017

OVERALL SITE EROSION CONTROL PLAN

POPULOUS HNTB eua

SHEET
A1 - 9

