

## CEDAR FINISHING

Cedar is ideal for a variety of finishes. Location, weather, use and ease of maintenance should be considered when selecting the proper finish for your project.

Good surface preparation practices are essential to achieve a durable, long-lasting exterior finish. The application of the finish is as important for durability and optimal performance as is the finish-substrate combination chosen for the job. Refer to your finish application directions for best results.

### NATURAL WEATHERING

for a silvery gray look, best in dry climates

### OPAQUE FINISHES

primers, paint, solid color stains

### NATURAL FINISHES

transparent stains, semi-transparent stains



## BENEFITS OF CEDAR

### BEAUTY

There is absolutely no substitute for the natural beauty of cedar. Crisp, yet superbly rich, tonal qualities are a designer's dream.

### DURABILITY

Cedar is naturally resistant to rot, decay and insects. It lasts longer and requires less maintenance than most other wood species.

### VERSATILITY

Cedar is ideal for accepting a wide range of finishes. It comes in a wide variety of textures and grades.

### SUSTAINABILITY

While other building materials generate greenhouse gases, cedar removes those gases from the atmosphere and is a renewable resource.



## WHY CEDAR

Idaho Forest Group makes a science of growing and producing the very best Inland Northwest cedar. Our forests grow slowly, creating tight knots and a pleasing grain. The result is a consistently good looking, high quality product. Cedar is great for a variety of projects. It's a renewable resource that's highly revered and durable, naturally resistant to rot, decay and insect attacks. Your projects will last longer and require less maintenance.

## FACILITIES

### CORPORATE HEADQUARTERS

Located in beautiful Coeur d'Alene, Idaho, our headquarters is home to our sales management, finance and administrative departments.

We have mills in:

CHILCO

GRANGEVILLE

LACLEDE

LEWISTON

MOYIE SPRINGS

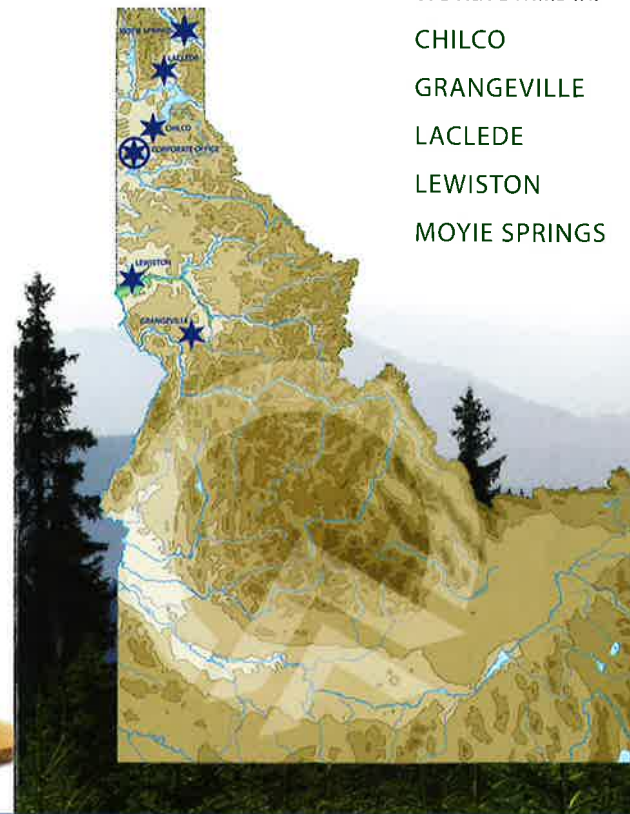

WOOD FOR A GROWING WORLD



VERSATILE • SUSTAINABLE  
BEAUTIFUL • DURABLE



IDFG.COM | (208) 762-6630

687 CANFIELD AVE., SUITE 100  
COEUR D'ALENE, ID 83815

WESTERN  
RED CEDAR  
SIDING



We are dedicated to environment-enhancing forest management practices and our products are available with Sustainable Forestry certification. IFG's fiber is sourced from U.S. Forest Service land, state land, industrial and non-industrial private land in Idaho, Montana, Washington and Canada.



## ABOUT IDAHO FOREST GROUP

Excellence is our goal in caring for natural resources, employees and customers. We have a global reach built on hometown ethics and pride in a job well done.

Our company is proud to be at the forefront of technology and innovation, to have a first-class workforce, and to offer a renewable resource with the lowest carbon footprint of any building material.

We continue to expand in facilities and market share; we are now one of America's largest lumber producers, with capacity for over 1.1 billion board feet per year and markets around the globe.

Headquartered in Coeur d'Alene, Idaho, we are located in the prime timber-growing country of the Intermountain West, and have five high-tech production facilities throughout northern Idaho in Chilco, Laclede, Moyie Springs, Grangeville and Lewiston.



SFI-01200

Bevel siding is the most widely used type of siding. It has warmth and casual charm and is ideal for homes, cottages and club-houses.

NOMINAL SIZE	ACTUAL SIZE	PATTERN	FACTOR FOR BF
1x6	.656x5.5	Bevel Siding	1.33
1x8	.656x7.25	Bevel Siding	1.28
1x10	.75x9.25	Bevel Siding	1.21

Actual size is at time of manufacture.

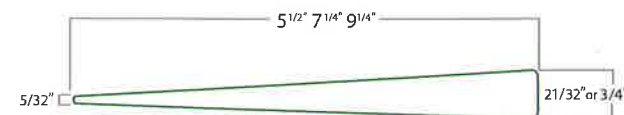

## APPLICATION INSTRUCTIONS

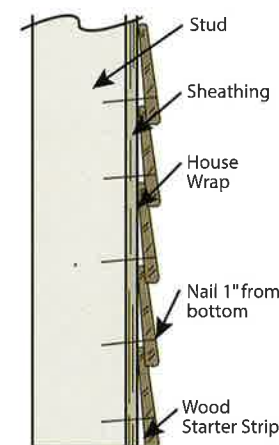

Spacing for the siding should be laid out beforehand. Start with the bottom course using a wood starter strip to support the lower edge. A wood starter strip should be the same thickness as the siding. Each succeeding course overlaps the upper edge of the previous one by a minimum of 1 inch. Where possible, the bottom of the board that is placed across the top of the windows should coincide with the window cap.

Bevel siding should be face nailed to studs with 1-1/4 inch penetration into solid wood using one ring shank hot dipped galvanized (meeting ASTM 153A) or stainless steel nail per piece spaced at a maximum of 24 inches on center. Place nail just above the overlap. Take care not to nail through the overlap of two pieces.

Do not reduce the siding overlap recommendations. Doing so could result in damage from wind-driven rain. Use the larger overlaps for unseasoned sidings to allow for shrinkage and expansion. Take care not to overdrive fasteners. Butt joints between boards should be staggered and meet on studs. Fit siding snugly to other pieces and to trim.

Tongue and groove is widely used for its look and versatility. It can be installed horizontally or vertically, giving distinctly different looks.

NOMINAL SIZE	ACTUAL SIZE	PATTERN	FACTOR FOR BF
1x6	.656x5.375	V4E T&G	1.17

Actual size is at time of manufacture.

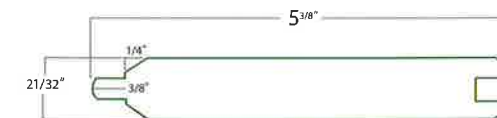

## APPLICATION INSTRUCTIONS

### HORIZONTAL

Start at the bottom and work up with the groove edges facing downwards. Can be blind nailed with one siding nail per bearing toe-nailed through the base of each tongue. Nails must penetrate 1-1/4 inches into solid wood.

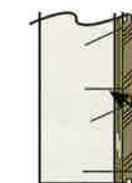

Windy or extreme weather conditions usually require two nails. Blind nail siding by toe-nailing in tongue, and add one face nail to secure the siding.

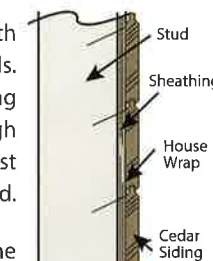

### VERTICAL

Start at one corner with grooved edge toward the adjacent wall. Use a level or plumb line to ensure that the first board is installed plumb. The grooved edge of the first board may have to be trimmed to ensure a flush fit. Siding is nailed to horizontal blocking lines installed between studs or to wood starter strips. Pieces up to 6 inches can be blind nailed and wider pieces should be face nailed.

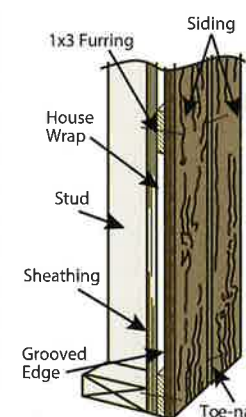

Cedar is one of the most stable softwoods, yet it can shrink or swell as it reaches equilibrium with the level of moisture in the air. To adequately acclimate before installing, stack the siding on a vapor barrier, evenly spaced, vertically aligned stickers in the area in which it will be installed with good air flow.

Use 2x4, 2x6 or cinder blocks to elevate the first level. Store in a covered area. A fan will increase air circulation and can speed up drying.

We recommended adequately acclimating cedar for two to four weeks in the environment in which it will be installed.

