



**CITY OF MILWAUKEE
OFFICE OF THE CITY CLERK**

Tuesday, May 02, 2023

COMMITTEE MEETING NOTICE

AD 12

PEREZ MARTINEZ, Toribio, Agent
Taqueria El Toro LLC
1640 S 56th St
Milwaukee, WI 53214

You are requested to attend a hearing which is to be held in Room 301-B, Third Floor, City Hall or you may attend virtually using the link below.

Tuesday, May 16, 2023 at 09:30 AM

The access code is <https://meet.goto.com/500790805>. If you wish to call in: [+1 \(646\) 749-3122](tel:+16467493122) and use Access Code: 500-790-805.
Please see the enclosed best practices document for further instructions.

Regarding: Your Public Entertainment Premises License Application Requesting 5 Amusement Machines as agent for "Taqueria El Toro LLC" for "Taqueria El Toro LLC" at 551 W Historic Mitchell St.

There is a possibility that your application may be denied for one or more of the following reasons: The recommendation of the committee regarding the application shall be based on evidence presented at the hearing. Per MCO 85-2.7-4, probative evidence concerning whether or not a new license should be granted may be presented on the following subjects: whether or not the applicant meets the municipal requirements, the appropriateness of the location and premises where the licensed premises is to be located and whether use of the premises for the purposes or activities permitted by the license would tend to facilitate a public or private nuisance or create undesirable neighborhood problems such as disorderly patrons, unreasonably loud noise, litter, and excessive traffic and parking congestion. Probative evidence relating to these matters may be taken from the plan of operation submitted with the license application, if any, but shall not include the content of any music. Evidence regarding the fitness of the location of the premises to be maintained as the principal place of business, including but not limited to whether there is an overconcentration of businesses of the type for which the license is sought; whether the proposal is consistent with any pertinent neighborhood business or development plans, or the location's proximity to areas where children are typically present. The applicant's record in operating similarly licensed premises; and whether or not the applicant has been charged with or convicted of any felony, misdemeanor, municipal offense or other offense, the circumstances of which substantially relate to the activity to be permitted by the license being applied for or any other factor which reasonably relates to the public health, safety or welfare may also be considered. See attached police report or correspondence.

Notice for applicants with warrants or unpaid fines:

Proof of warrant satisfaction or payment of fines must be submitted at the hearing on the above date and time. Failure to comply with this requirement may result in a delay of the granting/denial of your application.

Failure to appear at this meeting may result in the denial of your license. Individual applicants must appear only in person or by an attorney. Corporate or Limited Liability applicants must appear only by the agent designated on the application or by an attorney. Partnership applicants must appear by a partner listed on the application or by an attorney. If you wish to do so and at your own expense, you may be accompanied by an attorney of your choosing to represent you at this hearing.

You will be given an opportunity to speak on behalf of the application and to respond and challenge any charges or reasons given for the denial. No petitions can be accepted by the committee, unless the people who signed the petition are present at the committee hearing and willing to testify. You may present witnesses under oath and you may also confront and cross-examine opposing witnesses under oath. If you have difficulty with the English language, you should bring an interpreter with you, at your expense, so that you can answer questions and participate in your hearing.

You may examine the application file at this office during regular business hours prior to the hearing date. Inquiries regarding this matter may be directed to the person whose signature appears below.

Limited parking for persons attending meetings during normal business hours is available at reduced rates (5 hour limit) at the Milwaukee Center on the southwest corner of Kilbourn Avenue and Water Street. You must present a copy of the meeting notice to the parking cashier.

PLEASE NOTE: Upon reasonable notice, efforts will be made to accommodate the needs of disabled individuals through sign language interpreters or other auxiliary aids. For additional information or to request this service, contact the Council Services Division ADA Coordinator at (414) 286-2998, Fax - (414) 286-3456, TDD - (414) 286-2025.

JIM OWCZARSKI, CITY CLERK

BY: _____

Jim Cooney
License Division Manager

If you have questions regarding this notice, please contact the License Division at (414) 286-2238.

200 E. Wells Street, Room 105, City Hall, Milwaukee, WI 53202. www.milwaukee.gov/license
Phone: (414) 286-2238 Fax: (414) 286-3057 Email Address: License@milwaukee.gov

FW: Taqueria EL Toro

License <LICENSE@milwaukee.gov>

Mon 5/1/2023 9:30 AM

To: Collins, Rolanda <Rolanda.Collins@milwaukee.gov>

Cc: Cooney, Jim <Jim.Cooney@milwaukee.gov>; Martin, Faviola <Faviola.Martin@milwaukee.gov>

Please add objection

Marissa Milano

She/her/hers

License Coordinator

City Clerk-License Division

200 E Wells St #105

www.milwaukee.gov/license**REDACTED RECORD**

From

Sent: Sunday, April 30, 2023 4:37 PM

To: Murillo, Maribel <Maribel.Murillo@milwaukee.gov>

Cc: License <LICENSE@milwaukee.gov>; Benitez, Xavier <xbenit@milwaukee.gov>; Williamson2, Latasha <Latasha.Williamson2@milwaukee.gov>; Perez, Jose <JoseG.Perez@milwaukee.gov>

Subject: Re: Taqueria EL Toro

I see that this location has now applied for a public entertainment license but it has not been granted and they are still operating as though it has been. Their machines are still powered on and in operation. Why would you want to issue additional licenses to a business that cares so little about the rules?

On Sun, Mar 19, 2023, 12:07 PM Murillo, Maribel <Maribel.Murillo@milwaukee.gov> wrote:

| Thank you for your email.

License and MPD will be looking into this matter.

Respectfully,

Maribel Murillo

Legislative Assistant | Common Council President José G. Pérez

City Hall 200 E. Wells St Room 205

Milwaukee, Wisconsin 53202

Please excuse any grammatical errors, sent from my mobile device.

On Mar 18, 2023, at 10:07 PM
wrote:

Good evening,

Taqueria EL Toro located at 551 W Historic Mitchell St does not have a public entertainment license, nor have they ever bothered to apply for one, and yet they're running this place like a casino.

The City of Milwaukee is subject to Wisconsin Statutes related to public records. Unless otherwise exempted from the public records law, senders and receivers of City of Milwaukee e-mail should presume that e-mail is subject to release upon request, and is subject to state records retention requirements. See City of Milwaukee full e-mail disclaimer at www.milwaukee.gov/email_disclaimer

REDACTED RECORD

10

Cox, Andrew

From: Cooney, Jim
Sent: Monday, March 20, 2023 8:21 AM
To: Cox, Andrew
Cc: Milano, Marissa
Subject: FW: Taqueria EL Toro

Andrew,

Can you add this as an objection and send them a letter telling them to apply for a PEP?

Thanks

Jim Cooney
License Division Manager
City Clerk-License Division
200 E Wells St #105
414-286-2238
www.milwaukee.gov/license

REDACTED RECORD



From: Pajot, Patrick <ppajot@milwaukee.gov>
Sent: Sunday, March 19, 2023 3:20 PM
To: Murillo, Maribel <Maribel.Murillo@milwaukee.gov>
Cc: Cooney, Jim <Jim.Cooney@milwaukee.gov>; Milano, Marissa <ldcoord@milwaukee.gov>; district, two <mpd2@milwaukee.gov>; Carloni, Justin <jcarlo@milwaukee.gov>; Gloria, Jesus <jglori@milwaukee.gov>; Velasquez, Guadalupe <gvelas@milwaukee.gov>; Clifford, Daniel <dcliffo@milwaukee.gov>; Contreras, Eliel <econtr@milwaukee.gov>; Williamson2, Latasha <Latasha.Williamson2@milwaukee.gov>; Perez, Jose <JoseG.Perez@milwaukee.gov>;
Subject: Re: Taqueria EL Toro

Yes maribel I will have my tavern squad check it out.

Sent from my iPhone

On Mar 19, 2023, at 12:04 PM, Murillo, Maribel <Maribel.Murillo@milwaukee.gov> wrote:

Good afternoon all,

License- does Taqueria el Toro have the proper license to have gaming machines?
MPD-Can you please have someone look into this matter.

Respectfully,

Maribel Murillo
Legislative Assistant | Common Council **President José G. Pérez**
City Hall 200 E. Wells St Room 205
Milwaukee, Wisconsin 53202

Please excuse any grammatical errors, sent from my mobile device.

Begin forwarded message:

REDACTED RECORD

From:

Date: March 18, 2023 at 10:07:57 PM CDT

To: License <LICENSE@milwaukee.gov>, "Benitez, Xavier"
<xbenit@milwaukee.gov>, "Perez, Jose" <JoseG.Perez@milwaukee.gov>

Subject: Taqueria EL Toro

Good evening,

Taqueria EL Toro located at 551 W Historic Mitchell St does not have a public entertainment license, nor have they ever bothered to apply for one, and yet they're running this place like a casino.



Tuesday, May 02, 2023



Notice of Public Hearing

Blank Notice

PEREZ MARTINEZ, Toribio, Agent
Taqueria El Toro LLC at 551 W Historic Mitchell St
Public Entertainment Premises License Application Requesting 5 Amusement Machines

Tuesday, May 16, 2023 at 9:30 AM

To whom it may concern:

The above application has been made by the above named applicant(s). This requires approval from the Licenses Committee and the Common Council of the City of Milwaukee. The hearing before the Licenses Committee will take place on 5/16/2023 at 9:30 AM in Room 301-B, Third Floor, City Hall. This is a public hearing. Those wishing to view the proceeding are able to do so via the City Channel – Channel 25 on Spectrum Cable – or on the Internet at <http://city.milwaukee.gov/citychannel>. Those wishing to provide oral testimony via phone or internet are asked to contact the staff assistant, Yadira Melendez at (414) 286-2775 or stasst5@milwaukee.gov for necessary information. Please make such requests no later than one business day prior to the start of the meeting. You are not required to attend the hearing, but please see the information below if you would like to provide testimony. Once the Licenses Committee makes its recommendation, this recommendation is forwarded to the full Common Council for approval at its next regularly scheduled hearing.

Important details for those wishing to provide information for the Licenses Committee to consider when making its recommendation:

1. The license application is scheduled to be heard at the above time. Due to other hearings running longer than scheduled, you may have to wait some time to provide your testimony.
2. You must appear in person and testify as to matters that you have personally experienced or seen. (You cannot provide testimony for your neighbor, parent or anyone else; this is considered hearsay and cannot be considered by the committee.)
3. No letters or petitions can be accepted by the committee (unless the person who wrote the letter or the persons who signed the petition are present at the committee hearing and willing to testify).
4. Persons opposed to the license application are given the opportunity to testify first; supporters may testify after the opponents have finished.
5. When you are called to testify, you will be sworn in and asked to give your name, and address. (If your first and/or last names are uncommon please spell them.)
6. You may then provide testimony.
 - a. Include only information relating to the above license application.
 - b. Include only information you have personally witnessed or seen.
 - c. Provide concise and relevant information detailing how this business has affected or may affect the peaceful enjoyment of your neighborhood.
 - d. If by the time you have the opportunity to testify, the information you wish to share has already been provided to the committee, you may state that you agree with the previous testimony. Redundant or repetitive testimony will not assist the committee in making its recommendation.
7. After giving your testimony, the members of the Licenses Committee and the licensee may ask questions regarding the testimony you have given or other factors relating to the license application.
8. Business Competition is not a valid basis for denial or non-renewal of a license.
Please Note: If you have submitted an objection to the above application your objection cannot be considered by the committee unless you personally testify at the hearing.

CURRENT OCCUPANT	1672 S 6TH ST	MILWAUKEE, WI 53204-3407
CURRENT OCCUPANT	1672A S 6TH ST	MILWAUKEE, WI 53204-3407
CURRENT OCCUPANT	1720 S 6TH ST	MILWAUKEE, WI 53204-3502
CURRENT OCCUPANT	1724 S 6TH ST	MILWAUKEE, WI 53204-3502
CURRENT OCCUPANT	1724A S 6TH ST	MILWAUKEE, WI 53204-3502
CURRENT OCCUPANT	1724B S 6TH ST	MILWAUKEE, WI 53204-3502
CURRENT OCCUPANT	1724C S 6TH ST	MILWAUKEE, WI 53204-3502
CURRENT OCCUPANT	1726 S 6TH ST	MILWAUKEE, WI 53204-3502
CURRENT OCCUPANT	1726A S 6TH ST	MILWAUKEE, WI 53204-3502
CURRENT OCCUPANT	1728 S 7TH ST	MILWAUKEE, WI 53204-3538
CURRENT OCCUPANT	1730 S 6TH ST	MILWAUKEE, WI 53204-3502
CURRENT OCCUPANT	1730B S 6TH ST	MILWAUKEE, WI 53204-3502
CURRENT OCCUPANT	1731 S 5TH ST	MILWAUKEE, WI 53204-3501
CURRENT OCCUPANT	1732 S 7TH ST	MILWAUKEE, WI 53204-3538
CURRENT OCCUPANT	1734 S 6TH ST	MILWAUKEE, WI 53204-3502
CURRENT OCCUPANT	1739 S 6TH ST	MILWAUKEE, WI 53204-3503
CURRENT OCCUPANT	1739A S 6TH ST	MILWAUKEE, WI 53204-3503
CURRENT OCCUPANT	511 W LAPHAM BLVD# 101	MILWAUKEE, WI 53204-3416
CURRENT OCCUPANT	511 W LAPHAM BLVD# 102	MILWAUKEE, WI 53204-3416
CURRENT OCCUPANT	511 W LAPHAM BLVD# 103	MILWAUKEE, WI 53204-3416
CURRENT OCCUPANT	511 W LAPHAM BLVD# 104	MILWAUKEE, WI 53204-3416
CURRENT OCCUPANT	511 W LAPHAM BLVD# 201	MILWAUKEE, WI 53204-3416
CURRENT OCCUPANT	511 W LAPHAM BLVD# 202	MILWAUKEE, WI 53204-3416
CURRENT OCCUPANT	511 W LAPHAM BLVD# 203	MILWAUKEE, WI 53204-3416
CURRENT OCCUPANT	511 W LAPHAM BLVD# 204	MILWAUKEE, WI 53204-3416
CURRENT OCCUPANT	516 W MAPLE ST	MILWAUKEE, WI 53204-3505
CURRENT OCCUPANT	516A W MAPLE ST	MILWAUKEE, WI 53204-3505
CURRENT OCCUPANT	516B W MAPLE ST	MILWAUKEE, WI 53204-3505
CURRENT OCCUPANT	516C W MAPLE ST	MILWAUKEE, WI 53204-3505
CURRENT OCCUPANT	521 W LAPHAM BLVD# 101	MILWAUKEE, WI 53204-3417
CURRENT OCCUPANT	521 W LAPHAM BLVD# 102	MILWAUKEE, WI 53204-3417
CURRENT OCCUPANT	521 W LAPHAM BLVD# 103	MILWAUKEE, WI 53204-3417
CURRENT OCCUPANT	521 W LAPHAM BLVD# 104	MILWAUKEE, WI 53204-3417
CURRENT OCCUPANT	521 W LAPHAM BLVD# 201	MILWAUKEE, WI 53204-3417
CURRENT OCCUPANT	521 W LAPHAM BLVD# 202	MILWAUKEE, WI 53204-3417
CURRENT OCCUPANT	521 W LAPHAM BLVD# 203	MILWAUKEE, WI 53204-3417
CURRENT OCCUPANT	521 W LAPHAM BLVD# 204	MILWAUKEE, WI 53204-3417
CURRENT OCCUPANT	522 W MAPLE ST	MILWAUKEE, WI 53204-3505
CURRENT OCCUPANT	522A W MAPLE ST	MILWAUKEE, WI 53204-3505
CURRENT OCCUPANT	524 W MAPLE ST	MILWAUKEE, WI 53204-3505
CURRENT OCCUPANT	526 W MAPLE ST	MILWAUKEE, WI 53204-3505
CURRENT OCCUPANT	528 W MAPLE ST	MILWAUKEE, WI 53204-3505
CURRENT OCCUPANT	531 W LAPHAM BLVD# 101	MILWAUKEE, WI 53204-3418
CURRENT OCCUPANT	531 W LAPHAM BLVD# 102	MILWAUKEE, WI 53204-3418
CURRENT OCCUPANT	531 W LAPHAM BLVD# 103	MILWAUKEE, WI 53204-3418
CURRENT OCCUPANT	531 W LAPHAM BLVD# 104	MILWAUKEE, WI 53204-3418
CURRENT OCCUPANT	531 W LAPHAM BLVD# 201	MILWAUKEE, WI 53204-3418

CURRENT OCCUPANT	609 W HISTORIC MITCHELL ST# 405	MILWAUKEE, WI 53204-3595
CURRENT OCCUPANT	609 W HISTORIC MITCHELL ST# 406	MILWAUKEE, WI 53204-3595
CURRENT OCCUPANT	609 W HISTORIC MITCHELL ST# 407	MILWAUKEE, WI 53204-3595
CURRENT OCCUPANT	609 W HISTORIC MITCHELL ST# 408	MILWAUKEE, WI 53204-3595
CURRENT OCCUPANT	616 W MAPLE ST	MILWAUKEE, WI 53204-3507
CURRENT OCCUPANT	616A W MAPLE ST	MILWAUKEE, WI 53204-3507

Blank Notice

Total Records: 193

Radius 250.0 feet and Center of the Circle: 551 W Historic Mitchell St



BUSINESS LICENSE PLAN OF OPERATION

ccl-busplan 12/14/17

Office of the City Clerk License Division
200 E. Wells St. Room 105, Milwaukee, WI 53202
(414) 286-2238 www.milwaukee.gov/license e-mail address: license@milwaukee.gov

1. Type of Business

Applying for: Extended Hours (12AM to 5AM) - If a food establishment, check all that apply: Delivery Drive Thru Dining Room
 Self Service Laundry Massage Establishment Filling Station
 Other (supplemental application for specific license also required)

Provide a detailed description of the type of business you plan on operating:

Full Service Restaurant

Do you have any experience operating this type of business? No Yes If yes, explain: Have other Bus. Rest.

2. Business Operations

- a. Proposed Opening Date: already open
- b. Is this premise under construction? No Yes If yes, list estimated completion date: _____
- c. Is this a franchise? No Yes
- d. Is this premises currently licensed? No Yes If yes, list type of license: Food License
- e. Is the current licensee operating? No Yes If no, list date closed: _____
- f. Do you have future plans for other businesses, licenses or permits at this location? No Yes
If yes, explain: _____
- g. Have you previously held an Extended Hours License in Milwaukee? No Yes
If yes, list address(es): _____
- h. Are other businesses operating in the same building? No Yes If yes, describe: _____

3. Litter & Noise

- a. How are grounds kept clean? Sweep Pressure Wash Pick Up Litter Other: _____
- b. How often will grounds be cleaned? Daily Weekly As Needed Monthly Other: _____
- c. Grounds cleaned by: Licensee Building Owner Employees Hired Maintenance Other: _____
- d. How are noise issues prevented and/or addressed? Security Manager approaches customer(s) Call Police
 Signs Posted Other: _____
- e. Will a sound amplification system be used? No Yes If yes, describe: _____

4. Smoking & Sanitation

- a. Are there designated outdoor smoking areas? No Yes If yes, describe: _____
- b. Number of Garbage Cans: Inside: 7 Locations: Restrooms, Kitchen, Freezer.
Outside: 2 Locations: Back Parking.
- c. Is a crowd control barrier used? No Yes If yes, describe: _____
- d. How many restrooms are on the premises? 2
- e. Name of solid waste contractor: Advanced Disposal Waste Management Other: American Eagle

5. Security

- a. Are there onsite parking spaces? No Yes If yes, indicate how many? 1 and describe the parking security plan: Cameras.
- b. Is there a loading zone? No Yes If yes, describe the loading area security plan: _____
- c. Will you have security personnel on premise? No Yes If yes, how many? 1 and answer the following:
 What are their responsibilities? walk around parking lot
 Is security equipment used? No Yes If yes, describe _____
 List their licensing, certification, or training credentials None
- d. Will there be security cameras? No Yes If yes, where? one at back one at front door one on back entrance.
- e. Will searches/identification checks be done upon entry? No Yes If yes, describe _____

6. Percentage of Sales (must total 100%)

Alcohol <u>15</u> %	Food <u>85</u> %	Secondhand Merchandise _____ %	Precious Metals & Gems _____ %
Entertainment _____ %	Cigarettes _____ %	Personal Services (such as tattoo, body piercing, salon, tailor, tanning, etc.) _____ %	Other _____ % Describe: _____
Pawnbroker Activity _____ %	Salvaged Materials _____ % (such as scrap metal)		

7. Businesses/Licenses on the Premises (check all that apply):

- Type 1
- Full Service Restaurant Cafe/Coffee Shop Deli or Fast Food Restaurant Private/Fraternal/Veterans Club
- Night Club Tavern Cocktail Lounge Teen Club
- Banquet Hall Sports Facility Bowling Alley
- Hotel/Motel: Number of Floors: _____ Rooming House: Number of Floors: _____
 Number of Rooms: _____ Number of Rooms: _____

- Type 2
- Liquor Store Corner Store Supermarket Convenience Store
- Gas Station Amusement/Phonograph Distributor Recycling, Salvage or Towing
- Used Car Dealer Personal Service Establishment (such as tattoo business, hair salon, tailor, etc.) Recording Studio

What other licenses/permits will you hold at this location? (check all that apply)

- Occupancy Permit Cigarette & Tobacco Gas Station Extended Hours Class "B" Tavern Weights & Measures
- Secondhand Dealer Precious Metal & Gem Other: PEP

8. Legal Capacity (only if a Type 1 premises in #7 above)

Capacity 80 (Call the Milwaukee Development Center at 414-286-8211 if you have questions.)

9. Premises Description

a. Identify all area(s) of the premises that will be used in operating this business (include areas used only for storage):

1st Floor 2nd Floor Basement Storage Patio Beer Garden Sidewalk Café Deck Rooftop

Other: Describe: _____

b. Describe Location: Major Thoroughfare Secondary Street Other: Mitchell and Cohn St

c. Nearest Major Cross Street: Mitchell and Cohn Street

d. Describe Building: Free Standing Building Strip Mall Other: _____

e. Describe Premises Structure: Single Story Multi-Story - # of Stories 2 Other: _____

f. Describe Surrounding Area: Commercial Residential Industrial Other: _____

g. Building Owner Name: Mitchell 557 LLC Phone Number: 414-645-2467

Business Owner Address: 557 Mitchell St - Milwaukee WI 53204

10. Hours of Operation & Customers

Will customers be entering the premises? No Yes

Day of the Week	Proposed Hours of Operation:		Estimated Number of Customers expected each day	Potential Age Range of Customers	Class B Tavern Applicant Only: Age Restriction (If none, write 'None')
	Open Time (include a.m. or p.m.)	Close Time (include a.m. or p.m.)			
Sunday	10 AM	2 AM	100	1-100	NONE
Monday	10 a.m.	2 AM	100	1-100	NONE
Tuesday	10 a.m.	2 AM	100	1-100	NONE
Wednesday	10 a.m.	2 AM	100	1-100	NONE
Thursday	10 AM	2 AM	100	1-100	NONE
Friday	10 AM	2:30 AM	100	1-100	NONE
Saturday	10 AM	2:30 AM	100	1-100	NONE

An Extended Hours Establishment License is required for any convenience store, filling station, personal service establishment (such as tattoo, body piercing, salon, tailor, tanning, etc.), recording studio or restaurant which is open between the hours of 12:00 a.m. and 5:00 a.m.

Alcohol Establishments Class A: 8:00 am to 9:00 pm Sunday thru Saturday
 Permitted Hours of Operation: Class B: 6:00 am to 2:00 am Sunday thru Thursday, 6:00 am to 2:30 am Friday & Saturday

Entertainment Outdoor Closing Hours: 10:00pm Sunday-Thursday; 12:00am Friday & Saturday; unless a different time, either earlier or later, is established by the Common Council in its approval of the licensee's plan of operation.

11. Signature(s)

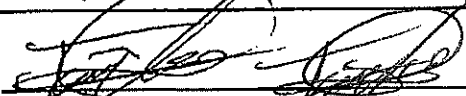
 Signature of Sole Proprietor, Partner, or 20% or more Shareholder
 (If there are no 20% or more shareholders, Corporate Officer-print name/title and sign)

 Signature of additional partner or 20% or more shareholder

See Application Information for a complete list of all required application forms.



**ALCOHOL BEVERAGE & PUBLIC ENTERTAINMENT PREMISES
SUPPLEMENTAL APPLICATION**

Office of the City Clerk License Division
200 E. Wells St. Room 105, Milwaukee, WI 53202
(414) 286-2238 e-mail address: license@milwaukee.gov www.milwaukee.gov/license

Legal Entity Name: Taqueria El Toro LLC.

Premise Address: 551 W. Mitchell St Milwaukee WI 53204

Proximity of Premises to Church, School, Daycare Center or Hospital

Is the building within 300 feet of any church, school, daycare center or hospital? No Yes

"Service Bar Only" Designation

If applying for Class B or C license, are you applying for "Service Bar Only"? No Yes
Service Bar Only means customers cannot sit at the bar. Alcohol is served to employees who serve patrons seated at tables. No stools, chairs or other articles of furniture shall be placed at the service bar for patrons to sit upon.

Business Information

a) Are you taking out this application for anyone that may not be eligible for a license? No Yes
If yes, list their name and address: _____

b) Will the agent, a partner or the individual licensee be conducting the day-to-day operations of the business? No Yes
If no, list the name and address of the person(s) who will: _____

Class B Applicants: If the agent, a partner or the individual licensee will not be conducting the day-to-day operations of the business, the person(s) listed above must obtain a Class B Managers license.

c) Does anyone else have money invested or any other interest in this business? No Yes
If yes, explain: _____

d) Have you made an agreement with anyone to repay any loan or any other payments based upon income from the business?
 No Yes If yes, list name and address: _____

Property Information (New & Transfer Applicants Only)

a) Do you own or lease the building? Own Lease

b) Who owns the fixtures (for example, coolers, etc.)? Taqueria El Toro

c) Are you purchasing the stock and/or fixtures? No Yes If yes, amount paid \$ _____

d) Total amount paid for business \$ N/A

e) Total amount paid for goodwill of the business \$ N/A

Goodwill comprises the reputation and customer relationships of an existing business. If the price you pay for the business exceeds the fair market value of all of the rest of the assets of the business, the excess may be considered goodwill.

f) Have you made arrangements with the seller for payment of personal property taxes? No Yes

Lease Information (New & Transfer Applicants who are leasing the premises only)

a) Date lease begins 9/01/18 Ends 8-31-20 change to month to month now

b) Monthly rental \$ 2000

c) Do you have an option to renew the lease? No Yes

d) Does your lease allow for assignment to another party without the consent of the owner? No Yes

e) For what length of time have you been guaranteed occupancy (number of years)? 10 to 20



Lease Information (Continued)

- f) In addition to paying the monthly rental, will you have to pay anything additional to the owner of the building to guarantee performance of the lease? No Yes If yes, explain _____
- g) Does the present owner or occupant object to the granting of your license? No Yes
If yes, explain _____

Change of Agent Applicants Only

Have there been any changes to the floor plan since the last application was submitted? No Yes
If no, a new floor plan is not required. If yes, submit a new floor plan and explain the change(s):

Signature

 _____
 _____
Signature of Sole Proprietor, Partner or 20% or More Shareholder
(If no 20% or more Shareholder, Corporate Officer - print name/title and sign)

Note: All information contained in this application is subject to approval by the Common Council.
Deviating from approved plan of operation will subject licensee to citations, and/or suspension or non-renewal of the license.
Contact the License Division for information on how to request changes.

New and transfer of premises applicants must submit the following:

- Detailed floor plan
- If a restaurant, copy of the menu



PUBLIC ENTERTAINMENT PREMISES LICENSE SUPPLEMENTAL APPLICATION

Office of the City Clerk License Division
200 E. Wells St. Room 105, Milwaukee, WI 53202
(414) 286-2238 www.milwaukee.gov/license e-mail address: license@milwaukee.gov

PREMISES ADDRESS: 551th s. Mitchell st. Milwaukee WI 53204

TYPES OF ENTERTAINMENT (CHECK ALL THAT APPLY)

<input type="checkbox"/> Instrumental Musicians	<input type="checkbox"/> Battle of the Bands	<input type="checkbox"/> Dancing by Performers	<input checked="" type="checkbox"/> Amusement Machines How many? <u>5</u>
<input type="checkbox"/> Bands	<input type="checkbox"/> Comedy Acts	<input type="checkbox"/> Adult Entertainment/ Strippers/Erotic Dance	<input type="checkbox"/> Concerts Approx. # per year? _____
<input type="checkbox"/> Bowling Alley How many? _____	<input type="checkbox"/> Disc Jockey	<input type="checkbox"/> Wrestling	<input type="checkbox"/> Theatrical Performances Approx. # per year? _____
<input type="checkbox"/> Pool Tables How many? _____	<input type="checkbox"/> Magic Shows	<input type="checkbox"/> Patron Contests	<input type="checkbox"/> Jukebox
<input type="checkbox"/> Motion Pictures (movies by admission) - How many? _____	<input type="checkbox"/> Poetry Readings	<input type="checkbox"/> Patrons Dancing	<input type="checkbox"/> Karaoke
<input type="checkbox"/> Other: _____			

Entertainment Outdoor Closing Hours: 10:00pm Sunday-Thursday; 12:00am Friday & Saturday; unless a different time, either earlier or later, is established by the Common Council in its approval of the licensee's plan of operation.

PROMOTERS/SOUND AMPLIFICATION

Will promoters ever be used for any of the entertainment? No Yes If Yes, Describe:

At any time will sound amplification be used? No Yes If Yes, Describe:

LEGAL CAPACITY OF PREMISES

_____ (Call the Development Center at 414-286-8211 with questions.) Legal capacity determines the fee for your Public Entertainment Premises License. If you would like to request the license be approved with a lower capacity than that listed above, indicate the lower capacity here: _____. If approved, this lower capacity will print on your license and override the capacity listed on your Occupancy Permit.

ACKNOWLEDGEMENT/SIGNATURE

I understand that after the license has been issued, a change to the plan of operation will require a written request to change and approval from the Common Council. I agree to inform the City Clerk within 10 days of any substantial changes in the information supplied in this application. I understand that I shall not willfully refuse to provide the services offered under this license, or add charges or require deposits not required of the general public because of race, color, sex, religion, national origin or ancestry, age, handicap, lawful source of income, marital status, sexual orientation, gender identity or expression, familial status or the fact that a person is now or has been a member of the military service, whether dressed in uniform or not; and shall not seek such information as a condition of employment, or penalize any employee or discriminate in the selection of personnel for training or promotion on the basis of such information.

I have knowledge of the City Ordinances currently regulating public entertainment, and understand that the license may be subject to suspension, non-renewal or revocation, if I violate any rule, law or regulation of the city of Milwaukee and State of Wisconsin.

[Signature]
Signature of Sole Proprietor, Partner or 20% or More Shareholder
(If no 20% or more Shareholder, Corporate Officer - print name/title and sign)

Office Use Only:

Initials: _____ Filed: _____ App: _____

Only PEP? No Yes If Yes, Queue to MPD and Email Mgrs/Team Lead (must be heard w/in 60 days)

Date 3-28-2023
 Total 54100
 only kg...

Fayena El Toro LLC BIA Taperan-el Toro LLC
 551 W Historic Mitchell St
 Milwaukee WI 53204
 Agent Tori... Pence...
 18
 25
 18
 25
 18
 25

UP dated floor plan
 (up dated floor plan)
 (up dated floor plan)

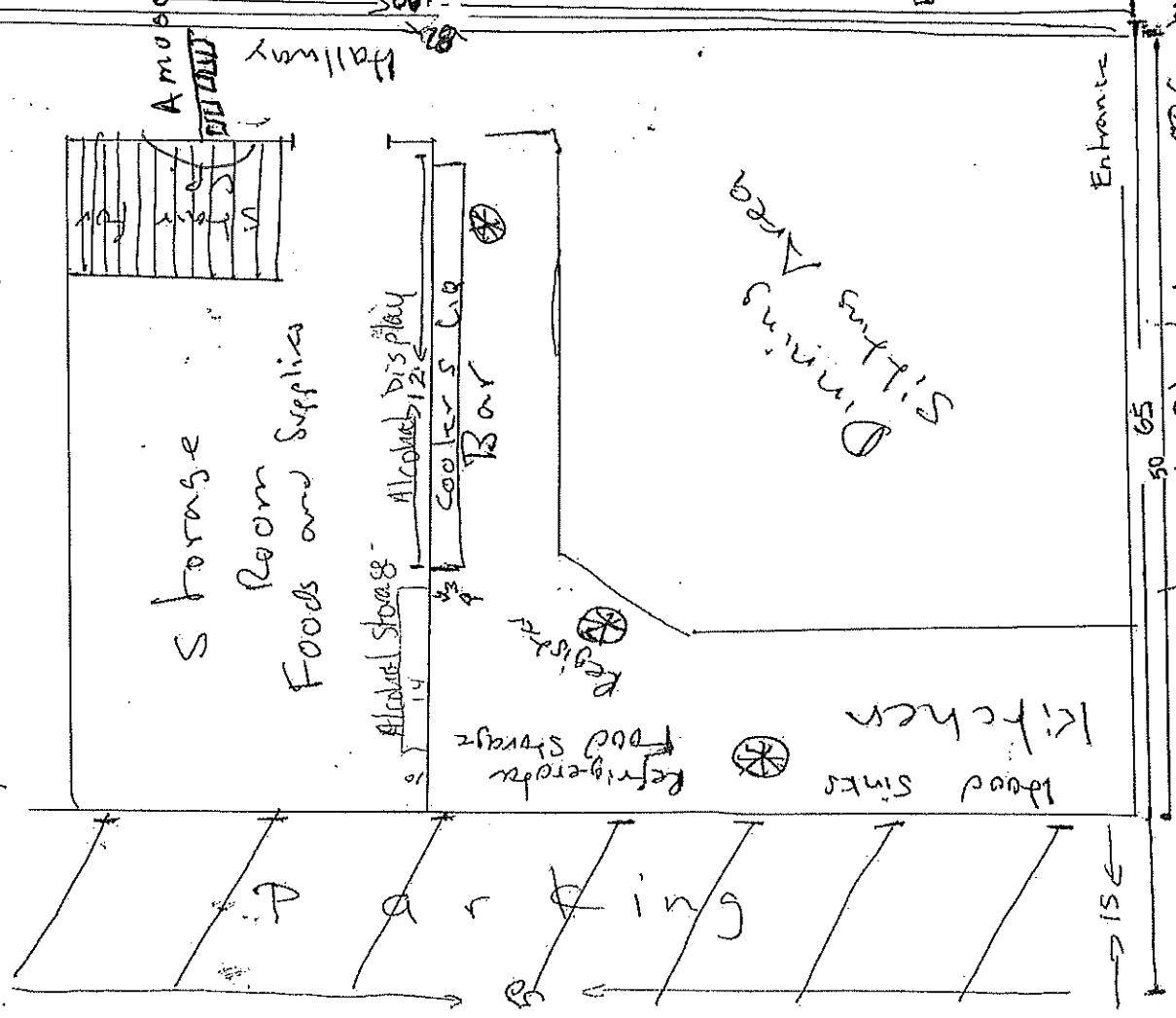

Mitchell Street
 50
 65
 Garbage Cans

Fayvera El Toro LLC DBA Fayvera El Toro LLC
551 W Historic Mitchell St
Milwaukee WI 53204
Agent Toribio Perez Martinez

Date
9/20/18

Total SF
1,200

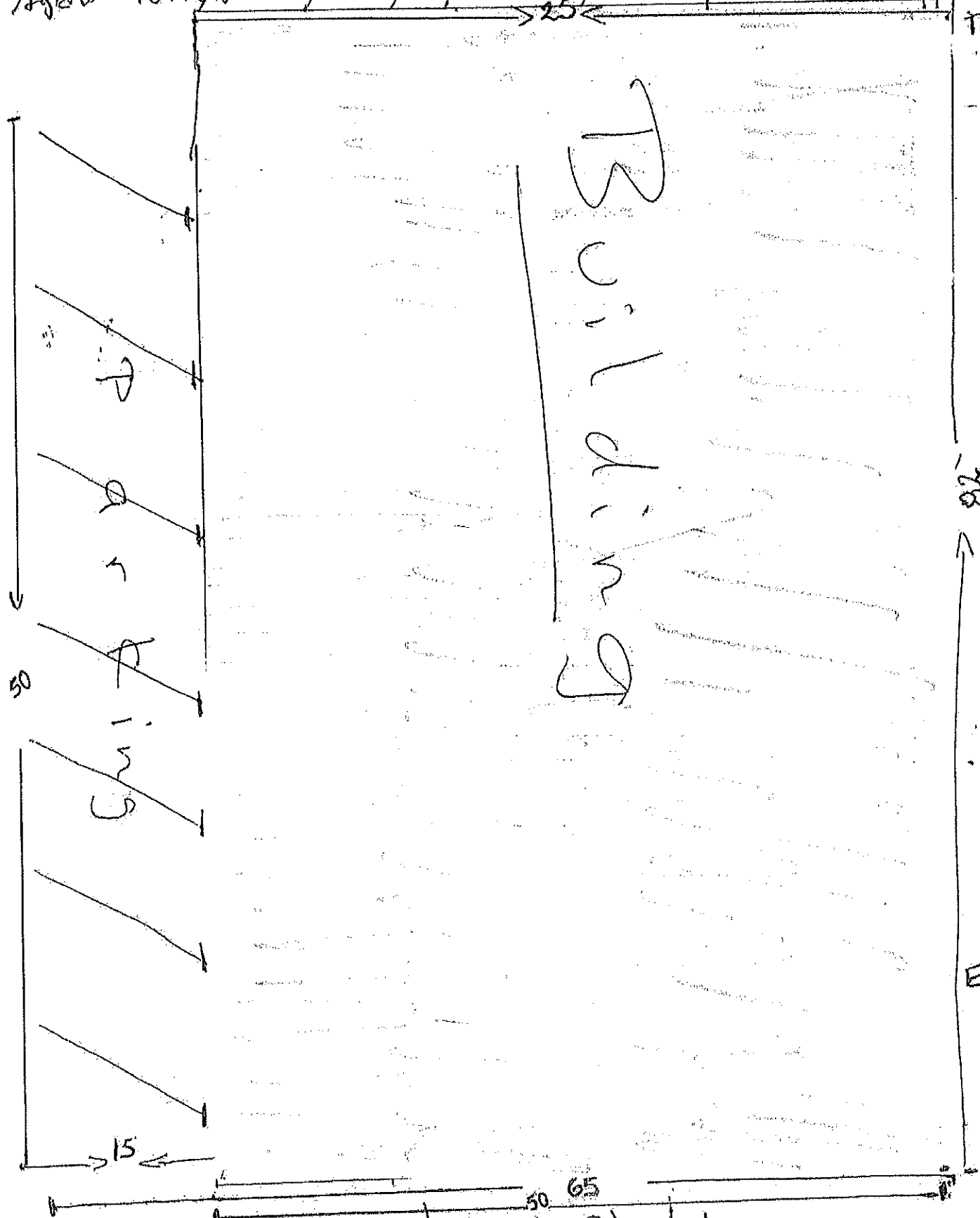

6th Street
S
N

50 65
Mitchell Street