



**CITY OF MILWAUKEE
OFFICE OF THE CITY CLERK**

Thursday, July 24, 2025

COMMITTEE MEETING NOTICE

AD 14

MARTIN, Jennifer J, Agent
PIGGLY WIGGLY MIDWEST, LLC
123 W OKLAHOMA Av
Milwaukee, WI 53207

You are requested to attend a hearing which is to be held in the Council Chambers, Third Floor, City Hall:

Thursday, July 31, 2025 at 08:45 AM

Regarding: Your Class A Malt & Class A Liquor, Food Dealer and Weights & Measures Licenses Application as agent for "PIGGLY WIGGLY MIDWEST, LLC" for "PIGGLY WIGGLY SUPERMARKET #7" at 123 W OKLAHOMA Av.

There is a possibility that your application may be denied for one or more of the following reasons: The recommendation of the committee regarding the application shall be based on evidence presented at the hearing. Per MCO 85-2.7-4, probative evidence concerning whether or not a new license should be granted may be presented on the following subjects: whether or not the applicant meets the municipal requirements, the appropriateness of the location and premises where the licensed premises is to be located and whether use of the premises for the purposes or activities permitted by the license would tend to facilitate a public or private nuisance or create undesirable neighborhood problems such as disorderly patrons, unreasonably loud noise, litter, and excessive traffic and parking congestion. Probative evidence relating to these matters may be taken from the plan of operation submitted with the license application, if any, but shall not include the content of any music. Evidence regarding the fitness of the location of the premises to be maintained as the principal place of business, including but not limited to whether there is an overconcentration of businesses of the type for which the license is sought; whether the proposal is consistent with any pertinent neighborhood business or development plans, or the location's proximity to areas where children are typically present. The applicant's record in operating similarly licensed premises; and whether or not the applicant has been charged with or convicted of any felony, misdemeanor, municipal offense or other offense, the circumstances of which substantially relate to the activity to be permitted by the license being applied for or any other factor which reasonably relates to the public health, safety or welfare may also be considered. See attached police report or correspondence.

**Notice for applicants with
warrants or unpaid fines:**

Proof of warrant satisfaction or payment of fines must be submitted at the hearing on the above date and time. Failure to comply with this requirement may result in a delay of the granting/denial of your application.

Failure to appear at this meeting may result in the denial of your license. Individual applicants must appear only in person or by an attorney. Corporate or Limited Liability applicants must appear only by the agent designated on the application or by an attorney. Partnership applicants must appear by a partner listed on the application or by an attorney. If you wish to do so and at your own expense, you may be accompanied by an attorney of your choosing to represent you at this hearing.

You will be given an opportunity to speak on behalf of the application and to respond and challenge any charges or reasons given for the denial. No petitions can be accepted by the committee, unless the people who signed the petition are present at the committee hearing and willing to testify. You may present witnesses under oath and you may also confront and cross-examine opposing witnesses under oath. If you have difficulty with the English language, you should bring an interpreter with you, at your expense, so that you can answer questions and participate in your hearing.

You may examine the application file at this office during regular business hours prior to the hearing date. Inquiries regarding this matter may be directed to the person whose signature appears below.

Limited parking for persons attending meetings during normal business hours is available at reduced rates (5 hour limit) at the Milwaukee Center on the southwest corner of Kilbourn Avenue and Water Street. You must present a copy of the meeting notice to the parking cashier.

PLEASE NOTE: Upon reasonable notice, efforts will be made to accommodate the needs of disabled individuals through sign language interpreters or other auxiliary aids. For additional information or to request this service, contact the Council Services Division ADA Coordinator at (414) 286-2998, Fax - (414) 286-3456, TDD - (414) 286-2025.

JIM OWCZARSKI, CITY CLERK

BY: _____

Jim Cooney
License Division Manager

If you have questions regarding this notice, please contact the License Division at (414) 286-2238.

200 E. Wells Street, Room 105, City Hall, Milwaukee, WI 53202. www.milwaukee.gov/license
Phone: (414) 286-2238 Fax: (414) 286-3057 Email Address: License@milwaukee.gov



**CITY OF MILWAUKEE
OFFICE OF THE CITY CLERK**

Thursday, July 24, 2025

COMMITTEE MEETING NOTICE

AD 14

MARTIN, Jennifer J, Agent
PIGGLY WIGGLY MIDWEST, LLC
2929A S 15TH ST
Milwaukee, WI 53215

You are requested to attend a hearing which is to be held in the Council Chambers, Third Floor, City Hall:

Thursday, July 31, 2025 at 08:45 AM

Regarding: Your Class A Malt & Class A Liquor, Food Dealer and Weights & Measures Licenses Application as agent for "PIGGLY WIGGLY MIDWEST, LLC" for "PIGGLY WIGGLY SUPERMARKET #7" at 123 W OKLAHOMA Av.

There is a possibility that your application may be denied for one or more of the following reasons: The recommendation of the committee regarding the application shall be based on evidence presented at the hearing. Per MCO 85-2.7-4, probative evidence concerning whether or not a new license should be granted may be presented on the following subjects: whether or not the applicant meets the municipal requirements, the appropriateness of the location and premises where the licensed premises is to be located and whether use of the premises for the purposes or activities permitted by the license would tend to facilitate a public or private nuisance or create undesirable neighborhood problems such as disorderly patrons, unreasonably loud noise, litter, and excessive traffic and parking congestion. Probative evidence relating to these matters may be taken from the plan of operation submitted with the license application, if any, but shall not include the content of any music. Evidence regarding the fitness of the location of the premises to be maintained as the principal place of business, including but not limited to whether there is an overconcentration of businesses of the type for which the license is sought; whether the proposal is consistent with any pertinent neighborhood business or development plans, or the location's proximity to areas where children are typically present. The applicant's record in operating similarly licensed premises; and whether or not the applicant has been charged with or convicted of any felony, misdemeanor, municipal offense or other offense, the circumstances of which substantially relate to the activity to be permitted by the license being applied for or any other factor which reasonably relates to the public health, safety or welfare may also be considered. See attached police report or correspondence.

**Notice for applicants with
warrants or unpaid fines:**

Proof of warrant satisfaction or payment of fines must be submitted at the hearing on the above date and time. Failure to comply with this requirement may result in a delay of the granting/denial of your application.

Failure to appear at this meeting may result in the denial of your license. Individual applicants must appear only in person or by an attorney. Corporate or Limited Liability applicants must appear only by the agent designated on the application or by an attorney. Partnership applicants must appear by a partner listed on the application or by an attorney. If you wish to do so and at your own expense, you may be accompanied by an attorney of your choosing to represent you at this hearing.

You will be given an opportunity to speak on behalf of the application and to respond and challenge any charges or reasons given for the denial. No petitions can be accepted by the committee, unless the people who signed the petition are present at the committee hearing and willing to testify. You may present witnesses under oath and you may also confront and cross-examine opposing witnesses under oath. If you have difficulty with the English language, you should bring an interpreter with you, at your expense, so that you can answer questions and participate in your hearing.

You may examine the application file at this office during regular business hours prior to the hearing date. Inquiries regarding this matter may be directed to the person whose signature appears below.

Limited parking for persons attending meetings during normal business hours is available at reduced rates (5 hour limit) at the Milwaukee Center on the southwest corner of Kilbourn Avenue and Water Street. You must present a copy of the meeting notice to the parking cashier.

PLEASE NOTE: Upon reasonable notice, efforts will be made to accommodate the needs of disabled individuals through sign language interpreters or other auxiliary aids. For additional information or to request this service, contact the Council Services Division ADA Coordinator at (414) 286-2998, Fax - (414) 286-3456, TDD - (414) 286-2025.

JIM OWCZARSKI, CITY CLERK

BY: _____

Jim Cooney
License Division Manager

If you have questions regarding this notice, please contact the License Division at (414) 286-2238.

200 E. Wells Street, Room 105, City Hall, Milwaukee, WI 53202. www.milwaukee.gov/license
Phone: (414) 286-2238 Fax: (414) 286-3057 Email Address: License@milwaukee.gov

MILWAUKEE POLICE DEPARTMENT

LICENSING

CRIMINAL RECORD/ORDINANCE VIOLATION/INCIDENTS SYNOPSIS

DATE: 07/07/25
LICENSE TYPE: AMALT
NEW: ☐
RENEWAL: ☒

No. 383053
Application Date:

License Location: 123 W Oklahoma
Business Name: Piggly Wiggly

Licensee/Applicant: Martin, Jennifer J
(Last Name, First Name, MI)

Date of Birth: 07/30/72

Home Address: 2929 S. 15th St
City: Milwaukee
Home Phone:

State: WI Zip Code: 53215

This report is written by Police Officer Penny Monreal, assigned to the License Investigation Unit, Days.

The Milwaukee Police Department's investigation regarding this application revealed the following:

1. On 04/14/23, Milwaukee Police were dispatched to a Hold Up Alarm at 123 W. Oklahoma. It was determined the alarm was pushed by accident.
2. On 05/05/23 at 8:12a.m., Milwaukee Police were dispatched to a Threat at 123 W. Oklahoma Av. The officers spoke to the manager who called regarding a subject that was attempting to steal and refusing to leave the premise. The officers escorted the subject out of the store and the caller was given information regarding a restraining order.
3. On 05/31/23 at 8:09p.m., Milwaukee Police were dispatched to a Trouble with Subject at 123 W. Oklahoma Av. Investigation revealed a subject was living out of a truck in the parking lot and refusing to leave. The subject and vehicle were gone on police arrival.
4. On 06/28/23 at 8:14a.m., Milwaukee Police were dispatched to a Trouble with Subject at 123 W. Oklahoma Av. The manager stated a subject was in front of the premise refusing to leave, however, left prior to police arrival. The manager was cooperative with the officer.

- =====
5. On 01/12/25 at 5:29p.m., Milwaukee Police were dispatched to a Theft. Investigation revealed this was not a theft, but a trouble with juveniles, who were gone on police arrival. The business was cooperative.

6. On 01/27/25 at 9:31p.m., Milwaukee Police were dispatched to a Trouble with Subject. On arrival the business was closed.
7. On 03/10/25 at 12:15p.m., Milwaukee Police were dispatched to a Theft. Investigation revealed a suspect took a customer's purse out of the shopping cart, while they were loading groceries. The business was cooperative with the investigation and allowed officers to view video surveillance of the incident.
8. On 03/15/25 at 9:31p.m., Milwaukee Police were dispatched to a Trouble with Subject. On arrival the officers found the store to be closed and the caller was advised to call back tomorrow if they wanted to file a report.
9. On 03/31/25 at 6:08p.m., Milwaukee Police were dispatched to a Battery. Investigation revealed a customer was being escorted out of the store for causing a disturbance, when they elbowed an employee twice in the face, causing injury to their lip. The business was cooperative with the investigation and allowed officers to view video surveillance of the incident.

=====

Items 5-9 added as Previous Premise

Date: 07/11/2025
Officer: PO Fabian Garcia

City of Milwaukee Police Department
90-5-1.5 Crime Prevention Survey
Convenience Store/Liquor Store Inspection

Name of Premise: Piggly Wiggly
Address: 123 W Oklahoma Ave.
Phone:

Owner: Piggly Wiggly Midwest LLC
Owner address:
City State Zip:
Owner Phone:
Owner email:

Manager: Jennifer J. Martin
Home Address: 2929A S 15th St.
City State Zip: 53215
Phone: 4148080072
Email: Jennyandharrison@gmail.com

Preferred contact: Email

Location currently open: ☒ YES ☐ NO

Projected open date:

Day's open: ☐S ☐M ☐T ☐W ☐Th ☐F ☐SA ☒ALL

Hours of Operation: Sun: 7am-9pm ☐24 hours ☐Y ☒N
Mon: 7am-9pm
Tue: 7am-9pm
Wed: 7am-9pm
Thu: 7am-9pm
Fri: 7am-9pm
Sat: 7am-9pm

Premise Type: ☐Liquor Store
☒Convenience Store
☐Other:

Licenses currently held:
Alcohol: ☒Yes ☐No #: ALQML-0200790

Tobacco: ☒ Yes ☐ No #: CIG-1033134
 Food: ☒ Yes ☐ No #: 0015472
 Extended Hours: ☐ Yes ☐ No #:
 Secondhand Dealer: ☐ Yes ☐ No Type: #:
 Other: ☒ Yes ☐ No Type: W&M-0009042
 Other: ☐ Yes ☐ No Type: #:

Who is your alcohol distributor?

- Beer Capitol

Exterior Survey:

1. Is the area around the location clean? ☒ Yes ☐ No
2. What surrounds the location? (Check all the apply)
 - a. ☐ Park
 - b. ☐ School
 - c. ☐ Youth Center
 - d. ☐ Church
 - e. ☐ Tavern(s) If so, how many
 - f. ☐ Residential
 - g. ☒ Other businesses
 - h. ☐ Other:
3. Can you see from the outside of the location into the interior ☒ Yes ☐ No
4. Can you see the employees inside of the location from the outside ☐ Yes ☒ No
5. Are exterior windows free of signage ☒ Yes ☐ No
6. Is there a parking lot ☒ Yes ☐ No
7. Is the parking lot clean? ☒ Yes ☐ No
8. Is the parking lot well lit? ☒ Yes ☐ No
9. Are there areas where a person could conceal themselves ☐ Yes ☒ No
10. Is there exterior lighting? ☒ Yes ☐ No. Does it appears to be adequate ☒ Yes ☐ No
11. Exterior Payphone? ☐ Yes ☒ No
12. Are there No Loitering Signs posted? ☒ Yes ☐ No
13. Are there exterior security cameras ☒ Yes ☐ No How Many: 6
14. Are the address numbers prominently displayed and easy to see ☐ Yes ☒ No

Camera Survey:

15. Does this location have security cameras? ☒ Yes ☐ No
16. Are they in working order? ☒ Yes ☐ No
17. What format are the cameras?
 - a. Color ☒ Yes ☐ No
 - b. Digital ☒ Yes ☐ No
 - c. VCR ☐ Yes ☐ No
 - d. Recorded ☒ Yes ☐ No
18. How long is footage stored for later viewing: 90 Days
19. Are there exterior cameras ☒ Yes ☐ No How many: 6
20. Are there interior cameras ☒ Yes ☐ No How many: 49
21. Do all employees know how to retrieve recorded digital images/footage? ☐ Yes ☒ No
- Managers and above

Interior Survey:

22. Is the storeowner willing to be a standing complainant regarding loitering? ☒ Yes ☐ No

- a. If yes have them fill out the standing complaint form and give them two of the commercial signs ☐ Yes ☐ No
23. Is the interior of the location neat and clean? ☒ Yes ☐ No
24. Does an interior camera face the entrance/exit? ☒ Yes ☐ No
25. Is there a lockable area that separates employees from customers? ☒ Yes ☐ No
26. Does the store sell single chore boy? ☐ Yes ☒ No
27. Does the store sell blunt wraps? ☐ Yes ☒ No
28. Does the store sell scales? ☐ Yes ☒ No
29. Does the store sell items that may be used as crack pipes? ☐ Yes ☒ No
- a. Describe item
30. Does the store have an over abundance of sandwich baggies: ☐ Yes ☒ No
31. Does the owner understand that these items are often used for drug use? ☒ Yes ☐ No
32. Do the products in the store appear to be new and rotated often? ☒ Yes ☐ No
33. Are emergency and non-emergency numbers posted near the phone? ☒ Yes ☐ No
34. Does the owner know how to contact their police district directly? ☒ Yes ☐ No
- a. Did you provide a district contact guide to the owner? ☒ Yes ☐ No

Complete this section if alcohol establishment is a convenience store:

(** Read full ordinance for all details "68-55 Convenience Food Stores")

All convenience food stores not exempted under sub. 3 shall:

1. Is the cash register located in a manner so that at the time of a sales transaction, the employee and customer are both visible from the sidewalk? ☐ Yes ☒ No **
2. Are the glass entrance and exit doors clear of any signs or advertisements with the exception of a sign which states that the cash register contains \$50 or less and that the safe is no accessible to employees? ☐ Yes ☒ No
3. Does the store maintain one of the following on the licensed premise:
 - a. A safe that was in use at the convenience food store on August 17, 1994? ☐ Yes ☐ No
 - b. A drop-safe or time release safe that weighs at least 500 pounds or which is attached to or set into the floor in a manner approved by the police department? ☒ Yes ☐ No
4. Is lighting provided for the store's parking area during all hours of darkness when employees or customers are on the premises at a minimum average of 2-foot candles per square foot, unless the store is not open for business after sunset and before sunrise? ☒ Yes ☐ No ☐ N/A
5. Are at least two high-resolution surveillance security cameras installed? ☒ Yes ☐ No
6. Are the security cameras in working order? ☒ Yes ☐ No
7. Does one camera show an overall view of the counter and register area? ☒ Yes ☐ No
8. Does one camera show a clear, identifiable, full frame image of the face of each person entering and leaving the store? ☒ Yes ☐ No
9. Are the camera views obstructed by fixtures or displays? ☐ Yes ☒ No
10. Is the recorded footage stored for at least 30 days? ☒ Yes ☐ No (Unknown)
11. Do all store employees know how to record footage from the camera system to media capable of being transferred to police custody? ☐ Yes ☒ No (Contact Manager)
12. Are customer entrances/exits made of glass or other transparent material? ☒ Yes ☐ No
 - a. Exception: A store that does not have such doors on August 17, 1994 shall not be required to install such doors until the holder of the store's food dealer license changes.
13. Has the owner and their employees attended the Robbery Prevention Training within 120 days of ownership or employment? ☐ Yes ☐ No
 - a. Contact Community Outreach and Education at 935-7836 for schedule.

Sub 3. Exemptions. The requirements of this section do not apply to a convenience food store that conforms to either of the following descriptions:

- a-1. The store is located in an enclosed shopping structure, enclosed commercial building or hospital. A convenience food store is not in an enclosed structure or building if a customer can enter it directly from the outside.
Does store conform to a-1 ☐ Yes ☒ No
- a-2 The store physically separates employees from customers with a solid partition that bars a person from entering the employee area from the customer area, has a secure lock on the employee side of any door between the employee area and the customer, and conducts all transaction through a service window or similar arrangement.
Does store conform to a-2 ☐ Yes ☒ No
- a. At the commissioner's discretion, a convenience store may be exempted from any or all of the regulations specified in sub 2.
Does this location hold an exemption from the commissioner regarding any of the requirements of Sub 2? ☐ Yes ☐ No

ADDITIONAL COMMENTS/RECOMMENDATIONS:

This report was written by Police Officer Fabian Garcia assigned to District 6-Days, Community Partnership Unit.

On Friday, July 11, 2025, at 11:00 am, my partner Police Officer Michael Ward and I met with the licensee/agent Jennifer J. Martin at 123 W. Oklahoma Avenue (Piggly Wiggly). The location is currently open, and the hours of operation are planned to be 7am-9pm Sunday-Saturday. Jennifer stated that she has been an employee for Piggly Wiggly for 17 years.

The location is a convenience store located on the south end of the parking lot that has multiple store also located within the lot. The location has two entry and exit points that has cameras facing both locations. The store is equipped with 6 exterior cameras and 49 interior cameras, which only managers have access too. The liquor isle is a single isle with only one entry and exit point that is equipped with two surveillance cameras, and is located near the front service counter.

The store is equipped with eight registers, 1 express lane, and a front service counter. Near the beer section, is equipped with three surveillance cameras and one surveillance camera located inside of the walk in cooler.



City of Concentration Map 123 W OKLAHOMA AVE

Area of Interest (AOI) Information

Area : 21,862,585.72 ft²

Jun 27 2025 15:33:17 Central Daylight Time

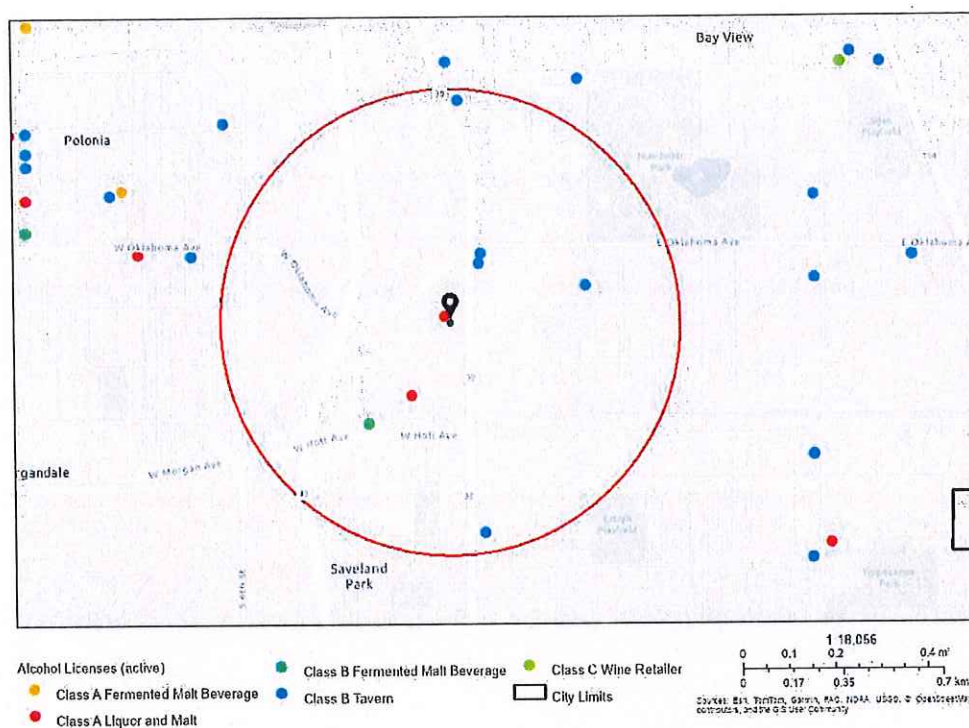

123 W OKLAHOMA AVE

Summary

Name	Count	Area(ft²)	Length(mi)
Alcohol Licenses	9		

Alcohol Licenses

#	Legal Entity	Trade Name	Licensee	Address	License Type Name	Total Capacity	Expiration Date	Count
1	Chase Entertainment LLC	Sam's Tap	Sam J Leaf, Agt	3118 S CHASE AV	Class B Tavern License	37	9/1/2025, 7:00 PM	1
2	Restaurante La Salsa, LLC	Restaurante La Salsa	Cristian Jimenez, Agt	117-119 E Oklahoma AV	Class B Tavern License	99	10/9/2025, 7:00 PM	1
3	SAL B, LLC	Piggly Wiggly Supermarket # 71	Jennifer J Martin, Agt	123 W Oklahoma AV	Class A Malt & Class A Liquor License		9/30/2025, 7:00 PM	1
4	MEGA MARTS LLC	PICK 'N SAVE #6878	Traci E Galicia, Agt	250 W HOLT AV	Class A Malt & Class A Liquor License		10/22/2025, 7:00 PM	1
5	Las 7 Estrellas LLC	Las 7 Estrellas	Javier Perez-Rivera, Agt	112 E Dakota ST	Class B Tavern License		12/10/2025, 6:00 PM	1
6	Dale and Carrie, LLC	Dale Z's	DALE J ZBIERANEK, JR, Agt	3585 S Howell AV	Class B Tavern License	79	12/16/2025, 6:00 PM	1
7	THE BUBBLER, LLC	THE BUBBLER	THERESA L BASHAW, Agt	3158 S Howell AV	Class B Tavern License	120	12/9/2025, 6:00 PM	1
8	HONG KONG SEAFOOD BUFFET LLC	Asian Buffet	Tingcai Zhou, Agt	270 W HOLT AV	Class C Wine Retailer's License		2/9/2026, 6:00 PM	1
9	HONG KONG SEAFOOD BUFFET LLC	Asian Buffet	Tingcai Zhou, Agt	270 W HOLT AV	Class B Fermented Malt Beverage Retailer's License		2/9/2026, 6:00 PM	1

Establishments within a 0.5 miles radius centered on area of interest.



Thursday, July 24, 2025



Notice of Public Hearing

Blank Notice

MARTIN, Jennifer J, Agent
PIGGLY WIGGLY SUPERMARKET #7 at 123 W OKLAHOMA Av
Class A Malt & Class A Liquor, Food Dealer and Weights & Measures Licenses Application

Thursday, July 31, 2025 at 8:45 AM

To whom it may concern:

The above application has been made by the above named applicant(s). This requires approval from the Licenses Committee and the Common Council of the City of Milwaukee. The hearing before the Licenses Committee will take place on 7/31/2025 at 8:45 AM in Room 301-B, Third Floor, City Hall. This is a public hearing. Those wishing to view the proceeding are able to do so via the City Channel – Channel 25 on Spectrum Cable – or on the Internet at <http://city.milwaukee.gov/citychannel>. Those wishing to provide oral testimony via internet are asked to contact the staff assistant, Yadira Melendez at (414) 286-2775 or stasst5@milwaukee.gov for necessary information. Please make such requests no later than one business day prior to the start of the meeting. You are not required to attend the hearing, but please see the information below if you would like to provide testimony. Once the Licenses Committee makes its recommendation, this recommendation is forwarded to the full Common Council for approval at its next regularly scheduled hearing.

Important details for those wishing to provide information for the Licenses Committee to consider when making its recommendation:

1. The license application is scheduled to be heard at the above time. Due to other hearings running longer than scheduled, you may have to wait some time to provide your testimony.
2. You must appear in person and testify as to matters that you have personally experienced or seen. (You cannot provide testimony for your neighbor, parent or anyone else; this is considered hearsay and cannot be considered by the committee.)
3. No letters or petitions can be accepted by the committee (unless the person who wrote the letter or the persons who signed the petition are present at the committee hearing and willing to testify).
4. Persons opposed to the license application are given the opportunity to testify first; supporters may testify after the opponents have finished.
5. When you are called to testify, you will be sworn in and asked to give your name, and address. (If your first and/or last names are uncommon please spell them.)
6. You may then provide testimony.
 - a. Include only information relating to the above license application.
 - b. Include only information you have personally witnessed or seen.
 - c. Provide concise and relevant information detailing how this business has affected or may affect the peaceful enjoyment of your neighborhood.
 - d. If by the time you have the opportunity to testify, the information you wish to share has already been provided to the committee, you may state that you agree with the previous testimony. Redundant or repetitive testimony will not assist the committee in making its recommendation.
7. After giving your testimony, the members of the Licenses Committee and the licensee may ask questions regarding the testimony you have given or other factors relating to the license application.
8. Business Competition is not a valid basis for denial or non-renewal of a license.
Please Note: If you have submitted an objection to the above application your objection cannot be considered by the committee unless you personally testify at the hearing.

OCCUPANT	MAIL ADDRESS	CITY STATE ZIP
CURRENT OCCUPANT	103 E OHIO AVE	MILWAUKEE, WI 53207-2756
CURRENT OCCUPANT	105 E OHIO AVE	MILWAUKEE, WI 53207-2756
CURRENT OCCUPANT	111 E OHIO AVE	MILWAUKEE, WI 53207-2756
CURRENT OCCUPANT	119 E OHIO AVE	MILWAUKEE, WI 53207-2756
CURRENT OCCUPANT	3130 S CHASE AVE	MILWAUKEE, WI 53207-2636
CURRENT OCCUPANT	3136 S CHASE AVE	MILWAUKEE, WI 53207-2636
CURRENT OCCUPANT	3142 S CHASE AVE	MILWAUKEE, WI 53207-2636
CURRENT OCCUPANT	3143 S BURRELL ST	MILWAUKEE, WI 53207-2607
CURRENT OCCUPANT	3148 S CHASE AVE	MILWAUKEE, WI 53207-2636
CURRENT OCCUPANT	3149 S BURRELL ST	MILWAUKEE, WI 53207-2607
CURRENT OCCUPANT	3154 S CHASE AVE	MILWAUKEE, WI 53207-2636
CURRENT OCCUPANT	3155 S BURRELL ST	MILWAUKEE, WI 53207-2607
CURRENT OCCUPANT	3161 S BURRELL ST	MILWAUKEE, WI 53207-2607
CURRENT OCCUPANT	3167 S BURRELL ST	MILWAUKEE, WI 53207-2607
CURRENT OCCUPANT	3173 S BURRELL ST	MILWAUKEE, WI 53207-2607
CURRENT OCCUPANT	3200 S CHASE AVE	MILWAUKEE, WI 53207-2637
CURRENT OCCUPANT	3201 S BURRELL ST	MILWAUKEE, WI 53207-2752
CURRENT OCCUPANT	3206 S CHASE AVE	MILWAUKEE, WI 53207-2637
CURRENT OCCUPANT	3207 S BURRELL ST	MILWAUKEE, WI 53207-2752
CURRENT OCCUPANT	3212 S CHASE AVE	MILWAUKEE, WI 53207-2637
CURRENT OCCUPANT	3213 S BURRELL ST	MILWAUKEE, WI 53207-2752
CURRENT OCCUPANT	3218 S CHASE AVE	MILWAUKEE, WI 53207-2637
CURRENT OCCUPANT	3219 S BURRELL ST	MILWAUKEE, WI 53207-2752
CURRENT OCCUPANT	3224 S CHASE AVE	MILWAUKEE, WI 53207-2637
CURRENT OCCUPANT	3225 S BURRELL ST	MILWAUKEE, WI 53207-2752
CURRENT OCCUPANT	3230 S CHASE AVE	MILWAUKEE, WI 53207-2637
CURRENT OCCUPANT	3231 S BURRELL ST	MILWAUKEE, WI 53207-2752
CURRENT OCCUPANT	3236 S CHASE AVE	MILWAUKEE, WI 53207-2637
CURRENT OCCUPANT	3237 S BURRELL ST	MILWAUKEE, WI 53207-2752
CURRENT OCCUPANT	3242 S CHASE AVE	MILWAUKEE, WI 53207-2637
CURRENT OCCUPANT	3243 S BURRELL ST	MILWAUKEE, WI 53207-2752
CURRENT OCCUPANT	3247 S BURRELL ST	MILWAUKEE, WI 53207-2752
CURRENT OCCUPANT	3248 S CHASE AVE	MILWAUKEE, WI 53207-2637
CURRENT OCCUPANT	3253 S BURRELL ST	MILWAUKEE, WI 53207-2752
CURRENT OCCUPANT	3254 S CHASE AVE	MILWAUKEE, WI 53207-2637
CURRENT OCCUPANT	3259 S BURRELL ST	MILWAUKEE, WI 53207-2752
CURRENT OCCUPANT	3260 S CHASE AVE	MILWAUKEE, WI 53207-2637
CURRENT OCCUPANT	3265 S BURRELL ST	MILWAUKEE, WI 53207-2752
CURRENT OCCUPANT	3266 S CHASE AVE	MILWAUKEE, WI 53207-2637
CURRENT OCCUPANT	3271 S BURRELL ST	MILWAUKEE, WI 53207-2752
CURRENT OCCUPANT	3272 S CHASE AVE	MILWAUKEE, WI 53207-2637
CURRENT OCCUPANT	3276 S CHASE AVE	MILWAUKEE, WI 53207-2637
CURRENT OCCUPANT	3276A S CHASE AVE	MILWAUKEE, WI 53207-2637
CURRENT OCCUPANT	3276B S CHASE AVE	MILWAUKEE, WI 53207-2637
CURRENT OCCUPANT	3277 S BURRELL ST	MILWAUKEE, WI 53207-2752

Blank Notice

Total Records: 45

Radius 250 feet and Center of the Circle: 123 W Oklahoma Av



BUSINESS LICENSE PLAN OF OPERATION

ccl-busplan 5/12/2020

Office of the City Clerk License Division
200 E. Wells St. Room 105, Milwaukee, WI 53202
(414) 286-2238 www.milwaukee.gov/license e-mail address: license@milwaukee.gov

1. Type of Business

Applying for: ☐ Extended Hours (12AM to 5AM) - If a food establishment, check all that apply: ☐ Delivery ☐ Drive Thru ☐ Dining Room
☐ Self Service Laundry ☐ Massage Establishment ☐ Filling Station
☐ Other (supplemental application for specific license also required)

Provide a detailed description of the type of business you plan on operating:

RETAIL GROCERY SUPERMARKET

Do you have any experience operating this type of business? ☐ No ☒ Yes If yes, explain: OWN/operate 12 other locations throughout WI

2. Business Operations

- a. Proposed Opening Date: 7-27-2025
- b. Is this premise under construction? ☒ No ☐ Yes If yes, list estimated completion date: _____
- c. Is this a franchise? ☒ No ☐ Yes
- d. Is this premises currently licensed? ☐ No ☒ Yes If yes, list type of license: Food/Liquor/Cigarette
- e. Is the current licensee operating? ☐ No ☒ Yes If no, list date closed: _____
- f. Do you have future plans for other businesses, licenses or permits at this location? ☒ No ☐ Yes
If yes, explain: _____
- g. Have you previously held an Extended Hours License in Milwaukee? ☒ No ☐ Yes
If yes, list address(es): _____
- h. Are other businesses operating in the same building? ☒ No ☐ Yes If yes, describe: _____

3. Litter & Noise

- a. How are grounds kept clean? ☒ Sweep ☐ Pressure Wash ☒ Pick Up Litter ☐ Other: _____
- b. How often will grounds be cleaned? ☒ Daily ☐ Weekly ☒ As Needed ☐ Monthly ☐ Other: _____
- c. Grounds cleaned by: ☐ Licensee ☐ Building Owner ☒ Employees ☐ Hired Maintenance ☐ Other: _____
- d. How are noise issues prevented and/or addressed? ☐ Security ☒ Manager approaches customer(s) ☐ Call Police
☐ Signs Posted ☐ Other: _____
- e. Will a sound amplification system be used? ☒ No ☐ Yes If yes, describe: _____

4. Smoking & Sanitation

- a. Are there designated outdoor smoking areas? ☒ No ☐ Yes If yes, describe: _____
- b. Number of Garbage Cans: Inside: 10+ Locations: throughout store
Outside: 2 Locations: one at each entrance
- c. Is a crowd control barrier used? ☒ No ☐ Yes If yes, describe: _____
- d. How many restrooms are on the premises? 2
- e. Name of solid waste contractor: ☐ Advanced Disposal ☒ Waste Management ☐ Other: _____

5. Security

- a. Are there onsite parking spaces? No ☒ Yes If yes, how many? 273 and describe the parking security plan: Lighting
- b. Is there a loading zone? No ☒ Yes If yes, describe the loading area security plan: Signs
- c. Will you have licensed security on premise? ☒ No ☐ Yes If yes, how many? 1 and answer the following:
What are their responsibilities? _____
Describe equipment used _____
List their License Number (s) _____
- d. Will there be security cameras? ☐ No ☒ Yes If yes, how many? 10+ and list locations: Strategically located throughout the store
- e. Will searches/identification checks be done upon entry? ☒ No ☐ Yes If yes, describe _____

6. Percentage of Sales (must total 100%)

Alcohol <u>7</u> %	Food <u>92</u> % Cigarettes, Electronic Vape Devices, Tobacco Products <u>>1</u> %	Secondhand Merchandise <u>0</u> %	Precious Metals & Gems <u>0</u> %
Entertainment <u>0</u> %	Salvaged Materials <u>0</u> % (such as scrap metal)	Personal Services (such as tattoo, body piercing, salon, tailor, tanning, etc.) <u>0</u> %	Other _____ % Describe: _____
Pawnbroker Activity <u>0</u> %			

7. Businesses/Licenses on the Premises (check all that apply):

Type 1

- ☐ Full Service Restaurant ☐ Cafe/Coffee Shop ☐ Deli or Fast Food Restaurant ☐ Private/Fraternal/Veterans Club
- ☐ Night Club ☐ Tavern ☐ Cocktail Lounge ☐ Teen Club
- ☐ Banquet Hall ☐ Sports Facility ☐ Bowling Alley
- ☐ Hotel/Motel: Number of Floors: _____ Number of Rooms: _____
☐ Rooming House: Number of Floors: _____ Number of Rooms: _____

Type 2

- ☐ Liquor Store ☐ Corner Store ☒ Supermarket ☐ Convenience Store
- ☐ Gas Station ☐ Amusement/Phonograph Distributor ☐ Recycling, Salvage or Towing
- ☐ Used Car Dealer ☐ Personal Service Establishment (such as tattoo business, hair salon, tailor, etc.) ☐ Recording Studio

What other licenses/permits will you hold at this location? (check all that apply)

- ☒ Occupancy Permit ☒ Cigarette, Tobacco, Electronic Vape Products ☐ Gas Station ☐ Extended Hours ☐ Class "B" Tavern ☒ Weights & Measures
- ☐ Secondhand Dealer ☐ Precious Metal & Gem ☐ Other: _____

8. Legal Capacity (only if a Type 1 premises in #7 above)

Capacity N/A (Call the Milwaukee Development Center at 414-286-8211 if you have questions.)

9. Premises Description

a. Identify all area(s) of the premises that will be used in operating this business (include areas used only for storage):

☒ 1st Floor ☐ 2nd Floor ☐ Basement Storage ☐ Patio ☐ Beer Garden ☐ Sidewalk Café ☐ Deck ☐ Rooftop

☐ Other: Describe: _____

b. Describe Location: ☒ Major Thoroughfare ☐ Secondary Street ☐ Other: _____

c. Nearest Major Cross Street: W Oklahoma Ave & S Chase Ave

d. Describe Building: ☐ Free Standing Building ☒ Strip Mall ☐ Other: _____

e. Describe Premises Structure: ☒ Single Story ☐ Multi-Story - # of Stories _____ ☐ Other: _____

f. Describe Surrounding Area: ☐ Commercial ☐ Residential ☐ Industrial ☒ Other: Mix - Commercial & residential

g. Building Owner Name: PJR Properties LLC Phone Number: 630-335-0097

Building Owner Address: 1153 S LEE ST, STE 109, DES PLAINES, IL 60016

10. Hours of Operation & Customers

Will customers be entering the premises? ☐ No ☒ Yes

Day of the Week	Proposed Hours of Operation:		Estimated Number of Customers expected each day	Potential Age Range of Customers	Class B Tavern Applicant Only: Age Restriction (If none, write 'None')
	Open Time (include a.m. or p.m.)	Close Time (include a.m. or p.m.)			
Sunday	7:00 A	9:00 P	800	all ages	
Monday	7:00 A	9:00 P	800	all ages	
Tuesday	7:00 A	9:00 P	800	all ages	
Wednesday	7:00 A	9:00 P	800	all ages	
Thursday	7:00 A	9:00 P	800	all ages	
Friday	7:00 A	9:00 P	800	all ages	
Saturday	7:00 A	9:00 P	800	all ages	

An Extended Hours Establishment License is required for any convenience store, filling station, personal service establishment (such as tattoo, body piercing, salon, tailor, tanning, etc.), recording studio or restaurant which is open between the hours of 12:00 a.m. and 5:00 a.m.

Alcohol Establishments Class A: 8:00 am to 9:00 pm Sunday thru Saturday
Permitted Hours of Operation: Class B: 6:00 am to 2:00 am Sunday thru Thursday, 6:00 am to 2:30 am Friday & Saturday

Entertainment Outdoor Closing Hours: 10:00pm Sunday-Thursday; 12:00am Friday & Saturday; unless a different time, either earlier or later, is established by the Common Council in its approval of the licensee's plan of operation.

11. Signature(s)

Signature of Sole Proprietor, Partner, or 20% or more Shareholder

(If there are no 20% or more shareholders,
Corporate Officer-print name/title and sign)

Signature of additional partner or 20% or more shareholder

See Application Information for a complete list of all required application forms.



ALCOHOL BEVERAGE & PUBLIC ENTERTAINMENT PREMISES SUPPLEMENTAL APPLICATION

Office of the City Clerk License Division
200 E. Wells St. Room 105, Milwaukee, WI 53202
(414) 286-2238 e-mail address: license@milwaukee.gov www.milwaukee.gov/license

Legal Entity Name: Piggly Wiggly Midwest LLC

Premise Address: 123 W Oklahoma Ave Milwaukee WI 53207

Proximity of Premises to Church, School, Daycare Center or Hospital

Is the building within 300 feet of any church, school, daycare center or hospital? ☒ No ☐ Yes

"Service Bar Only" Designation

If applying for Class B or C license, are you applying for "Service Bar Only"? ☐ No ☐ Yes

Service Bar Only means customers cannot sit at the bar. Alcohol is served to employees who serve patrons seated at tables. No stools, chairs or other articles of furniture shall be placed at the service bar for patrons to sit upon.

N/A

Business Information

a) Are you taking out this application for anyone that may not be eligible for a license? ☒ No ☐ Yes

If yes, list their name and address: _____

b) Will the agent, a partner or the individual licensee be conducting the day-to-day operations of the business? ☐ No ☒ Yes

If no, list the name and address of the person(s) who will: _____

Class B Applicants: If the agent, a partner or the individual licensee will not be conducting the day-to-day operations of the business, the person(s) listed above must obtain a Class B Managers license.

c) Does anyone else have money invested or any other interest in this business? ☒ No ☐ Yes

If yes, explain: _____

d) Have you made an agreement with anyone to repay any loan or any other payments based upon income from the business?

☒ No ☐ Yes If yes, list name and address: _____

Property Information (New & Transfer Applicants Only)

a) Do you own or lease the building? ☐ Own ☒ Lease

b) Who owns the fixtures (for example, coolers, etc.)?

Piggly Wiggly Midwest LLC

c) Are you purchasing the stock and/or fixtures?

☐ No ☒ Yes If yes, amount paid \$ 800,000

d) Total amount paid for business

\$ 800,000

e) Total amount paid for goodwill of the business

\$ _____

Goodwill comprises the reputation and customer relationships of an existing business. If the price you pay for the business exceeds the fair market value of all of the rest of the assets of the business, the excess may be considered goodwill.

f) Have you made arrangements with the seller for payment of personal property taxes? ☒ No ☐ Yes

Lease Information (New & Transfer Applicants who are leasing the premises only)

a) Date lease begins Aug 15, 2011 Ends Sept 30, 2011

b) Monthly rental \$ 20,918.75

c) Do you have an option to renew the lease? ☐ No ☒ Yes

d) Does your lease allow for assignment to another party without the consent of the owner? ☒ No ☐ Yes

e) For what length of time have you been guaranteed occupancy (number of years)? 15 yrs

Lease Information (Continued)

- f) In addition to paying the monthly rental, will you have to pay anything additional to the owner of the building to guarantee performance of the lease? ☒ No ☐ Yes If yes, explain _____
- g) Does the present owner or occupant object to the granting of your license? ☒ No ☐ Yes
If yes, explain _____

Change of Agent Applicants Only

Have there been any changes to the floor plan since the last application was submitted? ☒ No ☐ Yes
If no, a new floor plan is not required. If yes, submit a new floor plan and explain the change(s):

Signature



Michael Isken, Sr Dir Finance

Signature of Sole Proprietor, Partner or 20% or More Shareholder

(If no 20% or more Shareholder, Corporate Officer - print name/title and sign)



Note: All information contained in this application is subject to approval by the Common Council.
Deviating from approved plan of operation will subject licensee to citations, and/or suspension or non-renewal of the license.
Contact the License Division for information on how to request changes.

New and transfer of premises applicants must submit the following:

- ☐ Detailed floor plan
- ☐ If a restaurant, copy of the menu

**FOOD DEALER LICENSE PLAN OF OPERATION**

OFFICE OF THE CITY CLERK, LICENSE DIVISION
CITY HALL, 200 E. WELLS ST, ROOM 105, MILWAUKEE, WI 53202
(414) 286-2238 • license@milwaukee.gov • www.milwaukee.gov/license

Legal Entity Name: PIGGLY WIGGLY MIDWEST LLC dba Piggy Wiggly Supermarket #7
Premises Address: 123 W OKLAHOMA AVE

SECTION 1 TYPE OF BUSINESS

What will be the majority of your food sales? (check one)

☐ Restaurant Items (meals):

MEALS include, but are not limited to, chicken, ribs, sandwiches, roasted corn, baked potatoes, hot dogs, brats, tacos, nachos w/ cheese and meat, French fries, cooked or deep fried vegetables/fruit, cooked cheese curds, corn dogs, egg rolls, salads.

☒ Retail Items (snacks and beverages):

RETAIL items include, but are not limited to, ice cream/soft serve, lemonade, snow cones, coffee, espresso, cappuccino, tea, fruit juice, smoothies, candy, dispensed soda, fruit cups, bakery, cookies, kettle corn, cotton candy, funnel cakes, fritters, tortilla chips w/ cheese.

Will it be a convenience store? ☐ Yes ☒ No

A convenience store contains less than 7,500 square feet of retail space and has, as its primary business, the sale of basic food items and in addition, sells household products or is a filling station that sells basic food items and household products.

☐ Bed & Breakfast

☐ Micro Market

All Applicants: Submit a menu or a list of food items that will be sold.

Will any wholesale business be done? ☒ No ☐ Yes If yes, what percentage of food sales will be wholesale?

☐ Less than 25%

☐ 25% or More AND:

☐ Restaurant items (meals) will be sold – Complete this application and also contact DATCP.

☐ NO restaurant items (meals) will be sold - Do NOT complete this application. Contact DATCP only.

SECTION 2 FOOD PROCESSING

Will any food processing be done? ☐ No ☒ Yes

Processing is defined as assembling, grinding, cutting, mixing, baking, coating, stuffing, packing, bottling, grilling, canning, extracting, fermenting, distilling, pickling, freezing, drying, smoking, or packaging.

SECTION 3 FOOD REQUIRING TEMPERATURE CONTROL

Will any food that requires temperature control be sold? ☐ No ☒ Yes
(Includes dairy products such as milk, cheese, and ice cream, fish, shellfish, meat, poultry)

If yes, list the types of food items: _____

SECTION 4 DETAILS OF OPERATION

- Will you have seating on site for dining? ☒ No ☐ Yes
- Will you be doing any catering? ☒ No ☐ Yes
- Will you be doing any delivery? ☒ No ☐ Yes
- Will you have outdoor activities? ☒ No ☐ Yes - Check all that apply: ☐ Bar ☐ Cooking/Grilling ☐ Dining
- Will you have a drive thru window? ☒ No ☐ Yes - Are hours different from inside? ☐ No ☐ Yes
- If Yes, provide drive thru hours: _____
- Will scales or barcode scanners be used? ☐ No ☒ Yes - You must also apply for a Weights & Measures License.

SECTION 5 ADDITIONAL SITES

Where will food be prepared and/or sold?

- ☒ At a single site ☐ At multiple sites: How many? _____ (for example, a hotel with several dining rooms or bars)

If multiple sites, attach a Food Dealer Additional Site Addendum (ccl-foodadd) for each additional site.

SECTION 6 CONSTRUCTION OR CHANGES

Are you planning any construction, remodeling or equipment changes?

- ☒ No If No, SKIP to Section 7
- ☐ Yes If Yes, check all that apply: ☐ New construction of a building ☐ Renovation or remodeling
- ☐ Construction changes to existing building ☐ Equipment changes only

Provide a brief description of the changes: _____

Start date: _____

Name, Address & Phone Number of Architect: _____

Name, Address & Phone Number of Contractor: _____

SECTION 7 ALCOHOL BEVERAGES

Are you applying for an alcohol beverage license?

- ☐ No If No, SKIP to Section 8
- ☒ Yes If YES, if your food license is approved prior to the alcohol license, when do you want the food license issued?
- ☐ Immediately ☒ At the same time as the alcohol license

SECTION 8 ACKNOWLEDGEMENTS & SIGNATURE

You must initial each item confirming your understanding:



I understand the Health Department must conduct an inspection and advise the License Division of their approval before the license may be issued.



I understand I must obtain an occupancy permit from the Department of Neighborhood Services and an inspection may be required. Neighborhood Services must advise the License Division of their approval before the license may be issued.



I understand the district alderperson will review and either support or object to my application. If he/she objects, I may appeal and be scheduled to appear before the Licenses Committee. The Licenses Committee will then make a recommendation to the Common Council. The Common Council must grant the license before it may be issued.



I understand proof of payment for all license fees must be on file in the License Division before the license may be issued and the license must be issued and posted in my establishment prior to opening for business.

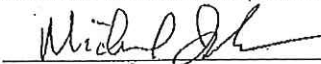

I will not operate my food business until the license has been issued and posted in the establishment.

Signature of Sole Proprietor, Partner, or 20% Shareholder:  Michael IskenSignature of Additional Partner:  Sr Dir France



WEIGHTS & MEASURES LICENSE SUPPLEMENTAL APPLICATION

OFFICE OF THE CITY CLERK, LICENSE DIVISION
CITY HALL, 200 E. WELLS ST, ROOM 105, MILWAUKEE, WI 53202
(414) 286-2238 • license@milwaukee.gov • www.milwaukee.gov/license

Office Use Only: **WEM**
App# 385050
Filed 6/27/2015
Initials (CN)
Paid _____
Lic # _____

Legal Entity Name: Piggly Wiggly Midwest LLC
Premise Address: 123 W Oklahoma Ave Milw, WI 53207

Device Type(s)

- Check all device types for which you need a license.
 - For each device type checked, indicate how many you have in the Number of Devices column (b).
 - Calculate the Total Fee Per Device Type by multiplying the Fee Per Device Type (a) by the Number of Devices (b).
 - Add all Total Fee Per Device Type amounts together and that will be your Total Fee Due.
- * **Exception:** The Scanner fee is not per device. Check the box for the appropriate range.
If you have 1-3 scanners, the total due is \$130. If you have 4 or more scanners, the total due is \$250.
Check the Number of Devices (b).

Device Type	License Period	Fee Per Device Type (a)	Number of Devices (b)	Total Fee Per Device Type (a x b)
Liquid Measuring Devices				
<input type="checkbox"/> Retail Petroleum Meters	12 months	\$60		
<input type="checkbox"/> 0 to 30 gallons per minute	24 months	\$60		
<input type="checkbox"/> 31 to 200 gallons per minute	24 months	\$250		
<input type="checkbox"/> Over 200 gallons per minute	24 months	\$250		
Scales				
<input checked="" type="checkbox"/> Measuring any weight amount	24 months	\$55	<u>21</u>	<u>\$1,155</u>
Scanners				
		Fee for scanners is by range	Check how many scanners you have	
<input type="checkbox"/> Up to 3 scanners	24 months	\$130 total*	<input type="checkbox"/> 1 <input type="checkbox"/> 2 <input type="checkbox"/> 3	
<input checked="" type="checkbox"/> Four or more scanners	24 months	\$250 total*	<input checked="" type="checkbox"/> 4 <input type="checkbox"/> Other	<u>250</u>
Other Devices				
<input type="checkbox"/> Length Measuring Device	24 months	\$60		
<input type="checkbox"/> Timing Device	24 months	\$30		

Total Fee Due 1405

Signature

I hereby agree that I will comply with the applicable sections of the Wisconsin State Statutes, Administrative Code and the Milwaukee Code of Ordinances regarding the operation of weighing and measuring devices.

I understand that all devices must be operated within the specifications, tolerances and other technical requirements set forth in the National Institute of Standards and Technology Handbook 44. I understand that the license for which I am applying must be posted on the premises or in my vehicle prior to opening for business or operating the device.

I understand that these device licenses are not transferable (with the exception of scanners). If the device is replaced or needs to be resealed, I must apply for and receive a new license so that an inspection of the device can be performed prior to its use. I acknowledge that as a condition of being issued this license, I must allow the Health Department into the establishment to test the device to validate its specifications/tolerances. If my devices are found out of compliance, I may be charged inspection fees. I have read, understand, and will adhere to all the above acknowledgments.

Jeff Martin
Signature of Sole Proprietor, Partner, or 20% or more Shareholder
(If there are no 20% or more shareholders, Corporate Officer-print name/title and sign)

Signature of additional partner or 20% or more shareholder

This form must be submitted with the Business License Application, Weights & Measures Plan of Operation, and appropriate fee. Forms can be obtained online at www.milwaukee.gov/licenses.



WEIGHTS & MEASURES PLAN OF OPERATION

ccl-wmplan 1/9/18

Office of the City Clerk License Division
200 E. Wells St. Room 105, Milwaukee, WI 53202
(414) 286-2238 www.milwaukee.gov/license license@milwaukee.gov

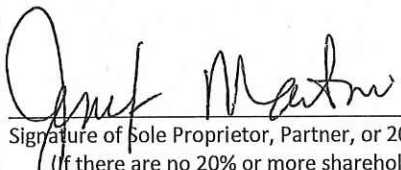
Legal Entity Name:	<u>Piggly Wiggly Midwest LLC</u>
Premise Address:	<u>63 W. Oklahoma Ave, Milw, WI 53207</u>
Type of Business	
Provide a brief description of the establishment/business:	
Other licenses may be required depending on the type of business you are operating.	
Litter & Noise	
a. How are grounds kept clean? <input checked="" type="checkbox"/> Sweep <input type="checkbox"/> Pressure Wash <input checked="" type="checkbox"/> Pick Up Litter <input type="checkbox"/> Other: _____	
b. How often will grounds be cleaned? <input checked="" type="checkbox"/> Daily <input type="checkbox"/> Weekly <input type="checkbox"/> As Needed <input type="checkbox"/> Monthly <input type="checkbox"/> Other: _____	
c. Grounds cleaned by: <input checked="" type="checkbox"/> Licensee <input type="checkbox"/> Building Owner <input checked="" type="checkbox"/> Employees <input type="checkbox"/> Hired Maintenance <input type="checkbox"/> Other: _____	
d. How are noise issues prevented and/or addressed? <input type="checkbox"/> Security <input checked="" type="checkbox"/> Manager approaches customer(s) <input checked="" type="checkbox"/> Call Police <input type="checkbox"/> Signs Posted <input type="checkbox"/> Other: _____	
Signature	
 Signature of Sole Proprietor, Partner, or 20% or more Shareholder (If there are no 20% or more shareholders, Corporate Officer-print name/title and sign)	_____ Signature of additional partner or 20% or more shareholder
This form must be submitted with the Business License Application, Weights & Measures License Supplemental Application, and appropriate fee. Forms can be obtained online at www.milwaukee.gov/licenses .	

A hand-drawn diagram of a Z-shaped curve. It consists of three horizontal segments connected by two diagonal segments. Arrows are drawn on each segment to indicate the direction of travel: the top segment points right, the first diagonal segment points down and right, the middle segment points left, the second diagonal segment points down and left, and the bottom segment points right.

SHEET NAME: FP-E

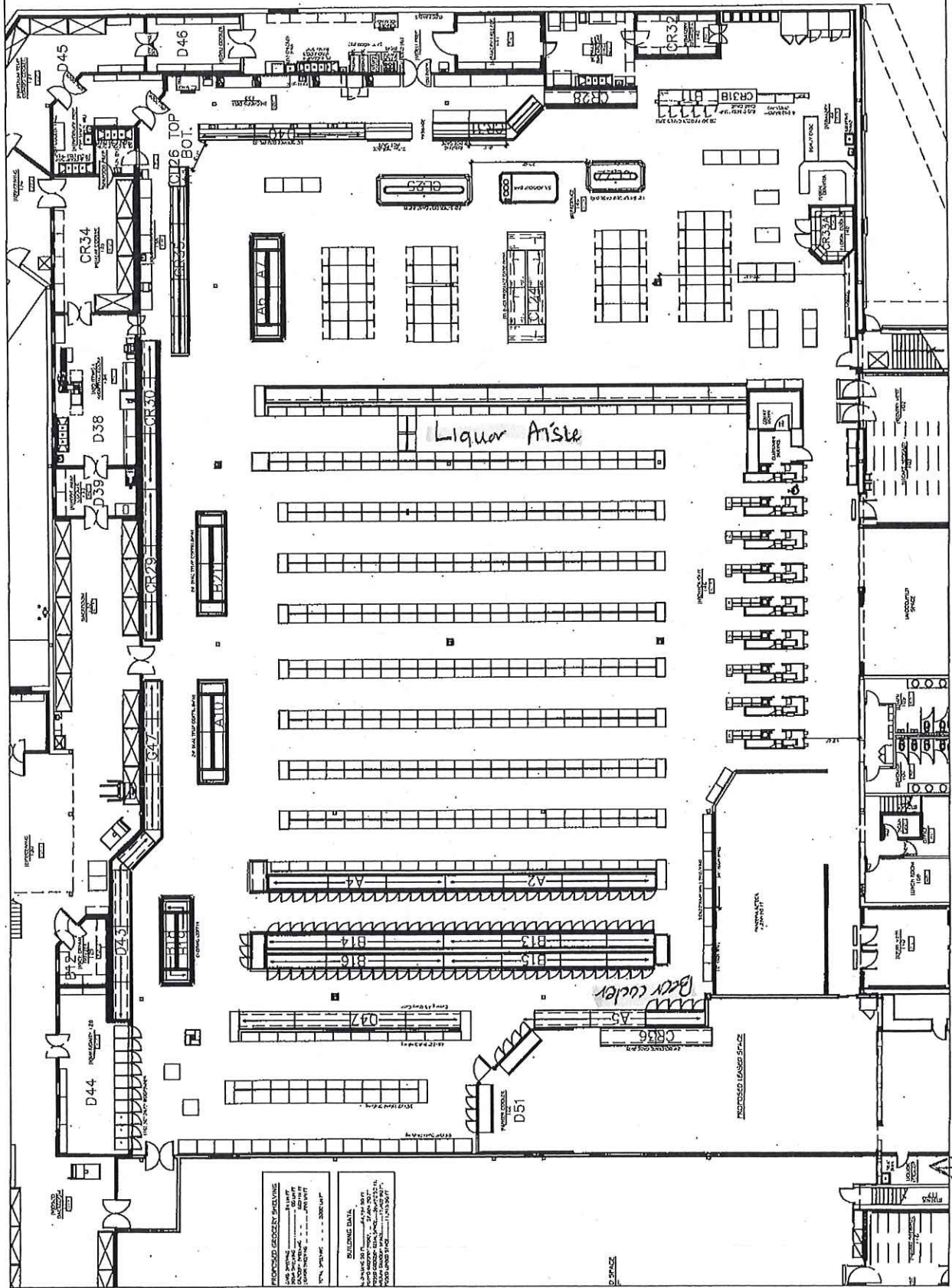

Liquor
State of
Legal Entity: Piggly Wiggly Midwest LLC
Trade Name: Piggly Wiggly Supermarket #7
Agent: Jennifer Martik

Jennifer
Martin

6/27/2025

Over view

4000 ft

600 ft

400 ft

Beer
area

Liquor
area

183'-3"

313'-4"

North

S. CHASE AVE.



total sq:
64700

Legal Entity: Piggly Wiggly Midwest LLC
Trad Name: Piggly Wiggly Supermarket #7
Agent: Jennifer Martin