



DEER DISTRICT LLC

1543 N. 2nd Street | 6th Floor | Milwaukee, WI 53212 | 414.227.0500



DEER DISTRICT FISERV FORUM DEVELOPMENT

Final Report

Table of Contents

3	Letter from MKE Bucks President
4 - 6	Executive Summary
7 - 8	Project Partners
9	Deer District Inclusion Requirements
10 - 15	Professional Services Inclusion
16 - 28	Construction Services Inclusion
29 - 63	RPP Inclusion
64	RPP By Aldermanic Districts
65 - 83	Overall Project Outreach & Business Profile Highlights

Prepared by
Prism Technical Management & Marketing Services, LLC
in conjunction with Cross Management Services, Inc.

Cover Photo: Crowds gathering outside Fiserv Forum for the 2019 NBA playoffs.

MILWAUKEE BUCKS



Letter from MKE Bucks President: Peter Feigin

The building of the Fiserv Forum and the Deer District is a realization of the commitment Sen. Herb Kohl and our owners made three years ago to Bucks fans and the entire community to keep the team in Wisconsin and help revitalize downtown Milwaukee. We are incredibly thankful for all the hard work that went into this historic public-private partnership from the Wisconsin Center District, elected officials and community leaders.

The Fiserv Forum is the heart of entertainment, community engagement, and neighborhood revitalization. This is not just about Milwaukee Bucks basketball. It is about seizing an opportunity to evolve and create access to world class sports, music and family-centric entertainment that ignites progression in downtown Milwaukee, the community at large, and Wisconsin as a whole.



Deer District : Executive Summary

Deer District LLC, along with Developer’s Representative, ICON Venue Group (“CAA ICON”), and Inclusion Monitors, Cross Management Services, Inc. (“CMSI”) and Prism Technical Management & Marketing Services, LLC (“Prism Technical” or “Prism”), are dedicated to ensuring the projects are successful and meet or exceed the goals described herein.

The Projects paid SBE firms \$5,626,103 or 21.3% of professional services cost subject to inclusion and \$98,747,108 or 36.8% of the construction cost subject to inclusion and Milwaukee RPP Workers have performed 42.0% of the construction hours.

This report provides information on the inclusion achieved for professional services, construction, and Residents Preference Program on the Fiserv Forum, 5th Street Parking Structure, and Public Plaza (“the Projects”).

The Inclusion Requirements were established in the Human Resources (“HR”) Agreement with the City of Milwaukee. The HR Agreement applies to the Projects and requires 18% Small Business Enterprise (“SBE”)¹ professional services inclusion, 25% SBE construction inclusion, 40% City of Milwaukee Residents Preference Program (“RPP”) inclusion, and payment of City of Milwaukee prescribed living wages.²

Bucks fans gathered in plaza for Giannis MVP celebration.



¹ SBE includes Small Business Enterprises (“SBE”) certified by the City of Milwaukee, Disadvantaged Business Enterprises (“DBE”) certified by a member of the Wisconsin Unified Certification Program, a Small Disadvantaged Business (“SDB”) as designated by the Small Business Administration, and an 8(a) certified by the Small Business Administration.

² The 5th Street Parking Structure is also subject to payment of prevailing wages by virtue of its location in the Park East and the development agreement with Milwaukee County regarding this site.

Deer District : Executive Summary

Table 1 : Professional Services Inclusion

PROJECT	TOTAL PAYMENTS	COST SUBJECT TO INCLUSION	%
Fiserv Forum	\$ 4,331,864	\$ 22,564,093	19.2%
5th Street Parking Structure	\$ 783,787	\$ 2,419,339	32.4%
Public Plaza	\$ 510,452	\$ 1,463,860	34.9%
Total	\$ 5,626,103	\$ 26,447,292	21.3%

Each Project exceeded the 18% professional services inclusion requirement.

Inclusion Achieved

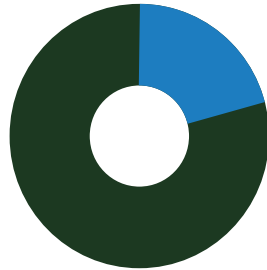

- **21.3% Inclusion Firm Payments**
\$5,626,103
 - **78.7% Non-Inclusion Firm Payments**
\$20,821,189
- Cost Subject to Inclusion**
\$26,447,292

Milwaukee Fire Department commemorating the arena.



Deer District : Executive Summary

Table 2 - Construction Inclusion

PROJECT	TOTAL PAYMENTS	COST SUBJECT TO INCLUSION	%
Fiserv Forum	\$ 85,952,104	\$ 230,211,533	37.3%
5th Street Parking Structure	\$ 8,819,055	\$ 26,993,978	32.7%
Public Plaza	\$ 3,975,949	\$ 11,292,932	35.2%
Total	\$ 98,747,108	\$ 268,498,443	36.8%

Payments to SBE firms have exceeded the 25% inclusion requirement.

Inclusion Achieved

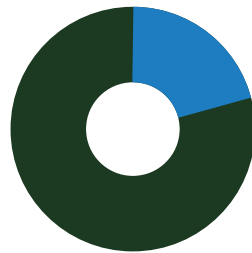

■ **36.8% Inclusion Firm Payments**
\$98,747,108

■ **63.2% Non-Inclusion Firm Payments**
\$169,751,335

Cost Subject to Inclusion
\$268,498,443

Table 3 - RPP Inclusion

PROJECT	TOTAL HOURS	TOTAL RPP HOURS	RPP REQUIREMENT	RPP % TO DATE
Fiserv Forum	1,622,648.0	684,840.1	40.0%	42.2%
5th Street Parking Structure	164,738.0	66,012.5	40.0%	40.1%
Public Plaza	34,315.1	14,555.1	40.0%	42.4%
Total	1,821,701.1	765,407.7	40.0%	42.0%

Total Residents Preference Program (RPP) Inclusion

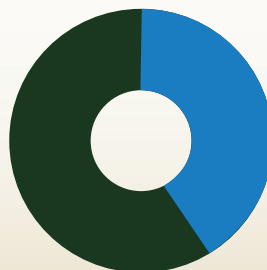

■ **42.0 % RPP Participation**
765,407.7 Total RPP Hours

■ **58.0% Non-RPP Hours**
1,056,293.4 Total Non-RPP Hours

Total Workforce Hours
1,821,701.1

Project Partners

PROJECT MANAGEMENT TEAM



A division of leading entertainment and sports agency Creative Artists Agency (CAA), CAA ICON is the world's-leading owners representative and strategic management consulting firm for public and private sports and entertainment facility owners/operators, professional franchises, and leagues. With more than 50 sports, entertainment, and public assembly projects and over 1,000 consulting engagements, CAA ICON has managed the development of many of the most successful venues around the world, spanning 11 professional sports leagues, totaling nearly \$20 billion. CAA ICON offers world-class service in the areas of project management, strategic advisory, feasibility and planning, and beyond.



Cross Management Services, Inc. (CMSI), a project management consulting firm, provides business management, public relations, research, and planning services. With a passion for excellence, ethical conduct, and knowledge, CMSI achieves high-quality results and consistently meets its commitments to its clients. CMSI specializes in coordinating and monitoring supplier and workforce diversity goals for developers, contractors, corporations, and governmental entities on construction projects.



Prism Technical is a multifaceted consulting firm that specializes in project and construction management, public relations and outreach, business training and corporate workforce diversity and inclusion. Based in Milwaukee, Prism started in 1995 working to ensure the diversity of workers and legitimate contracting practices on major construction projects funded by tax payers. This has allowed Prism to advise many forward thinking companies and governmental entities on matters of process, management, knowledge transfer and strategy. Prism has had unprecedented success on Wisconsin's most prestigious and challenging projects and has accumulated an unparalleled catalog of experiences working with small, women and minority owned businesses and underemployed workers. The firm opened a second office in St. Louis, MO in 2016.

ARCHITECTS & CONSTRUCTION MANAGERS



American Design Inc. is a twenty-year old firm whose experienced management team provides a full range of architectural services to satisfy its clients. American Design Inc. has the architectural background necessary to work with clients through each phase of the design process. Their design experiences includes residential, educational, commercial office, retail and public buildings.



eppstein uhen : architects

Eppstein Uhen Architects, Inc. (EUA) is an architecture firm located in Milwaukee (headquarters), Madison and Des Moines. More than 150 EUA team members demonstrate unparalleled commitment to the markets, communities and clients it serves. EUA works closely with clients and partners to create environments that exceed expectations while elevating people's potential. EUA, an 108 year-old firm specializes in workplace, healthcare, learning, living and entertainment environments.

Project Partners

Findorff

J. H. Findorff & Son Inc. is one of the Midwest's leading builders with offices in Madison and Milwaukee. For over 125 years, Findorff has continued to position itself as a dependable and reputable Company dedicated to excellence. Talented staff, a passion for innovation, and a focus on technology has helped secure our status as a leader in the construction industry. With over 700 employees currently, Findorff proudly acknowledges receipt of over 100 awards and recognition, for both commitment to quality construction and civic initiatives.

GRAEF

Established in 1961, GRAEF-USA Inc. has grown to become a leading U.S. consulting firm, as ranked by Engineering News Record Magazine. Their technical personnel, located in multiple offices in Wisconsin, Illinois, and Florida, represent a comprehensive resource with diverse technical expertise able to address all phases of analysis, design, and construction. From public infrastructure to environmental issues, industry to communications, governmental facilities to healthcare, education and retail, from and for numerous other project categories, GRAEF has positioned itself to serve their clients in unique and innovative ways.

HNTB

HNTB Corporation is an employee-owned infrastructure solutions firm. With more than a century of service, HNTB understands the life cycle of infrastructure and addresses clients' most complex technical, financial and operational challenges. Professionals nationwide deliver a full range of infrastructure-related services, including award-winning planning, design, program management and construction management.



Hunzinger Construction Company is a fourth generation, family-owned company that has continuously served the construction industry in Southeast Wisconsin since 1907. Hunzinger consists of construction managers, general contractors and design/builders who have built and managed some of Wisconsin's most notable and challenging projects. Hunzinger has received numerous awards for outstanding project management, safety, engineering, concrete work, and core values, including the Marquette University Family Business Excellence Award for Core Values and being recognized as Employer of Choice by Wisconsin Builder magazine over multiple years.



M. A. Mortenson Company is the 2nd largest sport builder in the United States with over 160 sports and entertainment projects. Founded in 1954, Mortenson is a U.S.-based, family-owned company. As one of the nation's top builders and developers, Mortenson provides a complete range of services, including planning, program management, pre-construction, general contracting, construction management, design-build, and turn-key development. Mortenson has offices in Chicago, Denver, Madison, Milwaukee, Minneapolis, Phoenix, Portland, and Seattle with international operations in Canada.

POPULOUS™

Since inception in 1983, Populous, Inc. has grown into the world's leading design firm dedicated exclusively to creating environments that draw people and communities together for unforgettable experiences. The firm has completed more than 1,000 projects around the globe with construction value exceeding \$20 billion. Populous has worked with 24 Major League Baseball franchises, 30 NFL franchises, 80 professional and civic arena clients, 40 global soccer and rugby teams, 120 universities, 40 convention center clients, 29 equestrian clients and has planned more than 30 major worldwide events.

RINKA|CHUNG

Rinka Chung Architecture, Inc. is a full service award-winning firm existing to serve progressive and visionary clients. They are differentiated by the ability to deliver inspiring design solutions that are both aesthetically elegant and functionally efficient. Rinka Chung places the highest value on people and relationships – both externally and internally.



City of Milwaukee Inclusion Requirements

- 18% Professional Service spending with Disadvantaged Business Enterprise (DBE), Small Business Enterprise (SBE), Small Disadvantaged Business (SDB) and/or 8(a)
- 25% construction spending with Disadvantaged Business Enterprise (DBE), Small Business Enterprise (SBE), Small Disadvantaged Business (SDB) and/or 8(a)
- 40% of the on-site construction hours to be performed by City residents meeting the City of Milwaukee Resident Preference Program (RPP) requirements as set forth in the HR Agreement
- Living wages must be paid to each worker performing construction trade labor on the project

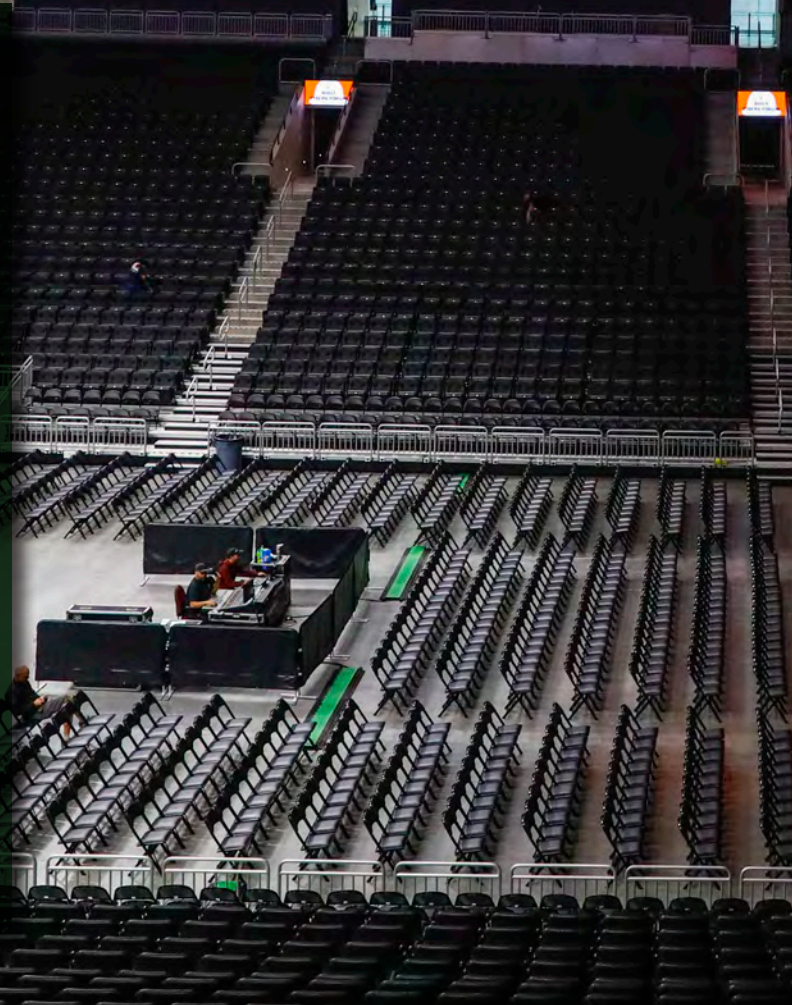

Seating inside the arena for the craft workers thank you party.

Profesional Services Inclusion



Electrical being installed in the lobby.

Printing Solutions for Large Scale Projects

Copy N'More, Inc.



Theophilus Iyasele,
President of Copy N'More, Inc.

Founded by Theophilus Iyasele and Olaitan Olapo in 1995, Copy N' More, Inc. provides quality printing, copying, and duplicating services, with a specialty in construction bid document printing and distribution. Copy N' More's printing, copying and bid set management experience features large scale projects like Johnson Controls' Glendale location, Wisconsin Convention Center, Miller Park, Lambeau Field, and the Fiserv Forum.

Utilizing their knowledge and expertise in large-scale project printing, Copy N' More printed the plan specifications during the design phase for the Fiserv Forum for the design team. Three of their talented and skilled employees were designated for the Fiserv Forum project, adding an additional layer of large-scale project experience to Copy N' More's already impressive resume.

Providing clients with quality products at a reasonable cost is why Copy N' More continues to build their client base. Copy N' More is committed to exceptional service for its clients by understanding their needs, rendering excellent services, and delivering on time, resulting in long-lasting relationships

"Customers don't want to hear excuses, just solutions"



Fiserv Forum: Professional Services Inclusion

Table 4 - Fiserv Forum: Professional Services Inclusion

SBE, DBE, SDB, or 8(a) FIRMS	SBE, DBE, SDB or 8(a)	SUBCONTRACTOR TO	SERVICE PERFORMED	AMOUNT PAID
American Design, Inc.	S/DBE	Eppstein Uhen Architects, Inc.	Architectural - Main & Upper Concourse	\$ 250,000
American Design, Inc.	S/DBE	GRAEF-USA Inc.	Architectural - Skywalk	\$ 50,298
American Design, Inc.	S/DBE	Eppstein Uhen Architects, Inc.	Construction Administration	\$ 90,675
Barrientos Design & Consulting, Inc.	DBE	Eppstein Uhen Architects, Inc.	Architecture - Event Level	\$ 319,500
Capitol Lien Records & Research, Inc.	DBE	Terracon Consultants, Inc.	Title Search - Phase I - Block 1	\$ 3,280
Capitol Lien Records & Research, Inc.	DBE	Terracon Consultants, Inc.	Title Search - Phase I - Block 2	\$ 1,688
Capitol Lien Records & Research, Inc.	DBE	Terracon Consultants, Inc.	Title Search - Phase I - Block 4	\$ 425
Capitol Lien Records & Research, Inc.	DBE	Terracon Consultants, Inc.	Title Search - Phase I - Block 5	\$ 2,875
Coastwise Fireguard Inc.	DBE	M-E Engineers, Inc.	Fire Sprinkler	\$ 98,010
Copy N More, Inc.	SBE	Populous, Inc.	Printing	\$ 52,175
Cotter Consulting, Inc.	DBE	M.A. Mortenson Company	Construction Management	\$ 382,954
Cross Management Services, Inc.	S/DBE	Deer District LLC	Inclusion Monitor - Business	\$ 311,434
Gestra Engineering, Inc.	S/DBE	Terracon Consultants, Inc.	Drilling Services - Geotech	\$ 103,857
Gestra Engineering, Inc.	S/DBE	Terracon Consultants, Inc.	Drilling Services	\$ 5,186
Himalayan Consultants, LLC	S/DBE	Professional Service Industries, Inc.	Construction Obs & Testing	\$ 67,038
IBC Engineering Services, Inc.	S/DBE	M-E Engineers, Inc.	MEP	\$ 385,000
JCP Construction LLC	S/DBE	M.A. Mortenson Company	Construction Management	\$ 320,000
M & E Architects+Engineers, LLC	DBE	Eppstein Uhen Architects, Inc.	Architecture - Vertical Circulation	\$ 126,000
Martinsek & Associates	SBE	Deer District LLC	Workforce Recruitment Video	\$ 15,740
P3 Development Group LLC	S/DBE	M.A. Mortenson Company	Outreach	\$ 39,797
Prism Technical Management & Marketing, LLC	S/DBE	Deer District LLC	Inclusion Monitor - Workforce	\$ 524,868
Thunderbird Engineering, Inc.	S/DBE	M-E Engineers, Inc.	Commissioning	\$ 125,250
Thunderbird Engineering, Inc.	S/DBE	M-E Engineers, Inc.	Commissioning	\$ 33,800
White Water Associates, Inc.	DBE	Terracon Consultants, Inc.	Laboratory Services - Block 1	\$ 24,261

Table continued on next page

Fiserv Forum: Professional Services Inclusion (Continued)

Table 4 - Fiserv Forum: Professional Services Inclusion - Continued

SBE, DBE, SDB, or 8(a) FIRMS	SBE, DBE, SDB or 8(a)	SUBCONTRACTOR TO	SERVICE PERFORMED	AMOUNT PAID
White Water Associates, Inc.	DBE	Terracon Consultants, Inc.	Laboratory Services - Block 4	\$ 4,768
Wrightson, Johnson, Haddon & Williams, Inc.	DBE	Populous, Inc.	Audio/Video Consulting	\$ 356,985
ZS, LLC	SBE	HNTB Corporation	Structural Foundation Design	\$ 390,000
ZS, LLC	SBE	HNTB Corporation	Building Access Design	\$ 96,000
ZS, LLC	SBE	HNTB Corporation	Roof Design	\$ 60,000
ZS, LLC	SBE	HNTB Corporation	Envelope Consulting	\$ 90,000
TOTAL AMOUNT PAID				\$ 4,331,864
INCLUSION AS A % OF PROFESSIONAL SERVICES COST SUBJECT TO INCLUSION				19.2%
PROFESSIONAL SERVICES COST SUBJECT TO INCLUSION				\$ 22,564,093

The project achieved 1.2% over goal.

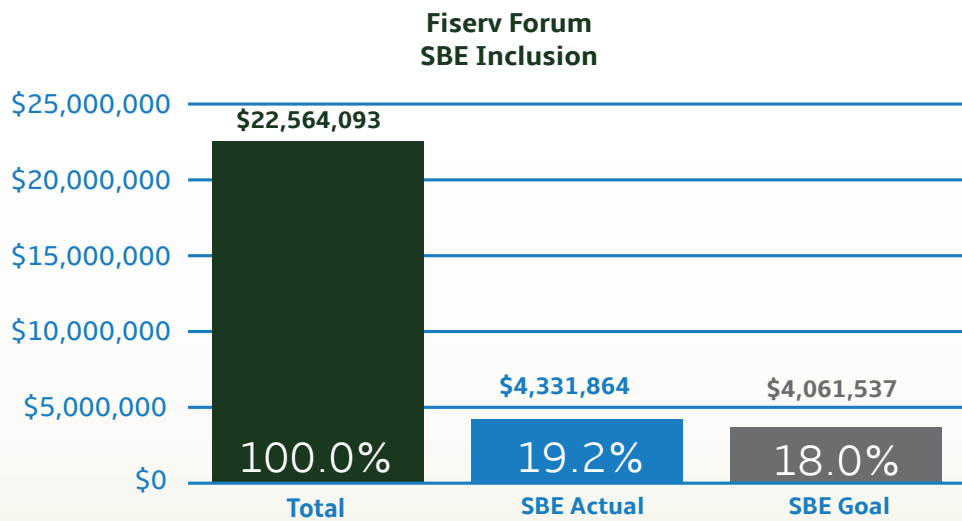

5th Street Parking Structure: Professional Services Inclusion

Table 5 - 5th Street Parking Structure: Professional Services Inclusion

SBE, DBE, SDB, or 8(a) FIRMS	SBE, DBE, SDB or 8(a)	SUBCONTRACTOR TO	SERVICE PERFORMED	AMOUNT PAID
American Design, Inc.	S/DBE	GRAEF-USA Inc.	Architectural - Parking Structure	\$ 362,974
American Design, Inc.	S/DBE	GRAEF-USA Inc.	Architectural - Housing	\$ 36,120
Capitol Lien Records & Research, Inc.	DBE	Terracon Consultants, Inc.	Title Search - Block 7	\$ 1,150
Cross Management Services, Inc.	S/DBE	Deer District LLC	Inclusion Monitor - Business	\$ 101,895
Dakota Intertek Corp.	S//DBE	Giles Engineering Associates, Inc.	Materials Testing	\$ 59,064
Gestra Engineering, Inc.	S/DBE	Terracon Consultants, Inc.	Drilling Services - Block 7	\$ 13,920
Gestra Engineering, Inc.	S/DBE	Terracon Consultants, Inc.	Geotech	\$ 30,145
Prism Technical Management & Marketing, LLC	S/DBE	Deer District LLC	Inclusion Monitor - Workforce	\$ 178,519
TOTAL AMOUNT PAID				\$ 783,787
INCLUSION AS A % OF PROFESSIONAL SERVICES COST SUBJECT TO INCLUSION				32.4%
PROFESSIONAL SERVICES COST SUBJECT TO INCLUSION				\$ 2,419,339

The project achieved 14.4% over goal.

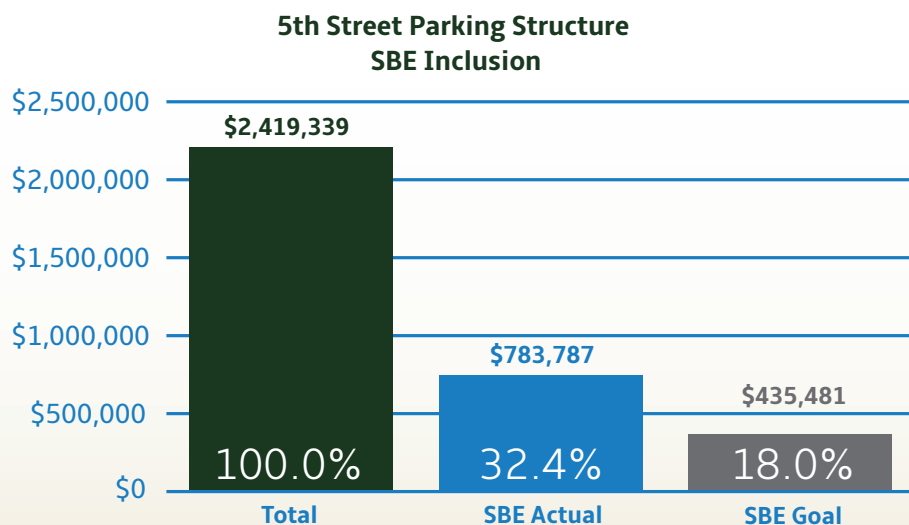

Public Plaza : Professional Services Inclusion

Table 6 - Public Plaza: Professional Services Inclusion

SBE, DBE, SDB, or 8(a) FIRMS	SBE, DBE, SDB or 8(a)	SUBCONTRACTOR TO	SERVICE PERFORMED	AMOUNT PAID
Cross Management Services, Inc.	S/DBE	Deer District LLC	Inclusion Monitor - Business	\$ 58,880
Nagel Architects	SDB	Deer District LLC	Architectural & Engineering	\$ 27,900
Prism Technical Management & Marketing, LLC	S/DBE	Deer District LLC	Inclusion Monitor - Workforce	\$ 149,097
Rinka Chung Architecture, Inc.	S/DBE	M. Arthur Gensler Jr. & Associates, Inc.	Architectural	\$ 152,650
Rinka Chung Architecture, Inc.	S/DBE	Deer District LLC	Architectural	\$ 108,225
Wrightson, Johnson, Haddon & Williams, Inc.	DBE	M. Arthur Gensler Jr. & Associates, Inc.	AV/IT Design	\$ 2,275
Wrightson, Johnson, Haddon & Williams, Inc.	DBE	Rinka Chung Architecture, Inc.	AV/IT Design	\$ 4,225
Wrightson, Johnson, Haddon & Williams, Inc.	DBE	Rinka Chung Architecture, Inc.	AV/IT Design	\$ 4,200
ZS, LLC	SBE	M. Arthur Gensler Jr. & Associates, Inc.	Structural Engineering	\$ 3,000
TOTAL AMOUNT PAID				\$ 510,452
INCLUSION AS A % OF PROFESSIONAL SERVICES COST SUBJECT TO INCLUSION				34.9%
PROFESSIONAL SERVICES COST SUBJECT TO INCLUSION				\$ 1,463,860

The project achieved 16.9% over goal.

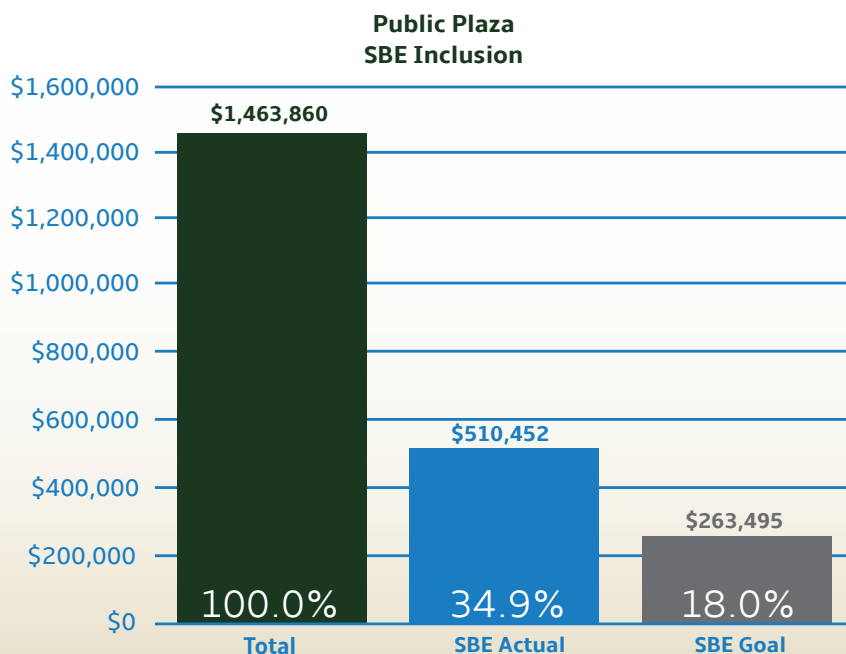

Construction Services Inclusion



Worker installing wood panels on the exterior of the arena.

A Part of Fiserv Forum, Inside and Out

PL Freeman Co.



Prentice L. Freeman Jr.,
President of PL Freeman Co.

Prentice L. Freeman Sr. started PL Freeman Co. as a roofing company in 1981 and expanded to include a mechanical division in 2003, under the leadership of its now president, Prentice L. Freeman, Jr. For the decades PL Freeman has been in business, it has contributed to several projects showcasing its talents and intricate attention to detail, which includes the Fiserv Forum project.

The firm's role in the construction of the Fiserv Forum included HVAC piping, plumbing, roofing, metals and sheet metal installation. Additionally, the firm provided laborers for cleaning and kitchen equipment setup. In total, over 25 of PL Freeman's steamfitters, plumbers, sheet metal workers, laborers and roofers supported work on the Fiserv Forum. Since its work on Fiserv Forum, PL Freeman has been featured in several articles, as well as becoming the prime contractor on a new housing development, 550 Ultra Lofts Project adjacent to the Fiserv Forum.

A strong value of PL Freeman is integrity. It operates on the belief that a business must be ethical in order to gain and keep the trust of its customers. There will always be issues in business but when the trust is built, and issues are immediately addressed, customers can maintain confidence in a company's services. Prentice L Freeman Jr and his firm live by the core values of setting a professional tone, being respectful and always having integrity.

"No matter who a customer speaks to at our company, they will always receive a high level of customer service."



Right: PL Freeman Co. employees working on HVAC piping for the arena.

Supporting Roles Creates New Opportunities

Price and Sons, Inc.

Incorporated in 1983, Price and Sons, Inc. is a locally owned and operated distributor of electrical, plumbing, HVAC, mechanical supplies and construction materials and equipment.

Price and Sons' prides itself on customer service that is second to none, delivering product orders to customers in a timely fashion and always placing their customers' needs first. Customers know they can trust Price and Sons to be available when they are needed and deliver what they have promised.

Price and Sons has supported the development of several projects including Miller Park, Camp Randall, Marriott Hotel in downtown Milwaukee and 30 years ago, the previous home of the Milwaukee Bucks, the BMO Harris Bradley Center.

Thrilled to be working on another Bucks project, Price and Sons provided some of the plumbing materials for the Fiserv Forum project with two experienced employees dedicated to the project. Because of their work on this project, Price and Sons has expanded its network and grown its capacity to continue working with the Milwaukee Bucks. They've experienced a bottom line increase, resulting in new opportunities for business growth and impact. Working on Fiserv Forum opened many more opportunities for Price and Sons, Inc.



Wayne Hampton,
President of Price and Sons, Inc.



"Work hard, don't give up and remain focused on your goals."

Table 7 - Fiserv Forum: Construction Inclusion

SBE, DBE, SDB, OR 8(a) FIRMS	SBE, DBE, SDB or 8(a)	SUBCONTRACTOR TO	SERVICE PERFORMED	AMOUNT PAID
Abaxent, LLC	S/DBE	Johnson Controls, Inc.	Cisco Stadium Hardware & Software	\$ 1,525,959
Abaxent, LLC	S/DBE	Johnson Controls, Inc.	Cisco Stadium Hardware & Software	\$ 4,985,350
Affirmative Supply Co.	SBE	C. M. Morris Group Inc.	Fireproofing Materials	\$ 493,858
Applied Flooring Solutions, LLC	DBE	M.A. Mortenson Company	Epoxy Flooring	\$ 606,983
Arrow Specialized Carriers, Inc.	SDB	Spancrete, Inc.	Precast Hauling	\$ 242,636
Arteaga Construction, Inc.	S/DBE	Langer Roofing & Sheet Metal Inc.	Sheet Metal Fabrication & Installation	\$ 976,898
Arteaga Construction, Inc.	S/DBE	M.A. Mortenson Company	Masonry	\$ 4,813,987
ASAP Fastening Systems, Inc.	DBE	Merrill Iron & Steel, Inc.	Fasteners	\$ 66,109
ASAP Fastening Systems, Inc.	DBE	Merrill Iron & Steel, Inc.	Fasteners	\$ 240,476
B&D Contractors, Inc.	S/DBE	Construction Supply & Erection, Inc.	Labor and Materials	\$ 291,214
Belonger Corporation	SBE	Ice Builders, Inc.	Labor and Materials	\$ 330,596
Benchmark LLC	DBE	Irwin Seating Co.	Seating Installation	\$ 1,407,627
Best Erectors, Inc.	S/DBE	Construction Supply & Erection, Inc.	Frabricate & Erect Drink Rails	\$ 57,118
Best Erectors, Inc.	S/DBE	Midwest Stairs & Iron, Inc.	Erector	\$ 672,100
BMR Design Group, Inc.	SBE	United States Alliance Fire Protection, Inc.	Design	\$ 785,730
C-Butts Electric, Inc.	S/DBE	Uihlein Electric Co., Inc.	Install Pipe and Wire	\$ 404,055
Choice Construction Companies, Inc.	S/DBE	Ice Builders, Inc.	Supply and install Rebar/Mesh	\$ 26,905
Choice Construction Companies, Inc.	S/DBE	Merrill Iron & Steel, Inc. / JP Cullen & Sons, Inc.	Steel Erection	\$ 1,176,641
Choice Construction Companies, Inc.	S/DBE	Merrill Iron & Steel, Inc. / JP Cullen & Sons, Inc.	Shoring Tower Rebar	\$ 14,400
Choice Construction Companies, Inc.	S/DBE	M.A. Mortenson Company	CIP Concrete (Rebar Install)	\$ 1,581,479
Choice Construction Companies, Inc.	S/DBE	Spancrete, Inc.	Precast Concrete Erection	\$ 718,527
Choice Construction Companies, Inc.	S/DBE	Staff Electric Co., Inc.	Concrete Work	\$ 2,039
Choice Construction Companies, Inc.	S/DBE	United Landshapers, LLC	Site Furnishings, Pavers	\$ 220,734
CK Gates and Associates LLC	S/DBE	Johnson Controls Inc.	PM, Field Verified/ Contract Mgmt	\$ 290,955

Table continued on next page

Fiserv Forum: Construction Inclusion (Continued)

Table 7 - Fiserv Forum: Construction Inclusion - Continued

SBE, DBE, SDB, OR 8(a) FIRMS	SBE, DBE, SDB or 8(a)	SUBCONTRACTOR TO	SERVICE PERFORMED	AMOUNT PAID
CK Gates and Associates LLC	S/DBE	Johnson Controls Inc.	DAS- Project Management	\$ 38,000
Courtland LLC	DBE	Egan Company	Supply Curtain Wall Glass/ Framing	\$ 2,152,048
Courtland LLC	DBE	M.A. Mortenson Company	Hardware	\$ 58,310
Crowley Construction Corp.	DBE	Payne & Dolan, Inc.	Trucking	\$ 2,000
D & G Insulation, Inc.	DBE	Ice Builders, Inc.	Mechanical Room Insulation	\$ 35,265
D & M Express of Wisconsin, Inc.	DBE	Egan Company	Trucking	\$ 27,289
D & M Express of Wisconsin, Inc.	DBE	Merrill Iron & Steel, Inc.	Trucking	\$ 440,334
Dairyland Energy Solutions, Inc.	S/DBE	Dimensional Innovations Corporation	Electrical Installation	\$ 22,500
Dairyland Energy Solutions, Inc.	S/DBE	Johnson Controls, Inc.	DAS - Inspection/PM Services	\$ 96,050
Dairyland Energy Solutions, Inc.	S/DBE	Rite-Hite Co., LLC	Electrical	\$ 48,410
Dairyland Energy Solutions, Inc.	S/DBE	Staff Electric Co., Inc.	Generator/Transfer Switch	\$ 980,788
Dairyland Energy Solutions, Inc.	S/DBE	Staff Electric Co., Inc. / Johnson Controls Inc.	Labor & Materials	\$ 1,418,359
Duwe Metal Products, Inc.	DBE	Construction Supply & Erection, Inc.	Miscellaneous Metals	\$ 207,267
Duwe Metal Products, Inc.	DBE	Merrill Iron & Steel, Inc.	Furnish & Install Structural Steel	\$ 10,852
Duwe Metal Products, Inc.	DBE	Merrill Iron & Steel, Inc.	Misc. Fabrication	\$ 1,117,340
Duwe Metal Products, Inc.	DBE	Merrill Iron & Steel, Inc.	Lab Mockup Fabrication and Erect	\$ 56,674
Duwe Metal Products, Inc.	DBE	Merrill Iron & Steel, Inc.	Joist Supply	\$ 57,415
Duwe Metal Products, Inc.	DBE	Merrill Iron & Steel, Inc.	Catwalk Fabrication	\$ 1,390,042
Duwe Metal Products, Inc.	DBE	Merrill Iron & Steel, Inc. / JP Cullen & Sons, Inc.	Steel Erection - Areas E & F & Temp Bracing, Shoring Tower	\$ 2,298,033
Duwe Metal Products, Inc.	DBE	Merrill Iron & Steel, Inc. / JP Cullen & Sons, Inc.	Temp Braces	\$ 202,063
Emerald City Tile, Inc.	SBE	Grazzini Brothers and Company	Material Supplier	\$ 991,568
Equity Supply Group LLC	S/DBE	MG McGrath Inc.	Waterproofing Zinc	\$ 868,200
Equity Supply Group LLC	SBE	Northern Illinois Terrazzo & Tile	Supply Terrazzo Material	\$ 595,615
Express Insulation, Inc.	DBE	Grunau Company, Inc.	HVAC Insulation	\$ 2,359,854
Express Insulation, Inc.	DBE	Hooper Corporation	Insulation	\$ 457,274

Table continued on next page

Fiserv Forum: Construction Inclusion (Continued)

Table 7 - Fiserv Forum: Construction Inclusion - Continued

SBE, DBE, SDB, OR 8(a) FIRMS	SBE, DBE, SDB or 8(a)	SUBCONTRACTOR TO	SERVICE PERFORMED	AMOUNT PAID
Express Insulation, Inc.	DBE	Ice Builders, Inc.	Insulation	\$ 15,123
Express Insulation, Inc.	DBE	Johnson Constrolc, Inc.	Chiller Insulation	\$ 16,174
Hall Trucking	DBE	Spancrete, Inc.	Trucking	\$ 30,240
Hard Rock Sawing & Drilling Specialists Company	DBE	Construction Supply & Erection, Inc.	Core Drilling	\$ 34,476
Hard Rock Sawing & Drilling Specialists Company	DBE	Hooper Corporation	Saw Cutting/Coring (T&M)	\$ 38,616
Hard Rock Sawing & Drilling Specialists Company	DBE	Rams Contracting, LTD.	Saw Cutting/Coring (T&M)	\$ 8,368
Hard Rock Sawing & Drilling Specialists Company	DBE	Spancrete, Inc.	Cutting Precast	\$ 9,408
Hard Rock Sawing & Drilling Specialists Company	DBE	Staff Electric Co., Inc.	Core Drilling	\$ 61,659
Hetzel-Sanfilippo Inc.	DBE	Austad & Son, Inc.	Acoustical Ceilings	\$ 499,370
Hetzel-Sanfilippo Inc.	DBE	Austad & Son, Inc./ Wall-Tech, Inc.	Labor & Drywall Framing	\$ 92,818
Hetzel-Sanfilippo Inc.	DBE	Langer Roofing & Sheet Metal Inc.	Carpentry	\$ 550,668
Hetzel Tile & Marble, Inc.	DBE	Grazzini Brothers & Company	Tile Installer	\$ 388,995
Hiram Power Electric, LLC	S/DBE	Johnson Controls Inc.	A/V Broadcasting Equipment	\$ 506,961
Hiram Power Electric, LLC	S/DBE	Staff Electric Co., Inc.	Electrical Labor & Materials	\$ 1,454,282
House of Stone, Inc.	SBE	Wilkie Sanderson	Stone Counters	\$ 616,169
Hurt Electric Inc.	S/DBE	Pieper Electric Inc. / Johnson Controls, Inc.	Communication Raceway	\$ 419,734
Hurt Electric Inc.	S/DBE	Staff Electric Co., Inc.	Distribution Equipment	\$ 2,705,882
Hurt Electric Inc.	S/DBE	Staff Electric Co., Inc.	Eaton/Powerware	\$ 465,307
Hurt Electric Inc.	S/DBE	Staff Electric Co., Inc.	Light Fixtures	\$ 4,834,776
HVA Products, Inc.	DBE	Grunau Company	HVAC Materials & Equipment	\$ 1,519,655
HVA Products, Inc.	DBE	Grunau Company	Supply & Install HVAC Vehicle Exhaust System	\$ 57,500
JCP Construction LLC	S/DBE	Chenery Bros. Inc.	Waterproofing	\$ 62,979
JCP Construction LLC	S/DBE	Ice Builders, Inc.	Vapor Barrier Installation	\$ 68,770
JCP Construction LLC	S/DBE	M.A. Mortenson Company	Site Concrete	\$ 848,284

Table continued on next page

Fiserv Forum: Construction Inclusion (Continued)

Table 7 - Fiserv Forum: Construction Inclusion - Continued

SBE, DBE, SDB, OR 8(a) FIRMS	SBE, DBE, SDB or 8(a)	SUBCONTRACTOR TO	SERVICE PERFORMED	AMOUNT PAID
JCP Construction LLC	S/DBE	M.A. Mortenson Company	Division 10 Specialities	\$ 1,783,523
JCP Construction LLC	S/DBE	M.A. Mortenson Company	Perimeter Security	\$ 1,937,205
JCP Construction LLC	SBE	Merrill Iron & Steel, Inc. / JP Cullen & Sons, Inc.	Shoring Tower Concrete Footings	\$ 32,892
JCP Construction LLC	S/DBE	MG McGrath Inc.	Install Grace HT	\$ 231,060
JCP Construction LLC	SBE	SC Railing Company	Railing Installation	\$ 1,518,272
JCP Construction LLC	S/DBE	Wall-Tech, Inc.	Carpentry	\$ 600,064
JCP Construction LLC	S/DBE	Wall-Tech, Inc.	Carpentry	\$ 161,316
Ketchum Professional Resources, LLC	DBE	Stafford Smith, Inc.	Supply and Install Equipment	\$ 1,673,175
Ketchum Professional Resources, LLC	DBE	Stafford Smith, Inc.	Supply and Install Equipment	\$ 329,839
McDowell Construction Corporation	SBE	Northway Fence, Inc.	Fencing Materials	\$ 37,288
NTL, LLC	SBE	Spancrete Inc.	Trucking	\$ 60,600
Nuvo Construction Company, Inc.	S/DBE	Michels Corporation	Pile Materials	\$ 445,785
Onyx Communications	DBE	Pieper Electric Inc. / Johnson Controls, Inc.	DAS - Supply and Install Cabling	\$ 105,258
PJ's Trucking LLC	SBE	D. F. Tomasini Contractors, Inc.	Trucking	\$ 13,151
P.L. Freeman Co.	SBE	Grunau Company, Inc.	Materials and Installation	\$ 2,496,359
P.L. Freeman Co.	SBE	Hooper Corporation	Labor	\$ 422,167
P.L. Freeman Co.	SBE	Langer Roofing & Sheet Metal Inc.	Roofing	\$ 129,559
P.L. Freeman Co.	SBE	Stafford Smith, Inc.	Food Service Equipment Installation	\$ 124,464
Peachy Clean Commerical and Construction Cleaning LLC	DBE	Grunau Company, Inc.	Cleaning	\$ 4,200
Peachy Clean Commerical and Construction Cleaning LLC	DBE	M.A. Mortenson Company	Final Cleaning	\$ 24,000
Price & Sons, Incorporated	SBE	Hooper Corporation	Materials Supplier	\$ 1,135,026
Rams Contracting, LTD.	SBE	Ice Builders, Inc.	Excavate Rink Mains	\$ 31,187
Rams Contracting, LTD.	SBE	M.A. Mortenson Company	Earthwork / Utilities	\$ 5,183,588
Rams Contracting, LTD.	SBE	M.A. Mortenson Company	Asphalt Paving	\$ 64,414

Table continued on next page

Fiserv Forum: Construction Inclusion (Continued)

Table 7 - Fiserv Forum: Construction Inclusion - Continued

SBE, DBE, SDB, OR 8(a) FIRMS	SBE, DBE, SDB or 8(a)	SUBCONTRACTOR TO	SERVICE PERFORMED	AMOUNT PAID
Rams Contracting, LTD.	SBE	Merrill Iron & Steel, Inc. / JP Cullen & Sons, Inc.	Shoring Tower, Concrete Footing	\$ 4,894
Rockwell Mechanical LLC	SBE	Grunau Company, Inc.	HVAC	\$ 1,138,835
Sonag Company, Inc.	DBE	Common Link Construction, LLC	T&M Framing & GWB	\$ 832,645
Sonag Ready Mix, LLC	SBE	Ice Builders, Inc.	CIP Concrete (Ready Mix Supplier)	\$ 51,373
Sonag Ready Mix, LLC	SBE	M.A. Mortenson Company	CIP Concrete (Ready Mix Supplier)	\$ 2,061,904
Sonag Ready Mix, LLC	SBE	Michels Corporation	Concrete & Pile Materials	\$ 101,877
South Star, Inc.	SBE	Rams Contracting, LTD.	Trucking	\$ 77,527
SPE, Inc.	DBE	Grunau Company, Inc.	Install TV Brackets	\$ 34,191
Stormwater Plans LLC	DBE	Hooper Corporation	Design BIM Work	\$ 148,810
Stormwater Plans LLC	DBE	Uihlein Electric Co., Inc.	Design BIM Work	\$ 33,708
Thomas A. Mason Company, Inc.	S/DBE	Dimensional Innovations Corporation	Install Graphics	\$ 80,618
Thomas A. Mason Company, Inc.	S/DBE	Grunau Company, Inc.	Touch-Up/Paint	\$ 23,577
Thomas A. Mason Company, Inc.	S/DBE	Ice Builders, Inc.	Painting	\$ 8,762
Thomas A. Mason Company, Inc.	S/DBE	M.A. Mortenson Company	Carpet & Resilient Flooring	\$ 2,169,617
Thomas A. Mason Company, Inc.	S/DBE	M.A. Mortenson Company	Wall Coverings, Painting & Coatings	\$ 2,750,354
Thomas A. Mason Company, Inc.	SBE	Merrill Iron & Steel, Inc. / JP Cullen & Sons, Inc.	Touch-Up/Paint	\$ 510,011
Thomas A. Mason Company, Inc.	SBE	Wall-Tech, Inc.	Drywall, Taping and Finishing	\$ 1,871,675
Tremmel-Anderson Trucking LLC	S/DBE	Jones Sign Co., Inc.	Trucking	\$ 2,066
Tremmel-Anderson Trucking LLC	S/DBE	Rams Contracting, LTD.	Trucking	\$ 385,485
Tremmel-Anderson Trucking LLC	S/DBE	Veit & Company, Inc.	Trucking/Disposal	\$ 55,178
Wards Welding & Fabrication, Inc.	SBE	Merrill Iron & Steel, Inc.	Material Supply	\$ 1,446,956
White Glove Group, Inc.	SBE	M.A. Mortenson Company	Final Cleaning	\$ 403,000
Wisconsin Utility Exposure, Inc.	SBE	Rams Contracting, LTD.	Utility Locator	\$ 3,444

Table continued on next page

Fiserv Forum: Construction Inclusion (Continued)

Table 7 - Fiserv Forum: Construction Inclusion - Continued

SBE, DBE, SDB, OR 8(a) FIRMS	SBE, DBE, SDB or 8(a)	SUBCONTRACTOR TO	SERVICE PERFORMED	AMOUNT PAID
ZS, LLC	SBE	Construction Supply & Erection, Inc.	Structural Engineering	\$ 1,690
ZS, LLC	SBE	Grunau Company, Inc.	Structural Engineering	\$ 39,375
TOTAL AMOUNT PAID				\$ 85,952,104
INCLUSION AS A % OF CONSTRUCTION COST SUBJECT TO INCLUSION				37.3%
CONSTRUCTION COST SUBJECT TO INCLUSION				\$ 230,211,533

The project achieved 12.3 % over goal.

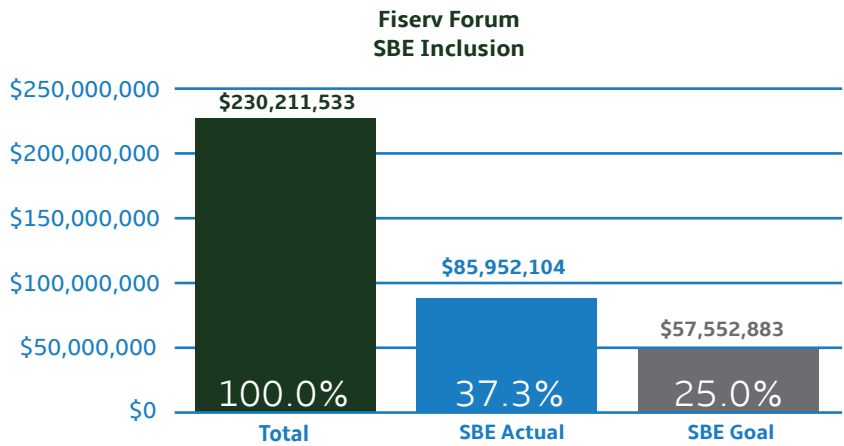

Interior photo of seating inside the arena.



5th Street Parking Structure: Construction Inclusion

Table 8 - 5th Street Parking Structure: Construction Inclusion

SBE, DBE, SDB, OR 8(a) FIRMS	SBE, DBE, SDB or 8(a)	SUBCONTRACTOR TO	SERVICE PERFORMED	AMOUNT PAID
3G Trucking, LLC	DBE	Lake Edge Logistics, LLC	Trucking	\$ 1,900
Best Erectors, Inc.	DBE	Klein Dickert Milwaukee, Inc.	Curtain Wall Erection	\$ 210,654
Best Erectors, Inc.	DBE	Midwest Stairs & Iron, Inc.	Barrier Cables	\$ 27,100
Best Erectors, Inc.	DBE	Midwest Stairs & Iron, Inc.	Metal Panels	\$ 269,710
Choice Construction Companies, Inc.	S/DBE	C. G. Schmidt, Inc.	Reinforcing Steel	\$ 2,032,588
Choice Construction Companies, Inc.	S/DBE	J. H. Findorff & Son Inc.	Reinforcing Steel	\$ 193,899
Duwe Metal Products, Inc.	DBE	J. H. Findorff & Son Inc.	Structural & Misc. Metals	\$ 530,218
EFH Trucking LLC	DBE	Lake Edge Logistics, LLC	Trucking & Tipping Fees	\$ 374,380
Express Insulation, Inc.	DBE	J. F. Ahern Co.	Fire Protection Insulation	\$ 8,475
Express Insulation, Inc.	DBE	J. F. Ahern Co.	HVAC Insulation	\$ 6,390
Express Insulation, Inc.	DBE	J. F. Ahern Co.	Plumbing Insulation	\$ 50,335
Hard Rock Sawing & Drilling Specialist Company	S/DBE	C.G. Schmidt, Inc.	Sawing Cutting	\$ 10,301
Hard Rock Sawing & Drilling Specialist Company	S/DBE	J. H. Findorff & Son Inc.	Wall Sawing	\$ 3,545
Harkinson Consulting LLC	DBE	J. H. Findorff & Son Inc.	Labor Compliance Services	\$ 74,292
Heider & Bott Company	DBE	Bohmann & Vick, Inc.	Material Supplier	\$ 29,185
Hetzel-Sanfilippo Inc.	DBE	J. H. Findorff & Son Inc.	Drywall	\$ 171,227
Hiram Power Electric, LLC	S/DBE	Lemberg Electric Company, Inc.	Electrical Materials	\$ 436,733
Hiram Power Electric, LLC	S/DBE	Staff Electric Co., Inc.	Supply & Install Struct. Cable	\$ 28,182
Hurt Electric Inc.	S/DBE	Uihlein Electric Co., Inc.	Electrical	\$ 16,932
HVA Products, Inc.	DBE	J. F. Ahern Co.	HVAC Equipment	\$ 57,055
HVA Products, Inc.	DBE	J. F. Ahern Co.	Controls	\$ 25,350
JCP Construction LLC	S/DBE	J. H. Findorff & Son Inc.	General Trades/ Carpentry	\$ 175,467
KMI Construction LLC	SBE	J. H. Findorff & Son Inc.	Masonry	\$ 1,517,092
LF Green Development, LLC	S/DBE	Michels Corporation	Construction Staking	\$ 3,823
Marek Landscaping, LLC	DBE	Edgerton Contractors, Inc.	Erosion Control	\$ 2,881

Table continued on next page

5th Street Parking Structure: Construction Inclusion (Continued)

Table 8 - 5th Street Parking Structure: Construction Inclusion - Continued

SBE, DBE, SDB, OR 8(a) FIRMS	SBE, DBE, SDB or 8(a)	SUBCONTRACTOR TO	SERVICE PERFORMED	AMOUNT PAID
Nuvo Construction Company, Inc.	S/DBE	Michels Corporation	Pile Material Supplier	\$ 263,729
Price and Sons, Incorporated	S/DBE	J. F. Ahern Co.	Plumbing Material Supplier	\$ 47,982
Renegade Trucking, LLC	SBE	Lake Edge Logistics, LLC	Trucking	\$ 708
Sanchez Painting Contractors, Inc.	SBE	J. H. Findorff & Son Inc.	Painting	\$ 201,871
Sanchez Painting Contractors, Inc.	SBE	J. H. Findorff & Son Inc.	Concrete Sealing	\$ 38,567
Sonag Ready Mix, LLC	SBE	C. G. Schmidt, Inc.	Ready Mix Concrete	\$ 1,741,420
Sonag Ready Mix, LLC	SBE	Michels Corporation	Ready Mix Concrete	\$ 31,462
Sonag Ready Mix, LLC	SBE	J. H. Findorff & Son Inc.	Ready Mix Concrete	\$ 202,455
Sonag Ready Mix, LLC	SBE	J. H. Findorff & Son Inc.	Precast Grout Mix	\$ 390
Sonag Ready Mix, LLC	SBE	Stark Pavement Corporation	Ready Mix Concrete	\$ 17,695
South Star, Inc.	S/DBE	Lake Edge Logistics, LLC	Trucking	\$ 5,752
South Star, Inc.	S/DBE	Stark Pavement Corporation	Trucking	\$ 1,467
TOTAL AMOUNT PAID				\$ 8,819,055
INCLUSION AS A % OF CONSTRUCTION COST SUBJECT TO INCLUSION				32.7%
CONSTRUCTION COST SUBJECT TO INCLUSION				\$ 26,993,978

The project achieved 7.7% over goal.

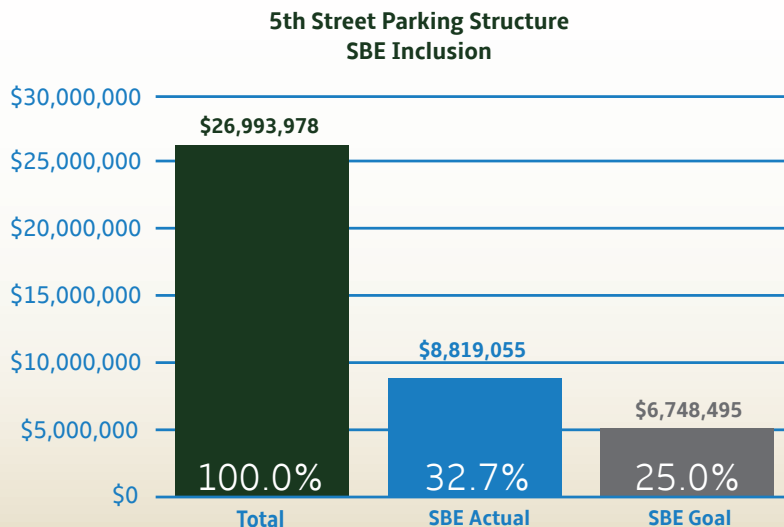

Public Plaza: Construction Inclusion

Table 9 - Public Plaza: Construction Inclusion

SBE, DBE, SDB, OR 8(a) FIRMS	SBE, DBE, SDB or 8(a)	SUBCONTRACTOR TO	SERVICE PERFORMED	AMOUNT PAID
Arteaga Construction, Inc.	SBE	Superior Masonry Builders, Inc.	Supply and Install Bollards and Gate Fence	\$ 848,361
Arteaga Construction, Inc.	SBE	Veit & Company, Inc.	Crane Rigging & Lifting Services	\$ 192,748
Autumn Trucking, Inc.	SBE	Veit & Company, Inc.	Trucking/Fuel Delivery	\$ 35,932
Beson-Houle LLC	DBE	Hunzinger Construction Company	Stie Railing Installation	\$ 20,676
Best Ed, LLC	SBE	Hunzinger Construction Company	Supplies	\$ 1,695
Crowley Construction Corporation	S/DBE	Stark Pavement Corporation	Stripping	\$ 11,852
Duwe Metal Products, Inc.	DBE	Hunzinger Construction Company	Misc. Metals Fabrication	\$ 182,731
Flores Contractors, Inc.	DBE	Veit & Company, Inc.	Erosion Control Measures	\$ 2,006
Hard Rock Sawing & Drilling Specialists Company	SBE	Spancrete, Inc.	Saw Cutting	\$ 9,408
Hard Rock Sawing & Drilling Specialists Company	SBE	Veit & Company, Inc.	Saw Cutting/Core Drilling	\$ 40,235
Hero Plumbing, LLC	DBE	Cornerstone Plumbing, LLC	Trench Drains Installation	\$ 151,755
Hurt Electric, Inc.	DBE	Pieper Electric, Inc.	Supply and Install Electrical Materials	\$ 349,501
KMI Construction LLC	DBE	Common Links Construction LLC	Air Vapor Barrier & Installation	\$ 123,204
Price and Sons, Incorporated	S/DBE	Cornerstone Plumbing, LLC	Distributor	\$ 110,086
Rams Contracting, LTD.	S/DBE	David J. Frank Landscape Contracting Inc.	Excavation	\$ 56,151
Rams Contracting, LTD.	S/DBE	Hunzinger Construction Company	Site Demo and Earthwork	\$ 969,571
Sirrah Construction LLC	SBE	Stark Pavement Corporation	Installation	\$ 39,389
Sonag Ready Mix, LLC	SBE	Cornerstone Plumbing, LLC	Supply Concrete Ready Mix	\$ 21,952
Sonag Ready Mix, LLC	SBE	Superior Masonry Builders, Inc.	Supply Concrete Ready Mix	\$ 261,401
South Star Inc.	SBE	Stark Pavement Corporation	Trucking	\$ 831
SPE, Inc.	DBE	Ace Iron & Steel Corp.	Structural Steel	\$ 147,716
Thomas A Mason Company, Inc.	S/DBE	Hunzinger Construction Company	Painting	\$ 159,768

Public Plaza: Construction Inclusion

Table 9 - Public Plaza: Construction Inclusion - Continued

SBE, DBE, SDB, OR 8(a) FIRMS	SBE, DBE, SDB or 8(a)	SUBCONTRACTOR TO	SERVICE PERFORMED	AMOUNT PAID
Tremmel-Anderson Trucking LLC	S/DBE	Cornerstone Plumbing, LLC	Trucking	\$ 32,976
Tremmel-Anderson Trucking LLC	S/DBE	Veit & Company, Inc.	Trucking	\$ 206,004
TOTAL AMOUNT PAID				\$ 3,975,949
INCLUSION AS A % OF CONSTRUCTION COST SUBJECT TO INCLUSION				35.2%
CONSTRUCTION COST SUBJECT TO INCLUSION				\$ 11,292,932

The project achieved 10.2% over goal.

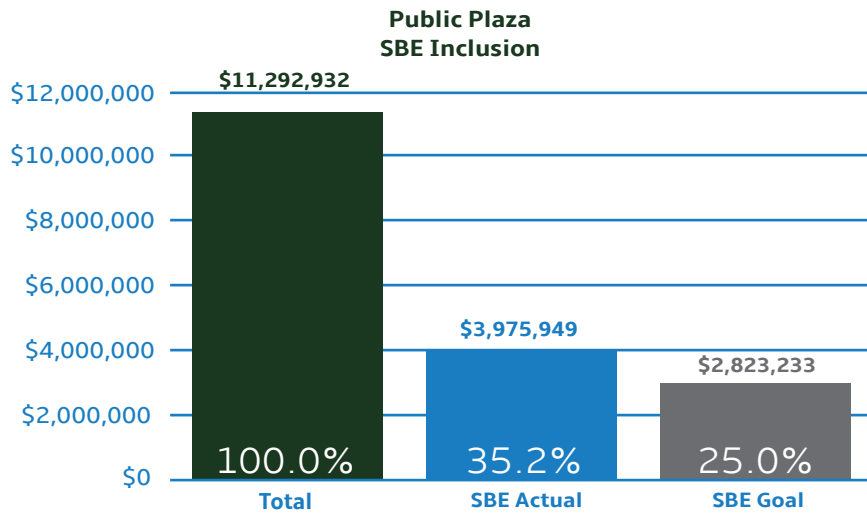

Entertainment Block Beer Garden.



RPP Inclusion



Worksite reflected in finished facade while workers complete construction inside.

A PART OF HIS CITY'S REDEVELOPMENT

Fernando Montoto - Bricklayer - Arteaga Construction, Inc.



"It's important, plus I enjoy what I do"

Arteaga Construction, Inc. employee for over four years, Fernando Montoto, has been working on the Milwaukee Bucks Arena project since February 2017. Originally pursuing a business degree at the University of Wisconsin-Milwaukee, Montoto was advised by a family friend to get into the trades and connected with the bricklayer's union.

Participating on a project that is redeveloping Milwaukee is crucial for Montoto. "It's important, plus I enjoy what I do," says Montoto. Being a Bricklayer is fulfilling to Montoto, especially working on a project such as the Milwaukee Bucks Arena in addition to other projects throughout the City of Milwaukee.

With the experience Montoto has gained throughout the years, he hopes to have enough knowledge to open his own construction company in the future. But as for now, he will continue to work on his craft as a bricklayer.



Table 10 - Fiserv Forum RPP Inclusion

Total Construction Hours	1,622,648.0
RPP Target Based on Total Hours (multiplied by 40%)	649,059.2
Applicable RPP Goal	40.0%
Total RPP Hours	684,840.1
RPP Hours Above (Below) Goal	35,780.8
RPP Percentage (Total RPP Construction Hours/Total Construction Hours Worked)	42.2%

Fiserv Forum Residents Preference Program (RPP) Inclusion

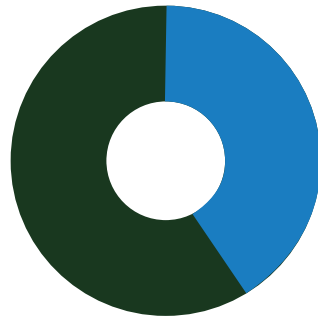

- **42.2 % RPP Participation**
684,840.1 Total RPP Hours
 - **57.8% Non-RPP Hours**
937,808.0 Total Non-RPP Hours
- Total Workforce Hours**
1,622,648.0

Table 11 - Fiserv Forum: RPP Inclusion (excluding Non-Wisconsin residents)

Total Construction Hours	1,622,648.0
Less Hours Worked by Non-Wisconsin Residents	79,494.7
Construction Hours Worked by Wisconsin Residents Only	1,543,153.3
RPP Hours	684,840.1
RPP Participation Percentage (Excluding non-Wisconsin residents)	44.4%

Milwaukee Code of Ordinances (MCO) Section 355-7(1)(a) notes that for the purpose of calculating RPP participation "...worker hours'... excludes the number of hours of work performed by all non-Wisconsin residents."

Table 12 - Fiserv Forum: RPP Inclusion by Contractor

CONTRACTOR	SUBCONTRACTOR TO	SERVICE PERFORMED	WORKFORCE HOURS	RPP INCLUSION HOURS
M. A. Mortenson Company	General Contractor	Concrete	179,144.0	73,245.5
Acuren Inspection, Inc.	Sports Facility Acoustics, Inc.	Testing/Inspection	2,575.0	0.0
AMJ Construction Management	W.L Hall Co.	General Construction	134.5	0.0
API Construction Company	P.L. Freeman Co.	Siding/Roofing	4,044.5	1,968.0
API Construction Company	M. A. Mortenson Company	Siding/Roofing	2,881.5	1,182.5
API Construction Company	JP Cullen & Sons Corporation	Siding/Roofing	56.0	0.0
Applied Flooring Solutions, LLC	M. A. Mortenson Company	Flooring	2,648.3	1,294.5
Arteaga Construction, Inc.	Langer Roofing & Sheet Metal Inc.	Masonry	2,620.5	1,310.5
Arteaga Construction, Inc.	M. A. Mortenson Company	Masonry	51,127.5	21,162.0
Athletica Sports Systems Inc.	Ice Builders, Inc.	Dasher Board Installation	353.5	0.0
Austad & Son, Inc.	M. A. Mortenson Company	Acoustical Tile	10,409.0	2,878.0
Austad & Son, Inc.	Wall-Tech, Inc.	Acoustical Tile	6,239.0	2,506.5
Automatic Entrances of Wisconsin, Inc.	Egan Company	Door Installation	144.8	0.0
Automatic Entrances of Wisconsin, Inc.	Laforce, Inc.	Door Installation	35.3	0.0
B&D Contractors, Inc.	Constructions Supply & Erection, Inc.	Fabrication/Installation	3,275.0	1,933.0
Badger Ladder & Scaffold LLC	Thomas A. Mason Company, Inc.	Scaffolding/Ladders	2,541.0	935.0
Badger Ladder & Scaffold LLC	Staff Electric Co., Inc.	Scaffolding/Ladders	125.8	14.8
Balestrieri Environmental & Development, Inc.	Veit & Company, Inc.	Hazardous Material Remediation	68.0	34.0
Belonger Corporation, Inc.	Ice Builders, Inc.	Mechanical/Plumbing	1,220.0	605.0
Benchmark Company	Irwin Seating Company	Seating	19,756.3	10,723.0
Beson & Houle, LLC	Arbon Equipment Corporation	Structural Steel	1,187.5	360.5
Best Erectors, Inc.	Constructions Supply & Erection, Inc.	Steel Erection	240.8	13.8
Best Erectors, Inc.	Midwest Stairs & Iron, Inc.	Steel Erection	5,770.0	4,007.0
Bevstream Corporation	Perlick Corporation	Installation of Beverage Piping	1,952.0	968.0
Black Mountain Products, Inc.	Parsons Electric LLC	Exercise Equipment	1,933.0	0.0

Table continued on next page

Table 12 - Fiserv Forum: RPP Inclusion by Contractor

CONTRACTOR	SUBCONTRACTOR TO	SERVICE PERFORMED	WORKFORCE HOURS	RPP INCLUSION HOURS
C.M. Morris Group, Inc.	M. A. Mortenson Company	Sprayed Applied Fireproofing	23,822.0	11,878.0
CButts Electric, Inc.	Uihlein Electric Co., Inc.	Electrical	5069.75	1,391.5
Chenery Brothers Inc.	M. A. Mortenson Company	Damproofing & Waterproofing	218.0	0.0
Choice Construction Companies, Inc.	Ice Builders, Inc.	Concr Reinf & PT Installation	146.5	35.5
Choice Construction Companies, Inc.	JP Cullen & Sons Corporation	Concr Reinf & PT Installation	10,716.0	4,954.0
Choice Construction Companies, Inc.	Staff Electric Co., Inc.	Concr Reinf & PT Installation	20.5	15.0
Choice Construction Companies, Inc.	Spancrete, Inc.	Concr Reinf & PT Installation	3,581.5	1,878.5
Choice Construction Companies, Inc.	M. A. Mortenson Company	Concr Reinf & PT Installation	16,847.5	7,249.0
Choice Construction Companies, Inc.	United Landscapers LLC	Concr Reinf & PT Installation	299.5	0.0
Common Links Construction, LLC	M. A. Mortenson Company	Steel/Stud/Drywall	15,714.5	5,858.0
Concrete & Masonry Restoration, LLC	M. A. Mortenson Company	Restoration	154.5	5.3
Construction Supply & Erection, Inc.	M. A. Mortenson Company	Erection	719.3	141.8
Crowley Construction Corporation	Rams Contracting, LTD.	Pavement Marking	16.5	5.5
D & G Insulation, Inc.	M. A. Mortenson Company	Insulation	126.0	0.0
D.F. Tomasini Contractors, Inc.	Staff Electric Co., Inc./ Rams Contracting, LTD.	Site Utilities	5862	1,141.5
Dairyland Energy Solutions, Inc.	Arbon Equipment Corporation	Electrical	672.5	2.5
Dairyland Energy Solutions, Inc.	Johnson Controls, Inc.	Electrical	5,985.5	4,640.5
Dairyland Energy Solutions, Inc.	Staff Electric Co., Inc.	Electrical	1,554.0	1,554.0
Dairyland Energy Solutions, Inc.	Dimensional Innovations	Electrical	144.0	144.0
Daktronics, Inc.	M. A. Mortenson Company	Video Display	2,888.8	0.0
Dawes Rigging & Crane Rental, Inc.	Choice Construction Companies, Inc.	Rigging/Erecting	850.5	0.0
Dawes Rigging & Crane Rental, Inc.	Common Links Construction, LLC	Rigging/Erecting	9.0	0.0
Dawes Rigging & Crane Rental, Inc.	Egan Company	Rigging/Erecting	489.0	0.0
Dawes Rigging & Crane Rental, Inc.	Grunau Company, Inc.	Rigging/Erecting	976.5	0.0
Dawes Rigging & Crane Rental, Inc.	JP Cullen & Sons Corporation	Rigging/Erecting	913.8	0.0

Table continued on next page

Table 12 - Fiserv Forum: RPP Inclusion by Contractor - Continued

CONTRACTOR	SUBCONTRACTOR TO	SERVICE PERFORMED	WORKFORCE HOURS	RPP INCLUSION HOURS
Dawes Rigging & Crane Rental, Inc.	Midwest Stairs & Iron, Inc.	Rigging/Erecting	391.0	0.0
Dawes Rigging & Crane Rental, Inc.	Wall-Tech, Inc.	Rigging/Erecting	1,475.0	0.0
Daxam, Inc.	Jones Sign Co., Inc.	Digital Image	214.0	0.0
Deangelis Construction LLC	Rams Contracting, LTD.	Concrete	394.0	168.3
Dimensional Innovations	M. A. Mortenson Company	Design Board	212.3	0.0
DJ Rossetti, Inc.	Ice Builders, Inc.	Concrete	246.5	36.0
Doral Corporation	Ice Builders, Inc.	Rigging/Erecting	53.0	9.0
Doral Corporation	JCP Construction LLC	Rigging/Erecting	10,866.0	2,969.0
Doral Corporation	Staff Electric Co., Inc.	Rigging/Erecting	1,296.5	291.5
Doral Corporation	Jones Sign Co., Inc.	Rigging/Erecting	169.5	0.0
Duwe Metal Products, Inc.	Constructions Supply & Erection, Inc.	Structural Fabrication	1,366.5	151.5
Duwe Metal Products, Inc.	JP Cullen & Sons Corporation	Structural Fabrication	22,688.5	14,985.5
Earthwise Environmental	Ice Builders, Inc.	Water Treatment Solutions	4.0	0.0
Egan Company	M. A. Mortenson Company	Aluminum Entrances, Storefront	18,551.0	9,293.0
Express Insulation, Inc.	Ice Builders, Inc.	Insulation	132.0	132.0
Express Insulation, Inc.	Johnson Controls, Inc.	Insulation	62.0	62.0
Express Insulation, Inc.	Hooper Corporation	Insulation	36,645.0	17,246.5
Gagnon, Inc.	Thomas A. Mason Company, Inc.	Insulation/Scaffolding/ Fireproofing	695.0	0.0
Gateway Concrete Forming Systems, Inc.	M. A. Mortenson Company	Concrete Shoring	357.0	0.0
Grazzini Brothers & Company	M. A. Mortenson Company	Commercial Tile/Flooring	27,278.5	9,897.3
Grunau Company, Inc	M. A. Mortenson Company	HVAC	104,140.4	46,623.7
Hard Rock Sawing & Drilling Specialists Company	Choice Construction Companies, Inc.	Concrete Saw Cutting	4.0	0.0
Hard Rock Sawing & Drilling Specialists Company	Constructions Supply & Erection, Inc.	Concrete Saw Cutting	112.0	0.0
Hard Rock Sawing & Drilling Specialists Company	Hooper Corporation	Concrete Saw Cutting	91.0	0.0
Hard Rock Sawing & Drilling Specialists Company	Rams Contracting, LTD.	Concrete Saw Cutting	9.5	0.0

Table continued on next page

Table 12 - Fiserv Forum: RPP Inclusion by Contractor - Continued

CONTRACTOR	SUBCONTRACTOR TO	SERVICE PERFORMED	WORKFORCE HOURS	RPP INCLUSION HOURS
Hard Rock Sawing & Drilling Specialists Company	Spancrete, Inc.	Concrete Saw Cutting	20.5	0.0
Hard Rock Sawing & Drilling Specialists Company	Staff Electric Co., Inc.	Concrete Saw Cutting	155.5	0.0
Hetzel Tile & Marble, Inc.	Grazzini Brothers & Company	Tile/Marble	4,602.5	1,687.0
Hetzel-Sanfilippo, Inc.	Austad & Son Inc.	Gypsum Wallboard	889.5	326.0
Hetzel-Sanfilippo, Inc.	Langer Roofing & Sheet Metal Inc.	Gypsum Wallboard	3,652.0	1,616.5
Hetzel-Sanfilippo, Inc.	Wall-Tech, Inc.	Gypsum Wallboard	782.0	312.0
High Voltage Maintenance Corporation	Staff Electric Co., Inc.	Electrical	381.5	0.0
Hiram Power, LLC	Staff Electric Co., Inc.	Electrical	4185.0	2,046.3
Hooper Corporation	M. A. Mortenson Company	Plumbing	60748.5	22,035.5
House of Stone, Inc.	Wilkie Sanderson	Fabricator/Installer of natural/ manufactured stone	1,361.5	0.0
Hurt Electric, Inc.	Pieper Electric, Inc./ DAS, LLC	Electrical	885.5	752.5
Hurt Electric, Inc.	Staff Electric Co., Inc.	Electrical	8,937.3	3,924.0
Ice Builders, Inc.	M. A. Mortenson Company	Store Refrigeration/Ice	872.0	0.0
Ideal Crane Rental, Inc.	Choice Construction Companies, Inc.	Crane Rental	352.5	169.5
Ideal Crane Rental, Inc.	Grunau Company, Inc.	Crane Rental	3.0	0.0
Ideal Crane Rental, Inc.	Langer Roofing & Sheet Metal Inc.	Crane Rental	1,781.3	0.0
International Erectors, Inc.	Spancrete, Inc.	Steel Erection	3,725.0	0.0
J.P. Cullen & Sons, Inc.	Merrill Iron & Steel, Inc.	Steel Fabrication	55,918.0	20,593.0
J.P. Cullen & Sons, Inc.	Daktronics, Inc.	Steel Fabrication	4,514.0	2,385.0
JCP Construction LLC	JP Cullen & Sons Corporation	Install Portion of Acoustical Ceilings	117.5	81.0
JCP Construction LLC	M. A. Mortenson Company	Install Portion of Acoustical Ceilings	25,589.5	13,162.3
JCP Construction LLC	MG McGrath, Inc.	Install Portion of Acoustical Ceilings	1,538.9	1,538.9
JCP Construction LLC	SC Railing Company dba Trex Commerical Products	Install Portion of Acoustical Ceilings	4,797.8	3,047.3
JCP Construction LLC	Wall-Tech, Inc.	Install Portion of Acoustical Ceilings	6,336.5	2,250.0
Jones Sign Co., Inc.	M. A. Mortenson Company	Digital Image	2,705.5	0.0

Table continued on next page

Table 12 - Fiserv Forum: RPP Inclusion by Contractor - Continued

CONTRACTOR	SUBCONTRACTOR TO	SERVICE PERFORMED	WORKFORCE HOURS	RPP INCLUSION HOURS
Kaemmerlen Parts & Service Inc.	Stafford Smith Inc.	Electrical Services	6,296.0	4,145.5
Kone, Inc.	M. A. Mortenson Company	Elevators	16,047.3	0.0
Langer Roofing & Sheet Metal Inc.	M. A. Mortenson Company	Roofing	33,364.0	12,984.0
Metropolitan Mechanical Contractors, Inc.	Grunau Company, Inc.	General Contracting	1,820.0	0.0
MG McGrath, Inc.	M. A. Mortenson Company	Metal Roof and Wall Panels	49,574.5	19,501.3
MG McGrath, Inc.	Wilkie Sanderson	Metal Roof and Wall Panels	379.0	0.0
Michels Corporation	Rams Contracting, LTD.	Site Remediation, Piles Caissons	473.0	189.0
Michels Corporation	M. A. Mortenson Company	Dynamic Compaction and Deep Foundations/Piles	7,245.0	2,904.5
Mid State Traffic Control, Inc.	M. A. Mortenson Company	Traffic Control	4.0	0.0
Milwaukee Lawn Sprinkler Corp.	United Landscapers LLC	Lawn Service	450.0	399.8
Mortl Restoration, Inc.	Spancrete, Inc.	Restoration	7,357.5	4,686.5
Munson, Inc.	United Landscapers LLC	Landscaping	61.8	0.0
Northern Illinois Terrazzo & Tile Company	M. A. Mortenson Company	Commercial Tile/Flooring	10,016.5	2,209.0
Northway Fence, Inc.	M. A. Mortenson Company	Temporary Fence/ Installation	128.0	0.0
Onyx, Inc.	Pieper Electric, Inc./ DAS, LLC	Data Antenna System	617.0	0.0
P.L. Freeman Co.	Grunau Company, Inc.	Plumbing/HVAC	4,411.8	1,419.5
P.L. Freeman Co.	Hooper Corporation	Plumbing/HVAC	5,100.3	5,100.3
P.L. Freeman Co.	Langer Roofing & Sheet Metal Inc.	Plumbing/HVAC	1,668.0	1,668.0
P.L. Freeman Co.	Stafford Smith Inc.	Plumbing/HVAC	1,665.5	1,522.0
Payne & Dolan, Inc.	Rams Contracting, LTD.	Earthwork/Site Utilities	147.3	11.0
Peachy Clean LLC	M. A. Mortenson Company	Cleaning Services	808.0	80.0
Pieper Electric, Inc.	Globenet Telecommunications, LLC	Electrical	13,673.5	5,849.5
Pieper Electric, Inc.	Johnson Controls, Inc./ DAS, LLC	Electrical	1,180.0	0.0
Pieper Electric, Inc. dba Pro Lightning Protection	Staff Electric Co., Inc.	Electrical	830.0	0.0
PJ's Trucking, LLC	D.F. Tomasini Contractors, Inc.	Trucking	125.3	0.0

Table continued on next page

Table 12 - Fiserv Forum: RPP Inclusion by Contractor - Continued

CONTRACTOR	SUBCONTRACTOR TO	SERVICE PERFORMED	WORKFORCE HOURS	RPP INCLUSION HOURS
The Price Erecting Company	Grunau Company, Inc.	Steel Erection	2,865.5	0.0
The Price Erecting Company	JP Cullen & Sons Corporation	Rigging/Erecting	2,843.0	0.0
Rams Contracting, LTD.	M. A. Mortenson Company	Earthwork/Site Utilities	17,233.5	6,595.0
Rams Contracting, LTD.	Ice Builders, Inc.	Earthwork/Site Utilities	103.8	25.3
Rockwell Mechanical LLC	Grunau Company, Inc.	HVAC	1,442.5	1,442.5
SPE, Inc.	Grunau Company, Inc.	Steel/ Precast/ Crane Erection	274.0	118.5
Sid's Sealants LLC	Arteaga Construction, Inc.	Caulking/Waterproofing	2,727.0	1,126.0
Sid's Sealants LLC	Egan Company	Caulking/Waterproofing	3,404.5	1,332.0
Sid's Sealants LLC	Langer Roofing & Sheet Metal Inc.	Caulking/Waterproofing	503.5	0.0
Sid's Sealants LLC	Wall-Tech, Inc.	Caulking/Waterproofing	4,102.1	1,798.3
Sid's Sealants LLC	M. A. Mortenson Company	Caulking/Waterproofing	1,980.7	346.5
Sonag Company, Inc.	Common Links Construction, LLC	Concrete Pouring	6,265.5	5,233.5
Sopinski Trenching & Excavating, LLC	Common Links Construction, LLC	Excavating	2,655.0	0.0
South Star Trucking, LLC	Staff Electric Co., Inc.	Trucking	776.5	430.0
Sports Facility Acoustics, Inc.	M. A. Mortenson Company	Acoustical installer	659.0	0.0
Staff Electric Co., Inc.	Daktronics, Inc.	Electrical	5,977.5	2,784.3
Staff Electric Co., Inc.	Johnson Controls, Inc.	Electrical	91,619.5	40,558.3
Staff Electric Co., Inc.	Johnson Controls, Inc./ DAS, LLC	Electrical	5,013.8	2,197.8
Staff Electric Co., Inc.	M. A. Mortenson Company	Electrical	214,871.8	112,317.8
Staff Electric Co., Inc.	Parsons Electric LLC	Electrical	22,095.3	9,713.3
Superior Window Services, Inc.	Kessor Enterprises	Window Installation	954.8	0.0
Superl, Inc.	Egan Company	Commercial Insulation	271.0	0.0
Theresa Tremmel Trucking, LLC	Rams Contracting, LTD.	Trucking	3,324.3	2,603.3
Thomas A. Mason Company, Inc.	M. A. Mortenson Company	Painting/Flooring	57,359.1	24,471.1
Thomas A. Mason Company, Inc.	Dimensional Innovations	Painting/Flooring	422.5	168.0

Table continued on next page

Table 12 - Fiserv Forum: RPP Inclusion by Contractor - Continued

CONTRACTOR	SUBCONTRACTOR TO	SERVICE PERFORMED	WORKFORCE HOURS	RPP INCLUSION HOURS
Tiffin Scenic Studios, Inc.	M. A. Mortenson Company	Stage Equipment Installation	544.5	0.0
Total Mechanical, Inc.	Stafford-Smith Inc.	Mechanical/Plumbing	682.5	284.0
Tremmel - Anderson Trucking LLC	M. A. Mortenson Company	Trucking	21.8	5.0
Uihlein Electric Co., Inc.	Ice Builders, Inc.	Electrical	467.0	165.0
Uihlein Electric Co., Inc.	Johnson Controls, Inc.	Electrical	13,887.5	4,703.5
United Construction & Fence LLC	Northway Fence, Inc.	Temporary Fence/Installation	577.5	577.5
United Landshapers, LLC	M. A. Mortenson Company	Commerical Landscape	2,513.6	1,416.6
United States Alliance Fire Protection, Inc.	M. A. Mortenson Company	Fire Protection	14,886.3	7,821.8
United States Alliance Fire Protection, Inc.	Starfire Extinguisher Co - Stafford Smith Inc.	Fire Protection	181.0	0.0
U.S. Smoke & Fire Corporation	Wall-Tech, Inc.	Fire Protection	28.0	0.0
Veit & Company, Inc.	M. A. Mortenson Company	Demolition/Abatement	358.0	301.5
W.L. Hall Co.	JCP Construction LLC	Interior Building Systems/Exterior Finishes	334.0	0.0
Wall-Tech, Inc.	M. A. Mortenson Company	Structural & Metal Stud Framing	148,657.3	49,734.5
White Glove Group, Inc.	M. A. Mortenson Company	Environmental Services	1,912.5	72.0
Zentih Tech, Inc.	JCP Construction LLC	Civil Construction	514.0	0.0
Zone Mechanical North, LLC	Stafford-Smith Inc.	Commercial Refrigeration/HVAC	3,307.5	0.0
TOTAL WORKFORCE HOURS			1,622,648.0	684,840.1
RPP PERCENTAGE REQUIREMENT			40.0%	
RPP PERCENTAGE ACHIEVED				42.2%

Fiserv Forum: RPP Inclusion by Zip Code & Trade

Table 13 - Fiserv Forum: RPP Inclusion by Zip Code & Trade

Trade	# OF RPP WORKERS	ZIP CODE	TOTAL RPP HOURS
Acoustic Ceiling Tile Installer	1	53202	1,161.5
	1	53206	302.0
	2	53207	640.5
	1	53208	384.0
	2	53209	1,334.0
	2	53210	1,425.5
	1	53212	667.0
	1	53214	145.5
	2	53215	136.5
	2	53216	299.5
	1	53218	38.5
	2	53219	1,004.0
	1	53221	229.0
	1	53223	1,153.0
	1	53233	802.0
Bricklayer	1	53204	1,559.0
	1	53207	1,904.0
	1	53210	1,615.5
	1	53216	1,738.0
	1	53219	69.0
	1	53221	2,059.0
	1	53223	463.0
	1	53225	24.0
Carpenter	4	53204	5,172.5
	4	53206	7,207.3

Table continued on next page

Table 13 - Fiserv Forum: RPP Inclusion by Zip Code & Trade - Continued

Trade	# OF RPP WORKERS	ZIP CODE	TOTAL RPP HOURS
Carpenter (Continued)	6	53207	7,250.8
	5	53208	4,572.5
	9	53209	8,293.0
	6	53210	5,577.4
	4	53212	3,691.0
	1	53213	544.0
	16	53215	11,577.0
	4	53216	2,930.5
	4	53218	2,817.0
	4	53219	3,503.0
	4	53220	3,142.8
	11	53221	7,340.5
	4	53222	4,344.5
	3	53223	7,057.0
	4	53225	1,279.0
	2	53227	1,580.5
	1	53228	3,312.5
1	53233	1,157.5	
Carpet Layer/Soft Floor Coverer	1	53208	845.0
	1	53215	1,257.5
Cement Finisher	3	53205	3,742.5
	2	53207	1,456.5
	1	53209	21.0
	1	53216	139.0
	1	53218	536.0
	1	53219	21.5
	1	53220	119.5

Table continued on next page

Table 13 - Fiserv Forum: RPP Inclusion by Zip Code & Trade - Continued

Trade	# OF RPP WORKERS	ZIP CODE	TOTAL RPP HOURS
Cement Finisher (Continued)	1	53223	1,148.5
	1	53224	1,027.0
Drywall Taper/Finisher	1	53202	609.0
	1	53204	259.5
	2	53207	2,981.5
	1	53208	1,673.5
	1	53209	91.5
	10	53215	13,458.0
	1	53219	1,309.5
	2	53220	985.0
	1	53221	305.5
	Electrician	3	53202
4		53204	4,305.8
3		53205	3,549.3
2		53206	3,307.5
18		53207	23,904.8
7		53208	6,188.5
4		53209	3,712.0
9		53210	7,499.0
2		53211	2,340.8
4		53212	2,433.0
2		53214	4,565.0
8		53215	10,503.0
5		53216	8,190.0
5		53218	12,152.8
7	53219	10,758.3	
6	53220	15,032.8	

Table continued on next page

Table 13 - Fiserv Forum: RPP Inclusion by Zip Code & Trade - Continued

Trade	# OF RPP WORKERS	ZIP CODE	TOTAL RPP HOURS
Electrician (Continued)	15	53221	23,040.0
	3	53222	6,286.0
	4	53223	3,986.8
	3	53224	2,069.8
	2	53225	697.5
	1	53228	79.5
Fence Erector	2	53204	264.5
	2	53215	148.5
	1	53220	164.5
Fire Sprinkler Fitter	1	53208	1,898.5
	1	53214	1,507.0
	1	53214	2,057.5
	1	53220	884.0
Glazier	1	53209	243.3
	2	53212	3,174.3
	1	53216	58.0
	1	53219	1,552.0
	1	53223	1,224.0
	1	53233	1,285.8
Heat or Frost Insulator	1	53202	768.5
	1	53204	139.0
	1	53206	373.0
	1	53207	1,365.0
	1	53213	1,399.0
	4	53215	5,018.5
	1	53216	2,018.0

Table continued on next page

Table 13 - Fiserv Forum: RPP Inclusion by Zip Code & Trade - Continued

Trade	# OF RPP WORKERS	ZIP CODE	TOTAL RPP HOURS
Heat or Frost Insulator (Continued)	1	53219	234.5
	2	53221	4,107.0
	1	53223	96.0
	2	53227	1,922.0
Heavy Equipment Operator	1	53207	47.0
	1	53209	169.5
	1	53210	132.5
	1	53215	11.0
	2	53218	886.8
	5	53219	4,386.0
	1	53224	978.5
Ironworker	1	53202	1,634.0
	1	53203	1,630.5
	4	53204	2,449.0
	3	53206	1,325.5
	3	53207	1,530.3
	7	53208	4,560.5
	1	53209	49.5
	3	53210	987.5
	3	53211	3,159.0
	5	53212	4,177.0
	5	53213	2,882.5
	11	53215	8,833.0
	1	53216	1,732.5
	1	53218	999.0
5	53219	4,227.0	
2	53220	364.5	

Table continued on next page

Table 13 - Fiserv Forum: RPP Inclusion by Zip Code & Trade - Continued

Trade	# OF RPP WORKERS	ZIP CODE	TOTAL RPP HOURS
Ironworker (Continued)	4	53221	1,679.0
	2	53222	152.0
	1	53223	1,161.5
	1	53224	132.0
	5	53225	3,511.0
	1	53227	302.5
	2	53228	1,853.0
Laborer	1	53203	3,365.0
	11	53204	5,918.0
	1	53206	1,362.0
	6	53207	3,573.3
	5	53208	6,013.5
	10	53209	10,552.5
	5	53210	3,158.0
	3	53211	1,665.8
	9	53212	10,690.0
	1	53213	4,114.0
	1	53214	1,332.5
	18	53215	10,506.8
	10	53216	5,031.5
	10	53218	12,704.0
	5	53219	2,544.3
	5	53220	3,022.0
5	53221	5,027.8	
3	53222	1,576.0	
1	53224	8.5	
7	53225	7,339.8	

Table continued on next page

Table 13 - Fiserv Forum: RPP Inclusion by Zip Code & Trade - Continued

Trade	# OF RPP WORKERS	ZIP CODE	TOTAL RPP HOURS
Laborer (Continued)	1	53228	881.0
	1	53233	275.5
Painter	1	53204	24.0
	1	53206	261.5
	1	53207	7.0
	1	53208	660.0
	1	53210	112.0
	1	53212	1,461.0
	2	53214	3,754.5
	3	53215	1,801.8
	3	53216	2,809.0
	3	53219	1,536.5
	1	53220	531.3
	1	53222	97.0
	1	53224	727.5
	1	53225	942.0
	1	53227	583.5
Piledriver	1	53206	143.0
	1	53216	183.0
Plasterer	1	53225	959.5
Plumber	1	53207	849.5
	1	53208	1,048.0
	2	53209	4,321.3
	4	53210	7,193.3
	1	53211	563.8
	1	53212	1,635.3
	1	53215	2,522.0

Table continued on next page

Table 13 - Fiserv Forum: RPP Inclusion by Zip Code & Trade - Continued

Trade	# OF RPP WORKERS	ZIP CODE	TOTAL RPP HOURS
Plumber (Continued)	1	53216	2,157.0
	2	53218	1,091.3
	2	53219	1,162.5
	1	53223	973.5
	1	53225	375.0
Project Engineer	2	53211	1,616.0
	1	53212	347.5
Roofer	1	53206	299.0
	5	53207	3,404.8
	1	53208	1,118.5
	3	53209	700.5
	3	53210	1,577.0
	1	53212	274.0
	1	53213	20.0
	1	53214	26.0
	2	53215	1,655.5
	1	53219	1,466.5
	1	53221	512.0
	1	53222	1,850.0
	1	53223	1,174.0
Sheet Metal Worker	2	53202	1,693.0
	1	53204	1,032.0
	5	53207	5,179.0
	1	53208	2,144.0
	1	53209	172.5
	2	53210	958.5
	3	53212	1,716.8

Table continued on next page

Table 13 - Fiserv Forum: RPP Inclusion by Zip Code & Trade - Continued

Trade	# OF RPP WORKERS	ZIP CODE	TOTAL RPP HOURS
Sheet Metal Worker (Continued)	5	53215	2,881.0
	2	53216	2,474.0
	5	53218	6,030.5
	1	53219	1,616.5
	4	53220	7,007.3
	3	53221	3,458.5
	1	53222	2,086.0
	1	53223	1,052.0
	1	53224	1,877.0
	1	53225	617.0
	2	53227	3,461.0
	2	53228	2,108.5
	Steamfitter	1	53202
2		53204	2,572.8
1		53207	2,336.5
1		53209	2,145.0
3		53210	553.5
1		53212	869.5
2		53213	5,532.5
1		53214	978.3
1		53218	776.5
3		53219	2,177.0
1		53220	101.0
3		53221	2,193.5
1		53224	441.0
1	53225	1,966.0	
1	53227	1,567.0	

Table continued on next page

Table 13 - Fiserv Forum: RPP Inclusion by Zip Code & Trade - Continued

Trade	# OF RPP WORKERS	ZIP CODE	TOTAL RPP HOURS
Steamfitter (Continued)	1	53228	549.5
Teledata Installer	3	53207	2,350.0
	1	53209	2,059.0
	3	53210	2,280.0
	3	53212	1,686.0
	2	53214	318.0
	6	53215	6,550.5
	2	53216	463.5
	3	53218	1,828.5
	1	53219	1,012.3
	4	53220	3,583.0
	6	53221	7,079.3
	2	53222	2,570.0
	1	53223	29.0
	3	53225	2,790.5
	Terrazzo Finisher	1	53215
	1	53221	1,066.0
Tile Setter	2	53204	661.5
	3	53208	1,797.3
	1	53209	310.0
	1	53215	1,517.8
	2	53216	1,634.5
	1	53219	764.0
	1	53220	430.0
	1	53221	1,065.0
	2	53222	1,313.8
	3	53225	2,591.5

Table continued on next page

Table 13 - Fiserv Forum: RPP Inclusion by Zip Code & Trade - Continued

Trade	# OF RPP WORKERS	ZIP CODE	TOTAL RPP HOURS
Tuckpointer	1	53206	322.5
	1	53208	893.0
	1	53209	1,447.0
	2	53212	1,471.0
	4	53215	2,345.3
	1	53216	710.5
Truck Driver	2	53204	99.0
	2	53205	154.3
	3	53206	48.8
	2	53207	473.8
	2	53208	35.8
	13	53209	514.8
	7	53210	1,885.5
	1	53211	40.5
	2	53212	57.5
	8	53215	354.5
	6	53216	856.8
	7	53218	188.5
	3	53219	176.5
	1	53220	9.8
	3	53221	26.5
	3	53222	1,041.0
	4	53223	191.5
1	53224	21.8	
4	53225	585.0	
	791	TOTAL	684,840.6

5th Street Parking Structure: RPP Inclusion

Table 14 - 5th Street Parking Structure: RPP Inclusion

Total Construction Hours	164,738.0
RPP Target Based on Total Hours (multiplied by 40%)	65,895.2
Applicable RPP Goal	40.0%
Total RPP Construction Hours	66,012.5
RPP Hours Above (Below) Goal	117.4
RPP Percentage (Total RPP Construction Hours/Total Construction Hours Worked)	40.1%

5th Street Parking Structure Residents Preference Program (RPP) Inclusion

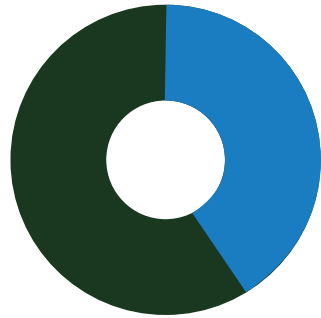

■ **40.1 % RPP Participation**
66,012.5 Total RPP Hours

■ **59.9% Non-RPP Hours**
98,725.4 Total Non-RPP Hours

Total Workforce Hours
164,738.0

Table 15 - 5th Street Parking Structure RPP Inclusion (excluding Non-Wisconsin residents)

Total Construction Hours	164,738.0
Less Hours Worked by Non-Wisconsin Residents	2,283.0
Construction Hours Worked by Wisconsin Residents Only	162,455.0
RPP Construction Hours	66,012.5
RPP Participation Percentage (Excluding Non-Wisconsin residents)	40.6%

Milwaukee Code of Ordinances (MCO) Section 355-7(1)(a) notes that for the purpose of calculating RPP participation "...'worker hours'... excludes the number of hours of work performed by all non-Wisconsin residents."

5th Street Parking Structure: RPP Inclusion by Contractor

Table 16 - 5th Street Parking Structure: RPP Inclusion by Contractor

CONTRACTOR	SUBCONTRACTOR TO	SERVICE PERFORMED	WORKFORCE HOURS	RPP INCLUSION HOURS
J.H. Findorff & Son Inc.	General Contractor	CIP Foundations	11,520.0	4,945.5
3G Trucking, LLC	Lake Edge Logistics, LLC	Trucking	19.0	19.0
Austad & Son, Inc.	J.H. Findorff & Son Inc.	Acoustical Tile Contractor	48.0	0.0
Automated Parking Technologies, LLC	J.H. Findorff & Son Inc.	Automated Parking	257.0	0.0
Best Erectors, Inc.	Midwest Stairs & Iron, Inc.	Structural Steel	3,496.5	2,088.0
Bohmann & Vick, Inc.	J.H. Findorff & Son Inc.	Utilities	484.5	186.5
Breezy Hill Nursery, Inc.	J.H. Findorff & Son Inc.	Landscape Services	180.1	0.0
C.G. Schmidt, Inc.	J.H. Findorff & Son Inc.	CIP Structure	73,228.8	31,904.0
Choice Construction Companies, Inc.	J.H. Findorff & Son Inc.	Install, Reinforcing Steel/ Bridge Work	25,544.5	10,690.5
Concrete & Masonry Restoration, LLC	J.H. Findorff & Son Inc.	Concrete & Masonry Resurfacing	842.3	279.3
David's M Trucking LLC	Guin's Trucking LLC	Trucking	7.2	7.2
Dawes Rigging & Crane Rental, Inc.	Egan Company	Crane Rental	162.5	0.0
Duwe Metal Products, Inc.	J.P. Cullen & Sons, Inc.	Metal Fabricating	2,621.5	812.0
Dywidag Systems Int'l USA, Inc.	Midwest Stairs & Iron, Inc.	Post Tensioning	99.5	49.0
Earth Augering Service LLC	Lemberg Electric Company, Inc.	Trenching	133.0	0.0
Edgerton Contractors, Inc.	J.H. Findorff & Son Inc.	Earthwork	2,888.0	437.3
EFH Trucking LLC	Lake Edge Logistics, LLC	Trucking	321.2	321.2
Express Insulation, Inc.	J.F. Ahern Co.	Insulation	196.0	150.0
Gonzalez E LLC	EFH Trucking LLC	Trucking	402.8	384.0
Guin's Trucking LLC	EFH Trucking LLC	Trucking	22.0	22.0
Hard Rock Sawing & Drilling Specialists Company	CG Schmidt, Inc.	Deep Sawing	19.0	0.0
Hennes Services, Inc.	Lemberg Electric Company, Inc.	Electrical	28.5	0.0
Hetzel-Sanfilippo, Inc.	Langer Roofing & Sheet Metal Inc.	Gypsum Wallboard	833.5	517.0
Hiram Power Electric, LLC	Staff Electric Co., Inc.	Electrical	129.0	129.0
Hurt Electric, Inc.	Uihlein Electric Co., Inc.	Underground Electrical	246.5	246.5
HVA Products, Inc.	J.F. Ahern Co.	General Contracting	189.5	0.0

Table continued on next page

5th Street Parking Structure: RPP Inclusion by Contractor (Continued)

Table 16 - 5th Street Parking Structure: RPP Inclusion by Contractor - Continued

CONTRACTOR	SUBCONTRACTOR TO	SERVICE PERFORMED	WORKFORCE HOURS	RPP INCLUSION HOURS
Illinois Facility Maintenance, Inc.	J.H. Findorff & Son Inc.	Janitorial Service	96.0	0.0
J.F. Ahern Co.	J.H. Findorff & Son Inc.	Plumbing/HVAC/Fire Protection	4,479.0	1,080.5
J.F. Cook Co., Inc.	J.H. Findorff & Son Inc.	Overhead Garage Door Installation	28.5	0.0
J.P. Anthony, Inc.	Uihlein Electric Co., Inc.	Concrete Cutting	6.5	0.0
JCP Construction LLC	J.H. Findorff & Son Inc.	General Contracting	595.8	172.8
Keen Trucking LLC	EFH Trucking LLC	Trucking	19.4	19.4
Kenwood Company	J.H. Findorff & Son Inc.	Sealants & Traffic Coating	234.0	70.0
Klein-Dickert Milwaukee, Inc.	J.H. Findorff & Son Inc.	Glass/Glazing	2,024.0	565.5
KMI Construction LLC	J.H. Findorff & Son Inc.	Masonry/Precast	9,702.0	4,448.0
Kone, Inc.	J.H. Findorff & Son Inc.	Elevator	1,675.0	0.0
Langer Roofing & Sheet Metal Inc.	J.H. Findorff & Son Inc.	Roofing	1,528.0	365.5
Lemberg Electric Company, Inc.	J.H. Findorff & Son Inc.	Electrical	9,533.3	3,298.5
Lippert Flooring and Tile	J.H. Findorff & Son Inc.	Flooring & Tile	198.5	0.0
Luz Mercado Trucking, Inc.	EFH Trucking LLC	Trucking	235.0	0.0
MCE Trucking LLC	EFH Trucking LLC	Trucking	26.2	26.2
Michels Corporation	J.H. Findorff & Son Inc.	Piles	1,769.0	673.0
Monos Trucking LLC	EFH Trucking LLC	Trucking	17.5	17.5
Mortl Restoration, Inc.	KMI Construction LLC	Restoration	112.5	19.0
Munson, Inc.	J.H. Findorff & Son Inc.	Fencing & Paving	109.0	35.5
Parking Lot Maintenance, Inc.	Stark Asphalt Service, Inc.	Asphalt & Concrete Paving	656.0	0.0
Poblocki Sign Company LLC	J.H. Findorff & Son Inc.	Signage	320.5	0.0
Potratz Concrete Pumping South, Inc.	CG Schmidt, Inc.	Concrete Pumping	366.0	0.0
Pro-Therm Insulation, Inc.	KMI Construction LLC	Insulation	69.0	0.0
Ram's Trucking LLC	EFH Trucking LLC	Trucking	15.8	0.0
Regency Janitorial Service, Inc.	J.H. Findorff & Son Inc.	Janitorial Service	377.0	160.8
Renegade Trucking, LLC	Lake Edge Logistics, LLC	Trucking	7.0	7.0

Table continued on next page

5th Street Parking Structure: RPP Inclusion by Contractor (Continued)

Table 16 - 5th Street Parking Structure: RPP Inclusion by Contractor - Continued

CONTRACTOR	SUBCONTRACTOR TO	SERVICE PERFORMED	WORKFORCE HOURS	RPP INCLUSION HOURS
RTA Trucking LLC	EFH Trucking LLC	Trucking	40.6	40.6
Sanchez Painting Contractors, Inc.	J.H. Findorff & Son Inc.	Painting	2,594.0	799.0
Sciachitano Caulking, Inc.	J.H. Findorff & Son Inc.	Caulking	520.0	0.0
South Star, Inc.	Lake Edge Logistics, LLC	Trucking	76.8	68.0
Staff Electric Co., Inc.	J.H. Findorff & Son Inc.	Electrical	1,138.5	491.0
Stark Asphalt Service Inc.	J.H. Findorff & Son Inc.	Asphalt Paving	890.3	386.0
Steve's Trenching Service, Inc.	Uihlein Electric Co., Inc.	Trenching	103.5	0.0
Terminal-Andrae, Inc.	J.F. Ahern Co.	Electrical	49.0	0.0
Uihlein Electric Co., Inc.	CG Schmidt, Inc.	Underground Electrical	729.0	81.0
Wahlen Corp.	J.H. Findorff & Son Inc.	Parking Lot Stripping	58.8	0.0
Zander Solutions, LLC	J.H. Findorff & Son Inc.	Waterproofing	49.0	0.0
Zenith Tech, Inc.	Edgerton Contractors, Inc.	Furnish & Install 26 Pipe Piling/ Earth Retention	368.0	0.0
TOTAL WORKFORCE HOURS			164,738.0	66,012.5
RPP PERCENTAGE REQUIREMENT			40.0%	
RPP PERCENTAGE TO DATE				40.1%

Completed vendor stations inside the arena.

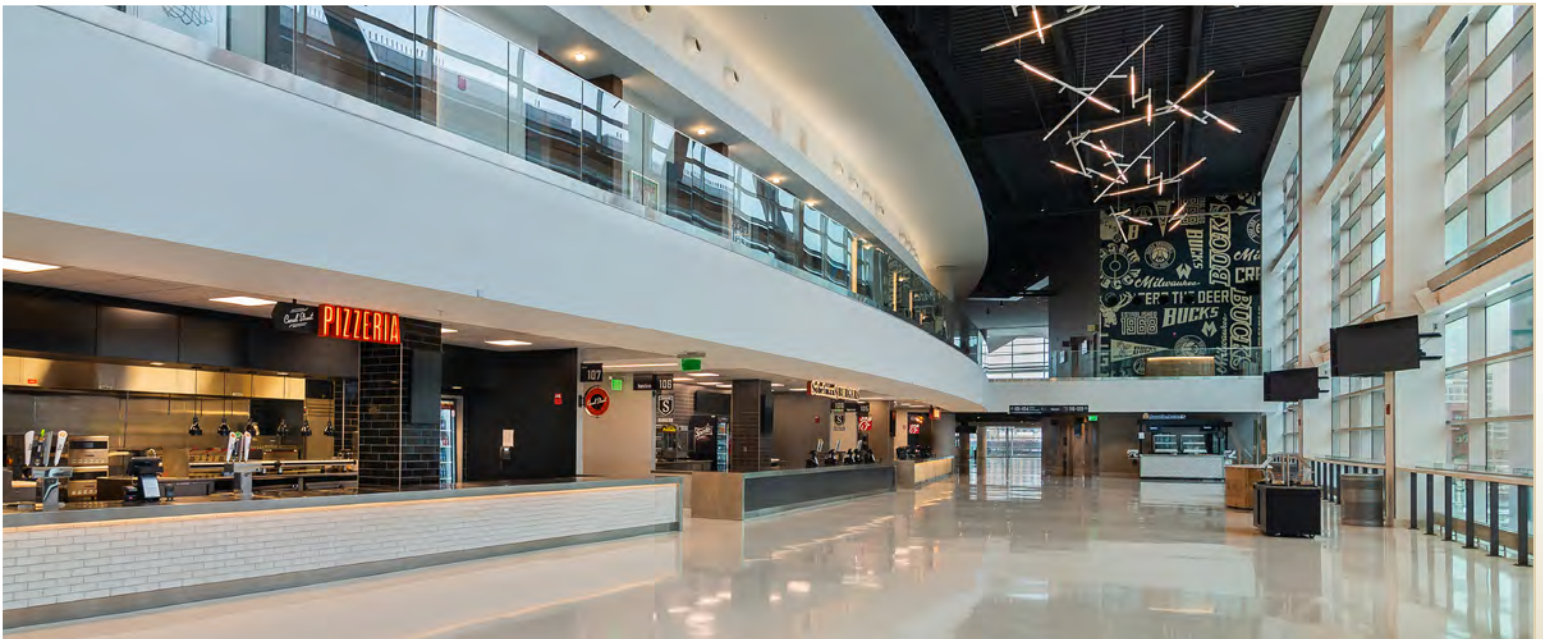

5th Street Parking Structure: RPP Inclusion by Zip Code & Trade

Table 17 - 5th Street Parking Structure: RPP Inclusion by Zip Code & Trade

Trade	# OF RPP WORKERS	ZIP CODE	TOTAL RPP HOURS
Acoustic Ceiling	1	53204	27.0
Bricklayer, Blocklayer	2	53204	398.0
	2	53210	921.0
	1	53213	390.5
	1	53218	30.5
	1	53223	781.5
	1	53227	931.0
Carpenter	1	53202	1,498.0
	2	53206	386.0
	4	53207	2,775.5
	1	53208	384.5
	1	53209	836.5
	4	53210	1,849.3
	1	53211	6.0
	1	53212	7.0
	2	53213	2,568.0
	4	53215	2,554.0
	1	53216	806.0
	4	53219	1,124.0
	1	53221	458.5
	4	53222	5,263.5
	1	53224	1,523.5
1	53225	88.0	
2	53227	1,252.0	
Cement Finisher	2	53202	335.5
	1	53205	32.0

Table continued on next page

5th Street Parking Structure: RPP Inclusion by Zip Code & Trade (Continued)

Table 17 - 5th Street Parking Structure: RPP Inclusion by Zip Code & Trade - Continued

Trade	# OF RPP WORKERS	ZIP CODE	TOTAL RPP HOURS
Cement Finisher	1	53207	760.5
	1	53209	1,110.0
	1	53210	32.0
	2	53215	214.0
	2	53219	1,172.5
	1	53223	38.0
	1	53224	944.5
Electrician	1	53207	162.5
	2	53218	165.0
	1	53215	2,165.5
	1	53220	1,133.0
Glazier	1	53209	123.0
	1	53212	8.0
	1	53220	434.5
Heat or Frost Insulator	1	53221	150.0
Heavy Equipment Operator	2	53207	214.5
	1	53215	118.5
	1	53224	112.5
Ironworker	1	53029	377.5
	4	53204	1,292.5
	3	53209	529.5
	2	53207	196.5
	5	53208	1,068.5
	3	53210	710.5
	2	53212	272.5
2	53213	129.0	

Table continued on next page

5th Street Parking Structure: RPP Inclusion by Zip Code & Trade (Continued)

Table 17 - 5th Street Parking Structure: RPP Inclusion by Zip Code & Trade - Continued

Trade	# OF RPP WORKERS	ZIP CODE	TOTAL RPP HOURS
Ironworker	4	53215	3,194.5
	1	53218	144.5
	4	53219	2,201.5
	1	53220	20.0
	4	53221	897.8
	1	53222	930.5
	2	53223	345.8
	1	53227	864.0
	1	53233	475.5
Laborer	5	53204	379.3
	1	53205	30.0
	4	53207	2,116.5
	1	53208	816.5
	3	53209	1,071.0
	1	53210	18.0
	1	53211	102.8
	1	53213	2,063.5
	7	53215	1,847.8
	5	53216	1,540.5
	2	53218	11.0
	1	53219	205.0
	1	53222	71.0
	1	53223	138.0
	1	53224	88.0
1	53225	241.5	
1	53227	504.5	

Table continued on next page

5th Street Parking Structure: RPP Inclusion by Zip Code & Trade (Continued)

Table 17 - 5th Street Parking Structure: RPP Inclusion by Zip Code & Trade - Continued

Trade	# OF RPP WORKERS	ZIP CODE	TOTAL RPP HOURS
Painter	3	53204	749.0
	1	53219	50.0
Piledriver	1	53206	261.5
Plumber	1	53204	263.0
	1	53210	547.0
	1	53225	56.0
Roofer or Waterproofer	1	53214	42.0
	2	53215	66.0
	2	53219	35.0
	1	53225	23.5
Sheet Metal Worker	1	53207	199.0
	1	53211	116.0
	1	53215	58.5
Steamfitter	1	53215	40.0
Teledata Technician or Installer	1	53214	456.5
	1	53216	129.0
	1	53221	11.5
	1	53222	11.5
	1	53225	11.5
Tuckpointer	1	53219	312.0
	2	53215	461.0
Truck Driver	1	53204	115.9
	1	53207	19.4
	1	53208	6.8
	1	53209	8.8
	3	53210	24.8

Table continued on next page

5th Street Parking Structure: RPP Inclusion by Zip Code & Trade (Continued)

Table 17 - 5th Street Parking Structure: RPP Inclusion by Zip Code & Trade - Continued

Trade	# OF RPP WORKERS	ZIP CODE	TOTAL RPP HOURS
Truck Driver	1	53214	26.3
	11	53215	362.7
	1	53218	14.0
	2	53219	300.2
	2	53220	25.0
	1	53221	7.7
	1	53222	7.0
	2	53223	13.8
	201	TOTAL	66,012.5

Interior picture of the arena featuring the main entrance lobby.



Public Plaza: RPP Inclusion

Table 18 - Public Plaza: RPP Inclusion

Total Construction Hours	34,315.1
RPP Target Based on Total Hours (multiplied by 40%)	13,726.0
Applicable RPP Goal	40.0%
Total RPP Construction Hours	14,555.1
RPP Hours Above (Below) Goal	829.1
RPP Percentage (Total RPP Construction Hours/Total Construction Hours Worked)	42.4%

Public Plaza Residents Preference Program (RPP) Inclusion

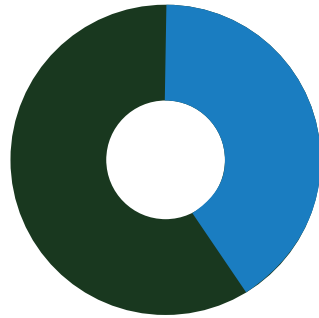

- **42.4 % RPP Participation**
14,555.1 Total RPP Hours
 - **57.6% Non-RPP Hours**
19,760.0 Total Non-RPP Hours
- Total Workforce Hours**
34,315.1

Table 19 - Public Plaza: RPP Inclusion (excluding Non-Wisconsin residents)

Total Construction Hours	34,315.1
Less Hours Worked by Non-Wisconsin Residents	111.8
Construction Hours Worked by Wisconsin Residents Only	34,203.3
RPP Construction Hours	14,555.1
RPP Participation Percentage (Excluding non-Wisconsin residents)	42.6%

Milwaukee Code of Ordinances (MCO) Section 355-7(1)(a) notes that for the purpose of calculating RPP participation "...'worker hours'... excludes the number of hours of work performed by all non-Wisconsin residents."

Public Plaza : RPP Inclusion by Contractor

Table 20 - Public Plaza: RPP Inclusion by Contractor

CONTRACTOR	SUBCONTRACTOR TO	SERVICE PERFORMED	WORKFORCE HOURS	RPP INCLUSION HOURS
Hunzinger Construction Company	General Contractor	Construction Manager	772.5	399.0
Arteaga Construction, Inc.	Hunzinger Construction Company	Restoration/ Masonry Panels	1,244.5	878.5
Beson & Houle, LLC	Hunzinger Construction Company	Specialty Contracting	216.0	123.0
Cornerstone Plumbing	Hunzinger Construction Company	Plumbing	1,577.0	390.0
Crowley Construction Corporation	Hunzinger Construction Company	Pavement Marking	62.3	0.0
Duwe Metal Products, Inc.	Hunzinger Construction Company	Metal	306.0	55.5
Flores Contractors, LLC	Hunzinger Construction Company	Erosion Control	3.0	0.0
Hard Rock Sawing & Drilling Specialist Company	Rams Contracting, LTD.	Saw Cutting	114.0	0.0
Hard Rock Sawing & Drilling Specialist Company	Spancrete, Inc.	Saw Cutting	271.0	0.0
Hero Plumbing, LLC	Hunzinger Construction Company	Plumbing	494.5	494.5
Hurt Electric, Inc.	Staff Electric Co., Inc.	Electrical	798.0	281.0
J&J Contracting of MN, LLC	Hunzinger Construction Company	Environmental Remediation	54.8	0.0
Langer Roofing & Sheet Metal Inc.	Hunzinger Construction Company	Roofing/Sheet Metal	47.0	9.5
Midwest Drilled Foundation & Engineering, Inc.	Hunzinger Construction Company	Deep Foundations	1,479.8	516.5
Milwaukee Lawn Sprinkler Corp.	United Landshapers, LLC	Lawn Irrigation System	126.0	126.0
Northway Fence, Inc.	Hunzinger Construction Company	Fencing	36.0	0.0
Pieper Electric, Inc.	Hunzinger Construction Company	Electrical	3,142.5	1,186.0
Rams Contracting, LTD.	Hunzinger Construction Company	Earthwork	5,693.0	2,631.6
SPE, Inc.	Grunau Company, Inc.	Steel/ Precast/ Crane Erection	1,430.5	796.0
South Star Trucking, LLC	Hunzinger Construction Company	Trucking	2.0	2.0
Stark Asphalt Service Inc.	Hunzinger Construction Company	Asphalt	1,232.5	418.0
Structures, Inc.	Hunzinger Construction Company	Structural work	16.0	0.0
Superior Masonry Builders, Inc.	Hunzinger Construction Company	Masonry	8,550.5	3,241.5
Theresa Tremmel Trucking, LLC	Hunzinger Construction Company	Trucking	189.3	166.8
Thomas A Mason Company, Inc.	Hunzinger Construction Company	Painting/Flooring	764.5	307.0
Tremmel - Anderson Trucking LLC	Cornerstone Plumbing, LLC	Trucking	909.1	495.8
United Construction & Fence LLC	Hunzinger Construction Company	Fencing	94.0	30.0
Veit & Company, Inc.	Hunzinger Construction Company	Demolition	4,689.0	2,007.0
TOTAL WORKFORCE HOURS			34,315.1	14,555.1
RPP PERCENTAGE REQUIREMENT			40.0%	
RPP PERCENTAGE TO DATE				42.4%

Public Plaza: RPP Inclusion by Zip Code & Trade

Table 21 - Public Plaza: RPP Inclusion by Zip Code & Trade

Trade	# OF RPP WORKERS	ZIP CODE	TOTAL RPP HOURS
Acoustic Tile Installer	1	53215	9.5
Bricklayer	1	53219	22.5
Carpenter	1	53205	4.0
	2	53207	56.0
	1	53212	740.5
	1	53224	4.0
	1	53225	108.0
Cement Finisher	1	53206	877.0
	4	53215	1265.8
	1	53219	16.0
	1	53220	21.5
Electrician	1	53207	152.0
	1	53208	390.0
	1	53215	8.0
	1	53216	129.0
	1	53224	788.0
Fence Erector	1	53204	30.0
Ironworker	2	53202	51.0
	1	53206	22.0
	1	53207	106.0
	1	53208	332.0
	1	53212	95.5
	1	53224	312.5
	1	53225	13.5
	1	53228	42.0
Laborers	1	53214	225.5
	6	53215	1652.0

Table continued on next page

Public Plaza: RPP Inclusion by Zip Code & Trade (Continued)

Table 21 - Public Plaza: RPP Inclusion by Zip Code & Trade (Continued)

Trade	# OF RPP WORKERS	ZIP CODE	TOTAL RPP HOURS
Laborers (Continued)	1	53216	176.5
	3	53219	901.5
	1	53224	235.8
	1	53227	296.5
Painter	1	53212	7.0
	1	53214	102.0
	1	53215	23.0
	2	53216	175.0
Piledriver	1	53212	29.8
Plumber	1	53206	339.5
	1	53208	155.0
Truck Driver	1	53029	14.5
	1	53204	147.8
	1	53206	5.8
	1	53207	81.8
	7	53209	145.0
	5	53210	728.8
	3	53215	37.3
	2	53218	87.0
	1	53219	5.3
	2	53221	52.3
	3	53222	99.5
	4	53223	46.3
1	53224	11.5	
2	53225	84.5	

Public Plaza: RPP Inclusion by Zip Code & Trade (Continued)

Table 21 - Public Plaza: RPP Inclusion by Zip Code & Trade (Continued)

Trade	# OF RPP WORKERS	ZIP CODE	TOTAL RPP HOURS
Heavy Equipment Operators	1	53206	11.8
	1	53215	129.3
	2	53218	988.5
	5	53219	962.8
	1	53222	32.5
	1	53225	968.0
Worker Totals	96	TOTAL	14,555.1

First game at the Fiserv Forum.



RPP by Aldermanic Districts - All Projects

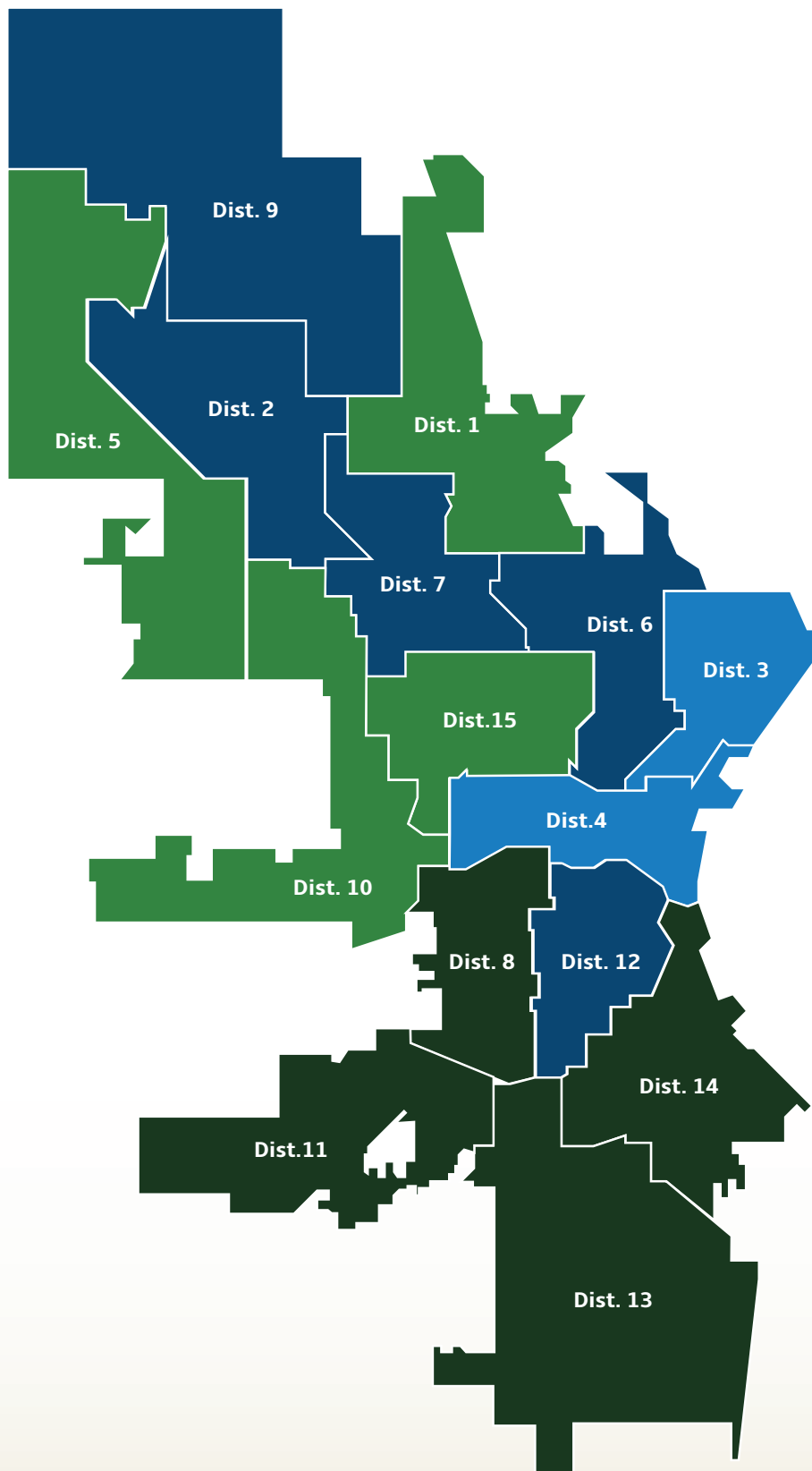

District Number	# of RPP Workers ³
District 1	60
District 2	50
District 3	27
District 4	33
District 5	71
District 6	46
District 7	57
District 8	90
District 9	43
District 10	79
District 11	142
District 12	50
District 13	112
District 14	81
District 15	64
Total	1,005

Legend

- 0 - 40 RPP Workers
- 41 - 60 RPP Workers
- 61 - 80 RPP Workers
- 81+ RPP Workers

³Count represents unique number of workers. **Workers may work in multiple trades.

⁴Workers who moved during the project may be counted in multiple zip codes.

⁵The Official numbers of workers employed through the Residents Preference Program is 867.

This map shows district numbers. Refer to chart for number of RPP workers.

Overall Project Outreach & Business Profile Highlights



Project Outreach

BUILD THE FUTURE EVENT

A major informational and networking session was held for small businesses seeking an opportunity on the Arena projects. Held at BMO Harris Bradley Center on March 14, 2016, the event featured presentations from Bucks President Peter Feigin, Mayor Tom Barrett and partners from the project management team on the Milwaukee Bucks Training Center, Block 7 Parking Structure and Arena projects. The partners discussed each project's respective bidding and construction schedules and inclusion goals. The night ended with a networking reception giving attendees an opportunity to connect with one another and the projects team members. Over 400 people attended.



ARENA TIP-OFF

On April 1, 2016, Mortenson held a tip-off event at the Italian Conference Center to engage business and community representatives and ensure availability of information about contracting and workforce opportunities on the Arena projects. Nearly 200 people attended.



WORKFORCE VIDEO FOCUS MEETING

A team from Media Makers developed a short video which can be utilized to encourage teens to consider careers in the construction trades. The video will discuss barriers and opportunities and direct teens to appropriate resources.



[Click here to view the "Making it" Video.](#)

FINDORFF OUTREACH MEETING

J. H. Findorff and JP Cullen held a joint meeting at ManpowerGroup to provide information about contracting and workforce opportunities on the 5th Street Parking Structure and Froedtert & Medical College of Wisconsin Sports Science Center. Over 150 people attended.



Photos from top to bottom: Build the Future Business Information Session, Construction Arena Tip-Off Event, Workforce Video Focus Meeting, and J.H Findorff Outreach Meeting.

Project Outreach: Contracting & Workforce

BUCKS GROUNDBREAKING

On June 18, 2016, the Bucks officially broke ground on the Milwaukee Bucks Arena at the corner of 4th and Juneau. The program included words from Gov. Scott Walker, Mayor Tom Barrett, Milwaukee County Executive Chris Abele, Senator Herb Kohl, and Bucks co-owners Wes Edens, Marc Lasry and Jamie Dinan. Following the morning program, attendees had an opportunity to sign a foundation pile, meet current and past Bucks players, and enjoy food vendors, music, and games.



Photos from Milwaukee Bucks Arena Groundbreaking.

Project Outreach: Contracting & Workforce

Executive Summary

Project Partners

Inclusion Data

Outreach

MORTENSON SUBCONTRACTOR INFORMATION SESSION FOR BID PACK 3

Mortenson Construction held a subcontractor information session for the new Fiserv Forum project on September 20, 2016 for the Bid Pack 3 portion of the project, estimated to be about \$60,000,000 worth of work. This portion of the project is expected to conclude by July 2018. Jesse Kemp, Senior Project Manager with Mortenson Construction, led the meeting, which about 50 subcontractors, consultants and visitors attended.



Photos from Mortenson Construction subcontractor information session

Project Outreach: Contracting & Workforce

Executive Summary

Project Partners

Inclusion Data

Outreach

JOURNEY HOUSE TOWN HALL MEETING

The Milwaukee Bucks partnered with the City of Milwaukee and SkillSmart to provide job seekers family-supporting employment opportunities based on skills, not degrees.

On December 15, 2016, the Milwaukee Bucks in partnership with the City of Milwaukee and SkillSmart held a town hall meeting at Journey House on the city's Near South Side. The meeting not only provided a local workforce for the building of the Fiserv Forum, but also provided a qualified workforce to operate the arena and its surrounding venues.

Over 100 City of Milwaukee and Milwaukee County residents attended the event to become familiar with how to use the SkillSmart platform which assessed worker skills, matched them with training and workforce opportunities.

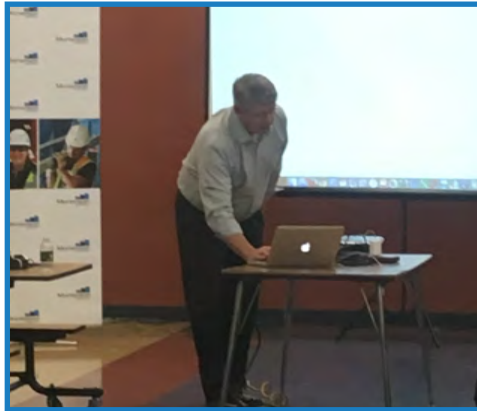

Alex Lasry of the Milwaukee Bucks speaking.



Project Outreach: Contracting & Workforce

Executive Summary

Project Partners

Inclusion Data

Outreach

HUNZINGER CONSTRUCTION PRE-BID & WALK-THROUGH MEETING

Hunzinger Construction held a subcontractor pre-bid meeting and walk-through at BMO Harris Bradley Center on March 1, 2017 to provide information about project requirements, contracting and workforce opportunities on the Public Plaza & Entertainment Block.



Photos of Public Plaza & Live Block Plaza pre-bid & walk-through meeting.

JOBS INFORMATIONAL SESSION – HILLSIDE RESOURCE CENTER

Alderwoman Milele A. Coggs and the Milwaukee Bucks hosted a community workforce session to discuss career opportunities upon completion of the Milwaukee Bucks Arena Projects. Over 50 attendees learned the process to become employed by the Bucks, and also used on-site computers to create a SkillSmart account and talk to representatives regarding RPP certification.

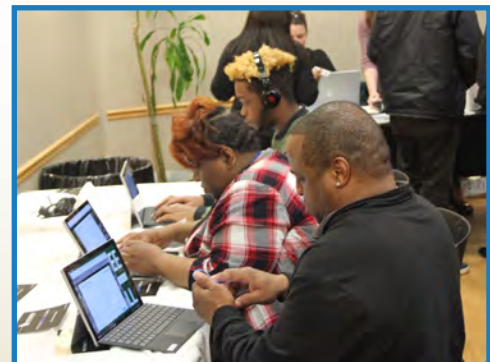

Photos of Hillside job information session.

Project Outreach: Contracting & Workforce

JUNETEENTH FESTIVAL

During the Juneteenth Festival held on Monday, June 19, 2017, a Bucks' Workforce Informational Table staffed by Prism Technical representatives was available for the duration of the festival to collect contact information for current and future Milwaukee Bucks' construction and hospitality job opportunities. Apprentice, Resident Preference Program (RPP) and SkillSmart information was shared with festival-goers.

Photos from Juneteenth Festival.



Project Outreach: Contracting & Workforce

GARFIELD DAYS BRONZEVILLE FESTIVALS

Bucks' Workforce Informational tables staffed by Prism Technical representatives was set up at the Garfield Days Festival held on Saturday, July 15, 2017 and the Bronzeville Festival held on Saturday, August 5, 2017. The informational tables were available during the duration of both festivals to collect contact information for current and future Milwaukee Bucks' construction and hospitality job opportunities. Apprentice, Residents Preference Program (RPP) and SkillSmart information was shared with festival-goers.

Photos from Garfield Days and Bronzeville Festivals.

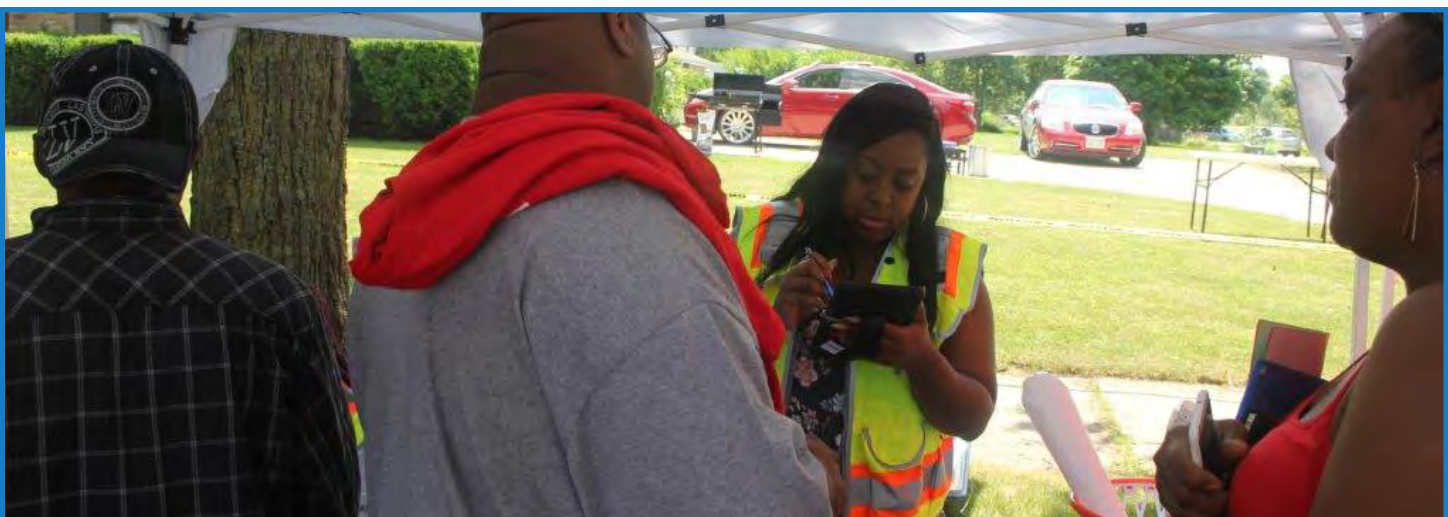

STUDENT ON THE RISE

Bryan Ramirez - Intern - Mortenson Construction

"I find it incredible how the drawings posted around the trailer are slowly coming to life."



Bryan Ramirez is a junior at Cristo Rey Jesuit High School. As noted on the school's website, through Cristo Rey's innovative work-study program, "students gain confidence, connect the relevance of their academic coursework to future employment, acquire skills that will benefit their career, and receive unprecedented access to the professional world."

Bryan enjoys the rigorous academics at Cristo Rey and credits ALEKS, a math program used at his school, for piquing his interest in math. He wanted an internship that would allow him to further enhance his math skills, as well as connect with his interest in construction, which was sparked by tagging along with his father, a carpenter. Bryan finds it interesting to observe the many tasks handled in the field and in the office.

This is Bryan's second year working for Mortenson Construction. He reviews safety document submissions and ensures that all contractors are submitting them in a timely fashion. What he loves most about working for Mortenson is seeing the steady progression of the arena project. "I find it incredible how the drawings posted around the trailer are slowly coming to life," he says. Besides bragging to his friends about his cool internship, he states, "My experience working for Mortenson Construction has been very positive. It is a very organized place to work and everyone works well together."

After high school, Bryan plans on attending a local college and getting his degree in construction management or civil engineering.

Project Outreach: Community Engagement

BUCKS CARE: TECHTERNS

Eppstein Uhen Architects and Mortenson Construction Company partnered with Milwaukee Public Schools' Bradley Tech High School to give students interested in building design and construction a hands-on learning experience at the Fiserv Forum and Froedtert & the Medical College of Wisconsin Sports Science Center. Eighteen TechTerns students were able to bring their curriculum-based learning to a real-life experience. Activities included virtual reality activities, 3D model assembly of the Arena, reviewing architectural plans, seat installation, construction development and sessions that exposed the students to electrical fitting and enclosure systems, seat installation, landscaping/sketching designs as well a chance to tape and mud drywall. The students ended their program by meeting Bucks President Peter Feigin and several Bucks players, attending a Bucks game and lastly a graduation ceremony for the TechTerns where they all received commemorative Bucks gear.



Photos from top to bottom: Bradley Tech High School TechTerns visited the Froedtert & The Medical College of Wisconsin Sports Science Center; Students toured the MATC campus; TechTerns helped lay boards into the practice courts.

COMMUNITY CELEBRATIONS AT THE NEW FISERV FORUM

The Milwaukee Bucks hosted a ribbon cutting ceremony as the first celebration to the opening of Fiserv Forum. The ceremony consisted of Bucks players, NBA Commissioner, elected officials and alumni as well as the Bucks present and former owners. Following the ribbon cutting ceremony, the community was able to get it's first look inside of the new arena.

The Milwaukee Bucks hosted a thank you party at the Fiserv Forum for the craft workers that helped build the world-class arena on August 7, 2018. 3,800 workers spent 2 million construction hours constructing the 128 foot-tall building over a two-year period.

More than 20,000 fans attended the 2019 Giannis Antetokounmpo MVP Celebration at the Fiserv Forum plaza on July 14, 2019. The event gave fans an opportunity to see Antetokounmpo presented with the MVP trophy and to check out his first signature shoe.

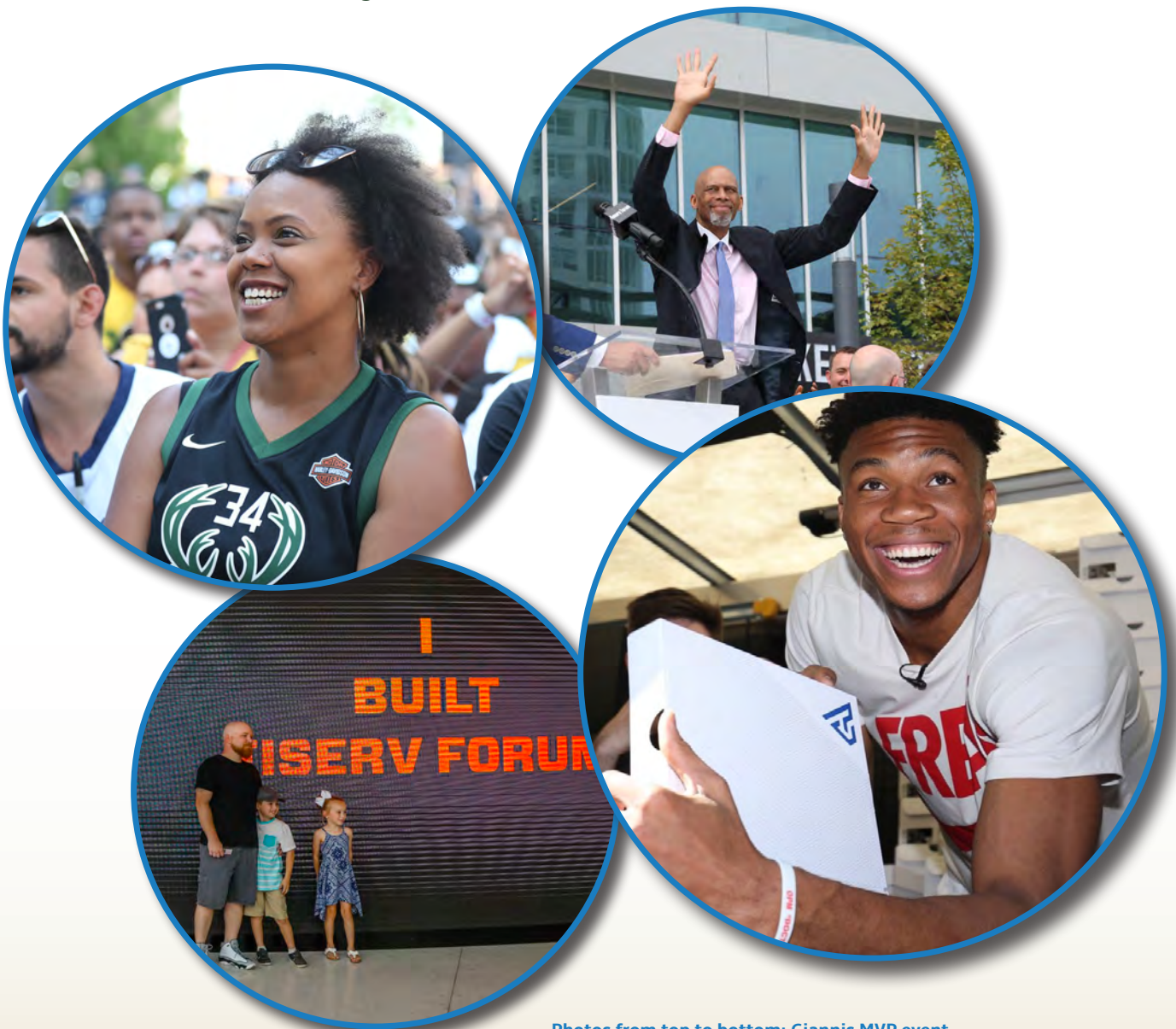

Photos from top to bottom: Giannis MVP event attendee, Kareem Abdul-Jabbar giving a speech at the ribbon cutting, Giannis with his new Nike shoes, a worker posing proudly with his family at the craft workers thank you party.



Tammy Ristow, President & CEO

In 2004, RAMS began as a small trucking firm with six employees. Today, RAMS is an earthwork contractor with 50 employees working on projects throughout southeastern Wisconsin. Tammy Ristow, President and CEO, credits the company's growth to RAMS being an optimal working and learning environment for employees. Tammy sees technology and learning as access points on their road to success. "I've never stopped learning, whether it was attending the Milwaukee Metropolitan Sewerage District training program, participating with employees in annual safety refresher courses, or investing in supervisory training, I'm learning to invest in those I work with at RAMS—my staff is my legacy," Tammy says.

With its fleet of GPS heavy equipment, RAMS' grading equipment has been key to the precision needed to complete work done on the Arena and the Froedtert & Medical College of Wisconsin Sports Science Center. RAMS was one of the first contractors on the site for excavation, demolition, and waste transportation. Project Manager, Todd Ormiston, comments, "Being on-site since June, RAMS has continued to work through winter to complete their tasks, including excavating footings, grading, and installation of a methane vapor barrier throughout the facility."

Tammy Ristow, President & CEO

Both Tammy and Todd reflect over the challenges as well as the successes of the Arena Project. "We are truly grateful to be working with a Construction Manager like Mortenson. The Mortenson team has foresight and strategic communication among trades on-site. We know what we are doing week-to-week, month-to-month. We know after the methane liner is down, concrete is coming in to continue the build. RAMS will return for the final grading for the sidewalks and landscaping." As a high-profile job, we see this as an opportunity for exposure and credibility of our work and really build upon our reputation," Tammy shares. Also, RAMS was the recipient of a 2016 Governor's Marketplace Outstanding Business Award.

Because of our success in winning multiple large projects simultaneously, Tammy shares, "Resources are always going to be what allows us to remain competitive. RAMS is successful because of its employees and the creation of an inclusive work environment. Our ability for a successful award, comes from the investment made in technology and our staff." "We may have competitors, but we are the competition," Tammy notes.



FITTING TOGETHER THE PIECES OF SUCCESS

Dairyland Energy Solutions, Inc.

"We've become a very, well-rounded company. We each bring our own expertise and experience into the business; and on this marquee project"



**Christopher Martinez, President
Dairyland Energy Solutions, Inc.**

In 1998, Chris Martinez, who also served as sole employee at its inception, founded Dairyland Energy Solutions as an electrical contracting firm. Over the first few years, Martinez was able to grow to a team of five. Honing in on its specialty of control wiring, Dairyland Energy Solutions provides industrial controls and building automation services.

About five years ago, Dairyland Energy Solutions expanded its offerings by adding a plumbing division. Today, just shy of its 20th year in business, Dairyland has grown to a team of 35 employees and has worked on some of the city's most quintessential projects. Martinez and his team have made a name for themselves in the industry by lending expertise on major additions to the city of Milwaukee's Miller Park Stadium and Wisconsin Center; and, now, Milwaukee's Northwestern Mutual Tower, and the Wisconsin Entertainment and Sports Center.

For the WESC, Dairyland Energy Solutions performs generator work, as well as the low voltage teledata installation. Despite

the incredible scale of this project, Martinez knows his team is up for whatever comes their way, "We've become a very, well-rounded company. We each bring our own expertise and experience into the business; and on this marquee project," he shares. Martinez hopes this opportunity showcases the talents and skills his firm brings to the job site for future work with the Bucks.

Martinez attributes his firm's success to the strong team and commitment to long-term development he's developed, "We've really developed a good rapport with one another within the organization. We keep a tight group of people; and once hired, we intend to keep the person long-term and work on developing the next leaders in their respective workforce; whether it be plumbing, automation, or electrical," says Chris. Dairyland Energy Solutions takes the time to cultivate future apprentices by providing guidance and support throughout the apprenticeship and beyond serving as mentors as team members become journey level employees.

"The growth of Dairyland Energy Solutions has only been possible due to the early investment in a strong professional team," says Martinez. Chris advises new business owners to "invest good money into your accountant, attorney, and insurance company. Don't worry about shaving costs when it comes to these professionals. You have to have everything in place before taking the next step."

PAINTING A NEW MILWAUKEE

Sanchez Painting Contractors, Inc.

"...Building a business is not a sprint, it's a marathon."



**Jose Sanchez Owner & President
Sanchez Painting Contractors, Inc.**

For Jose Sanchez, Founder and President of Sanchez Painting, the opportunity to grow a successful business has been a labor of love in the city he has always called home. The first generation from a family of immigrants, Jose grew up on the Southside of Milwaukee, becoming a graduate of the Milwaukee Public Schools system, and then MATC. Today, he prides himself on building a business that not only contributes to the expanding landscape of the city, but also creates careers for his 30 employees and their families.

Started in 1997, Sanchez Painting got its start with Jose as the sole employee primarily performing residential painting jobs. The firm soon found its niche, evolving to their current specialty of commercial painting. The team at Sanchez Painting has lent its expertise on numerous projects across Southeastern Wisconsin including the Iron Horse Hotel, St. Mary's Hospital, Marquette College of Engineering, Pabst Blue Ribbon Hotel, as well as multiple phases of the North End projects.

Of the experience to work on the 5th Street Parking Structure, Jose shares that he enjoyed the opportunity to work with Findorff. Responsible for painting stairwells, elevator shafts and lobbies, hallways, and more of the parking structure, the team successfully maintained the high quality work for

which they are known despite a demanding schedule and timeline. Their work on this project has already translated into additional jobs, fulfilling Jose's ultimate goal of continuing to create careers in the construction industry.

The long-term success and growth of Sanchez Painting can be attributed to Jose's commitment to a strong set of guiding principles, including "Don't spend what you don't have, don't buy what you don't need, and be patient. [Building a business] is not a sprint, it's a marathon." He has also found that being selective in the projects his firm undertakes allows them to deliver the most value and an overall superb customer experience. "We've maintained an impeccable reputation in the industry with ethical, quality-conscious construction practices. We're always looking for a way to save money without compromising the longevity of the project."

Jose is highly appreciative of the men and women he employees, acknowledging that without their hard work and dedication, he would not be where he is today. His will to take care of and assist others is not limited to those he employs. Jose also donates his time helping to build the next generation of business leaders, volunteering at the Multicultural Entrepreneurial Institute.

Lighting Landmarks on the Milwaukee Skyline

Hiram Power Electric, LLC



Left to right - George Trujillo, Vice President; Shady Sabbagh, Project Manager; and Hiram Croft, President.

Looking to offer another option for a minority-owned electric supply contractor business in the State of Wisconsin, Hiram E. Croft founded Hiram Power in 2005. Hiram Power began as a lighting distribution company and since that time, has morphed into a BIM, Purchase, Prefabrication and Professional Services company. Projects including Northwestern Mutual and the Fiserv Forum have made a major impact on Hiram Power, including an increase from three to forty-five employees in one year.

For the Fiserv Forum project, Hiram Power was tasked with a few roles including purchasing, project management and field installation. At the project's peak, 15 employees from Hiram Power worked on the arena, offering their trades expertise. The increase of employees isn't the only positive news to come from the work associated with this development project. Hiram Power has entered new relationships with mentors and partner companies with other firms working on the Fiserv Forum. In addition, Hiram Power has added new projects outside of the normal spectrum of SBE/DBE, further expanding the business' portfolio.

Hiram Power's tagline, "Imagine It", continues to be a part of the philosophy that guides both its work and company culture. The firm believes in providing exceptional service to exceptional customers, following the belief that whatever is important to the customer is important to Hiram Power.

*"Don't just provide a service to make money.
Provide a service to change an industry or make something better."*



Kanita Hunter – Journeyperson Laborer

In 2003, Kanita Hunter was a mother, a Certified Nursing Assistant and starving artist. She was looking for a career change that would not only allow her an opportunity to care for her family, but would also allow her a chance to work outside. She chose to become a Laborer with Local 113. This is working out for her because she loves being outdoors. “I have lost every inside job I’ve ever had.”

She is now in her thirteenth year working with the union. “The laborers contacted me first -- they were the first ones to try to put me to work and they have been straight with me ever since. So even though some other unions tried to contact me to join them, I decided to give my loyalty to the Laborers; they looked out for me first.”

RPP Certification has been helpful for her to gain and maintain employment. She was brought to this project immediately after completing work on another large project downtown. “It’s a shame that I wouldn’t be here if it weren’t for RPP. I never would have gotten the first call, and Mortenson never would have seen me working and learned what I can do.”

With what she earns, she is able to care for her family and have money left over to continue to pursue her dream of being an artist who is recognized by her peers for her work. “I’m hoping when we get done here Mr. Feigin will put one my paintings on his walls.”

Fiserv Forum: RPP Profile



Bryant Harris - Apprentice

A second opportunity isn’t always granted. Especially when referring to something worth having. Fortunately, Bryant Harris was given such an opportunity and he is making the most of it. In referring to the construction industry, first year Laborers’ apprentice Bryant Harris states, “They’ll run you off if you let ‘em.”

From 2007 – 2010 work as a construction tradesman in the greater Milwaukee area was hard to find. Bryant Harris had previously left an apprenticeship as an Electrician with IBEW 494 to become a Laborers’ apprentice with Local 113 when work industrywide became harder to get. It was during this period Bryant Harris decided to leave an apprenticeship he had put over two years into. He traded his hard hat for a position in factory work only to learn he hated it. “I was always inside; I like to be outside. That’s what I like about construction,” says Bryant.

Now Bryant is starting over. He is back in the first year of his Laborers’ apprenticeship. He is working for M.A. Mortenson Company, one of the largest builders in the country. “Now I’m here (working on the Milwaukee Bucks new arena). Working here will keep me on the big projects,” says Bryant.

Bryant may not be enjoying the success he has recently if not for the Residence Preference Program (RPP). Has the program helped him secure employment? “Definitely, a lot of times that’s the first thing they (employers) ask about.” He has used his certification to secure employment with high profile builders Payne and Dolan and has worked on large projects such as the Moderne Luxury Apartments.

On working on a project that is redeveloping the city. “I love it! I’m building a legacy for me. I can walk around down here and say I helped build this arena, and that hotel. I’m hoping my son can come do this too.” Bryant says it is easier now for him to pay his bills and save money. “I like not living paycheck to paycheck. it’s booming right now; the work will be strong for five to ten years.”

NEVER FORGET WHO YOU ARE

Antonio Delgado - RPP Apprentice Steamfitter - Grunau Company, Inc.



"There are no boundaries on what you can do"



"If I see a challenge, I find a way to do it," says 21-year-old Antonio Delgado. Three years ago, Antonio was working in a dead-end job that had no room for advancement, and decided to join the union as a steamfitter. He admires how supportive the union has been and that they focus on worker safety.

Getting into construction was physically demanding and intimidating for Antonio at first. "People said I couldn't do it, but look where I am now," he says. Antonio further states that everyone he works with is willing to teach him whatever it is that he wants to learn. "It gives me a sense of security to know that achieving completion of the apprenticeship program is possible," he says.

Antonio speaks passionately about the need for high schools to expose students to the construction field. "We're falling behind in getting the exposure out to the young people," he laments. When Antonio was growing up, he didn't see advertisements about being a part of the union, and thinks this is a shame. "People need to know the real facts about the opportunities that are out there," he says.

After completing his apprenticeship, Antonio is looking forward to teaching other workers what he has learned, running jobs of his own and even starting his own construction business. "The ability to move up [in construction] is undeniable," he notes. "[I]t is amazing to be a part of such a big project. We can't let our city fall apart; projects like this give me hope that we can revive Milwaukee." Antonio is very excited about the future, saying, "life is an equation; you have to find the [solution] that works, [and when you do], there's nothing stopping you from doing what you want to do."

THE DAILY GRIND LEADS TO SUCCESS

Elsol Zarate - Carpenter - Hunzinger Construction Company



"I am giving my kids something that I never had."

Sometimes the road to success takes several different turns, detours and stops. As we set down with Elsol Zarate a carpenter working on the Public Plaza, we got a glimpse of the different roads that he took to get to where he is today.

With stops on his life's journey he found himself as an employee in a foundry for some time, then a stop in a factory and he also shared time doing assembly work. We asked what made you choose the construction field? He said "I wanted to do something different and it was a better living plus I was intrigued by the daily grind".

Mr. Zarate performs carpentry and concrete form work that includes foundation and building lay outs on the Public Plaza. Everyday he starts at seven a.m. where he goes over his daily plans and makes sure everything is setup and ready for his shift.

Elsol says he chose carpentry because "projects like these are ran by carpenters." He further mentioned that when you are a well-versed carpenter, you get to meet different people in different trades. Elsol has been with Hunzinger Construction Company for about five years and certified as a RPP worker for ten years.

How do you think we could get more people like yourself involved in construction, into the apprenticeship programs or working on projects like this one? "Start them young, going to the high schools will make the most impact; marketing through the radio and social media." Elsol further stated, "everybody isn't made for college, I went to Milwaukee Tech High School, learned about the trades and knew this is what I wanted to do."

Being in the construction field has been all that Elsol Zarate has hoped for and more. Besides the long-lasting effects of working in the elements and the wear and tear on his body, the positives of earning an above average living with a great pension has afforded him the opportunity to own his home and have two vehicles (paid off) as well as putting two kids through private schools. "I'm giving my kids something that I didn't have" Elsol stated.

Mr. Zarate plans on retiring in the next ten years but right now he is excited about the redevelopment that is going on in the city of Milwaukee and is very happy to be apart of it.

THE CAREER PATH OF AN ELECTRICIAN

Robert Davenport - Staff Electric Co., Inc. - Electrician



“From Army to Circuits”

Sometimes the path to our careers are straight and other times they are like a long winding road. For Robert Davenport, a 17-year-old young man, started his career as a field generator worker for the Army Core of Engineers in 1977.

Robert earned his Associates Degree in air conditioning and refrigeration and got connected with the Milwaukee Bucks Arena project through a veteran’s resource center and has been working as an electrician for Staff Electric Co., Inc. since August 2017.

Being RPP (Resident Preference Program) certified has surely helped Robert get the opportunity to work on many projects in Milwaukee, however the Bucks project is the largest by far. It’s a “great program,” Robert said. He became RPP certified through WRTP-BIG STEP in July 2017.

When questioned about some of the reasons Robert chose to remain in the construction field, he stated, “it feels good waking up every morning knowing I love my job and knowing I have a steady paycheck coming.” Robert further mentioned that this field has given him great financial stability and has been a big change in his life since starting on his new career as an electrician.

End of Report.