



# Certificate of Appropriateness

Milwaukee Historic Preservation Commission/200 E. Wells Street/Milwaukee, WI 53202/phone 414-286-5712/fax 414-286-3004

<b>Property</b>	2017 N. TERRACE AV.	North Point South HD
<b>Description of work</b>	Front patio of bluestone deck and lannon knee walls per attached description and drawings	
<b>Date issued</b>	2/19/2020	PTS ID 114914 COA: front patio

In accordance with the provisions of Section 320-21 (11) and (12) of the Milwaukee Code of Ordinances, the Milwaukee Historic Preservation Commission has issued a certificate of appropriateness for the work listed above. The work was found to be consistent with preservation guidelines. The following conditions apply to this certificate of appropriateness:

N/A

All work must be done in a craftsman-like manner, and must be completed within one year of the date this certificate was issued. Staff must approve any changes or additions to this certificate before work begins. Work that is not completed in accordance with this certificate may be subject to correction orders or citations. If you require technical assistance, please contact Historic Preservation staff as follows: Phone: (414) 286-5712 E-mail: hpc@milwaukee.gov.

If permits are required, you are responsible for obtaining them from the Milwaukee Development Center. If you have questions about permit requirements, please consult the Development Center's web site, [www.milwaukee.gov/build](http://www.milwaukee.gov/build), or call (414) 286-8210.

City of Milwaukee Historic Preservation Staff

Copies to: Development Center, Ald. Nik Kovac, Contractor , Inspector Paul Wolfgramm (286-2590)

**Patio at the front of the house...**

**Dimensions not larger than 8' 6" x 14' 6" surrounded by a seat wall. Height of the wall will be approximately 24" with a 1 1/2" cap on top. Material for wall will be lannon stone that will match the back patio. There will be 4 rows of blocks that are 6" tall and 10" wide with varying lengths and bapped with bluestone. (see attached drawing)**

**Patio material will be blue stone pavers as previously approved to match back patio installed in Pattern A (attached)**

**Lannon wall will surround patio and will be set just past current front bumpout (will end up near window on left side and about 14" from window and right side.)**

**Design will be almost identical to the approved back patio.**



Area around front door will be modified.

OTZKO  
2017 N. TERRACE  
FRONT PATIO

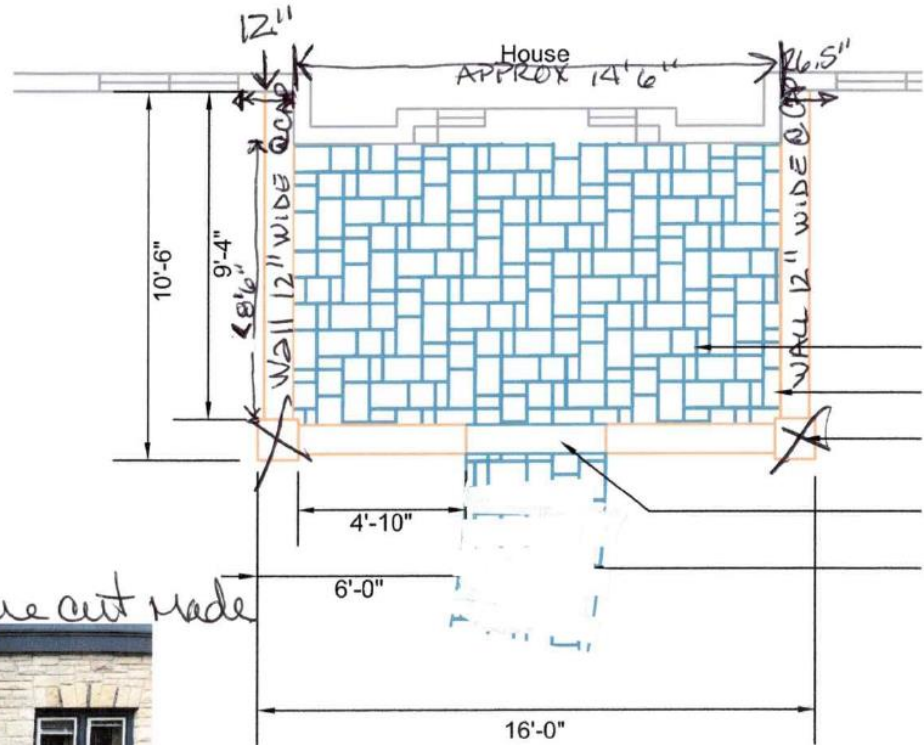

there might be some paver for sidewalk depending where cut made



- ⇒ Wall height approx 24" w/ 1 1/2" cap
- ⇒ Will NOT BE DOING TALLER CORNERS
- ⇒ ACTUAL PATIO NOT LARGER THAN 8'6" x 14'6"

Pattern for bluestone decking.

Pattern "A" 100 SQ. FT.

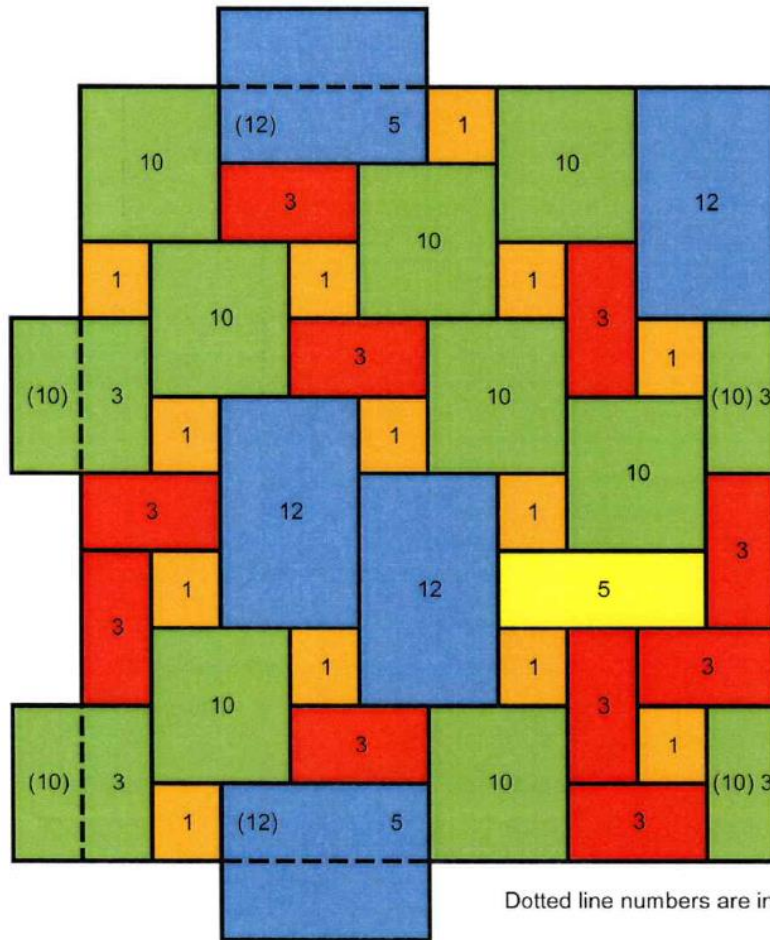

Size Schedule

No.	Size	Pcs.
1	12x12	13
3	12x24	10
5	12x36	1
10	24x24	10
12	24x36	4

Dotted line numbers are in ( )