



CITY OF MILWAUKEE
OFFICE OF THE CITY CLERK

Monday, June 28, 2021

COMMITTEE MEETING NOTICE

AD 13

ALI, Nawazish, Agent
National 4 Oil, LLC
5344 W Behrendt St

Franklin, WI 53132

You are requested to attend a virtual hearing to be held on:

Tuesday, July 13, 2021 at 09:20 AM

Regarding: Your Filling Station, Food Dealer, and Weights & Measures License Applications as agent for "National 4 Oil, LLC" for "BP" at 3725 S Howell Av.

This meeting will be held via GoToMeeting. Please see the e^goed best practices document for further instructions. The access code is <https://global.gotomeeting.com/join/175284253>. If you wish to call in, please call +1 (571) 317-3122 and use Access Code: 175-284-253.

There is a possibility that your application may be denied for one or more of the following reasons: The recommendation of the committee regarding the application shall be based on evidence presented at the hearing. Per MCO 85-2.7-4, probative evidence concerning whether or not a new license should be granted may be presented on the following subjects: whether or not the applicant meets the municipal requirements, the appropriateness of the location and premises where the licensed premises is to be located and whether use of the premises for the purposes or activities permitted by the license would tend to facilitate a public or private nuisance or create undesirable neighborhood problems such as disorderly patrons, unreasonably loud noise, litter, and excessive traffic and parking congestion. Probative evidence relating to these matters may be taken from the plan of operation submitted with the license application, if any, but shall not include the content of any music. Evidence regarding the fitness of the location of the premises to be maintained as the principal place of business, including but not limited to whether there is an overconcentration of businesses of the type for which the license is sought; whether the proposal is consistent with any pertinent neighborhood business or development plans, or the location's proximity to areas where children are typically present. The applicant's record in operating similarly licensed premises; and whether or not the applicant has been charged with or convicted of any felony, misdemeanor, municipal offense or other offense, the circumstances of which substantially relate to the activity to be permitted by the license being applied for or any other factor which reasonably relates to the public health, safety or welfare may also be considered. See attached police report or correspondence.

Notice for applicants with warrants or unpaid fines: Proof of warrant satisfaction or payment of fines must be submitted at the hearing on the above date and time. Failure to comply with this requirement may result in a delay of the granting/denial of your application.

Failure to attend this meeting may result in the denial of your license. Individual applicants and partnership applicants must attend or attend by an attorney. The agent or attorney for corporate or limited liability applicants must attend. If you wish to do so and at your own expense, you may be accompanied by an attorney of your choosing to represent you at this hearing.

You will be given an opportunity to speak on behalf of the application and to respond and challenge any charges or reasons given for the denial. No petitions can be accepted by the committee, unless the people who signed the petition attend the virtual hearing and are willing to testify. You may present witnesses under oath and you may also confront and cross-examine opposing witnesses under oath. If you have difficulty with the English language, you should request an interpreter attend the meeting with you, at your expense, so that you can answer questions and participate in your hearing.

PLEASE NOTE: Upon reasonable notice, efforts will be made to accommodate the needs of disabled individuals through sign language interpreters or other auxiliary aids. For additional information or to request this service, contact the Council Services Division ADA Coordinator at (414) 286-2998, Fax - (414) 286-3456, TDD - (414) 286-2025.

JIM OWCZARSKI, CITY CLERK

BY: _____

Jim Cooney

License Division Manager

If you have questions regarding this meeting, please contact the staff assistant, Molly Kuether-Steele at (414) 286-2775 or molly.kuether-steele@milwaukee.gov.

200 E. Wells Street, Room 105, City Hall, Milwaukee, WI 53202. www.milwaukee.gov/license
Phone: (414) 286-2238 Fax: (414) 286-3057 Email Address: License@milwaukee.gov

Cooney, Jim

From: Cooney, Jim
Sent: Sunday, June 27, 2021 10:25 AM
To: Becker, Keren
Cc: Martin, Faviola; Byrd, Yashica
Subject: FW: Objection to Filling Station and Food Dealer

Please add

REDACTED RECORD

From: Dimitrijevic, Marina <Marina@milwaukee.gov>
Sent: Saturday, June 26, 2021 10:04 PM

1
Cc: License <LICENSE@milwaukee.gov>; Williams, Terri <Terri.Williams@milwaukee.gov>; Cooney, Jim <Jim.Cooney@milwaukee.gov>
Subject: Re: Objection to Filling Station and Food Dealer

Thank you for sending in your thoughts on license renewal. We have also sent them to licensing to be registered.

~Marina

You may use our Click for Action online system to report city service requests: https://iframe.publicstuff.com/#?client_id=1000167

Sign up for my Aldermanic District 14 monthly e-newsletter and other updates at <https://city.milwaukee.gov/enotify>

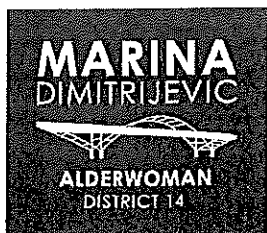

Marina Dimitrijevic
Alderwoman | 14th District

She/Her/Hers

p: (414) 286-3769
e: marina@milwaukee.gov

200 E Wells Street, Room 205
Milwaukee, WI 53202

milwaukee.gov/district14

On Jun 25, 2021, at 2:59 PM,

_____ wrote:

To whom it may concern,

I received a notice that the gas station _____ has applied for a new filling station and food dealer – retail convenience store license in the city of Milwaukee. Applicant name is Nawazish Ali, Agt National 4 Oil, LLC, business name BP.

I do not want this gas station in my neighborhood any longer. They are repeatedly robbed at gun point. I do not want criminals, who carry guns and commit crimes in my neighborhood, and if it weren't for this gas station, they would not be here.

Also, the station constantly has cars pulling away at top speed and peeling their tires when they leave the station. There are many children in the neighborhood, and the abundance of these cars is a nuisance and is dangerous to the safety of the local residents.

And it never fails, at least two or three times a summer, there will be a loud, heated exchange or fight between patrons at the gas station. Again, all 3 of these things would not exist if the gas station were not there in the first place.

Please do not allow the renewal or approval of this license.

I can be contacted at _____ e are any questions.

Thank You,

REDACTED RECORD

<image001.jpg>

<image002.png>

Please view the brief video link below that showcases Morgan Stanley's online services and more. Stay informed about your investments and manage your everyday finances.

[Morgan Stanley Online and Mobile Video](#)

If you would like to unsubscribe from marketing e-mails from Morgan Stanley Wealth Management, you may do so [here](#). Please note, you will still receive service e-mails from Morgan Stanley Wealth Management.



Monday, June 28, 2021



Notice of Public Hearing

blank
notice

ALI, Nawazish, Agent
BP at 3725 S Howell Av
Filling Station, Food Dealer, and Weights & Measures License Applications

Tuesday, July 13, 2021 at 9:20 AM

To whom it may concern:

The above application has been made by the above named applicant(s). This requires approval from the Licenses Committee and the Common Council of the City of Milwaukee. The hearing before the Licenses Committee will take place virtually on 7/13/2021 at 9:20 AM. This is a public hearing. Those wishing to view the proceeding are able to do so via the City Channel – Channel 25 on Spectrum Cable – or on the Internet at <http://city.milwaukee.gov/citychannel>. Those wishing to provide oral testimony will be asked to do so by phone or internet and are asked to contact the staff assistant, Molly Kuether-Steele at (414) 286-2775 or molly.kuether-steele@milwaukee.gov for necessary information. Please make such requests no later than one business day prior to the start of the meeting. You are not required to attend the hearing, but please see the information below if you would like to provide testimony. Once the Licenses Committee makes its recommendation, this recommendation is forwarded to the full Common Council for approval at its next regularly scheduled hearing.

Important details for those wishing to provide information for the Licenses Committee to consider when making its recommendation:

1. The license application is scheduled to be heard at the above time. Due to other hearings running longer than scheduled, you may have to wait some time to provide your testimony.
2. You must testify as to matters that you have personally experienced or seen. (You cannot provide testimony for your neighbor, parent or anyone else; this is considered hearsay and cannot be considered by the committee.)
3. No letters or petitions can be accepted by the committee (unless the person who wrote the letter or the persons who signed the petition are willing to testify).
4. Persons opposed to the license application are given the opportunity to testify first; supporters may testify after the opponents have finished.
5. When you are called to testify, you will be sworn in and asked to give your name, and address. (If your first and/or last names are uncommon please spell them.)
6. You may then provide testimony.
 - a. Include only information relating to the above license application.
 - b. Include only information you have personally witnessed or seen.
 - c. Provide concise and relevant information detailing how this business has affected or may affect the peaceful enjoyment of your neighborhood.
 - d. If by the time you have the opportunity to testify, the information you wish to share has already been provided to the committee, you may state that you agree with the previous testimony. Redundant or repetitive testimony will not assist the committee in making its recommendation.
7. After giving your testimony, the members of the Licenses Committee and the licensee may ask questions regarding the testimony you have given or other factors relating to the license application.
8. Business Competition is not a valid basis for denial or non-renewal of a license.

Please Note: If you have submitted an objection to the above application your objection cannot be considered by the committee unless you personally testify at the hearing.

OCCUPANT	MAIL ADDRESS	CITY STATE ZIP
CURRENT OCCUPANT	103 W SAVELAND AVE	MILWAUKEE, WI 53207-3842
CURRENT OCCUPANT	115 E BRADLEY AVE	MILWAUKEE, WI 53207-3960
CURRENT OCCUPANT	115 W SAVELAND AVE	MILWAUKEE, WI 53207-3842
CURRENT OCCUPANT	118 W CRAWFORD AVE	MILWAUKEE, WI 53207-3831
CURRENT OCCUPANT	118 W CRAWFORD AVE, A	MILWAUKEE, WI 53207-3831
CURRENT OCCUPANT	121 W SAVELAND AVE	MILWAUKEE, WI 53207-3842
CURRENT OCCUPANT	124 W SAVELAND AVE	MILWAUKEE, WI 53207-3843
CURRENT OCCUPANT	125 W WILBUR AVE	MILWAUKEE, WI 53207-3227
CURRENT OCCUPANT	126 W CRAWFORD AVE	MILWAUKEE, WI 53207-3831
CURRENT OCCUPANT	128 W CRAWFORD AVE	MILWAUKEE, WI 53207-3831
CURRENT OCCUPANT	130 W SAVELAND AVE	MILWAUKEE, WI 53207-3843
CURRENT OCCUPANT	140 W SAVELAND AVE	MILWAUKEE, WI 53207-3872
CURRENT OCCUPANT	3676 S 1ST ST	MILWAUKEE, WI 53207-3215
CURRENT OCCUPANT	3676 S HOWELL AVE	MILWAUKEE, WI 53207-3360
CURRENT OCCUPANT	3680A S HOWELL AVE	MILWAUKEE, WI 53207-3360
CURRENT OCCUPANT	3686 S 1ST ST	MILWAUKEE, WI 53207-3215
CURRENT OCCUPANT	3696 S 1ST ST	MILWAUKEE, WI 53207-3215
CURRENT OCCUPANT	3704 S HOWELL AVE	MILWAUKEE, WI 53207-3839
CURRENT OCCUPANT	3704A S HOWELL AVE	MILWAUKEE, WI 53207-3839
CURRENT OCCUPANT	3710 S HOWELL AVE	MILWAUKEE, WI 53207-3839
CURRENT OCCUPANT	3714 S 1ST ST	MILWAUKEE, WI 53207-3823
CURRENT OCCUPANT	3716 S 1ST ST	MILWAUKEE, WI 53207-3823
CURRENT OCCUPANT	3716 S HOWELL AVE	MILWAUKEE, WI 53207-3839
CURRENT OCCUPANT	3723 S 1ST ST	MILWAUKEE, WI 53207-3822
CURRENT OCCUPANT	3723A S 1ST ST	MILWAUKEE, WI 53207-3822
CURRENT OCCUPANT	3724 S HOWELL AVE	MILWAUKEE, WI 53207-3839
CURRENT OCCUPANT	3724A S HOWELL AVE	MILWAUKEE, WI 53207-3839
CURRENT OCCUPANT	3736 S HOWELL AVE	MILWAUKEE, WI 53207-3839
CURRENT OCCUPANT	3744 S HOWELL AVE, 1	MILWAUKEE, WI 53207-3839
CURRENT OCCUPANT	3744 S HOWELL AVE, 2	MILWAUKEE, WI 53207-3839
CURRENT OCCUPANT	3744 S HOWELL AVE, 3	MILWAUKEE, WI 53207-3839
CURRENT OCCUPANT	3744 S HOWELL AVE, 4	MILWAUKEE, WI 53207-3839
CURRENT OCCUPANT	3749 S 1ST ST	MILWAUKEE, WI 53207-3860
CURRENT OCCUPANT	3750 S HOWELL AVE	MILWAUKEE, WI 53207-3839
CURRENT OCCUPANT	3757A S HOWELL AVE	MILWAUKEE, WI 53207-3870
CURRENT OCCUPANT	3758 S HOWELL AVE	MILWAUKEE, WI 53207-3839
CURRENT OCCUPANT	3768 S HOWELL AVE, 1	MILWAUKEE, WI 53207-3839
CURRENT OCCUPANT	3768 S HOWELL AVE, 2	MILWAUKEE, WI 53207-3839
CURRENT OCCUPANT	3768 S HOWELL AVE, 3	MILWAUKEE, WI 53207-3839
CURRENT OCCUPANT	3768 S HOWELL AVE, 4	MILWAUKEE, WI 53207-3839
CURRENT OCCUPANT	3768 S HOWELL AVE, 5	MILWAUKEE, WI 53207-3839
CURRENT OCCUPANT	3768 S HOWELL AVE, 6	MILWAUKEE, WI 53207-3839
CURRENT OCCUPANT	3769 S HOWELL AVE	MILWAUKEE, WI 53207-3870
CURRENT OCCUPANT	3769A S HOWELL AVE	MILWAUKEE, WI 53207-3870
blank	notice	

Total Records: 44

Radius: 250.0 feet and Center of Circle: 3725 S Howell Ave



BUSINESS LICENSE PLAN OF OPERATION

ref: busplan 5/1/2019

Office of the City Clerk License Division
200 E. Wells St. Room 105 Milwaukee, WI 53201
(414) 286-2300 www.milwaukee.gov/bizlic

1. Type of Business

- Applying for: Extended Hours (11PM to 5AM) for food establishment, child care center, or bar/night club. Drive Thru Open
- Self Service Laundry Massage Establishment Street Vending
- Other (supplemental application for specific license is required)

Provide a detailed description of the type of business you plan on operating: Gas Station with Car Wash & Store

Do you have any experience operating this type of business? No Yes. If yes, list your business: Convenience Store in Gas Station

2. Business Operations

- a. Proposed Opening Date: 07/01/2020
- b. Is this premise under construction? No Yes. If yes, list estimated completion date: _____
- c. Is this a franchise? No Yes
- d. Is this premises currently licensed? No Yes. If yes, list type of license: Building License with Car Wash
- e. Is the current license operating? No Yes. If no, list date closed: _____
- f. Do you have future plans for other buildings, licenses or permits at this location? No Yes. If yes, explain: _____
- g. Have you previously held an Extended Hours License in Milwaukee? No Yes. If yes, list address(es): _____
- h. Are other businesses operating in the same building? No Yes. If yes, list address(es): _____

3. Litter & Noise

- a. How are grounds kept clean? Sweep Pressure Wash Pick Up Litter Other: _____
- b. How often will grounds be cleaned? Daily Weekly As Needed Monthly Other: _____
- c. Grounds cleaned by: Licenses Building Owner Employees Street Sweeper Other: _____
- d. How are noise issues prevented and/or addressed? Sound by Business operations (equipment) Loud Music Signs Posted Other: _____
- e. Will a sound amplification system be used? No Yes. If yes, describe: _____

4. Smoking & Sanitation

- a. Are there designated outdoor smoking areas? No Yes. If yes, describe: _____
- b. Number of Garbage Cans: Inside: 4 Location: Customer Counter/Back of Building
- Outside: 2 Location: By Gas Pump and Fuel Line
- c. Is a crowd control barrier used? No Yes. If yes, describe: _____
- d. How many restrooms are on the premises? 2
- e. Name of solid waste contractor: Green of Disposal City of Milwaukee

5. Security

- a. Are there onsite parking spaces? No Yes. If yes, how many? _____ and describe the parking area in detail.
 plan: Security Camera
- b. Is there a loading zone? No Yes. If yes, describe the loading area in detail. _____
- c. Will you have security personnel on premises? No Yes. If yes, how many? _____ and answer the following:
 What are their responsibilities? _____
 Is security equipment used? No Yes. If yes, describe _____
 List their licensing, certification, or training credentials. _____
- d. Will there be security cameras? No Yes. If yes, how many? _____ and describe them. Cash Register
 _____? inside the store, and Gas Pumps
- e. Will searches/identification checks be done upon entry? No Yes. If yes, describe _____

6. Percentage of Sales (must total 100%)

Alcohol _____ %	Food _____ %	Merchandise/Non-alcoholic _____ %	Previous M.I.B. Cases _____
Entertainment _____ %	Cigarettes _____ %	_____	_____
Bar/Beverage Activity _____ %	Salvaged Materials _____ %	_____	Other <u>60</u>
_____	_____	_____	Decrease <u>30 M.I.B. Cases</u>

7. Businesses/Licenses on the Premises (check all that apply)

- Type 1
- Full Service Restaurant Cash/Convenience Store Deli or Hot Food Restaurant Mobile Food Stand/Vendor
- Night Club Tavern Concessions Stand _____
- Banquet Hall Sports Facility Bowling Alley
- Home/Motel: Number of Floors _____ Number of Rooms _____
 Number of Rooms _____ Number of Rooms _____

- Type 2
- Liquor Store Grocery Store Supermarket Food Service Store
- Gas Station Amusement/Photograph Developer _____
- Used Car Dealer Dry Cleaning/Alterations Establishment _____

What other licenses/permits will you hold at the location (check as they apply)

- Occupancy Permit Cigarette & Tobacco Gas Station _____ _____ Weights & Measures
- Secondhand Dealer Previous M.I.B. Cases Other _____

8. Legal Capacity (only if a Type 1 premises in #7 above)

Capacity _____ (Call the following: Dev. Dept. and Dept. of Health _____)

9. Premises Description

- a. Identify all area(s) of the premises that will be used in operating this business (include areas for sales or storage):
 1st Floor 2nd Floor Basement/Storage Patio Door/Screened Deck Rooftop
 Other: Describe _____
- b. Describe Location: Major Thoroughfare Secondary Street Other Savin Ave
- c. Nearest Major Cross Street: Howard Ave
- d. Describe Building: Free Standing Building Shop/Mall Other _____
- e. Describe Premises Structure: Single Story Multi-Story Multi-Levels Other _____
- f. Describe Surrounding Area: Commercial Residential Industrial Other _____
- g. Building Owner Name: Nawazish Ali Phone Number: 702-383-1315
 Building Owner Address: 5344 West Behrendt Street Las Vegas NV 89132

10. Hours of Operation & Customers

Will customers be entering the premises? No Yes

Day of the Week	Proposed Hours of Operation:		Estimated Number of Customers expected each day	Potential Age Range of Customers	Class B Tavern Applicant Only Age Restrictions (If none, write "None")
	Open Time (include a.m. or p.m.)	Close Time (include a.m. or p.m.)			
Sunday	5AM	12Am 12:00 AM	100	20-40	
Monday	5AM	12Am 12:00 AM	100	20-40	
Tuesday	5AM	12Am 12:00 AM	100	20-40	
Wednesday	5AM	12Am 12:00 AM	100	20-40	
Thursday	5AM	12Am 12:00 AM	100	20-40	
Friday	5AM	12Am 12:00 AM	100	20-40	
Saturday	5AM	12Am 12:00 AM	300	30-40	

An Extended Hours Establishment License is required for any convenience store, filling station, or any other establishment (such as tavern, body piercing, salon, toilet, tanning, etc.) recording studio or restaurant which is open between the hours of 12 a.m. and 5:00 a.m.

Alcohol Establishments Class A: 8:00 am to 9:00 pm Sunday thru Friday
 Permitted Hours of Operation: Class B: 6:00 am to 2:00 am Sunday thru Friday 10:00 am to 2:00 am Saturday & Sunday
 Entertainment Outdoor Closing Hours: 10:00pm Sunday-Thursday, 12:00am Friday & Saturday (unless a different time is established by the Commission, which it may do in a plan of operation)

11. Signature(s)

Nawazish Ali

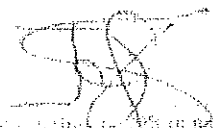

Signature of Sole Proprietor, Partner, or 20% or more shareholder (if there are no 20% or more shareholders, Corporate Officer, print name/title and sign)

Signature of Applicant, print name/title and sign



FOOD DEALER LICENSE PLAN OF OPERATION

ccl-foodplan 2/28/19

OFFICE OF THE CITY CLERK, LICENSE DIVISION
CITY HALL, 200 E. WELLS ST, ROOM 105, MILWAUKEE, WI 53202
(414) 286-2238 • license@milwaukee.gov • www.milwaukee.gov/license

Legal Entity Name: **NATIONAL 4 OIL LLC**

Premises Address: **3725 SOUTH HOWELL AVE MILWAUKEE, WI 53207**

SECTION 1 TYPE OF BUSINESS

What will be the majority of your food sales? (check one)

Restaurant Items (meals):

MEALS include, but are not limited to, chicken, ribs, sandwiches, roasted corn, baked potatoes, hot dogs, brats, tacos, nachos w/ cheese and meat, French fries, cooked or deep fried vegetables/fruit, cooked cheese curds, corn dogs, egg rolls, salads.

Retail Items (snacks and beverages):

RETAIL items include, but are not limited to, ice cream/soft serve, lemonade, snow cones, coffee, espresso, cappuccino, tea, fruit juice, smoothies, candy, dispensed soda, fruit cups, bakery, cookies, kettle corn, cotton candy, funnel cakes, fritters, tortilla chips w/ cheese.

Will it be a convenience store? Yes No

A convenience store contains less than 5,000 square feet of retail space and has, as its primary business, the sale of basic food items and in addition, sells household products or is a filling station that sells basic food items and household products.

Bed & Breakfast

Micro Market

All Applicants: Submit a menu or a list of food items that will be sold.

Will any wholesale business be done? No Yes If yes, what percentage of food sales will be wholesale?

Less than 25%

25% or More AND:

Restaurant items (meals) will be sold – Complete this application and also contact DATCP.

NO restaurant items (meals) will be sold - Do NOT complete this application. Contact DATCP only.

SECTION 2 FOOD PROCESSING

Will any food processing be done? No Yes

Processing is defined as assembling, grinding, cutting, mixing, baking, coating, stuffing, packing, bottling, grilling, canning, extracting, fermenting, distilling, pickling, freezing, drying, smoking, or packaging.

SECTION 3 FOOD REQUIRING TEMPERATURE CONTROL

Will any food that requires temperature control be sold? No Yes

(includes dairy products such as milk, cheese, and ice cream, fish, shellfish, meat, poultry)

If yes, list the types of food items: **FROZEN MEALS, MILK, ICE CREAM, EGGS, MEAT**

SECTION 4 DETAILS OF OPERATION

- Will you have seating on site for dining? No Yes
- Will you be doing any catering? No Yes
- Will you be doing any delivery? No Yes
- Will you have outdoor activities? No Yes - Check all that apply: Bar Cooking/Grilling Dining
- Will you have a drive thru window? No Yes - Are hours different from inside? No Yes
- If Yes, provide drive thru hours: _____
- Will scales or barcode scanners be used? No Yes - You must also apply for a Weights & Measures License.

SECTION 5 ADDITIONAL SITES

Where will food be prepared and/or sold?

At a single site At multiple sites: How many? _____ (for example, a hotel with several dining rooms or bars)

If multiple sites, attach a Food Dealer Additional Site Addendum (ccl-foodadd) for each additional site.

SECTION 6 CONSTRUCTION OR CHANGES

Are you planning any construction, remodeling or equipment changes?

No If No, SKIP to Section 8

Yes If Yes, check all that apply: New construction of a building Renovation or remodeling

Construction changes to existing building Equipment changes only

Provide a brief description of the changes: _____

Start date: _____

Name, Address & Phone Number of Architect: _____

Name, Address & Phone Number of Contractor: _____

SECTION 7 ALCOHOL BEVERAGES

Are you applying for an alcohol beverage license?

No If No, SKIP to Section 8

Yes If YES, if your food license is approved prior to the alcohol license, when do you want the food license issued?

Immediately At the same time as the alcohol license

SECTION 8 ACKNOWLEDGEMENTS & SIGNATURE

You must initial each item confirming your understanding:

N.A. I understand the Health Department must conduct an inspection and advise the License Division of their approval before the license may be issued.

N.A. I understand I must obtain an occupancy permit from the Department of Neighborhood Services and an inspection may be required. Neighborhood Services must advise the License Division of their approval before the license may be issued.

N.A. I understand the district alderperson will review and either support or object to my application. If he/she objects, I may appeal and be scheduled to appear before the Licenses Committee. The Licenses Committee will then make a recommendation to the Common Council. The Common Council must grant the license before it may be issued.

N.A. I understand proof of payment for all license fees must be on file in the License Division before the license may be issued and the license must be issued and posted in my establishment prior to opening for business.

N.A. I will not operate my food business until the license has been issued and posted in the establishment.

Signature of Sole Proprietor, Partner, or 20% Shareholder: P. Waz AC

Signature of Additional Partner: _____



**FILLING STATION LICENSE AND
WEIGHTS & MEASURES (RETAIL PETROLEUM METERS)
LICENSE SUPPLEMENTAL APPLICATION**

OFFICE OF THE CITY CLERK, LICENSE DIVISION
CITY HALL, 200 E. WELLS ST, ROOM 105, MILWAUKEE, WI 53202
(414) 286-2238 • licensing@cityclerk.wisconsin.gov • www.milwaukee.gov

Legal Entity Name: NATIONAL 4 OIL LLC

Premise Address: 3725 SOUTH HOWELL AVE MILWAUKEE WI 53207

Filling Station License Fee \$ 275

Weights & Measures License Fee
Number of Retail Petroleum Meters* 8 x \$60 per meter = \$ 480

* For each nozzle, count the number of grades (not including midgrade if mixed in the pump), add the number of all grades together and that is your number of retail petroleum meters.

Will electronic scanners be used to determine/record the price of items? No Yes

Will scales be used to price items based on their weight? No Yes

If yes to either or both questions, a separate Weights & Measures License Application must be submitted for these devices.

Acknowledgements and Signature

I confirm that all information is true and correct. I understand any changes to the information in this application must be reported to the City Clerk License Division within 10 days. I have knowledge of the City of Milwaukee ordinances currently regulating the licenses applied for and understand that the licenses may be subject to suspension, non-renewal, or revocation if I violate these regulations.

Pawel Re.
Signature of Sole Proprietor, Partner, 20% or more Shareholder
(If no 20% or more Shareholder, Corporate Officer must sign and provide title)

[Signature]
Signature of Additional Partner or 20% or more Shareholder

- Submit this form with the following:
- Business License Application
 - Business Plan of Operation
 - Floor plan
 - License fees
- Forms can be obtained online at www.milwaukee.gov/licenses

Office Use Only:

App# _____	Filed _____	Initials _____
Paid _____	MPD _____	CC _____
HD _____	DNS _____	Lic # _____

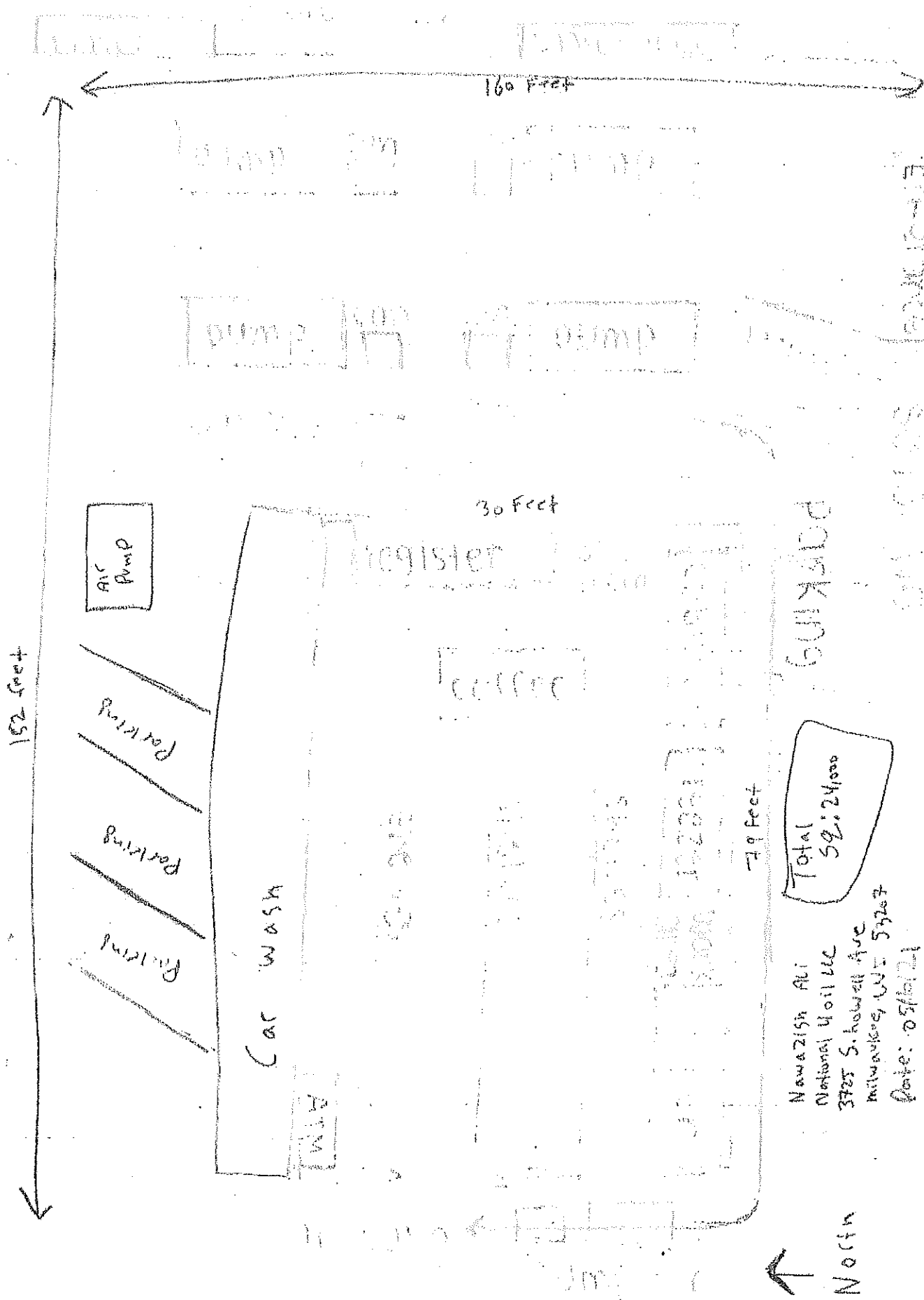

Total
\$9,240,000

12/10/50: 1000
Date: 08/10/21
3725 S. Kolmer Ave
Millwaukee, WI 53228
National Mail LLC
Newark, NJ

[Handwritten signature]