



Certificate of Appropriateness

Milwaukee Historic Preservation Commission/841 N Broadway/Milwaukee, WI 53202/phone 414-286-5722

Property Description of work

1921 N. 2nd Street, Brewers Hill Historic District

Replace existing primary, second story porch, and both front storm doors with the Simpson doors provided below.

Date issued 7/10/2023

In accordance with the provisions of Section 320-21 (11) and (12) of the Milwaukee Code of Ordinances, the Milwaukee Historic Preservation Commission has issued a certificate of appropriateness for the work listed above. The work was found to be consistent with preservation guidelines. The following conditions apply to this certificate of appropriateness:

All finish wood must be smooth and free of knots and must be painted or treated with an opaque stain upon completion. Note: when new, bare wood is left exposed to the exterior elements for a period of only a week or two, the life the of the paint job subsequently applied to it will be decreased. The use of a decay-resistant wood for is required for porch areas. Using western white pine or Ponderosa pine is "at your own risk" because this wood has no natural decay resistance and can deteriorate in some exterior settings in just a few years.

All work must be done in a craftsman-like manner, and must be completed within one year of the date this certificate was issued. Staff must approve any changes or additions to this certificate before work begins. Work that is not completed in accordance with this certificate may be subject to correction orders or citations. If you require technical assistance, please contact Historic Preservation staff as follows: Phone: (414) 286-5722 E-mail: hpc@milwaukee.gov.

If permits are required, you are responsible for obtaining them from the Milwaukee Development Center. If you have questions about permit requirements, please consult the Development Center's web site, www.milwaukee.gov/lms, or call (414) 286-8210.

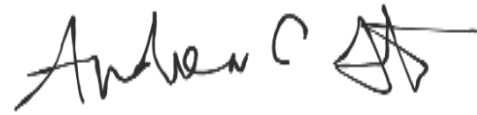
A handwritten signature in black ink, appearing to read "Andrew C. Coggs". The signature is written in a cursive style with a large, stylized initial "A".

City of Milwaukee Historic Preservation

Copies to: Development Center, Ald. Coggs

As shown, from Interior. Glazing is a general representation

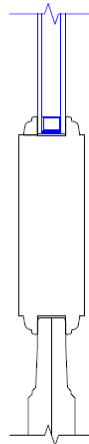
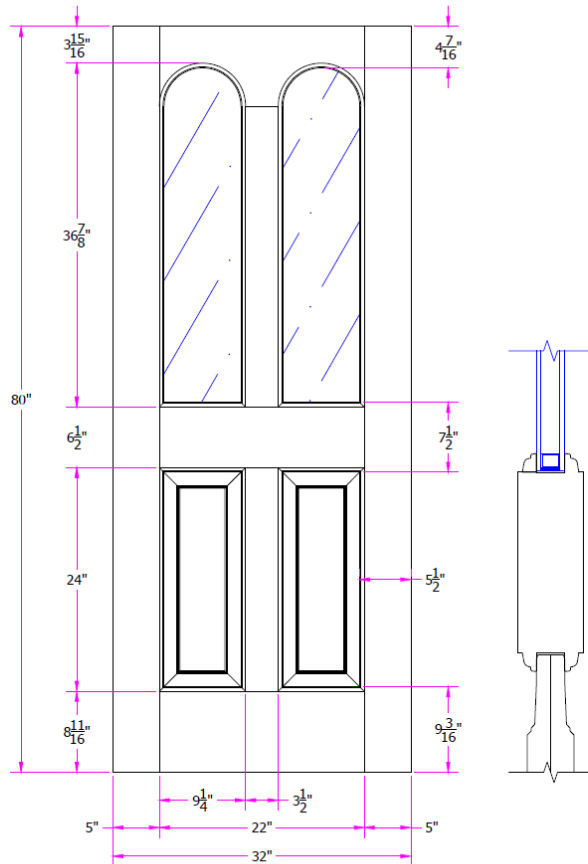

THIS DRAWING AND THE INFORMATION CONTAINED HEREIN IS PROPRIETARY TO SIMPSON DOOR COMPANY AND SHALL NOT BE REPRODUCED, COPIED OR DISCLOSED IN WHOLE OR PART, OR USED FOR MANUFACTURE OR FOR ANY OTHER PURPOSE WITHOUT THE WRITTEN PERMISSION OF SIMPSON DOOR COMPANY.

NOTE: It is your responsibility to proof all specifications and details of this drawing. Any questions or concerns regarding the drawing must be communicated to Simpson Door Company prior to your approval. Any changes to this drawing may effect price and lead time. Signed off orders may not be canceled and any changes must be approved by Simpson Door Company for viability of design or ability for modification.

Customer Approvals: Printed Name: Signature: Date:

Quote#	585584	ID#	585584
TITLE	7042 2/8 x 6/8 Quote Layout		
DRAWING NO:	ID-585584		
LAYOUT	CSTM		
DRAWN BY:	J. Swigert	DATE	06/20/2023



Order# / Line Item :



P - Unnamed Quote

Ryan Mastenbrook
Western Building Products

QUOTE #: P3911787-100-1
QUOTE VALID THROUGH: 7/24/2023

2044 Traditional

SERIES: Traditional Exterior Doors
DOOR DESIGN: 2044
QUANTITY: 1

DOOR SPECIFICATIONS

SPECIES: Fir
WOOD GRADE: Select
WIDTH: 2-6"
HEIGHT: 6-8"
THICKNESS: 1 3/4"
STILE WIDTH: 5-1/2"
PROFILE: Ovolo Sticking
PANEL: 3/4" DHRP
ADDITIONAL OPTIONS:
Cartoned

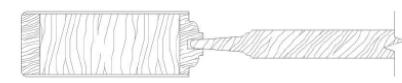
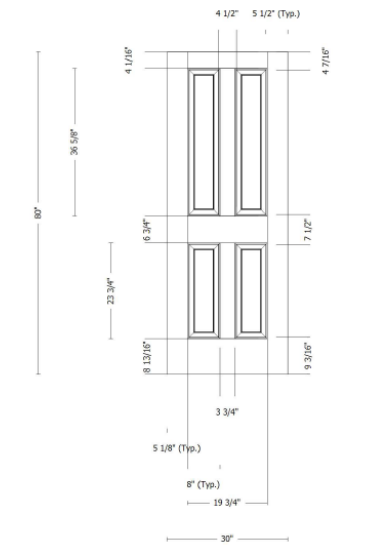

1st floor (left) and 2nd floor patio (right) replacement doors

Approved

Doors



Storm and screen door styles, 1860-1940

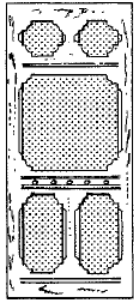

Victorian Gothic,
Queen Anne
1870-1890

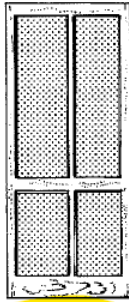

All Styles
1860-1920

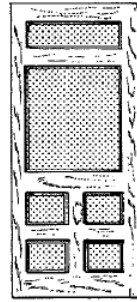

Queen Anne
1885-1905

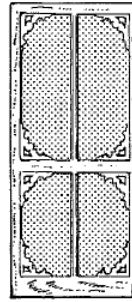

Queen Anne
1885-1905

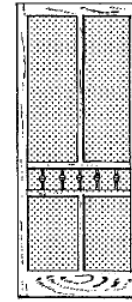

Queen Anne
1885-1905

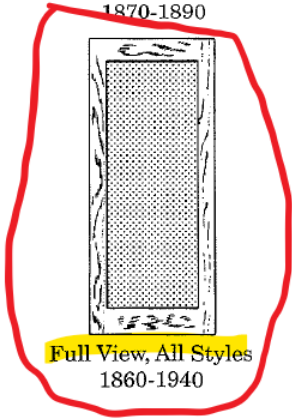

Full View, All Styles
1860-1940

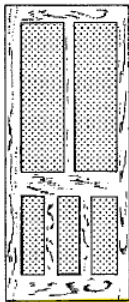

Craftsman
1905-1935

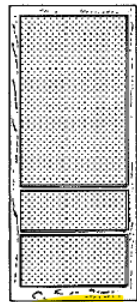

All Styles
1860-1940

(Often used on rear or side doors)

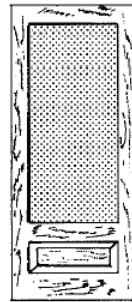

All Styles
1915-1940

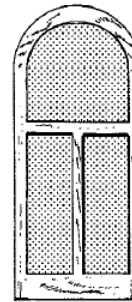

Craftsman,
Period Revival
1905-1940

Two wood storm doors with full glass