



CERTIFICATE OF APPROPRIATENESS APPLICATION FORM

Incomplete applications will not be processed for Commission review.
Please print legibly.

1. HISTORIC NAME OF PROPERTY OR HISTORIC DISTRICT: (if known)

American System Built Houses

ADDRESS OF PROPERTY:

2714 Burnham

2. NAME AND ADDRESS OF OWNER:

Name(s): *Frank Lloyd Wright Wisconsin*

Address: *PO Box 6339*

City: *Madison*

State: *WI*

ZIP: *537*

Email: _____

Telephone number (area code & number) Daytime: _____

Evening: _____

3. APPLICANT, AGENT OR CONTRACTOR: (if different from owner)

Name(s): *Barbara M. ELSNER*

Address: *2420 N Terrace Ave*

City: *Milw*

State: *WI*

ZIP Code: *53211*

Email: *RELSNER@wildso.org*

Telephone number (area code & number) Daytime: *414-961-2496*

Evening: *same*

4. ATTACHMENTS: (Because projects can vary in size and scope, please call the HPC Office at 414-286-5712 for submittal requirements)

A. REQUIRED FOR MAJOR PROJECTS:

Photographs of affected areas & all sides of the building (annotated photos recommended)

Sketches and Elevation Drawings (1 full size and 1 reduced to 11" x 17" or 8 1/2" x 11")
A digital copy of the photos and drawings is also requested.

Material and Design Specifications (see next page)

B. NEW CONSTRUCTION ALSO REQUIRES:

Floor Plans (1 full size and 1 reduced to a maximum of 11" x 17")

Site Plan showing location of project and adjoining structures and fences

**PLEASE NOTE: YOUR APPLICATION CANNOT BE PROCESSED UNLESS
BOTH PAGES OF THIS FORM ARE PROPERLY COMPLETED
AND SIGNED.**

5. DESCRIPTION OF PROJECT:

Tell us what you want to do. Describe all proposed work including materials, design, and dimensions. Additional pages may be attached.

6. SIGNATURE OF APPLICANT:

Barbara M Elser
Signature

Barbara ELSNER
Please print or type name

May 31, 2013
Date

This form and all supporting documentation **MUST** arrive by 12:00 noon on the deadline date established to be considered at the next Historic Preservation Commission Meeting. Any information not provided to staff in advance of the meeting will not be considered by the Commission during their deliberation. Please call if you have any questions and staff will assist you.

Hand Deliver or Mail Form to:
Historic Preservation Commission
City Clerk's Office
200 E. Wells St. Room B-4
Milwaukee, WI 53202

PHONE: (414) 286-5722

FAX: (414) 286-3004

www.milwaukee.gov/hpc

SUBMIT

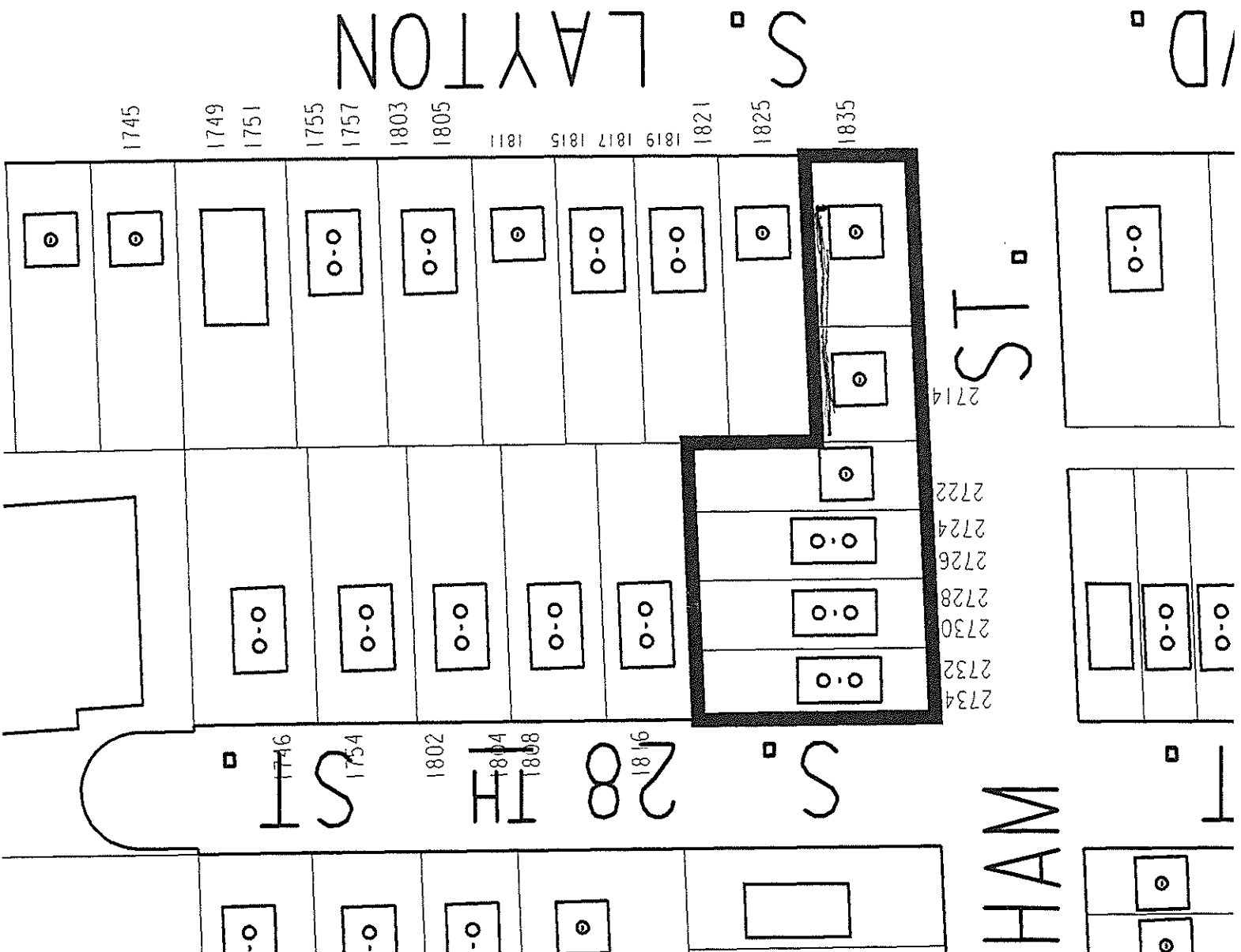
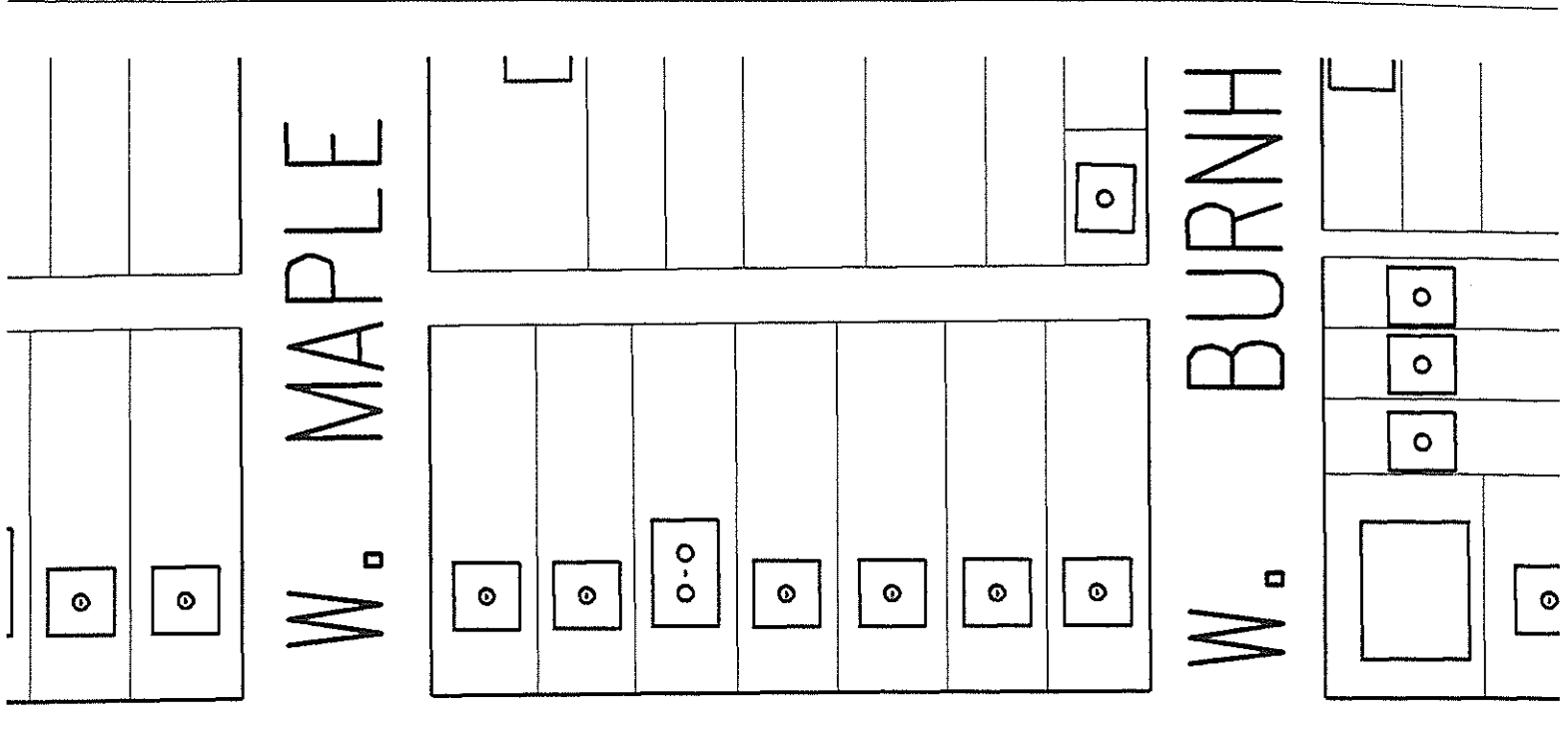

1745
1749
1751
1755
1757
1803
1805
1811
1815
1817
1819
1821
1825
1835

1746
1754
1802
1804
1808
1816
1824
1826
1828
1830
1832
1834

2714
2722
2724
2726
2728
2730
2732
2734

W. MAPLE

W. BURNH

S. LAYTON

S. 28th ST

ST
HAM