

UNLESS SPECIFICALLY STATED BY WRITTEN AGREEMENT, THIS DRAWING IS THE SOLE PROPERTY OF REFLO, INC. (REFLO). THE INFORMATION SHOWN ON THE DRAWING IS SOLELY FOR USE BY REFLO'S CLIENT OR CLIENT'S DESIGNATED REPRESENTATIVE FOR THE SPECIFIC PROJECT AND LOCATION IDENTIFIED ON THE DRAWING. THE DRAWING SHALL NOT BE TRANSFERRED, REUSED, COPIED, OR ALTERED IN ANY MANNER FOR USE AT ANY OTHER LOCATION OR FOR ANY OTHER PURPOSE WITHOUT THE PRIOR WRITTEN CONSENT OF REFLO. ANY TRANSFER, REUSE, OR MODIFICATION TO THE DRAWING BY THE CLIENT OR OTHERS, WITHOUT THE PRIOR WRITTEN EXPRESS CONSENT OF REFLO, WILL BE AT THE USER'S SOLE RISK AND WITHOUT ANY RISK OR LIABILITY OF REFLO.

Garden of Arts and Learning Conceptual Site Plan

3rd Street and Walker Street
Walker's Point, Milwaukee, WI
February 2015



Development Objectives

1. Engage the project stakeholders in water related educational programming
2. Reduce stormwater runoff volume entering into sewer systems which ultimately drain to Lake Michigan, reducing the risk of flooding, basement back-ups and combined sewer overflows in your neighborhood
3. Improve the quality of local watersheds
4. Create artistic opportunities for project stakeholders
5. Provide a built environment which integrates principals of STEAM (Science, Technology, Engineering, Arts, and Mathematics)



T: 414-949-7356
www.reflo2o.com



Prepared by:

Cover Page
and Site Location

Drawing Title:

Project:
Garden of Arts and Learning
Walker's Point, Wisconsin
Designed By: Reflo, Arts@Large, and Walker's Point Residents
Drawn By: Justin Hegarty
Date: 2/8/15

Project No.
2014.MKE.00

Figure No.
1

UNLESS SPECIFICALLY STATED BY WRITTEN AGREEMENT, THIS DRAWING IS THE SOLE PROPERTY OF REFLO, INC. (REFLO). THE INFORMATION SHOWN ON THE DRAWING IS SOLELY FOR USE BY REFLO'S CLIENT OR CLIENT'S DESIGNATED REPRESENTATIVE FOR THE SPECIFIC PROJECT AND LOCATION IDENTIFIED ON THE DRAWING. THE DRAWING SHALL NOT BE TRANSFERRED, REUSED, COPIED, OR ALTERED IN ANY MANNER FOR USE AT ANY OTHER LOCATION OR FOR ANY OTHER PURPOSE WITHOUT THE PRIOR WRITTEN CONSENT OF REFLO. ANY TRANSFER, REUSE, OR MODIFICATION TO THE DRAWING BY THE CLIENT OR OTHERS, WITHOUT THE PRIOR WRITTEN EXPRESS CONSENT OF REFLO, WILL BE AT THE USER'S SOLE RISK AND WITHOUT ANY RISK OR LIABILITY OF REFLO.

© Reflo, Inc.



"Stone Bracelet"
Artist: Zoran Mojsilov
Created for Neighbors of
Historic Walker's Point

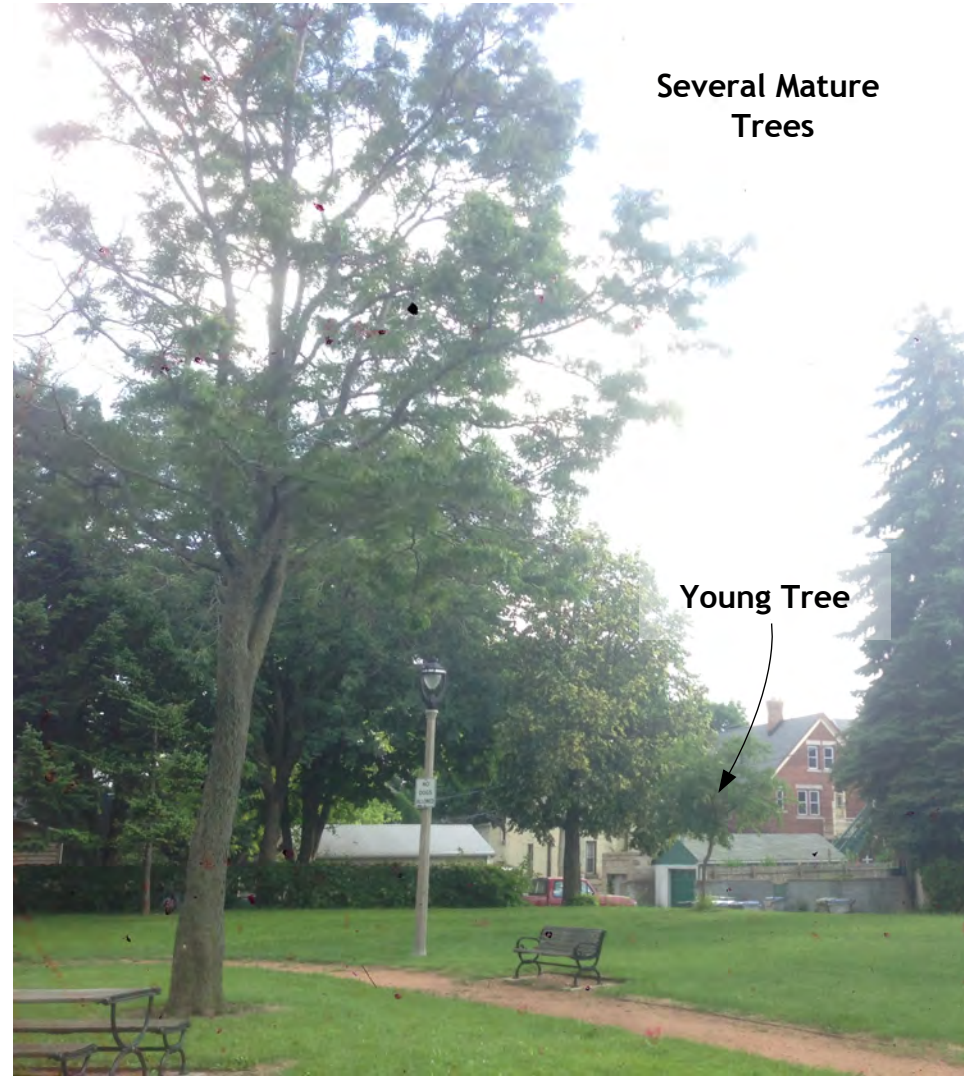

Several Mature
Trees

Young Tree

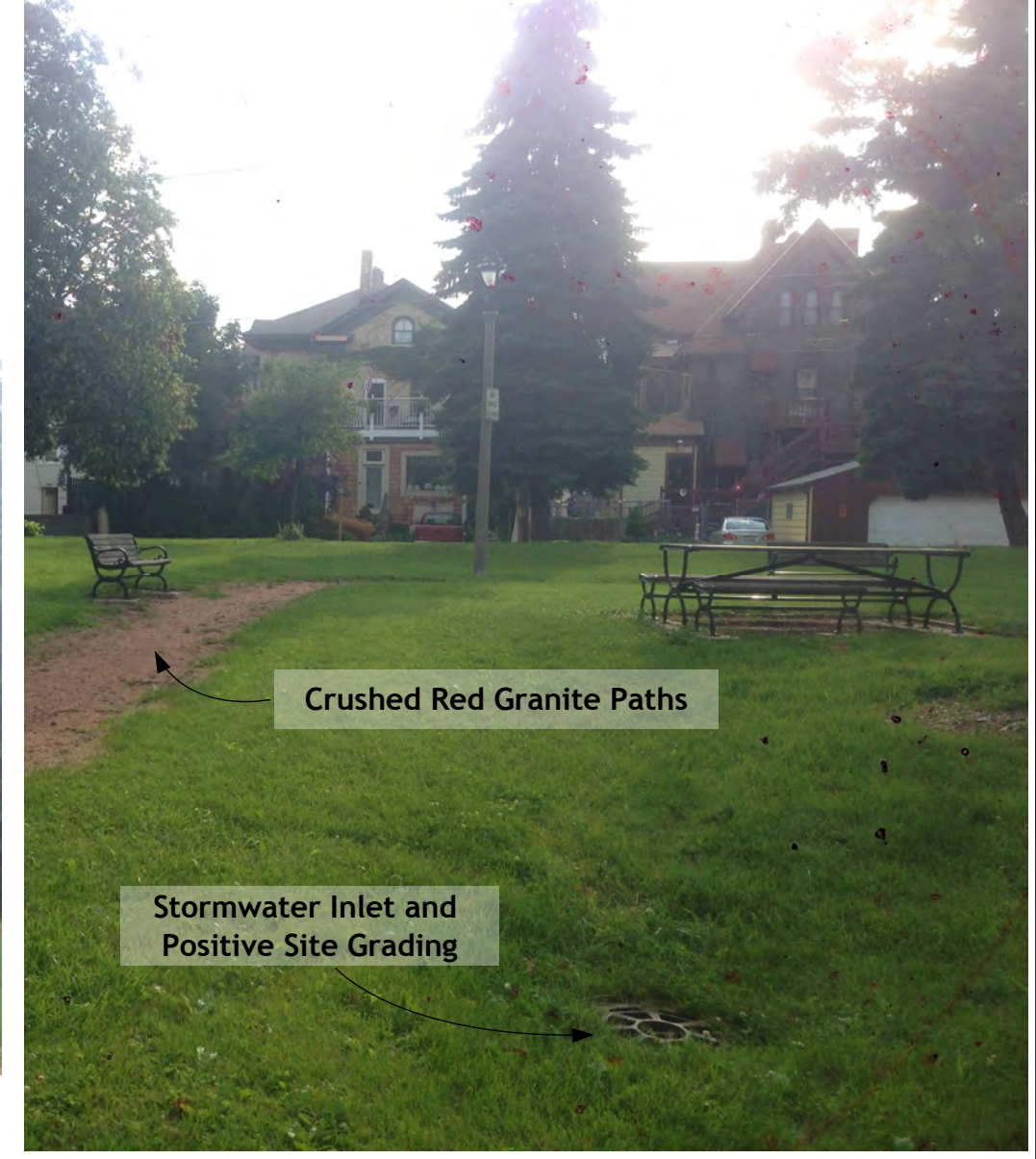

Crushed Red Granite Paths

Stormwater Inlet and
Positive Site Grading



Ornamental Lighting
(3 on Site plus street lighting)

Tree Stumps (2)

Substantial Park Benches

Decorative Entrance Pillars
(2 Designated Entrances)

T: 414-949-7356
www.refloh2o.com



Prepared by:

Existing Site Conditions

Drawing Title:

Project:
Garden of Arts and Learning
Walker's Point, Wisconsin

Designed By: Reflo, Arts@Large, and Walker's Point Residents
Drawn By: Justin Hegarty
Date: 2/8/15

Project No.
2014.MKE.00
Figure No.

UNLESS SPECIFICALLY STATED BY WRITTEN AGREEMENT, THIS DRAWING IS THE SOLE PROPERTY OF REFLO, INC. (REFLO). THE INFORMATION SHOWN ON THE DRAWING IS SOLELY FOR USE BY REFLO'S CLIENT OR CLIENT'S DESIGNATED REPRESENTATIVE FOR THE SPECIFIC PROJECT AND LOCATION IDENTIFIED ON THE DRAWING. THE DRAWING SHALL NOT BE TRANSFERRED, REUSED, COPIED, OR ALTERED IN ANY MANNER FOR USE AT ANY OTHER LOCATION OR FOR ANY OTHER PURPOSE WITHOUT THE PRIOR WRITTEN CONSENT OF REFLO. ANY TRANSFER, REUSE, OR MODIFICATION TO THE DRAWING BY THE CLIENT OR OTHERS, WITHOUT THE PRIOR WRITTEN EXPRESS CONSENT OF REFLO, WILL BE AT THE USER'S SOLE RISK AND WITHOUT ANY RISK OR LIABILITY OF REFLO.

3
A

Rock Sculpture, Raised Beds, and Water Harvesting

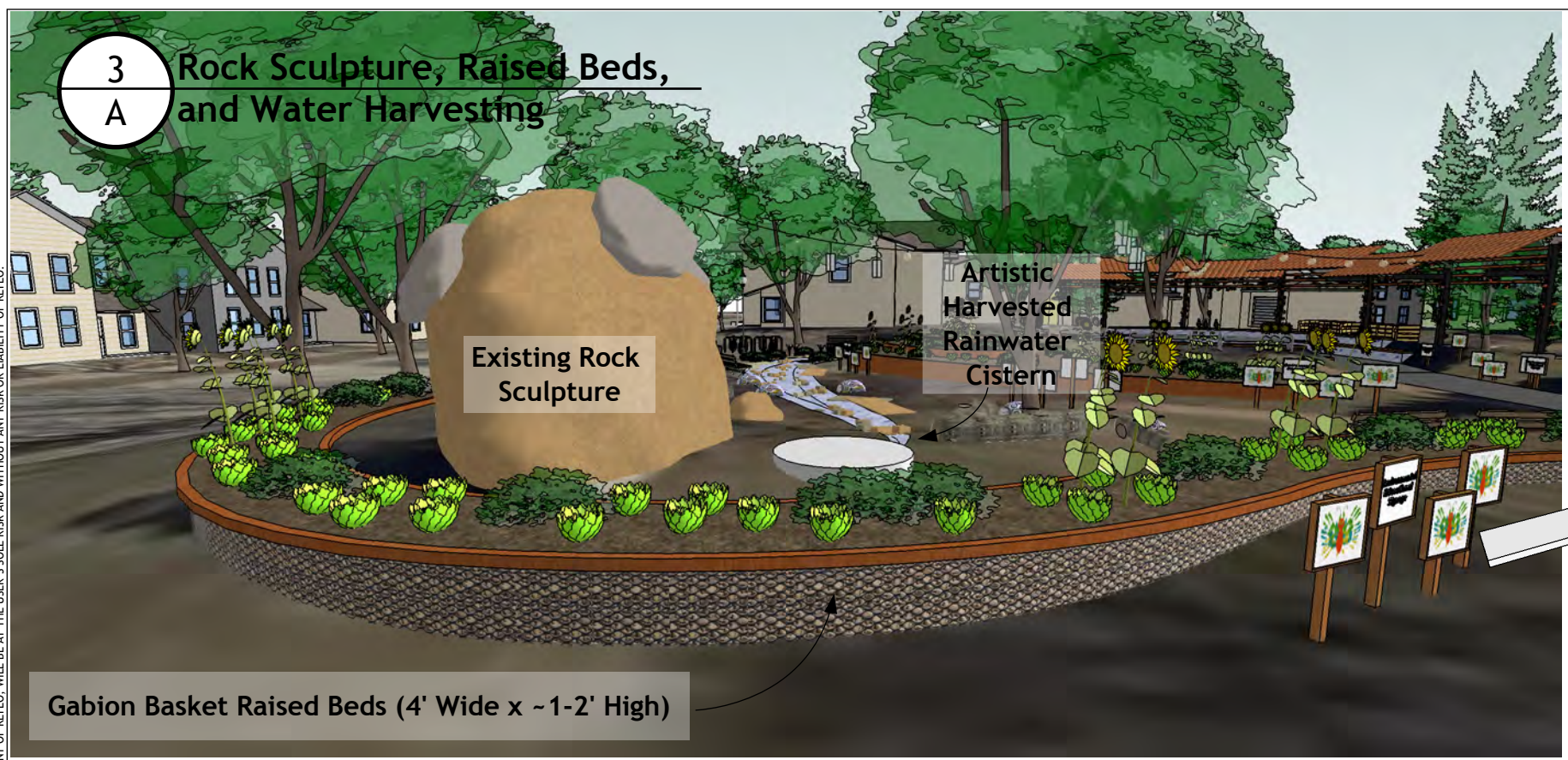

Existing Rock Sculpture

Artistic Harvested Rainwater Cistern

Gabion Basket Raised Beds (4' Wide x ~1-2' High)



3rd Street

Walker Street

A

B



Student and Local Artist Art Installations and Environmental Education Signage

Existing decorative trash bin with additional proposed recycling bin near both entrances

Site Signage
- History
- Events
- Partners

Environmental Educational Signage

3
B

Northern Site Entrance, Gardening, and Signage

UNLESS SPECIFICALLY STATED BY WRITTEN AGREEMENT, THIS DRAWING IS THE SOLE PROPERTY OF REFLO, INC. (REFLO). THE INFORMATION SHOWN ON THE DRAWING IS SOLELY FOR USE BY REFLO'S CLIENT OR CLIENT'S DESIGNATED REPRESENTATIVE FOR THE SPECIFIC PROJECT AND LOCATION IDENTIFIED ON THE DRAWING. THE DRAWING SHALL NOT BE TRANSFERRED, REUSED, COPIED, OR ALTERED IN ANY MANNER FOR USE AT ANY OTHER LOCATION OR FOR ANY OTHER PURPOSE WITHOUT THE PRIOR WRITTEN CONSENT OF REFLO. ANY TRANSFER, REUSE, OR MODIFICATION TO THE DRAWING BY THE CLIENT OR OTHERS, WITHOUT THE PRIOR WRITTEN EXPRESS CONSENT OF REFLO, WILL BE AT THE USER'S SOLE RISK AND WITHOUT ANY RISK OR LIABILITY OF REFLO.

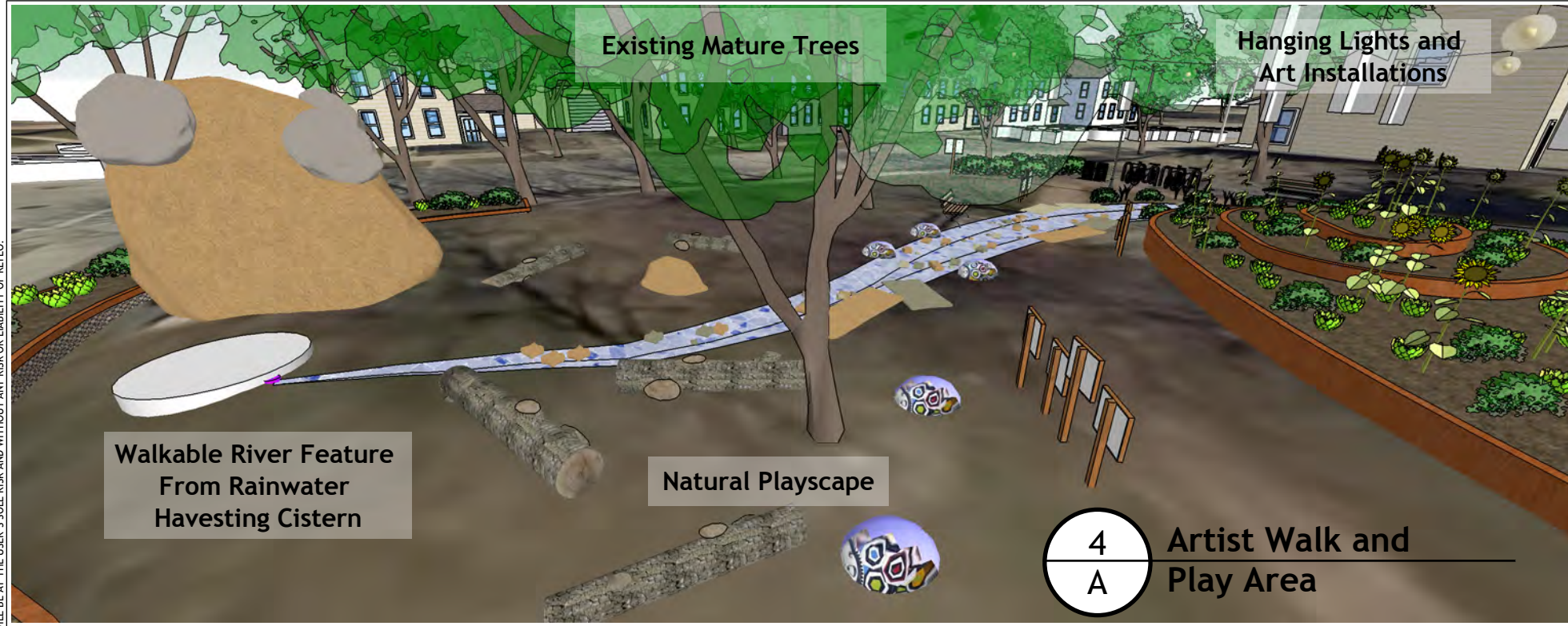

Existing Mature Trees

Hanging Lights and Art Installations

Walkable River Feature From Rainwater Harvesting Cistern

Natural Playscape

4
A

Artist Walk and Play Area

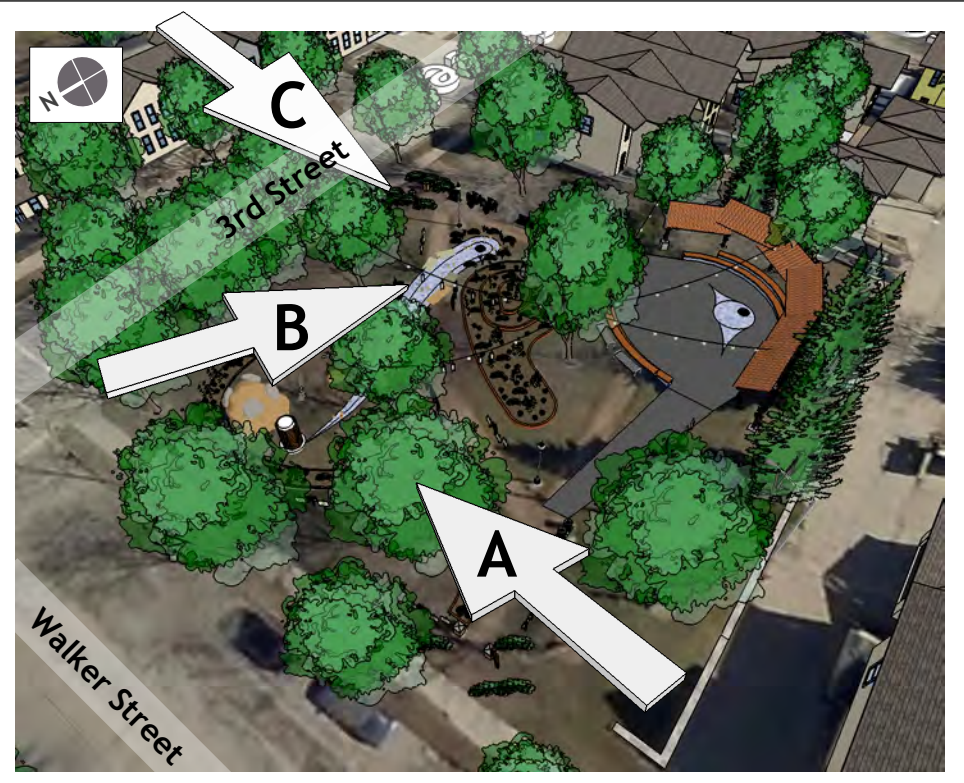

3rd Street

Walker Street

C

B

A



Unique Terraced Gardening for Various Urban Agriculture Demonstrations

Educational, Logistical, and Artistic Signage

Existing Stormwater Catchbasin and Proposed Walkable River

4
B

Terraced Gardening And Walkable River



Existing Ornamental Lighting

Bike Racks

Landscaped Entrance

Site Signage
- History
- Events
- Partners

4
C

Eastern Entrance

UNLESS SPECIFICALLY STATED BY WRITTEN AGREEMENT, THIS DRAWING IS THE SOLE PROPERTY OF REFLO, INC. (REFLO). THE INFORMATION SHOWN ON THE DRAWING IS SOLELY FOR USE BY REFLO'S CLIENT OR CLIENT'S DESIGNATED REPRESENTATIVE FOR THE SPECIFIC PROJECT AND LOCATION IDENTIFIED ON THE DRAWING. THE DRAWING SHALL NOT BE TRANSFERRED, REUSED, COPIED, OR ALTERED IN ANY MANNER FOR USE AT ANY OTHER LOCATION OR FOR ANY OTHER PURPOSE WITHOUT THE PRIOR WRITTEN CONSENT OF REFLO. ANY TRANSFER, REUSE, OR MODIFICATION TO THE DRAWING BY THE CLIENT OR OTHERS, WITHOUT THE PRIOR WRITTEN EXPRESS CONSENT OF REFLO, WILL BE AT THE USER'S SOLE RISK AND WITHOUT ANY RISK OR LIABILITY OF REFLO.

© Reflo, Inc.

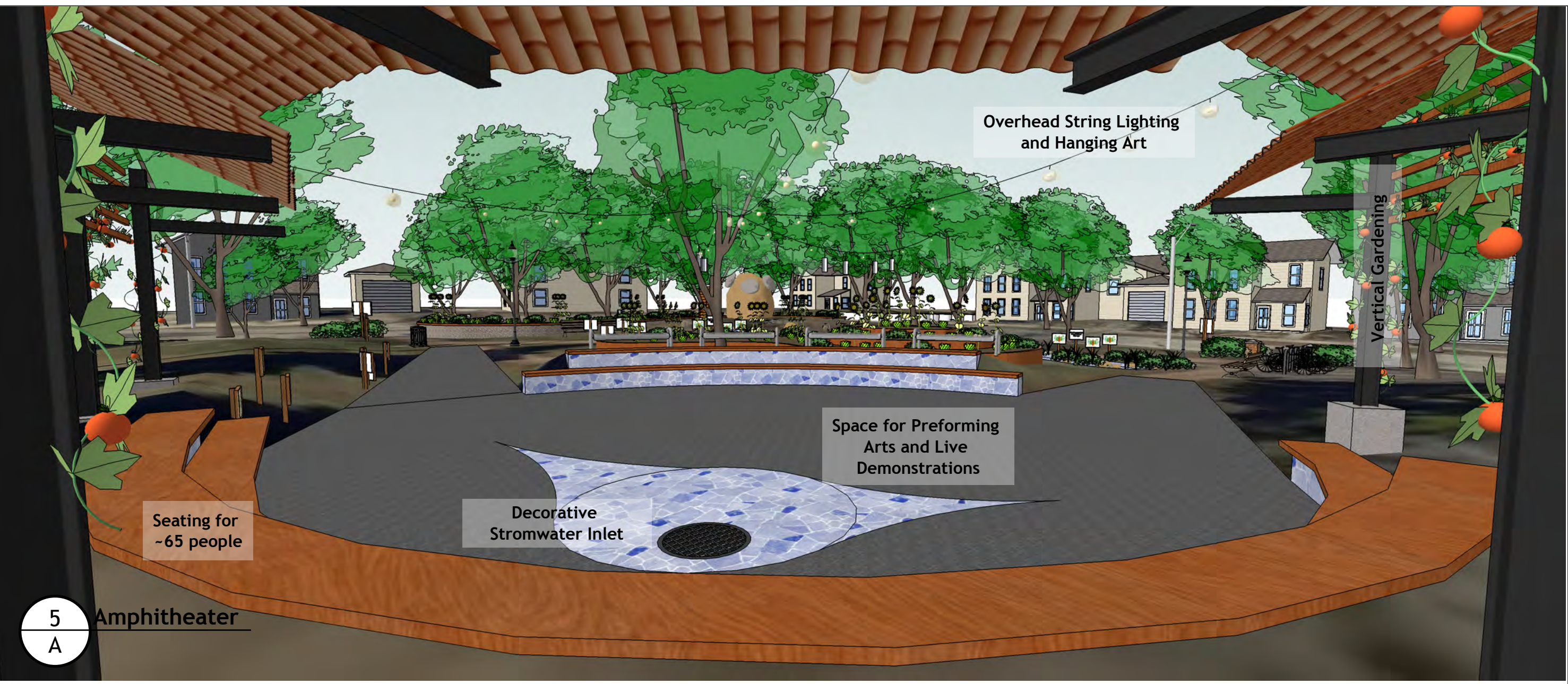

Overhead String Lighting and Hanging Art

Vertical Gardening

Space for Performing Arts and Live Demonstrations

Decorative Stormwater Inlet

Seating for ~65 people

5
A
Amphitheater



3rd Street

Walker Street

A
B

C

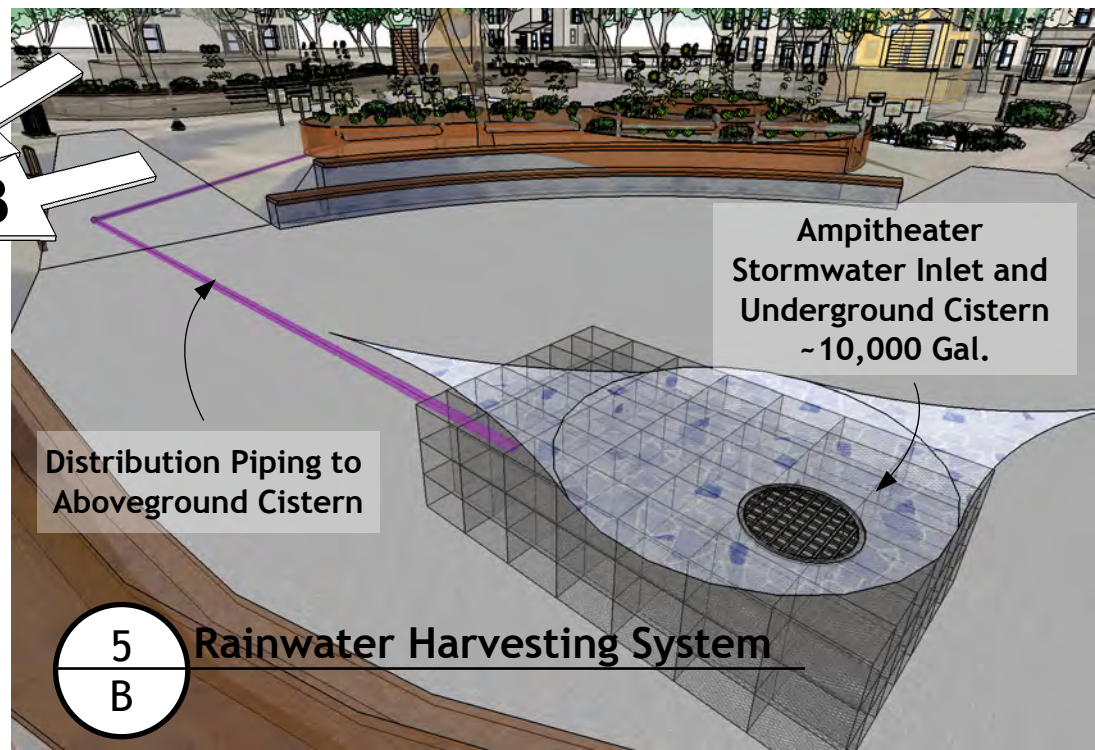

Amphitheater Stormwater Inlet and Underground Cistern ~10,000 Gal.

Distribution Piping to Aboveground Cistern

5
B
Rainwater Harvesting System

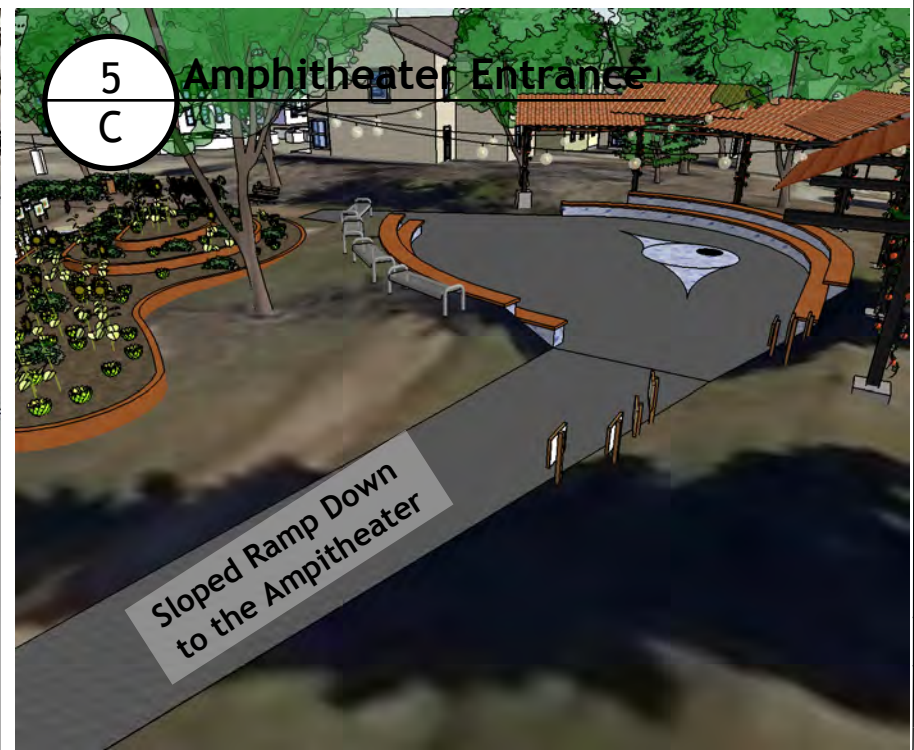

5
C
Amphitheater Entrance

Sloped Ramp Down to the Amphitheater

T: 414-949-7356
www.reflo2o.com



Prepared by:

Proposed Amphitheater, Rainwater Harvesting, and Walkable River

Drawing Title:

Project:
Garden of Arts and Learning
Walker's Point, Wisconsin

Designed By: Reflo, Arts@Large, and Walker's Point Residents
Drawn By: Justin Hegarty
Date: 2/8/15

Project No.
2014.MKE.00
Figure No.

5

UNLESS SPECIFICALLY STATED BY WRITTEN AGREEMENT, THIS DRAWING IS THE SOLE PROPERTY OF REFLO, INC. (REFLO). THE INFORMATION SHOWN ON THE DRAWING IS SOLELY FOR USE BY REFLO'S CLIENT OR CLIENT'S DESIGNATED REPRESENTATIVE FOR THE SPECIFIC PROJECT AND LOCATION IDENTIFIED ON THE DRAWING. THE DRAWING SHALL NOT BE TRANSFERRED, REUSED, COPIED, OR ALTERED IN ANY MANNER FOR USE AT ANY OTHER LOCATION OR FOR ANY OTHER PURPOSE WITHOUT THE PRIOR WRITTEN CONSENT OF REFLO. ANY TRANSFER, REUSE, OR MODIFICATION TO THE DRAWING BY THE CLIENT OR OTHERS, WITHOUT THE PRIOR WRITTEN EXPRESS CONSENT OF REFLO, WILL BE AT THE USER'S SOLE RISK AND WITHOUT ANY RISK OR LIABILITY OF REFLO.

© Reflo, Inc.



Danceworks: Community Dance workshops/Performances

AWE: Community art site for the mobile art cars.

Urban Ecology Center: Possible birding destination. Site to supplement activities happening at the center.

Walkers Point Center for the Arts: Yarn-bombing trees. Outdoor arts activities connected to their after-school art program.

Arts @ Large: Mosaic pieces for seating and artistic herb gardens. Seasonal art installation, etc.

Milwaukee Environmental Sciences: Destination for culture stand to sell student created micro-enterprise goods.

Creative Café via Arts @ Large: Destination for community coffee sales and workshops.

Serve 2 Unite: Opportunities for peace rallies, public discussions on social justice and civil rights issues.

Hometown: Art market for the community.

UW-Extension: workshops on alternative gardening techniques.

Braise and other local restaurants: Demonstrations on RSA's, CSA's and how to utilize the food grown in your own gardens.

Reflo - Sustainable Water Solutions: Rainwater harvesting demonstrations, water educational programing, and community outreach.

T: 414-949-7356
www.refloh2o.com



Prepared by:

Proposed Conceptual Site Plan and Potential Programing and Activities

Drawing Title:

Project: Garden of Arts and Learning Walker's Point, Wisconsin
Designed By: Reflo, Arts@Large, and Walker's Point Residents
Drawn By: Justin Hegarty Date: 2/8/15

Project No. 2014.MKE.00
Figure No.