

DCD #3348

CERTIFIED SURVEY MAP NO. _____

LOTS 4, 5, 6 AND 7 AND PART OF LOTS 9, 12 AND 13 IN BLOCK 1 OF H. LICHTFELDT'S SUBDIVISION, AND LANDS IN THE NORTHWEST 1/4 OF THE SOUTHEAST 1/4 OF SECTION 8, TOWNSHIP 7 NORTH, RANGE 22 EAST, IN THE CITY OF MILWAUKEE, MILWAUKEE COUNTY, WISCONSIN.

ADDRESSES: 3317-3349 N. M. L. KING DR.,
456 W. CONCORDIA AV.

TAX KEY #S: 282-1204-100, 282-1205-000, 282-1206-100,
282-1209-100, 282-2782-110

ZONING: LB2

GRAPHIC SCALE

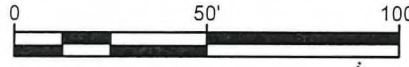

Vicinity Map:



SE 1/4 SEC 08-7-22
Scale: 1" = 2000'

CONC. MON.
W/ BRASS
CAP
CEN. SEC.
8-7-22

LOT 12
LOT 13

H. LICHTFELDT'S SUBD.
BLOCK 1

LOT 3

N88° 59' 36"E

145.66'

LEGEND & NOTES:

- FOUND MONUMENTATION, AS NOTED ON DRAWING.
- SET 3/4" DIAM. REBAR, 18" LONG WEIGHING 1.50 LBS/LIN. FT.

BEARINGS REFERENCED THE WISCONSIN STATE PLANE COORDINATE SYSTEM WITH THE W LINE OF THE SE1/4 OF SEC. 8-7-22 BEARING N 0°21'30" W, AS PUBLISHED BY SEWRPC, NAD 1983, 2019 DATUM

PEIRCE & DAVIS' ADDN.
BLOCK 4
LOT 15

LOT 14
LOT 15

W. LINE SE1/4 SEC. 8-7-22 (2650.99' TOTAL) N0° 21' 30"W
193.00'

LOT 1

AREA: 48,178 SQ. FT.
OR 1.106 ACRES



LOT 20

LOT 20

N0° 21' 30"W
1618.67'

H. LICHTFELDT'S SUBD.
BLOCK 1

LOT 15

LOT 14

LOT 13

N0° 21' 30"W

97.00'

23.00'

S88° 59' 24"W

100.00'

S88° 59' 24"W

20.00'

S0° 21' 30"E

12.50'

42.00'

S88° 59' 24"W

40.00'

S88° 59' 24"W

S88° 59' 24"W

20.00'

S0° 21' 30"E

12.50'

42.00'

S88° 59' 24"W

83.50'

S0° 21' 30"E

97.00'

S88° 59' 24"W

20.00'

S0° 21' 30"E

12.50'

42.00'

S88° 59' 24"W

40.00'

S88° 59' 24"W

20.00'

S0° 21' 30"E

12.50'

42.00'

S88° 59' 24"W

40.00'

S88° 59' 24"W

20.00'

S0° 21' 30"E

12.50'

42.00'

S88° 59' 24"W

40.00'

S88° 59' 24"W

20.00'

S0° 21' 30"E

12.50'

42.00'

S88° 59' 24"W

S22° 42' 13"E

25.83'

(R. 25.81')

73.91'

S88° 59' 24"W

LOT 9

S88° 59' 24"W

LOT 10

LOT 11

H. LICHTFELDT'S SUBD.

BLOCK 1

LOT 10

H. LICHTFELDT'S SUBD.

BLOCK 1

LOT 11

H. LICHTFELDT'S SUBD.

BLOCK 1

LOT 11

H. LICHTFELDT'S SUBD.

BLOCK 1

LOT 11

H. LICHTFELDT'S SUBD.

BLOCK 1

LOT 11

H. LICHTFELDT'S SUBD.

BLOCK 1

LOT 11

H. LICHTFELDT'S SUBD.

BLOCK 1

LOT 11

H. LICHTFELDT'S SUBD.

BLOCK 1

LOT 11

H. LICHTFELDT'S SUBD.

BLOCK 1

LOT 11

N. DR. MARTIN LUTHER KING JR. DR.
(66' public R/W)
S32° 30' 12"E
187.63'
S32° 31' 34"E
38.69'

N. 5TH ST.
(70' public R/W)

W. CONCORDIA AV. (60' public R/W)

CONC. MON.
W/ BRASS CAP
S1/4 COR. SEC.
8-7-22

INFRASTRUCTURE SERVICES DIVISION
Yun Ut 6/29/2023
CENTRAL DRAFTING & RECORDS MANAGER
KTS 6-29-23
ENGR. IN CHARGE ENVIRON. ENGR.
CORRECT
[Signature] 6/30/2023
CITY ENGINEER
APPROVED

DEPARTMENT OF CITY DEVELOPMENT
CITY OF MILWAUKEE

JUN 02 2022
[Signature]
STAFF APPROVED

CERTIFIED SURVEY MAP NO. _____

LOTS 4, 5, 6 AND 7 AND PART OF LOTS 9, 12 AND 13 IN BLOCK 1 OF H. LICHTFELDT'S SUBDIVISION, AND LANDS IN THE NORTHWEST 1/4 OF THE SOUTHEAST 1/4 OF SECTION 8, TOWNSHIP 7 NORTH, RANGE 22 EAST, IN THE CITY OF MILWAUKEE, MILWAUKEE COUNTY, WISCONSIN.

SURVEYOR'S CERTIFICATE

STATE OF WISCONSIN)

SS

MILWAUKEE COUNTY)

I, Kevin A. Slotke, Professional Land Surveyor, hereby certify that I have surveyed, divided and mapped LOTS 4, 5, 6 AND 7 AND PART OF LOTS 9, 12 AND 13 IN BLOCK 1 OF H. LICHTFELDT'S SUBDIVISION, AND LANDS IN THE NORTHWEST 1/4 OF THE SOUTHEAST 1/4 OF SECTION 8, TOWNSHIP 7 NORTH, RANGE 22 EAST, CITY OF MILWAUKEE, MILWAUKEE COUNTY, WISCONSIN, bounded and described as follows:

Commencing at the South 1/4 corner of said Section 8; thence North 0°21'30" West, 1618.67 feet along the west line of the Southeast 1/4 of said Section 8 to the point of beginning; continue thence North 0°21'30" West, 193.00 feet along said west line to the north line of Lot 4, Block 1, in H. Lichtfeldt's Subdivision; thence North 88°59'36" East, 145.66 feet along said north line to the southwesterly line of North Dr. Martin Luther King Jr. Drive; thence South 32°30'12" East, 187.63 feet along said southwesterly line; thence South 32°31'34" East, 38.69 feet along said southwesterly line; thence South 22°42'13" East, 25.83 feet; thence South 88°59'24" West, 73.91 feet; thence South 0°21'30" East, 12.50 feet; thence South 88°59'24" West, 42.00 feet; thence South 0°21'30" East, 83.50 feet to the north line of West Concordia Avenue; thence South 88°59'24" West, 40.00 feet along said north line to the east line of Lot 13 of aforesaid Block 1, in H. Lichtfeldt's Subdivision; thence North 0°21'30" West, 97.00 feet along said east line; thence South 88°59'24" West, 20.00 feet; thence North 0°21'30" West, 23.00 feet to the north line of said Lot 13; thence South 88°59'24" West, 100.00 feet along said north line and its extension to the point of beginning.

Said parcel contains 48,178 square feet or 1.106 acres of land, more or less.

That I have made the survey, land division, and map by the direction of Five Points MLKEDC LLC, the owners of said land.

That the map is a correct representation of all the exterior boundaries of the land surveyed and the land division thereof made.

That I have fully complied with Chapter 236 of the Wisconsin Statutes and Chapter 119 of the Milwaukee Code of Ordinances in surveying, dividing and mapping the same. Per Wis. Stat. 236.21 (1), this certificate has the same force and effect as an affidavit.

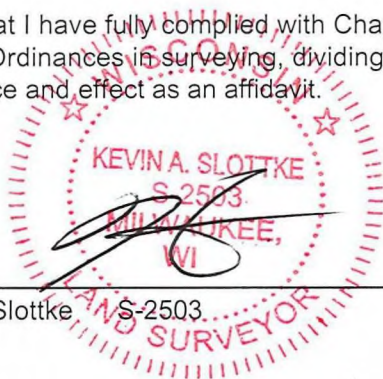

9/21/23

Kevin A. Slotke S-2503

DATE



www.thesigmagroup.com
1300 West Canal Street
Milwaukee, WI 53233
Phone: 414-643-4200
Fax: 414-643-4210

CERTIFIED SURVEY MAP NO. _____

LOTS 4, 5, 6 AND 7 AND PART OF LOTS 9, 12 AND 13 IN BLOCK 1 OF H. LICHTFELDT'S SUBDIVISION, AND LANDS IN THE NORTHWEST 1/4 OF THE SOUTHEAST 1/4 OF SECTION 8, TOWNSHIP 7 NORTH, RANGE 22 EAST, IN THE CITY OF MILWAUKEE, MILWAUKEE COUNTY, WISCONSIN.

ENTITY OWNER'S CERTIFICATE

Five Points MLKEDC LLC, a limited liability company duly organized and existing under and by virtue of the laws of the State of Wisconsin as owner, certifies that said company caused the land described on this map to be surveyed, divided, mapped and dedicated as represented on this map in accordance with the requirements of Chapter 119 of the Milwaukee Code of Ordinances.

In consideration of the approval of the map by the Common Council and in accordance with Chapter 119 of the Milwaukee Code, the undersigned agrees:

A. That all utility lines to provide electric power and telephone services and cable television or communications systems lines or cables to all lots in the certified survey map (other than already existing lines and cables) shall be installed underground in easements provided therefor, where feasible.

This agreement shall be binding on the undersigned and assigns.

Five Points MLKEDC LLC

Date: 6/14/2023

Signature: Nicole R

Printed name & title: Nicole Robbins, Executive Director

STATE OF WISCONSIN))SS
MILWAUKEE COUNTY)

Personally came before me this 16 day of JUNE, 2023, Nicole Robbins, to me known to be the person who executed the foregoing instrument, and to me known to be the **Executive Director of Five Points MLKEDC LLC** and acknowledged that she executed the foregoing instrument by its authority.

(SEAL) NOTARY PUBLIC, STATE OF WISCONSIN

Notary signature Olawale Print notary name Olawale Ajibade

My commission expires 07-16-2026.



www.thesigmagroup.com
1300 West Canal Street
Milwaukee, WI 53233
Phone: 414-643-4200
Fax: 414-643-4210

CERTIFIED SURVEY MAP NO. _____

LOTS 4, 5, 6 AND 7 AND PART OF LOTS 9, 12 AND 13 IN BLOCK 1 OF H. LICHTFELDT'S SUBDIVISION, AND LANDS IN THE NORTHWEST 1/4 OF THE SOUTHEAST 1/4 OF SECTION 8, TOWNSHIP 7 NORTH, RANGE 22 EAST, IN THE CITY OF MILWAUKEE, MILWAUKEE COUNTY, WISCONSIN.

CERTIFICATE OF CITY TREASURER

I, Spencer Coggs, being the duly elected and acting City Treasurer of the City of Milwaukee, certify that in accordance with the records in the office of the City Treasurer of the City of Milwaukee there are no unpaid taxes or unpaid special assessments on the land included in this certified survey map.

Per Wis. Stat. 75.06 and 74.87, the City of Milwaukee collects property taxes and enforces nonpayment of same on parcels in the City of Milwaukee. Per Wis. Stat. 74.83, the City of Milwaukee and Milwaukee County entered into an Intergovernmental Cooperation Agreement approved by Council Resolution 901408, whereby the city is the sole collector and enforcer of property taxes for parcels in the city.

Date: 09/27/2023 Signature: James J. Kuybon, DEPUTY
Type or Print Name: for Spencer Coggs
(City Treasurer)

CERTIFICATE OF CITY CLERK REGARDING COMMON COUNCIL APPROVAL

I certify that this certified survey map was approved under Resolution File No. 230859, adopted by the Common Council of the City of Milwaukee on October 10, 2023

Date: October 13, 2023 Signature: [Signature]
Type or Print Name: James Owczarski
(City Clerk)

