

# Renew Basement Foundation

[www.renewbasementfoundation.com](http://www.renewbasementfoundation.com)

Renewbasementfoundation@gmail.com

414-429-4901

5411 W Mobile St

West Allis, WI 53219



**Family Owned and Operated.**  
**Fully Licensed, Bonded, and Insured.**

**Date** Aug. 14, 2024

**Client Details**

Noah  
 414 935 8159  
 noahbenbazze@gmail.com  
 2118 E Kenilworth pl  
 Milwaukee, WI 53202

**Sales Representative**

Christian Rivera  
 (414) 429-4901  
 renewbasement@gmail.com

**Product List**

Description	Quantity	Amount
<p><b>Concrete installation</b></p> <p>* Cut/ break existing concrete and haul away to landfill; Install base of traffic bond; install 2x4 to frame concrete as shown in diagram; Renew will make depth of concrete at a minimum of 4"; Install concrete wire mesh and fiber glass in concrete to add strength to new concrete; once concrete is dried Renew will remove 2x4 and add new top soil; Renew will leave job site as clean as possible.</p> <p>Base Price: C</p>	291.61 sq ft	\$4,999.32
<p><b>Drain Tile System Installation</b></p> <p>Remove Floor along wall area (12"-18" wide) where indicated; Remove existing drain tile and create down pitch towards sump pump; Drill 1" weep holes in the bottom of the first course; Drill holes in fourth block every 4 feet; flush all weep holes until completely clean, clean and flush bleeders. When flushing observe water flow into sump pump, Clean trench if necessary; Install 4" perforated drain tile; fill new drain tile with 3/4 chip stone; Install drainage board against first course; Re-cement floor.</p> <p>Base Price: A</p>	52.74 ft	\$2,900.70
<p><b>Notes</b></p> <p>* Renew will obtain permits required by city to perform project; Work will be perform by WAFRP standards; Client is responsible for removing any personal belongings by perimeter where renew will work on; Renew will install plastic to protect personal items; Turn furnace off when breaking concrete in basement; Remove/ Reinstall sink, washer or dryer if required; Connect drain tiles into sump pump; Cancel palmer valve if required; Flush all weep holes and clean all bleeders; Install MTI floor edging by new drain tile installation; Remove any drywall, cabinets, flooring, toilet and carpet required to install drain tiles, Renew will not reinstall; Work will be perform as shown in diagram; Remove/Reinstall window used to haul away material; Renew will leave job site as clean as possible.</p>	1	
<p><b>Sump pump installation</b></p> <p>Install 18"x22 sump pump basin; Connect drain tiles into basin. GLETRONICS ST1033-NS SUMP PUMP 1/3HP NO SWITCH. 3 YEAR WARRANTY GLETRONICS DFC2 DUAL FLOAT SWITCH &amp; CONTROLLER. Installation includes check valve, labor, material, Licensed plumber and licensed electrician for outlet. ( Renew only covers outlet cost with a new breaker, any additional work required to install breaker is not covered by Renew basement.)</p> <p>Base Price:</p>	1	\$1,400.00

**Wall replacement**

**\$17,392.00**

Call diggers hot line , Install plywood properly in work area. Excavate area to footings, Haul away to approved landfill ; clean excavated wall; Remove existing damaged wall as shown in diagram; Check condition of footings; if footings are in bad condition: new footings with bleeders will have to be installed ( footing size 20"wide x 10" thick); Install new wall as shown in engineer report; reinforce new wall with #5 rebar at 48" on center; Clean and flush any bleeders in footings; Apply waterproofing tar by hand; install new 4" exterior drain tile and connect with drain tile; Back fill with 80% #1 stone; install fabric on top of stone and 20% top soil; grade away from foundation wall.

Base Price:	27.32 ft	
	Subtotal	\$26,692.02
	<b>Total</b>	<b>\$26,692.02</b>

**Additional Information**

Signed by: <i>Amine (Nohi) Benkayza</i> <small>021E38381F74451...</small>	<u>8/16/2024</u> Date	 Authorized Rep. Signature	<u>08-14-2024</u> Date
Customer Signature			

I have read the terms and conditions, I hereby accept the conditions, specifications and prices. **Any changes to the original scope of the project will require a written change order prior to commencing the work.**

Detail Plan

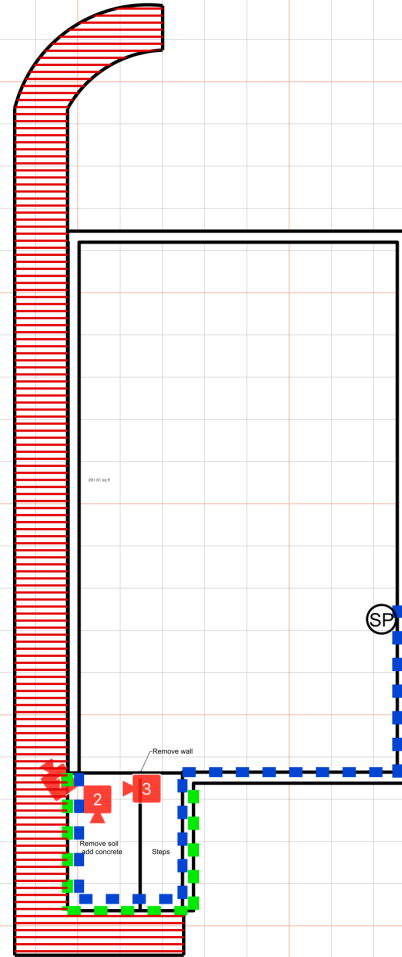

Legend	
Concrete installation	Drain Tile System Installation
Sump pump installation	Wall replacement





1 - 1



2 - 1



3 - 1

Renew Basement Foundation LLC is referred as "Contractor" and Noah Benbazze is referred as client.

This contract requires a deposit of 20 % at time of contracting balance is due upon completion of the agreed scope of project.

Contractor will maintain adequate liability coverage during the performance of this contract.

Contractor guarantees labor for a period of 20 years.

Warranty for waterproofing only covers water leakage in the floor and walls. Does not cover any dampness.

Warranty does not cover water entering from windows, chimney, sewer or any water from above the foundation walls.

Renew Basement is not responsible for any damage to siding, gutters/guards, fascia, soffit, downspouts nor landscaping.

Warranty for sump pumps are only through the manufacturer.

Warranty only applies if gutters and downspouts are maintained in good working condition by the owner after the work has been completed.

For client protection, during contract performance, the client shall not be permitted in the working area without the company of the contractor, emergencies exempted.

Services are strictly in the work area and do not cover any leakage or flow in non-working areas.

Client is responsible for removing personal property from the working area prior to commencing work. The Contractor is not responsible for damages of personal property not removed or properly protected.

Renew Basement Foundation LLC is not responsible for any damages to landscaping (lawn, flowers, shrubs, or trees) unless restricted by the contract.

Any changes to the original scope of project will require a written change order prior to commencing the work.

This contract may be cancelled via written notification with a 15 days' notice. Client shall be responsible for all expenses incurred prior to cancellation.

Neither the Contractor nor the Client shall be considered in breach of this Contract to the extent that performance of their respective obligations (excluding payment obligations) is prevented by an Event of Force Majeure that arises after the Effective Date.

Any disagreements arising from the performance of this contract shall be resolved by a third neutral mutually agreed by all parties to the contract.

This contract shall be governed by Wisconsin Statutes.

A waiver of construction lien will be provided after the final payment.

**Renew Basement Foundation**  
5411 W. Mobile St.  
West Allis, WI 53219  
414-429-4901  
renewbasementfoundation@gmail.com