

Downer Avenue Parking Lot -- Proposed Marketing

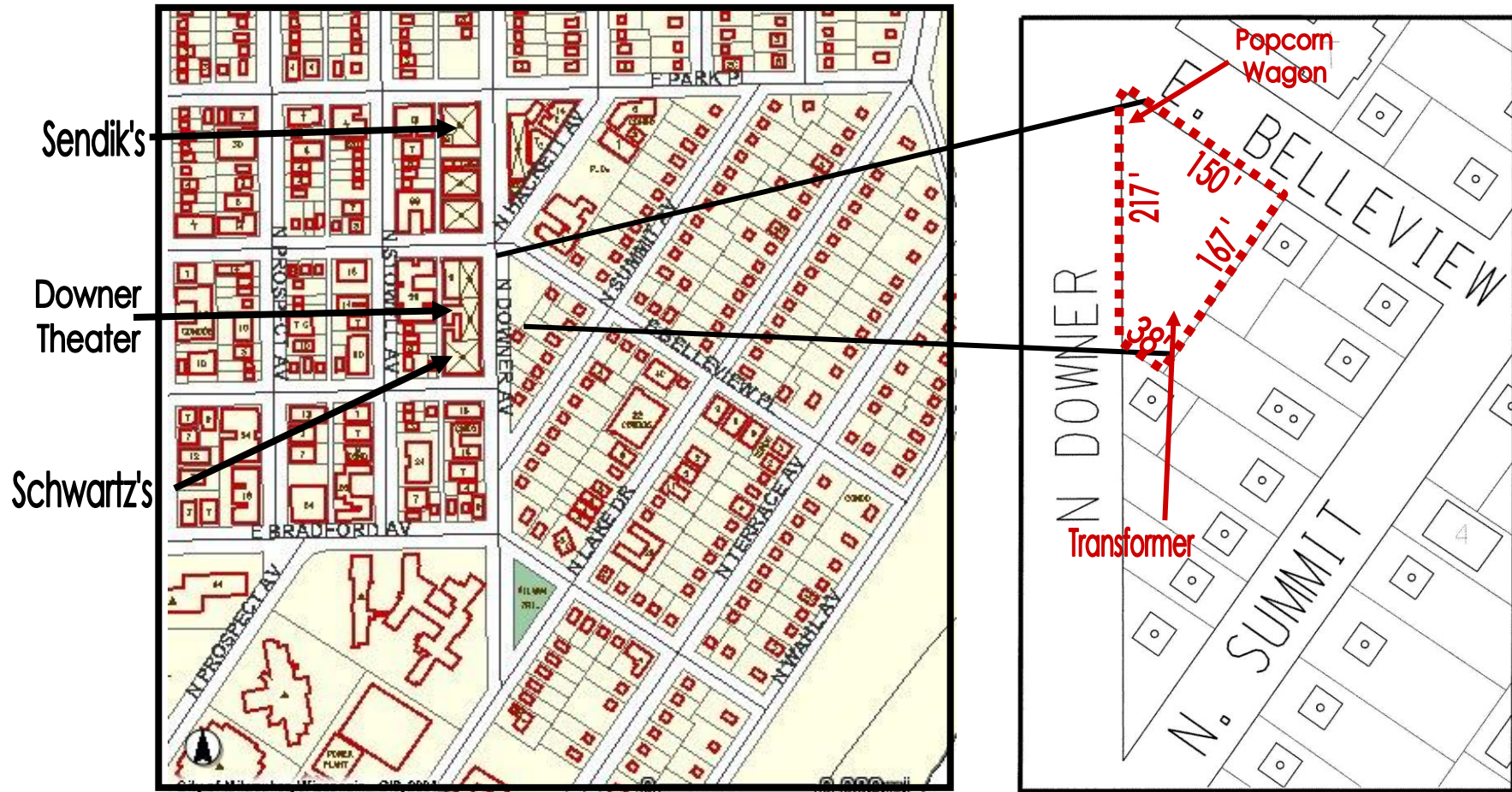

Property: 16,517 SF, triangular lot with approximately 217 feet on Downer and 150 feet on Bellevue

Special Conditions: Prospective buyer would be expected to:

- Propose a use that contributes to the Downer Avenue Commercial District
- Propose a design that is sensitive to the Downer Avenue Commercial Historic District and the adjacent North Point Historic Districts
- Replace 28 spaces of public parking on a meter basis
- Incorporate the historic popcorn wagon in the project
- Incorporate or relocation City transformer

Process: Work with Downers Merchants Association and area residents on use and design standards



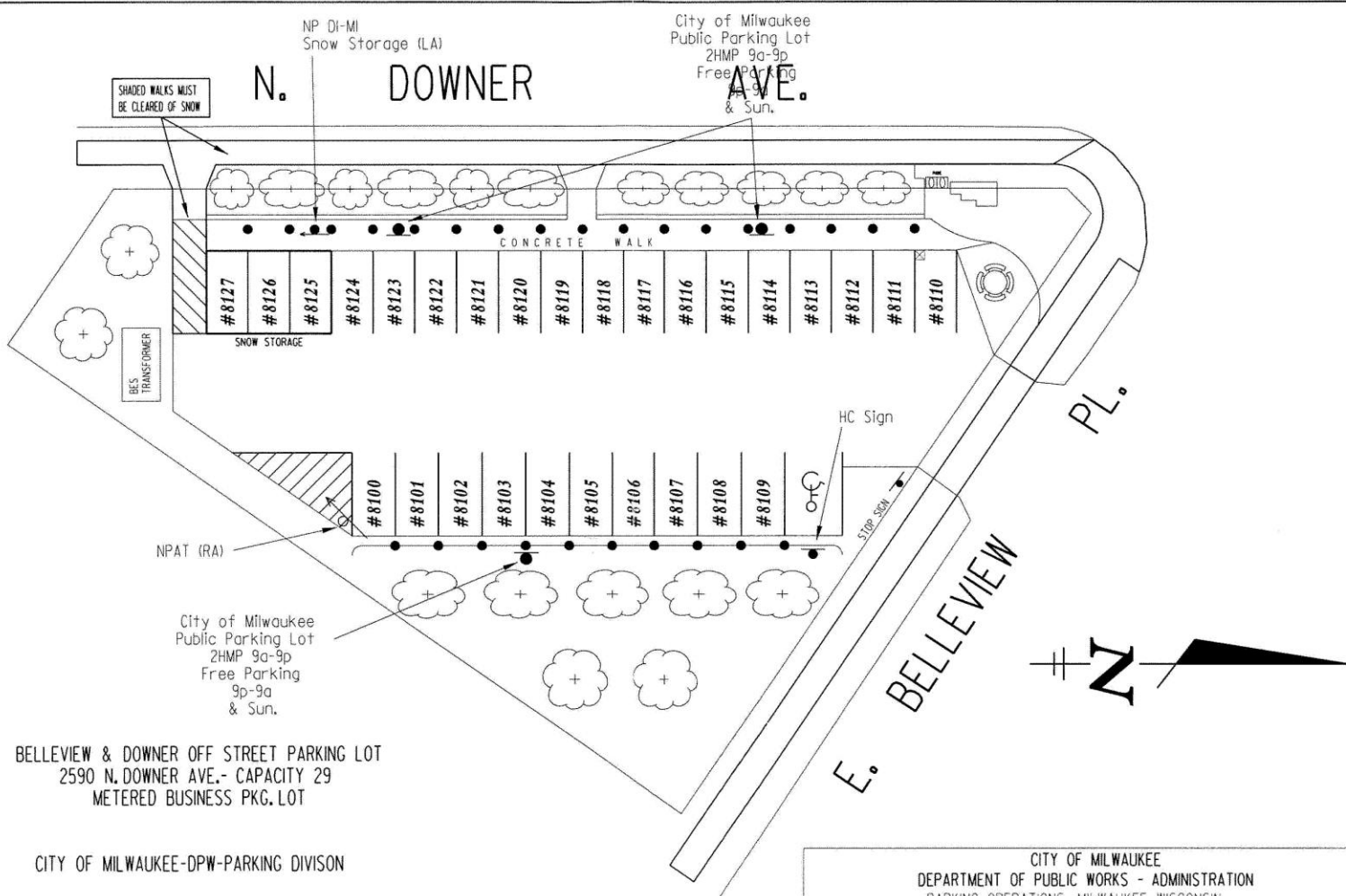

BELLEVIEW & DOWNER OFF STREET PARKING LOT
 2590 N. DOWNER AVE.- CAPACITY 29
 METERED BUSINESS PKG. LOT

CITY OF MILWAUKEE-DPW-PARKING DIVISON

CITY OF MILWAUKEE DEPARTMENT OF PUBLIC WORKS - ADMINISTRATION PARKING OPERATIONS, MILWAUKEE, WISCONSIN					
PLAN OF: BELLEVIEW & DOWNER OFF STREET PKG. LOT					
DESIGNED BY		DATE:	SCALE	1/4 SEC.	ALD.DIST.
DRAWN BY	M.R.WILLIAMS	DATE:6-27-02	1"=20'	318	
REVISED:		DATE:	PLOT DATE: 07 Jun 2005		
FILE: C:\Parking Drawings\offstreet\belleview_downer.dgn					

BELLEVIEW & DOWNER OFF STREET PKG. LOT