



**CITY OF MILWAUKEE
OFFICE OF THE CITY CLERK**

Friday, June 13, 2025

COMMITTEE MEETING NOTICE

AD 08

MARTINEZ- PEREZ, Hermelindo, Agent
TAQUERIA EL ARRIERO LLC
3530 W NATIONAL AV
Milwaukee, WI 53215

You are requested to attend a hearing which is to be held in Room 301-B, Third Floor, City Hall or you may attend virtually using the link below.

Friday, June 27, 2025 at 09:00 AM

The access code is <https://meet.goto.com/114029581>. Please see the enclosed best practices document for further instructions.

Regarding: Your Class B Tavern, Public Entertainment Premises and Food Dealer Licenses Application Requesting Jukebox and 4 Amusement Machines as agent for "TAQUERIA EL ARRIERO LLC" for "TAQUERIA EL ARRIERO " at 3530 W NATIONAL Av.



There is a possibility that your application may be denied for one or more of the following reasons: The recommendation of the committee regarding the application shall be based on evidence presented at the hearing. Per MCO 85-2.7-4, probative evidence concerning whether or not a new license should be granted may be presented on the following subjects: whether or not the applicant meets the municipal requirements, the appropriateness of the location and premises where the licensed premises is to be located and whether use of the premises for the purposes or activities permitted by the license would tend to facilitate a public or private nuisance or create undesirable neighborhood problems such as disorderly patrons, unreasonably loud noise, litter, and excessive traffic and parking congestion. Probative evidence relating to these matters may be taken from the plan of operation submitted with the license application, if any, but shall not include the content of any music. Evidence regarding the fitness of the location of the premises to be maintained as the principal place of business, including but not limited to whether there is an overconcentration of businesses of the type for which the license is sought; whether the proposal is consistent with any pertinent neighborhood business or development plans, or the location's proximity to areas where children are typically present. The applicant's record in operating similarly licensed premises; and whether or not the applicant has been charged with or convicted of any felony, misdemeanor, municipal offense or other offense, the circumstances of which substantially relate to the activity to be permitted by the license being applied for or any other factor which reasonably relates to the public health, safety or welfare may also be considered. See attached police report or correspondence.

**Notice for applicants with
warrants or unpaid fines:**

Proof of warrant satisfaction or payment of fines must be submitted at the hearing on the above date and time. Failure to comply with this requirement may result in a delay of the granting/denial of your application.

Failure to appear at this meeting may result in the denial of your license. Individual applicants must appear only in person or by an attorney. Corporate or Limited Liability applicants must appear only by the agent designated on the application or by an attorney. Partnership applicants must appear by a partner listed on the application or by an attorney. If you wish to do so and at your own expense, you may be accompanied by an attorney of your choosing to represent you at this hearing.

You will be given an opportunity to speak on behalf of the application and to respond and challenge any charges or reasons given for the denial. No petitions can be accepted by the committee, unless the people who signed the petition are present at the committee hearing and willing to testify. You may present witnesses under oath and you may also confront and cross-examine opposing witnesses under oath. If you have difficulty with the English language, you should bring an interpreter with you, at your expense, so that you can answer questions and participate in your hearing.

You may examine the application file at this office during regular business hours prior to the hearing date. Inquiries regarding this matter may be directed to the person whose signature appears below.

Limited parking for persons attending meetings during normal business hours is available at reduced rates (5 hour limit) at the Milwaukee Center on the southwest corner of Kilbourn Avenue and Water Street. You must present a copy of the meeting notice to the parking cashier.

PLEASE NOTE: Upon reasonable notice, efforts will be made to accommodate the needs of disabled individuals through sign language interpreters or other



**CITY OF MILWAUKEE
OFFICE OF THE CITY CLERK**

Friday, June 13, 2025

COMMITTEE MEETING NOTICE

AD 08

MARTINEZ- PEREZ, Hermelindo, Agent
TAQUERIA EL ARRIERO LLC
2051 W VILTER LN
Milwaukee, WI 53204

You are requested to attend a hearing which is to be held in Room 301-B, Third Floor, City Hall or you may attend virtually using the link below.

Friday, June 27, 2025 at 09:00 AM

The access code is <https://meet.goto.com/114029581>. Please see the enclosed best practices document for further instructions.

Regarding: Your Class B Tavern, Public Entertainment Premises and Food Dealer Licenses Application Requesting Jukebox and 4 Amusement Machines as agent for "TAQUERIA EL ARRIERO LLC" for "TAQUERIA EL ARRIERO " at 3530 W NATIONAL Av.

There is a possibility that your application may be denied for one or more of the following reasons: The recommendation of the committee regarding the application shall be based on evidence presented at the hearing. Per MCO 85-2.7-4, probative evidence concerning whether or not a new license should be granted may be presented on the following subjects: whether or not the applicant meets the municipal requirements, the appropriateness of the location and premises where the licensed premises is to be located and whether use of the premises for the purposes or activities permitted by the license would tend to facilitate a public or private nuisance or create undesirable neighborhood problems such as disorderly patrons, unreasonably loud noise, litter, and excessive traffic and parking congestion. Probative evidence relating to these matters may be taken from the plan of operation submitted with the license application, if any, but shall not include the content of any music. Evidence regarding the fitness of the location of the premises to be maintained as the principal place of business, including but not limited to whether there is an overconcentration of businesses of the type for which the license is sought; whether the proposal is consistent with any pertinent neighborhood business or development plans, or the location's proximity to areas where children are typically present. The applicant's record in operating similarly licensed premises; and whether or not the applicant has been charged with or convicted of any felony, misdemeanor, municipal offense or other offense, the circumstances of which substantially relate to the activity to be permitted by the license being applied for or any other factor which reasonably relates to the public health, safety or welfare may also be considered. See attached police report or correspondence.

**Notice for applicants with
warrants or unpaid fines:**

Proof of warrant satisfaction or payment of fines must be submitted at the hearing on the above date and time. Failure to comply with this requirement may result in a delay of the granting/denial of your application.

Failure to appear at this meeting may result in the denial of your license. Individual applicants must appear only in person or by an attorney. Corporate or Limited Liability applicants must appear only by the agent designated on the application or by an attorney. Partnership applicants must appear by a partner listed on the application or by an attorney. If you wish to do so and at your own expense, you may be accompanied by an attorney of your choosing to represent you at this hearing.

You will be given an opportunity to speak on behalf of the application and to respond and challenge any charges or reasons given for the denial. No petitions can be accepted by the committee, unless the people who signed the petition are present at the committee hearing and willing to testify. You may present witnesses under oath and you may also confront and cross-examine opposing witnesses under oath. If you have difficulty with the English language, you should bring an interpreter with you, at your expense, so that you can answer questions and participate in your hearing.

You may examine the application file at this office during regular business hours prior to the hearing date. Inquiries regarding this matter may be directed to the person whose signature appears below.

Limited parking for persons attending meetings during normal business hours is available at reduced rates (5 hour limit) at the Milwaukee Center on the southwest corner of Kilbourn Avenue and Water Street. You must present a copy of the meeting notice to the parking cashier.

PLEASE NOTE: Upon reasonable notice, efforts will be made to accommodate the needs of disabled individuals through sign language interpreters or other auxiliary aids. For additional information or to request this service, contact the Council Services Division ADA Coordinator at (414) 286-2998. Fax: (414) 286-

Date: 05/20/25
Officer: Diener

City of Milwaukee Police Department
90-5-1.5 Crime Prevention Survey
Tavern Inspection

Name of Premise: Taqueria El Arriero
Address: 3530 W National
Phone:

Owner: Hermelindo Martinez Perez
Owner address: 2501 W Vilter Ln
City State Zip: Milwaukee, WI 53204
Owner Phone: 414-275-0672
Owner email: linomartinez21@gmail.com

Licensee/Agent: Same
Home Address:
City State Zip:
Phone:
Email:

Preferred contact: Same

Location currently open: ☐ YES ☒ NO

Projected open date:

Day's open: ☒S ☐M ☒T ☒W ☒Th ☒F ☒SA ☒ALL

Hours of Operation: Sun: 8a-2a ☐24 hours ☐Y ☒N
Mon: "
Tue: "
Wed: "
Thu: "
Fri: "
Sat: "

- a. ☐ Park
 - b. ☐ School
 - c. ☐ Youth Center
 - d. ☐ Church
 - e. ☐ Tavern(s) If so, how many
 - f. ☒ Residential
 - g. ☒ Other businesses
 - h. ☐ Other:
3. Can you see from the outside of the location into the interior ☒ Yes ☐ No
 4. Can you see the employees inside of the location from the outside ☒ Yes ☐ No
 5. Are exterior windows free of signage ☐ Yes ☒ No
 6. Is there a parking lot ☐ Yes ☒ No
 7. Is the parking lot clean? ☒ Yes ☐ No
 8. Is the parking lot well lit? ☒ Yes ☐ No
 9. Valet Parking ☐ Yes ☒ No
 - a. Will this lot have a guard? ☐ Yes ☐ No
 - b. Will this lot have cameras? ☐ Yes ☐ No
 10. Are there areas where a person could conceal themselves ☐ Yes ☒ No
 11. Is there exterior lighting? ☒ Yes ☐ No. Does it appear to be adequate ☒ Yes ☐ No
 12. Are there No Loitering Signs posted? ☐ Yes ☒ No
 13. Are the address numbers prominently displayed and easy to see ☒ Yes ☐ No

Camera Survey:

14. Does this location have security cameras? ☒ Yes ☐ No
15. Are they in working order? ☒ Yes ☐ No
16. What format are the cameras?
 - a. Color ☒ Yes ☐ No
 - b. Digital ☒ Yes ☐ No
 - c. Recorded ☒ Yes ☐ No
17. How long is footage stored for later viewing: 30 days
18. Are there exterior cameras ☒ Yes ☐ No How many: 4
19. Are there interior cameras ☒ Yes ☐ No How many: 6
20. Do all employees know how to retrieve recorded digital images/footage? ☐ Yes ☒ No
21. Cameras located in parking lot ☒ Yes ☐ No How many 1

Interior Survey:

22. What is the planned capacity 80
23. What is the minimum number of employees That will be on premise 3

a. Did you provide a district contact guide to the owner? ☐ Yes ☒ No

Security

30. How many security personnel are going to be employed: 1

31. How will they be deployed: Interior ☐ Exterior ☐

32. What days will they be deployed ☐ Mon ☐ Tue ☐ Wed ☐ Thu ☒ Fri ☒ Sat ☐ Sun

33. Will the security be managed by business ☒ or contracted ☐

34. Will they be armed ☐ Yes ☒ No

35. What type of security measures to be used:

☐ Wandering/metal detector

☐ ID Scanner

☐ Dress Code

☐ Cover Charge

☐ Age restriction

☒ Other Checking Id's

ADDITIONAL COMMENTS/RECOMMENDATIONS:

Business is currently not open. They have plans to install 10 cameras. They will hire a security guard for weekend nights only.

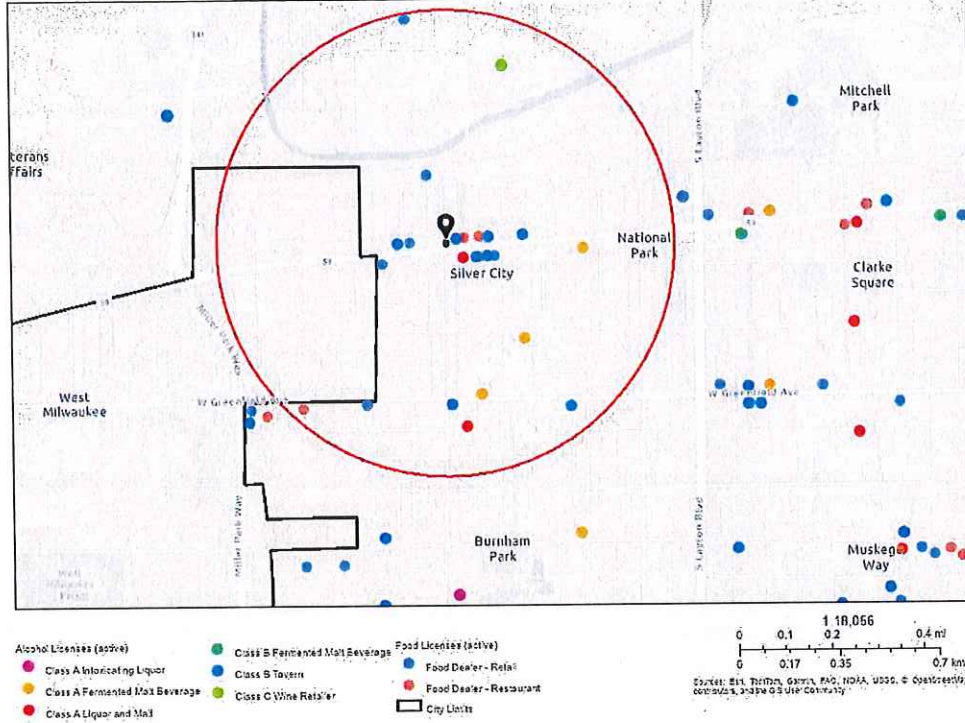

4	MAMIE'S	MAMIE'S	DEBRA L MICKEY, Agt	3300 W NATIONAL AV	Food Dealer - Restaurant		6/29/2025, 7:00 PM	1
5	ALDI, INC	ALDI #87	Matteo G Allred, Agt	1441 S 35TH ST	Food Dealer Retail		7/10/2025, 7:00 PM	1
6	ATLANTISVAL LEY FOODS, LLC	ATLANTISVAL LEY FOODS, LLC	Michael Swanson, Agt	3700 W MILWAUKEE RD	Food Dealer Retail		8/4/2025, 7:00 PM	1
7	Taqueria Los 3 Carnales LLC	Taqueria Los 3 Carnales	Alfredo Cardenas, Agt	3514 W National AV	Food Dealer - Restaurant		10/17/2025, 7:00 PM	1
8	Bamboo LLC	Bamboo	Jay Xa Khongmany, Agt	3427 W NATIONAL AV	Food Dealer - Restaurant		10/28/2025, 7:00 PM	1
9	Vientiane Noodle Shop	Vientiane Noodle Shop	Duan Nguyen, SP	3422 W NATIONAL AV	Food Dealer - Restaurant		10/23/2025, 7:00 PM	1
10	National Beer & Food Mart, LLC	National Food	JASMINDER SINGH, Agt	3101 W National AV	Food Dealer Retail		9/23/2025, 7:00 PM	1
11	THAI BARBECUE, LLC	THAI BAR-B- QUE	XAY CHAI, Agt	3417 W NATIONAL AV	Food Dealer - Restaurant		11/5/2025, 6:00 PM	1
12	Forest Home Ave Chicken Palace LLC	Chicken Palace National	VALDEMAR ESCOBAR, Agt	3433 W National AV	Food Dealer - Restaurant		11/25/2025, 6:00 PM	1
13	FIRST STOP FOODS	FIRST STOP FOODS	ABDELMUNA MA ASAD, SP	1330 S 35TH ST	Food Dealer Retail		12/19/2025, 6:00 PM	1
14	Scott Beer & Food LLC	El Rincon Grocery	GURMUKH SINGH, Agt	1201 S 33rd ST	Food Dealer Retail		12/11/2025, 6:00 PM	1
15	Taqueria El Rodeo, LLC	Taqueria EL Rodeo	Francisco Santos Leon, Agt	3535 W GREENFIELD AV	Food Dealer - Restaurant		1/21/2026, 6:00 PM	1
16	LAO FOODS GROUP, LLC	ASIAN INTERNATIO NAL MARKET	Bouachanh Phonthavisouk , Agt	3401 W NATIONAL AV	Food Dealer Retail		1/6/2026, 6:00 PM	1
17	Missy Sweets Lounge LLC	Missy Sweets Lounge	Melissa M Hoepfner, Agt	3412 W National AV	Food Dealer - Restaurant		11/30/2025, 6:00 PM	1
18	Energy & Nutrition LLC	Energy Place MKE	Adelina Lopez Morales, Agt	1401 S 38th ST	Food Dealer Retail		1/28/2026, 6:00 PM	1
19	PK PALACE, LLC	PK Palace	Rick K Vang, Agt	3730 W NATIONAL AV	Food Dealer - Restaurant		3/4/2026, 6:00 PM	1
20	SUNRISE NUTRITION MKE LLC	Sunrise Nutrition	Ma de los Angeles Hernandez Arce, Agt	3700 W NATIONAL AV	Food Dealer Retail		2/24/2026, 6:00 PM	1
21	Palermo Villa, Inc	Pizzeria 3301	Laurie Ann Fallucca, Agt	3301 W Canal ST	Food Dealer - Restaurant		4/7/2026, 7:00 PM	1

25	National Grocery, LLC	National Grocery	National Singh, Agt	National AV	Retail		7:00 PM	1
----	-----------------------	------------------	---------------------	-------------	--------	--	---------	---

Alcohol Licenses

4	THAI BARBECUE, LLC	THAI BAR-B-QUE	XAY CHAI, Agt	3417 W NATIONAL AV	Class B Tavern License		11/5/2025, 6:00 PM	1
5	Forest Home Ave Chicken Palace LLC	Chicken Palace National	VALDEMAR ESCOBAR, Agt	3433 W National AV	Class B Tavern License	65	11/25/2025, 6:00 PM	1
6	Rain 24, LLC	Rain 24	ESMERALDA NAVARRETE GONZALEZ, Agt	3121 W GREENFIELD AV	Class B Tavern License		11/12/2025, 6:00 PM	1
7	FIRST STOP FOODS	FIRST STOP FOODS	ABDELMUNA MAASAD, SP	1330 S 35TH ST	Class A Fermented Malt Beverage Retailer's License		12/19/2025, 6:00 PM	1
8	Scott Beer & Food LLC	El Rincon Grocery	GURMUKH SINGH, Agt	1201 S 33rd ST	Class A Fermented Malt Beverage Retailer's License		12/11/2025, 6:00 PM	1
9	Missy Sweets Lounge LLC	Missy Sweets Lounge	Melissa M Hoepfner, Agt	3412 W National AV	Class B Tavern License		10/31/2025, 7:00 PM	1
10	PK PALACE, LLC	PK Palace	Rick K Vang, Agt	3730 W NATIONAL AV	Class B Tavern License		3/4/2026, 6:00 PM	1
11	Palermo Villa, Inc	Pizzeria 3301	Laurie Ann Fallucca, Agt	3301 W Canal ST	Class B Fermented Malt Beverage Retailer's License		4/7/2026, 7:00 PM	1
12	Palermo Villa, Inc	Pizzeria 3301	Laurie Ann Fallucca, Agt	3301 W Canal ST	Class C Wine Retailer's License		4/7/2026, 7:00 PM	1
13	LEVA ENTERPRISE S SOUTH LLC	Orenda	Leticia C Munoz Hernandez, Agt	3514 W NATIONAL AV	Class B Tavern License		4/23/2026, 7:00 PM	1
14	National Grocery, LLC	National Grocery	Manpreet Singh, Agt	3501 W National AV	Class A Malt & Class A Liquor License		4/20/2026, 7:00 PM	1
15	Taqueria El Rodeo, LLC	Taqueria EL Rodeo	Francisco Santos Leon, Agt	3535 W GREENFIELD AV	Class B Tavern License	48	4/23/2026, 7:00 PM	1

Establishments within a 0.5 miles radius centered on area of interest.

MARTINEZ- PEREZ, Hermelindo, Agent
TAQUERIA EL ARRIERO at 3530 W National Av
Class B Tavern, Public Entertainment Premises and Food Dealer Licenses Application Requesting
Jukebox and 4 Amusement Machines

Friday, June 27, 2025 at 9:00 AM

To whom it may concern:

The above application has been made by the above named applicant(s). This requires approval from the Licenses Committee and the Common Council of the City of Milwaukee. The hearing before the Licenses Committee will take place on 6/27/2025 at 9:00 AM in Room 301-B, Third Floor, City Hall. This is a public hearing. Those wishing to view the proceeding are able to do so via the City Channel – Channel 25 on Spectrum Cable – or on the Internet at <http://city.milwaukee.gov/citychannel>. Those wishing to provide oral testimony via internet are asked to contact the staff assistant, Yadira Melendez at (414) 286-2775 or stasst5@milwaukee.gov for necessary information. Please make such requests no later than one business day prior to the start of the meeting. You are not required to attend the hearing, but please see the information below if you would like to provide testimony. Once the Licenses Committee makes its recommendation, this recommendation is forwarded to the full Common Council for approval at its next regularly scheduled hearing.

**Important details for those wishing to provide information for the
Licenses Committee to consider when making its recommendation:**

1. The license application is scheduled to be heard at the above time. Due to other hearings running longer than scheduled, you may have to wait some time to provide your testimony.
2. You must appear in person and testify as to matters that you have personally experienced or seen. (You cannot provide testimony for your neighbor, parent or anyone else; this is considered hearsay and cannot be considered by the committee.)
3. No letters or petitions can be accepted by the committee (unless the person who wrote the letter or the persons who signed the petition are present at the committee hearing and willing to testify).
4. Persons opposed to the license application are given the opportunity to testify first; supporters may testify after the opponents have finished.
5. When you are called to testify, you will be sworn in and asked to give your name, and address. (If your first and/or last names are uncommon please spell them.)
6. You may then provide testimony.
 - a. Include only information relating to the above license application.
 - b. Include only information you have personally witnessed or seen.
 - c. Provide concise and relevant information detailing how this business has affected or may affect the peaceful enjoyment of your neighborhood.
 - d. If by the time you have the opportunity to testify, the information you wish to share has already been provided to the committee, you may state that you agree with the previous testimony. Redundant or repetitive testimony will not assist the committee in making its recommendation.
7. After giving your testimony, the members of the Licenses Committee and the licensee may ask questions regarding the testimony you have given or other factors relating to the license application.
8. Business Competition is not a valid basis for denial or non-renewal of a license.
Please Note: If you have submitted an objection to the above application your objection cannot be considered by the committee unless you personally testify at the hearing.

CURRENT OCCUPANT	3523 W NATIONAL AVE# 1	MILWAUKEE, WI 53215-1024
CURRENT OCCUPANT	3523 W NATIONAL AVE# 2	MILWAUKEE, WI 53215-1024
CURRENT OCCUPANT	3523 W NATIONAL AVE# 3	MILWAUKEE, WI 53215-1024
CURRENT OCCUPANT	3526 W NATIONAL AVE	MILWAUKEE, WI 53215-1025
CURRENT OCCUPANT	3526 W NATIONAL AVE# A	MILWAUKEE, WI 53215-1025
CURRENT OCCUPANT	3528 W NATIONAL AVE	MILWAUKEE, WI 53215-1025
CURRENT OCCUPANT	3602 W NATIONAL AVE	MILWAUKEE, WI 53215-1027
CURRENT OCCUPANT	3602A W NATIONAL AVE	MILWAUKEE, WI 53215-1027
CURRENT OCCUPANT	3605B W NATIONAL AVE	MILWAUKEE, WI 53215-1026
CURRENT OCCUPANT	3606 W NATIONAL AVE	MILWAUKEE, WI 53215-1027
CURRENT OCCUPANT	3606A W NATIONAL AVE	MILWAUKEE, WI 53215-1027
CURRENT OCCUPANT	3607 W NATIONAL AVE	MILWAUKEE, WI 53215-1026
CURRENT OCCUPANT	3610 W NATIONAL AVE	MILWAUKEE, WI 53215-1027
CURRENT OCCUPANT	3615 W NATIONAL AVE# 1	MILWAUKEE, WI 53215-1039
CURRENT OCCUPANT	3615 W NATIONAL AVE# 10	MILWAUKEE, WI 53215-1040
CURRENT OCCUPANT	3615 W NATIONAL AVE# 11	MILWAUKEE, WI 53215-1040
CURRENT OCCUPANT	3615 W NATIONAL AVE# 12	MILWAUKEE, WI 53215-1040
CURRENT OCCUPANT	3615 W NATIONAL AVE# 13	MILWAUKEE, WI 53215-1040
CURRENT OCCUPANT	3615 W NATIONAL AVE# 14	MILWAUKEE, WI 53215-1040
CURRENT OCCUPANT	3615 W NATIONAL AVE# 15	MILWAUKEE, WI 53215-1041
CURRENT OCCUPANT	3615 W NATIONAL AVE# 16	MILWAUKEE, WI 53215-1041
CURRENT OCCUPANT	3615 W NATIONAL AVE# 17	MILWAUKEE, WI 53215-1041
CURRENT OCCUPANT	3615 W NATIONAL AVE# 18	MILWAUKEE, WI 53215-1041
CURRENT OCCUPANT	3615 W NATIONAL AVE# 19	MILWAUKEE, WI 53215-1041
CURRENT OCCUPANT	3615 W NATIONAL AVE# 2	MILWAUKEE, WI 53215-1039
CURRENT OCCUPANT	3615 W NATIONAL AVE# 20	MILWAUKEE, WI 53215-1041
CURRENT OCCUPANT	3615 W NATIONAL AVE# 21	MILWAUKEE, WI 53215-1041
CURRENT OCCUPANT	3615 W NATIONAL AVE# 22	MILWAUKEE, WI 53215-1041
CURRENT OCCUPANT	3615 W NATIONAL AVE# 23	MILWAUKEE, WI 53215-1041
CURRENT OCCUPANT	3615 W NATIONAL AVE# 24	MILWAUKEE, WI 53215-1041
CURRENT OCCUPANT	3615 W NATIONAL AVE# 25	MILWAUKEE, WI 53215-1042
CURRENT OCCUPANT	3615 W NATIONAL AVE# 26	MILWAUKEE, WI 53215-1042
CURRENT OCCUPANT	3615 W NATIONAL AVE# 27	MILWAUKEE, WI 53215-1042
CURRENT OCCUPANT	3615 W NATIONAL AVE# 28	MILWAUKEE, WI 53215-1042
CURRENT OCCUPANT	3615 W NATIONAL AVE# 3	MILWAUKEE, WI 53215-1039
CURRENT OCCUPANT	3615 W NATIONAL AVE# 4	MILWAUKEE, WI 53215-1039
CURRENT OCCUPANT	3615 W NATIONAL AVE# 5	MILWAUKEE, WI 53215-1039
CURRENT OCCUPANT	3615 W NATIONAL AVE# 6	MILWAUKEE, WI 53215-1039
CURRENT OCCUPANT	3615 W NATIONAL AVE# 7	MILWAUKEE, WI 53215-1039

CURRENT OCCUPANT	727 S 35TH ST	MILWAUKEE, WI 53215-1036
CURRENT OCCUPANT	729 S 35TH ST	MILWAUKEE, WI 53215-1036
CURRENT OCCUPANT	733 S 35TH ST	MILWAUKEE, WI 53215-1036
CURRENT OCCUPANT	735 S 35TH ST	MILWAUKEE, WI 53215-1036
CURRENT OCCUPANT	736 S 36TH ST	MILWAUKEE, WI 53215-1017
CURRENT OCCUPANT	737 S 35TH ST	MILWAUKEE, WI 53215-1036
CURRENT OCCUPANT	737 S 36TH ST	MILWAUKEE, WI 53215-1016
CURRENT OCCUPANT	739 S 35TH ST	MILWAUKEE, WI 53215-1036
CURRENT OCCUPANT	740 S 36TH ST	MILWAUKEE, WI 53215-1017
CURRENT OCCUPANT	743 S 35TH ST	MILWAUKEE, WI 53215-1036
CURRENT OCCUPANT	743 S 36TH ST	MILWAUKEE, WI 53215-1016
CURRENT OCCUPANT	743A S 36TH ST	MILWAUKEE, WI 53215-1016
CURRENT OCCUPANT	744 S 36TH ST	MILWAUKEE, WI 53215-1017
CURRENT OCCUPANT	745 S 35TH ST	MILWAUKEE, WI 53215-1036
CURRENT OCCUPANT	747 S 35TH ST	MILWAUKEE, WI 53215-1036
CURRENT OCCUPANT	749 S 35TH ST	MILWAUKEE, WI 53215-1036
CURRENT OCCUPANT	800 S 36TH ST	MILWAUKEE, WI 53215-1019
CURRENT OCCUPANT	800 S 37TH ST	MILWAUKEE, WI 53215-1023
CURRENT OCCUPANT	803 S 36TH ST	MILWAUKEE, WI 53215-1018
CURRENT OCCUPANT	803 S 36TH ST# A	MILWAUKEE, WI 53215-1018
CURRENT OCCUPANT	804 S 36TH ST	MILWAUKEE, WI 53215-1019
CURRENT OCCUPANT	806 S 36TH ST	MILWAUKEE, WI 53215-1019
CURRENT OCCUPANT	806 S 37TH ST	MILWAUKEE, WI 53215-1023
CURRENT OCCUPANT	806A S 36TH ST	MILWAUKEE, WI 53215-1019
CURRENT OCCUPANT	807 S 36TH ST	MILWAUKEE, WI 53215-1018
CURRENT OCCUPANT	810 S 36TH ST	MILWAUKEE, WI 53215-1019
CURRENT OCCUPANT	810 S 37TH ST	MILWAUKEE, WI 53215-1023
CURRENT OCCUPANT	811 S 36TH ST	MILWAUKEE, WI 53215-1018
CURRENT OCCUPANT	813 S 36TH ST	MILWAUKEE, WI 53215-1018
CURRENT OCCUPANT	814 S 36TH ST	MILWAUKEE, WI 53215-1019
CURRENT OCCUPANT	814 S 37TH ST	MILWAUKEE, WI 53215-1023
CURRENT OCCUPANT	816 S 36TH ST	MILWAUKEE, WI 53215-1019
CURRENT OCCUPANT	817 S 36TH ST	MILWAUKEE, WI 53215-1018
CURRENT OCCUPANT	817A S 36TH ST	MILWAUKEE, WI 53215-1018
CURRENT OCCUPANT	818 S 36TH ST	MILWAUKEE, WI 53215-1019
CURRENT OCCUPANT	818 S 37TH ST	MILWAUKEE, WI 53215-1023
CURRENT OCCUPANT	818A S 36TH ST	MILWAUKEE, WI 53215-1019
CURRENT OCCUPANT	819 S 36TH ST	MILWAUKEE, WI 53215-1018
CURRENT OCCUPANT	819A S 36TH ST	MILWAUKEE, WI 53215-1018

CURRENT OCCUPANT	907 S 35TH ST# 4	MILWAUKEE, WI 53215-1405
CURRENT OCCUPANT	907 S 36TH ST	MILWAUKEE, WI 53215-1411
CURRENT OCCUPANT	907A S 36TH ST	MILWAUKEE, WI 53215-1411
CURRENT OCCUPANT	907B S 36TH ST	MILWAUKEE, WI 53215-1411
CURRENT OCCUPANT	909 S 36TH ST	MILWAUKEE, WI 53215-1411
CURRENT OCCUPANT	909A S 36TH ST	MILWAUKEE, WI 53215-1411
CURRENT OCCUPANT	915 S 35TH ST	MILWAUKEE, WI 53215-1405
CURRENT OCCUPANT	918 S 36TH ST	MILWAUKEE, WI 53215-1412
CURRENT OCCUPANT	918A S 36TH ST	MILWAUKEE, WI 53215-1412
CURRENT OCCUPANT	920 S 36TH ST	MILWAUKEE, WI 53215-1412
CURRENT OCCUPANT	921 S 35TH ST	MILWAUKEE, WI 53215-1405
CURRENT OCCUPANT	921A S 35TH ST	MILWAUKEE, WI 53215-1405
CURRENT OCCUPANT	922 S 36TH ST	MILWAUKEE, WI 53215-1412

Blank Notice

Total Records: 114

Radius 250 feet and Center of the Circle: 3530 W National Av

Provide a detailed description of the type of business you plan on operating:

RESTAURANT/BAR

Do you have any experience operating this type of business? ☐ No ☒ Yes If yes, explain: EXPERIENCE IN THE FOOD INDUSTRY

2. Business Operations

- a. Proposed Opening Date: 05/12/25
- b. Is this premise under construction? ☒ No ☐ Yes If yes, list estimated completion date: _____
- c. Is this a franchise? ☒ No ☐ Yes
- d. Is this premises currently licensed? ☐ No ☒ Yes If yes, list type of license: RESTAURANT
- e. Is the current licensee operating? ☒ No ☐ Yes If no, list date closed: _____
- f. Do you have future plans for other businesses, licenses or permits at this location? ☒ No ☐ Yes
If yes, explain: _____
- g. Have you previously held an Extended Hours License in Milwaukee? ☒ No ☐ Yes
If yes, list address(es): _____
- h. Are other businesses operating in the same building? ☒ No ☐ Yes If yes, describe: _____

3. Litter & Noise

- a. How are grounds kept clean? ☒ Sweep ☒ Pressure Wash ☒ Pick Up Litter ☐ Other: _____
- b. How often will grounds be cleaned? ☒ Daily ☐ Weekly ☐ As Needed ☐ Monthly ☐ Other: _____
- c. Grounds cleaned by: ☒ Licensee ☐ Building Owner ☒ Employees ☐ Hired Maintenance ☐ Other: _____
- d. How are noise issues prevented and/or addressed? ☒ Security ☐ Manager approaches customer(s) ☒ Call Police
☒ Signs Posted ☐ Other: _____
- e. Will a sound amplification system be used? ☐ No ☒ Yes If yes, describe: SPEAKERS

4. Smoking & Sanitation

- a. Are there designated outdoor smoking areas? ☒ No ☐ Yes If yes, describe: _____
- b. Number of Garbage Cans: Inside: 2 Locations: BEHIND THE BAR ON THE SIDE MAIN DOOR
Outside: 2 Locations: ON THE SIDE OF THE BUILDING
- c. Is a crowd control barrier used? ☒ No ☐ Yes If yes, describe: _____
- d. How many restrooms are on the premises? 2
- e. Name of solid waste contractor: ☐ Advanced Disposal ☒ Waste Management ☐ Other: _____

- c. Will you have licensed security on premise? ☒ No ☐ Yes If yes, how many? _____
- What are their responsibilities? _____
- Describe equipment used _____
- List their License Number (s) _____
- d. Will there be security cameras? ☐ No ☒ Yes If yes, how many? 4 and list locations: 2 ON THE OUTSIDE OF THE BUILDING AND 2 INSIDE OF THE BUILDING
- e. Will searches/identification checks be done upon entry? ☒ No ☐ Yes If yes, describe _____

6. Percentage of Sales (must total 100%)

Alcohol <u>20</u> %	Food <u>80</u> % Cigarettes, Electronic Vape Devices, Tobacco Products _____ %	Secondhand Merchandise _____ %	Precious Metals & Gems _____ %
Entertainment _____ %	Pawnbroker Activity _____ %	Salvaged Materials _____ % (such as scrap metal)	Personal Services (such as tattoo, body piercing, salon, tailor, tanning, etc.) _____ %
		Other _____ % Describe: _____	

7. Businesses/Licenses on the Premises (check all that apply):

Type 1

- ☒ Full Service Restaurant ☐ Cafe/Coffee Shop ☐ Deli or Fast Food Restaurant ☐ Private/Fraternal/Veterans Club
- ☐ Night Club ☐ Tavern ☐ Cocktail Lounge ☐ Teen Club
- ☐ Banquet Hall ☐ Sports Facility ☐ Bowling Alley
- ☐ Hotel/Motel : Number of Floors: _____ Number of Rooms: _____
- ☐ Rooming House: Number of Floors: _____ Number of Rooms: _____

Type 2

- ☐ Liquor Store ☐ Corner Store ☐ Supermarket ☐ Convenience Store
- ☐ Gas Station ☐ Amusement/Phonograph Distributor ☐ Recycling, Salvage or Towing
- ☐ Used Car Dealer ☐ Personal Service Establishment
(such as tattoo business, hair salon, tailor, etc.) ☐ Recording Studio

What other licenses/permits will you hold at this location? (check all that apply)

- ☒ Occupancy Permit ☐ Cigarette, Tobacco, Electronic Vape Products ☐ Gas Station ☐ Extended Hours ☐ Class "B" Tavern ☐ Weights & Measures
- ☐ Secondhand Dealer ☐ Precious Metal & Gem ☐ Other: _____

8. Legal Capacity (only if a Type 1 premises in #7 above)

Capacity 100 (Call the Milwaukee Development Center at 414-286-8211 if you have questions.)

- c. Nearest Major Cross Street: _____
- d. Describe Building: ☒ Free Standing Building ☐ Strip Mall ☐ Other: _____
- e. Describe Premises Structure: ☒ Single Story ☐ Multi-Story - # of Stories _____ ☐ Other: _____
- f. Describe Surrounding Area: ☒ Commercial ☐ Residential ☐ Industrial ☐ Other: _____
- g. Building Owner Name: PATRICIA ORTIZ Phone Number: 4147790029
- Building Owner Address: 5130 W FORESTHOME AVE MILWAUKEE WI

10. Hours of Operation & Customers

Will customers be entering the premises? ☐ No ☒ Yes

Day of the Week	Proposed Hours of Operation:		Estimated Number of Customers expected each day	Potential Age Range of Customers	Class B Tavern Applicant Only: Age Restriction (If none, write 'None')
	Open Time (include a.m. or p.m.)	Close Time (include a.m. or p.m.)			
Sunday	8:00AM	2:00AM	60	20+	
Monday	8:00AM	2:00AM	20	20+	
Tuesday	8:00AM	2:00AM	20	20+	
Wednesday	8:00AM	2:00AM	20	20+	
Thursday	8:00AM	2:00AM	35	20+	
Friday	8:00AM	2:00AM	40	20+	
Saturday	8:00AM	2:00AM	65	20+	

An Extended Hours Establishment License is required for any convenience store, filling station, personal service establishment (such as tattoo, body piercing, salon, tailor, tanning, etc.), recording studio or restaurant which is open between the hours of 12:00 a.m. and 5:00 a.m.

Alcohol Establishments Class A: 8:00 am to 9:00 pm Sunday thru Saturday
 Permitted Hours of Operation: Class B: 6:00 am to 2:00 am Sunday thru Thursday, 6:00 am to 2:30 am Friday & Saturday

Entertainment Outdoor Closing Hours: 10:00pm Sunday-Thursday; 12:00am Friday & Saturday; unless a different time, either earlier or later, is established by the Common Council in its approval of the licensee's plan of operation.

11. Signature(s)

 Signature of Sole Proprietor, Partner, or 20% or more Shareholder
 (If there are no 20% or more shareholders,
 Corporate Officer-print name/title and sign)

 Signature of additional partner or 20% or more shareholder

See Application Information for a complete list of all required application forms.

Is the building within 300 feet of any church, school, daycare center or hospital?

☒ No ☐ Yes

"Service Bar Only" Designation

If applying for Class B or C license, are you applying for "Service Bar Only"?

☒ No ☐ Yes

Service Bar Only means customers cannot sit at the bar. Alcohol is served to employees who serve patrons seated at tables. No stools, chairs or other articles of furniture shall be placed at the service bar for patrons to sit upon.

Business Information

a) Are you taking out this application for anyone that may not be eligible for a license?

☒ No ☐ Yes

If yes, list their name and address: _____

b) Will the agent, a partner or the individual licensee be conducting the day-to-day operations of the business? ☐ No ☒ Yes

If no, list the name and address of the person(s) who will: _____

Class B Applicants: If the agent, a partner or the individual licensee will not be conducting the day-to-day operations of the business, the person(s) listed above must obtain a Class B Managers license.

c) Does anyone else have money invested or any other interest in this business? ☒ No ☐ Yes

If yes, explain: _____

d) Have you made an agreement with anyone to repay any loan or any other payments based upon income from the business?

☒ No ☐ Yes If yes, list name and address: _____

Property Information (New & Transfer Applicants Only)

a) Do you own or lease the building? ☐ Own ☒ Lease

b) Who owns the fixtures (for example, coolers, etc.)? I OWN THEM _____

c) Are you purchasing the stock and/or fixtures? ☒ No ☐ Yes If yes, amount paid \$ _____

d) Total amount paid for business \$ N/A _____

e) Total amount paid for goodwill of the business \$ N/A _____

Goodwill comprises the reputation and customer relationships of an existing business. If the price you pay for the business exceeds the fair market value of all of the rest of the assets of the business, the excess may be considered goodwill.

f) Have you made arrangements with the seller for payment of personal property taxes? ☒ No ☐ Yes

Lease Information (New & Transfer Applicants who are leasing the premises only)

a) Date lease begins 04/1/25 _____ Ends 03/31/27 _____

b) Monthly rental \$ 3700 _____

c) Do you have an option to renew the lease? ☐ No ☒ Yes

d) Does your lease allow for assignment to another party without the consent of the owner? ☒ No ☐ Yes

e) For what length of time have you been guaranteed occupancy (number of years)? 2 YEARS _____

If no, a new floor plan is not required. If yes, submit a new floor plan and explain the change(s):

Signature

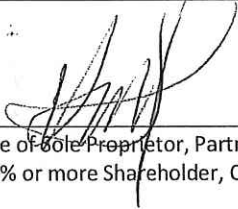

Signature of Sole Proprietor, Partner or 20% or More Shareholder
(If no 20% or more Shareholder, Corporate Officer - print name/title and sign)

Note: All information contained in this application is subject to approval by the Common Council.

Deviating from approved plan of operation will subject licensee to citations, and/or suspension or non-renewal of the license.

Contact the License Division for information on how to request changes.

New and transfer of premises applicants must submit the following:

☐ Detailed floor plan

☐ If a restaurant, copy of the menu

What will be the majority of your food sales? (check one)

☒ Restaurant Items (meals):

MEALS include, but are not limited to, chicken, ribs, sandwiches, roasted corn, baked potatoes, hot dogs, brats, tacos, nachos w/ cheese and meat, French fries, cooked or deep fried vegetables/fruit, cooked cheese curds, corn dogs, egg rolls, salads.

☐ Retail Items (snacks and beverages):

RETAIL items include, but are not limited to, ice cream/soft serve, lemonade, snow cones, coffee, espresso, cappuccino, tea, fruit juice, smoothies, candy, dispensed soda, fruit cups, bakery, cookies, kettle corn, cotton candy, funnel cakes, fritters, tortilla chips w/ cheese.

Will it be a convenience store? ☐ Yes ☒ No

A convenience store contains less than 7,500 square feet of retail space and has, as its primary business, the sale of basic food items and in addition, sells household products or is a filling station that sells basic food items and household products.

☐ Bed & Breakfast

☐ Micro Market

All Applicants: Submit a menu or a list of food items that will be sold.

Will any wholesale business be done? ☒ No ☐ Yes If yes, what percentage of food sales will be wholesale?

☐ Less than 25%

☐ 25% or More AND:

☐ Restaurant items (meals) will be sold – Complete this application and also contact DATCP.

☐ NO restaurant items (meals) will be sold - Do NOT complete this application. Contact DATCP only.

SECTION 2 FOOD PROCESSING

Will any food processing be done? ☐ No ☒ Yes

Processing is defined as assembling, grinding, cutting, mixing, baking, coating, stuffing, packing, bottling, grilling, canning, extracting, fermenting, distilling, pickling, freezing, drying, smoking, or packaging.

SECTION 3 FOOD REQUIRING TEMPERATURE CONTROL

Will any food that requires temperature control be sold? ☐ No ☒ Yes
(includes dairy products such as milk, cheese, and ice cream, fish, shellfish, meat, poultry)

If yes, list the types of food items: MILK , FISH, SHELLFISH ,MEAT ,POULTRY

Will scales or barcode scanners be used? ☒ No ☐ Yes - You must also apply for a Weights & Measures License.

SECTION 5 ADDITIONAL SITES

Where will food be prepared and/or sold?

☒ At a single site ☐ At multiple sites: How many? _____ (for example, a hotel with several dining rooms or bars)

If multiple sites, attach a Food Dealer Additional Site Addendum (ccl-foodadd) for each additional site.

SECTION 6 CONSTRUCTION OR CHANGES

Are you planning any construction, remodeling or equipment changes?

☒ No If No, SKIP to Section 7

☐ Yes If Yes, check all that apply: ☐ New construction of a building ☐ Renovation or remodeling
☐ Construction changes to existing building ☐ Equipment changes only

Provide a brief description of the changes: _____

Start date: _____

Name, Address & Phone Number of Architect: _____

Name, Address & Phone Number of Contractor: _____

SECTION 7 ALCOHOL BEVERAGES

Are you applying for an alcohol beverage license?

☐ No If No, SKIP to Section 8

☒ Yes If YES, if your food license is approved prior to the alcohol license, when do you want the food license issued?

☒ Immediately ☐ At the same time as the alcohol license

SECTION 8 ACKNOWLEDGEMENTS & SIGNATURE

You must initial each item confirming your understanding:

HM I understand the Health Department must conduct an inspection and advise the License Division of their approval before the license may be issued.

HM I understand I must obtain an occupancy permit from the Department of Neighborhood Services and an inspection may be required. Neighborhood Services must advise the License Division of their approval before the license may be issued.

HM I understand the district alderperson will review and either support or object to my application. If he/she objects, I may appeal and be scheduled to appear before the Licenses Committee. The Licenses Committee will then make a recommendation to the Common Council. The Common Council must grant the license before it may be issued.

HM I understand proof of payment for all license fees must be on file in the License Division before the license may be issued and the license must be issued and posted in my establishment prior to opening for business.

HM I will not operate my food business until the license has been issued and posted in the establishment.

Signature of Sole Proprietor, Partner, or 20% Shareholder: _____

Signature of Additional Partner: _____

<input type="checkbox"/> Instrumental Musicians	<input type="checkbox"/> Battle of the Bands	<input type="checkbox"/> Dancing by Performers	How many? <u>4</u>
<input type="checkbox"/> Bands	<input type="checkbox"/> Comedy Acts	<input type="checkbox"/> Adult Entertainment/ Strippers/Erotic Dance	<input type="checkbox"/> Concerts
How many? _____			Approx. # per year? _____
<input type="checkbox"/> Bowling Alley	<input type="checkbox"/> Disc Jockey	<input type="checkbox"/> Wrestling	<input type="checkbox"/> Theatrical Performances
How many? _____			Approx. # per year? _____
<input type="checkbox"/> Pool Tables	<input type="checkbox"/> Magic Shows	<input type="checkbox"/> Patron Contests	<input checked="" type="checkbox"/> Jukebox
How many? _____			
<input type="checkbox"/> Motion Pictures (movies by admission) - How many? _____	<input type="checkbox"/> Poetry Readings	<input type="checkbox"/> Patrons Dancing	<input type="checkbox"/> Karaoke
<input type="checkbox"/> Other: _____			

Entertainment Outdoor Closing Hours: 10:00pm Sunday-Thursdays; 12:00am Friday & Saturday; unless a different time, either earlier or later,
Is established by the Common Council in its approval of the licensee's plan of operation.

PROMOTERS/SOUND AMPLIFICATION

Will promoters ever be used for any of the entertainment? ☒ No ☐ Yes If Yes, Describe:

At any time will sound amplification be used? ☒ No ☐ Yes If Yes, Describe:

LEGAL CAPACITY OF PREMISES

100 (Call the Development Center at 414-286-8211 with questions.) Legal capacity determines the fee for your Public Entertainment
Premises License. If you would like to request the license be approved with a lower capacity than that listed above, indicate the lower capacity
here: _____. If approved, this lower capacity will print on your license and override the capacity listed on your Occupancy Permit.

ACKNOWLEDGEMENT/SIGNATURE

I understand that after the license has been issued, a change to the plan of operation will require a written request to change and approval from
the Common Council. I agree to inform the City Clerk within 10 days of any substantial changes in the information supplied in this application.
I understand that I shall not willfully refuse to provide the services offered under this license, or add charges or require deposits not required of
the general public because of race, color, sex, religion, national origin or ancestry, age, handicap, lawful source of income, marital status, sexual
orientation, gender identity or expression, familial status or the fact that a person is now or has been a member of the military service, whether
dressed in uniform or not; and shall not seek such information as a condition of employment, or penalize any employee or discriminate in the
selection of personnel for training or promotion on the basis of such information.

I have knowledge of the City Ordinances currently regulating public entertainment, and understand that the license may be subject to
suspension, non-renewal or revocation, if I violate any rule, law or regulation of the city of Milwaukee and State of Wisconsin.

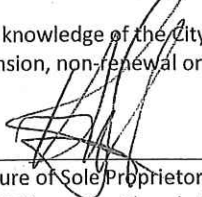

Signature of Sole Proprietor, Partner or 20% or More Shareholder
(If no 20% or more Shareholder, Corporate Officer - print name/title and sign)

Office Use Only:

Initials: _____ Filed: _____ App: _____

Only PEP? ☐ No ☐ Yes If Yes, ☐ Queue to MPD and ☐ Email Mgrs/Team Lead (must be heard w/in 60 days)

LEGEND
 INDICAT
 EXISTIN
 1 3 W
 2 4 W
 3 5 F
 4 6 F
 5 7 F
 6 8 F
 7 9 F
 8 10 F
 9 11 F
 10 12 F
 11 13 F
 12 14 F
 13 15 F
 14 16 F
 15 17 F
 16 18 F
 17 19 F
 18 20 F
 19 21 F
 20 22 F
 21 23 F
 22 24 F
 23 25 F
 24 26 F
 25 27 F
 26 28 F
 27 29 F
 28 30 F
 29 31 F
 30 32 F
 31 33 F
 32 34 F
 33 35 F
 34 36 F
 35 37 F
 36 38 F
 37 39 F
 38 40 F
 39 41 F
 40 42 F
 41 43 F
 42 44 F
 43 45 F
 44 46 F
 45 47 F
 46 48 F
 47 49 F
 48 50 F
 49 51 F
 50 52 F
 51 53 F
 52 54 F
 53 55 F
 54 56 F
 55 57 F
 56 58 F
 57 59 F
 58 60 F
 59 61 F
 60 62 F
 61 63 F
 62 64 F
 63 65 F
 64 66 F
 65 67 F
 66 68 F
 67 69 F
 68 70 F
 69 71 F
 70 72 F
 71 73 F
 72 74 F
 73 75 F
 74 76 F
 75 77 F
 76 78 F
 77 79 F
 78 80 F
 79 81 F
 80 82 F
 81 83 F
 82 84 F
 83 85 F
 84 86 F
 85 87 F
 86 88 F
 87 89 F
 88 90 F
 89 91 F
 90 92 F
 91 93 F
 92 94 F
 93 95 F
 94 96 F
 95 97 F
 96 98 F
 97 99 F
 98 100 F
 99 101 F
 100 102 F
 101 103 F
 102 104 F
 103 105 F
 104 106 F
 105 107 F
 106 108 F
 107 109 F
 108 110 F
 109 111 F
 110 112 F
 111 113 F
 112 114 F
 113 115 F
 114 116 F
 115 117 F
 116 118 F
 117 119 F
 118 120 F
 119 121 F
 120 122 F
 121 123 F
 122 124 F
 123 125 F
 124 126 F
 125 127 F
 126 128 F
 127 129 F
 128 130 F
 129 131 F
 130 132 F
 131 133 F
 132 134 F
 133 135 F
 134 136 F
 135 137 F
 136 138 F
 137 139 F
 138 140 F
 139 141 F
 140 142 F
 141 143 F
 142 144 F
 143 145 F
 144 146 F
 145 147 F
 146 148 F
 147 149 F
 148 150 F
 149 151 F
 150 152 F
 151 153 F
 152 154 F
 153 155 F
 154 156 F
 155 157 F
 156 158 F
 157 159 F
 158 160 F
 159 161 F
 160 162 F
 161 163 F
 162 164 F
 163 165 F
 164 166 F
 165 167 F
 166 168 F
 167 169 F
 168 170 F
 169 171 F
 170 172 F
 171 173 F
 172 174 F
 173 175 F
 174 176 F
 175 177 F
 176 178 F
 177 179 F
 178 180 F
 179 181 F
 180 182 F
 181 183 F
 182 184 F
 183 185 F
 184 186 F
 185 187 F
 186 188 F
 187 189 F
 188 190 F
 189 191 F
 190 192 F
 191 193 F
 192 194 F
 193 195 F
 194 196 F
 195 197 F
 196 198 F
 197 199 F
 198 200 F
 199 201 F
 200 202 F
 201 203 F
 202 204 F
 203 205 F
 204 206 F
 205 207 F
 206 208 F
 207 209 F
 208 210 F
 209 211 F
 210 212 F
 211 213 F
 212 214 F
 213 215 F
 214 216 F
 215 217 F
 216 218 F
 217 219 F
 218 220 F
 219 221 F
 220 222 F
 221 223 F
 222 224 F
 223 225 F
 224 226 F
 225 227 F
 226 228 F
 227 229 F
 228 230 F
 229 231 F
 230 232 F
 231 233 F
 232 234 F
 233 235 F
 234 236 F
 235 237 F
 236 238 F
 237 239 F
 238 240 F
 239 241 F
 240 242 F
 241 243 F
 242 244 F
 243 245 F
 244 246 F
 245 247 F
 246 248 F
 247 249 F
 248 250 F
 249 251 F
 250 252 F
 251 253 F
 252 254 F
 253 255 F
 254 256 F
 255 257 F
 256 258 F
 257 259 F
 258 260 F
 259 261 F
 260 262 F
 261 263 F
 262 264 F
 263 265 F
 264 266 F
 265 267 F
 266 268 F
 267 269 F
 268 270 F
 269 271 F
 270 272 F
 271 273 F
 272 274 F
 273 275 F
 274 276 F
 275 277 F
 276 278 F
 277 279 F
 278 280 F
 279 281 F
 280 282 F
 281 283 F
 282 284 F
 283 285 F
 284 286 F
 285 287 F
 286 288 F
 287 289 F
 288 290 F
 289 291 F
 290 292 F
 291 293 F
 292 294 F
 293 295 F
 294 296 F
 295 297 F
 296 298 F
 297 299 F
 298 300 F
 299 301 F
 300 302 F
 301 303 F
 302 304 F
 303 305 F
 304 306 F
 305 307 F
 306 308 F
 307 309 F
 308 310 F
 309 311 F
 310 312 F
 311 313 F
 312 314 F
 313 315 F
 314 316 F
 315 317 F
 316 318 F
 317 319 F
 318 320 F
 319 321 F
 320 322 F
 321 323 F
 322 324 F
 323 325 F
 324 326 F
 325 327 F
 326 328 F
 327 329 F
 328 330 F
 329 331 F
 330 332 F
 331 333 F
 332 334 F
 333 335 F
 334 336 F
 335 337 F
 336 338 F
 337 339 F
 338 340 F
 339 341 F
 340 342 F
 341 343 F
 342 344 F
 343 345 F
 344 346 F
 345 347 F
 346 348 F
 347 349 F
 348 350 F
 349 351 F
 350 352 F
 351 353 F
 352 354 F
 353 355 F
 354 356 F
 355 357 F
 356 358 F
 357 359 F
 358 360 F
 359 361 F
 360 362 F
 361 363 F
 362 364 F
 363 365 F
 364 366 F
 365 367 F
 366 368 F
 367 369 F
 368 370 F
 369 371 F
 370 372 F
 371 373 F
 372 374 F
 373 375 F
 374 376 F
 375 377 F
 376 378 F
 377 379 F
 378 380 F
 379 381 F
 380 382 F
 381 383 F
 382 384 F
 383 385 F
 384 386 F
 385 387 F
 386 388 F
 387 389 F
 388 390 F
 389 391 F
 390 392 F
 391 393 F
 392 394 F
 393 395 F
 394 396 F
 395 397 F
 396 398 F
 397 399 F
 398 400 F
 399 401 F
 400 402 F
 401 403 F
 402 404 F
 403 405 F
 404 406 F
 405 407 F
 406 408 F
 407 409 F
 408 410 F
 409 411 F
 410 412 F
 411 413 F
 412 414 F
 413 415 F
 414 416 F
 415 417 F
 416 418 F
 417 419 F
 418 420 F
 419 421 F
 420 422 F
 421 423 F
 422 424 F
 423 425 F
 424 426 F
 425 427 F
 426 428 F
 427 429 F
 428 430 F
 429 431 F
 430 432 F
 431 433 F
 432 434 F
 433 435 F
 434 436 F
 435 437 F
 436 438 F
 437 439 F
 438 440 F
 439 441 F
 440 442 F
 441 443 F
 442 444 F
 443 445 F
 444 446 F
 445 447 F
 446 448 F
 447 449 F
 448 450 F
 449 451 F
 450 452 F
 451 453 F
 452 454 F
 453 455 F
 454 456 F
 455 457 F
 456 458 F
 457 459 F
 458 460 F
 459 461 F
 460 462 F
 461 463 F
 462 464 F
 463 465 F
 464 466 F
 465 467 F
 466 468 F
 467 469 F
 468 470 F
 469 471 F
 470 472 F
 471 473 F
 472 474 F
 473 475 F
 474 476 F
 475 477 F
 476 478 F
 477 479 F
 478 480 F
 479 481 F
 480 482 F
 481 483 F
 482 484 F
 483 485 F
 484 486 F
 485 487 F
 486 488 F
 487 489 F
 488 490 F
 489 491 F
 490 492 F
 491 493 F
 492 494 F
 493 495 F
 494 496 F
 495 497 F
 496 498 F
 497 499 F
 498 500 F
 499 501 F
 500 502 F
 501 503 F
 502 504 F
 503 505 F
 504 506 F
 505 507 F
 506 508 F
 507 509 F
 508 510 F
 509 511 F
 510 512 F
 511 513 F
 512 514 F
 513 515 F
 514 516 F
 515 517 F
 516 518 F
 517 519 F
 518 520 F
 519 521 F
 520 522 F
 521 523 F
 522 524 F
 523 525 F
 524 526 F
 525 527 F
 526 528 F
 527 529 F
 528 530 F
 529 531 F
 530 532 F
 531 533 F
 532 534 F
 533 535 F
 534 536 F
 535 537 F
 536 538 F
 537 539 F
 538 540 F
 539 541 F
 540 542 F
 541 543 F
 542 544 F
 543 545 F
 544 546 F
 545 547 F
 546 548 F
 547 549 F
 548 550 F
 549 551 F
 550 552 F
 551 553 F
 552 554 F
 553 555 F
 554 556 F
 555 557 F
 556 558 F
 557 559 F
 558 560 F
 559 561 F
 560 562 F
 561 563 F
 562 564 F
 563 565 F
 564 566 F
 565 567 F
 566 568 F
 567 569 F
 568 570 F
 569 571 F
 570 572 F
 571 573 F
 572 574 F
 573 575 F
 574 576 F
 575 577 F
 576 578 F
 577 579 F
 578 580 F
 579 581 F
 580 582 F
 581 583 F
 582 584 F
 583 585 F
 584 586 F
 585 587 F
 586 588 F
 587 589 F
 588 590 F
 589 591 F
 590 592 F
 591 593 F
 592 594 F
 593 595 F
 594 596 F
 595 597 F
 596 598 F
 597 599 F
 598 600 F
 599 601 F
 600 602 F
 601 603 F
 602 604 F
 603 605 F
 604 606 F
 605 607 F
 606 608 F
 607 609 F
 608 610 F
 609 611 F
 610 612 F
 611 613 F
 612 614 F
 613 615 F
 614 616 F
 615 617 F
 616 618 F
 617 619 F
 618 620 F
 619 621 F
 620 622 F
 621 623 F
 622 624 F
 623 625 F
 624 626 F
 625 627 F
 626 628 F
 627 629 F
 628 630 F
 629 631 F
 630 632 F
 631 633 F
 632 634 F
 633 635 F
 634 636 F
 635 637 F
 636 638 F
 637 639 F
 638 640 F
 639 641 F
 640 642 F
 641 643 F
 642 644 F
 643 645 F
 644 646 F
 645 647 F
 646 648 F
 647 649 F
 648 650 F
 649 651 F
 650 652 F
 651 653 F
 652 654 F
 653 655 F
 654 656 F
 655 657 F
 656 658 F
 657 659 F
 658 660 F
 659 661 F
 660 662 F
 661 663 F
 662 664 F
 663 665 F
 664 666 F
 665 667 F
 666 668 F
 667 669 F
 668 670 F
 669 671 F
 670 672 F
 671 673 F
 672 674 F
 673 675 F
 674 676 F
 675 677 F
 676 678 F
 677 679 F
 678 680 F
 679 681 F
 680 682 F
 681 683 F
 682 684 F
 683 685 F
 684 686 F
 685 687 F
 686 688 F
 687 689 F
 688 690 F
 689 691 F
 690 692 F
 691 693 F
 692 694 F
 693 695 F
 694 696 F
 695 697 F
 696 698 F
 697 699 F
 698 700 F
 699 701 F
 700 702 F
 701 703 F
 702 704 F
 703 705 F
 704 706 F
 705 707 F
 706 708 F
 707 709 F
 708 710 F
 709 711 F
 710 712 F
 711 713 F
 712 714 F
 713 715 F
 714 716 F
 715 717 F
 716 718 F
 717 719 F
 718 720 F
 719 721 F
 720 722 F
 721 723 F
 722 724 F
 723 725 F
 724 726 F
 725 727 F
 726 728 F
 727 729 F
 728 730 F
 729 731 F
 730 732 F
 731 733 F
 732 734 F
 733 735 F
 734 736 F
 735 737 F
 736 738 F
 737 739 F
 738 740 F
 739 741 F
 740 742 F
 741 743 F
 742 744 F
 743 745 F
 744 746 F
 745 747 F
 746 748 F
 747 749 F
 748 750 F
 749 751 F
 750 752 F
 751 753 F
 752 754 F
 753 755 F
 754 756 F
 755 757 F
 756 758 F
 757 759 F
 758 760 F
 759 761 F
 760 762 F
 761 763 F
 762 764 F
 763 765 F
 764 766 F
 765 767 F
 766 768 F
 767 769 F
 768 770 F
 769 771 F
 770 772 F
 771 773 F
 772 774 F
 773 775 F
 774 776 F
 775 777 F
 776 778 F
 777 779 F
 778 780 F
 779 781 F
 780 782 F
 781 783 F
 782 784 F
 783 785 F
 784 786 F
 785 787 F
 786 788 F
 787 789 F
 788 790 F
 789 791 F
 790 792 F
 791 793 F
 792 794 F
 793 795 F
 794 796 F
 795 797 F
 796 798 F
 797 799 F
 798 800 F
 799 801 F
 800 802 F
 801 803 F
 802 804 F
 803 805 F
 804 806 F
 805 807 F
 806 808 F
 807 809 F
 808 810 F
 809 811 F
 810 812 F
 811 813 F
 812 814 F
 813 815 F
 814 816 F
 815 817 F
 816 818 F
 817 819 F
 818 820 F
 819 821 F
 820 822 F
 821 823 F
 822 824 F
 823 825 F
 824 826 F
 825 827 F
 826 828 F
 827 829 F
 828 830 F
 829 831 F
 830 832 F
 831 833 F
 832 834 F
 833 835 F
 834 836 F
 835 837 F
 836 838 F
 837 839 F
 838 840 F
 839 841 F
 840 842 F
 841 843 F
 842 844 F
 843 845 F
 844 846 F
 845 847 F
 846 848 F
 847 849 F
 848 850 F
 849 851 F
 850 852 F
 851 853 F
 852 854 F
 853 855 F
 854 856 F
 855 857 F
 856 858 F
 857 859 F
 858 860 F
 859 861 F
 860 862 F
 861 863 F
 862 864 F
 863 865 F
 864 866 F
 865 867 F
 866 868 F
 867 869 F
 868 870 F
 869 871 F
 870 872 F
 871 873 F
 872 874 F
 873 875 F
 874 876 F
 875 877 F
 876 878 F
 877 879 F
 878 880 F
 879 881 F
 880 882 F
 881 883 F
 882 884 F
 883 885 F
 884 886 F
 885 887 F
 886 888 F
 887 889 F
 888 890 F
 889 891 F
 890 892 F
 891 893 F
 892 894 F
 893 895 F
 894 896 F
 895 897 F
 896 898 F
 897 899 F
 898 900 F
 899 901 F
 900 902 F
 901 903 F
 902 904 F
 903 905 F
 904 906 F
 905 907 F
 906 908 F
 907 909 F
 908 910 F
 909 911 F
 910 912 F
 911 913 F
 912 914 F
 913 915 F
 914 916 F
 915 917 F
 916 918 F
 917 919 F
 918 920 F
 919 921 F
 920 922 F
 921 923 F
 922 924 F
 923 925 F
 924 926 F
 925 927 F
 926 928 F
 927 929 F
 928 930 F
 929 931 F
 930 932 F
 931 933 F
 932 934 F
 933 935 F
 934 936 F
 935 937 F
 936 938 F
 937 939 F
 938 940 F
 939 941 F
 940 942 F
 941 943 F
 942 944 F
 943 945 F
 944 946 F
 945 947 F
 946 948 F
 947 949 F
 948 950 F
 949 951 F
 950 952 F
 951 953 F
 952 954 F
 953 955 F
 954 956 F
 955 957 F
 956 958 F
 957 959 F
 958 960 F
 959 961 F
 960 962 F
 961 963 F
 962 964 F
 963 965 F
 964 966 F
 965 967 F
 966 9

Taquevia El arriero LLC

Taquevia el arriero

3530 W National Ave, Milwaukee

Basement

W/ 53215

Hermelindo Martinez Perez, Agent

Storage

5/12/25

Total Sq: 940

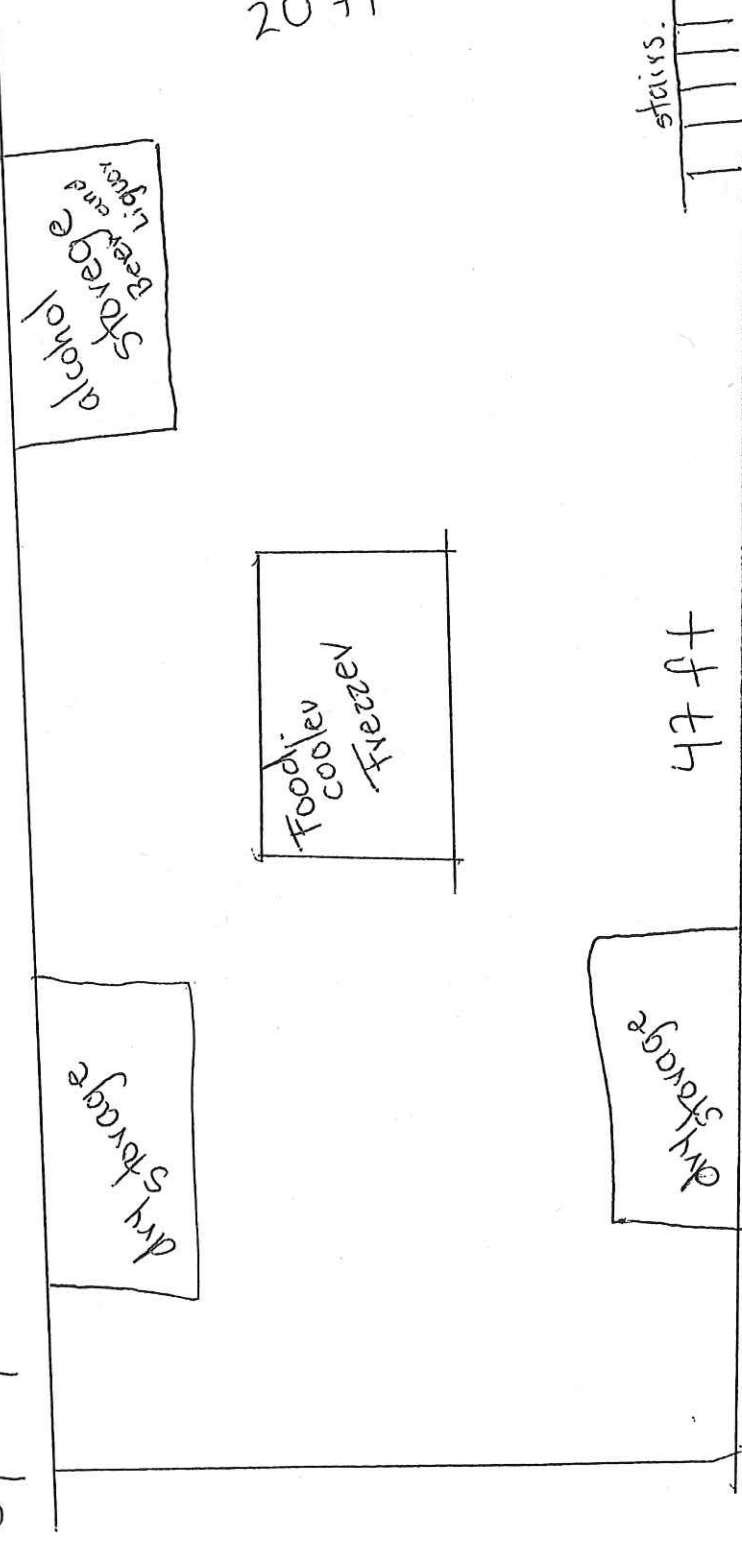

- **TORTAS \$10 (POLLO, ASADA , ALPASTOR)**
- **QUESADILLAS \$8 (POLLO, ASADA , ALPASTOR)**
- **TLAYUDAS\$15 (POLLO, ASADA , ALPASTOR)**
- **MENUDOS\$15**
- **CARNE ASADA \$15**
- **REFRESCOS \$2**
- **AGUAS FRESCAS \$3**