

PETITION FOR A SPECIAL PRIVILEGE

SP 1988

ccl-354 (Rev. 1/00)

\$208.00 Publication Fee
Must Accompany This Petition
SUBMIT PETITION IN DUPLICATE

September 26, 20 01

To the Honorable, The Common Council of the City of Milwaukee:

Council Members:

The undersigned The Newark Group, Inc., a foreign corporation d/b/a/ Wisconsin Paperboard Cor
(State whether petitioner is an individual, co-partnership, Wisconsin or foreign corporation)

being the owners of the following described real estate:

1514 East Thomas Avenue in the city of Milwaukee
(Legal description)

and number as 1514 E. Thomas Avenue in the 3rd Aldermanic District also known by street
City of Milwaukee according to the provisions of Section 66.045 of the Wisconsin Statutes, that the following privilege be granted:

Construct and maintain two (2) 4' x 4' brick columns, each extending three (3) feet into
(Here describe the privilege)
the public right-of-way for North Newhall Street at the corner of vacated
East Thomas Avenue.

Please note that the fence will be on our side of the property line.

of which a plan or sketch is herewith submitted. Petitioner agrees to comply with all laws and all ordinances of the City
of Milwaukee, to abide by any order or resolution of the Common Council affecting this privilege, to be primarily liable for damages
to person or property by reason of the granting of such privilege, to furnish a bond and pay annual compensation as provided by law in
the sum to be fixed by the proper city officers, and to file and keep current throughout the existence of the privilege, a certificate of
insurance indicating applicant holds a public liability policy in at least the sums of \$25,000.00/\$50,000.00 bodily injury, and
\$10,000.00 property damage, insuring the city against any liability that might arise by reason of the privilege.

Petitioner further agrees to remove said privilege whenever public necessity so requires when so ordered upon resolution
adopted by the Common Council or other legislative body.

Should this special privilege be discontinued for any reason whatsoever, petitioner agrees to remove all construction work
executed pursuant to this special privilege, to restore to its former condition and to the approval of the Commissioner of Public Works,
any curb, pavement, or other public improvement which was removed, changed or disturbed by reason of the granting of this special
privilege. Petitioner further agrees not to contest the validity of Section 66.045 of the Wisconsin Statutes, or the legality of this special
privilege in any way.

FILE WITH CITY CLERK LICENSE DIVISION
ROOM 105 CITY HALL, 200 EAST WELLS STREET

Signed Robert F. Demrow
Address 1514 E. Thomas Avenue

The Newark Group, Inc.
d/b/a Wisconsin Paperboard Corp.
(if firm, society or corporation, give its full name)
1514 E. Thomas Avenue, Milwaukee, Wisconsin 53211
Address Bruce R. Smith, Plant Engineer
Controller 414-319-3948
(Tele or office held in same) (Local Phone Number of Engineer/Contractor)

MNI

June 22, 2001

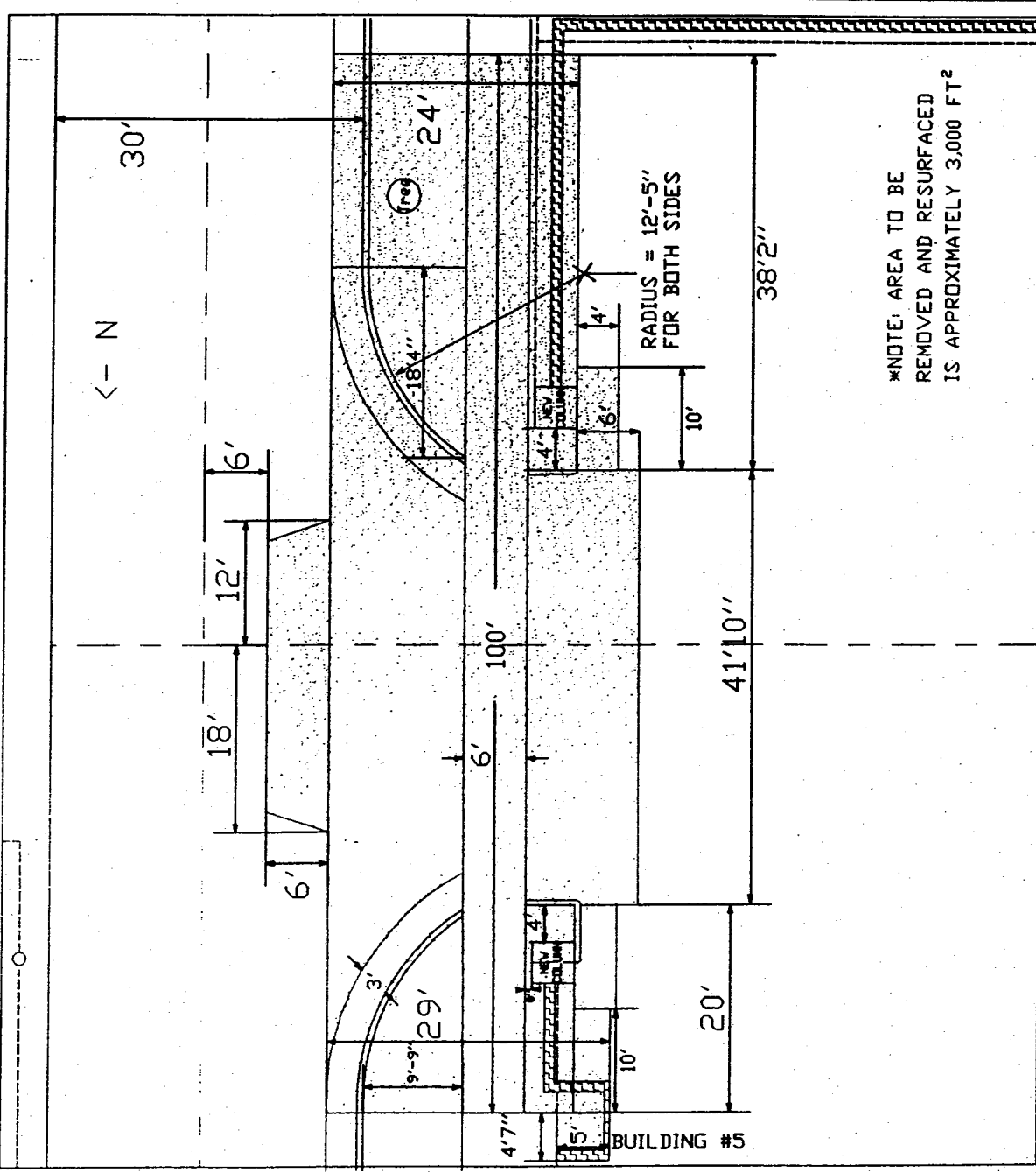

1/8 Inch = 2 Feet

Dimension - Proposed Intersection

DWG N-T 0004



AUGUST 2, 2001

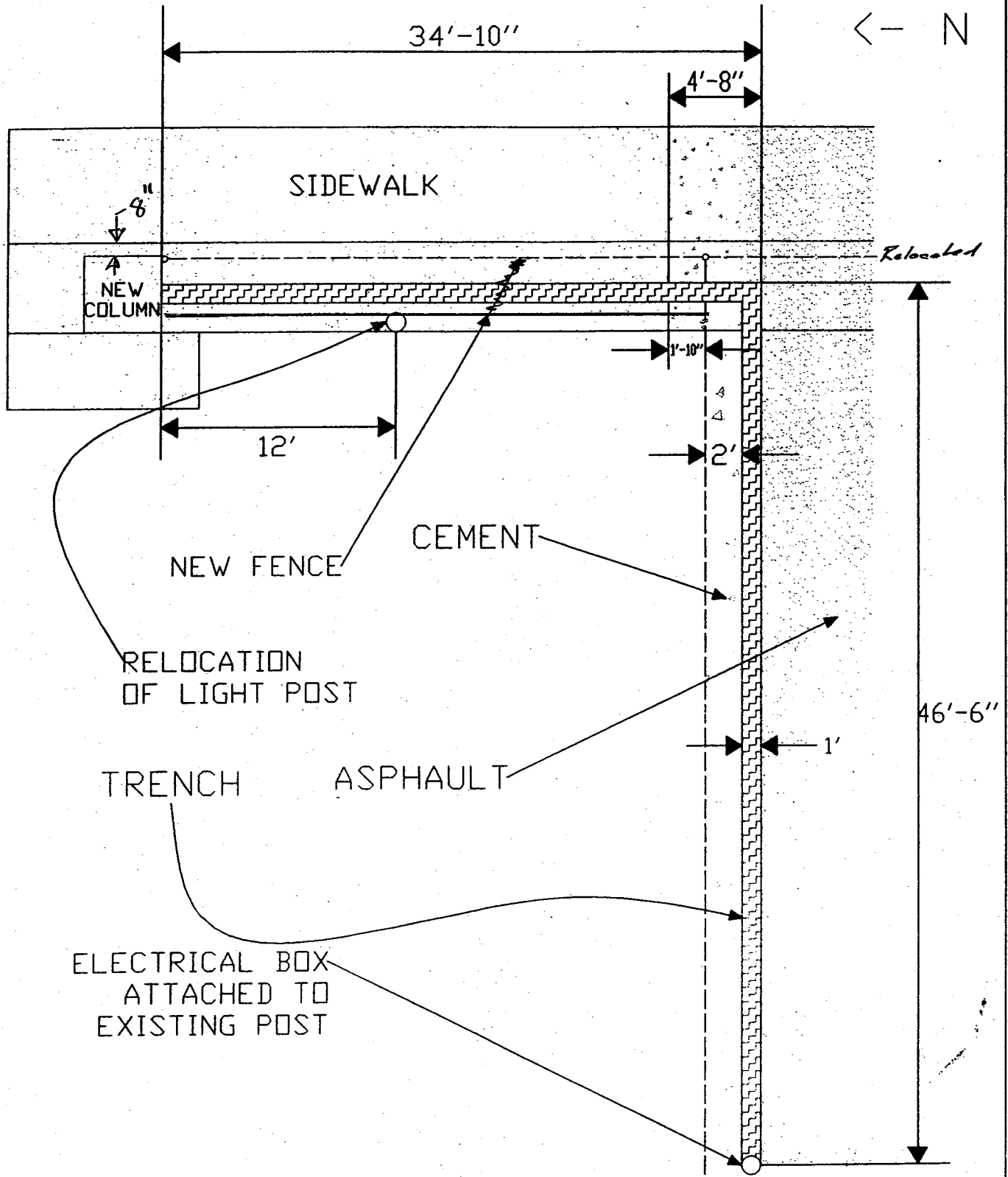

South Electrical Trench

DWG N-7 2006

WISCONSIN  
PAPERBOARD  
CORP.

AUGUST 2, 2001

<— N

TRENCH

ELECTRIC BOX

18"

4'9"

12'6"

SIDEWALK

8"

NEW COLUMN

~36"

NEW HALL  
WEST RIGHT-OF-WAY



1"

DRAINAGE GRATE

6"

1/8 INCH = 6 INCHES

North Electrical Trench

DWG N-T 0007

WISCONSIN  
PAPERBOARD

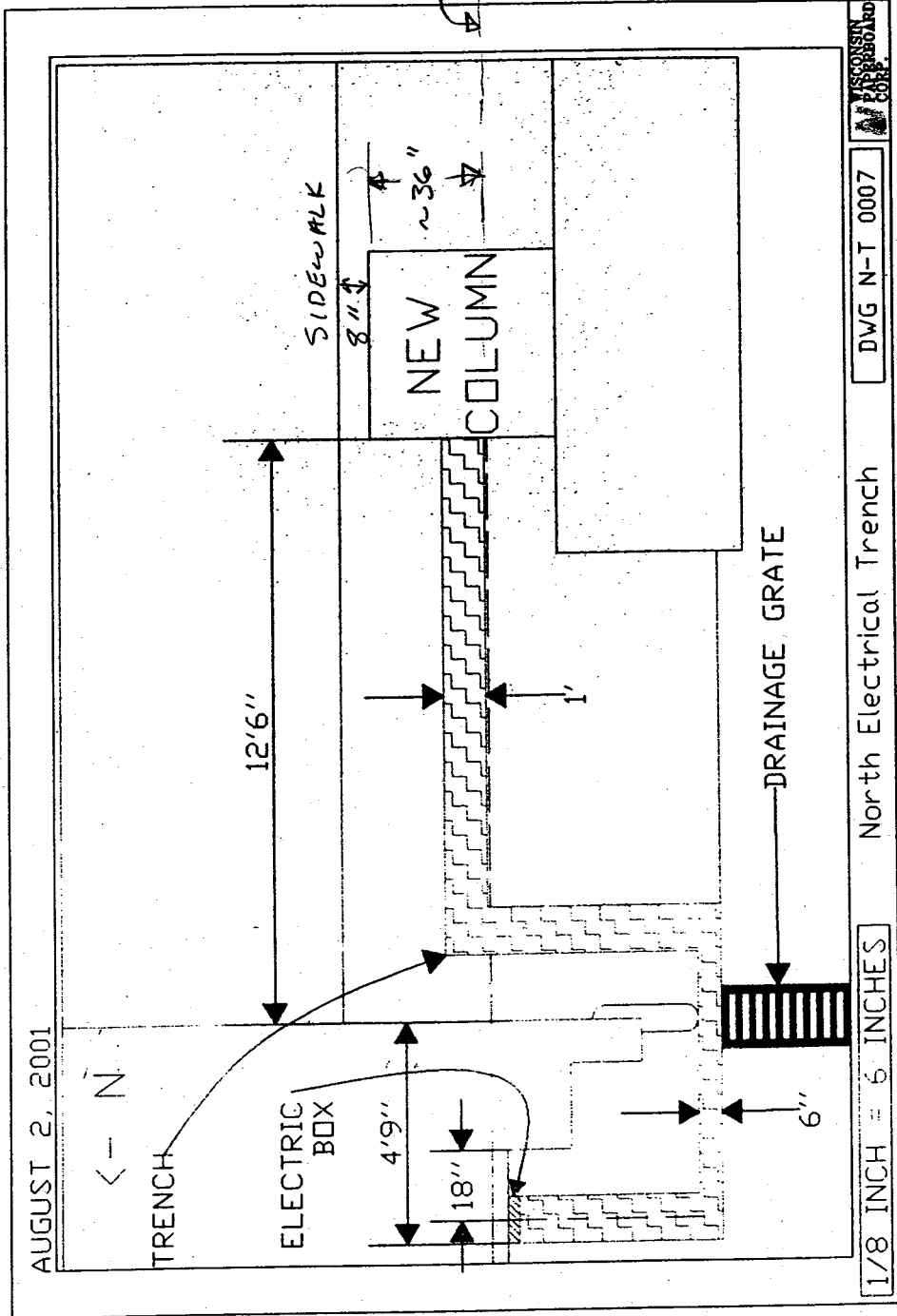

**Certificate of Insurance**

THIS CERTIFICATE IS ISSUED AS A MATTER OF INFORMATION ONLY AND CONFERS NO RIGHTS UPON YOU THE CERTIFICATE HOLDER. THIS CERTIFICATE IS NOT AN INSURANCE POLICY AND DOES NOT AMEND, EXTEND, OR ALTER THE COVERAGE AFFORDED BY THE POLICIES LISTED BELOW.

**This is to Certify that**

WISCONSIN PAPERBOARD  
THE NEWARK GROUP, INC.  
20 JACKSON DRIVE  
CRANFORD, NJ 07016

← Name and address of Insured.



is, as of the issue date of this certificate, insured by the Company under the policy(ies) listed below. The insurance afforded by the listed policy(ies) is subject to all their terms, exclusions and conditions and is not altered by any requirement, term or condition of any contract or other document with respect to which this certificate may be issued.

| TYPE OF POLICY  | EXP. DATE                                      |                                   | POLICY NUMBER     | LIMIT OF LIABILITY  |   |
|---|--|-----------------------------------|-------------------|---|---|
|   | <input checked="" type="checkbox"/> CONTINUOUS | <input type="checkbox"/> EXTENDED |                   |   |   |
| WORKERS COMPENSATION  | MAY 1  |                                   | WA1-63D-004147-08 | COVERAGE AFFORDED UNDER WC LAW OF THE FOLLOWING STATES:<br>AL, CA, CO, CT, FL, GA, IL, LA, ME, MA, NH, NJ, NY, NC, PA, SC, TX, UT<br><br>OR, WI | <b>EMPLOYERS LIABILITY</b><br>Bodily Injury By Accident<br>\$ 500,000 Each Accident                       |
|   |  |                                   | WC1-631-004147-09 |   | Bodily Injury By Disease<br>\$ 500,000 Policy Limit<br>Bodily Injury By Disease<br>\$ 500,000 Each Person |
| GENERAL LIABILITY<br><input checked="" type="checkbox"/> OCCURRENCE<br><input type="checkbox"/> CLAIMS MADE   | MAY 1  |                                   | RG1-631-004147-05 | General Aggregate - Other than Products/Completed Operations<br>\$ 4,000,000  |   |
|   |  |                                   |                   | Products/Completed Operations Aggregate<br>\$ 2,000,000   |   |
|   |  |                                   |                   | Bodily Injury and Property Damage Liability<br>\$ 1,000,000 Per Occurrence  |   |
|   |  |                                   |                   | Personal Injury<br>INCLUDED ABOVE Per Person/ Organization  |   |
|   |  | RETRO DATE                        | Other             |   | Other   |
| AUTOMOBILE LIABILITY<br><input checked="" type="checkbox"/> OWNED<br><input checked="" type="checkbox"/> NON-OWNED<br><input checked="" type="checkbox"/> HIRED | MAY 1  |                                   | AS2-631-004147-02 | \$ 1,000,000 Each Accident - Single Limit B.I. and P.D. Combined  |   |
|   |  |                                   |                   | Each Person   |   |
|   |  |                                   |                   | Each Accident or Occurrence   |   |
|   |  |                                   |                   | Each Accident or Occurrence   |   |
| OTHER   |  |                                   |                   |   |   |

ADDITIONAL COMMENTS  
 AUTO LIABILITY POLICY INCLUDES LEGAL LIABILITY FOR TRAILERS UNDER A TRAILER INTERCHANGE CONTRACT;  
 ACV OR \$40,000 PER TRAILER COMPREHENSIVE \$ 100 DEDUCTIBLE /// COLLISION \$ 5,000 DEDUCTIBLE  
 GENERAL LIABILITY POLICY INCLUDES THE CITY OF MILWAUKEE AS AN ADDITIONAL INSURED

\* If the certificate expiration date is continuous or extended term, you will be notified if coverage is terminated or reduced before the certificate expiration date.  
 SPECIAL NOTICE-Ohio: ANY PERSON WHO, WITH INTENT TO DEFRAUD OR KNOWING THAT HE IS FACILITATING A FRAUD AGAINST AN INSURER, SUBMITS AN APPLICATION OR FILES A CLAIM CONTAINING A FALSE OR DECEPTIVE STATEMENT IS GUILTY OF INSURANCE FRAUD.  
 IMPORTANT NOTICE TO FLORIDA POLICYHOLDERS AND CERTIFICATE HOLDERS: IN THE EVENT YOU HAVE ANY QUESTIONS OR NEED INFORMATION ABOUT THIS CERTIFICATE FOR ANY REASON, PLEASE CONTACT YOUR LOCAL SALES PRODUCER, WHOSE NAME AND TELEPHONE NUMBER APPEARS IN THE LOWER RIGHT HAND CORNER OF THIS CERTIFICATE. THE APPROPRIATE LOCAL SALES OFFICE MAILING ADDRESS MAY ALSO BE OBTAINED BY CALLING THIS NUMBER.  
 NOTICE OF CANCELLATION: (NOT APPLICABLE UNLESS A NUMBER OF DAYS IS ENTERED BELOW.) BEFORE THE STATED EXPIRATION DATE THE COMPANY WILL NOT CANCEL OR REDUCE THE INSURANCE AFFORDED UNDER THE ABOVE POLICIES UNTIL AT LEAST 30 DAY notice of such termination or reduction has been mailed to:

CERTIFICATE HOLDER

CITY CLERK, LICENSE DIVISION  
ROOM 105, CITY HALL  
200 EAST WELLS STREET  
MILWAUKEE, WI 53202

324  
A-2

*Mary A. Taylor*  
Mary A. Taylor

AUTHORIZED REPRESENTATIVE

East Hanover, NJ (973) 887-7400 9/26/2001  
OFFICE PHONE NUMBER DATE ISSUED