



CITY OF MILWAUKEE
OFFICE OF THE CITY CLERK

Thursday, September 16, 2021

COMMITTEE MEETING NOTICE

AD 03

PAUL, Richard J, Agent
ZUM ZEPPEL, LLC
1731 N Arlington Pl
Milwaukee, WI 53202

You are requested to attend a virtual hearing to be held on:

Tuesday, September 28, 2021 at 11:45 AM

Regarding: Your Class B Tavern and Public Entertainment Premises License Applications Requesting Bands, Instrumental Musicians, Disc Jockey, Jukebox, and Karaoke as agent for "ZUM ZEPPEL, LLC" for "Thurmans 15" at 1731 N Arlington Pl.

This meeting will be held via GoToMeeting. Please see  enclosed best practices document for further instructions. The access code is <https://global.gotomeeting.com/join/84170701>. If you wish to call in, please call [+1 \(786\) 535-3211](tel:+17865353211) and use Access Code: 284-170-701.

There is a possibility that your application may be denied for one or more of the following reasons: The recommendation of the committee regarding the application shall be based on evidence presented at the hearing. Per MCO 85-2.7-4, probative evidence concerning whether or not a new license should be granted may be presented on the following subjects: whether or not the applicant meets the municipal requirements, the appropriateness of the location and premises where the licensed premises is to be located and whether use of the premises for the purposes or activities permitted by the license would tend to facilitate a public or private nuisance or create undesirable neighborhood problems such as disorderly patrons, unreasonably loud noise, litter, and excessive traffic and parking congestion. Probative evidence relating to these matters may be taken from the plan of operation submitted with the license application, if any, but shall not include the content of any music. Evidence regarding the fitness of the location of the premises to be maintained as the principal place of business, including but not limited to whether there is an overconcentration of businesses of the type for which the license is sought; whether the proposal is consistent with any pertinent neighborhood business or development plans, or the location's proximity to areas where children are typically present. The applicant's record in operating similarly licensed premises; and whether or not the applicant has been charged with or convicted of any felony, misdemeanor, municipal offense or other offense, the circumstances of which substantially relate to the activity to be permitted by the license being applied for or any other factor which reasonably relates to the public health, safety or welfare may also be considered. See attached police report or correspondence.

Notice for applicants with warrants or unpaid fines: Proof of warrant satisfaction or payment of fines must be submitted at the hearing on the above date and time. Failure to comply with this requirement may result in a delay of the granting/denial of your application.

Failure to attend this meeting may result in the denial of your license. Individual applicants and partnership applicants must attend or attend by an attorney. The agent or attorney for corporate or limited liability applicants must attend. If you wish to do so and at your own expense, you may be accompanied by an attorney of your choosing to represent you at this hearing.

You will be given an opportunity to speak on behalf of the application and to respond and challenge any charges or reasons given for the denial. No petitions can be accepted by the committee, unless the people who signed the petition attend the virtual hearing and are willing to testify. You may present witnesses under oath and you may also confront and cross-examine opposing witnesses under oath. If you have difficulty with the English language, you should request an interpreter attend the meeting with you, at your expense, so that you can answer questions and participate in your hearing.

PLEASE NOTE: Upon reasonable notice, efforts will be made to accommodate the needs of disabled individuals through sign language interpreters or other auxiliary aids. For additional information or to request this service, contact the Council Services Division ADA Coordinator at (414) 286-2998, Fax - (414) 286-3456, TDD - (414) 286-2025.

JIM OWCZARSKI, CITY CLERK

BY: _____

Jim Cooney
License Division Manager

If you have questions regarding this meeting, please contact the staff assistant, Molly Kuether-Steele at (414) 286-2775 or molly.kuether-steele@milwaukee.gov.

200 E. Wells Street, Room 105, City Hall, Milwaukee, WI 53202. www.milwaukee.gov/license
Phone: (414) 286-2238 Fax: (414) 286-3057 Email Address: License@milwaukee.gov



CITY OF MILWAUKEE
OFFICE OF THE CITY CLERK

Thursday, September 16, 2021

COMMITTEE MEETING NOTICE

AD 03

PAUL, Richard J, Agent
ZUM ZEPPEL, LLC
1865 Lone Oak Circle East
Brookfield, WI 53045

You are requested to attend a virtual hearing to be held on:

Tuesday, September 28, 2021 at 11:45 AM

Regarding: Your Class B Tavern and Public Entertainment Premises License Applications Requesting Bands, Instrumental Musicians, Disc Jockey, Jukebox, and Karaoke as agent for "ZUM ZEPPEL, LLC" for "Thurmans 15" at 1731 N Arlington Pl.

This meeting will be held via GoToMeeting. Please see the enclosed best practices document for further instructions. The access code is <https://global.gotomeeting.com/join/284170701>. If you wish to call in, please call [+1 \(786\) 535-3211](tel:+17865353211) and use Access Code: 284-170-701.

There is a possibility that your application may be denied for one or more of the following reasons: The recommendation of the committee regarding the application shall be based on evidence presented at the hearing. Per MCO 85-2.7-4, probative evidence concerning whether or not a new license should be granted may be presented on the following subjects: whether or not the applicant meets the municipal requirements, the appropriateness of the location and premises where the licensed premises is to be located and whether use of the premises for the purposes or activities permitted by the license would tend to facilitate a public or private nuisance or create undesirable neighborhood problems such as disorderly patrons, unreasonably loud noise, litter, and excessive traffic and parking congestion. Probative evidence relating to these matters may be taken from the plan of operation submitted with the license application, if any, but shall not include the content of any music. Evidence regarding the fitness of the location of the premises to be maintained as the principal place of business, including but not limited to whether there is an overconcentration of businesses of the type for which the license is sought; whether the proposal is consistent with any pertinent neighborhood business or development plans, or the location's proximity to areas where children are typically present. The applicant's record in operating similarly licensed premises; and whether or not the applicant has been charged with or convicted of any felony, misdemeanor, municipal offense or other offense, the circumstances of which substantially relate to the activity to be permitted by the license being applied for or any other factor which reasonably relates to the public health, safety or welfare may also be considered. See attached police report or correspondence.

Notice for applicants with warrants or unpaid fines: Proof of warrant satisfaction or payment of fines must be submitted at the hearing on the above date and time. Failure to comply with this requirement may result in a delay of the granting/denial of your application.

Failure to attend this meeting may result in the denial of your license. Individual applicants and partnership applicants must attend or attend by an attorney. The agent or attorney for corporate or limited liability applicants must attend. If you wish to do so and at your own expense, you may be accompanied by an attorney of your choosing to represent you at this hearing.

You will be given an opportunity to speak on behalf of the application and to respond and challenge any charges or reasons given for the denial. No petitions can be accepted by the committee, unless the people who signed the petition attend the virtual hearing and are willing to testify. You may present witnesses under oath and you may also confront and cross-examine opposing witnesses under oath. If you have difficulty with the English language, you should request an interpreter attend the meeting with you, at your expense, so that you can answer questions and participate in your hearing.

PLEASE NOTE: Upon reasonable notice, efforts will be made to accommodate the needs of disabled individuals through sign language interpreters or other auxiliary aids. For additional information or to request this service, contact the Council Services Division ADA Coordinator at (414) 286-2998, Fax - (414) 286-3456, TDD - (414) 286-2025.

JIM OWCZARSKI, CITY CLERK

BY: _____

Jim Cooney

License Division Manager

If you have questions regarding this meeting, please contact the staff assistant, Molly Kuether-Steele at (414) 286-2775 or molly.kuether-steele@milwaukee.gov.

200 E. Wells Street, Room 105, City Hall, Milwaukee, WI 53202. www.milwaukee.gov/license
Phone: (414) 286-2238 Fax: (414) 286-3057 Email Address: License@milwaukee.gov

Date: 08/27/21
Officer: Xavier Benitez

City of Milwaukee Police Department
90-5-1.5 Crime Prevention Survey
Tavern Inspection

Name of Premise: Thurmans 15
Address: 1731 N. Arlington Pl
Phone:

Owner: Richard J. Paul
Owner address: 1507 N Cass St.
City State Zip: Milwaukee WI 53202
Owner Phone: 262 784-6981
Owner email: zumzeppel@gmail.com

Licensee/Agent: Same
Home Address:
City State Zip:
Phone:
Email:

Preferred contact: by phone

Location currently open: YES NO

Projected open date: Fall 2021

Day's open: S M T W Th F SA ALL

Hours of Operation: Sun: 12pm-2am 24 hours Y N
Mon: 12pm-2am
Tue: 12pm-2am
Wed: 12pm-2am
Thu: 12pm-2am
Fri: 12pm-2:30am
Sat: 12pm-2:30am

Premise Type: Tavern/Bar
Restaurant
Other:

Licenses currently held:

Alcohol: Yes No Class: #:
 Tobacco: Yes No #:
 Food: Yes No #:
 Extended Hours: Yes No #:
 Secondhand Dealer: Yes No Type: #:
 Other: Yes No Type: #:
 Other: Yes No Type: #:

Exterior Survey:

1. Is the area around the location clean? Yes No
2. What surrounds the location? (Check all the apply)
 - a. Park
 - b. School
 - c. Youth Center
 - d. Church
 - e. Tavern(s) If so, how many
 - f. Residential
 - g. Other businesses
 - h. Other:
3. Can you see from the outside of the location into the interior Yes No
4. Can you see the employees inside of the location from the outside Yes No
5. Are exterior windows free of signage Yes No
6. Is there a parking lot Yes No
7. Is the parking lot clean? Yes No
8. Off-Street parking Yes No
9. Is the parking lot well lit? Yes No
10. Valet Parking Yes No
 - a. Will this lot have a guard? Yes No
 - b. Will this lot have cameras? Yes No
11. Are there areas where a person could conceal themselves Yes No
12. Is there exterior lighting? Yes No. Does it appears to be adequate Yes No
13. Exterior Payphone? Yes No
14. Are there No Loitering Signs posted? Yes No
15. Are there exterior security cameras Yes No How Many: 2
16. Are the address numbers prominently displayed and easy to see Yes No

Camera Survey:

17. Does this location have security cameras? Yes No
18. Are they in working order? Yes No
19. What format are the cameras?
 - a. Color Yes No
 - b. Digital Yes No
 - c. Recorded Yes No
20. How long is footage stored for later viewing: 14 days
21. Are there exterior cameras Yes No How many: 2
22. Are there interior cameras Yes No How many: 3
23. Do all employees know how to retrieve recorded digital images/footage? Yes No

24. Cameras located in parking lot Yes No How many

Interior Survey:

- 25. What is the planned capacity 80
- 26. What is the minimum number of employees That will be on premise 2
- 27. Is the storeowner willing to be a standing complainant regarding loitering? Yes No
 - a. If yes have them fill out the standing complaint form and give them two of the commercial signs Yes No
- 28. Is the interior of the location neat and clean? Yes No
- 29. Does an interior camera face the entrance/exit? Yes No
- 30. Is there a lockable area that separates employees from customers? Yes No
- 31. Are emergency and non-emergency numbers posted near the phone? Yes No
- 32. Does the owner know how to contact their police district directly? Yes No
 - a. Did you provide a district contact guide to the owner? Yes No

Security

- 33. How many security personnel are going to be employed: N/A
- 34. How ill they be deployed: Interior Exterior
- 35. What days will they be deployed MonTueWedThuFriSatSun
- 36. Will the security be managed by business or contracted
- 37. Will they be armed Yes No
- 38. What type of security measures to be used:
 - Wanding/metal detector
 - ID Scanner
 - Dress Code
 - Cover Charge
 - Age restriction
 - Other

ADDITIONAL COMMENTS/RECOMMENDATIONS:

The location is finishing renovations, and has a camera system in place. The agent stated that he may add mores cameras that would cover the sidewalk area.

MILWAUKEE POLICE DEPARTMENT
LICENSE INVESTIGATION UNIT

CRIMINAL RECORD/ORDINANCE VIOLATION/INCIDENTS
SYNOPSIS

DATE: 08/17/21

LICENSE TYPE: CLASS B TAVERN

NEW: X

RENEWAL:

No. 328092

Application Date: 08/17/21

Expiration Date:

License Location: 1731 N Arlington Pl

Aldermanic District: 03

Business Name: Thurmans 15

Licensee/Applicant: Lennon, Suzanne
(Last Name, First Name, MI)

Date of Birth: 04/15/47

Male:

Female: X

Home Address: 5554 N. Shoreland Ave.

City: Whitefish Bay

State: WI

Zip Code: 53217

Home Phone: 414-961-2141

This report is written by Police Officer David NOVAK, assigned to the License Investigation Unit, Days.

The Milwaukee Police Department's investigation regarding this application revealed the following:

1. On 01/03/2002 at 12:50 AM officers made a lawful inspection of the licensed premises at 1731 N Arlington Place, Thurmans. Officers observed an underage person drinking beer. Investigation revealed that this 19 year old had used a false ID to obtain the beer. He was cited. Incident Report Filed.
 2. On 01/08/2002 at 12:15 AM officers made a lawful inspection of the licensed premises at 1731 N Arlington Place, Thurmans. Officers observed two 20 year olds in tavern. Investigation revealed that they both used false ID to gain entry. However, neither was drinking at the time of the investigation. Both were sited for Underage Loitering in Class 'B' Premises. Incident Report Filed
-
3. On 3-14-2003 at 9:22pm, an underage Milwaukee Police Aide entered Thurmans 15, 1731 N Arlington Pl at the direction of Milwaukee Police Officers. The aide was able to purchase a beer without being asked for identification by the bartender, Robert P Vespalec. A citation was issued.

Charge: Sale To Underage

Finding: Guilty

Sentence: \$150.00

Date: 5-8-2003

Case: 03059964

=====

- 4. On 10/23/10 at approximately 2:25am officers were at Thurman's 15 at 1731 N. Arlington Pl. Officers observed that there were 8-12 patrons still seated at the tavern with drinks. Officers heard patrons inside say "It's the cops. Let's go." and while attempting to gain entry, observed the tavern staff rush everyone inside out the back door. After the tavern was empty the staff unlocked the door and allowed the officers inside.

The tavern staff denied to the officers that patrons were in the tavern after hours. When asked to view the license, the staff retrieved it from the floor behind the bar.

The bartender on duty (Daisy Vasquez) did not have a valid bartender's license. When asked who was on scene licensed to serve alcohol, she stated "No one".

Ordinance violations that were advised were: Patrons After Hours, Immediate Entry for Police and Posting of License.

As to Agent William Lennon:

Charge: Responsible Person Upon Premises
 Finding: Guilty, Municipal Court
 Sentence: \$383.00 fine
 Date: 12/17/10
 Case: 10131076

As to Bartender Daisy Vasquez:

Charge: Class D Operator's License Required
 Finding: **Guilty**
 Sentence: Fined \$368.00
 Date: 03/18/11
 Case: 10131112

Items 1-4 occurred while William Lennon was the agent for Thurman's 15.

=====
 Item # 4 previously reported, disposition on Vasquez updated on 01/30/12.

- 5. On 04/04/11 at 10:22 pm, Milwaukee police conducted a License Premise Check at 1731 N Arlington Place. Police spoke with the bartender Shannon Kebir who was asked to provide officers her bartender's license. Kebir stated she didn't have one. There were no other licensed bartenders on scene, nor the licensee. Police closed the bar and had the licensee Suzanne Lennon respond the bar. Officers advised Lennon that Kebir was not licensed and couldn't operate the bar. Lennon stated she would remain on scene until another licensed bartender arrived to supervise Kebir. A warning was issued.

- On 12/29/11 at 1:20 am, Vasquez was arrested for OWI.
- On 01/28/12, Vasquez's license was suspended for 6 months for BAC.

=====

6. On 05/03/2014 a 20 year old Milwaukee police aide, working in conjunction with Milwaukee police, was able to purchase a Miller Lite brand beer from the bartender at 1731 North Arlington Place (Aligator). The applicant was cited.

Charge	1:	Sale of Alcohol to Underage Person
	2:	Allow Underage on Premises
Finding	1:	Guilty
	2:	Guilty
Sentence	1:	\$181.00 fine
	2:	\$384.00 fine
Date	:	07/02/2014
Case	1:	14041919
	2:	14041920

7. On 02/19/2015 Milwaukee police conducted a tavern check and dropped off a packet related ordinances at 1730 North Arlington Place (Thurman's 15).

8. On 02/26/2015 a 18 year old Milwaukee police aide, working in conjunction with Milwaukee police, was able to purchase a Miller Lite brand beer from the bartender at Thurmans 15 (1731 North Arlington Place). The applicant was cited.

Charge	1:	Sale of Alcohol to Underage Person
	2:	Presence of Minor at Licensed Premise
Finding	1:	Guilty
	2:	Guilty
Sentence	1:	\$181.00 fine
	2:	\$447.00 fine
Date	:	07/23/2015
Case	1:	15027476
	2:	15027477

9. On Milwaukee 08/29/2016 police responded to a battery/cutting complaint at 1731 North Arlington Place (Thurman's Bar). Officers observed Milwaukee Fire Department personnel performing CPR on a subject who suffered multiple stab wounds and was now on the south curb of the street approximately 40 feet from the intersection of North Arlington Place and North Pulaski Street. Milwaukee Fire Department personnel continued to conduct CPR on this subject until he was pronounced dead on the scene. Investigation revealed this subject had earlier been inside Thurman's when he became involved in an altercation with two other tavern patrons. The incident moved outside where witness's state they observed a fight before observing the victim collapse near the curb. Milwaukee police incident report #162420010 filed.

10. On 03/30/2017 officers conducted underage tavern enforcement in District 1. An underage Police Aid attempted to gain entry to Thurman's, 1731 N. Arlington Pl. There was no security at the door and the Police Aid was able to enter and order a Miller Lite beer for \$3.00.

Charge: Presence of Minor at Licensed Premise
Finding: Guilty
Sentence: Fined \$384.00
Date: 09/08/2017
Case: 17034888

=====
11. On 11/30/18 at 10:05pm, Milwaukee Police conducted underage tavern enforcement in the First District. An underage Police Aid attempted to gain entry to Thurman's, 1731 N. Arlington Place. There was no security at the door and the Police Aid was able to enter and order a Miller Lite beer for \$4.00. The bartender of the tavern was issued a citation.
=====

PREVIOUS PREMISE

Becker, Keren

From:
Sent: Thursday, August 19, 2021 7:56 AM
To: License
Subject: Thurmans 15

Categories: KB working on

[You don't often get email from <http://aka.ms/LearnAboutSenderIdentification>.] Learn why this is important at

I object to this license request.

Now only was i violently assaulted in this bar and no person working there helped or checked on me around 2015 but there is already a high concentration of bar and liquor on and around Brady St is too high and an increase in other crime.

REDACTED RECORD



Thursday, September 16, 2021

Licenses Committee Notice of Hearing

WILLIAM LENNON, JR
5554 N SHORELAND Av
WHITEFISH BAY, WI 53217

The Licenses Committee will consider the following license application:

Class B Tavern and Public Entertainment Premises License Applications
Requesting Bands, Instrumental Musicians, Disc Jockey, Jukebox, and Karaoke
PAUL, Richard J, Agent
Thurmans 15 at 1731 N Arlington Pl

Date: 9/28/2021

Time: 11:45 AM

Location: The hearing before the Licenses Committee will take place virtually on Tuesday, September 28, 2021. This is a public hearing. Those wishing to view the proceeding are able to do so via the City Channel – Channel 25 on Spectrum Cable – or on the Internet at <http://city.milwaukee.gov/citychannel>. Those wishing to provide oral testimony will be asked to do so by phone or internet and are asked to contact the staff assistant, Molly Kuether-Steele at (414) 286-2775 or molly.kuether-steele@milwaukee.gov for necessary information. Please make such requests no later than one business day prior to the start of the meeting. You are not required to attend the hearing, but please see the information below if you would like to provide testimony

Please note this application may be recommended for denial based on fitness of the location due to concentration of alcohol beverage outlets in the area. If the application is denied for this reason, no other application for an alcohol beverage license for this location shall be recommended for approval by the Licenses Committee within three years of the date of denial unless the applicant has demonstrated a change of circumstances since the prior denial.





Thursday, September 16, 2021

Licenses Committee Notice of Hearing

Black Dog Holdings LLC
PO Box 1411
Milwaukee, WI 53202

The Licenses Committee will consider the following license application:

Class B Tavern and Public Entertainment Premises License Applications
Requesting Bands, Instrumental Musicians, Disc Jockey, Jukebox, and Karaoke
PAUL, Richard J, Agent
Thurmans 15 at 1731 N Arlington Pl

Date: 9/28/2021

Time: 11:45 AM

Location: The hearing before the Licenses Committee will take place virtually on Tuesday, September 28, 2021. This is a public hearing. Those wishing to view the proceeding are able to do so via the City Channel – Channel 25 on Spectrum Cable – or on the Internet at <http://city.milwaukee.gov/citychannel>. Those wishing to provide oral testimony will be asked to do so by phone or internet and are asked to contact the staff assistant, Molly Kuether-Steele at (414) 286-2775 or molly.kuether-steele@milwaukee.gov for necessary information. Please make such requests no later than one business day prior to the start of the meeting. You are not required to attend the hearing, but please see the information below if you would like to provide testimony

Please note this application may be recommended for denial based on fitness of the location due to concentration of alcohol beverage outlets in the area. If the application is denied for this reason, no other application for an alcohol beverage license for this location shall be recommended for approval by the Licenses Committee within three years of the date of denial unless the applicant has demonstrated a change of circumstances since the prior denial.





Thursday, September 16, 2021



Notice of Public Hearing

blank
notice

PAUL, Richard J, Agent
Thurmans 15 at 1731 N Arlington Pl
Class B Tavern and Public Entertainment Premises License Applications Requesting Bands,
Instrumental Musicians, Disc Jockey, Jukebox, and Karaoke

Tuesday, September 28, 2021 at 11:45 AM

To whom it may concern:

The above application has been made by the above named applicant(s). This requires approval from the Licenses Committee and the Common Council of the City of Milwaukee. The hearing before the Licenses Committee will take place virtually on 9/28/2021 at 11:45 AM. This is a public hearing. Those wishing to view the proceeding are able to do so via the City Channel – Channel 25 on Spectrum Cable – or on the Internet at <http://city.milwaukee.gov/citychannel>. Those wishing to provide oral testimony will be asked to do so by phone or internet and are asked to contact the staff assistant, Molly Kuether-Steele at (414) 286-2775 or molly.kuether-steele@milwaukee.gov for necessary information. Please make such requests no later than one business day prior to the start of the meeting. You are not required to attend the hearing, but please see the information below if you would like to provide testimony. Once the Licenses Committee makes its recommendation, this recommendation is forwarded to the full Common Council for approval at its next regularly scheduled hearing.

Important details for those wishing to provide information for the Licenses Committee to consider when making its recommendation:

1. The license application is scheduled to be heard at the above time. Due to other hearings running longer than scheduled, you may have to wait some time to provide your testimony.
2. You must testify as to matters that you have personally experienced or seen. (You cannot provide testimony for your neighbor, parent or anyone else; this is considered hearsay and cannot be considered by the committee.)
3. No letters or petitions can be accepted by the committee (unless the person who wrote the letter or the persons who signed the petition are willing to testify).
4. Persons opposed to the license application are given the opportunity to testify first; supporters may testify after the opponents have finished.
5. When you are called to testify, you will be sworn in and asked to give your name, and address. (If your first and/or last names are uncommon please spell them.)
6. You may then provide testimony.
 - a. Include only information relating to the above license application.
 - b. Include only information you have personally witnessed or seen.
 - c. Provide concise and relevant information detailing how this business has affected or may affect the peaceful enjoyment of your neighborhood.
 - d. If by the time you have the opportunity to testify, the information you wish to share has already been provided to the committee, you may state that you agree with the previous testimony. Redundant or repetitive testimony will not assist the committee in making its recommendation.
7. After giving your testimony, the members of the Licenses Committee and the licensee may ask questions regarding the testimony you have given or other factors relating to the license application.
8. Business Competition is not a valid basis for denial or non-renewal of a license.

Please Note: If you have submitted an objection to the above application your objection cannot be considered by the committee unless you personally testify at the hearing.

OCCUPANT	MAIL ADDRESS	CITY STATE ZIP
BUSINESS OCCUPANT	1220 E BRADY ST	MILWAUKEE, WI 53202-1603
BUSINESS OCCUPANT	1224 E BRADY ST	MILWAUKEE, WI 53202-2671
BUSINESS OCCUPANT	1224 E BRADY ST	MILWAUKEE, WI 53202-2671
BUSINESS OCCUPANT	1230 E BRADY ST	MILWAUKEE, WI 53202-1603
BUSINESS OCCUPANT	1234 E BRADY ST	MILWAUKEE, WI 53202-1603
BUSINESS OCCUPANT	1240 E BRADY ST	MILWAUKEE, WI 53202-1603
BUSINESS OCCUPANT	1300 E BRADY ST	MILWAUKEE, WI 53202-1613
BUSINESS OCCUPANT	1310 E BRADY ST	MILWAUKEE, WI 53202-1613
BUSINESS OCCUPANT	1316 E BRADY ST	MILWAUKEE, WI 53202-1613
BUSINESS OCCUPANT	1320 E BRADY ST	MILWAUKEE, WI 53202-1613
BUSINESS OCCUPANT	1330 E BRADY ST	MILWAUKEE, WI 53202-1613
BUSINESS OCCUPANT	1701 N ARLINGTON PL	MILWAUKEE, WI 53202-1618
BUSINESS OCCUPANT	1716 N ARLINGTON PL	MILWAUKEE, WI 53202-1619
BUSINESS OCCUPANT	1728 N FRANKLIN PL	MILWAUKEE, WI 53202-1605
BUSINESS OCCUPANT	1729 N PULASKI ST	MILWAUKEE, WI 53202-1608
BUSINESS OCCUPANT	1731 N ARLINGTON PL	MILWAUKEE, WI 53202-1618
CURRENT OCCUPANT	1218 E BRADY ST	MILWAUKEE, WI 53202-1603
CURRENT OCCUPANT	1218A E BRADY ST	MILWAUKEE, WI 53202-1603
CURRENT OCCUPANT	1224 E BRADY ST, 1	MILWAUKEE, WI 53202-1603
CURRENT OCCUPANT	1224 E BRADY ST, N	MILWAUKEE, WI 53202-1603
CURRENT OCCUPANT	1224 E BRADY ST, S	MILWAUKEE, WI 53202-1603
CURRENT OCCUPANT	1228 E BRADY ST, 201	MILWAUKEE, WI 53202-1654
CURRENT OCCUPANT	1228 E BRADY ST, 202	MILWAUKEE, WI 53202-1654
CURRENT OCCUPANT	1228 E BRADY ST, 203	MILWAUKEE, WI 53202-1654
CURRENT OCCUPANT	1228 E BRADY ST, A	MILWAUKEE, WI 53202-1654
CURRENT OCCUPANT	1228 E BRADY ST, B	MILWAUKEE, WI 53202-1654
CURRENT OCCUPANT	1238 E BRADY ST, 1	MILWAUKEE, WI 53202-1603
CURRENT OCCUPANT	1238 E BRADY ST, 2	MILWAUKEE, WI 53202-1603
CURRENT OCCUPANT	1238 E BRADY ST, 3	MILWAUKEE, WI 53202-1603
CURRENT OCCUPANT	1238 E BRADY ST, 4	MILWAUKEE, WI 53202-1603
CURRENT OCCUPANT	1238 E BRADY ST, 5	MILWAUKEE, WI 53202-1603
CURRENT OCCUPANT	1238 E BRADY ST, 6	MILWAUKEE, WI 53202-1603
CURRENT OCCUPANT	1238 E BRADY ST, 7	MILWAUKEE, WI 53202-1603
CURRENT OCCUPANT	1238 E BRADY ST, 8	MILWAUKEE, WI 53202-1603
CURRENT OCCUPANT	1240 E BRADY ST	MILWAUKEE, WI 53202-1603
CURRENT OCCUPANT	1305 E HAMILTON ST	MILWAUKEE, WI 53202-1636
CURRENT OCCUPANT	1305A E HAMILTON ST	MILWAUKEE, WI 53202-1636
CURRENT OCCUPANT	1309 E HAMILTON ST	MILWAUKEE, WI 53202-1636
CURRENT OCCUPANT	1702 N PULASKI ST, 1	MILWAUKEE, WI 53202-1609
CURRENT OCCUPANT	1702 N PULASKI ST, 2	MILWAUKEE, WI 53202-1609
CURRENT OCCUPANT	1702 N PULASKI ST, 3	MILWAUKEE, WI 53202-1609
CURRENT OCCUPANT	1703A N ARLINGTON PL	MILWAUKEE, WI 53202-1618
CURRENT OCCUPANT	1703B N ARLINGTON PL	MILWAUKEE, WI 53202-1618
CURRENT OCCUPANT	1706 N ARLINGTON PL, A	MILWAUKEE, WI 53202-1619
CURRENT OCCUPANT	1706 N ARLINGTON PL, B	MILWAUKEE, WI 53202-1619
CURRENT OCCUPANT	1708 N ARLINGTON PL, A	MILWAUKEE, WI 53202-1619

CURRENT OCCUPANT	1708 N ARLINGTON PL, B	MILWAUKEE, WI 53202-1619
CURRENT OCCUPANT	1710 N PULASKI ST, 1	MILWAUKEE, WI 53202-1609
CURRENT OCCUPANT	1710 N PULASKI ST, 2	MILWAUKEE, WI 53202-1609
CURRENT OCCUPANT	1710 N PULASKI ST, 3	MILWAUKEE, WI 53202-1609
CURRENT OCCUPANT	1710 N PULASKI ST, 4	MILWAUKEE, WI 53202-1609
CURRENT OCCUPANT	1711 N PULASKI ST	MILWAUKEE, WI 53202-1608
CURRENT OCCUPANT	1714 N FRANKLIN PL	MILWAUKEE, WI 53202-1605
CURRENT OCCUPANT	1714A N FRANKLIN PL	MILWAUKEE, WI 53202-1605
CURRENT OCCUPANT	1719 N ARLINGTON PL	MILWAUKEE, WI 53202-1618
CURRENT OCCUPANT	1720 N PULASKI ST	MILWAUKEE, WI 53202-1609
CURRENT OCCUPANT	1721 N ARLINGTON PL	MILWAUKEE, WI 53202-1618
CURRENT OCCUPANT	1722 N FRANKLIN PL	MILWAUKEE, WI 53202-1605
CURRENT OCCUPANT	1722 N PULASKI ST	MILWAUKEE, WI 53202-1609
CURRENT OCCUPANT	1722A N FRANKLIN PL	MILWAUKEE, WI 53202-1605
CURRENT OCCUPANT	1723 N ARLINGTON PL	MILWAUKEE, WI 53202-1618
CURRENT OCCUPANT	1723 N WARREN AVE	MILWAUKEE, WI 53202-1616
CURRENT OCCUPANT	1724 N FRANKLIN PL	MILWAUKEE, WI 53202-1605
CURRENT OCCUPANT	1724 N PULASKI ST	MILWAUKEE, WI 53202-1609
CURRENT OCCUPANT	1724A N FRANKLIN PL	MILWAUKEE, WI 53202-1605
CURRENT OCCUPANT	1725 N ARLINGTON PL	MILWAUKEE, WI 53202-1618
CURRENT OCCUPANT	1725 N PULASKI ST	MILWAUKEE, WI 53202-1608
CURRENT OCCUPANT	1725 N WARREN AVE	MILWAUKEE, WI 53202-1616
CURRENT OCCUPANT	1725A N ARLINGTON PL	MILWAUKEE, WI 53202-1618
CURRENT OCCUPANT	1726 N ARLINGTON PL	MILWAUKEE, WI 53202-1619
CURRENT OCCUPANT	1726 N ARLINGTON PL, A	MILWAUKEE, WI 53202-1619
CURRENT OCCUPANT	1726 N ARLINGTON PL, B	MILWAUKEE, WI 53202-1619
CURRENT OCCUPANT	1726 N PULASKI ST, 1	MILWAUKEE, WI 53202-1678
CURRENT OCCUPANT	1726 N PULASKI ST, 2	MILWAUKEE, WI 53202-1678
CURRENT OCCUPANT	1726 N PULASKI ST, 3	MILWAUKEE, WI 53202-1678
CURRENT OCCUPANT	1726 N PULASKI ST, 4	MILWAUKEE, WI 53202-1678
CURRENT OCCUPANT	1726A N ARLINGTON PL	MILWAUKEE, WI 53202-1619
CURRENT OCCUPANT	1727 N ARLINGTON PL	MILWAUKEE, WI 53202-1618
CURRENT OCCUPANT	1727 N WARREN AVE	MILWAUKEE, WI 53202-1616
CURRENT OCCUPANT	1727A N ARLINGTON PL	MILWAUKEE, WI 53202-1618
CURRENT OCCUPANT	1729 N WARREN AVE	MILWAUKEE, WI 53202-1616
CURRENT OCCUPANT	1729A N WARREN AVE	MILWAUKEE, WI 53202-1616
CURRENT OCCUPANT	1730 N ARLINGTON PL	MILWAUKEE, WI 53202-1619
CURRENT OCCUPANT	1730 N FRANKLIN PL, 1R	MILWAUKEE, WI 53202-1605
CURRENT OCCUPANT	1730 N FRANKLIN PL, 2	MILWAUKEE, WI 53202-1605
CURRENT OCCUPANT	1730A N ARLINGTON PL	MILWAUKEE, WI 53202-1619
CURRENT OCCUPANT	1730B N ARLINGTON PL	MILWAUKEE, WI 53202-1619
CURRENT OCCUPANT	1730C N ARLINGTON PL	MILWAUKEE, WI 53202-1619
CURRENT OCCUPANT	1731 N ARLINGTON PL	MILWAUKEE, WI 53202-1618
CURRENT OCCUPANT	1731 N WARREN AVE	MILWAUKEE, WI 53202-1616
CURRENT OCCUPANT	1731A N WARREN AVE	MILWAUKEE, WI 53202-1616
CURRENT OCCUPANT	1731B N WARREN AVE	MILWAUKEE, WI 53202-1616
CURRENT OCCUPANT	1734 N ARLINGTON PL	MILWAUKEE, WI 53202-1619

CURRENT OCCUPANT	1734 N FRANKLIN PL	MILWAUKEE, WI 53202-1605
CURRENT OCCUPANT	1734 N FRANKLIN PL, A	MILWAUKEE, WI 53202-1605
CURRENT OCCUPANT	1734 N PULASKI ST	MILWAUKEE, WI 53202-1609
CURRENT OCCUPANT	1735 N WARREN AVE	MILWAUKEE, WI 53202-1616
CURRENT OCCUPANT	1736 N ARLINGTON PL	MILWAUKEE, WI 53202-1619
CURRENT OCCUPANT	1736 N PULASKI ST	MILWAUKEE, WI 53202-1609
CURRENT OCCUPANT	1736 N PULASKI ST, 2	MILWAUKEE, WI 53202-1609
CURRENT OCCUPANT	1736A N ARLINGTON PL	MILWAUKEE, WI 53202-1619
CURRENT OCCUPANT	1739 N WARREN AVE	MILWAUKEE, WI 53202-1616
CURRENT OCCUPANT	1740 N ARLINGTON PL	MILWAUKEE, WI 53202-1619
CURRENT OCCUPANT	1740 N ARLINGTON PL, A	MILWAUKEE, WI 53202-1619
CURRENT OCCUPANT	1740 N FRANKLIN PL	MILWAUKEE, WI 53202-1605
CURRENT OCCUPANT	1741 N WARREN AVE	MILWAUKEE, WI 53202-1616
CURRENT OCCUPANT	1742 N PULASKI ST	MILWAUKEE, WI 53202-1609
CURRENT OCCUPANT	1744 N FRANKLIN PL	MILWAUKEE, WI 53202-1605
CURRENT OCCUPANT	1744 N PULASKI ST	MILWAUKEE, WI 53202-1609
CURRENT OCCUPANT	1744A N ARLINGTON PL	MILWAUKEE, WI 53202-1619
CURRENT OCCUPANT	1744B N ARLINGTON PL	MILWAUKEE, WI 53202-1619
CURRENT OCCUPANT	1745 N WARREN AVE	MILWAUKEE, WI 53202-1616
CURRENT OCCUPANT	1746 N FRANKLIN PL	MILWAUKEE, WI 53202-1605
CURRENT OCCUPANT	1747 N ARLINGTON PL	MILWAUKEE, WI 53202-1662
CURRENT OCCUPANT	1747 N WARREN AVE	MILWAUKEE, WI 53202-1616
CURRENT OCCUPANT	1747A N ARLINGTON PL	MILWAUKEE, WI 53202-1662
CURRENT OCCUPANT	1747A N WARREN AVE	MILWAUKEE, WI 53202-1616
CURRENT OCCUPANT	1748 N ARLINGTON PL	MILWAUKEE, WI 53202-1619
CURRENT OCCUPANT	1748 N ARLINGTON PL, A	MILWAUKEE, WI 53202-1619
CURRENT OCCUPANT	1748 N PULASKI ST	MILWAUKEE, WI 53202-1609
CURRENT OCCUPANT	1749 N WARREN AVE	MILWAUKEE, WI 53202-1616
CURRENT OCCUPANT	1751 N ARLINGTON PL	MILWAUKEE, WI 53202-1662
CURRENT OCCUPANT	1752 N ARLINGTON PL	MILWAUKEE, WI 53202-1619
CURRENT OCCUPANT	1752A N ARLINGTON PL	MILWAUKEE, WI 53202-1619
CURRENT OCCUPANT	1753 N ARLINGTON PL	MILWAUKEE, WI 53202-1662
CURRENT OCCUPANT	1753 N WARREN AVE	MILWAUKEE, WI 53202-1616
CURRENT OCCUPANT	1753A N ARLINGTON PL	MILWAUKEE, WI 53202-1662
CURRENT OCCUPANT	1754 N PULASKI ST	MILWAUKEE, WI 53202-1609
CURRENT OCCUPANT	1754 N PULASKI ST, A	MILWAUKEE, WI 53202-1609
CURRENT OCCUPANT	1754 N PULASKI ST, B	MILWAUKEE, WI 53202-1609
CURRENT OCCUPANT	1754 N PULASKI ST, C	MILWAUKEE, WI 53202-1609
CURRENT OCCUPANT	1754 N PULASKI ST, D	MILWAUKEE, WI 53202-1609
CURRENT OCCUPANT	1755 N ARLINGTON PL	MILWAUKEE, WI 53202-1662
CURRENT OCCUPANT	1755A N ARLINGTON PL	MILWAUKEE, WI 53202-1662
CURRENT OCCUPANT	1756 N ARLINGTON PL	MILWAUKEE, WI 53202-1619
CURRENT OCCUPANT	1756A N ARLINGTON PL	MILWAUKEE, WI 53202-1619
CURRENT OCCUPANT	1756B N ARLINGTON PL	MILWAUKEE, WI 53202-1619
CURRENT OCCUPANT	1759 N ARLINGTON PL	MILWAUKEE, WI 53202-1662
CURRENT OCCUPANT	1759A N ARLINGTON PL	MILWAUKEE, WI 53202-1662
CURRENT OCCUPANT	1760 N ARLINGTON PL	MILWAUKEE, WI 53202-1619

CURRENT OCCUPANT	1767 N ARLINGTON PL, 1	MILWAUKEE, WI 53202-1647
CURRENT OCCUPANT	1767 N ARLINGTON PL, 10	MILWAUKEE, WI 53202-1648
CURRENT OCCUPANT	1767 N ARLINGTON PL, 11	MILWAUKEE, WI 53202-1648
CURRENT OCCUPANT	1767 N ARLINGTON PL, 12	MILWAUKEE, WI 53202-1648
CURRENT OCCUPANT	1767 N ARLINGTON PL, 14	MILWAUKEE, WI 53202-1648
CURRENT OCCUPANT	1767 N ARLINGTON PL, 15	MILWAUKEE, WI 53202-1648
CURRENT OCCUPANT	1767 N ARLINGTON PL, 16	MILWAUKEE, WI 53202-1648
CURRENT OCCUPANT	1767 N ARLINGTON PL, 17	MILWAUKEE, WI 53202-1649
CURRENT OCCUPANT	1767 N ARLINGTON PL, 18	MILWAUKEE, WI 53202-1649
CURRENT OCCUPANT	1767 N ARLINGTON PL, 19	MILWAUKEE, WI 53202-1649
CURRENT OCCUPANT	1767 N ARLINGTON PL, 2	MILWAUKEE, WI 53202-1647
CURRENT OCCUPANT	1767 N ARLINGTON PL, 20	MILWAUKEE, WI 53202-1649
CURRENT OCCUPANT	1767 N ARLINGTON PL, 21	MILWAUKEE, WI 53202-1649
CURRENT OCCUPANT	1767 N ARLINGTON PL, 22	MILWAUKEE, WI 53202-1649
CURRENT OCCUPANT	1767 N ARLINGTON PL, 23	MILWAUKEE, WI 53202-1649
CURRENT OCCUPANT	1767 N ARLINGTON PL, 24	MILWAUKEE, WI 53202-1650
CURRENT OCCUPANT	1767 N ARLINGTON PL, 25	MILWAUKEE, WI 53202-1650
CURRENT OCCUPANT	1767 N ARLINGTON PL, 26	MILWAUKEE, WI 53202-1650
CURRENT OCCUPANT	1767 N ARLINGTON PL, 27	MILWAUKEE, WI 53202-1650
CURRENT OCCUPANT	1767 N ARLINGTON PL, 28	MILWAUKEE, WI 53202-1650
CURRENT OCCUPANT	1767 N ARLINGTON PL, 29	MILWAUKEE, WI 53202-1650
CURRENT OCCUPANT	1767 N ARLINGTON PL, 3	MILWAUKEE, WI 53202-1647
CURRENT OCCUPANT	1767 N ARLINGTON PL, 30	MILWAUKEE, WI 53202-1650
CURRENT OCCUPANT	1767 N ARLINGTON PL, 31	MILWAUKEE, WI 53202-1650
CURRENT OCCUPANT	1767 N ARLINGTON PL, 4	MILWAUKEE, WI 53202-1647
CURRENT OCCUPANT	1767 N ARLINGTON PL, 5	MILWAUKEE, WI 53202-1647
CURRENT OCCUPANT	1767 N ARLINGTON PL, 6	MILWAUKEE, WI 53202-1647
CURRENT OCCUPANT	1767 N ARLINGTON PL, 7	MILWAUKEE, WI 53202-1647
CURRENT OCCUPANT	1767 N ARLINGTON PL, 8	MILWAUKEE, WI 53202-1648
CURRENT OCCUPANT	1767 N ARLINGTON PL, 9	MILWAUKEE, WI 53202-1648
blank	notice	

Total Records: 170

Radius: 250.0 feet and Center of Circle: 1731 N Arlington Pl



BUSINESS LICENSE PLAN OF OPERATION

ccl-busplan 5/12/2020

Office of the City Clerk License Division
200 E. Wells St. Room 105, Milwaukee, WI 53202
(414) 286-2238 www.milwaukee.gov/license e-mail address: license@milwaukee.gov

1. Type of Business

Applying for: Extended Hours (12AM to 5AM) - If a food establishment, check all that apply: Delivery Drive Thru Dining Room
 Self Service Laundry Massage Establishment Filling Station
 Other (supplemental application for specific license also required)

Provide a detailed description of the type of business you plan on operating:

SMALL CORNER TAVERN OPERATED AS TITANIAN'S 15 (AS IT HAS SINCE 1987)

Do you have any experience operating this type of business? No Yes If yes, explain: MULTIPLE MEMBERS OF LLC HAVE WORKED FOR LOCAL BARS

2. Business Operations

- a. Proposed Opening Date: SEPTEMBER 27, 2021
- b. Is this premise under construction? No Yes If yes, list estimated completion date: FLOOR REFINISHING, PAINTING, CLEANING - COMPLETED BY 8/15/21
- c. Is this a franchise? No Yes
- d. Is this premises currently licensed? No Yes If yes, list type of license: _____
- e. Is the current licensee operating? No Yes If no, list date closed: _____
- f. Do you have future plans for other businesses, licenses or permits at this location? No Yes
If yes, explain: _____
- g. Have you previously held an Extended Hours License in Milwaukee? No Yes
If yes, list address(es): _____
- h. Are other businesses operating in the same building? No Yes If yes, describe: _____

3. Litter & Noise

- a. How are grounds kept clean? Sweep Pressure Wash Pick Up Litter Other: _____
- b. How often will grounds be cleaned? Daily Weekly As Needed Monthly Other: _____
- c. Grounds cleaned by: Licensee Building Owner Employees Hired Maintenance Other: _____
- d. How are noise issues prevented and/or addressed? Security Manager approaches customer(s) Call Police
 Signs Posted Other: _____
- e. Will a sound amplification system be used? No Yes If yes, describe: ONLY FOR BANDS/ENTERTAINMENT INDOORS

4. Smoking & Sanitation

- a. Are there designated outdoor smoking areas? No Yes If yes, describe: _____
- b. Number of Garbage Cans: Inside: 5 Locations: 2 RESTROOMS, BEHIND BAR, STORAGE/BASEMENT
Outside: 1 Locations: REAR OF BUILDING
- c. Is a crowd control barrier used? No Yes If yes, describe: _____
- d. How many restrooms are on the premises? 2
- e. Name of solid waste contractor: Advanced Disposal Waste Management Other: EAGLE DISPOSAL

5. Security

- a. Are there onsite parking spaces? No Yes If yes, how many? _____ and describe the parking security plan: _____
- b. Is there a loading zone? No Yes If yes, describe the loading area security plan: _____
- c. Will you have security personnel on premise? No Yes If yes, how many? _____ and answer the following:
 What are their responsibilities? _____
 Is security equipment used? No Yes If yes, describe _____
 List their licensing, certification, or training credentials _____
- d. Will there be security cameras? No Yes If yes, how many? 4-5 and list locations: 3 INDOOR (MAIN FLOOR & BASEMENT STORAGE), 2 EXTERIOR.
- e. Will searches/identification checks be done upon entry? No Yes If yes, describe BY DOOR SECURITY ON WORKDAYS

6. Percentage of Sales (must total 100%)

Alcohol <u>100</u> %	Food _____ %	Secondhand Merchandise _____ %	Precious Metals & Gems _____ %
Entertainment _____ %	Cigarettes _____ %	Personal Services (such as tattoo, body piercing, salon, tailor, tanning, etc.) _____ %	Other _____ % Describe: _____
Pawnbroker Activity _____ %	Salvaged Materials _____ % (such as scrap metal)		

7. Businesses/Licenses on the Premises (check all that apply):

Type 1

- Full Service Restaurant Cafe/Coffee Shop Deli or Fast Food Restaurant Private/Fraternal/Veterans Club
- Night Club Tavern Cocktail Lounge Teen Club
- Banquet Hall Sports Facility Bowling Alley
- Hotel/Motel: Number of Floors: _____ Number of Rooms: _____
 Rooming House: Number of Floors: _____ Number of Rooms: _____

Type 2

- Liquor Store Corner Store Supermarket Convenience Store
- Gas Station Amusement/Phonograph Distributor Recycling, Salvage or Towing
- Used Car Dealer Personal Service Establishment (such as tattoo business, hair salon, tailor, etc.) Recording Studio

What other licenses/permits will you hold at this location? (check all that apply)

- Occupancy Permit Cigarette & Tobacco Gas Station Extended Hours Class "B" Tavern Weights & Measures
- Secondhand Dealer Precious Metal & Gem Other: _____

8. Legal Capacity (only if a Type 1 premises in #7 above)

Capacity EO (Call the Milwaukee Development Center at 414-286-8211 if you have questions.)

9. Premises Description

a. Identify all area(s) of the premises that will be used in operating this business (include areas used only for storage):

1st Floor 2nd Floor Basement Storage Patio Beer Garden Sidewalk Café Deck Rooftop

Other: Describe: _____

b. Describe Location: Major Thoroughfare Secondary Street Other: _____

c. Nearest Major Cross Street: BRADY ST

d. Describe Building: Free Standing Building Strip Mall Other: _____

e. Describe Premises Structure: Single Story Multi-Story - # of Stories 2 Other: _____

f. Describe Surrounding Area: Commercial Residential Industrial Other: _____

g. Building Owner Name: BLACK DOG HOLDINGS, LLC Phone Number: (414) 559-8707

Building Owner Address: P.O. BOX 1411, MILWAUKEE, WI 53202

10. Hours of Operation & Customers

Will customers be entering the premises? No Yes

Day of the Week	Proposed Hours of Operation:		Estimated Number of Customers expected each day	Potential Age Range of Customers	Class B Tavern Applicant Only: Age Restriction (If none, write 'None')
	Open Time (include a.m. or p.m.)	Close Time (include a.m. or p.m.)			
Sunday	12:00 PM	2:00 AM	15-60	21-100	
Monday	12:00 PM	2:00 AM	↓	↓	
Tuesday	12:00 PM	2:00 AM			
Wednesday	12:00 PM	2:00 AM			
Thursday	12:00 PM	2:00 AM			
Friday	12:00 PM	2:30 AM			
Saturday	12:00 PM	2:30 AM			

An Extended Hours Establishment License is required for any convenience store, filling station, personal service establishment (such as tattoo, body piercing, salon, tailor, tanning, etc.), recording studio or restaurant which is open between the hours of 12:00 a.m. and 5:00 a.m.

Alcohol Establishments Class A: 8:00 am to 9:00 pm Sunday thru Saturday
 Permitted Hours of Operation: Class B: 6:00 am to 2:00 am Sunday thru Thursday, 6:00 am to 2:30 am Friday & Saturday

Entertainment Outdoor Closing Hours: 10:00pm Sunday-Thursday; 12:00am Friday & Saturday; unless a different time, either earlier or later, is established by the Common Council in its approval of the licensee's plan of operation.

11. Signature(s)

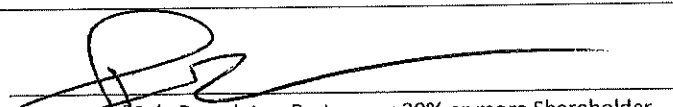
 Signature of Sole Proprietor, Partner, or 20% or more Shareholder
 (If there are no 20% or more shareholders,
 Corporate Officer-print name/title and sign)

 Signature of additional partner or 20% or more shareholder

See Application Information for a complete list of all required application forms.



ALCOHOL BEVERAGE & PUBLIC ENTERTAINMENT PREMISES SUPPLEMENTAL APPLICATION

Office of the City Clerk License Division
200 E. Wells St. Room 105, Milwaukee, WI 53202
(414) 286-2238 e-mail address: license@milwaukee.gov www.milwaukee.gov/license

Legal Entity Name: <u>ZUM ZEPPEL, LLC</u>
Premise Address: <u>1731 N. ARLINGTON PLACE</u>
Proximity of Premises to Church, School, Daycare Center or Hospital
Is the building within 300 feet of any church, school, daycare center or hospital? <input checked="" type="checkbox"/> No <input type="checkbox"/> Yes
"Service Bar Only" Designation
If applying for Class B or C license, are you applying for "Service Bar Only"? <input checked="" type="checkbox"/> No <input type="checkbox"/> Yes Service Bar Only means customers cannot sit at the bar. Alcohol is served to employees who serve patrons seated at tables. No stools, chairs or other articles of furniture shall be placed at the service bar for patrons to sit upon.
Business Information
a) Are you taking out this application for anyone that may not be eligible for a license? <input checked="" type="checkbox"/> No <input type="checkbox"/> Yes If yes, list their name and address: _____
b) Will the agent, a partner or the individual licensee be conducting the day-to-day operations of the business? <input type="checkbox"/> No <input checked="" type="checkbox"/> Yes If no, list the name and address of the person(s) who will: _____ Class B Applicants: If the agent, a partner or the individual licensee will not be conducting the day-to-day operations of the business, the person(s) listed above must obtain a Class B Managers license.
c) Does anyone else have money invested or any other interest in this business? <input checked="" type="checkbox"/> No <input type="checkbox"/> Yes If yes, explain: _____
d) Have you made an agreement with anyone to repay any loan or any other payments based upon income from the business? <input checked="" type="checkbox"/> No <input type="checkbox"/> Yes If yes, list name and address: _____
Property Information (New & Transfer Applicants Only)
a) Do you own or lease the building? <input type="checkbox"/> Own <input checked="" type="checkbox"/> Lease
b) Who owns the fixtures (for example, coolers, etc.)? <u>ZUM ZEPPEL, LLC</u>
c) Are you purchasing the stock and/or fixtures? <input checked="" type="checkbox"/> No <input type="checkbox"/> Yes If yes, amount paid \$ _____
d) Total amount paid for business \$ <u>0</u>
e) Total amount paid for goodwill of the business \$ <u>0</u> Goodwill comprises the reputation and customer relationships of an existing business. If the price you pay for the business exceeds the fair market value of all of the rest of the assets of the business, the excess may be considered goodwill.
f) Have you made arrangements with the seller for payment of personal property taxes? <input checked="" type="checkbox"/> No <input type="checkbox"/> Yes
Lease Information (New & Transfer Applicants who are leasing the premises only)
a) Date lease begins <u>SEPT 1, 2021</u> Ends <u>AUG 31, 2026</u>
b) Monthly rental <u>\$ 1395.00</u>
c) Do you have an option to renew the lease? <input type="checkbox"/> No <input checked="" type="checkbox"/> Yes
d) Does your lease allow for assignment to another party without the consent of the owner? <input checked="" type="checkbox"/> No <input type="checkbox"/> Yes
e) For what length of time have you been guaranteed occupancy (number of years)? <u>5 + RENEWALS</u>

Lease Information (Continued)

- f) In addition to paying the monthly rental, will you have to pay anything additional to the owner of the building to guarantee performance of the lease? No Yes If yes, explain _____
- g) Does the present owner or occupancy object to the granting of your license? No Yes
If yes, explain _____

Change of Agent Applicants Only

Have there been any changes to the floor plan since the last application was submitted? No Yes
If no, a new floor plan is not required. If yes, submit a new floor plan and explain the change(s):

Signature

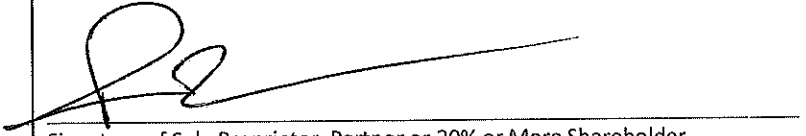

Signature of Sole Proprietor, Partner or 20% or More Shareholder
(If no 20% or more Shareholder, Corporate Officer - print name/title and sign)

Note: All information contained in this application is subject to approval by the Common Council.
Deviating from approved plan of operation will subject licensee to citations, and/or suspension or non-renewal of the license.
Contact the License Division for information on how to request changes.

New and transfer of premises applicants must submit the following:

- Detailed floor plan
- If a restaurant, copy of the menu



PUBLIC ENTERTAINMENT PREMISES LICENSE SUPPLEMENTAL APPLICATION

Office of the City Clerk License Division
200 E. Wells St. Room 105, Milwaukee, WI 53202
(414) 286-2238 www.milwaukee.gov/license e-mail address: license@milwaukee.gov

PREMISES ADDRESS: 1731 N. ARLINGTON PLACE, MILWAUKEE, WI 53202

TYPES OF ENTERTAINMENT (CHECK ALL THAT APPLY)

- | | | | |
|---|---|---|---|
| <input checked="" type="checkbox"/> Instrumental Musicians | <input type="checkbox"/> Battle of the Bands | <input type="checkbox"/> Dancing by Performers | <input type="checkbox"/> Amusement Machines
How many? _____ |
| <input checked="" type="checkbox"/> Bands | <input type="checkbox"/> Comedy Acts | <input type="checkbox"/> Adult Entertainment/
Strippers/Erotic Dance | <input type="checkbox"/> Concerts
Approx. # per year? _____ |
| <input type="checkbox"/> Bowling Alley
How many? _____ | <input checked="" type="checkbox"/> Disc Jockey | <input type="checkbox"/> Wrestling | <input type="checkbox"/> Theatrical Performances
Approx. # per year? _____ |
| <input type="checkbox"/> Pool Tables
How many? _____ | <input type="checkbox"/> Magic Shows | <input type="checkbox"/> Patron Contests | <input checked="" type="checkbox"/> Jukebox |
| <input type="checkbox"/> Motion Pictures (movies by
admission) - How many? _____ | <input type="checkbox"/> Poetry Readings | <input type="checkbox"/> Patrons Dancing | <input checked="" type="checkbox"/> Karaoke |
| <input type="checkbox"/> Other: _____ | | | |

Entertainment Outdoor Closing Hours: 10:00pm Sunday-Thursday; 12:00am Friday & Saturday; unless a different time, either earlier or later, is established by the Common Council in its approval of the licensee's plan of operation.

PROMOTERS/SOUND AMPLIFICATION

Will promoters ever be used for any of the entertainment? No Yes If Yes, Describe: ALL PROMOTION WILL BE DONE BY OWNERSHIP.

At any time will sound amplification be used? No Yes If Yes, Describe: INSIDE PREMISES, MUSICIANS WILL HAVE PA SYSTEMS, AND INSTRUMENT AMPLIFIERS

LEGAL CAPACITY OF PREMISES

80 (Call the Development Center at 414-286-8211 with questions.) Legal capacity determines the fee for your Public Entertainment Premises License. If you would like to request the license be approved with a lower capacity than that listed above, indicate the lower capacity here: _____. If approved, this lower capacity will print on your license and override the capacity listed on your Occupancy Permit.

ACKNOWLEDGEMENT/SIGNATURE

I understand that after the license has been issued, a change to the plan of operation will require a written request to change and approval from the Common Council. I agree to inform the City Clerk within 10 days of any substantial changes in the information supplied in this application. I understand that I shall not willfully refuse to provide the services offered under this license, or add charges or require deposits not required of the general public because of race, color, sex, religion, national origin or ancestry, age, handicap, lawful source of income, marital status, sexual orientation, gender identity or expression, familial status or the fact that a person is now or has been a member of the military service, whether dressed in uniform or not; and shall not seek such information as a condition of employment, or penalize any employee or discriminate in the selection of personnel for training or promotion on the basis of such information.

I have knowledge of the City Ordinances currently regulating public entertainment, and understand that the license may be subject to suspension, non-renewal or revocation, if I violate any rule, law or regulation of the city of Milwaukee and State of Wisconsin.

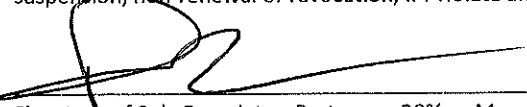

Signature of Sole Proprietor, Partner or 20% or More Shareholder
(If no 20% or more Shareholder, Corporate Officer - print name/title and sign)

Office Use Only:

Initials: _____ Filed: _____ App: _____
Only PEP? No Yes If Yes, Queue to MPD and Email Mgrs/Team Lead (must be heard w/in 60 days)

WILLINGTON PLACE

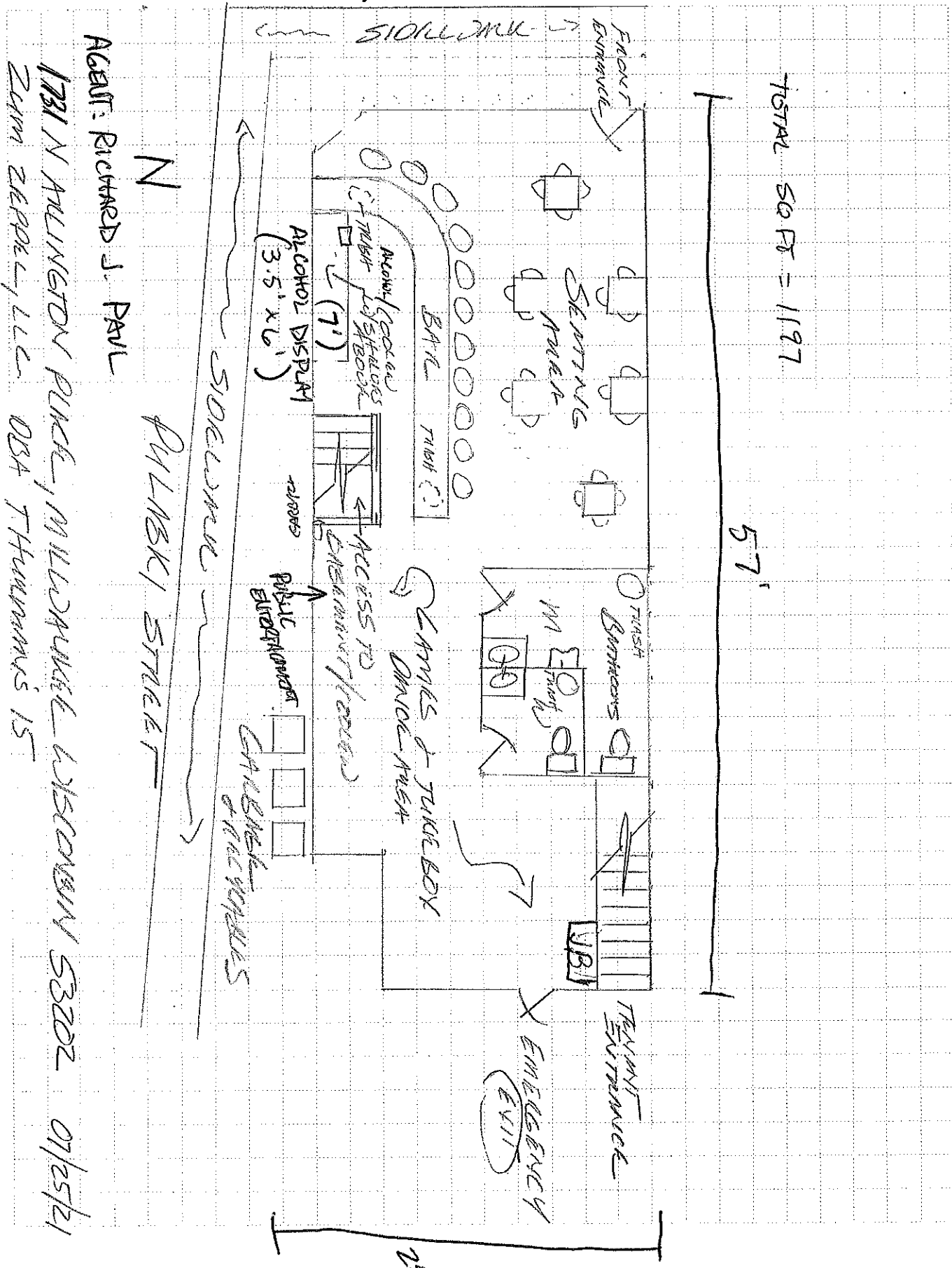

AGENT: RICHARD J. PAUL

N
WILLINKI STREET

1731 N WILLINGTON PLACE, MILWAUKEE WISCONSIN 53202 07/25/21
ZMM ZEPPE, LLC DBA THUNDERBOLT 15

BASEMENT DIMENSIONS

1731 N. ARLINGTON PLACE, MILWAUKEE, WI 53202

ZUM ZEPPEL, LLC DBA THURMAUS 15

AGENT: RICHARD PAUL

TOTAL SQ FT: 1197

