



CITY OF MILWAUKEE
OFFICE OF THE CITY CLERK

Monday, June 15, 2026

COMMITTEE MEETING NOTICE

AD 10

CASTRO TAPIA, Gloria IVELIS, Agent
DOS ISLAS CARIBBEAN KITCHEN LLC
5814 W BLUE MOUND RD
MILWAUKEE, WI 53213

You are requested to attend a hearing which is to be held in Room 301-B, Third Floor, City Hall or you may attend virtually using the link below.

Tuesday, June 30, 2026 at 09:20 AM

The access code is <https://meet.goto.com/873979789>. Please see the enclosed best practices document for further instructions.

Regarding: Your Class B Tavern License Application as agent for "DOS ISLAS CARIBBEAN KITCHEN LLC" for "DOS ISLAS CARIBBEAN KITCHEN" at 5814 W BLUE MOUND Rd.

There is a possibility that your application may be denied for one or more of the following reasons: The recommendation of the committee regarding the application shall be based on evidence presented at the hearing. Per MCO 85-2.7-4, probative evidence concerning whether or not a new license should be granted may be presented on the following subjects: whether or not the applicant meets the municipal requirements, the appropriateness of the location and premises where the licensed premises is to be located and whether use of the premises for the purposes or activities permitted by the license would tend to facilitate a public or private nuisance or create undesirable neighborhood problems such as disorderly patrons, unreasonably loud noise, litter, and excessive traffic and parking congestion. Probative evidence relating to these matters may be taken from the plan of operation submitted with the license application, if any, but shall not include the content of any music. Evidence regarding the fitness of the location of the premises to be maintained as the principal place of business, including but not limited to whether there is an overconcentration of businesses of the type for which the license is sought; whether the proposal is consistent with any pertinent neighborhood business or development plans, or the location's proximity to areas where children are typically present. The applicant's record in operating similarly licensed premises; and whether or not the applicant has been charged with or convicted of any felony, misdemeanor, municipal offense or other offense, the circumstances of which substantially relate to the activity to be permitted by the license being applied for or any other factor which reasonably relates to the public health, safety or welfare may also be considered. See attached police report or correspondence.

Notice for applicants with warrants or unpaid fines: Proof of warrant satisfaction or payment of fines must be submitted at the hearing on the above date and time. Failure to comply with this requirement may result in a delay of the granting/denial of your application.

Failure to appear at this meeting may result in the denial of your license. Individual applicants must appear only in person or by an attorney. Corporate or Limited Liability applicants must appear only by the agent designated on the application or by an attorney. Partnership applicants must appear by a partner listed on the application or by an attorney. If you wish to do so and at your own expense, you may be accompanied by an attorney of your choosing to represent you at this hearing.

You will be given an opportunity to speak on behalf of the application and to respond and challenge any charges or reasons given for the denial. No petitions can be accepted by the committee, unless the people who signed the petition are present at the committee hearing and willing to testify. You may present witnesses under oath and you may also confront and cross-examine opposing witnesses under oath. If you have difficulty with the English language, you should bring an interpreter with you, at your expense, so that you can answer questions and participate in your hearing.

You may examine the application file at this office during regular business hours prior to the hearing date. Inquiries regarding this matter may be directed to the person whose signature appears below.

Limited parking for persons attending meetings during normal business hours is available at reduced rates (5 hour limit) at the Associated Bank River Center on the southwest corner of Kilbourn Avenue and Water Street. You must present a copy of the meeting notice to the parking cashier.

PLEASE NOTE: Upon reasonable notice, efforts will be made to accommodate the needs of disabled individuals through sign language interpreters or other auxiliary aids. For additional information or to request this service, contact the Council Services Division ADA Coordinator at (414) 286-2998, Fax - (414) 286-3456, TDD - (414) 286-2025.

JIM OWCZARSKI, CITY CLERK

BY: _____

Jim Cooney
License Division Manager

If you have questions regarding this notice, please contact the License Division at (414) 286-2238.

200 E. Wells Street, Room 105, City Hall, Milwaukee, WI 53202. www.milwaukee.gov/license
Phone: (414) 286-2238 Fax: (414) 286-3057 Email Address: License@milwaukee.gov



CITY OF MILWAUKEE
OFFICE OF THE CITY CLERK

Monday, June 15, 2026

COMMITTEE MEETING NOTICE

AD 10

CASTRO TAPIA, Gloria IVELIS, Agent
DOS ISLAS CARIBBEAN KITCHEN LLC
526 S 64th st
MILWAUKEE, WI 53214

You are requested to attend a hearing which is to be held in Room 301-B, Third Floor, City Hall or you may attend virtually using the link below.

Tuesday, June 30, 2026 at 09:20 AM

The access code is <https://meet.goto.com/873979789>. Please see the enclosed best practices document for further instructions.

Regarding: Your Class B Tavern License Application as agent for "DOS ISLAS CARIBBEAN KITCHEN LLC" for "DOS ISLAS CARIBBEAN KITCHEN" at 5814 W BLUE MOUND Rd.

There is a possibility that your application may be denied for one or more of the following reasons: The recommendation of the committee regarding the application shall be based on evidence presented at the hearing. Per MCO 85-2.7-4, probative evidence concerning whether or not a new license should be granted may be presented on the following subjects: whether or not the applicant meets the municipal requirements, the appropriateness of the location and premises where the licensed premises is to be located and whether use of the premises for the purposes or activities permitted by the license would tend to facilitate a public or private nuisance or create undesirable neighborhood problems such as disorderly patrons, unreasonably loud noise, litter, and excessive traffic and parking congestion. Probative evidence relating to these matters may be taken from the plan of operation submitted with the license application, if any, but shall not include the content of any music. Evidence regarding the fitness of the location of the premises to be maintained as the principal place of business, including but not limited to whether there is an overconcentration of businesses of the type for which the license is sought; whether the proposal is consistent with any pertinent neighborhood business or development plans, or the location's proximity to areas where children are typically present. The applicant's record in operating similarly licensed premises; and whether or not the applicant has been charged with or convicted of any felony, misdemeanor, municipal offense or other offense, the circumstances of which substantially relate to the activity to be permitted by the license being applied for or any other factor which reasonably relates to the public health, safety or welfare may also be considered. See attached police report or correspondence.

Notice for applicants with warrants or unpaid fines:

Proof of warrant satisfaction or payment of fines must be submitted at the hearing on the above date and time. Failure to comply with this requirement may result in a delay of the granting/denial of your application.

Failure to appear at this meeting may result in the denial of your license. Individual applicants must appear only in person or by an attorney. Corporate or Limited Liability applicants must appear only by the agent designated on the application or by an attorney. Partnership applicants must appear by a partner listed on the application or by an attorney. If you wish to do so and at your own expense, you may be accompanied by an attorney of your choosing to represent you at this hearing.

You will be given an opportunity to speak on behalf of the application and to respond and challenge any charges or reasons given for the denial. No petitions can be accepted by the committee, unless the people who signed the petition are present at the committee hearing and willing to testify. You may present witnesses under oath and you may also confront and cross-examine opposing witnesses under oath. If you have difficulty with the English language, you should bring an interpreter with you, at your expense, so that you can answer questions and participate in your hearing.

You may examine the application file at this office during regular business hours prior to the hearing date. Inquiries regarding this matter may be directed to the person whose signature appears below.

Limited parking for persons attending meetings during normal business hours is available at reduced rates (5 hour limit) at the Associated Bank River Center on the southwest corner of Kilbourn Avenue and Water Street. You must present a copy of the meeting notice to the parking cashier.

PLEASE NOTE: Upon reasonable notice, efforts will be made to accommodate the needs of disabled individuals through sign language interpreters or other auxiliary aids. For additional information or to request this service, contact the Council Services Division ADA Coordinator at (414) 286-2998, Fax - (414) 286-3456, TDD - (414) 286-2025.

JIM OWCZARSKI, CITY CLERK

BY: _____

Jim Cooney
License Division Manager

If you have questions regarding this notice, please contact the License Division at (414) 286-2238.

200 E. Wells Street, Room 105, City Hall, Milwaukee, WI 53202. www.milwaukee.gov/license
Phone: (414) 286-2238 Fax: (414) 286-3057 Email Address: License@milwaukee.gov

MILWAUKEE POLICE DEPARTMENT LICENSING

CRIMINAL RECORD/ORDINANCE VIOLATION/INCIDENTS SYNOPSIS

DATE: 04/23/26

LICENSE TYPE: Class B Tavern

NEW:

RENEWAL:

No. 391924

Application Date:

License Location: 5814 W Bluemound

Business Name: Dos Islas

Licensee/Applicant: Castro Tapia, Gloria I
(Last Name, First Name, MI)

Date of Birth: 08/30/88

Home Address: 526 S 64th St

City: Milwaukee

State:

Zip Code: 53214

Home Phone:

This report is written by Police Officer Penny Monreal, assigned to the License Investigation Unit, Days.

The Milwaukee Police Department's investigation regarding this application revealed the following:

1. On 08/18/25, the applicant was charged with Child Abuse (Felony) in Milwaukee County Circuit Court. Review Hearing for Deferred Prosecution is scheduled for 07/10/26 Case 25CF003870

MILWAUKEE POLICE DEPARTMENT LICENSING

CRIMINAL RECORD/ORDINANCE VIOLATION/INCIDENTS SYNOPSIS

DATE: 04/23/26

LICENSE TYPE: Class B Tavern

NEW:

RENEWAL:

No. 391924

Application Date:

License Location: 5814 W Bluemound Rd

Business Name: Tavo's Mexican Restaurant

Licensee/Applicant: ORUE, Susy A
(Last Name, First Name, MI)

Date of Birth: 12/29/1985

Home Address: 9236 W Mitchell St

City: West Allis

State: WI Zip Code: 53214

Home Phone:

This report is written by Police Officer David Novak, assigned to the License Investigation Unit, Days.

The Milwaukee Police Department's investigation regarding this application revealed the following:

1. On 08/29/2009 the applicant was cited by the Greendale Police Department for Retail Theft.

Charge: Retail Theft
 Finding: Guilty
 Sentence: Forfeiture
 Date: 22/16/2009
 Case: 090854

2. On 11/21/2009 Gustavo CAMACHO (50% shareholder) was cited for Prohibited Alcohol Concentration. He was convicted on 12/21/2009 and his license was revoked for 6 months.

=====

PREVIOUS PREMISE



Crime Prevention Through Environmental Design

CPTED

Date: 04/27/26

Officer: Felix

Business:

Name: Dos Islas Caibbean Kitchen

Location: 5814 W. Blue Mound Rd.

Phone N/A:

Agent:

Name: Castro-Tapia, Gloria

Address: 526 S. 64th St.

City: Milwaukee

State: Wi ZIP: 53214

Phone: 414-915-2410

Email:

Owner of Business: Yes No (Add Info if not agent) _____

Phone: _____

Preferred Contact(s): Agent Owner Other Jose Soto

Type of business: Tavern/Bar Restaurant Convenience Other _____

The business is enclosed in a shopping structure, commercial building or hospital:

(Cannot be entered from a Public Street) Yes

Property is under construction or remodel: Survey was done by agent explaining plans. (Some items are not functional at time of survey).

Exterior Survey:

Are the address numbers prominently displayed and easy to see? Yes No

Is the area around the location clean? Yes No

The area is a business district or/and mix use (residential)?

Other businesses attached to the same building Yes No

Are windows free of signage? Yes No

Can the interior clearly be seen from outside? Yes No

Is there exterior lighting? Yes No.

Is lighting adequate? Yes No

Are there "No Loitering" Signs posted? Yes No

Parking:

- Adequate City Street parking Yes No
Will valet service be used any time during business hours? Yes No
Is there a parking lot? (If no, skip other items in parking section) Yes No
Is lot clean? Yes No
Is the lot well illuminated? Yes No
Is there a security guard or perimeter control? Yes No
Are there Cameras? Yes No

Other resources or businesses within the area? (If yes, how many)

- Park School Youth Center or Day care Community Outreach Church Medical
 Residential

- Convenience Store/ Supermarket: Yes No _____
Restaurant: Yes No _____
Gas station(s): Yes No _____
Tabaco/ Vape Store: Yes No _____
Liquor store(s): Yes No _____
Tavern(s): Yes No _____
Other(s): Auto Shops Yes

Security: (If no security check and skip to next)

- Will there be security Yes No Armed? Yes No
Employed by: business contracted company
Security will monitor: Interior Exterior
Security Hours (Add to narrative along with number and how they will be deployed)

Cameras:

- Plans to have a camera system but not installed or operating: Yes
(If yes, answer next question and skip additional camera section add info to narrative)
Are cameras required by city ordinance at this business? Yes No
(If no, and there is no system skip to next section)
Are there working cameras at the business Yes No
How many working? Interior _____ Exterior _____
Is there a camera facing and entrance / exit? Yes No
Is a camera facing the register? Yes No
Is the data saved on: local hard drive Cloud / off site service
How long is footage saved? _____
Is on site camera hard drive in a secured area? Yes No N/A
Who has access to security footage? Owner Manager Employee(s) Security/Service

Bar/ Tavern / night club/ Restaurant N/A (Skip to next section)

Age Restriction ID Scanner Dress Code Metal Detector Physical search

Planned capacity: # 25

Interior:

Is the interior clean and neat? Yes No

Can employees see out of the business to the exterior? Yes No

What is the minimum number of employees during hours of operation? 2

Is there an area employees can secure themselves? Yes No

Are emergency and non-emergency numbers posted near the phone? Yes NO

Does the store sell? N/A (Skip to next section)

Single chore boy: Yes No

Blunt wraps: Yes No

Scale/Grinders: Yes No

Items that may be used as crack pipes: Yes No

Describe items _____

Overabundance of sandwich baggies: Yes No

Does the owner/agent understand that these items are often used for drug use?

Yes No

Do the products in the store appear to be new and rotated often?

Yes No

Current License(s): (Held at location by agent or Business)

Alcohol #: _____ Yes No Class: A B B-Manager D-Oper

Extended Hours #: _____ Yes No

Filling #: _____ Yes No

Food #: _____ Yes No Type: Restaurant PED Retail

Hotel/Motel#: _____ Yes No

Tobacco #: _____ Yes No

Secondhand Dealer #: _____ Yes No Type: Pawn Vehicle

Parking lot #: _____ Yes No

Pub-Enter-Pre# _____ Yes No Type:

Other #: _____ Yes No Type: _____

Plan of Operation:

Currently Open: Yes No – Projected open date: Click or tap to enter a date. May 13, 2026

Hours: 24HRS Hours are the same every day (Enter time once)

Sun: _____:_____ - _____:_____ Closed

Mon: _____:_____ - _____:_____ Closed

Tue: _____:_____ - _____:_____ Closed

Wed: _____:_____ - _____:_____ Closed

Thu: _____:_____ - _____:_____ Closed

Fri: _____:_____ - _____:_____ Closed

Sat: _____:_____ - _____:_____ Closed

Complete this section if alcohol establishment is a convenience store: N/A (Skip to Recommendations)

(Exemption) Is the store located in an enclosed shopping structure, enclosed commercial building or hospital? A convenience food store is not in an enclosed structure or building if a customer cannot enter it directly from the outside.

- All convenience food stores not exempted under sub. 3 shall:

*Have cash register located in a manner so that at the time of a sales transaction, the employee and customer are both visible from the sidewalk? Yes No

*Post a sign which states that the cash register contains \$50 or less and that the safe is not accessible to employees? Yes No

- Maintain any of the following at the property?

*A safe that was in use at the convenience food store on August 17, 1994?

Yes No

* A drop-safe or time release safe that weighs at least 500 pounds or which is attached to or set into the floor in a manner approved by the police department?

Yes No

* Has the owner and their employees attended the Robbery Prevention Training within 120 days of ownership or employment? Yes No

* Sub 3. Exemptions. The requirements of this section do not apply to a convenience food store that conforms to either of the following descriptions: Yes No

(CPTED- A strategy that aims to reduce crime by changing the physical design of buildings and public spaces).

Comments/ Recommendations:

The owners and agent were both advised of the following.
Post emergency numbers near the phone. Secure or install a new rear door. If installing cameras cover the entrance, register, and liquor storage room.



Concentration Map - 5814 W Blue Mound Rd

Area of Interest (AOI) Information

Area : 21,862,585.81 ft²

Mar 31 2026 15:08:05 Central Daylight Time

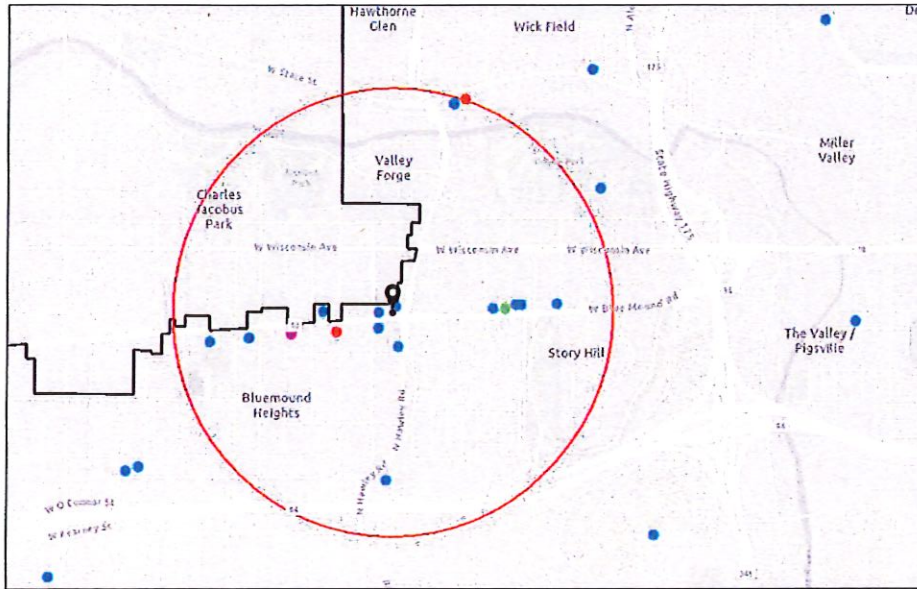

Alcohol Licenses (active)

● Class A Intoxicating Liquor

● Class A Fermented Malt Beverage

● Class A Liquor and Malt

● Class B Fermented Malt Beverage

● Class B Tavern

● Class C Wine Retailer

□ City Limits

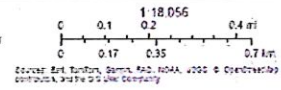

Summary

Name	Count	Area(ft ²)	Length(mi)
Alcohol Licenses	19		

Alcohol Licenses

#	Legal Entity	Trade Name	Licensee	Address	License Type Name	Total Capacity	Expiration Date	Count
1	SAZCO, INC	SAZ'S STATE HOUSE	Stephanie L Sazama-Schneck, Agt	5539 W STATE ST	Class B Tavern License	228	4/4/2026, 7:00 PM	1
2	DugOut 54 Inc	DugOut 54	David D Grycan, Agt	5328 W Blue Mound RD	Class B Tavern License	689	5/25/2026, 7:00 PM	1
3	Tavo's LLC	Tavo's Signature Cuisine	Susy A Orue, Agt	5814 W BLUE MOUND RD	Class B Tavern License	25	5/11/2026, 7:00 PM	1
4	MAGOOS ON THE MOUND LLC	MAGOO'S ON THE MOUND	MARK A ZIERATH, Agt	5841 W BLUE MOUND RD	Class B Tavern License		6/8/2026, 7:00 PM	1
5	SANDHAR WINE AND SPIRITS LLC	BLUEMOUND LIQUOR	NAVDEEP SANDHAR, Agt	6001 W BLUE MOUND RD	Class A Malt & Class A Liquor License		6/10/2026, 7:00 PM	1
6	Milwaukee Steakhouse LLC	Milwaukee Steakhouse	KEVIN M NUGENT, Agt	6024 W BLUE MOUND RD	Class B Tavern License	99	6/23/2026, 7:00 PM	1
7	ENCORE, INC	MONREAL'S ENCORE	NICOLAS S MONREAL, Agt	101 S DANA CT	Class B Tavern License	80	6/29/2026, 7:00 PM	1
8	BARBIERE'S ITALIAN INN, LTD	BARBIERE'S ITALIAN INN	Steven J Thalman, Agt	5844 W BLUE MOUND RD	Class B Tavern License	90	6/29/2026, 7:00 PM	1
9	Story Hill BKC LLC	Story Hill Bottle - Kitchen - Cup	DANIEL S SIDNER, Agt	5100 W Blue Mound RD	Class B Tavern License		7/29/2026, 7:00 PM	1
10	TOETZ ENTERPRISE S, LLC	ROUNDING THIRD	TIMOTHY R TOETZ, Agt	6317 W BLUE MOUND RD	Class B Tavern License	393	8/30/2026, 7:00 PM	1
11	S & V, INC	KELLY'S BLEACHERS	ANTHONY L LUCHINI, Agt	5218 W BLUE MOUND RD	Class B Tavern License	150	9/30/2026, 7:00 PM	1
12	SH Firehouse, LLC	Story Hill Firehouse	Janelle Meyer-Brown, Agt	407 N Hawley RD	Class B Tavern License		11/4/2026, 6:00 PM	1
13	IAN'S PIZZA STORY HILL MKE LLC	IAN'S PIZZA STORY HILL	Ryan W Donovan, Agt	5300 W BLUE MOUND RD	Class C Wine Retailer's License		10/12/2026, 7:00 PM	1
14	IAN'S PIZZA STORY HILL MKE LLC	IAN'S PIZZA STORY HILL	Ryan W Donovan, Agt	5300 W BLUE MOUND RD	Class B Fermented Malt Beverage Retailer's License		10/12/2026, 7:00 PM	1
15	MARIO, INC	BALISTRERI'S BLUEMOUND INN	MARIO J BALISTRERI, Agt	6501 W BLUE MOUND RD	Class B Tavern License	140	12/17/2026, 6:00 PM	1
16	SHARMA INC	ONE STOP PANTRY	KULWINDER KUMAR, Agt	6131 W BLUE MOUND RD	Class A Fermented Malt Beverage Retailer's License		2/3/2027, 6:00 PM	1
17	SHARMA INC	ONE STOP PANTRY	KULWINDER KUMAR, Agt	6131 W BLUE MOUND RD	Class A Retailer's Intoxicating Liquor License		2/3/2027, 6:00 PM	1
18	J B Tavern, LLC	J&B's Blue Ribbon Bar & Grill	JONATHAN E BLIESNER, Agt	5230 W BLUE MOUND RD	Class B Tavern License	150	3/2/2027, 6:00 PM	1

19	SAZCO, INC	SAZ'S STATE HOUSE	Stephanie L Sazama-Schneck, Agt	5539 W STATE ST	Class B Tavern License	228	4/4/2027, 7:00 PM	1
----	------------	-------------------	---------------------------------	-----------------	------------------------	-----	-------------------	---

Establishments within a 0.5 miles radius centered on area of interest.



Monday, June 15, 2026



Notice of Public Hearing

Blank Notice

CASTRO TAPIA, Gloria IVELIS, Agent
Dos Islas Caribbean Kitchen at 5814 W Blue Mound Rd
Class B Tavern License Application

Tuesday, June 30, 2026 at 9:20 AM

To whom it may concern:

The above application has been made by the above named applicant(s). This requires approval from the Licenses Committee and the Common Council of the City of Milwaukee. The hearing before the Licenses Committee will take place on 6/30/2026 at 9:20 AM in Room 301-B, Third Floor, City Hall. This is a public hearing. Those wishing to view the proceeding are able to do so via the City Channel – Channel 25 on Spectrum Cable – or on the Internet at <http://city.milwaukee.gov/citychannel>. Those wishing to provide oral testimony via internet are asked to contact the staff assistant, Yadira Melendez at (414) 286-2775 or stasst5@milwaukee.gov for necessary information. Please make such requests no later than one business day prior to the start of the meeting. You are not required to attend the hearing, but please see the information below if you would like to provide testimony. Once the Licenses Committee makes its recommendation, this recommendation is forwarded to the full Common Council for approval at its next regularly scheduled hearing.

Important details for those wishing to provide information for the Licenses Committee to consider when making its recommendation:

1. The license application is scheduled to be heard at the above time. Due to other hearings running longer than scheduled, you may have to wait some time to provide your testimony.
2. You must appear in person and testify as to matters that you have personally experienced or seen. (You cannot provide testimony for your neighbor, parent or anyone else; this is considered hearsay and cannot be considered by the committee.)
3. No letters or petitions can be accepted by the committee (unless the person who wrote the letter or the persons who signed the petition are present at the committee hearing and willing to testify).
4. Persons opposed to the license application are given the opportunity to testify first; supporters may testify after the opponents have finished.
5. When you are called to testify, you will be sworn in and asked to give your name, and address. (If your first and/or last names are uncommon please spell them.)
6. You may then provide testimony.
 - a. Include only information relating to the above license application.
 - b. Include only information you have personally witnessed or seen.
 - c. Provide concise and relevant information detailing how this business has affected or may affect the peaceful enjoyment of your neighborhood.
 - d. If by the time you have the opportunity to testify, the information you wish to share has already been provided to the committee, you may state that you agree with the previous testimony. Redundant or repetitive testimony will not assist the committee in making its recommendation.
7. After giving your testimony, the members of the Licenses Committee and the licensee may ask questions regarding the testimony you have given or other factors relating to the license application.
8. Business Competition is not a valid basis for denial or non-renewal of a license.
Please Note: If you have submitted an objection to the above application your objection cannot be considered by the committee unless you personally testify at the hearing.

OCCUPANT	MAIL ADDRESS	CITY STATE ZIP
CURRENT OCCUPANT	427 N HAWLEY RD	MILWAUKEE, WI 53213-4234
CURRENT OCCUPANT	427A N HAWLEY RD	MILWAUKEE, WI 53213-4234
CURRENT OCCUPANT	512 N 59TH ST# 1	MILWAUKEE, WI 53213-4212
CURRENT OCCUPANT	512 N 59TH ST# 10	MILWAUKEE, WI 53213-4212
CURRENT OCCUPANT	512 N 59TH ST# 2	MILWAUKEE, WI 53213-4212
CURRENT OCCUPANT	512 N 59TH ST# 3	MILWAUKEE, WI 53213-4212
CURRENT OCCUPANT	512 N 59TH ST# 4	MILWAUKEE, WI 53213-4212
CURRENT OCCUPANT	512 N 59TH ST# 5	MILWAUKEE, WI 53213-4212
CURRENT OCCUPANT	512 N 59TH ST# 6	MILWAUKEE, WI 53213-4212
CURRENT OCCUPANT	512 N 59TH ST# 7	MILWAUKEE, WI 53213-4212
CURRENT OCCUPANT	512 N 59TH ST# 8	MILWAUKEE, WI 53213-4212
CURRENT OCCUPANT	512 N 59TH ST# 9	MILWAUKEE, WI 53213-4212
CURRENT OCCUPANT	521 N HAWLEY RD	MILWAUKEE, WI 53213-4235
CURRENT OCCUPANT	527 N HAWLEY RD	MILWAUKEE, WI 53213-4235
CURRENT OCCUPANT	530 N HAWLEY RD	MILWAUKEE, WI 53213-4236
CURRENT OCCUPANT	530A N HAWLEY RD	MILWAUKEE, WI 53213-4236
CURRENT OCCUPANT	530B N HAWLEY RD	MILWAUKEE, WI 53213-4236
CURRENT OCCUPANT	530C N HAWLEY RD	MILWAUKEE, WI 53213-4236
CURRENT OCCUPANT	539 N HAWLEY RD# 1	MILWAUKEE, WI 53213-4235
CURRENT OCCUPANT	539 N HAWLEY RD# 2	MILWAUKEE, WI 53213-4235
CURRENT OCCUPANT	5701 W MICHIGAN ST	MILWAUKEE, WI 53213-4243
CURRENT OCCUPANT	5701A W MICHIGAN ST	MILWAUKEE, WI 53213-4243
CURRENT OCCUPANT	5729 W MICHIGAN ST	MILWAUKEE, WI 53213-4276
CURRENT OCCUPANT	5731 W MICHIGAN ST	MILWAUKEE, WI 53213-4276
CURRENT OCCUPANT	5834 W BLUE MOUND RD# 1	MILWAUKEE, WI 53213-4226
CURRENT OCCUPANT	5834 W BLUE MOUND RD# 2	MILWAUKEE, WI 53213-4226
CURRENT OCCUPANT	5834 W BLUE MOUND RD# 3	MILWAUKEE, WI 53213-4226
CURRENT OCCUPANT	5840 W BLUE MOUND RD# 1	MILWAUKEE, WI 53213-4226
CURRENT OCCUPANT	5840 W BLUE MOUND RD# 2	MILWAUKEE, WI 53213-4226
CURRENT OCCUPANT	5841 W BLUE MOUND RD# A	MILWAUKEE, WI 53213-4225
CURRENT OCCUPANT	603 N HAWLEY RD	MILWAUKEE, WI 53213-4237

Blank Notice

Total Records: 31

Radius 250 feet and Center of the Circle: 2903 W Clybourn St



BUSINESS LICENSE PLAN OF OPERATION

ccl-busplan 5/12/2020

Office of the City Clerk License Division
200 E. Wells St. Room 105, Milwaukee, WI 53202
(414) 286-2238 www.milwaukee.gov/license e-mail address: license@milwaukee.gov

1. Type of Business

Applying for: Extended Hours (12AM to 5AM) - If a food establishment, check all that apply: Delivery Drive Thru Dining Room
 Self Service Laundry Massage Establishment Filling Station
 Other (supplemental application for specific license also required)

Provide a detailed description of the type of business you plan on operating:

Food

Do you have any experience operating this type of business? No Yes If yes, explain:

2. Business Operations

- a. Proposed Opening Date: 04/02/2026
- b. Is this premise under construction? No Yes If yes, list estimated completion date: _____
- c. Is this a franchise? No Yes
- d. Is this premises currently licensed? No Yes If yes, list type of license: Food and Alcohol
- e. Is the current licensee operating? No Yes If no, list date closed: _____
- f. Do you have future plans for other businesses, licenses or permits at this location? No Yes
If yes, explain: Alcohol
- g. Have you previously held an Extended Hours License in Milwaukee? No Yes
If yes, list address(es): _____
- h. Are other businesses operating in the same building? No Yes If yes, describe: _____

3. Litter & Noise

- a. How are grounds kept clean? Sweep Pressure Wash Pick Up Litter Other: _____
- b. How often will grounds be cleaned? Daily Weekly As Needed Monthly Other: _____
- c. Grounds cleaned by: Licensee Building Owner Employees Hired Maintenance Other: _____
- d. How are noise issues prevented and/or addressed? Security Manager approaches customer(s) Call Police
 Signs Posted Other: _____
- e. Will a sound amplification system be used? No Yes If yes, describe: _____

4. Smoking & Sanitation

- a. Are there designated outdoor smoking areas? No Yes If yes, describe: _____
- b. Number of Garbage Cans: Inside: 3 Locations: Kitchen, Bar and Restrooms
Outside: 2 Locations: Front and backside
- c. Is a crowd control barrier used? No Yes If yes, describe: _____
- d. How many restrooms are on the premises? 1
- e. Name of solid waste contractor: Advanced Disposal Waste Management Other: GFL

5. Security

- a. Are there onsite parking spaces? No Yes If yes, how many? 12 and describe the parking security plan: light
- b. Is there a loading zone? No Yes If yes, describe the loading area security plan: _____
- c. Will you have licensed security on premise? No Yes If yes, how many? _____ and answer the following:
 What are their responsibilities? _____
 Describe equipment used _____
 List their License Number (s) _____
- d. Will there be security cameras? No Yes If yes, how many? _____ and list locations: _____
- e. Will searches/identification checks be done upon entry? No Yes If yes, describe _____

6. Percentage of Sales (must total 100%)

Alcohol <u>00</u> %	Food <u>40</u> % Cigarettes, Electronic Vape Devices, Tobacco Products _____ %	Secondhand Merchandise _____ %	Precious Metals & Gems _____ %
Entertainment _____ %	Salvaged Materials _____ % (such as scrap metal)	Personal Services (such as tattoo, body piercing, salon, tailor, tanning, etc.) _____ %	Other _____ % Describe: _____
Pawnbroker Activity _____ %			

7. Businesses/Licenses on the Premises (check all that apply):

Type 1

- Full Service Restaurant Cafe/Coffee Shop Deli or Fast Food Restaurant Private/Fraternal/Veterans Club
- Night Club Tavern Cocktail Lounge Teen Club
- Banquet Hall Sports Facility Bowling Alley
- Hotel/Motel : Number of Floors: _____ Number of Rooms: _____ Rooming House: Number of Floors: _____ Number of Rooms: _____

Type 2

- Liquor Store Corner Store Supermarket Convenience Store
- Gas Station Amusement/Phonograph Distributor Recycling, Salvage or Towing
- Used Car Dealer Personal Service Establishment (such as tattoo business, hair salon, tailor, etc.) Recording Studio

What other licenses/permits will you hold at this location? (check all that apply)

- Occupancy Permit Cigarette, Tobacco, Electronic Vape Products Gas Station Extended Hours Class "B" Tavern Weights & Measures
- Secondhand Dealer Precious Metal & Gem Other: Alcohol

8. Legal Capacity (only if a Type 1 premises in #7 above)

Capacity 25 (Call the Milwaukee Development Center at 414-286-8211 if you have questions.)

9. Premises Description

- a. Identify all area(s) of the premises that will be used in operating this business (include areas used only for storage):
 1st Floor 2nd Floor Basement Storage Patio Beer Garden Sidewalk Café Deck Rooftop
 Other: Describe: _____
- b. Describe Location: Major Thoroughfare Secondary Street Other: _____
- c. Nearest Major Cross Street: N Hawley Rd
- d. Describe Building: Free Standing Building Strip Mall Other: _____
- e. Describe Premises Structure: Single Story Multi-Story - # of Stories _____ Other: _____
- f. Describe Surrounding Area: Commercial Residential Industrial Other: _____
- g. Building Owner Name: Richard Greiten Phone Number: 414-975-6122
 Building Owner Address: 5814 W Bluemound Rd

10. Hours of Operation & Customers

Will customers be entering the premises? No Yes viernes y sábado ^{Closed} 12am - 2am after alcohol

Day of the Week	Proposed Hours of Operation:		Estimated Number of Customers expected each day	Potential Age Range of Customers	Class B Tavern Applicant Only: Age Restriction (If none, write 'None')
	Open Time (include a.m. or p.m.)	Close Time (include a.m. or p.m.)			
Sunday	6am	10pm	20	20	None
Monday	6am	10pm	20		None
Tuesday	6am	10pm	20		None
Wednesday	6am	10pm	20		None
Thursday	6am	10pm	20		None
Friday	6am	2am	20		None
Saturday	6am	2am	30		None

An Extended Hours Establishment License is required for any convenience store, filling station, personal service establishment (such as tattoo, body piercing, salon, tailor, tanning, etc.), recording studio or restaurant which is open between the hours of 12:00 a.m. and 5:00 a.m.

Alcohol Establishments Permitted Hours of Operation: Class A: 8:00 am to 9:00 pm Sunday thru Saturday
 Class B: 6:00 am to 2:00 am Sunday thru Thursday, 6:00 am to 2:30 am Friday & Saturday

Entertainment Outdoor Closing Hours: 10:00pm Sunday-Thursday; 12:00am Friday & Saturday; unless a different time, either earlier or later, is established by the Common Council in its approval of the licensee's plan of operation.

11. Signature(s)

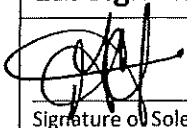

Signature of Sole Proprietor, Partner, or 20% or more Shareholder
 (If there are no 20% or more shareholders,
 Corporate Officer-print name/title and sign)

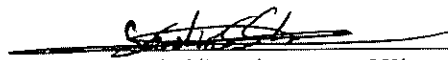

Signature of additional partner or 20% or more shareholder

See Application Information for a complete list of all required application forms.



ALCOHOL BEVERAGE & PUBLIC ENTERTAINMENT PREMISES SUPPLEMENTAL APPLICATION



Office of the City Clerk License Division
200 E. Wells St. Room 105, Milwaukee, WI 53202
(414) 286-2238 e-mail address: license@milwaukee.gov www.milwaukee.gov/license

Legal Entity Name: <u>Los Islas Food LLC</u>
Premise Address: <u>5814 W Bluemound Rd Milwaukee WI 53213</u>
Proximity of Premises to Church, School, Daycare Center or Hospital
Is the building within 300 feet of any church, school, daycare center or hospital? <input type="checkbox"/> No <input type="checkbox"/> Yes
"Service Bar Only" Designation
If applying for Class B or C license, are you applying for "Service Bar Only"? <input checked="" type="checkbox"/> No <input type="checkbox"/> Yes Service Bar Only means customers cannot sit at the bar. Alcohol is served to employees who serve patrons seated at tables. No stools, chairs or other articles of furniture shall be placed at the service bar for patrons to sit upon.
Business Information
a) Are you taking out this application for anyone that may not be eligible for a license? <input checked="" type="checkbox"/> No <input type="checkbox"/> Yes If yes, list their name and address: _____
b) Will the agent, a partner or the individual licensee be conducting the day-to-day operations of the business? <input type="checkbox"/> No <input checked="" type="checkbox"/> Yes If no, list the name and address of the person(s) who will: _____ _____
Class B Applicants: If the agent, a partner or the individual licensee will not be conducting the day-to-day operations of the business, the person(s) listed above must obtain a Class B Managers license.
c) Does anyone else have money invested or any other interest in this business? <input checked="" type="checkbox"/> No <input type="checkbox"/> Yes If yes, explain: _____
d) Have you made an agreement with anyone to repay any loan or any other payments based upon income from the business? <input checked="" type="checkbox"/> No <input type="checkbox"/> Yes If yes, list name and address: _____
Property Information (New & Transfer Applicants Only)
a) Do you own or lease the building? <input type="checkbox"/> Own <input checked="" type="checkbox"/> Lease
b) Who owns the fixtures (for example, coolers, etc.)? <u>Gloria Castro</u>
c) Are you purchasing the stock and/or fixtures? <input type="checkbox"/> No <input checked="" type="checkbox"/> Yes If yes, amount paid \$ <u>8,000</u>
d) Total amount paid for business \$ <u>8,000</u>
e) Total amount paid for goodwill of the business \$ <u>8,000</u>
Goodwill comprises the reputation and customer relationships of an existing business. If the price you pay for the business exceeds the fair market value of all of the rest of the assets of the business, the excess may be considered goodwill.

Form Continues on next page →

Lease Information (New & Transfer Applicants who are leasing the premises only)

- a) Date lease begins 03/07/26 Ends 03/07/27
- b) Monthly rental \$ 1,650
- c) Do you have an option to renew the lease? No Yes
- d) Does your lease allow for assignment to another party without the consent of the owner? No Yes
- e) For what length of time have you been guaranteed occupancy (number of years)? _____
- f) In addition to paying the monthly rental, will you have to pay anything additional to the owner of the building to guarantee performance of the lease? No Yes If yes, explain _____
- g) Does the present owner or occupancy object to the granting of your license? No Yes
If yes, explain _____

Change of Agent Applicants Only

Have there been any changes to the floor plan since the last application was submitted? No Yes
If no, a new floor plan is not required. If yes, submit a new floor plan and explain the change(s): _____

Responsible Beverage Server Training

- a) Within the last 2 years have you held a bartender's license in the state of Wisconsin? No Yes
- b) Within the last 2 years have you held a Class "A" or Class "B" alcohol beverage license, or a Class "B" manager's license in the state of Wisconsin? No Yes
- c) Within the last 2 years have you completed a Responsible Beverage Server Training Course in the state of Wisconsin? No Yes

If you answered no to all the above questions, proof of course completion must be provided by submitting your course certificate to the License Division.

For Course enrollment information, contact MATC at (414) 297-8370 or for similar approved courses see "Training" on the Wisconsin Department of Revenue's Website (<https://www.revenue.wi.gov/Pages/Training/alcSellerServer.aspx>)

I understand that a license will not be issued without a copy of the course certificate or proof of the license held within the last two years being submitted to the License Division.

Print Name of Individual/Partner/Agent

Signature of Individual/Partner/Agent

Signature

Signature of Sole Proprietor, Partner or 20% or More Shareholder
(If no 20% or more Shareholder, Corporate Officer - print name/title and sign)

Note: All information contained in this application is subject to approval by the Common Council.
Deviating from approved plan of operation will subject licensee to citations, and/or suspension or non-renewal of the license.
Contact the License Division for information on how to request changes.

New and transfer of premises applicants must submit the following:

- Detailed floor plan
- If a restaurant, copy of the menu

02/07/20

DOS 151AS turn in
Gloria Castro Tapia
5418 W Bluemound Rd
Milwaukee, WI 53213

Basement

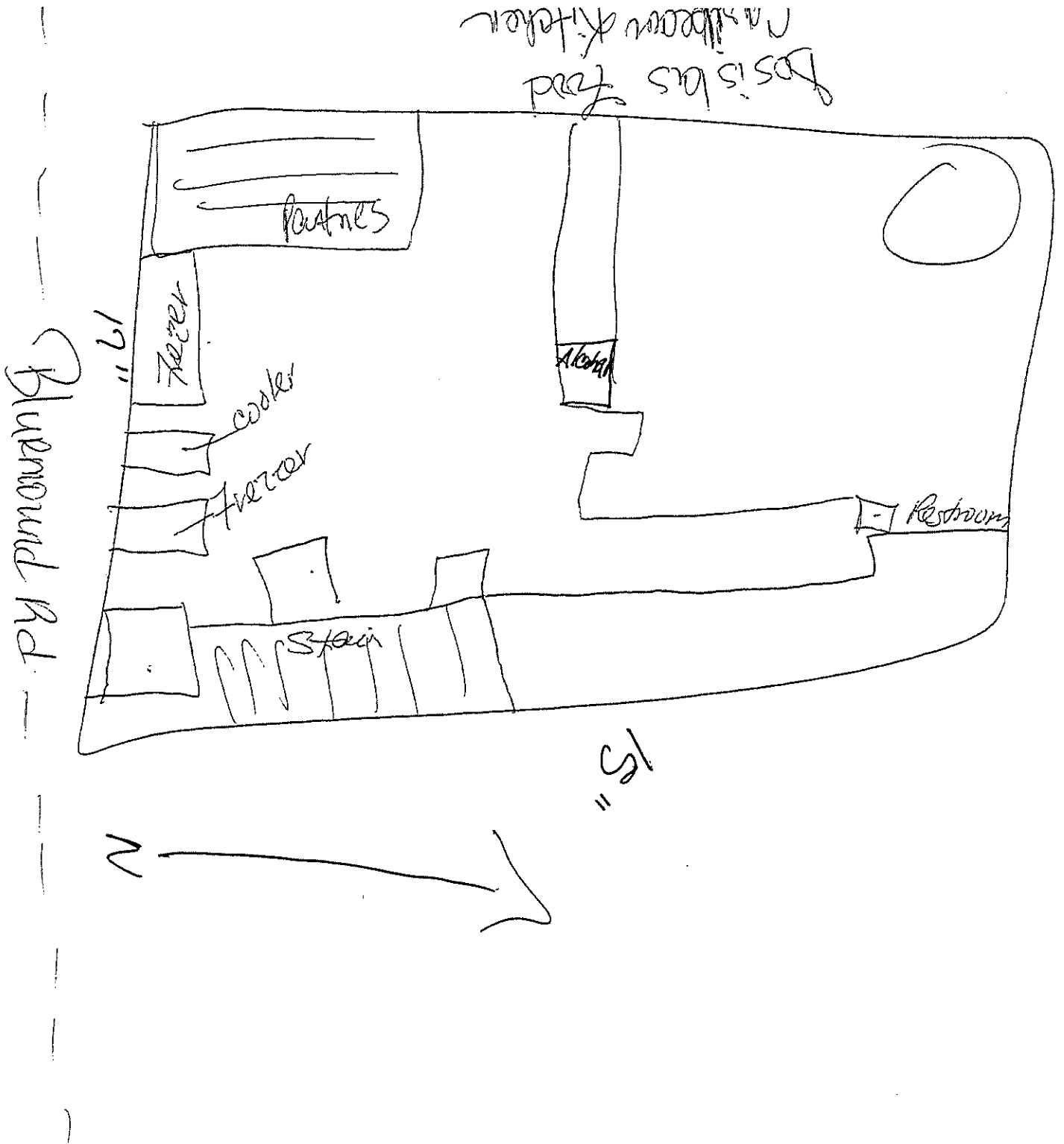

DOS 151AS turn in
Gloria Castro Tapia
Milwaukee, WI 53213