

Customer Information

809 N. Broadway/PO Box 324/Milwaukee, WI 53201-0324/414-286-8211

Air or Subterranean Space Lease Petition

Submit this application with \$150 application fee to:
Milwaukee Development Center
Make check payable to City of Milwaukee.
Application fee is non-refundable.

Date June 4, 2009

TO THE HONORABLE, THE COMMON COUNCIL OF THE CITY OF MILWAUKEE:

The undersigned MillerCoors, LLC, a Delaware limited liability company,
(state whether petitioner is an individual, co-partnership, Wisconsin or foreign corporation)
respectfully petitions the Common Council of the City of Milwaukee, according to the provisions of Section 66.048(3)
and (4) of the Wisconsin Statutes, that the following space lease be granted:

Subterranean Space Lease for existing Special Privilege (No. 369) structure consisting of an underground tunnel
approximately 6 feet wide and 7 feet high, the center line of which is about 9 feet 6 inches east of the center line of the tunnel
constructed under Special Privilege No. 308, across and beneath West State Street in the vicinity of 4002 West State Street
of which building plans, plot plans and descriptive data showing the elevations, locations, height and size of the
proposed structure and its relationship to adjoining buildings are herewith submitted.

The petitioners are the owners in fee of the following described real property:

MillerCoors, LLC owns the property on the north and south sides of West State Street

also known by street and number as 4001 West State Street (Bldg. 15) and 3930 West State Street (Bldg. 26)
which property is located on both sides of that portion of the (street/alley XXXXXXXXXXXXX) to be so leased.

This petition is subject to such terms and conditions as may be agreed up on between the City of Milwaukee and the
petitioner, which terms and conditions shall be set forth in a written lease pursuant to Section 66.048(3) and (4),
Wisconsin Statutes. The leasing of such space shall be subject to a determination by the Common Council of the City
of Milwaukee that such space is not needed for street, alley or other public purpose and that the public interest will be
served by such leasing, and upon such determination as shall be authorized by ordinance duly passed by the City of
Milwaukee.

Signature *Brian C. Randall* Brian C. Randall, Agent

Address 330 East Kilbourn Avenue, Suite 1250 (53202)

Phone (414) 271-0130

Corporation, firm or society MillerCoors, LLC

Address 3939 West Highland Boulevard (53208)

Title or office held in same Authorized Agent and Attorney-in-Fact

SUBSURFACE EASEMENT EXHIBIT

TUNNEL BELOW WEST STATE STREET

Situated in West State street, in the City of Milwaukee, Milwaukee County, Wisconsin.

A subsurface easement across West State street, being a part of the Southwest 1/4 of the Northwest 1/4 of Section 25, Town 7 North, Range 21 East, in the City of Milwaukee, Milwaukee County, Wisconsin, bounded and described as follows.

Commencing at the intersection of the present East line of North 41st street and the present South line of West State street; thence North 82°30'27" East along the Southerly right of way line of West State street 116.07 feet to the point of beginning of the present East line of North 41st street and the present South line of West State street; thence North 06°12'20" East along the Southerly right of way line of West State street 66.02 feet to a point on the Northerly line of West State street; thence North 82°30'27" East along said Northerly line 10.00 feet to a point; thence South 06°12'20" East 66.02 feet to a point on the Southerly line of West State street; thence South 82°30'27" West along said Southerly line 10.00 feet to the point of beginning.

Containing 660 sq.ft. (0.015 acres).

February 19, 2009

Miller Coors

Survey no. 163997-ojm

Note:
Elevations are based on the City of Milwaukee datum

PROFILE OF SUBSURFACE TUNNEL LOOKING WEST

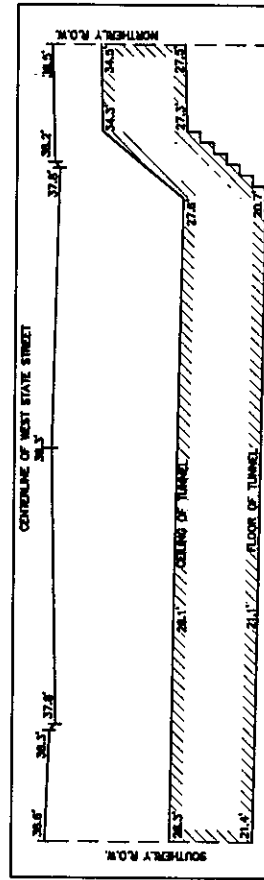

R.A. Smith National, Inc.
Beyond Surveying
and Engineering

16745 W. Blumound Road, Brookfield WI 53005
262-781-1000 Fax: 262-797-7373
www.ra-smithnational.com

S:163997dwg
EX0008.dwg EX:101010
SHEET | OF | 1

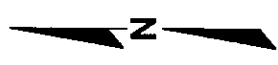
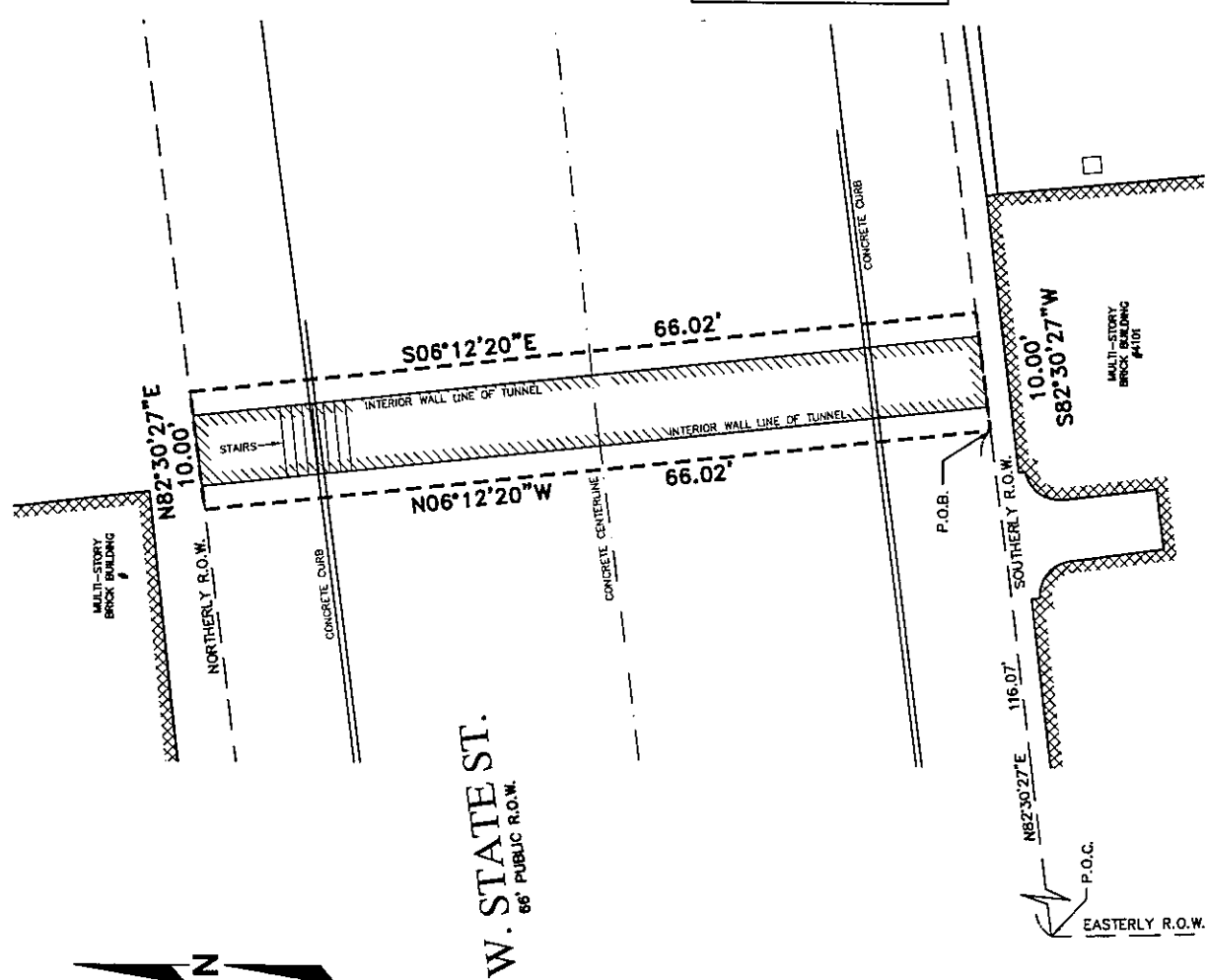
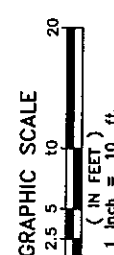

W. STATE ST.
66' PUBLIC R.O.W.

NORTH 41ST STREET
60' PUBLIC R.O.W.

(Existing SP 369)

| BUILDING LEGEND | |
|-----------------|-----------------------------|
| 1 | ENGINE ROOM AND CABLES BLDG |
| 2 | ENGINE ROOM |
| 3 | ENGINE ROOM |
| 4 | ENGINE ROOM |
| 5 | ENGINE ROOM |
| 6 | ENGINE ROOM |
| 7 | ENGINE ROOM |
| 8 | ENGINE ROOM |
| 9 | ENGINE ROOM |
| 10 | ENGINE ROOM |
| 11 | ENGINE ROOM |
| 12 | ENGINE ROOM |
| 13 | ENGINE ROOM |
| 14 | ENGINE ROOM |
| 15 | ENGINE ROOM |
| 16 | ENGINE ROOM |
| 17 | ENGINE ROOM |
| 18 | ENGINE ROOM |
| 19 | ENGINE ROOM |
| 20 | ENGINE ROOM |
| 21 | ENGINE ROOM |
| 22 | ENGINE ROOM |
| 23 | ENGINE ROOM |
| 24 | ENGINE ROOM |
| 25 | ENGINE ROOM |
| 26 | ENGINE ROOM |
| 27 | ENGINE ROOM |
| 28 | ENGINE ROOM |
| 29 | ENGINE ROOM |
| 30 | ENGINE ROOM |
| 31 | ENGINE ROOM |
| 32 | ENGINE ROOM |
| 33 | ENGINE ROOM |
| 34 | ENGINE ROOM |
| 35 | ENGINE ROOM |
| 36 | ENGINE ROOM |
| 37 | ENGINE ROOM |
| 38 | ENGINE ROOM |
| 39 | ENGINE ROOM |
| 40 | ENGINE ROOM |
| 41 | ENGINE ROOM |
| 42 | ENGINE ROOM |
| 43 | ENGINE ROOM |
| 44 | ENGINE ROOM |
| 45 | ENGINE ROOM |
| 46 | ENGINE ROOM |
| 47 | ENGINE ROOM |
| 48 | ENGINE ROOM |
| 49 | ENGINE ROOM |
| 50 | ENGINE ROOM |
| 51 | ENGINE ROOM |
| 52 | ENGINE ROOM |
| 53 | ENGINE ROOM |
| 54 | ENGINE ROOM |
| 55 | ENGINE ROOM |
| 56 | ENGINE ROOM |
| 57 | ENGINE ROOM |
| 58 | ENGINE ROOM |
| 59 | ENGINE ROOM |
| 60 | ENGINE ROOM |
| 61 | ENGINE ROOM |
| 62 | ENGINE ROOM |
| 63 | ENGINE ROOM |
| 64 | ENGINE ROOM |
| 65 | ENGINE ROOM |
| 66 | ENGINE ROOM |
| 67 | ENGINE ROOM |
| 68 | ENGINE ROOM |
| 69 | ENGINE ROOM |
| 70 | ENGINE ROOM |
| 71 | ENGINE ROOM |
| 72 | ENGINE ROOM |
| 73 | ENGINE ROOM |
| 74 | ENGINE ROOM |
| 75 | ENGINE ROOM |
| 76 | ENGINE ROOM |
| 77 | ENGINE ROOM |
| 78 | ENGINE ROOM |
| 79 | ENGINE ROOM |
| 80 | ENGINE ROOM |
| 81 | ENGINE ROOM |
| 82 | ENGINE ROOM |
| 83 | ENGINE ROOM |
| 84 | ENGINE ROOM |
| 85 | ENGINE ROOM |
| 86 | ENGINE ROOM |
| 87 | ENGINE ROOM |
| 88 | ENGINE ROOM |
| 89 | ENGINE ROOM |
| 90 | ENGINE ROOM |
| 91 | ENGINE ROOM |
| 92 | ENGINE ROOM |
| 93 | ENGINE ROOM |
| 94 | ENGINE ROOM |
| 95 | ENGINE ROOM |
| 96 | ENGINE ROOM |
| 97 | ENGINE ROOM |
| 98 | ENGINE ROOM |
| 99 | ENGINE ROOM |
| 100 | ENGINE ROOM |

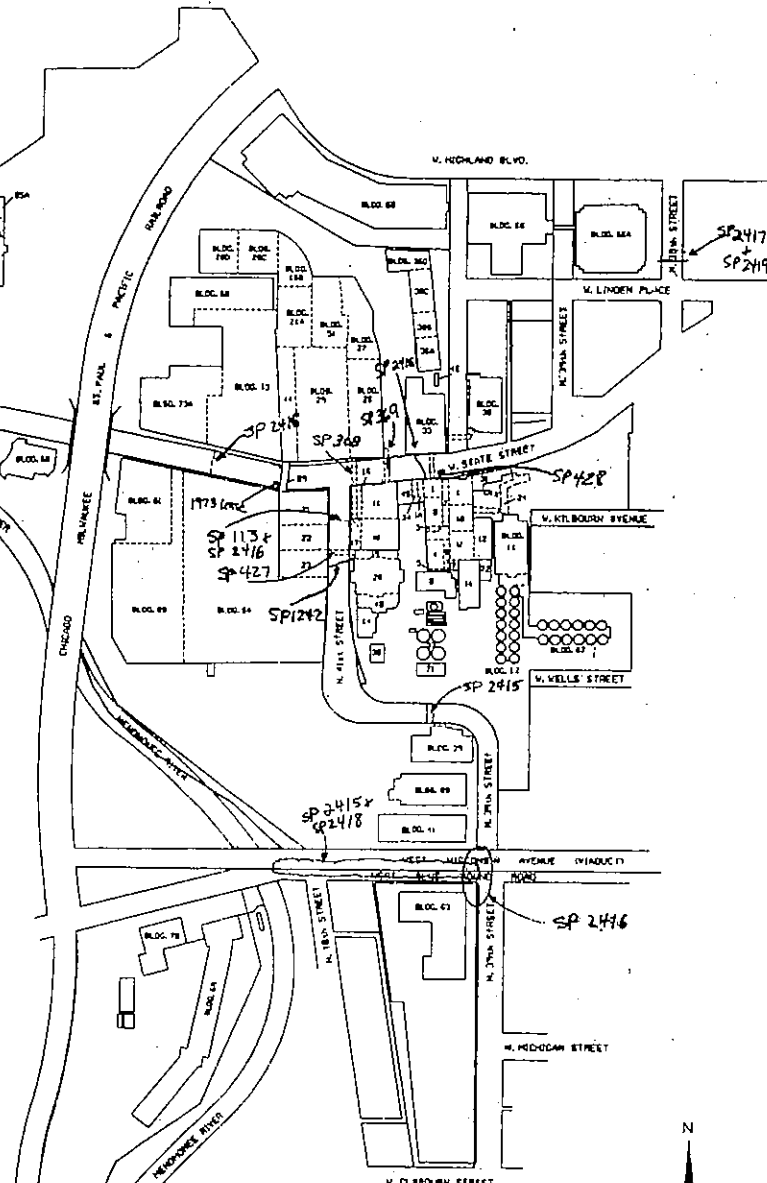

MILLER BREWING COMPANY
MILWAUKEE PLANT
FACILITY LAYOUT



SCALE
1" = 100' 200' 300'
APPROXIMATE 1"=150'

DATE: JUNE 28, 1968

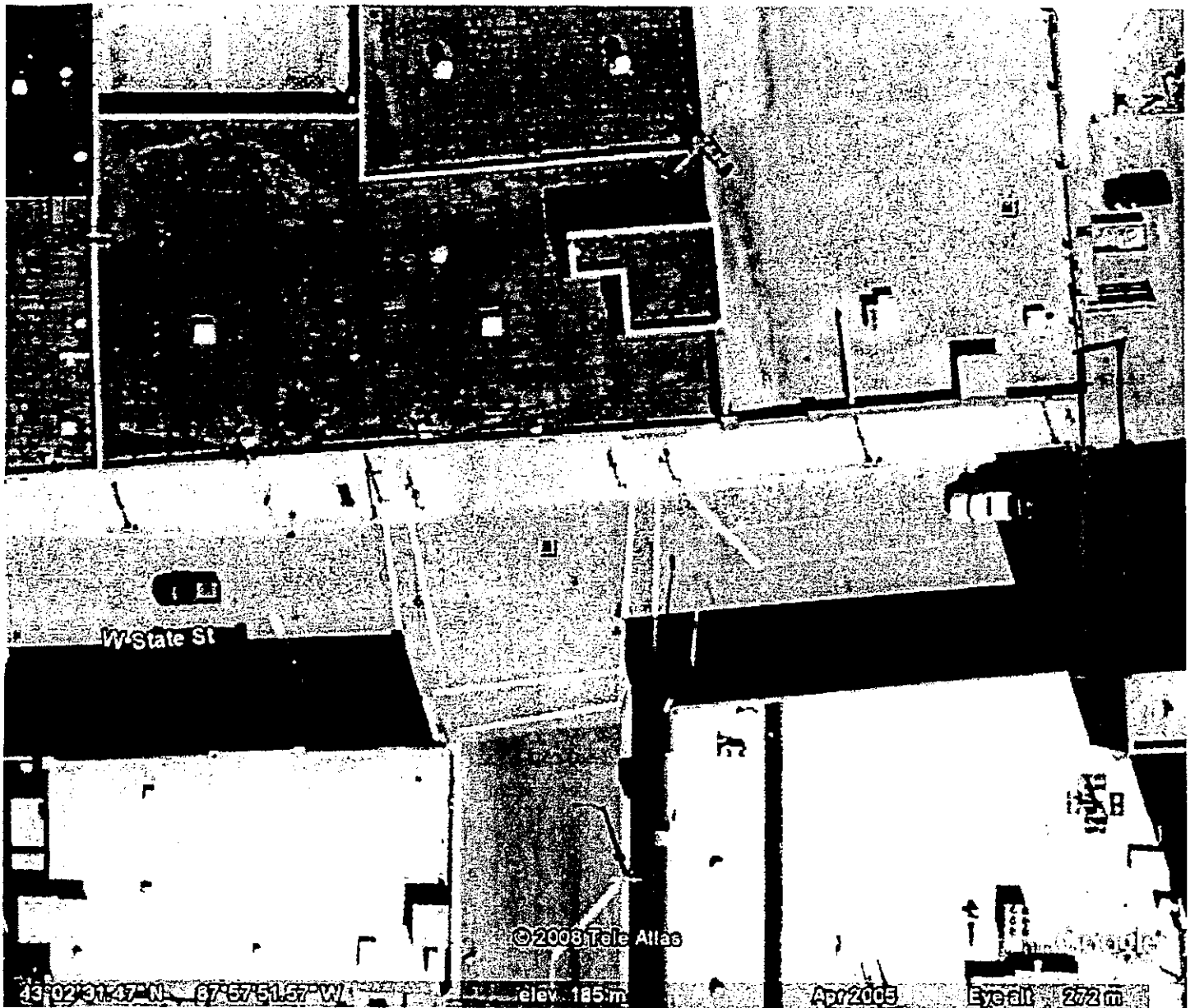

W State St

© 2008 Tele Atlas

43°02'31.47"N 67°57'51.57"W elev. 185 m Apr 2003 Eye alt. 272 m

SP 369

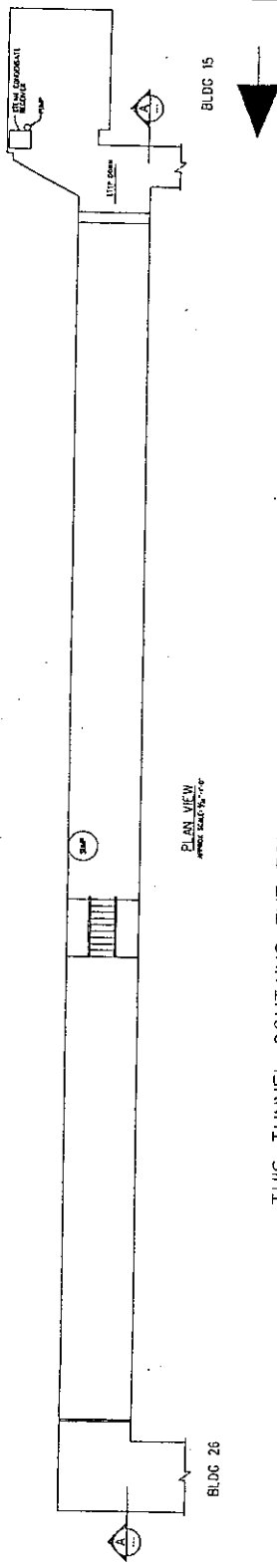

PLAN VIEW
SCALE 1/8" = 1'-0"

THIS TUNNEL CONTAINS THE FOLLOWING UTILITIES AND PROCESSES

- 2 1/2" STEAM CONDENSATE
- 4" LOOP 3 SUPPLY
- 4" LOOP 1 RETURN
- 4" LOOP 2 SUPPLY
- 1/2" ELECTRICAL CONDUIT
- 7/8" ELECTRICAL CONDUIT
- 6" LOOP 1 SUPPLY
- 7/8" ELECTRICAL CONDUIT
- 3" 4000V ELECTRICAL CONDUIT
- 1" ELECTRICAL CONDUIT
- 20" 12 LB STEAM
- 4" LOOP 9
- 1 1/2" DISCHARGE LINE FROM SLUMP

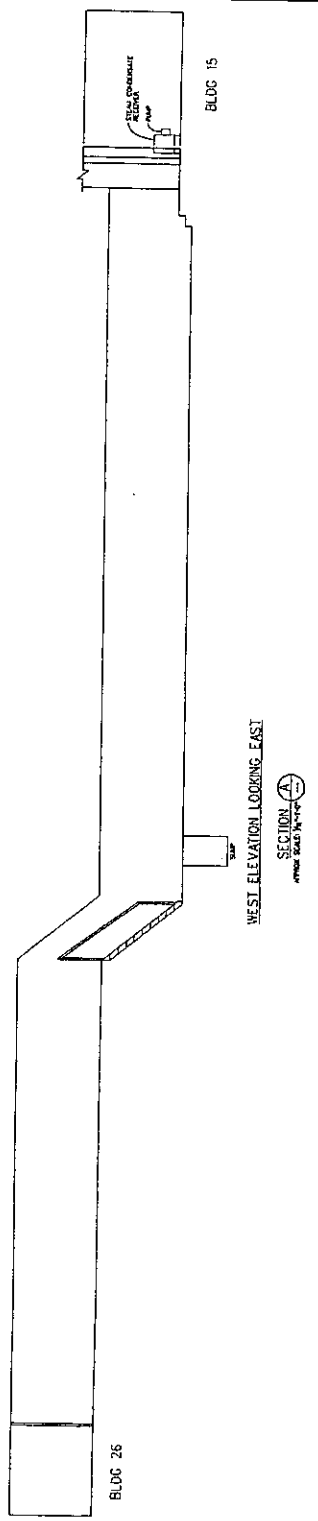

WEST ELEVATION, LOOKING EAST

SECTION
A-A

| | | | | | |
|--|----------|-----|------------|-----|------|
| DESIGNER | DATE | NO. | DATE | NO. | DATE |
| 15 | 10/15/04 | 1 | APRIL 2003 | 2 | 2003 |
| MILLER BREWING COMPANY MILWAUKEE PLANT TUNNEL CONNECTING BLDG 15 AND BLDG 26 | | | | | |
| TRADE ENGINEERING INCORPORATED | | | | | |
| 135 East Chicago Street Milwaukee, Wisconsin 53202 (414) 221-8840 FAX: 291-8841 | | | | | |

SP 369