



**CITY OF MILWAUKEE
OFFICE OF THE CITY CLERK**

Tuesday, June 17, 2025

COMMITTEE MEETING NOTICE

AD 03

GRIFFIN, Tyseria N, Agent
GIRL POWER LLC
1612 S 76TH ST #103
West Allis, WI 53214

You are requested to attend a hearing which is to be held in Room 301-B, Third Floor, City Hall or you may attend virtually using the link below.

Tuesday, July 01, 2025 at 01:00 PM

The access code is <https://meet.goto.com/731648413>. Please see the enclosed best practices document for further instructions.

Regarding: Your Class B Tavern and Extended Hours Establishments Licenses Application Requesting to Close at 4AM Fri-Sat as agent for "GIRL POWER LLC" for "THE SEAFOOD SHACK RESTAURANT" at  N FARWELL Av.

There is a possibility that your application may be denied for one or more of the following reasons: The recommendation of the committee regarding the application shall be based on evidence presented at the hearing. Per MCO 85-2.7-4, probative evidence concerning whether or not a new license should be granted may be presented on the following subjects: whether or not the applicant meets the municipal requirements, the appropriateness of the location and premises where the licensed premises is to be located and whether use of the premises for the purposes or activities permitted by the license would tend to facilitate a public or private nuisance or create undesirable neighborhood problems such as disorderly patrons, unreasonably loud noise, litter, and excessive traffic and parking congestion. Probative evidence relating to these matters may be taken from the plan of operation submitted with the license application, if any, but shall not include the content of any music. Evidence regarding the fitness of the location of the premises to be maintained as the principal place of business, including but not limited to whether there is an overconcentration of businesses of the type for which the license is sought; whether the proposal is consistent with any pertinent neighborhood business or development plans, or the location's proximity to areas where children are typically present. The applicant's record in operating similarly licensed premises; and whether or not the applicant has been charged with or convicted of any felony, misdemeanor, municipal offense or other offense, the circumstances of which substantially relate to the activity to be permitted by the license being applied for or any other factor which reasonably relates to the public health, safety or welfare may also be considered. See attached police report or correspondence.

**Notice for applicants with
warrants or unpaid fines:**

Proof of warrant satisfaction or payment of fines must be submitted at the hearing on the above date and time. Failure to comply with this requirement may result in a delay of the granting/denial of your application.

Failure to appear at this meeting may result in the denial of your license. Individual applicants must appear only in person or by an attorney. Corporate or Limited Liability applicants must appear only by the agent designated on the application or by an attorney. Partnership applicants must appear by a partner listed on the application or by an attorney. If you wish to do so and at your own expense, you may be accompanied by an attorney of your choosing to represent you at this hearing. You will be given an opportunity to speak on behalf of the application and to respond and challenge any charges or reasons given for the denial. No petitions can be accepted by the committee, unless the people who signed the petition are present at the committee hearing and willing to testify. You may present witnesses under oath and you may also confront and cross-examine opposing witnesses under oath. If you have difficulty with the English language, you should bring an interpreter with you, at your expense, so that you can answer questions and participate in your hearing.

You may examine the application file at this office during regular business hours prior to the hearing date. Inquiries regarding this matter may be directed to the person whose signature appears below.

Limited parking for persons attending meetings during normal business hours is available at reduced rates (5 hour limit) at the Milwaukee Center on the southwest corner of Kilbourn Avenue and Water Street. You must present a copy of the meeting notice to the parking cashier.

PLEASE NOTE: Upon reasonable notice, efforts will be made to accommodate the needs of disabled individuals through sign language interpreters or other auxiliary aids. For additional information or to request this service, contact the Council Services Division ADA Coordinator at (414) 286-2998, Fax - (414) 286-3456, TDD - (414) 286-2025.

JIM OWCZARSKI, CITY CLERK



BY: _____

**Jim Cooney
License Division Manager**

If you have questions regarding this notice, please contact the License Division at (414) 286-2238.

200 E. Wells Street, Room 105, City Hall, Milwaukee, WI 53202. www.milwaukee.gov/license
Phone: (414) 286-2238 Fax: (414) 286-3057 Email Address: License@milwaukee.gov

Date: 12/19/24 @
2:40PM
Officer: Felix, C

City of Milwaukee Police Department
90-5-1.5 Crime Prevention Survey
Tavern Inspection

Name of Premise: The Seafood Shack
Address: 2336 N Farwell Ave.
Phone: 414-3127-209

Owner: Griffin, Tyseria
Owner address: 1612 S. 76th ST.
City State Zip: West Allis, WI 53214
Owner Phone: 414-617-0007
Owner email: Tyseria099@gmail.com

Licensee/Agent:
Home Address:
City State Zip:
Phone:
Email:

Preferred contact: OWNER

Location currently open: ☒ YES ☐ NO

Projected open date:

Day's open: ☐S ☐M ☐T ☐W ☐Th ☐F ☐SA ☐ALL

Hours of Operation: Sun: 11A-10P ☐24 hours ☐Y ☐N
Mon: 11A-12A
Tue:
Wed:
Thu:
Fri: 11A-2:30A
Sat: 11A-2:30A

Premise Type: ☐ Tavern/Bar
☒ Restaurant
☐ Other:

Licenses currently held:

Alcohol: ☐ Yes ☐ No Class: #:
Tobacco: ☐ Yes ☐ No #:
Food: ☒ Yes ☐ No #:
Extended Hours: ☐ Yes ☐ No #:
Secondhand Dealer: ☐ Yes ☐ No Type: #:
Other: ☐ Yes ☐ No Type: #:
Other: ☐ Yes ☐ No Type: #:

Exterior Survey:

1. Is the area around the location clean? ☐ Yes ☐ No
2. What surrounds the location? (Check all the apply)
 - a. ☐ Park
 - b. ☐ School
 - c. ☐ Youth Center
 - d. ☐ Church
 - e. ☐ Tavern(s) If so, how many
 - f. ☒ Residential
 - g. ☒ Other businesses
 - h. ☒ Other: Medical
3. Can you see from the outside of the location into the interior ☒ Yes ☐ No
4. Can you see the employees inside of the location from the outside ☒ Yes ☐ No
5. Are exterior windows free of signage ☒ Yes ☐ No
6. Is there a parking lot ☒ Yes ☐ No
7. Is the parking lot clean? ☒ Yes ☐ No
8. Off-Street parking ☒ Yes ☐ No
9. Is the parking lot well lit? ☒ Yes ☐ No
10. Valet Parking ☐ Yes ☒ No
 - a. Will this lot have a guard? ☐ Yes ☒ No
 - b. Will this lot have cameras? ☐ Yes ☒ No
11. Are there areas where a person could conceal themselves ☒ Yes ☐ No
12. Is there exterior lighting? ☐ Yes ☐ No. Does it appears to be adequate ☒ Yes ☐ No
13. Exterior Payphone? ☐ Yes ☒ No
14. Are there No Loitering Signs posted? ☐ Yes ☒ No
15. Are there exterior security cameras ☐ Yes ☒ No How Many:
16. Are the address numbers prominently displayed and easy to see ☒ Yes ☐ No

Camera Survey:

17. Does this location have security cameras? ☒ Yes ☐ No
18. Are they in working order? ☒ Yes ☐ No
19. What format are the cameras?
 - a. Color ☒ Yes ☐ No
 - b. Digital ☒ Yes ☐ No
 - c. Recorded ☒ Yes ☐ No
20. How long is footage stored for later viewing: 30 DAYS
21. Are there exterior cameras ☐ Yes ☒ No How many: 0
22. Are there interior cameras ☒ Yes ☐ No How many: 2

23. Do all employees know how to retrieve recorded digital images/footage? ☐ Yes ☒ No
24. Cameras located in parking lot ☐ Yes ☒ No How many

Interior Survey:

25. What is the planned capacity 25
26. What is the minimum number of employees That will be on premise (2) 1 register and 1 cook
27. Is the storeowner willing to be a standing complainant regarding loitering? ☒ Yes ☐ No
a. If yes have them fill out the standing complaint form and give them two of the commercial signs ☐ Yes ☒ No
28. Is the interior of the location neat and clean? ☒ Yes ☐ No
29. Does an interior camera face the entrance/exit? ☒ Yes ☐ No
30. Is there a lockable area that separates employees from customers? ☐ Yes ☒ No
31. Are emergency and non-emergency numbers posted near the phone? ☐ Yes ☒ No
32. Does the owner know how to contact their police district directly? ☒ Yes ☐ No
a. Did you provide a district contact guide to the owner? ☐ Yes ☒ No

Security

33. How many security personnel are going to be employed: N/A
34. How ill they be deployed: Interior Exterior
35. What days will they be deployed ☐ Mon ☐ Tue ☐ Wed ☐ Thu ☐ Fri ☐ Sat ☐ Sun
36. Will the security be managed by business ☐ or contracted ☐
37. Will they be armed ☐ Yes ☐ No
38. What type of security measures to be used:
☐ Wanding/metal detector
☐ ID Scanner
☐ Dress Code
☐ Cover Charge
☐ Age restriction
☐ Other

ADDITIONAL COMMENTS/RECOMMENDATIONS:

Owner/ agent was on scene during the CPTED. The business is open and has been operating since September 2023. The agent plans on applying for an alcohol and extended hours license. Hookah service is offered at the business, which the agent stated is all nontobacco.

There is no safe in the business. The agent was advised adding a bolt in safe would provide additional security rather than leaving with cash in the later hours.

There is a plan to add an additional camera at the front exterior door. The agent was advised a second location for an exterior camera would be the rear door.

The non-emergency number was provided for the agent. They were advised to post both the nonemergency and emergency numbers near the business phone for employees.

End of report.



City of Concentration Map 2336 N Farwell Ave

Area of Interest (AOI) Information

Area : 21,862,585.81 ft²

Dec 10 2024 11:49:49 Central Standard Time

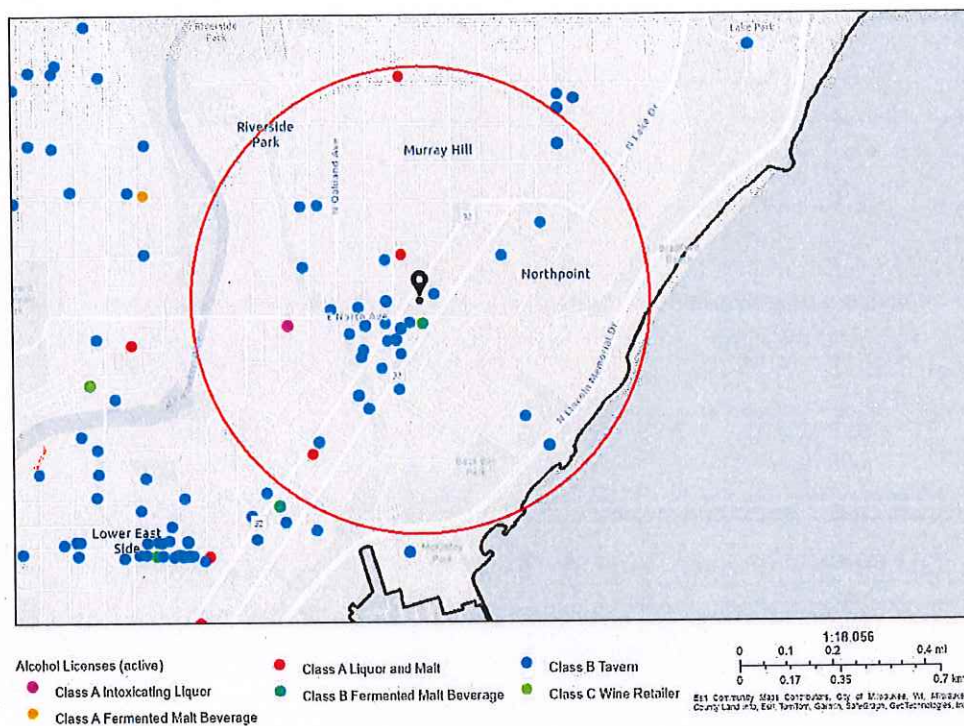

2336 N Farwell Ave

Summary

Name	Count	Area(ft²)	Length(mi)
Alcohol Licenses	53		

Alcohol Licenses

#	Legal Entity	Trade Name	Licensee	Address	License Type Name	Total Capacity	Expiration Date	Count
1	Crossroads Collective, LLC	Crossroads Collective	TIM B GOKHMAN, Agt	2238 N Farwell AV	Class B Tavern License	231	12/10/2024, 6:00 PM	1
2	VIER NORTH LLC	VIER NORTH	Melanie P Petersen, Agt	1832 E NORTH AV	Class B Tavern License		12/11/2024, 6:00 PM	1
3	Stone Bowl Grill, LLC	Stone Bowl	Young B Kim, Agt	1958-62 N Farwell AV	Class B Tavern License	99	12/15/2024, 6:00 PM	1
4	MAA VERA, INC.	Murray Pantry	Sandipkumar M Patel, Agt	2430 N MURRAY AV	Class A Malt & Class A Liquor License		1/16/2025, 6:00 PM	1
5	Mex Ave East LLC	Mex Avenue	Melissa G Escobar, Agt	2238 N FARWELL AV 6	Class B Tavern License		1/22/2025, 6:00 PM	1
6	Pomona Cider Company LLC	Pomona Cider Company	Thomas S Gabert, Agt	2163 N FARWELL AV	Class B Tavern License		2/5/2025, 6:00 PM	1
7	Izzy Hops LLC	Izzy Hops	MICHAEL J VITUCCI, Agt	2311 N Murray AV	Class B Tavern License		2/6/2025, 6:00 PM	1
8	HENRY'S TAVERN, LLC	HENRY'S TAVERN	NADER H PAKROO, Agt	2523 E BELLEVIEW PL	Class B Tavern License	50	2/9/2025, 6:00 PM	1
9	Strange Town, LLC	Strange Town	Mia L LeTendre, Agt	2101-2103 N Prospect AV	Class B Tavern License	49	2/13/2025, 6:00 PM	1
10	Charles Allis and Villa Terrace Museums, Inc.	Villa Terrace Decorative Arts Museum	Jaymee Harvey Willms, Agt	2220 N TERRACE AV	Class B Tavern License	85	2/21/2025, 6:00 PM	1
11	Erth Wellness, LLC	Kind Oasis	Salem J Kashou, Agt	2169 N FARWELL AV	Class B Tavern License		2/25/2025, 6:00 PM	1
12	Woori Wells Corp	Maru	Jongsoo Kim, Agt	2150 N Prospect AV	Class B Tavern License		2/25/2025, 6:00 PM	1
13	Krikar LLC	Koppa's Fulbeli Deli	Karthik B Pothumachi, Agt	1940 N FARWELL AV	Class A Malt & Class A Liquor License		2/26/2025, 6:00 PM	1
14	Ian's Pizza Milwaukee, LLC	Ian's Pizza Milwaukee	Ryan W Donovan, Agt	2035 E NORTH AV	Class C Wine Retailer's License		3/1/2025, 6:00 PM	1
15	PADDY'S PET & PUB, LLC	PADDY'S PET & PUB	ORLEN G WOOD, Agt	2339-A N MURRAY AV	Class B Tavern License	179	3/1/2025, 6:00 PM	1
16	Ian's Pizza Milwaukee, LLC	Ian's Pizza Milwaukee	Ryan W Donovan, Agt	2035 E NORTH AV	Class B Fermented Malt Beverage Retailer's License		3/1/2025, 6:00 PM	1
17	WI LJ INC	Back Street	Ying Li, Agt	2116 N FARWELL AV	Class B Fermented Malt Beverage Retailer's License		3/18/2025, 7:00 PM	1

18	SPTresto, LLC	Rice N Roll Bistro	Bundid Muangsiri, Agt	1952 N Farwell AV	Class B Fermented Malt Beverage Retailer's License		3/29/2025, 7:00 PM	1
19	SPTresto, LLC	Rice N Roll Bistro	Bundid Muangsiri, Agt	1952 N Farwell AV	Class C Wine Retailer's License		3/29/2025, 7:00 PM	1
20	Saz's Catering Inc	Jan Serr Studio	Stephanie L Sazama-Schneck, Agt	2155 N Prospect AV	Class B Tavern License		4/4/2025, 7:00 PM	1
21	INCONTRO GROUP LLC	L'INCONTRO	Paul J Plotrowski, Agt	2315 N MURRAY AV	Class B Tavern License		4/7/2025, 7:00 PM	1
22	Premier Closers LLC	Upper East Bar	Stephanie R Townsend, Agt	1732 E NORTH AV	Class B Tavern License		4/7/2025, 7:00 PM	1
23	EASTCASTLE PLACE, INC	Eastcastle Place	Majarka M B Ford-Ziegelbauer, Agt	2505 E BRADFORD AV	Class B Tavern License		4/7/2025, 7:00 PM	1
24	PROSPECTOR PARTNERSHIP LLC	VINTAGE	REBECCA E GODFREY, Agt	2203 N PROSPECT AV	Class B Tavern License	151	4/10/2025, 7:00 PM	1
25	IFM Farwell LLC	Downer Theatre	Kristen C Heller, Agt	2589 N DOWNER AV	Class B Tavern License		4/10/2025, 7:00 PM	1
26	LANDMARK BARS, INC	LANDMARK LANES	SLAVA TUZHILKOV, Agt	2220 N FARWELL AV	Class B Tavern License	240	4/11/2025, 7:00 PM	1
27	GPJ OF MILWAUKEE, INC	MA FISCHER'S	HEIDI A PANAGIOTOPoulos, Agt	2214 N FARWELL AV	Class B Tavern License	240	4/11/2025, 7:00 PM	1
28	FRANKIES RESTAURANT AND CATERING, LLC	Frankies Restaurant and Catering	Donna D Afrifa, Agt	1815 E KENILWORTH PL	Class B Tavern License		5/10/2025, 7:00 PM	1
29	Nine Below Inc	Nine Below	Marla R Poytinger, Agt	1905 E North AV	Class B Tavern License	270	5/30/2025, 7:00 PM	1
30	Axe MKE, Inc	Axe MKE	Marla R Poytinger, Agt	1924 E KENILWORTH PL	Class B Tavern License		5/30/2025, 7:00 PM	1
31	BENJAMIN'S FINE WINE & SPIRITS LLC	Waterford Wine Company	BENJAMIN T CHRISTIANS EN, Agt	2120 N FARWELL AV	Class B Tavern License		5/30/2025, 7:00 PM	1
32	WHOLE FOODS MARKET GROUP, INC	WHOLE FOODS MARKET	Brooke M Remitz, Agt	2305 N PROSPECT AV	Class B Tavern License		6/13/2025, 7:00 PM	1
33	Black Gate LLC	Von Trier	MARK A ZIERATH, Agt	2235 N Farwell AV	Class B Tavern License	153	6/13/2025, 7:00 PM	1
34	Dairyland Retail Group LLC	7-Eleven #35852B	Daniel J Stachnik, Agt	1609 E NORTH AV	Class A Fermented Malt Beverage Retailer's License		6/14/2025, 7:00 PM	1

35	Dairyland Retail Group LLC	7-Eleven #35852B	Daniel J Stachnik, Agt	1609 E NORTH AV	Class A Retailer's Intoxicating Liquor License		6/14/2025, 7:00 PM	1
36	CHAMPION'S PUB, LLC	CHAMPION'S PUB	ROBERT R GREENYA, Agt	2417 N BARTLETT AV	Class B Tavern License	148	6/28/2025, 7:00 PM	1
37	HOOLIGAN'S SUPER IRISH DELI & BAR, INC	HOOLIGAN'S	MARK B BUESING, Agt	2017 E NORTH AV	Class B Tavern License	118	6/29/2025, 7:00 PM	1
38	Dock Bradford, LLC	The Dock at Bradford Beach	BRIAN C RANDALL, Agt	2400 N Lincoln Memorial DR	Class B Tavern License		7/29/2025, 7:00 PM	1
39	WV, LLC	TESS	MITCHELL D WAKEFIELD, Agt	2499 N BARTLETT AV	Class B Tavern License	60	7/30/2025, 7:00 PM	1
40	MOOSA BURGER, INC.	Moosa's	ALAA I MUSA, Agt	2272 N LINCOLN MEMORIAL DR	Class B Tavern License		8/4/2025, 7:00 PM	1
41	El Grupo J & K, LLC	Judy's Cantina	Kevin I Lopez, Agt	2124 N FARWELL AV	Class B Tavern License		8/13/2025, 7:00 PM	1
42	H & H ASSAD, LLC	PARKSIDE LIQUOR & GROCERY	HANA O UPRIGHT, Agt	2700 N MURRAY AV	Class A Malt & Class A Liquor License		8/16/2025, 7:00 PM	1
43	IFM Farwell LLC	Oriental Theatre	Kristen C Heller, Agt	2230 N FARWELL AV	Class B Tavern License	1,834	8/19/2025, 7:00 PM	1
44	BEANS & BARLEY, INC	BEANS & BARLEY	JAMES C NEUMEYER, Agt	1901 E NORTH AV	Class B Tavern License	180	8/30/2025, 7:00 PM	1
45	The Original MKE, LLC	The Original	Eric E Rzepka, Agt	2498 N Bartlett AV	Class B Tavern License	99	9/3/2025, 7:00 PM	1
46	Kawa Ramen & Sushi Inc	Kawa	LinJin Xiao, Agt	2321-23 N Murray AV	Class B Tavern License		9/12/2025, 7:00 PM	1
47	Milwaukee Catholic Home Inc	Milwaukee Catholic Home	Christopher A Reinheimer, Agt	2462 N PROSPECT AV	Class B Tavern License		9/18/2025, 7:00 PM	1
48	2597 LLC	Pizza Man Milwaukee	Michael B Behrens, Agt	2597 N Downer AV	Class B Tavern License		9/21/2025, 7:00 PM	1
49	7-ELEVEN, INC	7-ELEVEN # 35852J	Angela Schultz, Agt	1609 E NORTH AV	Class A Fermented Malt Beverage Retailer's License		10/23/2025, 7:00 PM	1
50	7-ELEVEN, INC	7-ELEVEN # 35852J	Angela Schultz, Agt	1609 E NORTH AV	Class A Retailer's Intoxicating Liquor License		10/23/2025, 7:00 PM	1
51	Crossroads Collective, LLC	Crossroads Collective	TIM B GOKHMAN, Agt	2238 N Farwell AV	Class B Tavern License	231	12/10/2025, 6:00 PM	1
52	The Jazz Estate Inc	The Jazz Estate	JOHN M DYE, Agt	2423 N MURRAY AV	Class B Tavern License	62	12/14/2025, 6:00 PM	1

53	Stone Bowl Grill, LLC	Stone Bowl	Young B Kim, Agt	1958-62 N Farwell AV	Class B Tavern License	99	12/15/2025, 6:00 PM	1
----	-----------------------	------------	------------------	----------------------	------------------------	----	---------------------	---

Establishments within a 0.5 miles radius centered on area of interest.



Tuesday, June 17, 2025



Notice of Public Hearing

Blank Notice

GRIFFIN, Tyseria N, Agent

The Seafood Shack Restaurant at 2336 N Farwell Av

Class B Tavern and Extended Hours Establishments Licenses Application Requesting to Close at
4AM Fri-Sat

Tuesday, July 01, 2025 at 1:00 PM

To whom it may concern:

The above application has been made by the above named applicant(s). This requires approval from the Licenses Committee and the Common Council of the City of Milwaukee. The hearing before the Licenses Committee will take place on 7/1/2025 at 1:00 PM in Room 301-B, Third Floor, City Hall. This is a public hearing. Those wishing to view the proceeding are able to do so via the City Channel – Channel 25 on Spectrum Cable – or on the Internet at <http://city.milwaukee.gov/citychannel>. Those wishing to provide oral testimony via internet are asked to contact the staff assistant, Yadira Melendez at (414) 286-2775 or stasst5@milwaukee.gov for necessary information. Please make such requests no later than one business day prior to the start of the meeting. You are not required to attend the hearing, but please see the information below if you would like to provide testimony. Once the Licenses Committee makes its recommendation, this recommendation is forwarded to the full Common Council for approval at its next regularly scheduled hearing.

Important details for those wishing to provide information for the Licenses Committee to consider when making its recommendation:

1. The license application is scheduled to be heard at the above time. Due to other hearings running longer than scheduled, you may have to wait some time to provide your testimony.
2. You must appear in person and testify as to matters that you have personally experienced or seen. (You cannot provide testimony for your neighbor, parent or anyone else; this is considered hearsay and cannot be considered by the committee.)
3. No letters or petitions can be accepted by the committee (unless the person who wrote the letter or the persons who signed the petition are present at the committee hearing and willing to testify).
4. Persons opposed to the license application are given the opportunity to testify first; supporters may testify after the opponents have finished.
5. When you are called to testify, you will be sworn in and asked to give your name, and address. (If your first and/or last names are uncommon please spell them.)
6. You may then provide testimony.
 - a. Include only information relating to the above license application.
 - b. Include only information you have personally witnessed or seen.
 - c. Provide concise and relevant information detailing how this business has affected or may affect the peaceful enjoyment of your neighborhood.
 - d. If by the time you have the opportunity to testify, the information you wish to share has already been provided to the committee, you may state that you agree with the previous testimony. Redundant or repetitive testimony will not assist the committee in making its recommendation.
7. After giving your testimony, the members of the Licenses Committee and the licensee may ask questions regarding the testimony you have given or other factors relating to the license application.
8. Business Competition is not a valid basis for denial or non-renewal of a license.

Please Note: If you have submitted an objection to the above application your objection cannot be considered by the committee unless you personally testify at the hearing.

OCCUPANT	MAIL ADDRESS	CITY STATE ZIP
CURRENT OCCUPANT	2006 E THOMAS AVE# A	MILWAUKEE, WI 53211-4405
CURRENT OCCUPANT	2006 E THOMAS AVE# B	MILWAUKEE, WI 53211-4405
CURRENT OCCUPANT	2009 E IVANHOE PL# 201	MILWAUKEE, WI 53202-1118
CURRENT OCCUPANT	2009 E IVANHOE PL# 202	MILWAUKEE, WI 53202-1118
CURRENT OCCUPANT	2009 E IVANHOE PL# 203	MILWAUKEE, WI 53202-1118
CURRENT OCCUPANT	2009 E IVANHOE PL# 204	MILWAUKEE, WI 53202-1118
CURRENT OCCUPANT	2009 E IVANHOE PL# 205	MILWAUKEE, WI 53202-1118
CURRENT OCCUPANT	2009 E IVANHOE PL# 206	MILWAUKEE, WI 53202-1118
CURRENT OCCUPANT	2009 E IVANHOE PL# 207	MILWAUKEE, WI 53202-1118
CURRENT OCCUPANT	2009 E IVANHOE PL# 208	MILWAUKEE, WI 53202-1118
CURRENT OCCUPANT	2009 E IVANHOE PL# 209	MILWAUKEE, WI 53202-1118
CURRENT OCCUPANT	2009 E IVANHOE PL# 210	MILWAUKEE, WI 53202-1118
CURRENT OCCUPANT	2009 E IVANHOE PL# 211	MILWAUKEE, WI 53202-1118
CURRENT OCCUPANT	2009 E IVANHOE PL# 212	MILWAUKEE, WI 53202-1118
CURRENT OCCUPANT	2009 E IVANHOE PL# 214	MILWAUKEE, WI 53202-1118
CURRENT OCCUPANT	2009 E IVANHOE PL# 215	MILWAUKEE, WI 53202-1118
CURRENT OCCUPANT	2009 E IVANHOE PL# 301	MILWAUKEE, WI 53202-1118
CURRENT OCCUPANT	2009 E IVANHOE PL# 302	MILWAUKEE, WI 53202-1118
CURRENT OCCUPANT	2009 E IVANHOE PL# 303	MILWAUKEE, WI 53202-1118
CURRENT OCCUPANT	2009 E IVANHOE PL# 304	MILWAUKEE, WI 53202-1118
CURRENT OCCUPANT	2009 E IVANHOE PL# 305	MILWAUKEE, WI 53202-1118
CURRENT OCCUPANT	2009 E IVANHOE PL# 306	MILWAUKEE, WI 53202-1118
CURRENT OCCUPANT	2009 E IVANHOE PL# 307	MILWAUKEE, WI 53202-1118
CURRENT OCCUPANT	2009 E IVANHOE PL# 308	MILWAUKEE, WI 53202-1118
CURRENT OCCUPANT	2009 E IVANHOE PL# 309	MILWAUKEE, WI 53202-1118
CURRENT OCCUPANT	2009 E IVANHOE PL# 310	MILWAUKEE, WI 53202-1118
CURRENT OCCUPANT	2009 E IVANHOE PL# 311	MILWAUKEE, WI 53202-1118
CURRENT OCCUPANT	2009 E IVANHOE PL# 312	MILWAUKEE, WI 53202-1118
CURRENT OCCUPANT	2009 E IVANHOE PL# 314	MILWAUKEE, WI 53202-1118
CURRENT OCCUPANT	2009 E IVANHOE PL# 315	MILWAUKEE, WI 53202-1118
CURRENT OCCUPANT	2325 N MURRAY AVE	MILWAUKEE, WI 53211-4404
CURRENT OCCUPANT	2329 N MURRAY AVE	MILWAUKEE, WI 53211-4404
CURRENT OCCUPANT	2353 N FARWELL AVE# 301	MILWAUKEE, WI 53211-4470
CURRENT OCCUPANT	2353 N FARWELL AVE# 302	MILWAUKEE, WI 53211-4470
CURRENT OCCUPANT	2353 N FARWELL AVE# 303	MILWAUKEE, WI 53211-4470
CURRENT OCCUPANT	2353 N FARWELL AVE# 304	MILWAUKEE, WI 53211-4470
CURRENT OCCUPANT	2353 N FARWELL AVE# 305	MILWAUKEE, WI 53211-4470
CURRENT OCCUPANT	2353 N FARWELL AVE# 306	MILWAUKEE, WI 53211-4470
CURRENT OCCUPANT	2353 N FARWELL AVE# 307	MILWAUKEE, WI 53211-4470
CURRENT OCCUPANT	2353 N FARWELL AVE# 308	MILWAUKEE, WI 53211-4470
CURRENT OCCUPANT	2353 N FARWELL AVE# 309	MILWAUKEE, WI 53211-4470
CURRENT OCCUPANT	2353 N FARWELL AVE# 310	MILWAUKEE, WI 53211-4470
CURRENT OCCUPANT	2353 N FARWELL AVE# 311	MILWAUKEE, WI 53211-4470
CURRENT OCCUPANT	2353 N FARWELL AVE# 312	MILWAUKEE, WI 53211-4470
CURRENT OCCUPANT	2353 N FARWELL AVE# 313	MILWAUKEE, WI 53211-4470
CURRENT OCCUPANT	2353 N FARWELL AVE# 314	MILWAUKEE, WI 53211-4470

[illegible]

CURRENT OCCUPANT	2409 N FREDERICK AVE	MILWAUKEE, WI 53211-4418
CURRENT OCCUPANT	2413 N FREDERICK AVE	MILWAUKEE, WI 53211-4418
CURRENT OCCUPANT	2415 N FREDERICK AVE	MILWAUKEE, WI 53211-4418

Blank Notice

Total Records: 96

Radius 250 feet and Center of the Circle: 2336 N Farwell Av



BUSINESS LICENSE PLAN OF OPERATION

ccl-busplan 5/12/2020

Office of the City Clerk License Division

200 E. Wells St. Room 105, Milwaukee, WI 53202

(414) 286-2238 www.milwaukee.gov/license e-mail address: license@milwaukee.gov

1. Type of Business

Applying for: ☒ Extended Hours (12AM to 5AM) - If a food establishment, check all that apply: ☐ Delivery ☐ Drive Thru ☒ Dining Room
☐ Self Service Laundry ☐ Massage Establishment ☐ Filling Station
☐ Other (supplemental application for specific license also required)

Provide a detailed description of the type of business you plan on operating: A restaurant you can come to and order food for take out or sit and eat

Do you have any experience operating this type of business? ☐ No ☒ Yes If yes, explain: Seafood shack restaurant

2. Business Operations and bar in south milw. I own that location

- a. Proposed Opening Date: Already open
- b. Is this premise under construction? ☒ No ☐ Yes If yes, list estimated completion date: _____
- c. Is this a franchise? ☒ No ☐ Yes
- d. Is this premises currently licensed? ☐ No ☒ Yes If yes, list type of license: restaurant / food
- e. Is the current licensee operating? ☐ No ☒ Yes If no, list date closed: _____
- f. Do you have future plans for other businesses, licenses or permits at this location? ☐ No ☒ Yes
If yes, explain: liquor license
- g. Have you previously held an Extended Hours License in Milwaukee? ☐ No ☒ Yes
If yes, list address(es): 2336 N Farwell
- h. Are other businesses operating in the same building? ☒ No ☐ Yes If yes, describe: _____

3. Litter & Noise

- a. How are grounds kept clean? ☒ Sweep ☐ Pressure Wash ☒ Pick Up Litter ☐ Other: _____
- b. How often will grounds be cleaned? ☒ Daily ☐ Weekly ☐ As Needed ☐ Monthly ☒ Other: Management
- c. Grounds cleaned by: ☐ Licensee ☐ Building Owner ☐ Employees ☒ Hired Maintenance ☒ Other: Management
- d. How are noise issues prevented and/or addressed? ☐ Security ☒ Manager approaches customer(s) ☐ Call Police
☒ Signs Posted ☐ Other: _____
- e. Will a sound amplification system be used? ☒ No ☐ Yes If yes, describe: _____

4. Smoking & Sanitation

- a. Are there designated outdoor smoking areas? ☒ No ☐ Yes If yes, describe: _____
- b. Number of Garbage Cans: Inside: 5 Locations: 2-womens, 1-mens - 2 kitchen
Outside: 1 Locations: Back of building
- c. Is a crowd control barrier used? ☒ No ☐ Yes If yes, describe: 2
- d. How many restrooms are on the premises? 2
- e. Name of solid waste contractor: ☐ Advanced Disposal ☐ Waste Management ☒ Other: Eagle

5. Security

- a. Are there onsite parking spaces? ☐ No ☒ Yes If yes, how many? 30 and describe the parking security plan: Shared lot w/ other businesses, lighting
- b. Is there a loading zone? ☒ No ☐ Yes If yes, describe the loading area security plan: _____
- c. Will you have licensed security on premise? ☒ No ☐ Yes If yes, how many? _____ and answer the following:
What are their responsibilities? _____
Describe equipment used _____
List their License Number (s) _____
- d. Will there be security cameras? ☐ No ☒ Yes If yes, how many? 2 and list locations: Front counter
inside front door
- e. Will searches/identification checks be done upon entry? ☐ No ☒ Yes If yes, describe ID check when
purchasing alcohol

6. Percentage of Sales (must total 100%)

Alcohol <u>30</u> %	Food <u>70</u> % Cigarettes, Electronic Vape Devices, Tobacco Products _____ %	Secondhand Merchandise _____ %	Precious Metals & Gems _____ %
Entertainment _____ %	Pawnbroker Activity _____ %	Salvaged Materials _____ % (such as scrap metal)	Personal Services (such as tattoo, body piercing, salon, tailor, tanning, etc.) _____ %
		Other _____ % Describe: _____	

7. Businesses/Licenses on the Premises (check all that apply):

Type 1

- ☒ Full Service Restaurant ☐ Cafe/Coffee Shop ☐ Deli or Fast Food Restaurant ☐ Private/Fraternal/Veterans Club
- ☐ Night Club ☐ Tavern ☒ Cocktail Lounge ☐ Teen Club
- ☐ Banquet Hall ☐ Sports Facility ☐ Bowling Alley
- ☐ Hotel/Motel: Number of Floors: _____ Number of Rooms: _____
Rooming House: Number of Floors: _____ Number of Rooms: _____

Type 2

- ☐ Liquor Store ☐ Corner Store ☐ Supermarket ☐ Convenience Store
- ☐ Gas Station ☐ Amusement/Phonograph Distributor ☐ Recycling, Salvage or Towing
- ☐ Used Car Dealer ☐ Personal Service Establishment
(such as tattoo business, hair salon, tailor, etc.) ☐ Recording Studio

What other licenses/permits will you hold at this location? (check all that apply)

- ☒ Occupancy Permit ☐ Cigarette, Tobacco, Electronic Vape Products ☐ Gas Station ☐ Extended Hours ☒ Class "B" Tavern ☐ Weights & Measures
- ☐ Secondhand Dealer ☐ Precious Metal & Gem ☐ Other: _____

8. Legal Capacity (only if a Type 1 premises in #7 above)

Capacity 25 (Call the Milwaukee Development Center at 414-286-8211 if you have questions.)

9. Premises Description

a. Identify all area(s) of the premises that will be used in operating this business (include areas used only for storage):

☒ 1st Floor ☐ 2nd Floor ☐ Basement Storage ☐ Patio ☐ Beer Garden ☐ Sidewalk Café ☐ Deck ☐ Rooftop

☐ Other: Describe: _____

b. Describe Location: ☐ Major Thoroughfare ☐ Secondary Street ☒ Other: Plaza

c. Nearest Major Cross Street: Farwell & North ave

d. Describe Building: ☐ Free Standing Building ☒ Strip Mall ☐ Other: _____

e. Describe Premises Structure: ☐ Single Story ☐ Multi-Story - # of Stories _____ ☐ Other: _____

f. Describe Surrounding Area: ☒ Commercial ☐ Residential ☐ Industrial ☐ Other: _____

g. Building Owner Name: MDH223WI, LLC Phone Number: 414 921 8299

Building Owner Address: PO BOX 103 Brookfield WI 53008

10. Hours of Operation & Customers

Will customers be entering the premises? ☐ No ☒ Yes

* Food Hours

Sunday to Thursday 11am - 12am

Friday and Saturday 11am - 4am

Day of the Week	Proposed Hours of Operation:		Estimated Number of Customers expected each day	Potential Age Range of Customers	Class B Tavern Applicant Only: Age Restriction (If none, write 'None')
	Open Time (include a.m. or p.m.)	Close Time (include a.m. or p.m.)			
Sunday	11 am	12 AM	30	NA	
Monday	11 am	12 am	30		
Tuesday	11 am	12 am	40		
Wednesday	11 am	12 am	45		
Thursday	11 am	12 am	55		✓
Friday	11 am	2:30 am	80		
Saturday	11 am	2:30 AM	80		

* Alcohol Hours

An Extended Hours Establishment License is required for any convenience store, filling station, personal service establishment (such as tattoo, body piercing, salon, tailor, tanning, etc.), recording studio or restaurant which is open between the hours of 12:00 a.m. and 5:00 a.m.

Alcohol Establishments Class A: 8:00 am to 9:00 pm Sunday thru Saturday
Permitted Hours of Operation: Class B: 6:00 am to 2:00 am Sunday thru Thursday, 6:00 am to 2:30 am Friday & Saturday

Entertainment Outdoor Closing Hours: 10:00pm Sunday-Thursday; 12:00am Friday & Saturday; unless a different time, either earlier or later, is established by the Common Council in its approval of the licensee's plan of operation.

11. Signature(s)

[Signature]

Signature of Sole Proprietor, Partner, or 20% or more Shareholder
(If there are no 20% or more shareholders,
Corporate Officer-print name/title and sign)

Signature of additional partner or 20% or more shareholder

See Application Information for a complete list of all required application forms.



ALCOHOL BEVERAGE & PUBLIC ENTERTAINMENT PREMISES SUPPLEMENTAL APPLICATION

Office of the City Clerk License Division
200 E. Wells St. Room 105, Milwaukee, WI 53202
(414) 286-2238 e-mail address: license@milwaukee.gov www.milwaukee.gov/license

Legal Entity Name: Girl Power LLC
Premise Address: 2336 N. Farwell

Proximity of Premises to Church, School, Daycare Center or Hospital

Is the building within 300 feet of any church, school, daycare center or hospital? ☒ No ☐ Yes

"Service Bar Only" Designation

If applying for Class B or C license, are you applying for "Service Bar Only"? ☐ No ☒ Yes
Service Bar Only means customers cannot sit at the bar. Alcohol is served to employees who serve patrons seated at tables.
No stools, chairs or other articles of furniture shall be placed at the service bar for patrons to sit upon.

Business Information

- a) Are you taking out this application for anyone that may not be eligible for a license? ☒ No ☐ Yes
If yes, list their name and address: _____
- b) Will the agent, a partner or the individual licensee be conducting the day-to-day operations of the business? ☐ No ☒ Yes
If no, list the name and address of the person(s) who will: _____
- Class B Applicants: If the agent, a partner or the individual licensee will not be conducting the day-to-day operations of the business, the person(s) listed above must obtain a Class B Managers license.
- c) Does anyone else have money invested or any other interest in this business? ☒ No ☐ Yes
If yes, explain: _____
- d) Have you made an agreement with anyone to repay any loan or any other payments based upon income from the business?
☒ No ☐ Yes If yes, list name and address: _____

Property Information (New & Transfer Applicants Only)

- a) Do you own or lease the building? ☐ Own ☒ Lease
- b) Who owns the fixtures (for example, coolers, etc.)? _____
- c) Are you purchasing the stock and/or fixtures? ☒ No ☐ Yes If yes, amount paid \$ _____
- d) Total amount paid for business \$ N/A
- e) Total amount paid for goodwill of the business \$ N/A
- Goodwill comprises the reputation and customer relationships of an existing business. If the price you pay for the business exceeds the fair market value of all of the rest of the assets of the business, the excess may be considered goodwill.
- f) Have you made arrangements with the seller for payment of personal property taxes? ☐ No ☐ Yes

Lease Information (New & Transfer Applicants who are leasing the premises only)

- a) Date lease begins JULY 24 Ends JULY 29
- b) Monthly rental \$ 2900
- c) Do you have an option to renew the lease? ☐ No ☒ Yes
- d) Does your lease allow for assignment to another party without the consent of the owner? ☒ No ☐ Yes
- e) For what length of time have you been guaranteed occupancy (number of years)? 5

Lease Information (Continued)

- f) In addition to paying the monthly rental, will you have to pay anything additional to the owner of the building to guarantee performance of the lease? ☒ No ☐ Yes If yes, explain _____
- g) Does the present owner or occupant object to the granting of your license? ☒ No ☐ Yes
If yes, explain _____

Change of Agent Applicants Only

Have there been any changes to the floor plan since the last application was submitted? ☒ No ☐ Yes
If no, a new floor plan is not required. If yes, submit a new floor plan and explain the change(s):

Signature



Signature of Sole Proprietor, Partner or 20% or More Shareholder
(If no 20% or more Shareholder, Corporate Officer - print name/title and sign)

Note: All information contained in this application is subject to approval by the Common Council.
Deviating from approved plan of operation will subject licensee to citations, and/or suspension or non-renewal of the license.
Contact the License Division for information on how to request changes.

New and transfer of premises applicants must submit the following:

- ☐ Detailed floor plan
☐ If a restaurant, copy of the menu

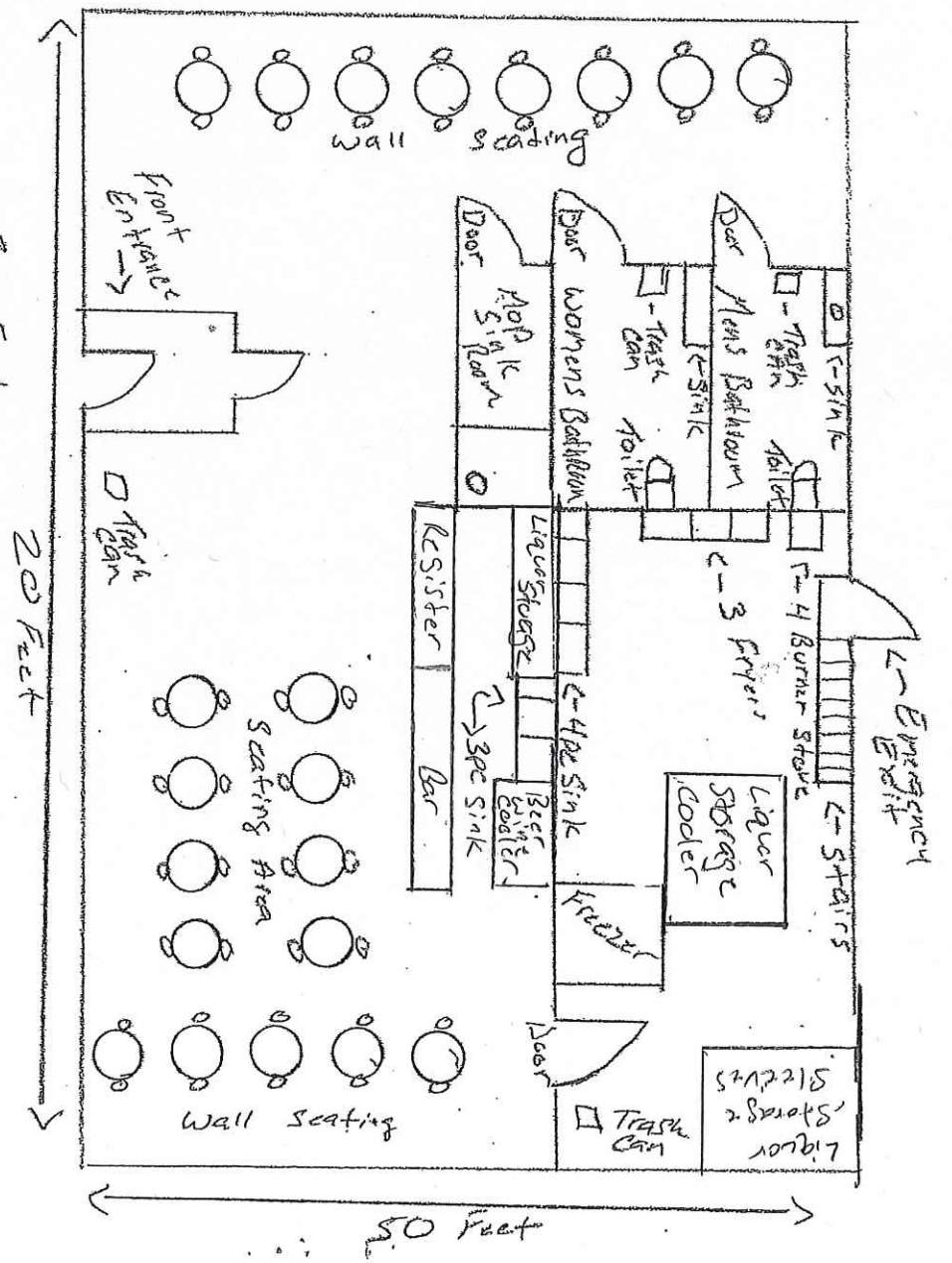
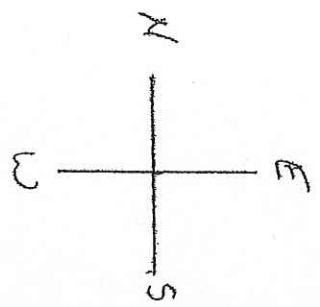
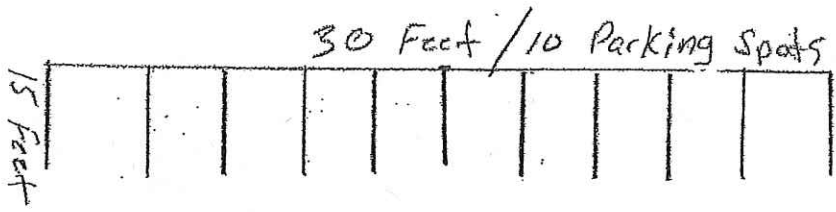

The Seafood Shack Restaurant
 Gail Power LLC
 Tyseria Griffith, Agent
 2330 N. Farwell Millway
 53202
 Capacity 25
 sqft. 1300
 12/10/2024

N. FARWELL