



CITY OF MILWAUKEE
OFFICE OF THE CITY CLERK

Monday, December 18, 2023

COMMITTEE MEETING NOTICE

AD 14

LOPEZ SALAZAR, Marta Y, Agent
MARTA'S TAMALES LLC
2531 N 19TH St
Milwaukee, WI 53206

You are requested to attend a hearing which is to be held in Room 301-B, Third Floor, City Hall or you may attend virtually using the link below.

Friday, January 05, 2024 at 09:25 AM

The access code is https://meet.goto.com/852030949. If you wish to call in: +1 (571) 317-3112 and use Access Code: 852-030-949 Please see the enclosed best practices document for further instructions.

Regarding: Your Class B Fermented Malt License Application as agent for "MARTA'S TAMALES LLC" for "MARTA'S TAMALES" at 551 W BECHER St.



There is a possibility that your application may be denied for one or more of the following reasons: The recommendation of the committee regarding the application shall be based on evidence presented at the hearing. Per MCO 85-2.7-4, probative evidence concerning whether or not a new license should be granted may be presented on the following subjects: whether or not the applicant meets the municipal requirements, the appropriateness of the location and premises where the licensed premises is to be located and whether use of the premises for the purposes or activities permitted by the license would tend to facilitate a public or private nuisance or create undesirable neighborhood problems such as disorderly patrons, unreasonably loud noise, litter, and excessive traffic and parking congestion. Probative evidence relating to these matters may be taken from the plan of operation submitted with the license application, if any, but shall not include the content of any music. Evidence regarding the fitness of the location of the premises to be maintained as the principal place of business, including but not limited to whether there is an overconcentration of businesses of the type for which the license is sought; whether the proposal is consistent with any pertinent neighborhood business or development plans, or the location's proximity to areas where children are typically present. The applicant's record in operating similarly licensed premises; and whether or not the applicant has been charged with or convicted of any felony, misdemeanor, municipal offense or other offense, the circumstances of which substantially relate to the activity to be permitted by the license being applied for or any other factor which reasonably relates to the public health, safety or welfare may also be considered. See attached police report or correspondence.

Notice for applicants with warrants or unpaid fines:

Proof of warrant satisfaction or payment of fines must be submitted at the hearing on the above date and time. Failure to comply with this requirement may result in a delay of the granting/denial of your application.

Failure to appear at this meeting may result in the denial of your license. Individual applicants must appear only in person or by an attorney. Corporate or Limited Liability applicants must appear only by the agent designated on the application or by an attorney. Partnership applicants must appear by a partner listed on the application or by an attorney. If you wish to do so and at your own expense, you may be accompanied by an attorney of your choosing to represent you at this hearing.

You will be given an opportunity to speak on behalf of the application and to respond and challenge any charges or reasons given for the denial. No petitions can be accepted by the committee, unless the people who signed the petition are present at the committee hearing and willing to testify. You may present witnesses under oath and you may also confront and cross-examine opposing witnesses under oath. If you have difficulty with the English language, you should bring an interpreter with you, at your expense, so that you can answer questions and participate in your hearing.

You may examine the application file at this office during regular business hours prior to the hearing date. Inquiries regarding this matter may be directed to the person whose signature appears below.

Limited parking for persons attending meetings during normal business hours is available at reduced rates (5 hour limit) at the Milwaukee Center on the southwest corner of Kilbourn Avenue and Water Street. You must present a copy of the meeting notice to the parking cashier.

PLEASE NOTE: Upon reasonable notice, efforts will be made to accommodate the needs of disabled individuals through sign language interpreters or other auxiliary aids. For additional information or to request this service, contact the Council Services Division ADA Coordinator at (414) 286-2998, Fax - (414) 286-3456, TDD - (414) 286-2025.

JIM OWCZARSKI, CITY CLERK

Handwritten signature of Jim Cooney

BY:

Jim Cooney
License Division Manager

If you have questions regarding this notice, please contact the License Division at (414) 286-2238.

200 E. Wells Street, Room 105, City Hall, Milwaukee, WI 53202. www.milwaukee.gov/license
Phone: (414) 286-2238 Fax: (414) 286-3057 Email Address: License@milwaukee.gov

Date: 11/14/23  
Officer: Benitez

City of Milwaukee Police Department  
90-5-1.5 Crime Prevention Survey  
Tavern Inspection

Name of Premise: Marta's Tamales  
Address: 551 W. Becher St  
Phone: 414 617-3797

Owner: Marta Lopez-Salazar  
Owner address: 2531 N. 19<sup>th</sup> St  
City State Zip: Milwaukee WI 53206  
Owner Phone: 414 617-3797  
Owner email: martalopez3393@yahoo.com

Licensee/Agent: Same  
Home Address:  
City State Zip:  
Phone:  
Email:

Preferred contact: By Cell

Location currently open:  YES  NO

Projected open date:

Day's open: S M T W Th F SA ALL

Hours of Operation: Sun: 7am -10pm 24 hours Y N  
Mon: 7am-10pm  
Tue: 7am-10pm  
Wed: 7am-10pm  
Thu: 7am-10pm  
Fri: 7am-10pm  
Sat: 7am-10pm

Premise Type: Tavern/Bar  
Restaurant  
Other:

Licenses currently held:

Alcohol:  Yes  No Class: #:  
 Tobacco:  Yes  No #:  
 Food:  Yes  No #:  
 Extended Hours:  Yes  No #:  
 Secondhand Dealer:  Yes  No Type: #:  
 Other:  Yes  No Type: #:  
 Other:  Yes  No Type: #:

**Exterior Survey:**

1. Is the area around the location clean?  Yes  No
2. What surrounds the location? (Check all the apply)
  - a.  Park
  - b.  School
  - c.  Youth Center
  - d.  Church
  - e.  Tavern(s) If so, how many
  - f.  Residential
  - g.  Other businesses
  - h.  Other:
3. Can you see from the outside of the location into the interior  Yes  No
4. Can you see the employees inside of the location from the outside  Yes  No
5. Are exterior windows free of signage  Yes  No
6. Is there a parking lot  Yes  No
7. Is the parking lot clean?  Yes  No
8. Off-Street parking  Yes  No
9. Is the parking lot well lit?  Yes  No
10. Valet Parking  Yes  No
  - a. Will this lot have a guard?  Yes  No
  - b. Will this lot have cameras?  Yes  No
11. Are there areas where a person could conceal themselves  Yes  No
12. Is there exterior lighting?  Yes  No. Does it appears to be adequate  Yes  No
13. Exterior Payphone?  Yes  No
14. Are there No Loitering Signs posted?  Yes  No
15. Are there exterior security cameras  Yes  No How Many: 15
16. Are the address numbers prominently displayed and easy to see  Yes  No

**Camera Survey:**

17. Does this location have security cameras?  Yes  No
18. Are they in working order?  Yes  No
19. What format are the cameras?
  - a. Color  Yes  No
  - b. Digital  Yes  No
  - c. Recorded  Yes  No
20. How long is footage stored for later viewing: 14 Days
21. Are there exterior cameras  Yes  No How many: 5
22. Are there interior cameras  Yes  No How many: 10
23. Do all employees know how to retrieve recorded digital images/footage?  Yes  No

24. Cameras located in parking lot Yes No How many2

**Interior Survey:**

25. What is the planned capacity 79
26. What is the minimum number of employees That will be on premise 7
27. Is the storeowner willing to be a standing complainant regarding loitering? Yes No
- a. If yes have them fill out the standing complaint form and give them two of the commercial signs Yes No
28. Is the interior of the location neat and clean? Yes No
29. Does an interior camera face the entrance/exit? Yes No
30. Is there a lockable area that separates employees from customers? Yes No
31. Are emergency and non-emergency numbers posted near the phone? Yes No
32. Does the owner know how to contact their police district directly? Yes No
- a. Did you provide a district contact guide to the owner? Yes No

**Security**

33. How many security personnel are going to be employed: N/A
34. How ill they be deployed: Interior Exterior
35. What days will they be deployed MonTueWedThuFriSatSun
36. Will the security be managed by business or contracted
37. Will they be armed Yes No
38. What type of security measures to be used:
- Wanding/metal detector
  - ID Scanner
  - Dress Code
  - Cover Charge
  - Age restriction
  - Other

**ADDITIONAL COMMENTS/RECOMMENDATIONS:**

The location is restaurant and primarily will be serving food. The location is finishing up some minor remodeling and hopes to be open soon. The agent stated that the hard drive for the camera operating system is a large capacity. The agent was not sure if the video is stored for two weeks or 30 days.



# Concentration Map 551 W BECHER ST

## Area of Interest (AOI) Information

Area : 21,862,585.6 ft<sup>2</sup>

Oct 17 2023 15:13:13 Central Daylight Time

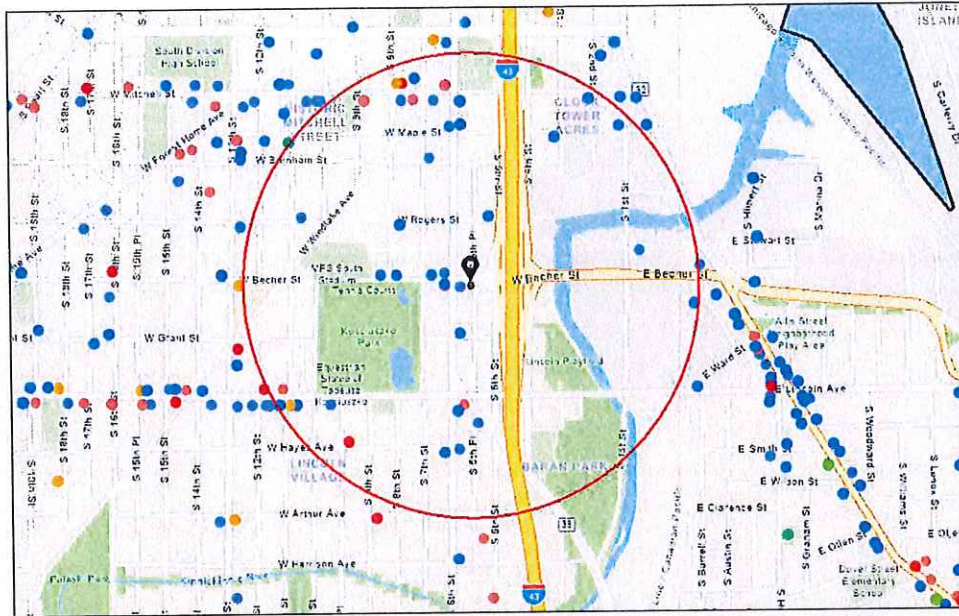

- Alcohol Licenses (active)
- Class A Fermented Malt Beverage
- Class A Liquor and Malt
- Class B Fermented Malt Beverage
- Class B Tavern
- Class C Wine Retailer
- Food Licenses (active)
- Food Dealer - Restaurant
- Food Dealer - Retailer
- City Limits

1:18,066  
 0 0.1 0.2 0.4 m  
 0 0.17 0.35 0.7 km  
 File: ConcnMap\_Download\_City of Milwaukee\_WI\_10/17/2023  
 County: Lincoln Co. Date: 10/17/2023 3:13:13 PM

551 W BECHER ST

### Summary

Name	Count	Area(ft <sup>2</sup> )	Length(mi)
Food Licenses	40		
Alcohol Licenses	24		

Food Licenses

#	Legal Entity	Trade Name	Licensee	Address	License Type Name	Total Capacity	Expiration Date	Count
1	Shrinathji Inc	Subway #33490	RAJENDRAB HAI S PATEL, Agt	839 W Historic Mitchell ST	Food Dealer - Restaurant		10/19/2023, 7:00 PM	1
2	Sabor Culichi LLC	Sabor Culichi	Gladys Leticia Zepeda Lopez, Agt	565 W LINCOLN AV	Food Dealer - Restaurant		10/29/2023, 7:00 PM	1
3	7TH ST MART LLC	7TH ST MART LLC	Alaadeen Abuawad, Agt	1832 S 7th ST	Food Dealer Retail		11/10/2023, 6:00 PM	1
4	MESA GARIBALDI, LLC	FIESTA GARIBALDI	VALDEMAR ESCOBAR, Agt	821-23 W LINCOLN AV	Food Dealer - Restaurant		12/11/2023, 6:00 PM	1
5	Taqueria El Toro LLC	Taqueria El Toro LLC	Toribio Perez Martinez, Agt	551 W Historic Mitchell ST	Food Dealer - Restaurant		12/11/2023, 6:00 PM	1
6	WHEEL & SPROCKET, INC	Wheel & Sprocket	Noel C Kegel, Agt	187 E BECHER ST	Food Dealer Retail		12/20/2023, 6:00 PM	1
7	Mercado Neza	Mercado Neza	Angela Portillo, Agt	2105 S 6TH ST	Food Dealer - Restaurant		12/25/2023, 6:00 PM	1
8	ASEEL'S FOOD	ASEEL'S FOOD	ABDULJALIL S ABDULJALIL, SP	1982 S 11TH ST	Food Dealer Retail		1/13/2024, 6:00 PM	1
9	Love's Lounge, LLC	Love's Lounge	MONTE A LOVE, Agt	201 W Mitchell ST	Food Dealer - Restaurant		1/23/2024, 6:00 PM	1
10	Carnitas Machetes	Carnitas Machetes	Alberto Morales, SP	2000 S 8th ST	Food Dealer - Restaurant		2/5/2024, 6:00 PM	1
11	La Casa del Chivolin, LLC	La Casa del Chivolin	Luis Alvarez, Agt	2423 S 6TH ST	Food Dealer - Restaurant		2/7/2024, 6:00 PM	1
12	Tony's Pizzeria, LLC	Tony's Pizzeria	Bernardino A Herrera, Agt	604 W Historic Mitchell ST	Food Dealer - Restaurant		2/13/2024, 6:00 PM	1
13	BECHER PETRO PANTRY	BECHER PETRO PANTRY	HARSINDER SINGH, Agt	610 W BECHER ST	Food Dealer Retail		2/29/2024, 6:00 PM	1
14	Taqueria Isabel LLC	Taqueria Isabel LLC	Leticia Morales Garcia, Agt	604 W HISTORIC MITCHELL ST	Food Dealer - Restaurant		3/10/2024, 7:00 PM	1
15	LA LUNA LIQUOR, INC	LA LUNA LIQUOR	HANIN K ABDELRAHIM, Agt	552 W MAPLE ST	Food Dealer Retail		3/19/2024, 7:00 PM	1
16	6 Petro Mart LLC	Best Petroleum	Bilal Muhammad, Agt	575 W Becher ST	Food Dealer Retail		3/26/2024, 7:00 PM	1
17	Beer Town LLC	Beer Town	PARAMJIT KAUR, Agt	1029 W Lincoln AV	Food Dealer Retail		4/2/2024, 7:00 PM	1
18	Lincoln Bakery Inc	Lincoln Bakery Inc	JUANA M Paredones, Agt	1023 W LINCOLN AV	Food Dealer Retail		4/2/2024, 7:00 PM	1
19	Speedway, LLC	Speedway #4292	Kimberly K Duncan, Agt	959 W Lincoln AV	Food Dealer Retail		4/8/2024, 7:00 PM	1
20	Kiyani LLC	Petro Mart	Bilal Muhammad, Agt	2341 S CHASE AV	Food Dealer Retail		4/8/2024, 7:00 PM	1
21	MKE TATERS LLC	MKE TATERS LLC	Roberto C Bermejo, Agt	604 W HISTORIC MITCHELL ST	Food Dealer - Restaurant		4/10/2024, 7:00 PM	1

22	Newhustle LLC	B&G Food	Nichole L Gonzalez, Agt	2420 S 6th ST	Food Dealer Retail		4/14/2024, 7:00 PM	1
23	FANNIES KIDS KITCHEN LLC	FANNIES KIDS KITCHEN; DIGGLERS DIET	Tamia M Freeman, Agt	833-837 W HISTORIC MITCHELL ST	Food Dealer - Restaurant		4/16/2024, 7:00 PM	1
24	Liquid Elevation LLC	La Pina	Patrick L Todd, Agt	1801 S 3RD ST	Food Dealer - Restaurant		4/30/2024, 7:00 PM	1
25	La Luna Liquor Taqueria LLC	La Luna Liquor Taqueria	HANIN K ABDELRAHIM, Agt	552R W MAPLE ST	Food Dealer - Restaurant		5/2/2024, 7:00 PM	1
26	MAMOE GROCERY STORE LLC	MAMOE GROCERY STORE LLC	Swabay Da, Agt	1101 W LINCOLN AV	Food Dealer Retail		5/16/2024, 7:00 PM	1
27	SASTA BAZAAR, INC.	SASTA BAZAAR	Mohammad A Patel, Agt	709 W HISTORIC MITCHELL ST	Food Dealer Retail		5/20/2024, 7:00 PM	1
28	TAQUERIA SIERRA MIXE LLC	TAQUERIA SIERRA MIXE	Ernestina Confesor Martinez, Agt	551 W HISTORIC MITCHELL ST	Food Dealer - Restaurant		6/26/2024, 7:00 PM	1
29	Benny's Pizza	Benny's Pizza	ABEL RODRIGUEZ, Agt	1102 W Lincoln AV	Food Dealer - Restaurant		6/29/2024, 7:00 PM	1
30	Anmol, LLC	Anmol Restaurant	Mohammad A Patel, Agt	711 W Historic Mitchell ST	Food Dealer - Restaurant		6/29/2024, 7:00 PM	1
31	El Salvador Restaurant	El Salvador Restaurant	Concepcion Arias, SP	2316 S 6TH ST	Food Dealer - Restaurant		7/29/2024, 7:00 PM	1
32	MOR Foods LLC	MOR Bakery	Traci L Morgan - Hoernke, Agt	2018 S 1ST ST	Food Dealer Retail		8/6/2024, 7:00 PM	1
33	Cream City Hospitality LLC	Heirloom MKE	Jessica J Ignatiev, Agt	604 W HISTORIC MITCHELL ST	Food Dealer - Restaurant		8/23/2024, 7:00 PM	1
34	Taqueria Hernandez LLC	Taqueria Hernandez	Amador Alvarez Pizano, Agt	551 W HISTORIC MITCHELL ST	Food Dealer - Restaurant		9/11/2024, 7:00 PM	1
35	La Salsita Restaurant LLC	La Salsita Restaurant	Nicolas Santa Cruz-Ruedas, Agt	1105 W Lincoln AV	Food Dealer - Restaurant		9/17/2024, 7:00 PM	1
36	AARAVJOT LLC	La Franja	Sukhpreet Randhawa, Agt	2366 S 9TH PL	Food Dealer Retail		9/18/2024, 7:00 PM	1
37	QUALITY DISCOUNT, LLC	QUALITY DISCOUNT	OMAR A ALI, Agt	738 W HISTORIC MITCHELL ST	Food Dealer Retail		9/20/2024, 7:00 PM	1
38	Dolgenercorp LLC	Dollar General Store #19014	Alfred C Savaglio, Agt	627 W HISTORIC MITCHELL ST	Food Dealer Retail		9/22/2024, 7:00 PM	1
39	LA BODEGA LLC	La Bodega	Eleazar A Maldonado, Agt	731 W HISTORIC MITCHELL ST	Food Dealer Retail		10/7/2024, 7:00 PM	1
40	Shrinathji Inc	Subway #33490	RAJENDRAB HAI S PATEL, Agt	839 W Historic Mitchell ST	Food Dealer - Restaurant		10/19/2024, 7:00 PM	1

## Alcohol Licenses



#	Legal Entity	Trade Name	Licensee	Address	License Type Name	Total Capacity	Expiration Date	Count
1	The Clem-Pank Group LLC	On My Way Home	DEBI DAMRON, Agt	2079 S 8TH ST	Class B Tavern License	71	11/17/2023, 6:00 PM	1
2	MITCHELL BEVERAGE, LLC	SAM'S LIQUOR	RUPINDER KAUR, Agt	732 W HISTORIC MITCHELL ST	Class A Malt & Class A Liquor License		11/29/2023, 6:00 PM	1
3	MESA GARIBALDI, LLC	FIESTA GARIBALDI	VALDEMAR ESCOBAR, Agt	821-23 W LINCOLN AV	Class B Tavern License		12/11/2023, 6:00 PM	1
4	Taqueria El Toro LLC	Taqueria El Toro LLC	Toribio Perez Martinez, Agt	551 W Historic Mitchell ST	Class B Tavern License	94	12/11/2023, 6:00 PM	1
5	WHEEL & SPROCKET, INC	Wheel & Sprocket	Noel C Kegel, Agt	187 E BECHER ST	Class B Tavern License		12/20/2023, 6:00 PM	1
6	La Casa del Chivolin, LLC	La Casa del Chivolin	Luis Alvarez, Agt	2423 S 6TH ST	Class B Tavern License		2/7/2024, 6:00 PM	1
7	RED MAPLE MKE LLC	RED MAPLE MKE	Robin L Koutecky, Agt	100 W MAPLE ST	Class B Tavern License	49	1/15/2024, 6:00 PM	1
8	Love's Lounge, LLC	Love's Lounge	MONTE A LOVE, Agt	201 W Mitchell ST	Class B Tavern License		1/23/2024, 6:00 PM	1
9	Carnitas Machetes	Carnitas Machetes	Alberto Morales, SP	2000 S 8th ST	Class B Tavern License		2/5/2024, 6:00 PM	1
10	Beer Town LLC	Beer Town	PARAMJIT KAUR, Agt	1029 W Lincoln AV	Class A Fermented Malt Beverage Retailer's License		4/2/2024, 7:00 PM	1
11	Liquid Elevation LLC	La Pina	Patrick L Todd, Agt	1801 S 3RD ST	Class B Tavern License		4/30/2024, 7:00 PM	1
12	LA LUNA LIQUOR, INC	LA LUNA LIQUOR	HANIN K ABDELRAHIM, Agt	552 W MAPLE ST	Class A Malt & Class A Liquor License		3/20/2024, 7:00 PM	1
13	La Luna Liquor Taqueria LLC	La Luna Liquor Taqueria	HANIN K ABDELRAHIM, Agt	552R W MAPLE ST	Class B Tavern License		5/2/2024, 7:00 PM	1
14	Salas' Bar LLC	Sala's Bar and Beer Garden	Agustin Salas Macias, Agt	2078 S 8th ST	Class B Tavern License		6/29/2024, 7:00 PM	1
15	CEDAR INN	CEDAR INN	JOANNE M HUMSIK, SP	2178 S 6TH ST	Class B Tavern License	25	6/29/2024, 7:00 PM	1
16	Club 6 LLC	Club 6	BLAS CERDA, Agt	2101 S 6th ST	Class B Tavern License	80	6/30/2024, 7:00 PM	1
17	GUANAJUAT O'S BAR	GUANAJUAT O'S BAR	FRANCISCO GONZALEZ, SR, SP	1979 S 5TH ST	Class B Tavern License	110	8/30/2024, 7:00 PM	1
18	El Salvador Restaurant	El Salvador Restaurant	Concepcion Arias, SP	2316 S 6TH ST	Class B Tavern License	50	7/29/2024, 7:00 PM	1

19	MITCHELL STREET ARTS COLLABORATIVE INCORPORATED	MITCHELL STREET ARTS COLLABORATIVE	Andrew Otto Gordon, Agt	710 W HISTORIC MITCHELL ST	Class B Tavern License		8/9/2024, 7:00 PM	1
20	TENTACIONES	TENTACIONES	MARTIN R SAAVEDRA, SP	600 W MAPLE ST	Class B Tavern License	75	8/28/2024, 7:00 PM	1
21	AARAVJOT LLC	La Franja	Sukhpreet Randhawa, Agt	2366 S 9TH PL	Class A Malt & Class A Liquor License		9/18/2024, 7:00 PM	1
22	KOZ'S MINI BOWL, INC	KOZ'S MINI BOWL	JUSTIN J KOSAKOSKI, Agt	2078 S 7TH ST	Class B Tavern License	80	9/19/2024, 7:00 PM	1
23	La Salsita Restaurant LLC	La Salsita Restaurant	Nicolas Santa Cruz-Ruedas, Agt	1105 W Lincoln AV	Class B Tavern License		9/17/2024, 7:00 PM	1
24	QUALITY DISCOUNT, LLC	QUALITY DISCOUNT	OMAR A ALI, Agt	738 W HISTORIC MITCHELL ST	Class A Fermented Malt Beverage Retailer's License		9/20/2024, 7:00 PM	1

Establishments within a 0.5 miles radius centered on area of interest.



Monday, December 18, 2023



# Notice of Public Hearing

Blank Notice

---

LOPEZ SALAZAR, Marta Y, Agent  
MARTA'S TAMALES at 551 W BECHER St  
Class B Fermented Malt License Application

**Friday, January 05, 2024 at 9:25 AM**

To whom it may concern:

The above application has been made by the above named applicant(s). This requires approval from the Licenses Committee and the Common Council of the City of Milwaukee. The hearing before the Licenses Committee will take place on 1/5/2024 at 9:25 AM in Room 301-B, Third Floor, City Hall. This is a public hearing. Those wishing to view the proceeding are able to do so via the City Channel – Channel 25 on Spectrum Cable – or on the Internet at <http://city.milwaukee.gov/citychannel>. Those wishing to provide oral testimony via phone or internet are asked to contact the staff assistant, Yadira Melendez at (414) 286-2775 or [stasst5@milwaukee.gov](mailto:stasst5@milwaukee.gov) for necessary information. Please make such requests no later than one business day prior to the start of the meeting. You are not required to attend the hearing, but please see the information below if you would like to provide testimony. Once the Licenses Committee makes its recommendation, this recommendation is forwarded to the full Common Council for approval at its next regularly scheduled hearing.

---

## Important details for those wishing to provide information for the Licenses Committee to consider when making its recommendation:

1. The license application is scheduled to be heard at the above time. Due to other hearings running longer than scheduled, you may have to wait some time to provide your testimony.
2. You must appear in person and testify as to matters that you have personally experienced or seen. (You cannot provide testimony for your neighbor, parent or anyone else; this is considered hearsay and cannot be considered by the committee.)
3. No letters or petitions can be accepted by the committee (unless the person who wrote the letter or the persons who signed the petition are present at the committee hearing and willing to testify).
4. Persons opposed to the license application are given the opportunity to testify first; supporters may testify after the opponents have finished.
5. When you are called to testify, you will be sworn in and asked to give your name, and address. (If your first and/or last names are uncommon please spell them.)
6. You may then provide testimony.
  - a. Include only information relating to the above license application.
  - b. Include only information you have personally witnessed or seen.
  - c. Provide concise and relevant information detailing how this business has affected or may affect the peaceful enjoyment of your neighborhood.
  - d. If by the time you have the opportunity to testify, the information you wish to share has already been provided to the committee, you may state that you agree with the previous testimony. Redundant or repetitive testimony will not assist the committee in making its recommendation.
7. After giving your testimony, the members of the Licenses Committee and the licensee may ask questions regarding the testimony you have given or other factors relating to the license application.
8. Business Competition is not a valid basis for denial or non-renewal of a license.  
**Please Note: If you have submitted an objection to the above application your objection cannot be considered by the committee unless you personally testify at the hearing.**

OCCUPANT	MAIL ADDRESS	CITY STATE ZIP
CURRENT OCCUPANT	2051 S 5TH PL	MILWAUKEE, WI 53204-3907
CURRENT OCCUPANT	2052 S 6TH ST	MILWAUKEE, WI 53204-3914
CURRENT OCCUPANT	2056 S 5TH PL	MILWAUKEE, WI 53204-3906
CURRENT OCCUPANT	2056A S 5TH PL	MILWAUKEE, WI 53204-3906
CURRENT OCCUPANT	2056B S 5TH PL	MILWAUKEE, WI 53204-3906
CURRENT OCCUPANT	2057 S 5TH PL	MILWAUKEE, WI 53204-3907
CURRENT OCCUPANT	2058 S 6TH ST	MILWAUKEE, WI 53204-3914
CURRENT OCCUPANT	2058A S 6TH ST	MILWAUKEE, WI 53204-3914
CURRENT OCCUPANT	2060 S 5TH PL	MILWAUKEE, WI 53204-3906
CURRENT OCCUPANT	2060 S 6TH ST	MILWAUKEE, WI 53204-3914
CURRENT OCCUPANT	2060A S 5TH PL	MILWAUKEE, WI 53204-3906
CURRENT OCCUPANT	2060B S 5TH PL	MILWAUKEE, WI 53204-3906
CURRENT OCCUPANT	2063 S 5TH PL	MILWAUKEE, WI 53204-3907
CURRENT OCCUPANT	2064 S 5TH PL	MILWAUKEE, WI 53204-3906
CURRENT OCCUPANT	2064 S 6TH ST	MILWAUKEE, WI 53204-3914
CURRENT OCCUPANT	2067 S 5TH PL	MILWAUKEE, WI 53204-3907
CURRENT OCCUPANT	2068 S 5TH PL	MILWAUKEE, WI 53204-3906
CURRENT OCCUPANT	2071 S 5TH PL	MILWAUKEE, WI 53204-3907
CURRENT OCCUPANT	2101 S 6TH ST	MILWAUKEE, WI 53215-2740
CURRENT OCCUPANT	2107 S 6TH ST	MILWAUKEE, WI 53215-2740
CURRENT OCCUPANT	2111 S 6TH ST	MILWAUKEE, WI 53215-2740
CURRENT OCCUPANT	2111A S 6TH ST	MILWAUKEE, WI 53215-2740
CURRENT OCCUPANT	2115 S 6TH ST	MILWAUKEE, WI 53215-2740
CURRENT OCCUPANT	2115A S 6TH ST	MILWAUKEE, WI 53215-2740
CURRENT OCCUPANT	2116 S 6TH ST	MILWAUKEE, WI 53215-2741
CURRENT OCCUPANT	2116A S 6TH ST	MILWAUKEE, WI 53215-2741
CURRENT OCCUPANT	2117 S 6TH ST	MILWAUKEE, WI 53215-2740
CURRENT OCCUPANT	2118 S 5TH PL	MILWAUKEE, WI 53207-1120
CURRENT OCCUPANT	2118A S 5TH PL	MILWAUKEE, WI 53207-1120
CURRENT OCCUPANT	2119 S 5TH PL	MILWAUKEE, WI 53207-1119
CURRENT OCCUPANT	2119 S 6TH ST	MILWAUKEE, WI 53215-2740
CURRENT OCCUPANT	2120 S 5TH PL	MILWAUKEE, WI 53207-1120
CURRENT OCCUPANT	2122 S 5TH PL	MILWAUKEE, WI 53207-1120
CURRENT OCCUPANT	2123 S 5TH PL	MILWAUKEE, WI 53207-1119
CURRENT OCCUPANT	2123A S 5TH PL	MILWAUKEE, WI 53207-1119
CURRENT OCCUPANT	2124 S 5TH PL	MILWAUKEE, WI 53207-1120
CURRENT OCCUPANT	2126 S 5TH PL	MILWAUKEE, WI 53207-1120
CURRENT OCCUPANT	2126 S 6TH ST	MILWAUKEE, WI 53215-2741
CURRENT OCCUPANT	2129 S 5TH PL	MILWAUKEE, WI 53207-1119
CURRENT OCCUPANT	2130 S 6TH ST	MILWAUKEE, WI 53215-2741
CURRENT OCCUPANT	2130 S 7TH ST# 100	MILWAUKEE, WI 53215-2744
CURRENT OCCUPANT	2130 S 7TH ST# 101	MILWAUKEE, WI 53215-2744
CURRENT OCCUPANT	2130 S 7TH ST# 102	MILWAUKEE, WI 53215-2744
CURRENT OCCUPANT	2130 S 7TH ST# 103	MILWAUKEE, WI 53215-2744
CURRENT OCCUPANT	2130 S 7TH ST# 104	MILWAUKEE, WI 53215-2744
CURRENT OCCUPANT	2130 S 7TH ST# 105	MILWAUKEE, WI 53215-2744

CURRENT OCCUPANT	2130 S 7TH ST# 106	MILWAUKEE, WI 53215-2744
CURRENT OCCUPANT	2130 S 7TH ST# 107	MILWAUKEE, WI 53215-2744
CURRENT OCCUPANT	2130 S 7TH ST# 108	MILWAUKEE, WI 53215-2744
CURRENT OCCUPANT	2130 S 7TH ST# 109	MILWAUKEE, WI 53215-2744
CURRENT OCCUPANT	2130 S 7TH ST# 200	MILWAUKEE, WI 53215-2744
CURRENT OCCUPANT	2130 S 7TH ST# 201	MILWAUKEE, WI 53215-2744
CURRENT OCCUPANT	2130 S 7TH ST# 202	MILWAUKEE, WI 53215-2744
CURRENT OCCUPANT	2130 S 7TH ST# 203	MILWAUKEE, WI 53215-2744
CURRENT OCCUPANT	2130 S 7TH ST# 204	MILWAUKEE, WI 53215-2744
CURRENT OCCUPANT	2130 S 7TH ST# 205	MILWAUKEE, WI 53215-2744
CURRENT OCCUPANT	2130 S 7TH ST# 206	MILWAUKEE, WI 53215-2744
CURRENT OCCUPANT	2130 S 7TH ST# 207	MILWAUKEE, WI 53215-2744
CURRENT OCCUPANT	2130 S 7TH ST# 208	MILWAUKEE, WI 53215-2744
CURRENT OCCUPANT	2130 S 7TH ST# 209	MILWAUKEE, WI 53215-2744
CURRENT OCCUPANT	2130A S 6TH ST	MILWAUKEE, WI 53215-2741
CURRENT OCCUPANT	2131 S 5TH PL	MILWAUKEE, WI 53207-1119
CURRENT OCCUPANT	2132 S 5TH PL	MILWAUKEE, WI 53207-1120
CURRENT OCCUPANT	2132A S 5TH PL	MILWAUKEE, WI 53207-1120
CURRENT OCCUPANT	2133 S 5TH PL	MILWAUKEE, WI 53207-1119
CURRENT OCCUPANT	2134 S 6TH ST	MILWAUKEE, WI 53215-2741
CURRENT OCCUPANT	2135 S 5TH PL	MILWAUKEE, WI 53207-1119
CURRENT OCCUPANT	2137 S 5TH PL	MILWAUKEE, WI 53207-1119
CURRENT OCCUPANT	2138 S 5TH PL	MILWAUKEE, WI 53207-1120
CURRENT OCCUPANT	2138 S 6TH ST	MILWAUKEE, WI 53215-2741
CURRENT OCCUPANT	2139 S 5TH ST	MILWAUKEE, WI 53207-1117
CURRENT OCCUPANT	2139 S 6TH ST	MILWAUKEE, WI 53215-2740
CURRENT OCCUPANT	2139A S 5TH ST	MILWAUKEE, WI 53207-1117
CURRENT OCCUPANT	2139A S 6TH ST	MILWAUKEE, WI 53215-2740
CURRENT OCCUPANT	2141 S 5TH PL	MILWAUKEE, WI 53207-1119
CURRENT OCCUPANT	2142 S 5TH PL	MILWAUKEE, WI 53207-1120
CURRENT OCCUPANT	2142 S 6TH ST	MILWAUKEE, WI 53215-2741
CURRENT OCCUPANT	2143 S 5TH PL	MILWAUKEE, WI 53207-1119
CURRENT OCCUPANT	2145 S 5TH PL	MILWAUKEE, WI 53207-1119
CURRENT OCCUPANT	2146 S 5TH PL	MILWAUKEE, WI 53207-1120
CURRENT OCCUPANT	2146 S 6TH ST	MILWAUKEE, WI 53215-2741
CURRENT OCCUPANT	515 W BECHER ST	MILWAUKEE, WI 53207-1125
CURRENT OCCUPANT	519 W BECHER ST	MILWAUKEE, WI 53207-1125
CURRENT OCCUPANT	523 W BECHER ST	MILWAUKEE, WI 53207-1125
CURRENT OCCUPANT	527 W BECHER ST	MILWAUKEE, WI 53207-1125
CURRENT OCCUPANT	554 W BECHER ST	MILWAUKEE, WI 53207-1136
CURRENT OCCUPANT	575 W BECHER ST	MILWAUKEE, WI 53207-1135

Blank Notice

Total Records: 87

Radius 250.0 feet and Center of the Circle: 551 W Becher St



# BUSINESS LICENSE PLAN OF OPERATION

ccl-busplan 5/12/2020

Office of the City Clerk License Division  
200 E. Wells St. Room 105, Milwaukee, WI 53202  
(414) 286-2238 www.milwaukee.gov/license e-mail address: license@milwaukee.gov

## 1. Type of Business

Applying for:  Extended Hours (12AM to 5AM) - If a food establishment, check all that apply:  Delivery  Drive Thru  Dining Room  
 Self Service Laundry  Massage Establishment  Filling Station  
 Other (supplemental application for specific license also required)

Provide a detailed description of the type of business you plan on operating:

Full Services Restaurant. with Beer

Do you have any experience operating this type of business?  No  Yes If yes, explain: Manage Restaurants.

## 2. Business Operations

- a. Proposed Opening Date: Nov 2023
- b. Is this premise under construction?  No  Yes If yes, list estimated completion date: \_\_\_\_\_
- c. Is this a franchise?  No  Yes
- d. Is this premises currently licensed?  No  Yes If yes, list type of license: \_\_\_\_\_
- e. Is the current licensee operating?  No  Yes If no, list date closed: \_\_\_\_\_
- f. Do you have future plans for other businesses, licenses or permits at this location?  No  Yes  
If yes, explain: \_\_\_\_\_
- g. Have you previously held an Extended Hours License in Milwaukee?  No  Yes  
If yes, list address(es): \_\_\_\_\_
- h. Are other businesses operating in the same building?  No  Yes If yes, describe: \_\_\_\_\_

## 3. Litter & Noise

- a. How are grounds kept clean?  Sweep  Pressure Wash  Pick Up Litter  Other: \_\_\_\_\_
- b. How often will grounds be cleaned?  Daily  Weekly  As Needed  Monthly  Other: \_\_\_\_\_
- c. Grounds cleaned by:  Licensee  Building Owner  Employees  Hired Maintenance  Other: \_\_\_\_\_
- d. How are noise issues prevented and/or addressed?  Security  Manager approaches customer(s)  Call Police  
 Signs Posted  Other: \_\_\_\_\_
- e. Will a sound amplification system be used?  No  Yes If yes, describe: Regular Speakers.

## 4. Smoking & Sanitation

- a. Are there designated outdoor smoking areas?  No  Yes If yes, describe: \_\_\_\_\_
- b. Number of Garbage Cans: Inside: 3 Locations: Kitchen. Bar. bath  
Outside: 2 Locations: Front of Building.
- c. Is a crowd control barrier used?  No  Yes If yes, describe: \_\_\_\_\_
- d. How many restrooms are on the premises? 2
- e. Name of solid waste contractor:  Advanced Disposal  Waste Management  Other: City Milwaukee

## 5. Security

- a. Are there onsite parking spaces?  No  Yes If yes, how many? 7 and describe the parking security plan: Lights Cameras.
- b. Is there a loading zone?  No  Yes If yes, describe the loading area security plan: \_\_\_\_\_
- c. Will you have security personnel on premise?  No  Yes If yes, how many? \_\_\_\_\_ and answer the following:  
 What are their responsibilities? \_\_\_\_\_  
 Is security equipment used?  No  Yes If yes, describe \_\_\_\_\_  
 List their licensing, certification, or training credentials \_\_\_\_\_
- d. Will there be security cameras?  No  Yes If yes, how many? 15 and list locations: Kitchen, Front, back of premises, dining area, Parking lot.
- e. Will searches/identification checks be done upon entry?  No  Yes If yes, describe \_\_\_\_\_

## 6. Percentage of Sales (must total 100%)

Alcohol <u>10</u> %	Food <u>90</u> %	Secondhand Merchandise _____ %	Precious Metals & Gems _____ %
Entertainment _____ %	Cigarettes _____ %	Personal Services (such as tattoo, body piercing, salon, tailor, tanning, etc.) _____ %	Other _____ %
Pawnbroker Activity _____ %	Salvaged Materials (such as scrap metal) _____ %	Describe: _____	

## 7. Businesses/Licenses on the Premises (check all that apply):

### Type 1

- Full Service Restaurant  Cafe/Coffee Shop  Deli or Fast Food Restaurant  Private/Fraternal/Veterans Club
- Night Club  Tavern  Cocktail Lounge  Teen Club
- Banquet Hall  Sports Facility  Bowling Alley
- Hotel/Motel: Number of Floors: \_\_\_\_\_ Number of Rooms: \_\_\_\_\_  
 Rooming House: Number of Floors: \_\_\_\_\_ Number of Rooms: \_\_\_\_\_

### Type 2

- Liquor Store  Corner Store  Supermarket  Convenience Store
- Gas Station  Amusement/Phonograph Distributor  Recycling, Salvage or Towing
- Used Car Dealer  Personal Service Establishment (such as tattoo business, hair salon, tailor, etc.)  Recording Studio

What other licenses/permits will you hold at this location? (check all that apply)

- Occupancy Permit  Cigarette & Tobacco  Gas Station  Extended Hours  Class "B" Tavern  Weights & Measures
- Secondhand Dealer  Precious Metal & Gem  Other: \_\_\_\_\_

## 8. Legal Capacity (only if a Type 1 premises in #7 above)

Capacity \_\_\_\_\_ (Call the Milwaukee Development Center at 414-286-8211 if you have questions.)

## 9. Premises Description

a. Identify all area(s) of the premises that will be used in operating this business (include areas used only for storage):

1<sup>st</sup> Floor  2<sup>nd</sup> Floor  Basement Storage  Patio  Beer Garden  Sidewalk Café  Deck  Rooftop

Other: Describe: \_\_\_\_\_

b. Describe Location:  Major Thoroughfare  Secondary Street  Other: \_\_\_\_\_

c. Nearest Major Cross Street: Becher

d. Describe Building:  Free Standing Building  Strip Mall  Other: \_\_\_\_\_

e. Describe Premises Structure:  Single Story  Multi-Story - # of Stories 2  Other: \_\_\_\_\_

f. Describe Surrounding Area:  Commercial  Residential  Industrial  Other: \_\_\_\_\_

g. Building Owner Name: Inderjeet S Dhillon Phone Number: 414 61737970 al

Building Owner Address: 551 W Becher St. (414 9756340)  
cel del dueño

## 10. Hours of Operation & Customers

Will customers be entering the premises?  No  Yes

Day of the Week	Proposed Hours of Operation:		Estimated Number of Customers expected each day	Potential Age Range of Customers	Class B Tavern Applicant Only: Age Restriction (If none, write 'None')
	Open Time (include a.m. or p.m.)	Close Time (include a.m. or p.m.)			
Sunday	7am	10 pm	1 - 70	0 a 100	
Monday	7am	10 pm	↓	↓	
Tuesday	7am	10 pm			
Wednesday	7am	10 pm			
Thursday	7am	10 pm			
Friday	7am	10 pm			
Saturday	7am	10 pm.			

An Extended Hours Establishment License is required for any convenience store, filling station, personal service establishment (such as tattoo, body piercing, salon, tailor, tanning, etc.), recording studio or restaurant which is open between the hours of 12:00 a.m. and 5:00 a.m.

Alcohol Establishments Class A: 8:00 am to 9:00 pm Sunday thru Saturday  
 Permitted Hours of Operation: Class B: 6:00 am to 2:00 am Sunday thru Thursday, 6:00 am to 2:30 am Friday & Saturday

Entertainment Outdoor Closing Hours: 10:00pm Sunday-Thursday; 12:00am Friday & Saturday; unless a different time, either earlier or later, is established by the Common Council in its approval of the licensee's plan of operation.

## 11. Signature(s)

*Sauria Lopez*

Signature of Sole Proprietor, Partner, or 20% or more Shareholder  
 (If there are no 20% or more shareholders,  
 Corporate Officer—print name/title and sign)

Signature of additional partner or 20% or more shareholder

See Application Information for a complete list of all required application forms.





## ALCOHOL BEVERAGE & PUBLIC ENTERTAINMENT PREMISES SUPPLEMENTAL APPLICATION

Office of the City Clerk License Division  
200 E. Wells St. Room 105, Milwaukee, WI 53202  
(414) 286-2238 e-mail address: license@milwaukee.gov [www.milwaukee.gov/license](http://www.milwaukee.gov/license)

Legal Entity Name: <u>Martals famales- LLC</u>
Premise Address: <u>551 W Beecher St.</u>
<b>Proximity of Premises to Church, School, Daycare Center or Hospital</b>
Is the building within 300 feet of any church, school, daycare center or hospital? <input checked="" type="checkbox"/> No <input type="checkbox"/> Yes
<b>"Service Bar Only" Designation</b>
If applying for Class B or C license, are you applying for "Service Bar Only"? <input checked="" type="checkbox"/> No <input type="checkbox"/> Yes Service Bar Only means customers cannot sit at the bar. Alcohol is served to employees who serve patrons seated at tables. No stools, chairs or other articles of furniture shall be placed at the service bar for patrons to sit upon.
<b>Business Information</b>
a) Are you taking out this application for anyone that may not be eligible for a license? <input checked="" type="checkbox"/> No <input type="checkbox"/> Yes If yes, list their name and address: _____
b) Will the agent, a partner or the individual licensee be conducting the day-to-day operations of the business? <input type="checkbox"/> No <input checked="" type="checkbox"/> Yes If no, list the name and address of the person(s) who will: _____
Class B Applicants: If the agent, a partner or the individual licensee will not be conducting the day-to-day operations of the business, the person(s) listed above must obtain a Class B Managers license.
c) Does anyone else have money invested or any other interest in this business? <input checked="" type="checkbox"/> No <input type="checkbox"/> Yes If yes, explain: _____
d) Have you made an agreement with anyone to repay any loan or any other payments based upon income from the business? <input checked="" type="checkbox"/> No <input type="checkbox"/> Yes If yes, list name and address: _____
<b>Property Information (New &amp; Transfer Applicants Only)</b>
a) Do you own or lease the building? <input type="checkbox"/> Own <input checked="" type="checkbox"/> Lease
b) Who owns the fixtures (for example, coolers, etc.)? _____
c) Are you purchasing the stock and/or fixtures? <input type="checkbox"/> No <input type="checkbox"/> Yes If yes, amount paid \$ _____
d) Total amount paid for business    \$ _____
e) Total amount paid for goodwill of the business    \$ _____
Goodwill comprises the reputation and customer relationships of an existing business. If the price you pay for the business exceeds the fair market value of all of the rest of the assets of the business, the excess may be considered goodwill.
f) Have you made arrangements with the seller for payment of personal property taxes? <input type="checkbox"/> No <input type="checkbox"/> Yes
<b>Lease Information (New &amp; Transfer Applicants who are leasing the premises only)</b>
a) Date lease begins <u>09-30-23</u> Ends <u>09-30-27</u>
b) Monthly rental    \$ <u>4,500</u>
c) Do you have an option to renew the lease? <input type="checkbox"/> No <input checked="" type="checkbox"/> Yes
d) Does your lease allow for assignment to another party without the consent of the owner? <input checked="" type="checkbox"/> No <input type="checkbox"/> Yes
e) For what length of time have you been guaranteed occupancy (number of years)? <u>5</u>

### Lease Information (Continued)

- f) In addition to paying the monthly rental, will you have to pay anything additional to the owner of the building to guarantee performance of the lease?  No  Yes If yes, explain \_\_\_\_\_
- g) Does the present owner or occupant object to the granting of your license?  No  Yes  
If yes, explain \_\_\_\_\_

### Change of Agent Applicants Only

Have there been any changes to the floor plan since the last application was submitted?  No  Yes  
If no, a new floor plan is not required. If yes, submit a new floor plan and explain the change(s):  
\_\_\_\_\_

### Signature



Signature of Sole Proprietor, Partner or 20% or More Shareholder  
(If no 20% or more Shareholder, Corporate Officer - print name/title and sign)

Note: All information contained in this application is subject to approval by the Common Council.  
Deviating from approved plan of operation will subject licensee to citations, and/or suspension or non-renewal of the license.  
Contact the License Division for information on how to request changes.

### New and transfer of premises applicants must submit the following:

- Detailed floor plan
- If a restaurant, copy of the menu

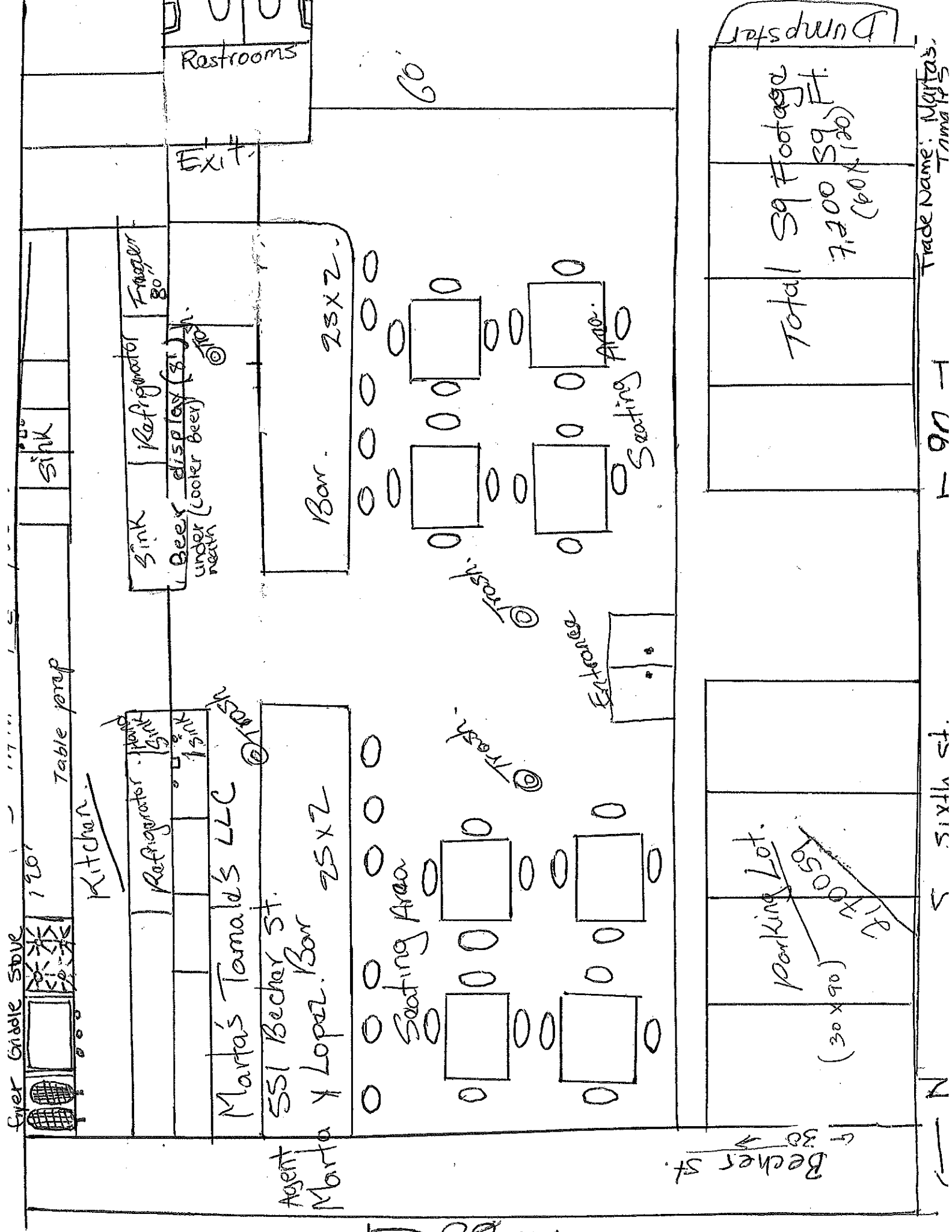

Total Sq Footage  
 7,200 Sq Ft.  
 (60x120)

Trade Name: Marta's  
 Trina H. S.

1-90-H

5 Sixth St.

N

Becher St. ← 530

1-60-1

Agent  
Marta y Lopez

Marta's Tamale's LLC  
 551 Becher St.  
 Bar 25x2

Kitchen  
 Table prep  
 Sink  
 Refrigerator  
 Sink  
 Sink

Marta's Tamalds. Marta y Lopez Salazar  
551 W Becher.

Total 59700 sq ft  
1800 sq ft

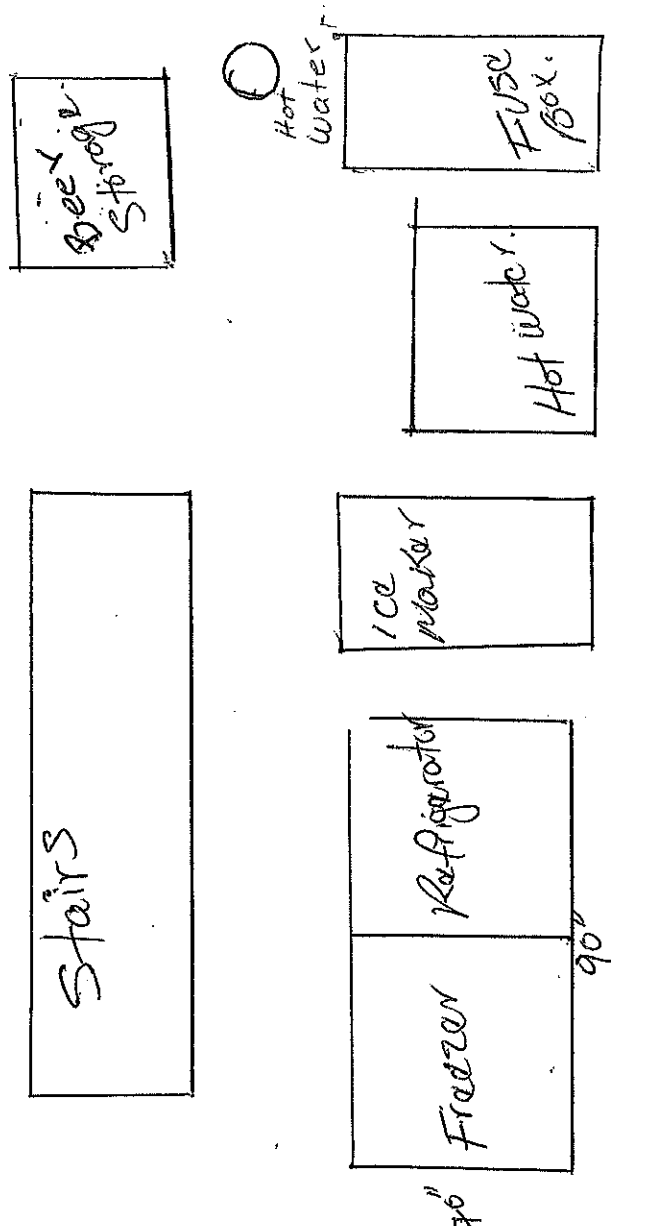

Becher Street

Basement

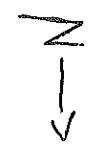

6th Street