

# Project area map

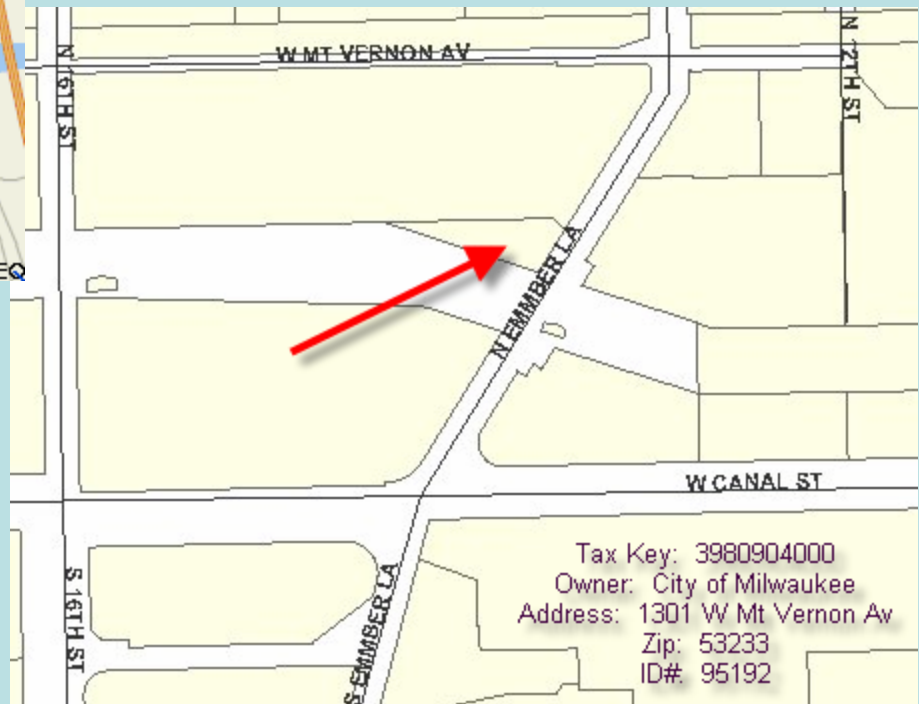

# Aerial Image of Project Area

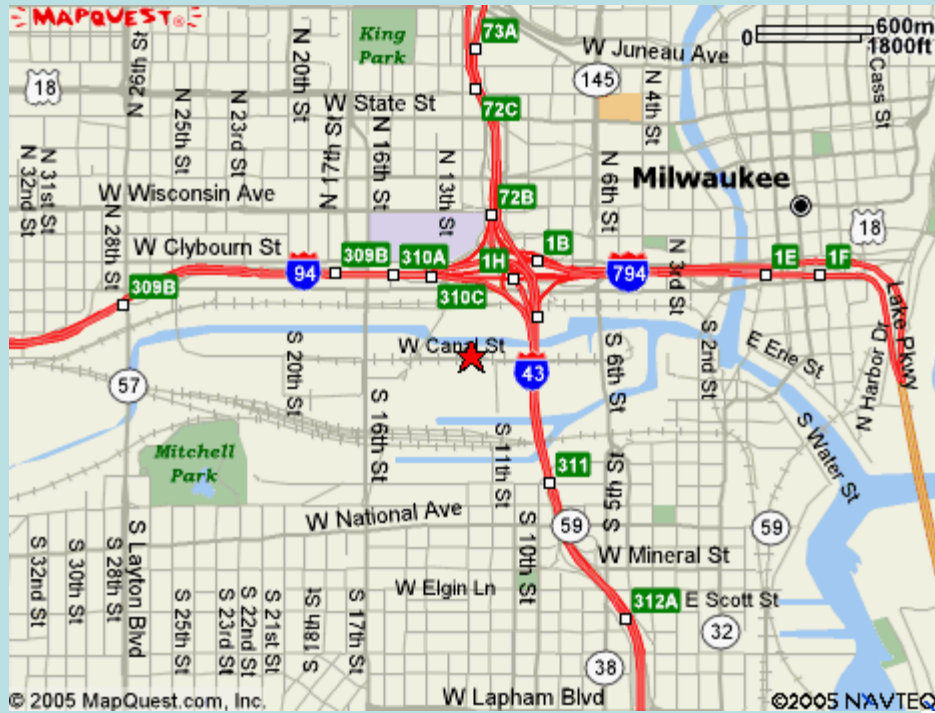

# Current Debris Collection



# Current Debris Collection



# Project Design Solution

## Features

- Trash Wall
- Pile Supported Viewing Deck/Walkway
- Cantilevered Access to Walkway
- Large Floating Launching Dock with Hinged access ramp.
- Floating Island with Wild Rice
- Upland Park with Native Plants

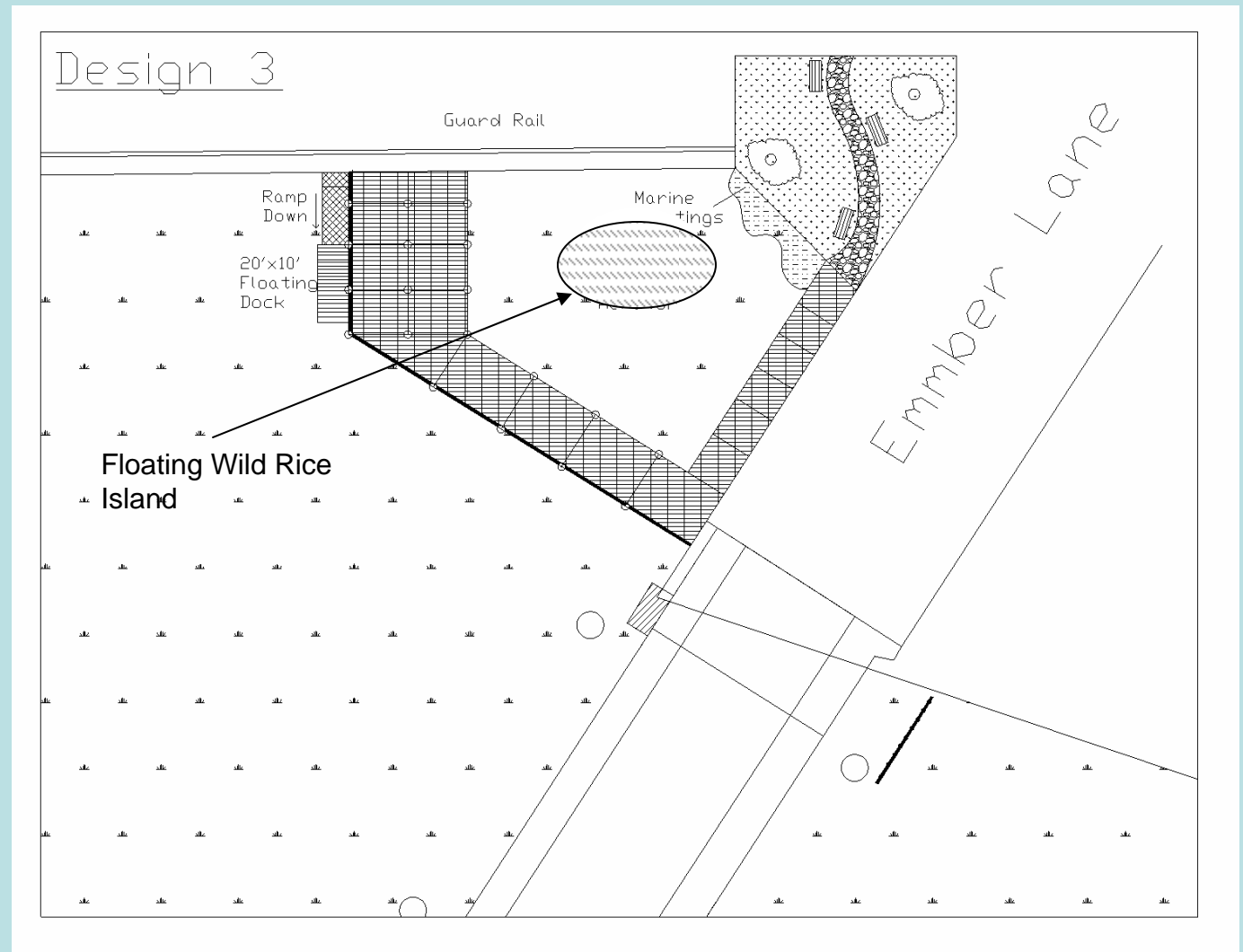

# Project Design Elements

