



**CITY OF MILWAUKEE  
OFFICE OF THE CITY CLERK**

Wednesday, March 20, 2019

**COMMITTEE MEETING NOTICE**

AD 09

DHILLON, Gurmeet K, Agent  
Royal Plaza Liquor Inc  
8700 W BROWN DEER Rd

Milwaukee, WI 53224

You are requested to attend a hearing which is to be held in Room 301-B, Third Floor, City Hall on:

**Wednesday, April 03, 2019 at 01:30 PM**

**Regarding:** Your Class A Malt & Class A Liquor License Renewal Application with a Change in Stockholder as agent for "Royal Plaza Liquor Inc" for "Royal Plaza Liquor Inc" at 8700 W BROWN DEER Rd.

There is a possibility that your application may be denied for one or more of the following reasons: The recommendation of the committee regarding the application shall be based on evidence presented at the hearing. Per MCO 85-4-4, unless otherwise specified in the code, probative evidence concerning non-renewal, suspension or revocation may include evidence of the following: failure of the applicant to meet municipal qualifications, pending charges against or the conviction of any felony, misdemeanor, municipal offense or other offense, the circumstances of which substantially relate to the circumstances of the particular licensed or permitted activity, by the applicant or by any employee or other agent of the applicant. If the activities of the applicant involve a licensed premises, whether the premises tends to facilitate a public or private nuisance or has been the source of congregations of persons which have resulted in any of the following: disturbance of the peace; illegal drug activity; public drunkenness; drinking in public; harassment of passers-by; gambling; prostitution; sale of stolen goods; public urination; theft; assaults; battery; acts of vandalism including graffiti, excessive littering, loitering, illegal parking, loud noise at times when the licensed premise is open for business; traffic violations; curfew violations; lewd conduct; display of materials harmful to minors, pursuant to s. 106-9.6; or any other factor which reasonably relates to the public health, safety and welfare, or failure to comply with the approved plan of operation. See attached police report or correspondence.

**Notice for applicants with warrants or unpaid fines:** Proof of warrant satisfaction or payment of fines must be submitted at the hearing on the above date and time. Failure to comply with this requirement may result in a delay of the granting/denial of your application.

Failure to appear at this meeting may result in the denial of your license. Individual applicants must appear only in person or by an attorney. Corporate or Limited Liability applicants must appear only by the agent designated on the application or by an attorney. Partnership applicants must appear by a partner listed on the application or by an attorney. If you wish to do so and at your own expense, you may be accompanied by an attorney of your choosing to represent you at this hearing.

You will be given an opportunity to speak on behalf of the application and to respond and challenge any charges or reasons given for the denial. No petitions can be accepted by the committee, unless the people who signed the petition are present at the committee hearing and willing to testify. You may present witnesses under oath and you may also confront and cross-examine opposing witnesses under oath. If you have difficulty with the English language, you should bring an interpreter with you, at your expense, so that you can answer questions and participate in your hearing.

You may examine the application file at this office during regular business hours prior to the hearing date. Inquiries regarding this matter may be directed to the person whose signature appears below.

Limited parking for persons attending meetings in City Hall is available at reduced rates (5 hour limit) at the Milwaukee Center on the southwest corner of East Kilbourn and North Water Street. Parking tickets must be validated in the first floor information booth in City Hall.

PLEASE NOTE: Upon reasonable notice, efforts will be made to accommodate the needs of disabled individuals through sign language interpreters or other auxiliary aids. For additional information or to request this service, contact the Council Services Division ADA Coordinator at (414) 286-2998, Fax - (414) 286-3456, TDD - (414) 286-2025.

JIM OWCZARSKI, CITY CLERK

BY: \_\_\_\_\_

Jessica Celella  
License Division Manager

**If you have questions regarding this notice, please contact the License Division at (414) 286-2238.**



Wednesday, March 20, 2019



# Notice of Public Hearing

---

DHILLON, Gurmeet K, Agent  
Royal Plaza Liquor Inc at 8700 W BROWN DEER Rd  
Class A Malt & Class A Liquor License Renewal Application with a Change in Stockholder

**Wednesday, April 03, 2019 at 1:30 PM**

To whom it may concern:

The above application has been made by the above named applicant(s). This requires approval from the Licenses Committee and the Common Council of the City of Milwaukee. The hearing before the Licenses Committee will take place on 4/3/2019 at 1:30 PM, in Room 301-B, Third Floor, City Hall. If you wish, you may provide testimony at the hearing regarding the request; see below for further information. You are not required to attend the hearing. Once the Licenses Committee makes its recommendation, this recommendation is forwarded to the full Common Council for approval at its next regularly scheduled hearing. Please review the information below and if you have further questions regarding this process, please contact the License Division at (414) 286-2238.

---

## Important details for those wishing to provide information for the Licenses Committee to consider when making its recommendation:

1. The license application is scheduled to be heard at the above time. Due to other hearings running longer than scheduled, you may have to wait some time to provide your testimony.
2. You must appear in person and testify as to matters that you have personally experienced or seen. (You cannot provide testimony for your neighbor, parent or anyone else; this is considered hearsay and cannot be considered by the committee.)
3. No letters or petitions can be accepted by the committee (unless the person who wrote the letter or the persons who signed the petition are present at the committee hearing and willing to testify).
4. Persons opposed to the license application are given the opportunity to testify first; supporters may testify after the opponents have finished.
5. When you are called to testify, you will be sworn in and asked to give your name, and address. (If your first and/or last names are uncommon please spell them.)
6. You may then provide testimony.
  - a. Include only information relating to the above license application.
  - b. Include only information you have personally witnessed or seen.
  - c. Provide concise and relevant information detailing how this business has affected or may affect the peaceful enjoyment of your neighborhood.
  - d. If by the time you have the opportunity to testify, the information you wish to share has already been provided to the committee, you may state that you agree with the previous testimony. Redundant or repetitive testimony will not assist the committee in making its recommendation.
7. After giving your testimony, the members of the Licenses Committee and the licensee may ask questions regarding the testimony you have given or other factors relating to the license application.
8. Business Competition is not a valid basis for denial or non-renewal of a license.  
**Please Note: If you have submitted an objection to the above application your objection cannot be considered by the committee unless you personally testify at the hearing.**

OCCUPANT	MAIL ADDRESS	CITY, STATE ZIP
CURRENT OCCUPANT	8711 W GREENBROOK DR	MILWAUKEE, WI 53224
CURRENT OCCUPANT	8701 W GREENBROOK DR	MILWAUKEE, WI 53224

Total Records: 2

Radius: 250.0 feet and Center of Circle: 8700 W Brown Deer Rd

# MILWAUKEE POLICE DEPARTMENT LICENSING

## CRIMINAL RECORD/ORDINANCE VIOLATION/INCIDENTS SYNOPSIS

**DATE:** 02/26/2019  
**LICENSE TYPE:** ALQML  
**NEW:**   
**RENEWAL:**

**No. 289541**  
**Application Date:** 02/26/2019

**License Location:** 8700 W Brown Deer Rd  
**Business Name:** Royal Plaza Liquor Inc

**Licensee/Applicant:** DHILLON, Gurmeet K  
(Last Name, First Name, MI)  
**Date of Birth:** 12/25/1959

**Home Address:** 2003 S Valley Spring Dr  
**City:** New Berlin **State:** WI **Zip Code:** 53151  
**Home Phone:** 414-975-6340

This report is written by Police Officer David NOVAK, assigned to the License Investigation Unit, Days.

The Milwaukee Police Department's investigation regarding this application revealed the following:

1. On 02/03/2016 Inderjeet DHILLON (shareholder) was cited at 2072 S 6<sup>th</sup> St in the city of Milwaukee for Secondhand Dealer-License Required.

**Charge:** Secondhand Dealer-License Required  
**Finding:** Guilty  
**Sentence:** \$250.00 fine  
**Date:** 06/23/2016  
**Case:** 16011024



**2018-2019 Plan of Operation for 8700 W BROWN DEER RD**

**1. Litter & Security Plans**

How are the grounds kept clean?  Sweep  Pressure Wash  Pick Up Litter  Other:

How often will grounds be cleaned?  Daily  Weekly  Other:

Who cleans the grounds?  Licensee  Building Owner  Employees  Hired Maintenance  Other:

How are noise issues prevented and/or addressed?  Security  Manager approaches customer(s)  Call Police  Signs Posted

Other: *Employee and Owner Keep Control*

Are there designated outdoor smoking areas?  No  Yes If Yes, Describe:

Number of garbage cans: Inside 1 Locations: \_\_\_\_\_  
 Outside 1 Locations: \_\_\_\_\_

Is a crowd control barrier used?  No  Yes If Yes, Describe:

Number of restrooms: one Name of solid waste contractor: *waste management*

Are there parking spaces on the premises?  No  Yes If Yes, list number of spaces: 7 and describe security plans:

Are there designated loading areas?  No  Yes If Yes, describe security plans:

Do you have security personnel on the premise?  No  Yes If Yes, how many? \_\_\_\_\_

AND What are their responsibilities? \_\_\_\_\_

What security equipment do they use? \_\_\_\_\_

List their licensing, certification or training credentials: \_\_\_\_\_

Are there security cameras?  No  Yes If Yes, list all locations: *outside parking - 5 inside store.*

Are searches and/or identification checks conducted upon entry?  No  Yes If Yes, describe:

**2. Percentage of Sales (must total 100%)**

Alcohol 80 % Food Sales 10 % Entertainment — % Other Cig 10 %

**3. Businesses On The Premises (choose all that apply):**

Restaurant  Cafe/Coffee Shop  Cocktail Lounge  Convenience Store  Night Club  Liquor Store  Tavern  Sports Facility  
 Hotel  Banquet Hall  Supermarket  Private/Fraternal/Veterans' Club  Other:

**4. Hours of Operation and Age Restriction**

Are there any changes to the current hours of operation or age restriction?  No  Yes If Yes, Describe:

Please Note: If you will be open earlier or later than the hours listed on your current license for even one event or holiday (for example, St. Patrick's Day, Brewers Opening Day, etc.) during the license period, this must be reported and printed on your license.

Your hours of operation and age restriction are listed on your current license.

**5. Floor Plan and Capacity**

Are you requesting any changes to your capacity or floor plan\*?  No  Yes If yes, describe: \_\_\_\_\_ and submit a new floor plan with this renewal application. A sample plan can be found online at [www.milwaukee.gov/licenses](http://www.milwaukee.gov/licenses) under License Forms and Related Information.

Alcohol/Food Establishments: A "Permanent Extension of Premises Application" is required if you are adding any square footage to the licensed premises.

**6. Sidewalk Dining: Fee:**

Are there any changes to the sidewalk dining site plan?  No  Yes If Yes, submit an updated site plan with this application.

**7. Food License: Fee:**

Your current food license includes the following food operations: Are there any changes to your food operations as listed above?  No  Yes, if Yes, explain

**8. Weights and Measures: Fee:**

Number/Type of Devices:  
 Are there any changes to the number or types of devices?  No  Yes If yes, contact our office for further instructions.



**CITY OF MILWAUKEE  
OFFICE OF THE CITY CLERK**

Wednesday, March 27, 2019

**COMMITTEE MEETING NOTICE**

AD 09

FAROOQUI, Faisal A, Agent  
STFR Investment LLC  
9026 W Brown Deer Rd  
Milwaukee, WI 53224

You are requested to attend a hearing which is to be held in Room 301-B, Third Floor, City Hall on:

**Wednesday, April 03, 2019 at 01:30 PM**

**Regarding:** Your Food Dealer Retail, Filling Station, and Weights & Measures License Applications as agent for "STFR Investment LLC" for "BP Gas Station" at 9026 W Brown Deer Rd.

There is a possibility that your application may be denied for one or more of the following reasons: The recommendation of the committee regarding the application shall be based on evidence presented at the hearing. Per MCO 85-2.7-4, probative evidence concerning whether or not a new license should be granted may be presented on the following subjects: whether or not the applicant meets the municipal requirements, the appropriateness of the location and premises where the licensed premises is to be located and whether use of the premises for the purposes or activities permitted by the license would tend to facilitate a public or private nuisance or create undesirable neighborhood problems such as disorderly patrons, unreasonably loud noise, litter, and excessive traffic and parking congestion. Probative evidence relating to these matters may be taken from the plan of operation submitted with the license application, if any, but shall not include the content of any music. Evidence regarding the fitness of the location of the premises to be maintained as the principal place of business, including but not limited to whether there is an overconcentration of businesses of the type for which the license is sought; whether the proposal is consistent with any pertinent neighborhood business or development plans, or the location's proximity to areas where children are typically present. The applicant's record in operating similarly licensed premises; and whether or not the applicant has been charged with or convicted of any felony, misdemeanor, municipal offense or other offense, the circumstances of which substantially relate to the activity to be permitted by the license being applied for or any other factor which reasonably relates to the public health, safety or welfare may also be considered. See attached police report or correspondence.

**Notice for applicants with warrants or unpaid fines:**

Proof of warrant satisfaction or payment of fines must be submitted at the hearing on the above date and time. Failure to comply with this requirement may result in a delay of the granting/denial of your application.

Failure to appear at this meeting may result in the denial of your license. Individual applicants must appear only in person or by an attorney. Corporate or Limited Liability applicants must appear only by the agent designated on the application or by an attorney. Partnership applicants must appear by a partner listed on the application or by an attorney. If you wish to do so and at your own expense, you may be accompanied by an attorney of your choosing to represent you at this hearing.

You will be given an opportunity to speak on behalf of the application and to respond and challenge any charges or reasons given for the denial. No petitions can be accepted by the committee, unless the people who signed the petition are present at the committee hearing and willing to testify. You may present witnesses under oath and you may also confront and cross-examine opposing witnesses under oath. If you have difficulty with the English language, you should bring an interpreter with you, at your expense, so that you can answer questions and participate in your hearing.

You may examine the application file at this office during regular business hours prior to the hearing date. Inquiries regarding this matter may be directed to the person whose signature appears below.

Limited parking for persons attending meetings in City Hall is available at reduced rates (5 hour limit) at the Milwaukee Center on the southwest corner of East Kilbourn and North Water Street. Parking tickets must be validated in the first floor information booth in City Hall.

PLEASE NOTE: Upon reasonable notice, efforts will be made to accommodate the needs of disabled individuals through sign language interpreters or other auxiliary aids. For additional information or to request this service, contact the Council Services Division ADA Coordinator at (414) 286-2998, Fax - (414) 286-3456, TDD - (414) 286-2025.

JIM OWCZARSKI, CITY CLERK

BY: \_\_\_\_\_

Jessica Celella  
License Division Manager

**If you have questions regarding this notice, please contact the License Division at (414) 286-2238.**

200 E. Wells Street, Room 105, City Hall, Milwaukee, WI 53202. [www.milwaukee.gov/license](http://www.milwaukee.gov/license)  
Phone: (414) 286-2238 Fax: (414) 286-3057 Email Address: [License@milwaukee.gov](mailto:License@milwaukee.gov)



**CITY OF MILWAUKEE  
OFFICE OF THE CITY CLERK**

Wednesday, March 27, 2019

**COMMITTEE MEETING NOTICE**

AD 09

FAROOQUI, Faisal A, Agent  
STFR Investment LLC  
4320 W Edgerton Ave  
Greenfield, WI 53220

You are requested to attend a hearing which is to be held in Room 301-B, Third Floor, City Hall on:

**Wednesday, April 03, 2019 at 01:30 PM**

**Regarding:** Your Food Dealer Retail, Filling Station, and Weights & Measures License Applications as agent for "STFR Investment LLC" for "BP Gas Station" at 9026 W Brown Deer Rd.

There is a possibility that your application may be denied for one or more of the following reasons: The recommendation of the committee regarding the application shall be based on evidence presented at the hearing. Per MCO 85-2.7-4, probative evidence concerning whether or not a new license should be granted may be presented on the following subjects: whether or not the applicant meets the municipal requirements, the appropriateness of the location and premises where the licensed premises is to be located and whether use of the premises for the purposes or activities permitted by the license would tend to facilitate a public or private nuisance or create undesirable neighborhood problems such as disorderly patrons, unreasonably loud noise, litter, and excessive traffic and parking congestion. Probative evidence relating to these matters may be taken from the plan of operation submitted with the license application, if any, but shall not include the content of any music. Evidence regarding the fitness of the location of the premises to be maintained as the principal place of business, including but not limited to whether there is an overconcentration of businesses of the type for which the license is sought; whether the proposal is consistent with any pertinent neighborhood business or development plans, or the location's proximity to areas where children are typically present. The applicant's record in operating similarly licensed premises; and whether or not the applicant has been charged with or convicted of any felony, misdemeanor, municipal offense or other offense, the circumstances of which substantially relate to the activity to be permitted by the license being applied for or any other factor which reasonably relates to the public health, safety or welfare may also be considered. See attached police report or correspondence.

**Notice for applicants with warrants or unpaid fines:**

Proof of warrant satisfaction or payment of fines must be submitted at the hearing on the above date and time. Failure to comply with this requirement may result in a delay of the granting/denial of your application.

Failure to appear at this meeting may result in the denial of your license. Individual applicants must appear only in person or by an attorney. Corporate or Limited Liability applicants must appear only by the agent designated on the application or by an attorney. Partnership applicants must appear by a partner listed on the application or by an attorney. If you wish to do so and at your own expense, you may be accompanied by an attorney of your choosing to represent you at this hearing.

You will be given an opportunity to speak on behalf of the application and to respond and challenge any charges or reasons given for the denial. No petitions can be accepted by the committee, unless the people who signed the petition are present at the committee hearing and willing to testify. You may present witnesses under oath and you may also confront and cross-examine opposing witnesses under oath. If you have difficulty with the English language, you should bring an interpreter with you, at your expense, so that you can answer questions and participate in your hearing.

You may examine the application file at this office during regular business hours prior to the hearing date. Inquiries regarding this matter may be directed to the person whose signature appears below.

Limited parking for persons attending meetings in City Hall is available at reduced rates (5 hour limit) at the Milwaukee Center on the southwest corner of East Kilbourn and North Water Street. Parking tickets must be validated in the first floor information booth in City Hall.

PLEASE NOTE: Upon reasonable notice, efforts will be made to accommodate the needs of disabled individuals through sign language interpreters or other auxiliary aids. For additional information or to request this service, contact the Council Services Division ADA Coordinator at (414) 286-2998, Fax - (414) 286-3456, TDD - (414) 286-2025.

JIM OWCZARSKI, CITY CLERK

BY: \_\_\_\_\_  
Jessica Celella  
License Division Manager

**If you have questions regarding this notice, please contact the License Division at (414) 286-2238.**

200 E. Wells Street, Room 105, City Hall, Milwaukee, WI 53202. [www.milwaukee.gov/license](http://www.milwaukee.gov/license)  
Phone: (414) 286-2238 Fax: (414) 286-3057 Email Address: [License@milwaukee.gov](mailto:License@milwaukee.gov)



Wednesday, March 27, 2019



# Notice of Public Hearing

---

FAROOQUI, Faisal A, Agent  
BP Gas Station at 9026 W Brown Deer Rd  
Food Dealer Retail, Filling Station, and Weights & Measures License Applications

**Wednesday, April 03, 2019 at 1:30 PM**

To whom it may concern:

The above application has been made by the above named applicant(s). This requires approval from the Licenses Committee and the Common Council of the City of Milwaukee. The hearing before the Licenses Committee will take place on 4/3/2019 at 1:30 PM, in Room 301-B, Third Floor, City Hall. If you wish, you may provide testimony at the hearing regarding the request; see below for further information. You are not required to attend the hearing. Once the Licenses Committee makes its recommendation, this recommendation is forwarded to the full Common Council for approval at its next regularly scheduled hearing. Please review the information below and if you have further questions regarding this process, please contact the License Division at (414) 286-2238.

---

## Important details for those wishing to provide information for the Licenses Committee to consider when making its recommendation:

1. The license application is scheduled to be heard at the above time. Due to other hearings running longer than scheduled, you may have to wait some time to provide your testimony.
2. You must appear in person and testify as to matters that you have personally experienced or seen. (You cannot provide testimony for your neighbor, parent or anyone else; this is considered hearsay and cannot be considered by the committee.)
3. No letters or petitions can be accepted by the committee (unless the person who wrote the letter or the persons who signed the petition are present at the committee hearing and willing to testify).
4. Persons opposed to the license application are given the opportunity to testify first; supporters may testify after the opponents have finished.
5. When you are called to testify, you will be sworn in and asked to give your name, and address. (If your first and/or last names are uncommon please spell them.)
6. You may then provide testimony.
  - a. Include only information relating to the above license application.
  - b. Include only information you have personally witnessed or seen.
  - c. Provide concise and relevant information detailing how this business has affected or may affect the peaceful enjoyment of your neighborhood.
  - d. If by the time you have the opportunity to testify, the information you wish to share has already been provided to the committee, you may state that you agree with the previous testimony. Redundant or repetitive testimony will not assist the committee in making its recommendation.
7. After giving your testimony, the members of the Licenses Committee and the licensee may ask questions regarding the testimony you have given or other factors relating to the license application.
8. Business Competition is not a valid basis for denial or non-renewal of a license.  
**Please Note: If you have submitted an objection to the above application your objection cannot be considered by the committee unless you personally testify at the hearing.**



OCCUPANT	MAIL ADDRESS	CITY, STATE ZIP
CURRENT OCCUPANT	8930F N 95TH ST	MILWAUKEE, WI 53224
CURRENT OCCUPANT	9011H N 95TH ST	MILWAUKEE, WI 53224
CURRENT OCCUPANT	9241E W ALLYN ST	MILWAUKEE, WI 53224
CURRENT OCCUPANT	9097F N 95TH ST	MILWAUKEE, WI 53224
CURRENT OCCUPANT	8827C N 95TH ST	MILWAUKEE, WI 53224
CURRENT OCCUPANT	9001C N SWAN RD	MILWAUKEE, WI 53224
CURRENT OCCUPANT	8931F N SWAN RD	MILWAUKEE, WI 53224
CURRENT OCCUPANT	9221E W ALLYN ST	MILWAUKEE, WI 53224
CURRENT OCCUPANT	9021E N SWAN RD	MILWAUKEE, WI 53224
CURRENT OCCUPANT	8951K N 95TH ST	MILWAUKEE, WI 53224
CURRENT OCCUPANT	8872H N 95TH ST	MILWAUKEE, WI 53224
CURRENT OCCUPANT	9011E N 95TH ST	MILWAUKEE, WI 53224
CURRENT OCCUPANT	9241J W ALLYN ST	MILWAUKEE, WI 53224
CURRENT OCCUPANT	8970J N 95TH ST	MILWAUKEE, WI 53224
CURRENT OCCUPANT	8860E N 95TH ST	MILWAUKEE, WI 53224
CURRENT OCCUPANT	8930C N 95TH ST	MILWAUKEE, WI 53224
CURRENT OCCUPANT	9060L N 95TH ST	MILWAUKEE, WI 53224
CURRENT OCCUPANT	8853E N SWAN RD	MILWAUKEE, WI 53224
CURRENT OCCUPANT	8872C N 95TH ST	MILWAUKEE, WI 53224
CURRENT OCCUPANT	9241C W ALLYN ST	MILWAUKEE, WI 53224
CURRENT OCCUPANT	9010A N 95TH ST	MILWAUKEE, WI 53224
CURRENT OCCUPANT	9010D N 95TH ST	MILWAUKEE, WI 53224
CURRENT OCCUPANT	9070G N 95TH ST	MILWAUKEE, WI 53224
CURRENT OCCUPANT	8871K N SWAN RD	MILWAUKEE, WI 53224
CURRENT OCCUPANT	9070E N 95TH ST	MILWAUKEE, WI 53224
CURRENT OCCUPANT	8860A N 95TH ST	MILWAUKEE, WI 53224
CURRENT OCCUPANT	8859A N SWAN RD	MILWAUKEE, WI 53224
CURRENT OCCUPANT	9241B W ALLYN ST	MILWAUKEE, WI 53224
CURRENT OCCUPANT	9060D N 95TH ST	MILWAUKEE, WI 53224
CURRENT OCCUPANT	8854G N 95TH ST	MILWAUKEE, WI 53224
CURRENT OCCUPANT	8859D N SWAN RD	MILWAUKEE, WI 53224
CURRENT OCCUPANT	8872F N 95TH ST	MILWAUKEE, WI 53224
CURRENT OCCUPANT	8865F N SWAN RD	MILWAUKEE, WI 53224
CURRENT OCCUPANT	9070F N 95TH ST	MILWAUKEE, WI 53224
CURRENT OCCUPANT	8867D N 95TH ST	MILWAUKEE, WI 53224
CURRENT OCCUPANT	8941J N SWAN RD	MILWAUKEE, WI 53224
CURRENT OCCUPANT	8867C N 95TH ST	MILWAUKEE, WI 53224
CURRENT OCCUPANT	8884K N 95TH ST	MILWAUKEE, WI 53224
CURRENT OCCUPANT	8859L N SWAN RD	MILWAUKEE, WI 53224
CURRENT OCCUPANT	9060A N 95TH ST	MILWAUKEE, WI 53224
CURRENT OCCUPANT	8889J N SWAN RD	MILWAUKEE, WI 53224
CURRENT OCCUPANT	9031K N SWAN RD	MILWAUKEE, WI 53224
CURRENT OCCUPANT	9001L N SWAN RD	MILWAUKEE, WI 53224
CURRENT OCCUPANT	9325E W ALLYN ST	MILWAUKEE, WI 53224
CURRENT OCCUPANT	8871A N SWAN RD	MILWAUKEE, WI 53224
CURRENT OCCUPANT	8910D N 95TH ST	MILWAUKEE, WI 53224

CURRENT OCCUPANT	9071K N 95TH ST	MILWAUKEE, WI 53224
CURRENT OCCUPANT	9060E N 95TH ST	MILWAUKEE, WI 53224
CURRENT OCCUPANT	9076H N 95TH ST	MILWAUKEE, WI 53224
CURRENT OCCUPANT	9076J N 95TH ST	MILWAUKEE, WI 53224
CURRENT OCCUPANT	8854F N 95TH ST	MILWAUKEE, WI 53224
CURRENT OCCUPANT	9020H N 95TH ST	MILWAUKEE, WI 53224
CURRENT OCCUPANT	8854E N 95TH ST	MILWAUKEE, WI 53224
CURRENT OCCUPANT	8931H N SWAN RD	MILWAUKEE, WI 53224
CURRENT OCCUPANT	8883F N SWAN RD	MILWAUKEE, WI 53224
CURRENT OCCUPANT	8860G N 95TH ST	MILWAUKEE, WI 53224
CURRENT OCCUPANT	8970A N 95TH ST	MILWAUKEE, WI 53224
CURRENT OCCUPANT	9125E W ALLYN ST	MILWAUKEE, WI 53224
CURRENT OCCUPANT	8866E N 95TH ST	MILWAUKEE, WI 53224
CURRENT OCCUPANT	9031H N SWAN RD	MILWAUKEE, WI 53224
CURRENT OCCUPANT	8835 N SWAN RD 5	MILWAUKEE, WI 53224
CURRENT OCCUPANT	8835 N SWAN RD 1	MILWAUKEE, WI 53224
CURRENT OCCUPANT	8835 N SWAN RD 7	MILWAUKEE, WI 53224
CURRENT OCCUPANT	8848D N 95TH ST	MILWAUKEE, WI 53224
CURRENT OCCUPANT	8865C N SWAN RD	MILWAUKEE, WI 53224
CURRENT OCCUPANT	9221F W ALLYN ST	MILWAUKEE, WI 53224
CURRENT OCCUPANT	8866A N 95TH ST	MILWAUKEE, WI 53224
CURRENT OCCUPANT	8877F N SWAN RD	MILWAUKEE, WI 53224
CURRENT OCCUPANT	9011J N SWAN RD	MILWAUKEE, WI 53224
CURRENT OCCUPANT	8827K N 95TH ST	MILWAUKEE, WI 53224
CURRENT OCCUPANT	9011D N 95TH ST	MILWAUKEE, WI 53224
CURRENT OCCUPANT	8853A N SWAN RD	MILWAUKEE, WI 53224
CURRENT OCCUPANT	8901F N SWAN RD	MILWAUKEE, WI 53224
CURRENT OCCUPANT	9010G N 95TH ST	MILWAUKEE, WI 53224
CURRENT OCCUPANT	9020F N 95TH ST	MILWAUKEE, WI 53224
CURRENT OCCUPANT	9261G W ALLYN ST	MILWAUKEE, WI 53224
CURRENT OCCUPANT	8889D N SWAN RD	MILWAUKEE, WI 53224
CURRENT OCCUPANT	8854B N 95TH ST	MILWAUKEE, WI 53224
CURRENT OCCUPANT	8848H N 95TH ST	MILWAUKEE, WI 53224
CURRENT OCCUPANT	8901E N SWAN RD	MILWAUKEE, WI 53224
CURRENT OCCUPANT	8911H N 95TH ST	MILWAUKEE, WI 53224
CURRENT OCCUPANT	8921E N SWAN RD	MILWAUKEE, WI 53224
CURRENT OCCUPANT	8827E N 95TH ST	MILWAUKEE, WI 53224
CURRENT OCCUPANT	8911D N 95TH ST	MILWAUKEE, WI 53224
CURRENT OCCUPANT	8889E N SWAN RD	MILWAUKEE, WI 53224
CURRENT OCCUPANT	9281A W ALLYN ST	MILWAUKEE, WI 53224
CURRENT OCCUPANT	8847B N SWAN RD	MILWAUKEE, WI 53224
CURRENT OCCUPANT	9076K N 95TH ST	MILWAUKEE, WI 53224
CURRENT OCCUPANT	8911K N SWAN RD	MILWAUKEE, WI 53224
CURRENT OCCUPANT	8827H N 95TH ST	MILWAUKEE, WI 53224
CURRENT OCCUPANT	9020B N 95TH ST	MILWAUKEE, WI 53224
CURRENT OCCUPANT	9241F W ALLYN ST	MILWAUKEE, WI 53224
CURRENT OCCUPANT	9060J N 95TH ST	MILWAUKEE, WI 53224

CURRENT OCCUPANT	9040F N 95TH ST	MILWAUKEE, WI 53224
CURRENT OCCUPANT	8847G N SWAN RD	MILWAUKEE, WI 53224
CURRENT OCCUPANT	8860K N 95TH ST	MILWAUKEE, WI 53224
CURRENT OCCUPANT	9096H N 95TH ST	MILWAUKEE, WI 53224
CURRENT OCCUPANT	9011H N SWAN RD	MILWAUKEE, WI 53224
CURRENT OCCUPANT	9221A W ALLYN ST	MILWAUKEE, WI 53224
CURRENT OCCUPANT	8884H N 95TH ST	MILWAUKEE, WI 53224
CURRENT OCCUPANT	8877C N SWAN RD	MILWAUKEE, WI 53224
CURRENT OCCUPANT	8871E N SWAN RD	MILWAUKEE, WI 53224
CURRENT OCCUPANT	8836H N 95TH ST	MILWAUKEE, WI 53224
CURRENT OCCUPANT	9071B N 95TH ST	MILWAUKEE, WI 53224
CURRENT OCCUPANT	8841G N SWAN RD	MILWAUKEE, WI 53224
CURRENT OCCUPANT	8883C N SWAN RD	MILWAUKEE, WI 53224
CURRENT OCCUPANT	8827D N 95TH ST	MILWAUKEE, WI 53224
CURRENT OCCUPANT	8848G N 95TH ST	MILWAUKEE, WI 53224
CURRENT OCCUPANT	9086C N 95TH ST	MILWAUKEE, WI 53224
CURRENT OCCUPANT	8950C N 95TH ST	MILWAUKEE, WI 53224
CURRENT OCCUPANT	8847J N SWAN RD	MILWAUKEE, WI 53224
CURRENT OCCUPANT	9021F N SWAN RD	MILWAUKEE, WI 53224
CURRENT OCCUPANT	8841D N SWAN RD	MILWAUKEE, WI 53224
CURRENT OCCUPANT	9060M N 95TH ST	MILWAUKEE, WI 53224
CURRENT OCCUPANT	8877A N SWAN RD	MILWAUKEE, WI 53224
CURRENT OCCUPANT	8847D N SWAN RD	MILWAUKEE, WI 53224
CURRENT OCCUPANT	8866B N 95TH ST	MILWAUKEE, WI 53224
CURRENT OCCUPANT	8877G N SWAN RD	MILWAUKEE, WI 53224
CURRENT OCCUPANT	8872E N 95TH ST	MILWAUKEE, WI 53224
CURRENT OCCUPANT	9076F N 95TH ST	MILWAUKEE, WI 53224
CURRENT OCCUPANT	8911A N SWAN RD	MILWAUKEE, WI 53224
CURRENT OCCUPANT	8895G N SWAN RD	MILWAUKEE, WI 53224
CURRENT OCCUPANT	9125A W ALLYN ST	MILWAUKEE, WI 53224
CURRENT OCCUPANT	8930A N 95TH ST	MILWAUKEE, WI 53224
CURRENT OCCUPANT	9021H N SWAN RD	MILWAUKEE, WI 53224
CURRENT OCCUPANT	8841H N SWAN RD	MILWAUKEE, WI 53224
CURRENT OCCUPANT	9061D N 95TH ST	MILWAUKEE, WI 53224
CURRENT OCCUPANT	9061F N 95TH ST	MILWAUKEE, WI 53224
CURRENT OCCUPANT	9031D N 95TH ST	MILWAUKEE, WI 53224
CURRENT OCCUPANT	8884A N 95TH ST	MILWAUKEE, WI 53224
CURRENT OCCUPANT	8877J N SWAN RD	MILWAUKEE, WI 53224
CURRENT OCCUPANT	8847K N SWAN RD	MILWAUKEE, WI 53224
CURRENT OCCUPANT	8854K N 95TH ST	MILWAUKEE, WI 53224
CURRENT OCCUPANT	8889F N SWAN RD	MILWAUKEE, WI 53224
CURRENT OCCUPANT	8990B N 95TH ST	MILWAUKEE, WI 53224
CURRENT OCCUPANT	8883D N SWAN RD	MILWAUKEE, WI 53224
CURRENT OCCUPANT	8835 N SWAN RD 8	MILWAUKEE, WI 53224
CURRENT OCCUPANT	8835 N SWAN RD 2	MILWAUKEE, WI 53224
CURRENT OCCUPANT	9070C N 95TH ST	MILWAUKEE, WI 53224
CURRENT OCCUPANT	8842B N 95TH ST	MILWAUKEE, WI 53224

CURRENT OCCUPANT	9241G W ALLYN ST	MILWAUKEE, WI 53224
CURRENT OCCUPANT	9076C N 95TH ST	MILWAUKEE, WI 53224
CURRENT OCCUPANT	8883H N SWAN RD	MILWAUKEE, WI 53224
CURRENT OCCUPANT	9070A N 95TH ST	MILWAUKEE, WI 53224
CURRENT OCCUPANT	9061C N 95TH ST	MILWAUKEE, WI 53224
CURRENT OCCUPANT	8842E N 95TH ST	MILWAUKEE, WI 53224
CURRENT OCCUPANT	8951B N 95TH ST	MILWAUKEE, WI 53224
CURRENT OCCUPANT	8931J N SWAN RD	MILWAUKEE, WI 53224
CURRENT OCCUPANT	8859M N SWAN RD	MILWAUKEE, WI 53224
CURRENT OCCUPANT	8866D N 95TH ST	MILWAUKEE, WI 53224
CURRENT OCCUPANT	8911J N SWAN RD	MILWAUKEE, WI 53224
CURRENT OCCUPANT	8847E N SWAN RD	MILWAUKEE, WI 53224
CURRENT OCCUPANT	9071H N 95TH ST	MILWAUKEE, WI 53224
CURRENT OCCUPANT	8836E N 95TH ST	MILWAUKEE, WI 53224
CURRENT OCCUPANT	8951C N 95TH ST	MILWAUKEE, WI 53224
CURRENT OCCUPANT	9030F N 95TH ST	MILWAUKEE, WI 53224
CURRENT OCCUPANT	8853F N SWAN RD	MILWAUKEE, WI 53224
CURRENT OCCUPANT	9071E N 95TH ST	MILWAUKEE, WI 53224
CURRENT OCCUPANT	9071F N 95TH ST	MILWAUKEE, WI 53224
CURRENT OCCUPANT	8883B N SWAN RD	MILWAUKEE, WI 53224
CURRENT OCCUPANT	9076B N 95TH ST	MILWAUKEE, WI 53224
CURRENT OCCUPANT	9051D N 95TH ST	MILWAUKEE, WI 53224
CURRENT OCCUPANT	9221H W ALLYN ST	MILWAUKEE, WI 53224
CURRENT OCCUPANT	9010M N 95TH ST	MILWAUKEE, WI 53224
CURRENT OCCUPANT	9031H N 95TH ST	MILWAUKEE, WI 53224
CURRENT OCCUPANT	8871G N SWAN RD	MILWAUKEE, WI 53224
CURRENT OCCUPANT	9031J N SWAN RD	MILWAUKEE, WI 53224
CURRENT OCCUPANT	9125C W ALLYN ST	MILWAUKEE, WI 53224
CURRENT OCCUPANT	9011B N SWAN RD	MILWAUKEE, WI 53224
CURRENT OCCUPANT	9021D N SWAN RD	MILWAUKEE, WI 53224
CURRENT OCCUPANT	9001J N SWAN RD	MILWAUKEE, WI 53224
CURRENT OCCUPANT	8990C N 95TH ST	MILWAUKEE, WI 53224
CURRENT OCCUPANT	9021B N SWAN RD	MILWAUKEE, WI 53224
CURRENT OCCUPANT	8878B N 95TH ST	MILWAUKEE, WI 53224
CURRENT OCCUPANT	9086A N 95TH ST	MILWAUKEE, WI 53224
CURRENT OCCUPANT	8836G N 95TH ST	MILWAUKEE, WI 53224
CURRENT OCCUPANT	9070D N 95TH ST	MILWAUKEE, WI 53224
CURRENT OCCUPANT	9031E N SWAN RD	MILWAUKEE, WI 53224
CURRENT OCCUPANT	9096J N 95TH ST	MILWAUKEE, WI 53224
CURRENT OCCUPANT	8878D N 95TH ST	MILWAUKEE, WI 53224
CURRENT OCCUPANT	8836B N 95TH ST	MILWAUKEE, WI 53224
CURRENT OCCUPANT	9060G N 95TH ST	MILWAUKEE, WI 53224
CURRENT OCCUPANT	8884F N 95TH ST	MILWAUKEE, WI 53224
CURRENT OCCUPANT	8853B N SWAN RD	MILWAUKEE, WI 53224
CURRENT OCCUPANT	8865E N SWAN RD	MILWAUKEE, WI 53224
CURRENT OCCUPANT	8910H N 95TH ST	MILWAUKEE, WI 53224
CURRENT OCCUPANT	8867B N 95TH ST	MILWAUKEE, WI 53224

CURRENT OCCUPANT	8859J N SWAN RD	MILWAUKEE, WI 53224
CURRENT OCCUPANT	9011M N SWAN RD	MILWAUKEE, WI 53224
CURRENT OCCUPANT	8970D N 95TH ST	MILWAUKEE, WI 53224
CURRENT OCCUPANT	8871C N SWAN RD	MILWAUKEE, WI 53224
CURRENT OCCUPANT	9086G N 95TH ST	MILWAUKEE, WI 53224
CURRENT OCCUPANT	9281F W ALLYN ST	MILWAUKEE, WI 53224
CURRENT OCCUPANT	8951E N 95TH ST	MILWAUKEE, WI 53224
CURRENT OCCUPANT	8841F N SWAN RD	MILWAUKEE, WI 53224
CURRENT OCCUPANT	9125K W ALLYN ST	MILWAUKEE, WI 53224
CURRENT OCCUPANT	8910M N 95TH ST	MILWAUKEE, WI 53224
CURRENT OCCUPANT	8866F N 95TH ST	MILWAUKEE, WI 53224
CURRENT OCCUPANT	9060B N 95TH ST	MILWAUKEE, WI 53224
CURRENT OCCUPANT	9281C W ALLYN ST	MILWAUKEE, WI 53224
CURRENT OCCUPANT	8910K N 95TH ST	MILWAUKEE, WI 53224
CURRENT OCCUPANT	9061L N 95TH ST	MILWAUKEE, WI 53224
CURRENT OCCUPANT	8990E N 95TH ST	MILWAUKEE, WI 53224
CURRENT OCCUPANT	8921K N SWAN RD	MILWAUKEE, WI 53224
CURRENT OCCUPANT	9050J N 95TH ST	MILWAUKEE, WI 53224
CURRENT OCCUPANT	9261C W ALLYN ST	MILWAUKEE, WI 53224
CURRENT OCCUPANT	8990D N 95TH ST	MILWAUKEE, WI 53224
CURRENT OCCUPANT	9040B N 95TH ST	MILWAUKEE, WI 53224
CURRENT OCCUPANT	8941D N SWAN RD	MILWAUKEE, WI 53224
CURRENT OCCUPANT	8854D N 95TH ST	MILWAUKEE, WI 53224
CURRENT OCCUPANT	9061B N 95TH ST	MILWAUKEE, WI 53224
CURRENT OCCUPANT	9325G W ALLYN ST	MILWAUKEE, WI 53224
CURRENT OCCUPANT	9281G W ALLYN ST	MILWAUKEE, WI 53224
CURRENT OCCUPANT	9020E N 95TH ST	MILWAUKEE, WI 53224
CURRENT OCCUPANT	9096G N 95TH ST	MILWAUKEE, WI 53224
CURRENT OCCUPANT	8911G N SWAN RD	MILWAUKEE, WI 53224
CURRENT OCCUPANT	8878F N 95TH ST	MILWAUKEE, WI 53224
CURRENT OCCUPANT	9076A N 95TH ST	MILWAUKEE, WI 53224
CURRENT OCCUPANT	8827J N 95TH ST	MILWAUKEE, WI 53224
CURRENT OCCUPANT	8901A N SWAN RD	MILWAUKEE, WI 53224
CURRENT OCCUPANT	8930D N 95TH ST	MILWAUKEE, WI 53224
CURRENT OCCUPANT	9021A N SWAN RD	MILWAUKEE, WI 53224
CURRENT OCCUPANT	8895F N SWAN RD	MILWAUKEE, WI 53224
CURRENT OCCUPANT	9040J N 95TH ST	MILWAUKEE, WI 53224
CURRENT OCCUPANT	9010B N 95TH ST	MILWAUKEE, WI 53224
CURRENT OCCUPANT	8854H N 95TH ST	MILWAUKEE, WI 53224
CURRENT OCCUPANT	8931K N SWAN RD	MILWAUKEE, WI 53224
CURRENT OCCUPANT	8901K N SWAN RD	MILWAUKEE, WI 53224
CURRENT OCCUPANT	8877H N SWAN RD	MILWAUKEE, WI 53224
CURRENT OCCUPANT	9325F W ALLYN ST	MILWAUKEE, WI 53224
CURRENT OCCUPANT	8871B N SWAN RD	MILWAUKEE, WI 53224
CURRENT OCCUPANT	8859B N SWAN RD	MILWAUKEE, WI 53224
CURRENT OCCUPANT	8911B N SWAN RD	MILWAUKEE, WI 53224
CURRENT OCCUPANT	9096A N 95TH ST	MILWAUKEE, WI 53224

CURRENT OCCUPANT	8854A N 95TH ST	MILWAUKEE, WI 53224
CURRENT OCCUPANT	9096E N 95TH ST	MILWAUKEE, WI 53224
CURRENT OCCUPANT	9050A N 95TH ST	MILWAUKEE, WI 53224
CURRENT OCCUPANT	8889K N SWAN RD	MILWAUKEE, WI 53224
CURRENT OCCUPANT	9071L N 95TH ST	MILWAUKEE, WI 53224
CURRENT OCCUPANT	9011A N SWAN RD	MILWAUKEE, WI 53224
CURRENT OCCUPANT	8889G N SWAN RD	MILWAUKEE, WI 53224
CURRENT OCCUPANT	8841B N SWAN RD	MILWAUKEE, WI 53224
CURRENT OCCUPANT	8910L N 95TH ST	MILWAUKEE, WI 53224
CURRENT OCCUPANT	8871F N SWAN RD	MILWAUKEE, WI 53224
CURRENT OCCUPANT	9030E N 95TH ST	MILWAUKEE, WI 53224
CURRENT OCCUPANT	9011A N 95TH ST	MILWAUKEE, WI 53224
CURRENT OCCUPANT	9031J N 95TH ST	MILWAUKEE, WI 53224
CURRENT OCCUPANT	8921G N SWAN RD	MILWAUKEE, WI 53224
CURRENT OCCUPANT	8910E N 95TH ST	MILWAUKEE, WI 53224
CURRENT OCCUPANT	8941C N SWAN RD	MILWAUKEE, WI 53224
CURRENT OCCUPANT	9070B N 95TH ST	MILWAUKEE, WI 53224
CURRENT OCCUPANT	8859C N SWAN RD	MILWAUKEE, WI 53224
CURRENT OCCUPANT	8878H N 95TH ST	MILWAUKEE, WI 53224
CURRENT OCCUPANT	8872D N 95TH ST	MILWAUKEE, WI 53224
CURRENT OCCUPANT	8878A N 95TH ST	MILWAUKEE, WI 53224
CURRENT OCCUPANT	8865B N SWAN RD	MILWAUKEE, WI 53224
CURRENT OCCUPANT	9086F N 95TH ST	MILWAUKEE, WI 53224
CURRENT OCCUPANT	9021C N SWAN RD	MILWAUKEE, WI 53224
CURRENT OCCUPANT	9010L N 95TH ST	MILWAUKEE, WI 53224
CURRENT OCCUPANT	9001D N SWAN RD	MILWAUKEE, WI 53224
CURRENT OCCUPANT	9325H W ALLYN ST	MILWAUKEE, WI 53224
CURRENT OCCUPANT	8878G N 95TH ST	MILWAUKEE, WI 53224
CURRENT OCCUPANT	9076D N 95TH ST	MILWAUKEE, WI 53224
CURRENT OCCUPANT	8901B N SWAN RD	MILWAUKEE, WI 53224
CURRENT OCCUPANT	8848C N 95TH ST	MILWAUKEE, WI 53224
CURRENT OCCUPANT	9031D N SWAN RD	MILWAUKEE, WI 53224
CURRENT OCCUPANT	8941G N SWAN RD	MILWAUKEE, WI 53224
CURRENT OCCUPANT	8877D N SWAN RD	MILWAUKEE, WI 53224
CURRENT OCCUPANT	9097H N 95TH ST	MILWAUKEE, WI 53224
CURRENT OCCUPANT	8836A N 95TH ST	MILWAUKEE, WI 53224
CURRENT OCCUPANT	8910A N 95TH ST	MILWAUKEE, WI 53224
CURRENT OCCUPANT	9086K N 95TH ST	MILWAUKEE, WI 53224
CURRENT OCCUPANT	8941E N SWAN RD	MILWAUKEE, WI 53224
CURRENT OCCUPANT	8883A N SWAN RD	MILWAUKEE, WI 53224
CURRENT OCCUPANT	9221L W ALLYN ST	MILWAUKEE, WI 53224
CURRENT OCCUPANT	8848B N 95TH ST	MILWAUKEE, WI 53224
CURRENT OCCUPANT	8911C N 95TH ST	MILWAUKEE, WI 53224
CURRENT OCCUPANT	8884B N 95TH ST	MILWAUKEE, WI 53224
CURRENT OCCUPANT	8901H N SWAN RD	MILWAUKEE, WI 53224
CURRENT OCCUPANT	8884C N 95TH ST	MILWAUKEE, WI 53224
CURRENT OCCUPANT	8911H N SWAN RD	MILWAUKEE, WI 53224

CURRENT OCCUPANT	8836D N 95TH ST	MILWAUKEE, WI 53224
CURRENT OCCUPANT	8859H N SWAN RD	MILWAUKEE, WI 53224
CURRENT OCCUPANT	9031F N 95TH ST	MILWAUKEE, WI 53224
CURRENT OCCUPANT	8910B N 95TH ST	MILWAUKEE, WI 53224
CURRENT OCCUPANT	8910G N 95TH ST	MILWAUKEE, WI 53224
CURRENT OCCUPANT	9261B W ALLYN ST	MILWAUKEE, WI 53224
CURRENT OCCUPANT	8878E N 95TH ST	MILWAUKEE, WI 53224
CURRENT OCCUPANT	8911D N SWAN RD	MILWAUKEE, WI 53224
CURRENT OCCUPANT	8860D N 95TH ST	MILWAUKEE, WI 53224
CURRENT OCCUPANT	8931G N SWAN RD	MILWAUKEE, WI 53224
CURRENT OCCUPANT	9011C N 95TH ST	MILWAUKEE, WI 53224
CURRENT OCCUPANT	9070H N 95TH ST	MILWAUKEE, WI 53224
CURRENT OCCUPANT	9001F N SWAN RD	MILWAUKEE, WI 53224
CURRENT OCCUPANT	8941A N SWAN RD	MILWAUKEE, WI 53224
CURRENT OCCUPANT	9071C N 95TH ST	MILWAUKEE, WI 53224
CURRENT OCCUPANT	8842K N 95TH ST	MILWAUKEE, WI 53224
CURRENT OCCUPANT	9071D N 95TH ST	MILWAUKEE, WI 53224
CURRENT OCCUPANT	8854J N 95TH ST	MILWAUKEE, WI 53224
CURRENT OCCUPANT	8853C N SWAN RD	MILWAUKEE, WI 53224
CURRENT OCCUPANT	9010C N 95TH ST	MILWAUKEE, WI 53224
CURRENT OCCUPANT	9281E W ALLYN ST	MILWAUKEE, WI 53224
CURRENT OCCUPANT	8847C N SWAN RD	MILWAUKEE, WI 53224
CURRENT OCCUPANT	9125B W ALLYN ST	MILWAUKEE, WI 53224
CURRENT OCCUPANT	9060H N 95TH ST	MILWAUKEE, WI 53224
CURRENT OCCUPANT	8827A N 95TH ST	MILWAUKEE, WI 53224
CURRENT OCCUPANT	8877B N SWAN RD	MILWAUKEE, WI 53224
CURRENT OCCUPANT	9031B N SWAN RD	MILWAUKEE, WI 53224
CURRENT OCCUPANT	9125F W ALLYN ST	MILWAUKEE, WI 53224
CURRENT OCCUPANT	9261A W ALLYN ST	MILWAUKEE, WI 53224
CURRENT OCCUPANT	9086B N 95TH ST	MILWAUKEE, WI 53224
CURRENT OCCUPANT	8970B N 95TH ST	MILWAUKEE, WI 53224
CURRENT OCCUPANT	8871H N SWAN RD	MILWAUKEE, WI 53224
CURRENT OCCUPANT	8872B N 95TH ST	MILWAUKEE, WI 53224
CURRENT OCCUPANT	8860F N 95TH ST	MILWAUKEE, WI 53224
CURRENT OCCUPANT	9010K N 95TH ST	MILWAUKEE, WI 53224
CURRENT OCCUPANT	9021K N SWAN RD	MILWAUKEE, WI 53224
CURRENT OCCUPANT	8911E N SWAN RD	MILWAUKEE, WI 53224
CURRENT OCCUPANT	9010H N 95TH ST	MILWAUKEE, WI 53224
CURRENT OCCUPANT	8889B N SWAN RD	MILWAUKEE, WI 53224
CURRENT OCCUPANT	9061E N 95TH ST	MILWAUKEE, WI 53224
CURRENT OCCUPANT	9325D W ALLYN ST	MILWAUKEE, WI 53224
CURRENT OCCUPANT	9097E N 95TH ST	MILWAUKEE, WI 53224
CURRENT OCCUPANT	9221C W ALLYN ST	MILWAUKEE, WI 53224
CURRENT OCCUPANT	8911F N 95TH ST	MILWAUKEE, WI 53224
CURRENT OCCUPANT	8842F N 95TH ST	MILWAUKEE, WI 53224
CURRENT OCCUPANT	8877E N SWAN RD	MILWAUKEE, WI 53224
CURRENT OCCUPANT	9241H W ALLYN ST	MILWAUKEE, WI 53224

CURRENT OCCUPANT	8827F N 95TH ST	MILWAUKEE, WI 53224
CURRENT OCCUPANT	8950D N 95TH ST	MILWAUKEE, WI 53224
CURRENT OCCUPANT	8930B N 95TH ST	MILWAUKEE, WI 53224
CURRENT OCCUPANT	9096B N 95TH ST	MILWAUKEE, WI 53224
CURRENT OCCUPANT	8931E N SWAN RD	MILWAUKEE, WI 53224
CURRENT OCCUPANT	8895A N SWAN RD	MILWAUKEE, WI 53224
CURRENT OCCUPANT	9020C N 95TH ST	MILWAUKEE, WI 53224
CURRENT OCCUPANT	9030H N 95TH ST	MILWAUKEE, WI 53224
CURRENT OCCUPANT	9125G W ALLYN ST	MILWAUKEE, WI 53224
CURRENT OCCUPANT	9031A N SWAN RD	MILWAUKEE, WI 53224
CURRENT OCCUPANT	9096D N 95TH ST	MILWAUKEE, WI 53224
CURRENT OCCUPANT	9050B N 95TH ST	MILWAUKEE, WI 53224
CURRENT OCCUPANT	8950E N 95TH ST	MILWAUKEE, WI 53224
CURRENT OCCUPANT	8883J N SWAN RD	MILWAUKEE, WI 53224
CURRENT OCCUPANT	8842J N 95TH ST	MILWAUKEE, WI 53224
CURRENT OCCUPANT	8827G N 95TH ST	MILWAUKEE, WI 53224
CURRENT OCCUPANT	9051F N 95TH ST	MILWAUKEE, WI 53224
CURRENT OCCUPANT	8884E N 95TH ST	MILWAUKEE, WI 53224
CURRENT OCCUPANT	9086D N 95TH ST	MILWAUKEE, WI 53224
CURRENT OCCUPANT	9050D N 95TH ST	MILWAUKEE, WI 53224
CURRENT OCCUPANT	8970H N 95TH ST	MILWAUKEE, WI 53224
CURRENT OCCUPANT	9001K N SWAN RD	MILWAUKEE, WI 53224
CURRENT OCCUPANT	8930G N 95TH ST	MILWAUKEE, WI 53224
CURRENT OCCUPANT	8950B N 95TH ST	MILWAUKEE, WI 53224
CURRENT OCCUPANT	9061M N 95TH ST	MILWAUKEE, WI 53224
CURRENT OCCUPANT	8911E N 95TH ST	MILWAUKEE, WI 53224
CURRENT OCCUPANT	8866J N 95TH ST	MILWAUKEE, WI 53224
CURRENT OCCUPANT	9325K W ALLYN ST	MILWAUKEE, WI 53224
CURRENT OCCUPANT	9241A W ALLYN ST	MILWAUKEE, WI 53224
CURRENT OCCUPANT	9261K W ALLYN ST	MILWAUKEE, WI 53224
CURRENT OCCUPANT	9096F N 95TH ST	MILWAUKEE, WI 53224
CURRENT OCCUPANT	8867F N 95TH ST	MILWAUKEE, WI 53224
CURRENT OCCUPANT	8865D N SWAN RD	MILWAUKEE, WI 53224
CURRENT OCCUPANT	9061H N 95TH ST	MILWAUKEE, WI 53224
CURRENT OCCUPANT	8866H N 95TH ST	MILWAUKEE, WI 53224
CURRENT OCCUPANT	9050F N 95TH ST	MILWAUKEE, WI 53224
CURRENT OCCUPANT	9221J W ALLYN ST	MILWAUKEE, WI 53224
CURRENT OCCUPANT	9076E N 95TH ST	MILWAUKEE, WI 53224
CURRENT OCCUPANT	8848J N 95TH ST	MILWAUKEE, WI 53224
CURRENT OCCUPANT	9060K N 95TH ST	MILWAUKEE, WI 53224
CURRENT OCCUPANT	8877K N SWAN RD	MILWAUKEE, WI 53224
CURRENT OCCUPANT	8990G N 95TH ST	MILWAUKEE, WI 53224
CURRENT OCCUPANT	8895H N SWAN RD	MILWAUKEE, WI 53224
CURRENT OCCUPANT	8931B N SWAN RD	MILWAUKEE, WI 53224
CURRENT OCCUPANT	9061A N 95TH ST	MILWAUKEE, WI 53224
CURRENT OCCUPANT	8827B N 95TH ST	MILWAUKEE, WI 53224
CURRENT OCCUPANT	8842A N 95TH ST	MILWAUKEE, WI 53224



CURRENT OCCUPANT	8835 N SWAN RD 6	MILWAUKEE, WI 53224
CURRENT OCCUPANT	8835 N SWAN RD 4	MILWAUKEE, WI 53224
CURRENT OCCUPANT	8835 N SWAN RD 9	MILWAUKEE, WI 53224
CURRENT OCCUPANT	8884D N 95TH ST	MILWAUKEE, WI 53224
CURRENT OCCUPANT	9221K W ALLYN ST	MILWAUKEE, WI 53224
CURRENT OCCUPANT	9060C N 95TH ST	MILWAUKEE, WI 53224
CURRENT OCCUPANT	9071A N 95TH ST	MILWAUKEE, WI 53224
CURRENT OCCUPANT	8847F N SWAN RD	MILWAUKEE, WI 53224
CURRENT OCCUPANT	8889C N SWAN RD	MILWAUKEE, WI 53224
CURRENT OCCUPANT	9241D W ALLYN ST	MILWAUKEE, WI 53224
CURRENT OCCUPANT	8841C N SWAN RD	MILWAUKEE, WI 53224
CURRENT OCCUPANT	9011B N 95TH ST	MILWAUKEE, WI 53224
CURRENT OCCUPANT	8866G N 95TH ST	MILWAUKEE, WI 53224
CURRENT OCCUPANT	8951A N 95TH ST	MILWAUKEE, WI 53224
CURRENT OCCUPANT	8866C N 95TH ST	MILWAUKEE, WI 53224
CURRENT OCCUPANT	8841E N SWAN RD	MILWAUKEE, WI 53224
CURRENT OCCUPANT	8848K N 95TH ST	MILWAUKEE, WI 53224
CURRENT OCCUPANT	8889H N SWAN RD	MILWAUKEE, WI 53224
CURRENT OCCUPANT	8941H N SWAN RD	MILWAUKEE, WI 53224
CURRENT OCCUPANT	9125H W ALLYN ST	MILWAUKEE, WI 53224
CURRENT OCCUPANT	8930E N 95TH ST	MILWAUKEE, WI 53224
CURRENT OCCUPANT	8901G N SWAN RD	MILWAUKEE, WI 53224
CURRENT OCCUPANT	9096K N 95TH ST	MILWAUKEE, WI 53224
CURRENT OCCUPANT	8911G N 95TH ST	MILWAUKEE, WI 53224
CURRENT OCCUPANT	8871J N SWAN RD	MILWAUKEE, WI 53224
CURRENT OCCUPANT	8872K N 95TH ST	MILWAUKEE, WI 53224
CURRENT OCCUPANT	9261E W ALLYN ST	MILWAUKEE, WI 53224
CURRENT OCCUPANT	8910F N 95TH ST	MILWAUKEE, WI 53224
CURRENT OCCUPANT	8930H N 95TH ST	MILWAUKEE, WI 53224
CURRENT OCCUPANT	9021J N SWAN RD	MILWAUKEE, WI 53224
CURRENT OCCUPANT	8911F N SWAN RD	MILWAUKEE, WI 53224
CURRENT OCCUPANT	9050E N 95TH ST	MILWAUKEE, WI 53224
CURRENT OCCUPANT	8941K N SWAN RD	MILWAUKEE, WI 53224
CURRENT OCCUPANT	9325A W ALLYN ST	MILWAUKEE, WI 53224
CURRENT OCCUPANT	8921J N SWAN RD	MILWAUKEE, WI 53224
CURRENT OCCUPANT	8990A N 95TH ST	MILWAUKEE, WI 53224
CURRENT OCCUPANT	8921C N SWAN RD	MILWAUKEE, WI 53224
CURRENT OCCUPANT	8895B N SWAN RD	MILWAUKEE, WI 53224
CURRENT OCCUPANT	8951D N 95TH ST	MILWAUKEE, WI 53224
CURRENT OCCUPANT	9030B N 95TH ST	MILWAUKEE, WI 53224
CURRENT OCCUPANT	8860B N 95TH ST	MILWAUKEE, WI 53224
CURRENT OCCUPANT	9281B W ALLYN ST	MILWAUKEE, WI 53224
CURRENT OCCUPANT	8951J N 95TH ST	MILWAUKEE, WI 53224
CURRENT OCCUPANT	8841A N SWAN RD	MILWAUKEE, WI 53224
CURRENT OCCUPANT	8970F N 95TH ST	MILWAUKEE, WI 53224
CURRENT OCCUPANT	8860H N 95TH ST	MILWAUKEE, WI 53224
CURRENT OCCUPANT	8910J N 95TH ST	MILWAUKEE, WI 53224

CURRENT OCCUPANT	8921D N SWAN RD	MILWAUKEE, WI 53224
CURRENT OCCUPANT	9061J N 95TH ST	MILWAUKEE, WI 53224
CURRENT OCCUPANT	9040A N 95TH ST	MILWAUKEE, WI 53224
CURRENT OCCUPANT	8941F N SWAN RD	MILWAUKEE, WI 53224
CURRENT OCCUPANT	8872J N 95TH ST	MILWAUKEE, WI 53224
CURRENT OCCUPANT	8921A N SWAN RD	MILWAUKEE, WI 53224
CURRENT OCCUPANT	8872A N 95TH ST	MILWAUKEE, WI 53224
CURRENT OCCUPANT	9261H W ALLYN ST	MILWAUKEE, WI 53224
CURRENT OCCUPANT	9031A N 95TH ST	MILWAUKEE, WI 53224
CURRENT OCCUPANT	9001A N SWAN RD	MILWAUKEE, WI 53224
CURRENT OCCUPANT	8950A N 95TH ST	MILWAUKEE, WI 53224
CURRENT OCCUPANT	8895C N SWAN RD	MILWAUKEE, WI 53224
CURRENT OCCUPANT	9097C N 95TH ST	MILWAUKEE, WI 53224
CURRENT OCCUPANT	8865H N SWAN RD	MILWAUKEE, WI 53224
CURRENT OCCUPANT	9097B N 95TH ST	MILWAUKEE, WI 53224
CURRENT OCCUPANT	8836F N 95TH ST	MILWAUKEE, WI 53224
CURRENT OCCUPANT	8853G N SWAN RD	MILWAUKEE, WI 53224
CURRENT OCCUPANT	8950F N 95TH ST	MILWAUKEE, WI 53224
CURRENT OCCUPANT	8847A N SWAN RD	MILWAUKEE, WI 53224
CURRENT OCCUPANT	9020G N 95TH ST	MILWAUKEE, WI 53224
CURRENT OCCUPANT	8931D N SWAN RD	MILWAUKEE, WI 53224
CURRENT OCCUPANT	8835 N SWAN RD 10	MILWAUKEE, WI 53224
CURRENT OCCUPANT	8835 N SWAN RD 11	MILWAUKEE, WI 53224
CURRENT OCCUPANT	8835 N SWAN RD 12	MILWAUKEE, WI 53224
CURRENT OCCUPANT	8990F N 95TH ST	MILWAUKEE, WI 53224
CURRENT OCCUPANT	9051C N 95TH ST	MILWAUKEE, WI 53224
CURRENT OCCUPANT	8878C N 95TH ST	MILWAUKEE, WI 53224
CURRENT OCCUPANT	9011G N SWAN RD	MILWAUKEE, WI 53224
CURRENT OCCUPANT	9011F N 95TH ST	MILWAUKEE, WI 53224
CURRENT OCCUPANT	8842D N 95TH ST	MILWAUKEE, WI 53224
CURRENT OCCUPANT	9040K N 95TH ST	MILWAUKEE, WI 53224
CURRENT OCCUPANT	8951G N 95TH ST	MILWAUKEE, WI 53224
CURRENT OCCUPANT	8951F N 95TH ST	MILWAUKEE, WI 53224
CURRENT OCCUPANT	8901J N SWAN RD	MILWAUKEE, WI 53224
CURRENT OCCUPANT	8853D N SWAN RD	MILWAUKEE, WI 53224
CURRENT OCCUPANT	9030K N 95TH ST	MILWAUKEE, WI 53224
CURRENT OCCUPANT	8883K N SWAN RD	MILWAUKEE, WI 53224
CURRENT OCCUPANT	8931A N SWAN RD	MILWAUKEE, WI 53224
CURRENT OCCUPANT	9021G N SWAN RD	MILWAUKEE, WI 53224
CURRENT OCCUPANT	8895D N SWAN RD	MILWAUKEE, WI 53224
CURRENT OCCUPANT	8889A N SWAN RD	MILWAUKEE, WI 53224
CURRENT OCCUPANT	9030D N 95TH ST	MILWAUKEE, WI 53224
CURRENT OCCUPANT	8866K N 95TH ST	MILWAUKEE, WI 53224
CURRENT OCCUPANT	9071J N 95TH ST	MILWAUKEE, WI 53224
CURRENT OCCUPANT	9001E N SWAN RD	MILWAUKEE, WI 53224
CURRENT OCCUPANT	9281H W ALLYN ST	MILWAUKEE, WI 53224
CURRENT OCCUPANT	9001G N SWAN RD	MILWAUKEE, WI 53224

CURRENT OCCUPANT	8970G N 95TH ST	MILWAUKEE, WI 53224
CURRENT OCCUPANT	9261J W ALLYN ST	MILWAUKEE, WI 53224
CURRENT OCCUPANT	9040H N 95TH ST	MILWAUKEE, WI 53224
CURRENT OCCUPANT	9031C N 95TH ST	MILWAUKEE, WI 53224
CURRENT OCCUPANT	9061K N 95TH ST	MILWAUKEE, WI 53224
CURRENT OCCUPANT	8859K N SWAN RD	MILWAUKEE, WI 53224
CURRENT OCCUPANT	9040D N 95TH ST	MILWAUKEE, WI 53224
CURRENT OCCUPANT	9011F N SWAN RD	MILWAUKEE, WI 53224
CURRENT OCCUPANT	9040C N 95TH ST	MILWAUKEE, WI 53224
CURRENT OCCUPANT	8950G N 95TH ST	MILWAUKEE, WI 53224
CURRENT OCCUPANT	9051B N 95TH ST	MILWAUKEE, WI 53224
CURRENT OCCUPANT	9020D N 95TH ST	MILWAUKEE, WI 53224
CURRENT OCCUPANT	9001B N SWAN RD	MILWAUKEE, WI 53224
CURRENT OCCUPANT	9325J W ALLYN ST	MILWAUKEE, WI 53224
CURRENT OCCUPANT	8970C N 95TH ST	MILWAUKEE, WI 53224
CURRENT OCCUPANT	9325B W ALLYN ST	MILWAUKEE, WI 53224
CURRENT OCCUPANT	9125D W ALLYN ST	MILWAUKEE, WI 53224
CURRENT OCCUPANT	8853H N SWAN RD	MILWAUKEE, WI 53224
CURRENT OCCUPANT	9221B W ALLYN ST	MILWAUKEE, WI 53224
CURRENT OCCUPANT	9031B N 95TH ST	MILWAUKEE, WI 53224
CURRENT OCCUPANT	8854C N 95TH ST	MILWAUKEE, WI 53224
CURRENT OCCUPANT	8871D N SWAN RD	MILWAUKEE, WI 53224
CURRENT OCCUPANT	8848F N 95TH ST	MILWAUKEE, WI 53224
CURRENT OCCUPANT	9030A N 95TH ST	MILWAUKEE, WI 53224
CURRENT OCCUPANT	8859E N SWAN RD	MILWAUKEE, WI 53224
CURRENT OCCUPANT	8931C N SWAN RD	MILWAUKEE, WI 53224
CURRENT OCCUPANT	8990H N 95TH ST	MILWAUKEE, WI 53224
CURRENT OCCUPANT	9086H N 95TH ST	MILWAUKEE, WI 53224
CURRENT OCCUPANT	8872G N 95TH ST	MILWAUKEE, WI 53224
CURRENT OCCUPANT	8911C N SWAN RD	MILWAUKEE, WI 53224
CURRENT OCCUPANT	9011D N SWAN RD	MILWAUKEE, WI 53224
CURRENT OCCUPANT	9060F N 95TH ST	MILWAUKEE, WI 53224
CURRENT OCCUPANT	8865G N SWAN RD	MILWAUKEE, WI 53224
CURRENT OCCUPANT	9097G N 95TH ST	MILWAUKEE, WI 53224
CURRENT OCCUPANT	8867E N 95TH ST	MILWAUKEE, WI 53224
CURRENT OCCUPANT	9051E N 95TH ST	MILWAUKEE, WI 53224
CURRENT OCCUPANT	9050G N 95TH ST	MILWAUKEE, WI 53224
CURRENT OCCUPANT	8867A N 95TH ST	MILWAUKEE, WI 53224
CURRENT OCCUPANT	9040E N 95TH ST	MILWAUKEE, WI 53224
CURRENT OCCUPANT	9050K N 95TH ST	MILWAUKEE, WI 53224
CURRENT OCCUPANT	9001M N SWAN RD	MILWAUKEE, WI 53224
CURRENT OCCUPANT	9261D W ALLYN ST	MILWAUKEE, WI 53224
CURRENT OCCUPANT	9051A N 95TH ST	MILWAUKEE, WI 53224
CURRENT OCCUPANT	9040G N 95TH ST	MILWAUKEE, WI 53224
CURRENT OCCUPANT	8842C N 95TH ST	MILWAUKEE, WI 53224
CURRENT OCCUPANT	8867J N 95TH ST	MILWAUKEE, WI 53224
CURRENT OCCUPANT	9221D W ALLYN ST	MILWAUKEE, WI 53224

CURRENT OCCUPANT	8860C N 95TH ST	MILWAUKEE, WI 53224
CURRENT OCCUPANT	9241K W ALLYN ST	MILWAUKEE, WI 53224
CURRENT OCCUPANT	9031E N 95TH ST	MILWAUKEE, WI 53224
CURRENT OCCUPANT	9071M N 95TH ST	MILWAUKEE, WI 53224
CURRENT OCCUPANT	8867G N 95TH ST	MILWAUKEE, WI 53224
CURRENT OCCUPANT	8865A N SWAN RD	MILWAUKEE, WI 53224
CURRENT OCCUPANT	8950H N 95TH ST	MILWAUKEE, WI 53224
CURRENT OCCUPANT	8951H N 95TH ST	MILWAUKEE, WI 53224
CURRENT OCCUPANT	8921H N SWAN RD	MILWAUKEE, WI 53224
CURRENT OCCUPANT	9281D W ALLYN ST	MILWAUKEE, WI 53224
CURRENT OCCUPANT	8847H N SWAN RD	MILWAUKEE, WI 53224
CURRENT OCCUPANT	9031G N 95TH ST	MILWAUKEE, WI 53224
CURRENT OCCUPANT	8884G N 95TH ST	MILWAUKEE, WI 53224
CURRENT OCCUPANT	9030J N 95TH ST	MILWAUKEE, WI 53224
CURRENT OCCUPANT	9097D N 95TH ST	MILWAUKEE, WI 53224
CURRENT OCCUPANT	9086E N 95TH ST	MILWAUKEE, WI 53224
CURRENT OCCUPANT	8859G N SWAN RD	MILWAUKEE, WI 53224
CURRENT OCCUPANT	8901C N SWAN RD	MILWAUKEE, WI 53224
CURRENT OCCUPANT	8911B N 95TH ST	MILWAUKEE, WI 53224
CURRENT OCCUPANT	9011G N 95TH ST	MILWAUKEE, WI 53224
CURRENT OCCUPANT	9050C N 95TH ST	MILWAUKEE, WI 53224
CURRENT OCCUPANT	9261F W ALLYN ST	MILWAUKEE, WI 53224
CURRENT OCCUPANT	8867K N 95TH ST	MILWAUKEE, WI 53224
CURRENT OCCUPANT	9071G N 95TH ST	MILWAUKEE, WI 53224
CURRENT OCCUPANT	9031G N SWAN RD	MILWAUKEE, WI 53224
CURRENT OCCUPANT	9221M W ALLYN ST	MILWAUKEE, WI 53224
CURRENT OCCUPANT	8941B N SWAN RD	MILWAUKEE, WI 53224
CURRENT OCCUPANT	9031K N 95TH ST	MILWAUKEE, WI 53224
CURRENT OCCUPANT	8921F N SWAN RD	MILWAUKEE, WI 53224
CURRENT OCCUPANT	8867H N 95TH ST	MILWAUKEE, WI 53224
CURRENT OCCUPANT	9051H N 95TH ST	MILWAUKEE, WI 53224
CURRENT OCCUPANT	9020A N 95TH ST	MILWAUKEE, WI 53224
CURRENT OCCUPANT	8970K N 95TH ST	MILWAUKEE, WI 53224
CURRENT OCCUPANT	8860J N 95TH ST	MILWAUKEE, WI 53224
CURRENT OCCUPANT	9011E N SWAN RD	MILWAUKEE, WI 53224
CURRENT OCCUPANT	8842H N 95TH ST	MILWAUKEE, WI 53224
CURRENT OCCUPANT	9050H N 95TH ST	MILWAUKEE, WI 53224
CURRENT OCCUPANT	9031C N SWAN RD	MILWAUKEE, WI 53224
CURRENT OCCUPANT	8970E N 95TH ST	MILWAUKEE, WI 53224
CURRENT OCCUPANT	8911A N 95TH ST	MILWAUKEE, WI 53224
CURRENT OCCUPANT	9001H N SWAN RD	MILWAUKEE, WI 53224
CURRENT OCCUPANT	8901D N SWAN RD	MILWAUKEE, WI 53224
CURRENT OCCUPANT	9096C N 95TH ST	MILWAUKEE, WI 53224
CURRENT OCCUPANT	9125J W ALLYN ST	MILWAUKEE, WI 53224
CURRENT OCCUPANT	9011L N SWAN RD	MILWAUKEE, WI 53224
CURRENT OCCUPANT	8883G N SWAN RD	MILWAUKEE, WI 53224
CURRENT OCCUPANT	9030C N 95TH ST	MILWAUKEE, WI 53224

CURRENT OCCUPANT	8836C N 95TH ST	MILWAUKEE, WI 53224
CURRENT OCCUPANT	8859F N SWAN RD	MILWAUKEE, WI 53224
CURRENT OCCUPANT	9010E N 95TH ST	MILWAUKEE, WI 53224
CURRENT OCCUPANT	8883E N SWAN RD	MILWAUKEE, WI 53224
CURRENT OCCUPANT	9051G N 95TH ST	MILWAUKEE, WI 53224
CURRENT OCCUPANT	8842G N 95TH ST	MILWAUKEE, WI 53224
CURRENT OCCUPANT	9325C W ALLYN ST	MILWAUKEE, WI 53224
CURRENT OCCUPANT	8921B N SWAN RD	MILWAUKEE, WI 53224
CURRENT OCCUPANT	9011K N SWAN RD	MILWAUKEE, WI 53224
CURRENT OCCUPANT	9010F N 95TH ST	MILWAUKEE, WI 53224
CURRENT OCCUPANT	9221G W ALLYN ST	MILWAUKEE, WI 53224
CURRENT OCCUPANT	8848E N 95TH ST	MILWAUKEE, WI 53224
CURRENT OCCUPANT	9086J N 95TH ST	MILWAUKEE, WI 53224
CURRENT OCCUPANT	9030G N 95TH ST	MILWAUKEE, WI 53224
CURRENT OCCUPANT	9010J N 95TH ST	MILWAUKEE, WI 53224
CURRENT OCCUPANT	9097A N 95TH ST	MILWAUKEE, WI 53224
CURRENT OCCUPANT	8848A N 95TH ST	MILWAUKEE, WI 53224
CURRENT OCCUPANT	8895E N SWAN RD	MILWAUKEE, WI 53224
CURRENT OCCUPANT	9011C N SWAN RD	MILWAUKEE, WI 53224
CURRENT OCCUPANT	9076G N 95TH ST	MILWAUKEE, WI 53224
CURRENT OCCUPANT	9031F N SWAN RD	MILWAUKEE, WI 53224
CURRENT OCCUPANT	8884J N 95TH ST	MILWAUKEE, WI 53224
CURRENT OCCUPANT	9061G N 95TH ST	MILWAUKEE, WI 53224
CURRENT OCCUPANT	8835 N SWAN RD 3	MILWAUKEE, WI 53224
CURRENT OCCUPANT	8910C N 95TH ST	MILWAUKEE, WI 53224

Total Records: 588

Radius: 250.0 feet and Center of Circle: 9026 W Brown Deer Rd



# BUSINESS LICENSE PLAN OF OPERATION

ccl-busplan 3/15/18

Office of the City Clerk License Division  
200 E. Wells St. Room 105, Milwaukee, WI 53202  
(414) 286-2238 www.milwaukee.gov/license e-mail address: license@milwaukee.gov

## 1. Type of Business

Applying for:  Extended Hours (12AM to 5AM) - If a food establishment, check all that apply:  Delivery  Drive Thru  Dining Room  
 Self Service Laundry  Massage Establishment  Filling Station  
 Other (supplemental application for specific license also required)

Provide a detailed description of the type of business you plan on operating:

Gas Station

Do you have any experience operating this type of business?  No  Yes If yes, explain:

## 2. Business Operations

- a. Proposed Opening Date: March 15, 2019
- b. Is this premise under construction?  No  Yes If yes, list estimated completion date: \_\_\_\_\_
- c. Is this a franchise?  No  Yes
- d. Is this premises currently licensed?  No  Yes If yes, list type of license: \_\_\_\_\_
- e. Is the current licensee operating?  No  Yes If no, list date closed: \_\_\_\_\_
- f. Do you have future plans for other businesses, licenses or permits at this location?  No  Yes  
If yes, explain: \_\_\_\_\_
- g. Have you previously held an Extended Hours License in Milwaukee?  No  Yes  
If yes, list address(es): \_\_\_\_\_
- h. Are other businesses operating in the same building?  No  Yes If yes, describe: \_\_\_\_\_

## 3. Litter & Noise

- a. How are grounds kept clean?  Sweep  Pressure Wash  Pick Up Litter  Other: \_\_\_\_\_
- b. How often will grounds be cleaned?  Daily  Weekly  As Needed  Monthly  Other: \_\_\_\_\_
- c. Grounds cleaned by:  Licensee  Building Owner  Employees  Hired Maintenance  Other: \_\_\_\_\_
- d. How are noise issues prevented and/or addressed?  Security  Manager approaches customer(s)  Call Police  
 Signs Posted  Other: \_\_\_\_\_
- e. Will a sound amplification system be used?  No  Yes If yes, describe: \_\_\_\_\_

## 4. Smoking & Sanitation

- a. Are there designated outdoor smoking areas?  No  Yes If yes, describe: \_\_\_\_\_
- b. Number of Garbage Cans: Inside: 2 Locations: Coffee and Exit  
Outside: 2 Locations: Pumps
- c. Is a crowd control barrier used?  No  Yes If yes, describe: \_\_\_\_\_
- d. How many restrooms are on the premises? 1
- e. Name of solid waste contractor:  Advanced Disposal  Waste Management  Other: \_\_\_\_\_

## 5. Security

- a. Are there onsite parking spaces?  No  Yes If yes, how many? 4 and describe the parking security plan: Front security camera side of building
- b. Is there a loading zone?  No  Yes If yes, describe the loading area security plan: Loading zone is side off the building
- c. Will you have security personnel on premise?  No  Yes If yes, how many? \_\_\_\_\_ and answer the following:  
 What are their responsibilities? \_\_\_\_\_  
 Is security equipment used?  No  Yes If yes, describe Cameras  
 List their licensing, certification, or training credentials \_\_\_\_\_
- d. Will there be security cameras?  No  Yes If yes, how many? 5 and list locations: Front Door, Back Door, Cashier, Outside
- e. Will searches/identification checks be done upon entry?  No  Yes If yes, describe \_\_\_\_\_

## 6. Percentage of Sales (must total 100%)

Alcohol <u>0</u> %	Food <u>20.30</u> %	Secondhand Merchandise <u>0</u> %	Precious Metals & Gems _____ %
Entertainment <u>0</u> %	Cigarettes <u>50</u> %	Personal Services (such as tattoo, body piercing, salon, tailor, tanning, etc.) _____ %	Other <u>30</u> % Describe: <u>fuel</u>
Pawnbroker Activity _____ %	Salvaged Materials _____ % (such as scrap metal)		

## 7. Businesses/Licenses on the Premises (check all that apply):

### Type 1

- Full Service Restaurant     Cafe/Coffee Shop     Deli or Fast Food Restaurant     Private/Fraternal/Veterans Club
- Night Club     Tavern     Cocktail Lounge     Teen Club
- Banquet Hall     Sports Facility     Bowling Alley
- Hotel/Motel : Number of Floors: \_\_\_\_\_     Rooming House: Number of Floors: \_\_\_\_\_  
 Number of Rooms: \_\_\_\_\_    Number of Rooms: \_\_\_\_\_

### Type 2

- Liquor Store     Corner Store     Supermarket     Convenience Store
- Gas Station     Amusement/Phonograph Distributor     Recycling, Salvage or Towing
- Used Car Dealer     Personal Service Establishment  
(such as tattoo business, hair salon, tailor, etc.)     Recording Studio

What other licenses/permits will you hold at this location? (check all that apply)

- Occupancy Permit     Cigarette & Tobacco     Gas Station     Extended Hours     Class "B" Tavern     Weights & Measures
- Secondhand Dealer     Precious Metal & Gem     Other: \_\_\_\_\_

## 8. Legal Capacity (only if a Type 1 premises in #7 above)

Capacity \_\_\_\_\_ (Call the Milwaukee Development Center at 414-286-8211 if you have questions.)

## 9. Premises Description

- a. Identify all area(s) of the premises that will be used in operating this business (include areas used only for storage):  
 1<sup>st</sup> Floor  2<sup>nd</sup> Floor  Basement Storage  Patio  Beer Garden  Sidewalk Café  Deck  Rooftop  
 Other: Describe: \_\_\_\_\_
- b. Describe Location:  Major Thoroughfare  Secondary Street  Other: \_\_\_\_\_
- c. Nearest Major Cross Street: Brown Deer Rd
- d. Describe Building:  Free Standing Building  Strip Mall  Other: \_\_\_\_\_
- e. Describe Premises Structure:  Single Story  Multi-Story - # of Stories \_\_\_\_\_  Other: \_\_\_\_\_
- f. Describe Surrounding Area:  Commercial  Residential  Industrial  Other: \_\_\_\_\_
- g. Building Owner Name: Kalim Beg Phone Number: 414 531-2270  
 Business Owner Address: 9026 W Brown Deer Rd Milwaukee WI 53224

## 10. Hours of Operation & Customers

Will customers be entering the premises?  No  Yes

Day of the Week	Proposed Hours of Operation:		Estimated Number of Customers expected each day	Potential Age Range of Customers	Class B Tavern Applicant Only: Age Restriction (If none, write 'None')
	Open Time (include a.m. or p.m.)	Close Time (include a.m. or p.m.)			
Sunday	24 hrs	100 →			
Monday	24 hrs	100 →			
Tuesday	24 hrs	100 →			
Wednesday	24 hrs	100 →			
Thursday	24 hrs	100 →			
Friday	24 hrs	100 →			
Saturday	24 hrs	100 →			

An Extended Hours Establishment License is required for any convenience store, filling station, personal service establishment (such as tattoo, body piercing, salon, tailor, tanning, etc.), recording studio or restaurant which is open between the hours of 12:00 a.m. and 5:00 a.m.

Alcohol Establishments Class A: 8:00 am to 9:00 pm Sunday thru Saturday  
 Permitted Hours of Operation: Class B: 6:00 am to 2:00 am Sunday thru Thursday, 6:00 am to 2:30 am Friday & Saturday

Entertainment Outdoor Closing Hours: 10:00pm Sunday-Thursday; 12:00am Friday & Saturday; unless a different time, either earlier or later, is established by the Common Council in its approval of the licensee's plan of operation.

## 11. Signature(s)

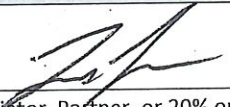
  
 Signature of Sole Proprietor, Partner, or 20% or more Shareholder  
 (If there are no 20% or more shareholders,  
 Corporate Officer-print name/title and sign)

\_\_\_\_\_  
 Signature of additional partner or 20% or more shareholder

See Application Information for a complete list of all required application forms.





# FOOD DEALER LICENSE PLAN OF OPERATION

ccl-foodplan 9/26/18

OFFICE OF THE CITY CLERK, LICENSE DIVISION  
CITY HALL, 200 E. WELLS ST, ROOM 105, MILWAUKEE, WI 53202  
(414) 286-2238 • [license@milwaukee.gov](mailto:license@milwaukee.gov) • [www.milwaukee.gov/license](http://www.milwaukee.gov/license)

Legal Entity Name: STFR Investment LLC

Premises Address: 9026 W Brown Deer rd Milwaukee WI 53224

## SECTION 1 TYPE OF BUSINESS

What will be the majority of your food sales? (check one)

Restaurant Items (meals):

MEALS include, but are not limited to, chicken, ribs, sandwiches, roasted corn, baked potatoes, hot dogs, brats, tacos, nachos w/ cheese and meat, French fries, cooked or deep fried vegetables/fruit, cooked cheese curds, corn dogs, egg rolls, salads.

Retail Items (snacks and beverages):

RETAIL items include, but are not limited to, ice cream/soft serve, lemonade, snow cones, coffee, espresso, cappuccino, tea, fruit juice, smoothies, candy, dispensed soda, fruit cups, bakery, cookies, kettle corn, cotton candy, funnel cakes, fritters, tortilla chips w/ cheese.

Will it be a convenience store?  Yes  No

A convenience store contains less than 5,000 square feet of retail space and has, as its primary business, the sale of basic food items and in addition, sells household products or is a filling station that sells basic food items and household products.

Bed & Breakfast

Micro Market

All Applicants: Submit a menu or a list of food items that will be sold.

Will any wholesale business be done?  No  Yes If yes, what percentage of food sales will be wholesale?

Less than 25%

25% or More AND:

Restaurant items (meals) will be sold – Complete this application and also contact DATCP.

NO restaurant items (meals) will be sold - Do NOT complete this application. Contact DATCP only.

## SECTION 2 FOOD PROCESSING

Will any food processing be done?  No  Yes

Processing is defined as assembling, grinding, cutting, mixing, baking, coating, stuffing, packing, bottling, grilling, canning, extracting, fermenting, distilling, pickling, freezing, drying, smoking, or packaging.

## SECTION 3 FOOD REQUIRING TEMPERATURE CONTROL

Will any food that requires temperature control be sold?  No  Yes  
(includes dairy products such as milk, cheese, and ice cream, fish, shellfish, meat, poultry)

If yes, list the types of food items: \_\_\_\_\_

**SECTION 5 DETAILS OF OPERATION**

Will you have seating on site for dining?  No  Yes  
 Will you be doing any catering?  No  Yes  
 Will you be doing any delivery?  No  Yes  
 Will you have outdoor activities?  No  Yes - Check all that apply:  Bar  Cooking/Grilling  Dining  
 Will you have a drive thru window?  No  Yes - Are hours different from inside?  No  Yes  
 If Yes, provide drive thru hours: \_\_\_\_\_  
 Will scales or barcode scanners be used?  No  Yes - You must also apply for a Weights & Measures License.

**SECTION 6 ADDITIONAL SITES**

Where will food be prepared and/or sold?  
 At a single site  At multiple sites: How many? \_\_\_\_\_ (for example, a hotel with several dining rooms or bars)  
 If multiple sites, attach a Food Dealer Additional Site Addendum (ccl-foodadd) for each additional site.

**SECTION 7 CONSTRUCTION OR CHANGES**

Are you planning any construction, remodeling or equipment changes?  
 No If No, SKIP to Section 8  
 Yes If Yes, check all that apply:  New construction of a building  Renovation or remodeling  
 Construction changes to existing building  Equipment changes only  
 Provide a brief description of the changes: \_\_\_\_\_  
 Start date: \_\_\_\_\_  
 Name, Address & Phone Number of Architect: \_\_\_\_\_  
 \_\_\_\_\_  
 Name, Address & Phone Number of Contractor: \_\_\_\_\_  
 \_\_\_\_\_

**SECTION 8 ALCOHOL BEVERAGES**

Are you applying for an alcohol beverage license?  
 No If No, SKIP to Section 9  
 Yes If YES, if your food license is approved prior to the alcohol license, when do you want the food license issued?  
 Immediately  At the same time as the alcohol license

**SECTION 9 ACKNOWLEDGEMENTS & SIGNATURE**

You must initial each item confirming your understanding:  
  J.J.   I understand the Health Department must conduct an inspection and advise the License Division of their approval before the license may be issued.  
  J.J.   I understand I must obtain an occupancy permit from the Department of Neighborhood Services and an inspection may be required. Neighborhood Services must advise the License Division of their approval before the license may be issued.  
  J.J.   I understand the district alderperson will review and either support or object to my application. If he/she objects, I may appeal and be scheduled to appear before the Licenses Committee. The Licenses Committee will then make a recommendation to the Common Council. The Common Council must grant the license before it may be issued.  
  J.J.   I understand proof of payment for all license fees must be on file in the License Division before the license may be issued and the license must be issued and posted in my establishment prior to opening for business.  
  J.J.   I will not operate my food business until the license has been issued and posted in the establishment.

Signature of Sole Proprietor, Partner, or 20% Shareholder: 100% J.J.  
 Signature of Additional Partner: \_\_\_\_\_



# WEIGHTS & MEASURES PLAN OF OPERATION

ccl-wmpln 1/9/18

Office of the City Clerk License Division  
200 E. Wells St. Room 105, Milwaukee, WI 53202  
(414) 286-2238 [www.milwaukee.gov/license](http://www.milwaukee.gov/license) [license@milwaukee.gov](mailto:license@milwaukee.gov)

Legal Entity Name: STER Investment LLC

Premise Address: 9026 W Brown Deer Rd Milwaukee WI 53224

## Type of Business

Provide a brief description of the establishment/business:

Gas Station, Convenience Store

*Other licenses may be required depending on the type of business you are operating.*

## Litter & Noise

- a. How are grounds kept clean?  Sweep  Pressure Wash  Pick Up Litter  Other: \_\_\_\_\_
- b. How often will grounds be cleaned?  Daily  Weekly  As Needed  Monthly  Other: \_\_\_\_\_
- c. Grounds cleaned by:  Licensee  Building Owner  Employees  Hired Maintenance  Other: \_\_\_\_\_
- d. How are noise issues prevented and/or addressed?  Security  Manager approaches customer(s)  Call Police  
 Signs Posted  Other: \_\_\_\_\_

## Signature

Signature of Sole Proprietor, Partner, or 20% or more Shareholder  
(If there are no 20% or more shareholders,  
Corporate Officer-print name/title and sign)

Signature of additional partner or 20% or more shareholder

*This form must be submitted with the Business License Application, Weights & Measures License Supplemental Application, and appropriate fee. Forms can be obtained online at [www.milwaukee.gov/licenses](http://www.milwaukee.gov/licenses).*

2-26-2014

B-P for Gas, station

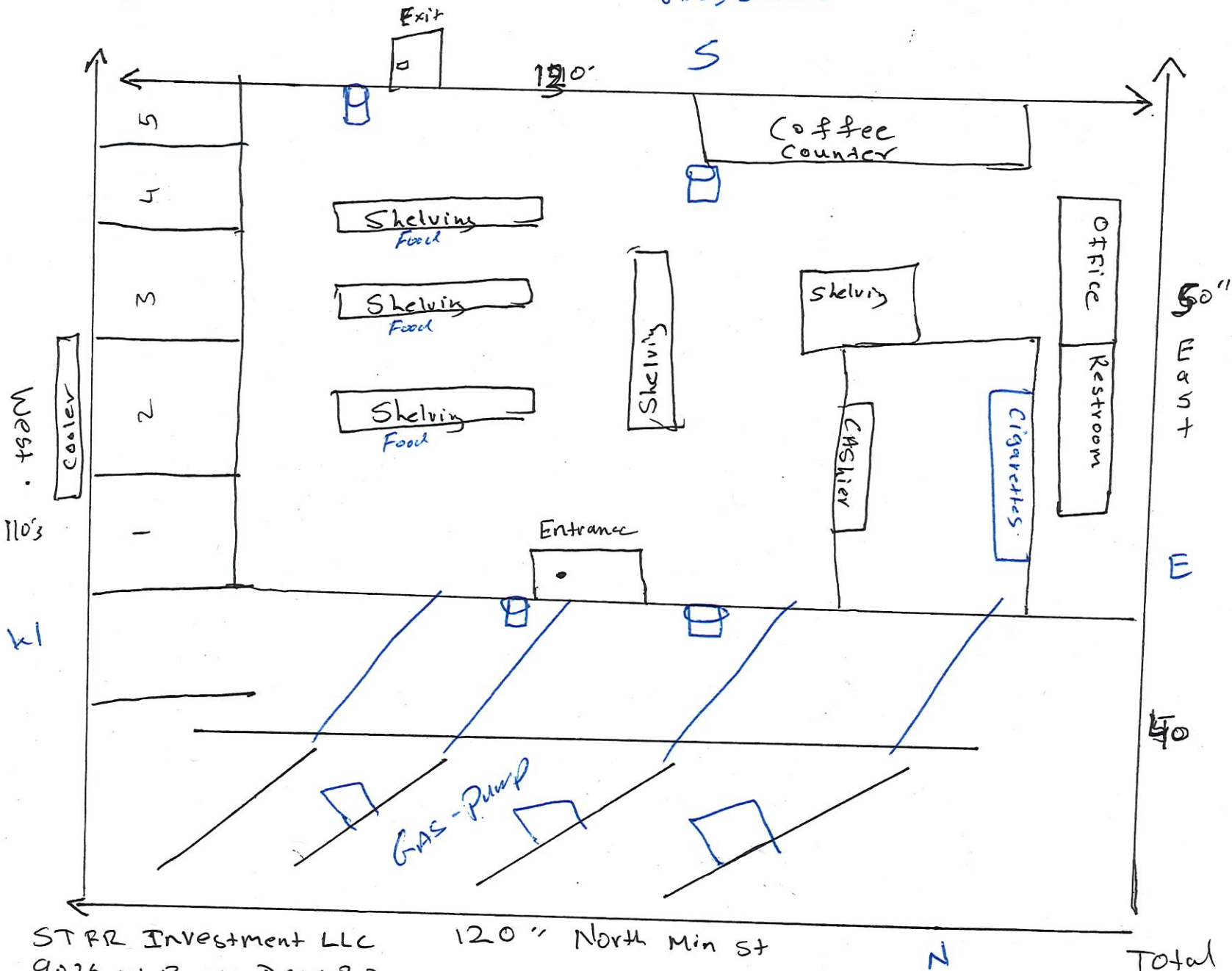

→ Brown Deer Rd

STRR Investment LLC  
9026 W Brown Deer R.D.  
Milwaukee WI 53224

Total  
Square  
Footage = 570



**CITY OF MILWAUKEE  
OFFICE OF THE CITY CLERK**

Monday, March 25, 2019

**COMMITTEE MEETING NOTICE**

AD 09

OLADOKUN, Orobola O, Agent  
Queen Bee Motors, Inc  
9310 N 107TH St #CU1  
Milwaukee, WI 53224

You are requested to attend a hearing which is to be held in Room 301-B, Third Floor, City Hall on:

**Wednesday, April 03, 2019 at 01:30 PM**

**Regarding:** Your Secondhand Motor Vehicle Dealer's - Wholesale Only License Application as agent for "Queen Bee Motors, Inc" for "Queen Bee Motors, Inc" at 9310 N 107TH St #CU1.

There is a possibility that your application may be denied  one or more of the following reasons: Neighborhood Objections to the granting of such a license due to the creation of undesirable neighborhood problems, such as: parking and traffic problems which cause the normal flow of traffic on roadways and alleys to be impeded, loitering, littering, noise, loud music, and conduct which will have an adverse impact on the public health, safety and welfare of the community. Additionally, the over concentration of secondhand motor vehicle dealers in the neighborhood such that the concentration will have an adverse impact on the public health, safety and welfare of the neighborhood. you do not meet the statutory and municipal requirements; the appropriateness of the location to be licensed and whether the location will create undesirable neighborhood problems, whether or not you have been charged with or convicted of any felony, misdemeanor, municipal offense or other offense, the circumstances of which substantially relate to the licensed activity; and any other factors which reasonably relate to the public health, safety and welfare. See attached police report and/or written correspondence regarding this application. Please be advised the public will be able to provide information to the committee in person or in writing. The committee will receive and consider evidence regarding the above mentioned criteria.

**Notice for applicants with warrants or unpaid fines:**

Proof of warrant satisfaction or payment of fines must be submitted at the hearing on the above date and time. Failure to comply with this requirement may result in a delay of the granting/denial of your application.

Failure to appear at this meeting may result in the denial of your license. Individual applicants must appear only in person or by an attorney. Corporate or Limited Liability applicants must appear only by the agent designated on the application or by an attorney. Partnership applicants must appear by a partner listed on the application or by an attorney. If you wish to do so and at your own expense, you may be accompanied by an attorney of your choosing to represent you at this hearing.

You will be given an opportunity to speak on behalf of the application and to respond and challenge any charges or reasons given for the denial. No petitions can be accepted by the committee, unless the people who signed the petition are present at the committee hearing and willing to testify. You may present witnesses under oath and you may also confront and cross-examine opposing witnesses under oath. If you have difficulty with the English language, you should bring an interpreter with you, at your expense, so that you can answer questions and participate in your hearing.

You may examine the application file at this office during regular business hours prior to the hearing date. Inquiries regarding this matter may be directed to the person whose signature appears below.

Limited parking for persons attending meetings in City Hall is available at reduced rates (5 hour limit) at the Milwaukee Center on the southwest corner of East Kilbourn and North Water Street. Parking tickets must be validated in the first floor information booth in City Hall.

PLEASE NOTE: Upon reasonable notice, efforts will be made to accommodate the needs of disabled individuals through sign language interpreters or other auxiliary aids. For additional information or to request this service, contact the Council Services Division ADA Coordinator at (414) 286-2998, Fax - (414) 286-3456, TDD - (414) 286-2025.

JIM OWZARSKI, CITY CLERK

BY: \_\_\_\_\_

Jessica Celella  
License Division Manager

**If you have questions regarding this notice, please contact the License Division at (414) 286-2238.**



CITY OF MILWAUKEE  
OFFICE OF THE CITY CLERK

Monday, March 25, 2019

COMMITTEE MEETING NOTICE

AD 09

OLADOKUN, Orobola O, Agent  
Queen Bee Motors, Inc  
6527 N 55<sup>th</sup> St  
Milwaukee, WI 53223

You are requested to attend a hearing which is to be held in Room 301-B, Third Floor, City Hall on:

**Wednesday, April 03, 2019 at 01:30 PM**

**Regarding:** Your Secondhand Motor Vehicle Dealer's - Wholesale Only License Application as agent for "Queen Bee Motors, Inc" for "Queen Bee Motors, Inc" at 9310 N 107TH St #CU1.

There is a possibility that your application may be denied for one or more of the following reasons: Neighborhood Objections to the granting of such a license due to the creation of undesirable neighborhood problems, such as: parking and traffic problems which cause the normal flow of traffic on roadways and alleys to be impeded, loitering, littering, noise, loud music, and conduct which will have an adverse impact on the public health, safety and welfare of the community. Additionally, the over concentration of secondhand motor vehicle dealers in the neighborhood such that the concentration will have an adverse impact on the public health, safety and welfare of the neighborhood. you do not meet the statutory and municipal requirements; the appropriateness of the location to be licensed and whether the location will create undesirable neighborhood problems, whether or not you have been charged with or convicted of any felony, misdemeanor, municipal offense or other offense, the circumstances of which substantially relate to the licensed activity; and any other factors which reasonably relate to the public health, safety and welfare. See attached police report and/or written correspondence regarding this application. Please be advised the public will be able to provide information to the committee in person or in writing. The committee will receive and consider evidence regarding the above mentioned criteria.

**Notice for applicants with warrants or unpaid fines:**

Proof of warrant satisfaction or payment of fines must be submitted at the hearing on the above date and time. Failure to comply with this requirement may result in a delay of the granting/denial of your application.

Failure to appear at this meeting may result in the denial of your license. Individual applicants must appear only in person or by an attorney. Corporate or Limited Liability applicants must appear only by the agent designated on the application or by an attorney. Partnership applicants must appear by a partner listed on the application or by an attorney. If you wish to do so and at your own expense, you may be accompanied by an attorney of your choosing to represent you at this hearing.

You will be given an opportunity to speak on behalf of the application and to respond and challenge any charges or reasons given for the denial. No petitions can be accepted by the committee, unless the people who signed the petition are present at the committee hearing and willing to testify. You may present witnesses under oath and you may also confront and cross-examine opposing witnesses under oath. If you have difficulty with the English language, you should bring an interpreter with you, at your expense, so that you can answer questions and participate in your hearing.

You may examine the application file at this office during regular business hours prior to the hearing date. Inquiries regarding this matter may be directed to the person whose signature appears below.

Limited parking for persons attending meetings in City Hall is available at reduced rates (5 hour limit) at the Milwaukee Center on the southwest corner of East Kilbourn and North Water Street. Parking tickets must be validated in the first floor information booth in City Hall.

PLEASE NOTE: Upon reasonable notice, efforts will be made to accommodate the needs of disabled individuals through sign language interpreters or other auxiliary aids. For additional information or to request this service, contact the Council Services Division ADA Coordinator at (414) 286-2998, Fax - (414) 286-3456, TDD - (414) 286-2025.

JIM OWCZARSKI, CITY CLERK

BY: \_\_\_\_\_

Jessica Celella  
License Division Manager

If you have questions regarding this notice, please contact the License Division at (414) 286-2238.



# BUSINESS LICENSE PLAN OF OPERATION

ccl-busplan 3/15/18

Office of the City Clerk License Division  
200 E. Wells St. Room 105, Milwaukee, WI 53202  
(414) 286-2238 www.milwaukee.gov/license e-mail address: license@milwaukee.gov

## 1. Type of Business

Applying for:  Extended Hours (12AM to 5AM) - If a food establishment, check all that apply:  Delivery  Drive Thru  Dining Room  
 Self Service Laundry  Massage Establishment  Filling Station  
 Other (supplemental application for specific license also required) Used Cars Wholesale Lic

Provide a detailed description of the type of business you plan on operating:

Dealers to Dealers Wholesale Lic

Do you have any experience operating this type of business?  No  Yes If yes, explain: Currently Selling Under another dealer and I just relocated here.

## 2. Business Operations

- a. Proposed Opening Date: March 15<sup>th</sup>
- b. Is this premise under construction?  No  Yes If yes, list estimated completion date: \_\_\_\_\_
- c. Is this a franchise?  No  Yes
- d. Is this premises currently licensed?  No  Yes If yes, list type of license: Wholesale Used Cars Sales
- e. Is the current licensee operating?  No  Yes If no, list date closed: \_\_\_\_\_
- f. Do you have future plans for other businesses, licenses or permits at this location?  No  Yes  
If yes, explain: When business pick up I will consider to move to a retail location
- g. Have you previously held an Extended Hours License in Milwaukee?  No  Yes  
If yes, list address(es): \_\_\_\_\_
- h. Are other businesses operating in the same building?  No  Yes If yes, describe: Business Center

## 3. Litter & Noise

- a. How are grounds kept clean?  Sweep  Pressure Wash  Pick Up Litter  Other: \_\_\_\_\_
- b. How often will grounds be cleaned?  Daily  Weekly  As Needed  Monthly  Other: \_\_\_\_\_
- c. Grounds cleaned by:  Licensee  Building Owner  Employees  Hired Maintenance  Other: \_\_\_\_\_
- d. How are noise issues prevented and/or addressed?  Security  Manager approaches customer(s)  Call Police  
 Signs Posted  Other: Landlord has a Surveillance Camera
- e. Will a sound amplification system be used?  No  Yes If yes, describe: \_\_\_\_\_

## 4. Smoking & Sanitation

- a. Are there designated outdoor smoking areas?  No  Yes If yes, describe: \_\_\_\_\_
- b. Number of Garbage Cans: Inside: 12 Locations: Through out the building  
Outside: 4 Locations: Outside
- c. Is a crowd control barrier used?  No  Yes If yes, describe: N/A my transactions are done at auction
- d. How many restrooms are on the premises? 4
- e. Name of solid waste contractor:  Advanced Disposal  Waste Management  Other: \_\_\_\_\_

## 5. Security

a. Are there onsite parking spaces?  No  Yes If yes, how many? 7 and describe the parking security

plan: Landlord has a Surveillance Cameras

b. Is there a loading zone?  No  Yes If yes, describe the loading area security plan: \_\_\_\_\_

c. Will you have security personnel on premise?  No  Yes If yes, how many? \_\_\_\_\_ and answer the following:

What are their responsibilities? Landlord has Surveillance Camera

Is security equipment used?  No  Yes If yes, describe Landlord Knows

List their licensing, certification, or training credentials Landlord Knows

d. Will there be security cameras?  No  Yes If yes, how many? \_\_\_\_\_ and list locations: \_\_\_\_\_

Landlord Knows the answer

e. Will searches/identification checks be done upon entry?  No  Yes If yes, describe \_\_\_\_\_

## 6. Percentage of Sales (must total 100%)

Alcohol _____%	Food _____%	Secondhand Merchandise _____%	Precious Metals & Gems _____%
Entertainment _____%	Cigarettes _____%		
Pawnbroker Activity _____%	Salvaged Materials _____% (such as scrap metal)	Personal Services (such as tattoo, body piercing, salon, tailor, tanning, etc.) _____%	Other <u>100</u> % Describe: <u>Wholesale Sale</u>

## 7. Businesses/Licenses on the Premises (check all that apply):

### Type 1

- Full Service Restaurant     Cafe/Coffee Shop     Deli or Fast Food Restaurant     Private/Fraternal/Veterans Club  
 Night Club     Tavern     Cocktail Lounge     Teen Club  
 Banquet Hall     Sports Facility     Bowling Alley  
 Hotel/Motel : Number of Floors: \_\_\_\_\_     Rooming House: Number of Floors: \_\_\_\_\_  
 Number of Rooms: \_\_\_\_\_    Number of Rooms: \_\_\_\_\_

### Type 2

- Liquor Store     Corner Store     Supermarket     Convenience Store  
 Gas Station     Amusement/Phonograph Distributor     Recycling, Salvage or Towing  
 Used Car Dealer     Personal Service Establishment  
 (such as tattoo business, hair salon, tailor, etc.)     Recording Studio

What other licenses/permits will you hold at this location? (check all that apply)

- Occupancy Permit     Cigarette & Tobacco     Gas Station     Extended Hours     Class "B" Tavern     Weights & Measures  
 Secondhand Dealer     Precious Metal & Gem     Other: \_\_\_\_\_

## 8. Legal Capacity (only if a Type 1 premises in #7 above)

Capacity \_\_\_\_\_ (Call the Milwaukee Development Center at 414-286-8211 if you have questions.)



## 9. Premises Description

a. Identify all area(s) of the premises that will be used in operating this business (include areas used only for storage):

1<sup>st</sup> Floor  2<sup>nd</sup> Floor  Basement Storage  Patio  Beer Garden  Sidewalk Café  Deck  Rooftop

Other: Describe: \_\_\_\_\_

b. Describe Location:  Major Thoroughfare  Secondary Street  Other: \_\_\_\_\_

c. Nearest Major Cross Street: 107<sup>th</sup> and Glenbrook

d. Describe Building:  Free Standing Building  Strip Mall  Other: \_\_\_\_\_

e. Describe Premises Structure:  Single Story  Multi-Story - # of Stories \_\_\_\_\_  Other: \_\_\_\_\_

f. Describe Surrounding Area:  Commercial  Residential  Industrial  Other: \_\_\_\_\_

g. Building Owner Name: WAYNE STAATS Phone Number: 414-305-9130

Business Owner Address: 9310 N 107<sup>th</sup> St Milwaukee WI 53224

## 10. Hours of Operation & Customers

Will customers be entering the premises?  No  Yes

Day of the Week	Proposed Hours of Operation:		Estimated Number of Customers expected each day	Potential Age Range of Customers	Class B Tavern Applicant Only: Age Restriction (If none, write 'None')
	Open Time (include a.m. or p.m.)	Close Time (include a.m. or p.m.)			
Sunday	Close		None	None	
Monday	9 am	5 pm	None	None	
Tuesday	9 am	5 pm	None	None	
Wednesday	9 am	5 pm	None	None	
Thursday	9 am	5 pm	None	None	
Friday	9 am	5 pm	None	None	
Saturday	Close				

An Extended Hours Establishment License is required for any convenience store, filling station, personal service establishment (such as tattoo, body piercing, salon, tailor, tanning, etc.), recording studio or restaurant which is open between the hours of 12:00 a.m. and 5:00 a.m.

Alcohol Establishments Class A: 8:00 am to 9:00 pm Sunday thru Saturday  
 Permitted Hours of Operation: Class B: 6:00 am to 2:00 am Sunday thru Thursday, 6:00 am to 2:30 am Friday & Saturday

Entertainment Outdoor Closing Hours: 10:00pm Sunday-Thursday; 12:00am Friday & Saturday; unless a different time, either earlier or later, is established by the Common Council in its approval of the licensee's plan of operation.

## 11. Signature(s)



Signature of Sole Proprietor, Partner, or 20% or more Shareholder

(If there are no 20% or more shareholders, Corporate Officer-print name/title and sign)

Signature of additional partner or 20% or more shareholder

See Application Information for a complete list of all required application forms.



**SECONDHAND MOTOR VEHICLE DEALER LICENSE  
SUPPLEMENTAL PLAN OF OPERATION**

Office of the City Clerk License Division  
200 E. Wells St. Room 105, Milwaukee, WI 53202  
(414) 286-2238 e-mail address: [license@milwaukee.gov](mailto:license@milwaukee.gov)

Legal Entity Name: <u>OROBOLA OLADOKUN, QUEEN BEE MOTORS INC</u>	
Premises Address: <u>9310 N 107<sup>th</sup> ST Milwaukee WI 53224</u>	
<b>SECTION 1 LICENSE TYPE</b> <u>#CUI</u>	
What type of license are you applying for? (check one) <input type="checkbox"/> Retail <input checked="" type="checkbox"/> Wholesale	
<b>SECTION 2</b>	
Will you also be dealing in secondhand vehicle parts? <input checked="" type="checkbox"/> Yes <input type="checkbox"/> No	
If wholesale, is the premises address a residential (home) address? <input type="checkbox"/> Yes <input checked="" type="checkbox"/> No	
If yes, you must obtain a Home Occupational Statement from the Department of Neighborhood Services (414) 286-3874. No vehicles can be parked and no customers are allowed at the premises. The following questions in Section 2 do not apply to wholesale from a residential address. Go to Section 3.	
Number of parking spaces available to customers/employees <u>7</u>	
Number of parking spaces that will be used for display/storage of Secondhand Motor Vehicles <u>7</u>	
Do you understand that all vehicles associated with the business must be stored on the licensed premise? <input checked="" type="checkbox"/> Yes <input type="checkbox"/> No	
<p><b>What are your plans to ensure this requirement is met (check all that apply)?</b>    <input type="checkbox"/> Employee Training</p> <input checked="" type="checkbox"/> Supervisor Monitoring <input type="checkbox"/> Fenced Lot <input type="checkbox"/> Keys Kept in Locked Box <input type="checkbox"/> Other: _____	
Do you understand all maintenance/repair work to these vehicles must be confined to the licensed premise? <input checked="" type="checkbox"/> Yes <input type="checkbox"/> No	
<p><b>What are your plans to ensure this requirement is met (check all that apply)?</b>    <input type="checkbox"/> Employee Training</p> <input checked="" type="checkbox"/> Supervisor Monitoring <input type="checkbox"/> Designated Repair Area <input type="checkbox"/> Other: _____	
Do you understand all keys to used motor vehicles offered for sale must be kept in a secure lockbox inside the dealership building at all times when the dealership is not open for business? <input checked="" type="checkbox"/> Yes <input type="checkbox"/> No	
<p><b>What are your plans to ensure this requirement is met (check all that apply)?</b>    <input type="checkbox"/> Employee Training</p> <input checked="" type="checkbox"/> Supervisor Monitoring <input type="checkbox"/> Other: <u>Landlord is in control</u>	
<b>SECTION 3 DISCLOSURE</b>	
Has any person on the application ever had a license relating to the activities licensed in Milwaukee Code of Ordinances Chapter 92 denied, not renewed, suspended, or revoked? <input checked="" type="checkbox"/> No <input type="checkbox"/> Yes	
If yes, provide the circumstances and jurisdiction in which the event occurred (including a record of any actions from the State Department of Transportation and Financial Institutions relating to suspensions, revocations, forfeitures and warnings imposed by these departments relating to the operation of any automotive sales business by the applicant):	
<b>SECTION 4 SIGNATURES</b>	
<u></u> Sole Proprietor, Partner, or 20% or more Shareholder (If there are no 20% or more shareholders, Corporate Officer-print name/title and sign)	_____ Additional partner or 20% or more shareholder



CITY OF MILWAUKEE  
OFFICE OF THE CITY CLERK

Wednesday, March 20, 2019

COMMITTEE MEETING NOTICE

AD 09

PATEL, Deven T, Agent  
KINKUN INC  
8082 N 76TH St

MILWAUKEE, WI 53223

You are requested to attend a hearing which is to be held in Room 301-B, Third Floor, City Hall on:

Wednesday, April 03, 2019 at 01:30 PM

**Regarding:** Your Class A Malt & Class A Liquor and Food Dealer Retail License Renewal Applications as agent for "KINKUN INC" for "SUNDEEP LIQUOR" at 8082 N 76TH St.

There is a possibility that your application may be denied for one or more of the following reasons: The recommendation of the committee regarding the application shall be based on evidence presented at the hearing. Per MCO 85-4-4, unless otherwise specified in the code, probative evidence concerning non-renewal, suspension or revocation may include evidence of the following: failure of the applicant to meet municipal qualifications, pending charges against or the conviction of any felony, misdemeanor, municipal offense or other offense, the circumstances of which substantially relate to the circumstances of the particular licensed or permitted activity, by the applicant or by any employee or other agent of the applicant. If the activities of the applicant involve a licensed premises, whether the premises tends to facilitate a public or private nuisance or has been the source of congregations of persons which have resulted in any of the following: disturbance of the peace; illegal drug activity; public drunkenness; drinking in public; harassment of passers-by; gambling; prostitution; sale of stolen goods; public urination; theft; assaults; battery; acts of vandalism including graffiti, excessive littering, loitering, illegal parking, loud noise at times when the licensed premise is open for business; traffic violations; curfew violations; lewd conduct; display of materials harmful to minors, pursuant to s. 106-9.6; or any other factor which reasonably relates to the public health, safety and welfare, or failure to comply with the approved plan of operation. See attached police report or correspondence.

**Notice for applicants with warrants or unpaid fines:**

Proof of warrant satisfaction or payment of fines must be submitted at the hearing on the above date and time. Failure to comply with this requirement may result in a delay of the granting/denial of your application.

Failure to appear at this meeting may result in the denial of your license. Individual applicants must appear only in person or by an attorney. Corporate or Limited Liability applicants must appear only by the agent designated on the application or by an attorney. Partnership applicants must appear by a partner listed on the application or by an attorney. If you wish to do so and at your own expense, you may be accompanied by an attorney of your choosing to represent you at this hearing.

You will be given an opportunity to speak on behalf of the application and to respond and challenge any charges or reasons given for the denial. No petitions can be accepted by the committee, unless the people who signed the petition are present at the committee hearing and willing to testify. You may present witnesses under oath and you may also confront and cross-examine opposing witnesses under oath. If you have difficulty with the English language, you should bring an interpreter with you, at your expense, so that you can answer questions and participate in your hearing.

You may examine the application file at this office during regular business hours prior to the hearing date. Inquiries regarding this matter may be directed to the person whose signature appears below.

Limited parking for persons attending meetings in City Hall is available at reduced rates (5 hour limit) at the Milwaukee Center on the southwest corner of East Kilbourn and North Water Street. Parking tickets must be validated in the first floor information booth in City Hall.

PLEASE NOTE: Upon reasonable notice, efforts will be made to accommodate the needs of disabled individuals through sign language interpreters or other auxiliary aids. For additional information or to request this service, contact the Council Services Division ADA Coordinator at (414) 286-2998, Fax - (414) 286-3456, TDD - (414) 286-2025.

JIM OWCZARSKI, CITY CLERK

BY:

Jessica Celella  
License Division Manager

If you have questions regarding this notice, please contact the License Division at (414) 286-2238.

200 E. Wells Street, Room 105, City Hall, Milwaukee, WI 53202. [www.milwaukee.gov/license](http://www.milwaukee.gov/license)  
Phone: (414) 286-2238 Fax: (414) 286-3057 Email Address: [License@milwaukee.gov](mailto:License@milwaukee.gov)

## Moon Siefert, Linda

---

**From:** License  
**Sent:** Monday, February 11, 2019 8:08 AM  
**To:** Moon Siefert, Linda  
**Cc:** Wagner, Janice  
**Subject:** FW: Sundeep Liquor Licence Renewal

**Follow Up Flag:** Follow up  
**Flag Status:** Flagged

**Categories:** Red Category

**REDACTED RECORD**

Keren Becker  
License Specialist III  
City Clerk – License Division  
O: (414) 286-2238  
F: (414) 286-3057  
[License@Milwaukee.gov](mailto:License@Milwaukee.gov)  
[www.Milwaukee.gov/license](http://www.Milwaukee.gov/license)



**From:**  
**Sent:** Sunday, February 10, 2019 7:06 AM  
**To:** License  
**Subject:** Sundeep Liquor Licence Renewal

To whom it may concern,  
My name is

I'm writing to express my concerns in regards to the liquor license renewal of Sundeep Liquor. Sundeep is next door to my church Jericho Church Without Walls at 8086 N. 76th St. Since our church moved into our current location seven years ago I have witnessed an employee (s) that drink on the side of the liquor store and leave beer cans on our property, men urinating next to the liquor store, a general accumulation of trash, and customers of Sundeep that park in our parking lot to go to the liquor store. Sundeep has been a nuisance to Jericho Church Without Walls and I strongly recommend their license not be renewed.

**MILWAUKEE POLICE DEPARTMENT  
LICENSE INVESTIGATION UNIT**

**CRIMINAL RECORD/ORDINANCE VIOLATION/INCIDENTS  
SYNOPSIS**

**DATE: 02/07/2019**

**LICENSE TYPE: ALQML**

**NEW:**

**RENEWAL: X**

**No. 288773**

**Application Date: 02/07/2019**

**Expiration Date:**

**License Location: 8082 N 76<sup>th</sup> Street**

**Aldermanic District: 09**

**Business Name: Sundeep Liquor**

**Licensee/Applicant: Patel, Deven T**

(Last Name, First Name, MI)

**Date of Birth: 11/11/70**

**Male:**

**Female:**

**Home Address: 10874 Coneflower Circle**

**City: Germantown**

**State: Wi**

**Zip Code: 53022**

**Home Phone: (262) 242-9513**

This report is written by Police Officer David NOVAK, assigned to the License Investigation Unit, Days.

The Milwaukee Police Department's investigation regarding this application revealed the following:

1. On 04/26/07 at 10:24 am, Milwaukee police were dispatched to an Armed Robbery at 8082 N 76<sup>th</sup> Street. Investigation revealed a male entered the business and asked the clerk for a pack of cigarettes. As the clerk reached for the cigarettes, the suspect pulled a handgun from his jacket and demanded money from the register. The suspect obtained money and cigarettes and fled the store. No injuries were reported.

- =====
2. On 06/08/10 at 7:55 pm, officers conducted a traffic stop near 8082 N 76<sup>th</sup> Street. Officers recovered a bottle of Hard Makers whiskey and found the driver to be under the legal drinking age. Further investigation revealed the driver bought the alcohol from Sundeep Liquor located at 8082 N 76<sup>th</sup> Street. Officers conducted follow up and spoke to the clerk who sold the liquor. The clerk was identified as Kirit Patel and he did admit to selling the bottle of liquor to the subject but told police that he thought the subject was 25. Kirit admitted to not asking for ID. Police then spoke to the licensee Deven Patel, who stated he was assisting another customer at the time and did not observe the transaction. Deven did allow police to view video surveillance, which did show the subject being sold the liquor. A citation was issued to Kirit for sale to underage.

As to Kirit Patel:

**Charge: Sale of Alcohol To Underage**  
**Finding: Guilty**  
**Sentence: Fined \$171.00**  
**Date: 09/27/10**  
**Case: 10080997**

3. On 11/13/10 at 3:02 pm, Milwaukee police were working the Wisconsin Tobacco Initiative and had an underage student enter 8082 N 76<sup>th</sup> Street in attempts to tobacco products. The clerk sold the student a white grape flavor white owl cigar without verifying the student's age. A citation was issued to Patel but was not found in the municipal system.
- =====

4. On 09/04/2013 a Milwaukee police officer made contact with the applicant and provided him with a copy of the city ordinance related to secondhand dealers licenses.
- =====

5. On 06/18/2013 Parul Patel was cited at 3441 West Wells Street in the city of Milwaukee for Cigarette and Tobacco License Required. Parul Patel is listed on the application as 50% shareholder.

Charge: Cigarette and Tobacco License Required  
Finding: Guilty  
Sentence: \$113.00 fine  
Date: 08/16/2013  
Case: 13069348

=====

6. On 03/05/2018 Parul PATEL (100% shareholder) was cited in the City of Milwaukee at 3447 W. Wells St for Responsible Person on Premise.

Charge: Responsible Person on Premise  
Finding: Guilty  
Sentence: Fined \$378.00  
Date: 04/20/2018  
Case: 18032660

7. On 08/11/2018 the applicant was cited in the City of Milwaukee at 3447 W. Wells St for Resisting or Obstructing an Officer.

Charge: Resisting or Obstructing an Officer  
Finding: Guilty  
Sentence: Fined \$196.00  
Date: 09/26/2018  
Case: 18068724



Wednesday, March 20, 2019



# Notice of Public Hearing

---

PATEL, Deven T, Agent  
SUNDEEP LIQUOR at 8082 N 76TH St  
Class A Malt & Class A Liquor and Food Dealer Retail License Renewal Applications

**Wednesday, April 03, 2019 at 1:30 PM**

To whom it may concern:

The above application has been made by the above named applicant(s). This requires approval from the Licenses Committee and the Common Council of the City of Milwaukee. The hearing before the Licenses Committee will take place on 4/3/2019 at 1:30 PM, in Room 301-B, Third Floor, City Hall. If you wish, you may provide testimony at the hearing regarding the request; see below for further information. You are not required to attend the hearing. Once the Licenses Committee makes its recommendation, this recommendation is forwarded to the full Common Council for approval at its next regularly scheduled hearing. Please review the information below and if you have further questions regarding this process, please contact the License Division at (414) 286-2238.

---

## **Important details for those wishing to provide information for the Licenses Committee to consider when making its recommendation:**

1. The license application is scheduled to be heard at the above time. Due to other hearings running longer than scheduled, you may have to wait some time to provide your testimony.
2. You must appear in person and testify as to matters that you have personally experienced or seen. (You cannot provide testimony for your neighbor, parent or anyone else; this is considered hearsay and cannot be considered by the committee.)
3. No letters or petitions can be accepted by the committee (unless the person who wrote the letter or the persons who signed the petition are present at the committee hearing and willing to testify).
4. Persons opposed to the license application are given the opportunity to testify first; supporters may testify after the opponents have finished.
5. When you are called to testify, you will be sworn in and asked to give your name, and address. (If your first and/or last names are uncommon please spell them.)
6. You may then provide testimony.
  - a. Include only information relating to the above license application.
  - b. Include only information you have personally witnessed or seen.
  - c. Provide concise and relevant information detailing how this business has affected or may affect the peaceful enjoyment of your neighborhood.
  - d. If by the time you have the opportunity to testify, the information you wish to share has already been provided to the committee, you may state that you agree with the previous testimony. Redundant or repetitive testimony will not assist the committee in making its recommendation.
7. After giving your testimony, the members of the Licenses Committee and the licensee may ask questions regarding the testimony you have given or other factors relating to the license application.
8. Business Competition is not a valid basis for denial or non-renewal of a license.  
**Please Note: If you have submitted an objection to the above application your objection cannot be considered by the committee unless you personally testify at the hearing.**

OCCUPANT	MAIL ADDRESS	CITY, STATE ZIP
CURRENT OCCUPANT	7700 W LOLITA AVE	MILWAUKEE, WI 53223
CURRENT OCCUPANT	7729 W BRADLEY RD	MILWAUKEE, WI 53223
CURRENT OCCUPANT	7825 W TOWER AVE	MILWAUKEE, WI 53223
CURRENT OCCUPANT	7800 W BRADLEY RD	MILWAUKEE, WI 53223
CURRENT OCCUPANT	7717 W BRADLEY RD	MILWAUKEE, WI 53223
CURRENT OCCUPANT	7701 W BRADLEY RD	MILWAUKEE, WI 53223
CURRENT OCCUPANT	7415 W DEAN RD	MILWAUKEE, WI 53223
CURRENT OCCUPANT	7720 W BRADLEY RD	MILWAUKEE, WI 53223

Total Records: 8

Radius: 750.0 feet and Center of Circle: 8082 N 76th St



**2018-2019 Plan of Operation for 8082 N 76TH ST**

**1. Litter & Security Plans**

How are the grounds kept clean?  Sweep  Pressure Wash  Pick Up Litter  Other:

How often will grounds be cleaned?  Daily  Weekly  Other:

Who cleans the grounds?  Licensee  Building Owner  Employees  Hired Maintenance  Other:

How are noise issues prevented and/or addressed?  Security  Manager approaches customer(s)  Call Police  Signs Posted  Other:

Are there designated outdoor smoking areas?  No  Yes If Yes, Describe: Out of Store in open

Number of garbage cans: Inside 2 Locations: near door near Register  
 Outside 2 Locations: both side of entrance door

Is a crowd control barrier used?  No  Yes If Yes, Describe:

Number of restrooms: 1 Name of solid waste contractor: WM

Are there parking spaces on the premises?  No  Yes If Yes, list number of spaces: 6 and describe security plans:  
In front of the parking lot

Are there designated loading areas?  No  Yes If Yes, describe security plans:

Do you have security personnel on the premise?  No  Yes If Yes, how many? 3 Two corners of store entrance & back door  
 AND What are their responsibilities? \_\_\_\_\_  
 What security equipment do they use? \_\_\_\_\_  
 List their licensing, certification or training credentials: \_\_\_\_\_

Are there security cameras?  No  Yes If Yes, list all locations: one on Register and one in front, in back, one in  
stock room

Are searches and/or identification checks conducted upon entry?  No  Yes If Yes, describe:

**2. Percentage of Sales (must total 100%)**

Alcohol 95 % Food Sales 1 % Entertainment 2 % Other 2 %

**3. Businesses On The Premises (choose all that apply):**

Restaurant  Cafe/Coffee Shop  Cocktail Lounge  Convenience Store  Night Club  Liquor Store  Tavern  Sports Facility  
 Hotel  Banquet Hall  Supermarket  Private/Fraternal/Veterans' Club  Other:

**4. Hours of Operation and Age Restriction**

Are there any changes to the current hours of operation or age restriction?  No  Yes If Yes, Describe:

Please Note: If you will be open earlier or later than the hours listed on your current license for even one event or holiday (for example, St. Patrick's Day, Brewers Opening Day, etc.) during the license period, this must be reported and printed on your license. Your hours of operation and age restriction are listed on your current license.

**5. Floor Plan and Capacity**

Are you requesting any changes to your capacity or floor plan\*?  No  Yes If yes, describe: \_\_\_\_\_ and submit a new floor plan with this renewal application. A sample plan can be found online at [www.milwaukee.gov/licenses](http://www.milwaukee.gov/licenses) under License Forms and Related Information.

Alcohol/Food Establishments: A "Permanent Extension of Premises Application" is required if you are adding any square footage to the licensed premises.

**6. Sidewalk Dining: Fee:**

Are there any changes to the sidewalk dining site plan?  No  Yes If Yes, submit an updated site plan with this application.

**7. Food License: FOOD 8833 Fee: \$350.00**

Your current food license includes the following food operations: Processing, Hazardous Foods, Sales < \$20,000, Food Store. Are there any changes to your food operations as listed above?  No  Yes, if Yes, explain \_\_\_\_\_

**8. Weights and Measures: Fee:**

Number/Type of Devices:  
 Are there any changes to the number or types of devices?  No  Yes  
 If yes, contact our office for further instructions.



**CITY OF MILWAUKEE  
OFFICE OF THE CITY CLERK**

Monday, March 25, 2019

**COMMITTEE MEETING NOTICE**

AD 09

PITNEY, Alan R, Agent  
Renascent Salvage Milwaukee LLC  
8501 W Calumet Rd  
Milwaukee, WI 53224

You are requested to attend a hearing which is to be held in Room 301-B, Third Floor, City Hall on:

**Wednesday, April 03, 2019 at 01:30 PM**

**Regarding:** Your Secondhand Motor Vehicle Dealer's - Wholesale Only License Application as agent for "Renascent Salvage Milwaukee LLC" for "Calumet Auto Parts" at 8501 W Calumet Rd.

There is a possibility that your application may be denied for one or more of the following reasons: Neighborhood Objections to the granting of such a license due to the creation of undesirable neighborhood problems, such as: parking and traffic problems which cause the normal flow of traffic on roadways and alleys to be impeded, loitering, littering, noise, loud music, and conduct which will have an adverse impact on the public health, safety and welfare of the community. Additionally, the over concentration of secondhand motor vehicle dealers in the neighborhood such that the concentration will have an adverse impact on the public health, safety and welfare of the neighborhood. you do not meet the statutory and municipal requirements; the appropriateness of the location to be licensed and whether the location will create undesirable neighborhood problems, whether or not you have been charged with or convicted of any felony, misdemeanor, municipal offense or other offense, the circumstances of which substantially relate to the licensed activity; and any other factors which reasonably relate to the public health, safety and welfare. See attached police report and/or written correspondence regarding this application. Please be advised the public will be able to provide information to the committee in person or in writing. The committee will receive and consider evidence regarding the above mentioned criteria.

**Notice for applicants with warrants or unpaid fines:**

Proof of warrant satisfaction or payment of fines must be submitted at the hearing on the above date and time. Failure to comply with this requirement may result in a delay of the granting/denial of your application.

Failure to appear at this meeting may result in the denial of your license. Individual applicants must appear only in person or by an attorney. Corporate or Limited Liability applicants must appear only by the agent designated on the application or by an attorney. Partnership applicants must appear by a partner listed on the application or by an attorney. If you wish to do so and at your own expense, you may be accompanied by an attorney of your choosing to represent you at this hearing.

You will be given an opportunity to speak on behalf of the application and to respond and challenge any charges or reasons given for the denial. No petitions can be accepted by the committee, unless the people who signed the petition are present at the committee hearing and willing to testify. You may present witnesses under oath and you may also confront and cross-examine opposing witnesses under oath. If you have difficulty with the English language, you should bring an interpreter with you, at your expense, so that you can answer questions and participate in your hearing.

You may examine the application file at this office during regular business hours prior to the hearing date. Inquiries regarding this matter may be directed to the person whose signature appears below.

Limited parking for persons attending meetings in City Hall is available at reduced rates (5 hour limit) at the Milwaukee Center on the southwest corner of East Kilbourn and North Water Street. Parking tickets must be validated in the first floor information booth in City Hall.

PLEASE NOTE: Upon reasonable notice, efforts will be made to accommodate the needs of disabled individuals through sign language interpreters or other auxiliary aids. For additional information or to request this service, contact the Council Services Division ADA Coordinator at (414) 286-2998, Fax - (414) 286-3456, TDD - (414) 286-2025.

JIM OWCZARSKI, CITY CLERK

BY:

\_\_\_\_\_  
Jessica Celella  
License Division Manager

**If you have questions regarding this notice, please contact the License Division at (414) 286-2238.**



**CITY OF MILWAUKEE  
OFFICE OF THE CITY CLERK**

Monday, March 25, 2019

**COMMITTEE MEETING NOTICE**

AD 09

PITNEY, Alan R, Agent  
Renascent Salvage Milwaukee LLC  
7434 Highwood Way  
Hudson, OH 44236

You are requested to attend a hearing which is to be held in Room 301-B, Third Floor, City Hall on:

**Wednesday, April 03, 2019 at 01:30 PM**

**Regarding:** Your Secondhand Motor Vehicle Dealer's - Wholesale Only License Application as agent for "Renascent Salvage Milwaukee LLC" for "Calumet Auto Parts" at 8501 W Calumet Rd.

There is a possibility that your application may be denied for one or more of the following reasons: Neighborhood Objections to the granting of such a license due to the creation of undesirable neighborhood problems, such as: parking and traffic problems which cause the normal flow of traffic on roadways and alleys to be impeded, loitering, littering, noise, loud music, and conduct which will have an adverse impact on the public health, safety and welfare of the community. Additionally, the over concentration of secondhand motor vehicle dealers in the neighborhood such that the concentration will have an adverse impact on the public health, safety and welfare of the neighborhood. you do not meet the statutory and municipal requirements; the appropriateness of the location to be licensed and whether the location will create undesirable neighborhood problems, whether or not you have been charged with or convicted of any felony, misdemeanor, municipal offense or other offense, the circumstances of which substantially relate to the licensed activity; and any other factors which reasonably relate to the public health, safety and welfare. See attached police report and/or written correspondence regarding this application. Please be advised the public will be able to provide information to the committee in person or in writing. The committee will receive and consider evidence regarding the above mentioned criteria.

**Notice for applicants with warrants or unpaid fines:**

Proof of warrant satisfaction or payment of fines must be submitted at the hearing on the above date and time. Failure to comply with this requirement may result in a delay of the granting/denial of your application.

Failure to appear at this meeting may result in the denial of your license. Individual applicants must appear only in person or by an attorney. Corporate or Limited Liability applicants must appear only by the agent designated on the application or by an attorney. Partnership applicants must appear by a partner listed on the application or by an attorney. If you wish to do so and at your own expense, you may be accompanied by an attorney of your choosing to represent you at this hearing.

You will be given an opportunity to speak on behalf of the application and to respond and challenge any charges or reasons given for the denial. No petitions can be accepted by the committee, unless the people who signed the petition are present at the committee hearing and willing to testify. You may present witnesses under oath and you may also confront and cross-examine opposing witnesses under oath. If you have difficulty with the English language, you should bring an interpreter with you, at your expense, so that you can answer questions and participate in your hearing.

You may examine the application file at this office during regular business hours prior to the hearing date. Inquiries regarding this matter may be directed to the person whose signature appears below.

Limited parking for persons attending meetings in City Hall is available at reduced rates (5 hour limit) at the Milwaukee Center on the southwest corner of East Kilbourn and North Water Street. Parking tickets must be validated in the first floor information booth in City Hall.

PLEASE NOTE: Upon reasonable notice, efforts will be made to accommodate the needs of disabled individuals through sign language interpreters or other auxiliary aids. For additional information or to request this service, contact the Council Services Division ADA Coordinator at (414) 286-2998, Fax - (414) 286-3456, TDD - (414) 286-2025.

JIM OWCZARSKI, CITY CLERK

BY: \_\_\_\_\_

Jessica Ceella  
License Division Manager

**If you have questions regarding this notice, please contact the License Division at (414) 286-2238.**



Monday, March 25, 2019



# Notice of Public Hearing

---

PITNEY, Alan R, Agent  
Calumet Auto Parts at 8501 W Calumet Rd  
Secondhand Motor Vehicle Dealer's - Wholesale Only License Application

**Wednesday, April 03, 2019 at 1:30 PM**

To whom it may concern:

The above application has been made by the above named applicant(s). This requires approval from the Licenses Committee and the Common Council of the City of Milwaukee. The hearing before the Licenses Committee will take place on 4/3/2019 at 1:30 PM, in Room 301-B, Third Floor, City Hall. If you wish, you may provide testimony at the hearing regarding the request; see below for further information. You are not required to attend the hearing. Once the Licenses Committee makes its recommendation, this recommendation is forwarded to the full Common Council for approval at its next regularly scheduled hearing. Please review the information below and if you have further questions regarding this process, please contact the License Division at (414) 286-2238.

---

## Important details for those wishing to provide information for the Licenses Committee to consider when making its recommendation:

1. The license application is scheduled to be heard at the above time. Due to other hearings running longer than scheduled, you may have to wait some time to provide your testimony.
2. You must appear in person and testify as to matters that you have personally experienced or seen. (You cannot provide testimony for your neighbor, parent or anyone else; this is considered hearsay and cannot be considered by the committee.)
3. No letters or petitions can be accepted by the committee (unless the person who wrote the letter or the persons who signed the petition are present at the committee hearing and willing to testify).
4. Persons opposed to the license application are given the opportunity to testify first; supporters may testify after the opponents have finished.
5. When you are called to testify, you will be sworn in and asked to give your name, and address. (If your first and/or last names are uncommon please spell them.)
6. You may then provide testimony.
  - a. Include only information relating to the above license application.
  - b. Include only information you have personally witnessed or seen.
  - c. Provide concise and relevant information detailing how this business has affected or may affect the peaceful enjoyment of your neighborhood.
  - d. If by the time you have the opportunity to testify, the information you wish to share has already been provided to the committee, you may state that you agree with the previous testimony. Redundant or repetitive testimony will not assist the committee in making its recommendation.
7. After giving your testimony, the members of the Licenses Committee and the licensee may ask questions regarding the testimony you have given or other factors relating to the license application.
8. Business Competition is not a valid basis for denial or non-renewal of a license.  
**Please Note: If you have submitted an objection to the above application your objection cannot be considered by the committee unless you personally testify at the hearing.**

OCCUPANT	MAIL ADDRESS	CITY, STATE ZIP
CURRENT OCCUPANT	7552 N 87TH ST	MILWAUKEE, WI 53224
CURRENT OCCUPANT	7444 N 86TH ST	MILWAUKEE, WI 53224
CURRENT OCCUPANT	7472 N 86TH ST	MILWAUKEE, WI 53224
CURRENT OCCUPANT	7474 N 86TH ST	MILWAUKEE, WI 53224
CURRENT OCCUPANT	7480 N 86TH ST R	MILWAUKEE, WI 53224
CURRENT OCCUPANT	7480 N 86TH ST M	MILWAUKEE, WI 53224
CURRENT OCCUPANT	7480 N 86TH ST U	MILWAUKEE, WI 53224
CURRENT OCCUPANT	7480 N 86TH ST H	MILWAUKEE, WI 53224
CURRENT OCCUPANT	7488 N 87TH ST	MILWAUKEE, WI 53224
CURRENT OCCUPANT	7554 N 87TH ST	MILWAUKEE, WI 53224
CURRENT OCCUPANT	8611 W MAGNOLIA ST	MILWAUKEE, WI 53224
CURRENT OCCUPANT	7480 N 86TH ST N	MILWAUKEE, WI 53224
CURRENT OCCUPANT	7480 N 86TH ST J	MILWAUKEE, WI 53224
CURRENT OCCUPANT	7502 N 87TH ST	MILWAUKEE, WI 53224
CURRENT OCCUPANT	7526 N 87TH ST	MILWAUKEE, WI 53224
CURRENT OCCUPANT	7446 N 86TH ST	MILWAUKEE, WI 53224
CURRENT OCCUPANT	7450 N 86TH ST	MILWAUKEE, WI 53224
CURRENT OCCUPANT	7466 N 86TH ST	MILWAUKEE, WI 53224
CURRENT OCCUPANT	7477 N 86TH ST	MILWAUKEE, WI 53224
CURRENT OCCUPANT	7480 N 86TH ST S	MILWAUKEE, WI 53224
CURRENT OCCUPANT	7480 N 86TH ST T	MILWAUKEE, WI 53224
CURRENT OCCUPANT	7492 N 87TH ST	MILWAUKEE, WI 53224
CURRENT OCCUPANT	7512 N 87TH ST	MILWAUKEE, WI 53224
CURRENT OCCUPANT	7536 N 87TH ST	MILWAUKEE, WI 53224
CURRENT OCCUPANT	7452 N 87TH ST	MILWAUKEE, WI 53224
CURRENT OCCUPANT	7467 N 86TH ST	MILWAUKEE, WI 53224
CURRENT OCCUPANT	7448 N 86TH ST	MILWAUKEE, WI 53224
CURRENT OCCUPANT	7462 N 86TH ST	MILWAUKEE, WI 53224
CURRENT OCCUPANT	7464 N 86TH ST	MILWAUKEE, WI 53224
CURRENT OCCUPANT	7498 N 87TH ST	MILWAUKEE, WI 53224
CURRENT OCCUPANT	7470 N 86TH ST	MILWAUKEE, WI 53224
CURRENT OCCUPANT	7454 N 86TH ST	MILWAUKEE, WI 53224
CURRENT OCCUPANT	7468 N 86TH ST	MILWAUKEE, WI 53224
CURRENT OCCUPANT	7480 N 86TH ST V	MILWAUKEE, WI 53224
CURRENT OCCUPANT	8620 W MAGNOLIA ST	MILWAUKEE, WI 53224
CURRENT OCCUPANT	7494 N 87TH ST	MILWAUKEE, WI 53224
CURRENT OCCUPANT	7496 N 87TH ST	MILWAUKEE, WI 53224
CURRENT OCCUPANT	7520 N 87TH ST	MILWAUKEE, WI 53224
CURRENT OCCUPANT	7460 N 87TH ST	MILWAUKEE, WI 53224
CURRENT OCCUPANT	7544 N 87TH ST	MILWAUKEE, WI 53224
CURRENT OCCUPANT	7456 N 86TH ST	MILWAUKEE, WI 53224
CURRENT OCCUPANT	7458 N 86TH ST	MILWAUKEE, WI 53224
CURRENT OCCUPANT	7460 N 86TH ST	MILWAUKEE, WI 53224
CURRENT OCCUPANT	7480 N 86TH ST D	MILWAUKEE, WI 53224
CURRENT OCCUPANT	7480 N 86TH ST G	MILWAUKEE, WI 53224
CURRENT OCCUPANT	7480 N 86TH ST L	MILWAUKEE, WI 53224

CURRENT OCCUPANT	7500 N 87TH ST	MILWAUKEE, WI 53224
CURRENT OCCUPANT	7510 N 87TH ST	MILWAUKEE, WI 53224
CURRENT OCCUPANT	8700 W CALUMET RD	MILWAUKEE, WI 53224
CURRENT OCCUPANT	7546 N 87TH ST	MILWAUKEE, WI 53224
CURRENT OCCUPANT	7452 N 86TH ST	MILWAUKEE, WI 53224
CURRENT OCCUPANT	7480 N 86TH ST F	MILWAUKEE, WI 53224
CURRENT OCCUPANT	7480 N 86TH ST W	MILWAUKEE, WI 53224
CURRENT OCCUPANT	7480 N 86TH ST B	MILWAUKEE, WI 53224
CURRENT OCCUPANT	7518 N 87TH ST	MILWAUKEE, WI 53224
CURRENT OCCUPANT	7534 N 87TH ST	MILWAUKEE, WI 53224
CURRENT OCCUPANT	7480 N 86TH ST C	MILWAUKEE, WI 53224
CURRENT OCCUPANT	7480 N 86TH ST A	MILWAUKEE, WI 53224
CURRENT OCCUPANT	7480 N 86TH ST E	MILWAUKEE, WI 53224
CURRENT OCCUPANT	7480 N 86TH ST P	MILWAUKEE, WI 53224
CURRENT OCCUPANT	7480 N 86TH ST K	MILWAUKEE, WI 53224
CURRENT OCCUPANT	7480 N 86TH ST X	MILWAUKEE, WI 53224
CURRENT OCCUPANT	8618 W MAGNOLIA ST	MILWAUKEE, WI 53224
CURRENT OCCUPANT	7486 N 87TH ST	MILWAUKEE, WI 53224
CURRENT OCCUPANT	7528 N 87TH ST	MILWAUKEE, WI 53224

Total Records: 65

Radius: 250.0 feet and Center of Circle: 8501 W Calumet Rd



# BUSINESS LICENSE PLAN OF OPERATION

ccl-busplan 3/15/18

Office of the City Clerk License Division  
200 E. Wells St. Room 105, Milwaukee, WI 53202  
(414) 286-2238 www.milwaukee.gov/license e-mail address: [license@milwaukee.gov](mailto:license@milwaukee.gov)

## 1. Type of Business

Applying for:  Extended Hours (12AM to 5AM) - If a food establishment, check all that apply:  Delivery  Drive Thru  Dining Room  
 Self Service Laundry  Massage Establishment  Filling Station  
 Other (supplemental application for specific license also required)

Provide a detailed description of the type of business you plan on operating:

WHOLESALE SECONDHAND AUTO SALES

Do you have any experience operating this type of business?  No  Yes If yes, explain: TWO SECONDHAND UNITS IN OHIO

## 2. Business Operations

- a. Proposed Opening Date: 3/4/2019
- b. Is this premise under construction?  No  Yes If yes, list estimated completion date: \_\_\_\_\_
- c. Is this a franchise?  No  Yes
- d. Is this premises currently licensed?  No  Yes If yes, list type of license: RST
- e. Is the current licensee operating?  No  Yes If no, list date closed: \_\_\_\_\_
- f. Do you have future plans for other businesses, licenses or permits at this location?  No  Yes  
If yes, explain: \_\_\_\_\_
- g. Have you previously held an Extended Hours License in Milwaukee?  No  Yes  
If yes, list address(es): \_\_\_\_\_
- h. Are other businesses operating in the same building?  No  Yes If yes, describe: SALVAGE YARD w/ RECYCLED PART SALES

## 3. Litter & Noise

- a. How are grounds kept clean?  Sweep  Pressure Wash  Pick Up Litter  Other: \_\_\_\_\_
- b. How often will grounds be cleaned?  Daily  Weekly  As Needed  Monthly  Other: \_\_\_\_\_
- c. Grounds cleaned by:  Licensee  Building Owner  Employees  Hired Maintenance  Other: \_\_\_\_\_
- d. How are noise issues prevented and/or addressed?  Security  Manager approaches customer(s)  Call Police  
 Signs Posted  Other: LIMIT OPERATING HOURS TO 8-5.
- e. Will a sound amplification system be used?  No  Yes If yes, describe: \_\_\_\_\_

## 4. Smoking & Sanitation

- a. Are there designated outdoor smoking areas?  No  Yes If yes, describe: \_\_\_\_\_
- b. Number of Garbage Cans: Inside: 6 Locations: WAREHOUSE ; GARAGE AREAS  
Outside: 1 Locations: DUMPSTER STORAGE AREA
- c. Is a crowd control barrier used?  No  Yes If yes, describe: \_\_\_\_\_
- d. How many restrooms are on the premises? 3
- e. Name of solid waste contractor:  Advanced Disposal  Waste Management  Other: JOHN'S DISPOSAL

## 5. Security

- a. Are there onsite parking spaces?  No  Yes If yes, how many? 20 and describe the parking security plan: SURVEILLANCE CAMERAS IN PARKING LOT
- b. Is there a loading zone?  No  Yes If yes, describe the loading area security plan: \_\_\_\_\_
- c. Will you have security personnel on premise?  No  Yes If yes, how many? \_\_\_\_\_ and answer the following:  
 What are their responsibilities? \_\_\_\_\_  
 Is security equipment used?  No  Yes If yes, describe \_\_\_\_\_  
 List their licensing, certification, or training credentials \_\_\_\_\_
- d. Will there be security cameras?  No  Yes If yes, how many? 15 and list locations: 2 - PARKING LOT  
5 - YARD 8 - INSIDE
- e. Will searches/identification checks be done upon entry?  No  Yes If yes, describe \_\_\_\_\_

## 6. Percentage of Sales (must total 100%)

Alcohol _____%	Food _____%	Secondhand Merchandise _____%	Precious Metals & Gems _____%
Entertainment _____%	Cigarettes _____%	Personal Services (such as tattoo, body piercing, salon, tailor, tanning, etc.) _____%	Other <u>100</u> % Describe: <u>WHOLESALE SECONDHAND CARS</u>
Pawnbroker Activity _____%	Salvaged Materials _____% (such as scrap metal)		

## 7. Businesses/Licenses on the Premises (check all that apply):

### Type 1

- Full Service Restaurant       Cafe/Coffee Shop       Deli or Fast Food Restaurant       Private/Fraternal/Veterans Club
- Night Club       Tavern       Cocktail Lounge       Teen Club
- Banquet Hall       Sports Facility       Bowling Alley
- Hotel/Motel: Number of Floors: \_\_\_\_\_       Rooming House: Number of Floors: \_\_\_\_\_  
 Number of Rooms: \_\_\_\_\_      Number of Rooms: \_\_\_\_\_

### Type 2

- Liquor Store       Corner Store       Supermarket       Convenience Store
- Gas Station       Amusement/Phonograph Distributor       Recycling, Salvage or Towing
- Used Car Dealer       Personal Service Establishment  
 (such as tattoo business, hair salon, tailor, etc.)       Recording Studio

What other licenses/permits will you hold at this location? (check all that apply)

- Occupancy Permit     Cigarette & Tobacco     Gas Station     Extended Hours     Class "B" Tavern     Weights & Measures
- Secondhand Dealer     Precious Metal & Gem     Other: \_\_\_\_\_

## 8. Legal Capacity (only if a Type 1 premises in #7 above)

Capacity \_\_\_\_\_ (Call the Milwaukee Development Center at 414-286-8211 if you have questions.)



## 9. Premises Description

- a. Identify all area(s) of the premises that will be used in operating this business (include areas used only for storage):  
 1<sup>st</sup> Floor  2<sup>nd</sup> Floor  Basement Storage  Patio  Beer Garden  Sidewalk Café  Deck  Rooftop  
 Other: Describe: MULTI STORY STORE STRUCTURE ARP
- b. Describe Location:  Major Thoroughfare  Secondary Street  Other: \_\_\_\_\_
- c. Nearest Major Cross Street: 76<sup>TH</sup> STREET
- d. Describe Building:  Free Standing Building  Strip Mall  Other: \_\_\_\_\_
- e. Describe Premises Structure:  Single Story  Multi-Story <sup>ARP</sup> # of Stories \_\_\_\_\_  Other: \_\_\_\_\_
- f. Describe Surrounding Area:  Commercial  Residential  Industrial  Other: \_\_\_\_\_
- g. Building Owner Name: CALUMET REAL ESTATE LLC Phone Number: 216-973-4222  
 Business Owner Address: 7434 Highway Way Hudson, OH 44236

## 10. Hours of Operation & Customers

Will customers be entering the premises?  No  Yes

Day of the Week	Proposed Hours of Operation:		Estimated Number of Customers expected each day	Potential Age Range of Customers	Class B Tavern Applicant Only: Age Restriction (If none, write 'None')
	Open Time (include a.m. or p.m.)	Close Time (include a.m. or p.m.)			
Sunday	CLOSED	CLOSED			
Monday	8 AM	5 PM	50 <sup>ARP</sup> <del>0</del>	16-75	
Tuesday	8 AM	5 PM	50 <sup>ARP</sup> <del>0</del>	16-75	
Wednesday	8 AM	5 PM	50 <sup>ARP</sup> <del>0</del>	16-75	
Thursday	8 AM	5 PM	50 <sup>ARP</sup> <del>0</del>	16-75	
Friday	8 AM	5 PM	50 <sup>ARP</sup> <del>0</del>	16-75	
Saturday	CLOSED	CLOSED			

An Extended Hours Establishment License is required for any convenience store, filling station, personal service establishment (such as tattoo, body piercing, salon, tailor, tanning, etc.), recording studio or restaurant which is open between the hours of 12:00 a.m. and 5:00 a.m.

Alcohol Establishments Permitted Hours of Operation: Class A: 8:00 am to 9:00 pm Sunday thru Saturday  
 Class B: 6:00 am to 2:00 am Sunday thru Thursday, 6:00 am to 2:30 am Friday & Saturday

Entertainment Outdoor Closing Hours: 10:00pm Sunday-Thursday; 12:00am Friday & Saturday; unless a different time, either earlier or later, is established by the Common Council in its approval of the licensee's plan of operation.

## 11. Signature(s)

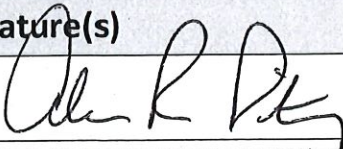
  
 Signature of Sole Proprietor, Partner, or 20% or more Shareholder  
 (If there are no 20% or more shareholders, Corporate Officer-print name/title and sign)

\_\_\_\_\_  
 Signature of additional partner or 20% or more shareholder

See Application Information for a complete list of all required application forms.



# SECONDHAND MOTOR VEHICLE DEALER LICENSE SUPPLEMENTAL PLAN OF OPERATION

Office of the City Clerk License Division  
200 E. Wells St. Room 105, Milwaukee, WI 53202  
(414) 286-2238 e-mail address: [license@milwaukee.gov](mailto:license@milwaukee.gov)

Legal Entity Name: RENASCENT SALVAGE MILWAUKEE LLC

Premises Address: 8501 W CALUMET RD

## SECTION 1 LICENSE TYPE

What type of license are you applying for? (check one)  Retail  Wholesale

## SECTION 2

Will you also be dealing in secondhand vehicle parts?  Yes  No

If wholesale, is the premises address a residential (home) address?  Yes  No

If yes, you must obtain a Home Occupational Statement from the Department of Neighborhood Services (414) 286-3874.

No vehicles can be parked and no customers are allowed at the premises.

The following questions in Section 2 do not apply to wholesale from a residential address. Go to Section 3.

Number of parking spaces available to customers/employees 20

Number of parking spaces that will be used for display/storage of Secondhand Motor Vehicles 5 <sup>APL</sup>

Do you understand that all vehicles associated with the business must be stored on the licensed premise?  Yes  No

What are your plans to ensure this requirement is met (check all that apply)?  Employee Training

Supervisor Monitoring  Fenced Lot  Keys Kept in Locked Box  Other: \_\_\_\_\_

Do you understand all maintenance/repair work to these vehicles must be confined to the licensed premise?  Yes  No

What are your plans to ensure this requirement is met (check all that apply)?  Employee Training

Supervisor Monitoring  Designated Repair Area  Other: \_\_\_\_\_

Do you understand all keys to used motor vehicles offered for sale must be kept in a secure lockbox inside the dealership building at all times when the dealership is not open for business?  Yes  No

What are your plans to ensure this requirement is met (check all that apply)?  Employee Training

Supervisor Monitoring  Other: \_\_\_\_\_

## SECTION 3 DISCLOSURE

Has any person on the application ever had a license relating to the activities licensed in Milwaukee Code of Ordinances Chapter 92 denied, not renewed, suspended, or revoked?  No  Yes

If yes, provide the circumstances and jurisdiction in which the event occurred (including a record of any actions from the State Department of Transportation and Financial Institutions relating to suspensions, revocations, forfeitures and warnings imposed by these departments relating to the operation of any automotive sales business by the applicant):

## SECTION 4 SIGNATURES

[Signature]  
Sole Proprietor, Partner, or 20% or more Shareholder  
(If there are no 20% or more shareholders,  
Corporate Officer-print name/title and sign)

\_\_\_\_\_  
Additional partner or 20% or more shareholder