

MIDWEST AIRLINES CENTER OUTDOOR EVENT AREA ADDITION MILWAUKEE, WI

CLIENT

Wisconsin Center District
400 W. Wisconsin Ave.
Milwaukee, WI 53203

DESIGNER

TN & Associates
1033 N. Mayfair Rd., Suite 200
Milwaukee, WI 53226

PLAN SET

SHEET 1 TITLE SHEET
SHEET 2 EXISTING SURVEY
SHEET 3 GRADING PLAN-WEST
SHEET 4 GRADING PLAN-EAST
SHEET 5 UTILITIES PLAN
SHEET 6 EROSION CONTROL PLAN
SHEET 7 LANDSCAPING PLAN
SHEET 8 SITE DETAILS

ISSUED FOR

#	DESCRIPTION	DATE
1	CONSTRUCTION AND CITY REVIEW	9/16/03

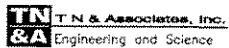

MIDWEST AIRLINES CENTER - OUTDOOR EVENTS AREA
TITLE SHEET

MIDWEST AIRLINES CENTER
PROPOSED EVENT AREA ADDITION
MILWAUKEE, WI

DWG NO:	XXXXXXXX
SHEET:	1 OF 8
DATE:	09/16/03
PROJ. ID:	2003131

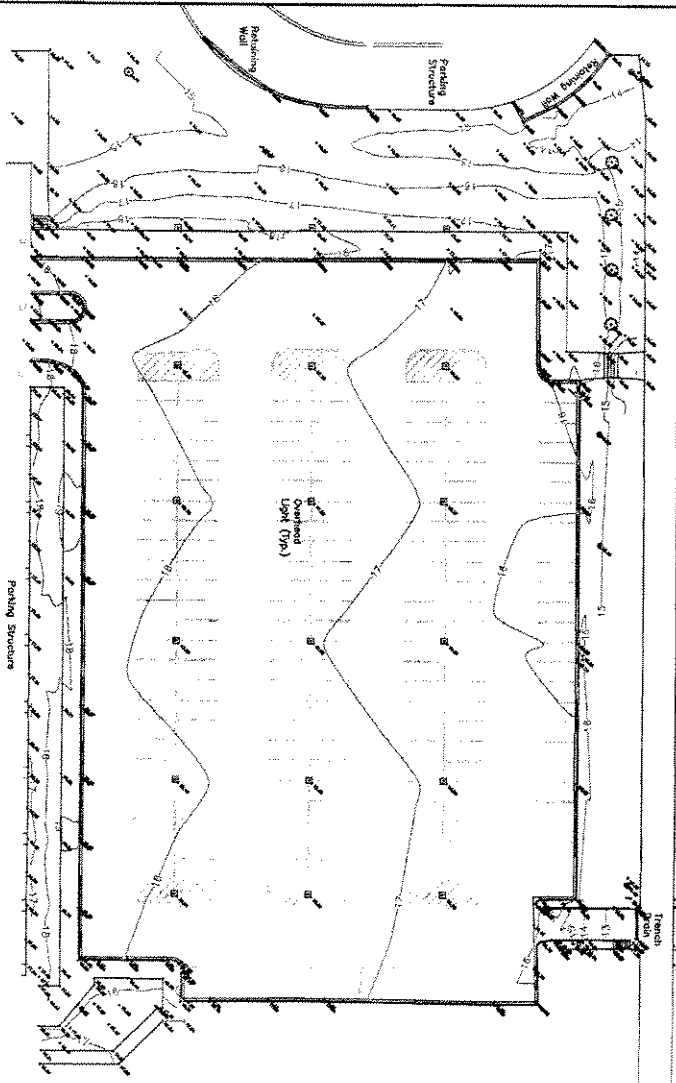

West Kibbourn Avenue



PLAT OF SURVEY - TOPO ONLY
 SURVEY FOR: WISCONSIN CENTER DISTRICT
 ADDRESS: MIDWEST AIRLINES CENTER
 400 W. WISCONSIN AVENUE
 MILWAUKEE, WI.

LEGAL DESCRIPTION:
 A BOUNDARY SURVEY WAS NOT INCLUDED AS PART OF THIS PLAN. EXISTING PARKING LOT IS WITHIN THE BOUNDARIES OF CITY OF MILWAUKEE CSM # 6244. HOWEVER, NO TITLE INFORMATION OR RESEARCH WAS CONDUCTED IN ORDER TO ESTABLISH BOUNDARIES.

- LEGEND**
- ⊙ MANHOLE
 - ⊠ LIGHT POLE
 - ⊗ TREE
 - INLET
 - ▲ SPOT ELEVATION

BENCHMARK USED: FIRE HYDRANT ON HW CORNER OF N. 4TH STREET AND W. KILBOURN AVENUE, NW FLANGE BOLT. ELEV=12.56.

I HEREBY CERTIFY THAT THIS MAP IS A CORRECT REPRESENTATION OF THE PARCEL SHOWN AND DESCRIBED HEREON, AND THAT TO THE BEST OF MY KNOWLEDGE, INFORMATION AND BELIEF, ALL INFORMATION IS TRUE AND ACCURATELY SHOWN HEREON.

DATED THIS 10th DAY OF SEPTEMBER, 2003

TN & Associates, Inc.
&A Engineering and Science

MIDWEST AIRLINES CENTER - OUTDOOR EVENT AREA
 EXISTING CONDITIONS SURVEY

MIDWEST AIRLINES CENTER
 PROPOSED EVENT AREA ADDITION
 MILWAUKEE, WI

DWG NO:	XXXXXXXX
SHEET:	2 OF 8
DATE:	09/16/03
PROJ. ID:	2003131

MATCH LINE - SHEET 3



WEST KILBOURN AVENUE

OUTDOOR EVENT AREA

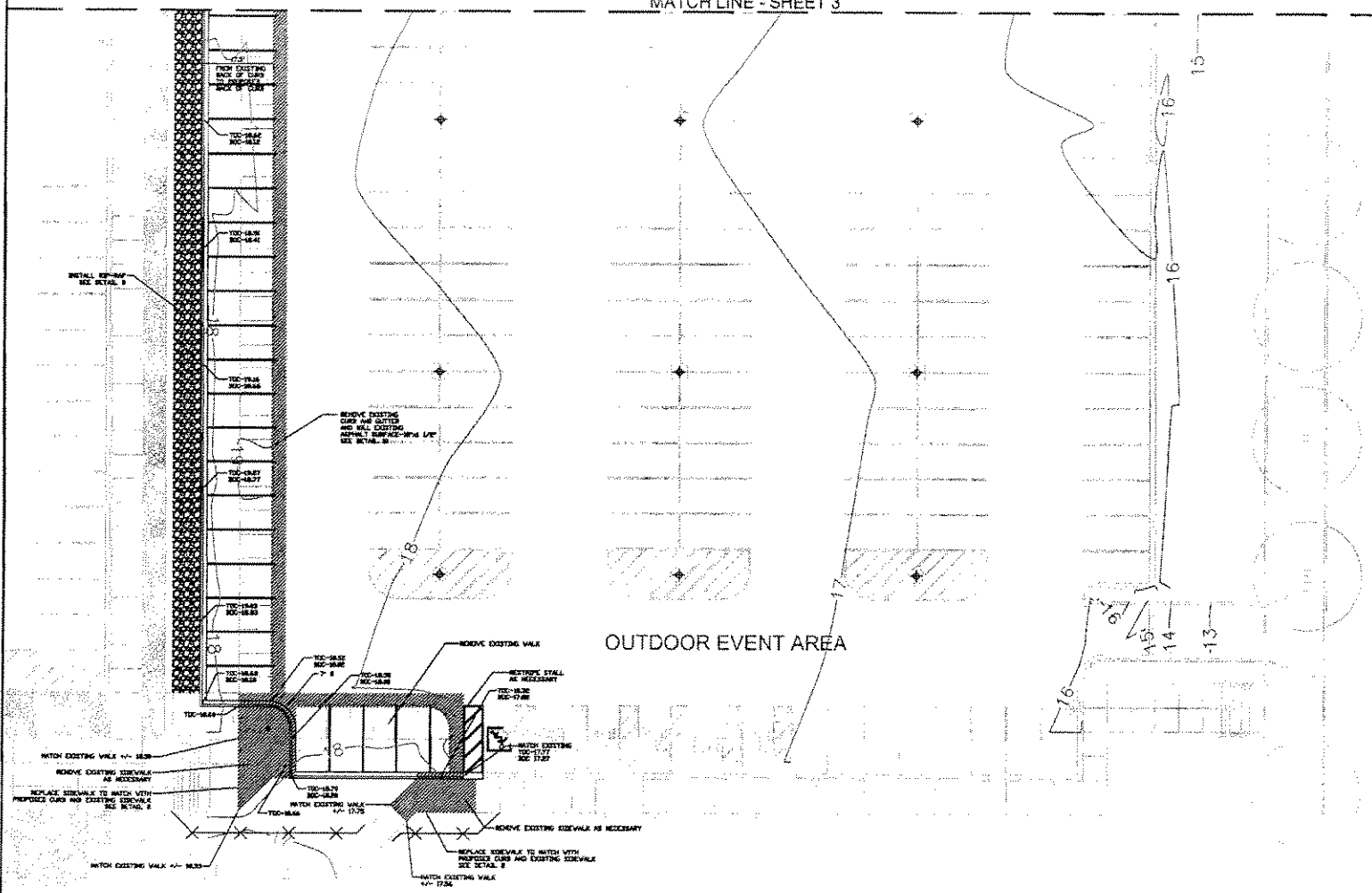

TNTN & Associates, Inc.
Engineering and Science

MIDWEST AIRLINES CENTER - OUTDOOR EVENT AREA
GRADING PLAN - EAST END

MIDWEST AIRLINES CENTER
PROPOSED EVENT AREA ADDITION
MILWAUKEE, WI

DWG NO:	XXXXXXXX
SHEET:	4 OF 8
DATE:	09/16/03
PROJ. ID:	2003131

FILE NAME: 13.DWG

NORTH SIXTH STREET

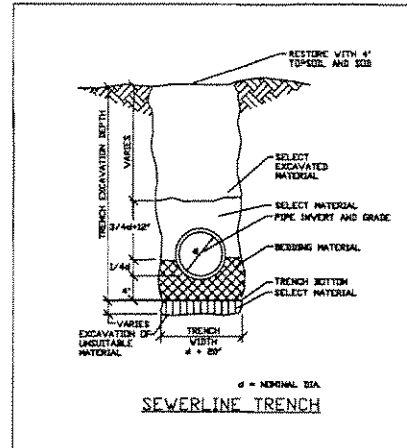
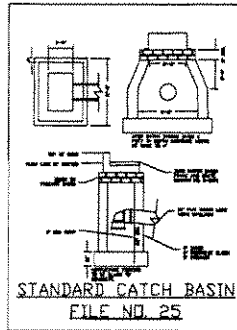

- NOTES**
1. THE UNDERGROUND UTILITY INFORMATION AS SHOWN HEREON IS BASED, IN PART, UPON INFORMATION FURNISHED BY UTILITY COMPANIES, THE LOCAL MUNICIPALITY, AND THE SURVEY OBTAINED FROM NATIONAL SURVEY & ENGINEERING 8/1/85. WHILE THIS INFORMATION IS BELIEVED TO BE RELIABLE, ITS ACCURACY CANNOT BE GUARANTEED NOR CERTIFIED. THE CONTRACTOR SHALL VERIFY ALL UTILITY INFORMATION PRIOR TO ANY CONSTRUCTION.
 2. MANHOLES, CLEANOUTS, AND VALVES SHALL BE CONSTRUCTED IN THE LOCATIONS SHOWN AND AS REQUIRED BY THE WISCONSIN ADMINISTRATIVE CODE LATEST EDITION, THE STANDARD SPECIFICATIONS FOR SEWER AND WATER CONSTRUCTION IN WISCONSIN LATEST EDITION, AND THE CITY OF MILWAUKEE REQUIREMENTS.
 3. THE CONTRACTOR SHALL MAKE ALL NECESSARY ADJUSTMENTS TO EXISTING, PROPOSED, OR RELOCATED STRUCTURES TO BRING THEM TO PROPOSED FINISHED SURFACE ELEVATION.
 4. PRIOR TO ANY CONSTRUCTION, THE CONTRACTOR SHALL INVESTIGATE ALL PROPOSED POINTS OF CONNECTION AND UTILITY CROSSINGS BETWEEN HIS WORK AND EXISTING WORK WHETHER ON THE SURFACE OR BELOW GROUND. IN THE CASE OF EXISTING BURIED FACILITIES, THE CONTRACTOR, AFTER GIVING THREE WORKING DAYS NOTICE TO THE APPROPRIATE GOVERNMENTAL UNITS, AND AFFECTED UTILITIES, SHALL CAREFULLY UNCOVER THE EXISTING FACILITIES AT THE POINTS OF CONNECTION AND VERIFY ADEQUATE UTILITY CROSSING CLEARANCES. THE CONTRACTOR SHALL COMPARE THE ACTUAL LOCATION AND ELEVATION OF THE EXISTING FACILITIES TO THE PLAN LOCATION AND ELEVATION OF EXISTING AND PROPOSED FACILITIES. IF EXISTING IF EXISTING UTILITY LINES ARE ENCOUNTERED THAT CONFLICT WITH THE NEW CONSTRUCTION, THE CONTRACTOR SHALL MAKE THE NECESSARY ADJUSTMENTS IN LINE AND GRADE OF THE PROPOSED WORK.
 5. SITE UTILITY CONTRACTOR TO FURNISH AND INSTALL ALL NECESSARY PIPE, FITTINGS, AND MATERIALS NECESSARY TO MAKE THE PROPER CONNECTIONS AT NEW COMBINED CATCH BASIN CURB LINE LOCATIONS.
 6. WHERE CONNECTIONS ARE MADE TO EXISTING SEWERS OR LATERALS, THE CONTRACTOR SHALL ADJUST INVERT ELEVATIONS AS REQUIRED FOLLOWING CONNECTION VERIFICATION.

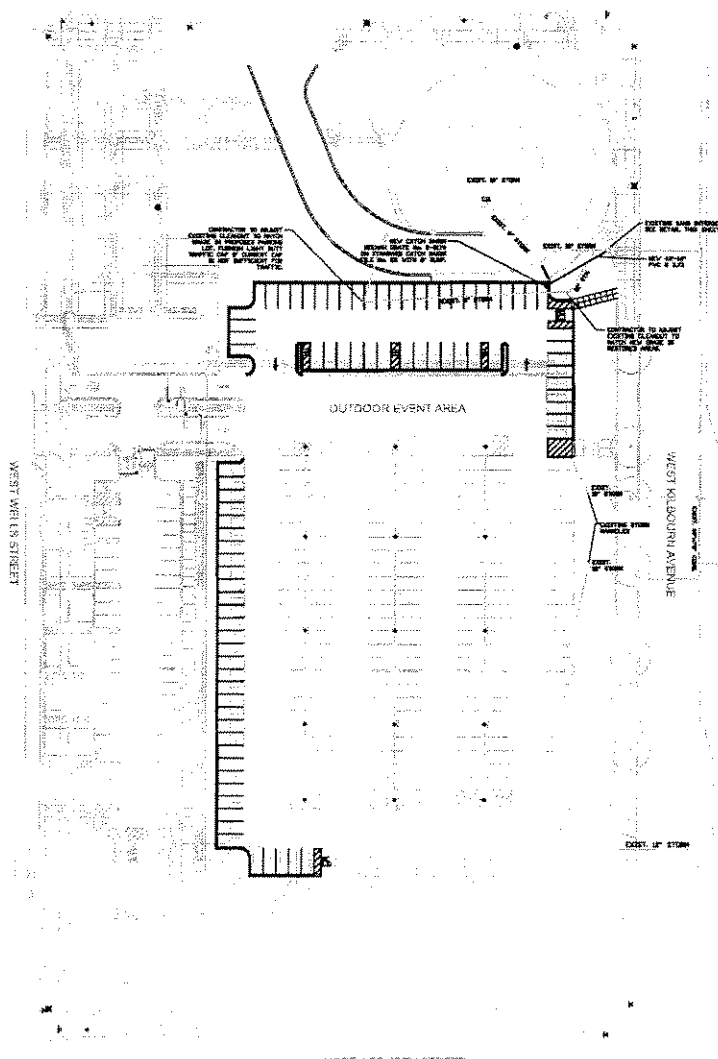
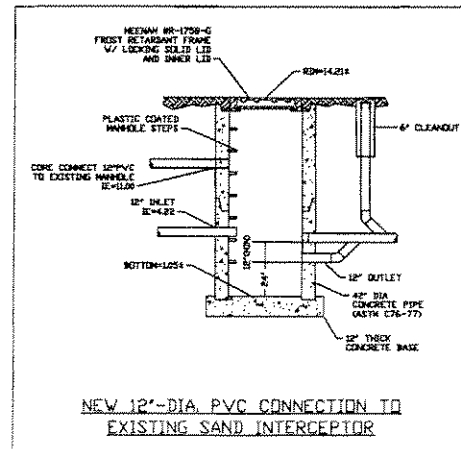

NORTH FOURTH STREET

T&A TN & Associates, Inc.
Engineering and Science

MIDWEST AIRLINES CENTER - OUTDOOR EVENT AREA
UTILITIES PLAN

MIDWEST AIRLINES CENTER
PROPOSED EVENT AREA ADDITION
MILWAUKEE, WI

DWG NO:	XXXXXXXX
SHEET:	5 OF 8
DATE:	09/16/03
PROJ. ID:	2003131

REF NAME: 2-DWG

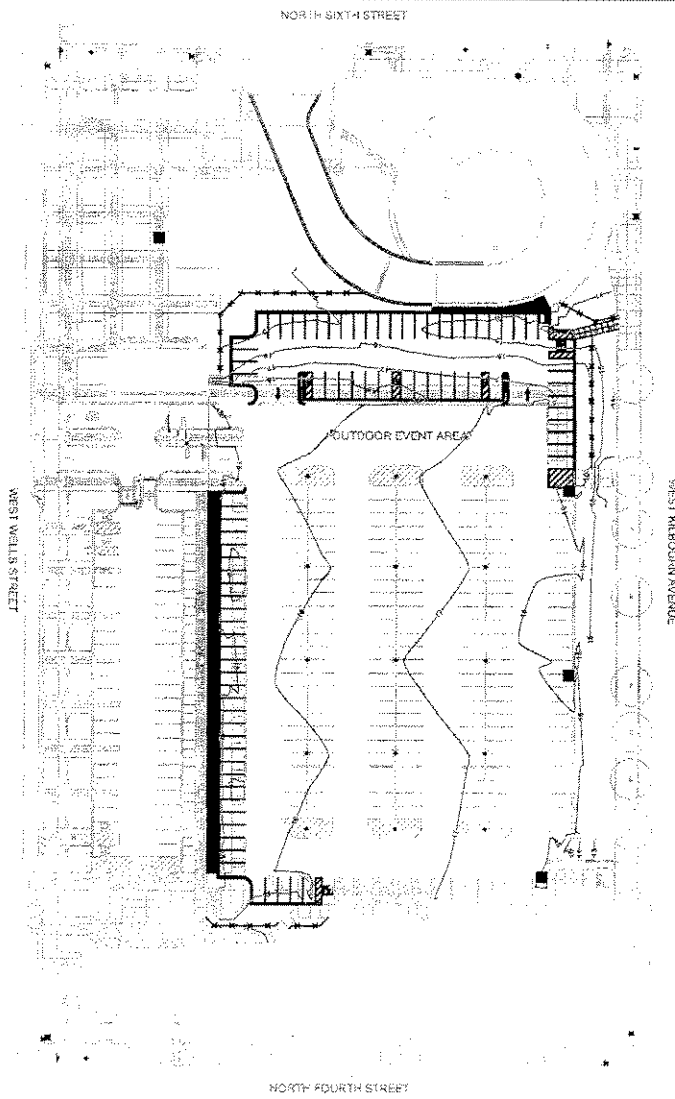

- LEGEND**
- ✂ PROPOSED SILT FENCE
 - PROPOSED GRATE SCREEN AT EXISTING CATCH BASIN
 - ▣ PROPOSED GRATE SCREEN AT PROPOSED CATCH BASIN

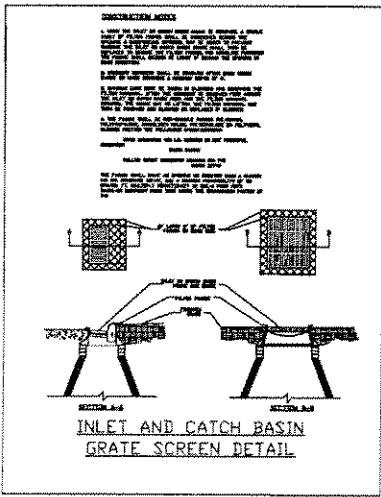
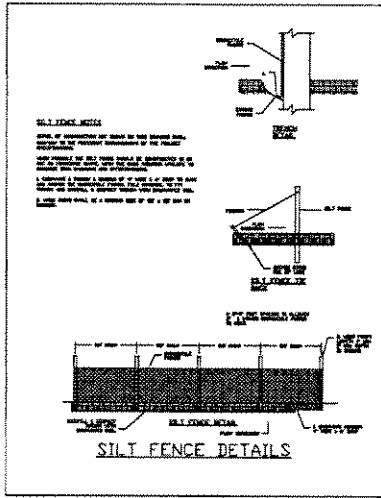

- NOTES**
- EXISTING TOPOGRAPHIC SURVEY OF PARKING LOT AND ADJACENT AREAS PERFORMED BY TN & ASSOCIATES 8-3-03.
- EROSION CONTROL NOTES**
- PERIODIC INSPECTION AND NEEDED MAINTENANCE OF ALL EROSION CONTROL FACILITIES SHALL BE PROVIDED AFTER EACH RAIN EVENT.
 - AT A MINIMUM ALL EROSION AND SEDIMENT CONTROL MEASURES SHALL BE CONSTRUCTED AND MAINTAINED IN ACCORDANCE WITH THE WISCONSIN BEST SITE CONSTRUCTION PRACTICES HANDBOOK. LOCAL REQUIREMENTS SHALL GOVERN WHERE THEY EXCEED THESE REQUIREMENTS.

TN & Associates, Inc.
Engineering and Science

**MIDWEST AIRLINES CENTER - OUTDOOR EVENT AREA
EROSION CONTROL PLAN**

MIDWEST AIRLINES CENTER
PROPOSED EVENT AREA ADDITION
MILWAUKEE, WI

DWG NO: XXXXXXXX
SHEET: 6 OF 8
DATE: 09/16/03
PROJ. ID: 2003131

NORTH 53X14 E' REET

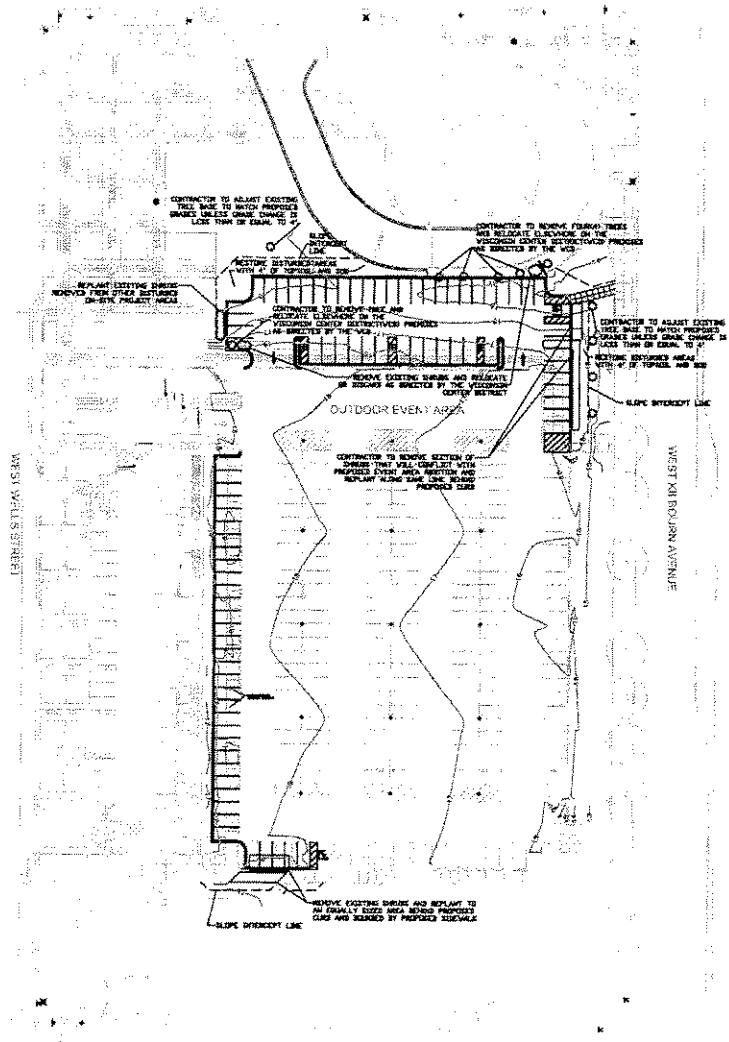
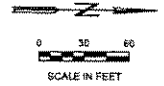

NORTH 14 FOURTH STREET

TN & Associates, Inc.
EA Engineering and Science

MIDWEST AIRLINES CENTER - OUTDOOR EVENT AREA
 LANDSCAPING PLAN

MIDWEST AIRLINES CENTER
 PROPOSED EVENT AREA ADDITION
 MILWAUKEE, WI

DWG NO:	XXXXXXXX
SHEET:	7 OF 8
DATE:	09/16/03
PROJ. ID:	2003131

FILE NAME: K203C

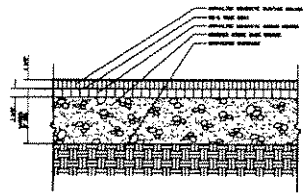

1 ASPHALT PAVEMENT
SHEET 3 AND 4
DETAIL
NOT TO SCALE

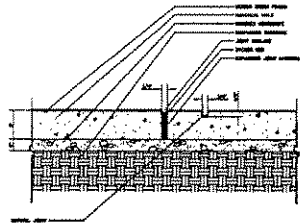

2 STANDARD DUTY CONCRETE WALK AND JOINTS
SHEET 3 AND 4
DETAIL
NOT TO SCALE

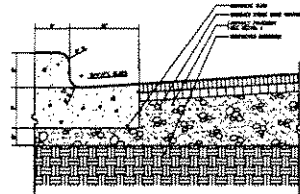

3 18" CONCRETE CURB AND GUTTER
SHEET 3 AND 4
DETAIL
NOT TO SCALE

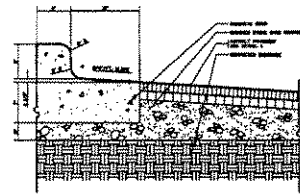

4 REVERSE 18" CONCRETE CURB
SHEET 3 AND 4
DETAIL
NOT TO SCALE

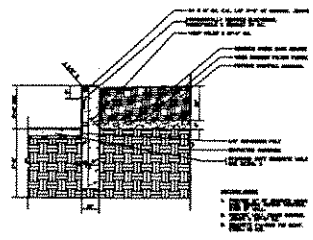

5 PLANTER WALL
SHEET 7
DETAIL
NOT TO SCALE

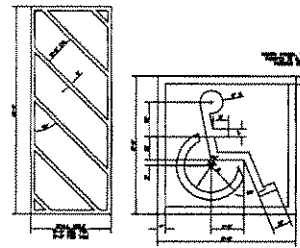

6 ACCESSIBLE PARKING (H.C.)
SHEET 3 AND 4
DETAIL
NOT TO SCALE

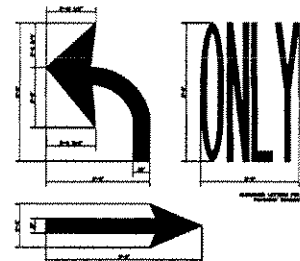

7 TYP. PAVEMENT MARKINGS
SHEET 1
DETAIL
NOT TO SCALE

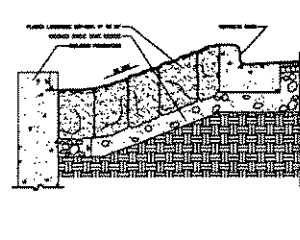

8 RIP-RAP
SHEET 3 AND 4
DETAIL
NOT TO SCALE

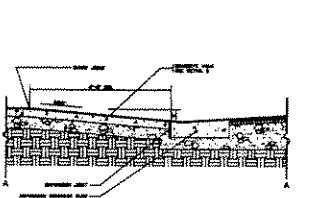

9 CURB AND SIDEWALK RAMP
SHEET 5
DETAIL
NOT TO SCALE

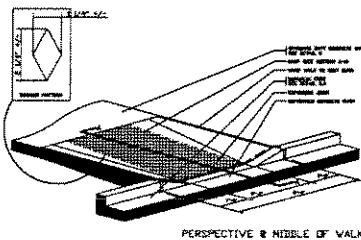

PERSPECTIVE & NIBBLE OF WALK

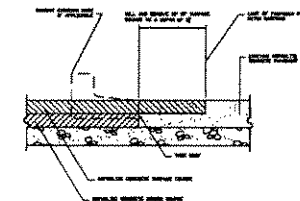

10 BUTT JOINT
SHEET 3 AND 4
DETAIL
NOT TO SCALE



Photo 1. View of the site from sidewalk looking north toward the Milwaukee Theater (left) and the U.S. Cellular Arena (right). The western edge of the existing 188-space parking lot is visible on the right. The area of the proposed 86-space expansion would be immediately to the west of the existing parking (in the center and to the left as viewed in this image). One of the pedestrian links, which would be relocated to accommodate the expansion, is clearly shown in the center of this image.

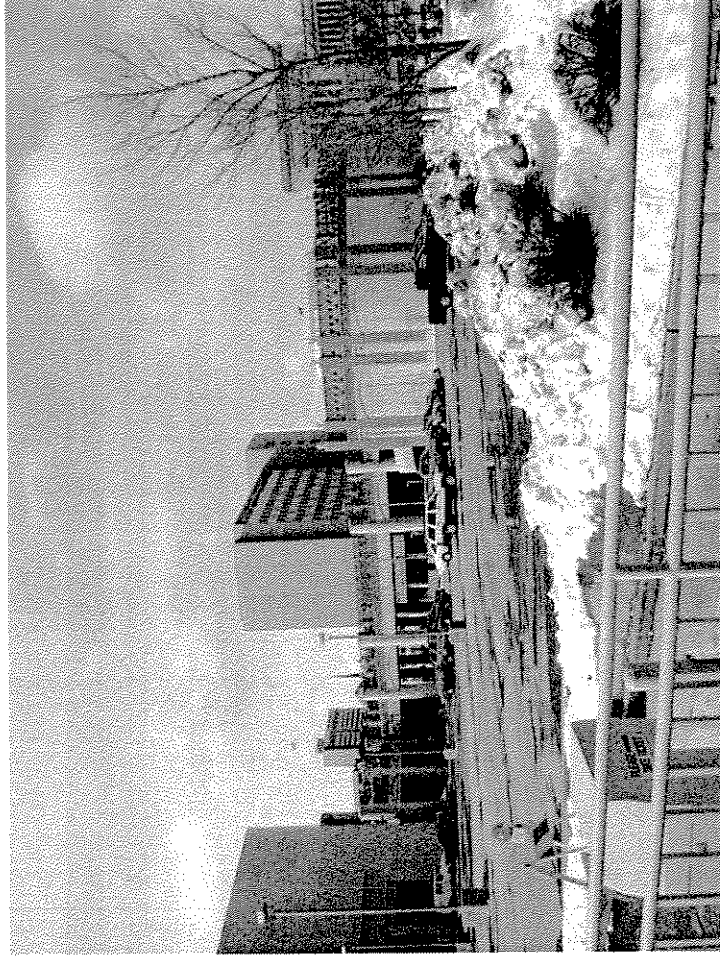

Photo 2. This image shows the existing parking lot and the landscape area that buffers the public sidewalk (just out of view to the right) from the existing parking (left). The gate-controlled access drive from Kilbourn is visible in the foreground. The loading area for the Midwest Airlines Center is visible in the background. The proposed expansion would occur between the existing parking and the loading dock.