

Features

- Trifab® VG 451/451T is 4-1/2" deep with a 2" sightline
- Front, Center, Back or Multi-Plane glass applications
- Flush glazed from either the inside or outside
- Screw Spline, Shear Block, Stick or Type-B fabrication
- SSG / Weatherseal option
- Isolock® lanced and debridged thermal break option with Trifab® VG 451T
- Infill options up to 1-1/8" thickness
- Permanodic® anodized finishes in 7 choices
- Painted finishes in standard and custom choices

Optional Features

- High performance interlocking flashing
- Acoustical rating per AAMA 1801 and ASTM E 1425
- Project specific U-factors (See Thermal Charts)

Product Applications

- Storefront, Ribbon Window or Punched Openings
- Single-span
- Integrated entrance framing allowing Kawneer standard entrances or other specialty entrances to be incorporated
- Kawneer Sealair® windows or GLASSvent® are easily incorporated

For specific product applications,
Consult your Kawneer representative.

Laws and building and safety codes governing the design and use of glazed entrance, window, and curtain wall products vary widely. Kawneer does not control the selection of product configurations, operating hardware, or glazing materials, and assumes no responsibility therefor.

Kawneer reserves the right to change configuration without prior notice when deemed necessary for product improvement.
© Kawneer Company, Inc., 2012

SCALE 3" = 1'-0"

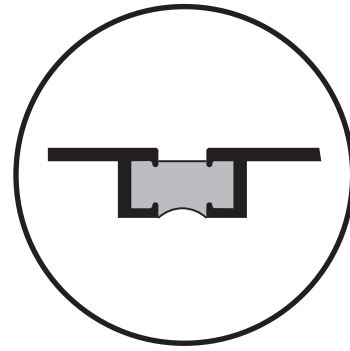
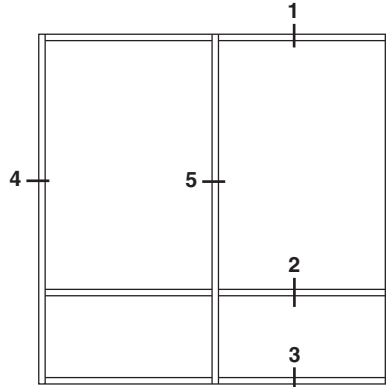

*Note: See Misc. Details for Thermal Pocket Filler and Thermal Flashing.

ELEVATION IS NUMBER KEYED TO DETAILS

NUMBERS IN BRACKETS ARE THERMALLY BROKEN MEMBERS

SCREW SPLINE

CAD Details (TF451) = TF_VG_451-SS-Center--CAD.zip
(TF451T) = TF_VG_451T-SS-Center--CAD.zip

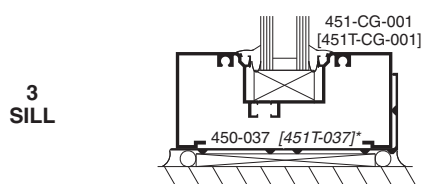
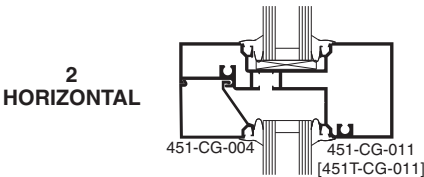
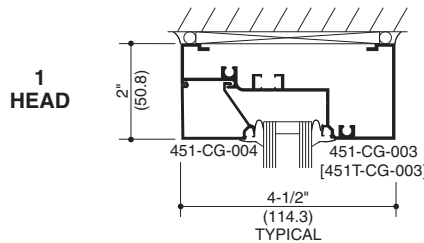
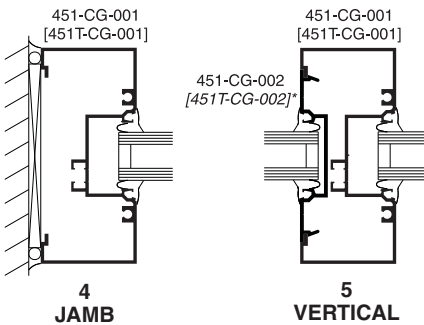

*See Page 14 for Thermal Flashing and Optional High Performance Flashing

SHEAR BLOCK

CAD Details (TF451) = TF_VG_451-SB-Center--CAD.zip
(TF451T) = TF_VG_451T-SB-Center--CAD.zip

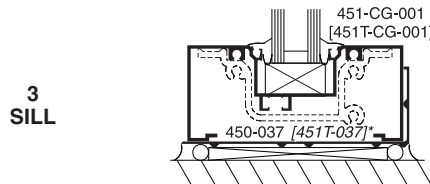
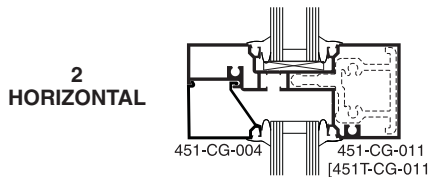
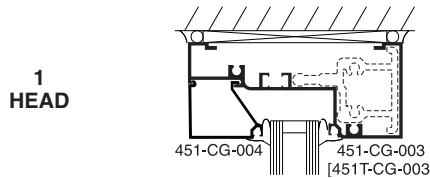
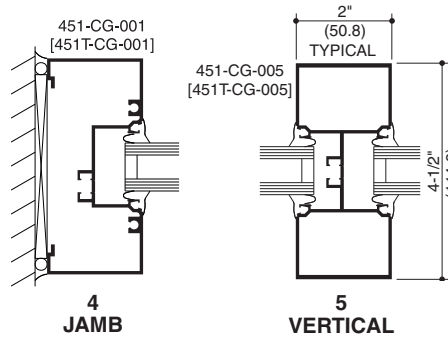

*See Page 14 for Thermal Flashing and Optional High Performance Flashing

STICK

CAD Details (TF451) = TF_VG_451-Stick-Center--CAD.zip
(TF451T) = TF_VG_451T-Stick-Center--CAD.zip

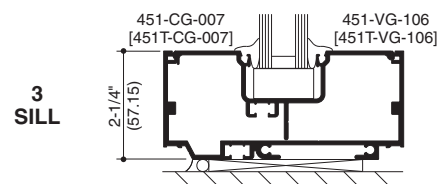
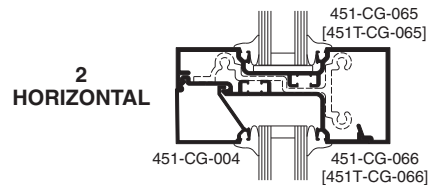
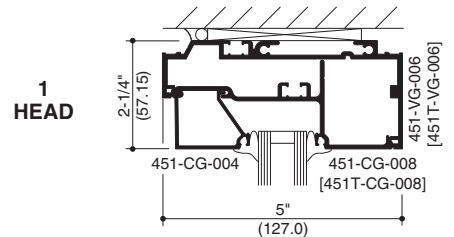
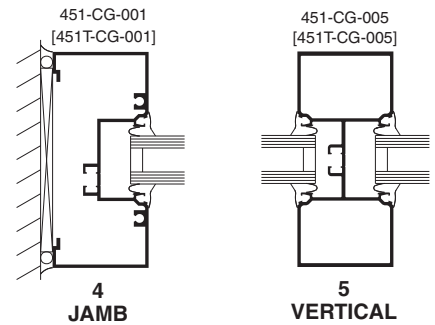

Laws and building and safety codes governing the design and use of glazed entrance, window, and curtain wall products vary widely. Kawneer does not control the selection of product configurations, operating hardware, or glazing materials, and assumes no responsibility therefor.

Kawneer reserves the right to change configuration without prior notice when deemed necessary for product improvement.
 © Kawneer Company, Inc., 2012

SCALE 3" = 1'-0"

CAD Details - SCREW SPLINE

(TF451) = TF_VG_451-SS-Center--CAD.zip
 (TF451T) = TF_VG_451T-SS-Center--CAD.zip

CAD Details - SHEAR BLOCK

(TF451) = TF_VG_451-SB-Center--CAD.zip
 (TF451T) = TF_VG_451T-SB-Center--CAD.zip

CAD Details - STICK

(TF451) = TF_VG_451-Stick-Center--CAD.zip
 (TF451T) = TF_VG_451T-Stick-Center--CAD.zip

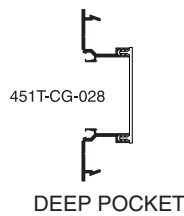
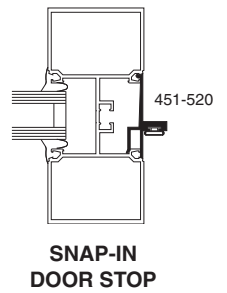
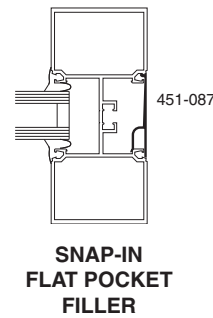
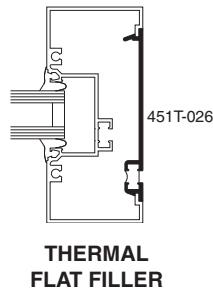
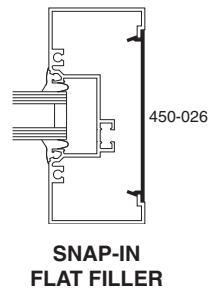
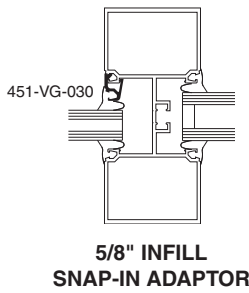
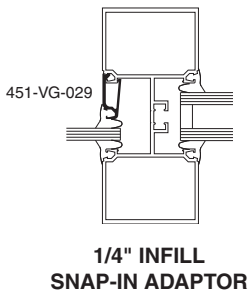
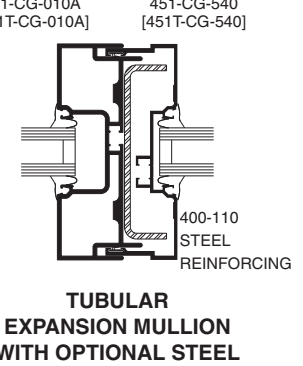
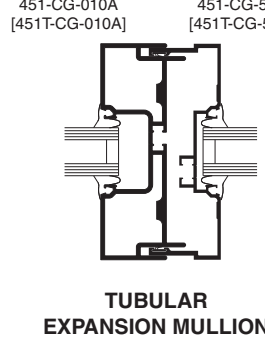
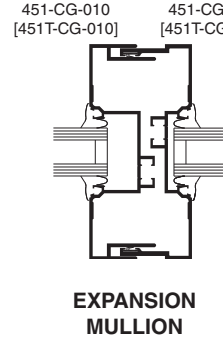
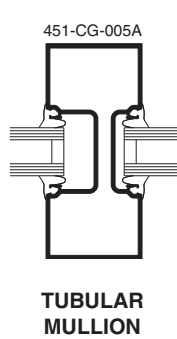
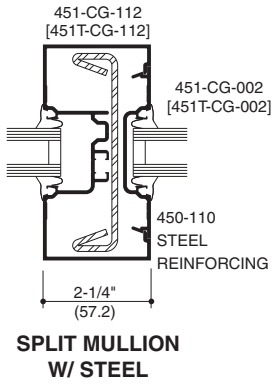

THERMAL POCKET FILLERS

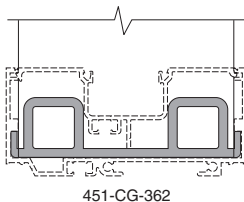
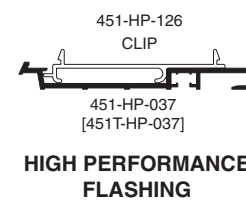
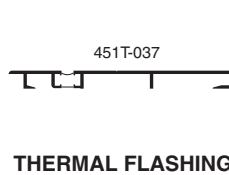

NOTE:
 If the end reaction of the mullion (mullion spacing (ft.) times height (ft.) times specified windload (psf), divided by two) is more than 500 LBS., the optional mullion anchor must be used. Consult Application Engineering.

NOTE:
 Mullion Anchor not used with Lightweight Receptor.

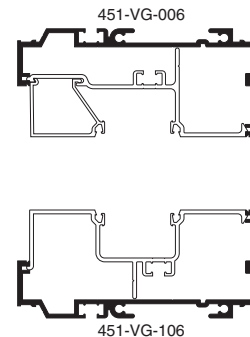
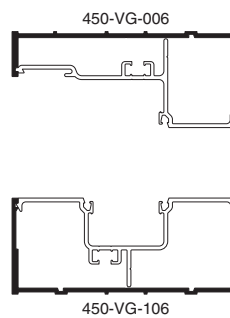

Law and building and safety codes governing the design and use of glazed entrance, window, and curtain wall products vary widely. Kawneer does not control the selection of product configurations, operating hardware, or glazing materials, and assumes no responsibility therefor.

Kawneer reserves the right to change configuration without prior notice when deemed necessary for product improvement.
 © Kawneer Company, Inc., 2012

SCALE 3" = 1'-0"

CAD Details - **SCREW SPLINE**

(TF451) = TF_VG_451-SS-Center--CAD.zip
(TF451T) = TF_VG_451T-SS-Center--CAD.zip

CAD Details - **SHEAR BLOCK**

(TF451) = TF_VG_451-SB-Center--CAD.zip
(TF451T) = TF_VG_451T-SB-Center--CAD.zip

CAD Details - **STICK**

(TF451) = TF_VG_451-Stick-Center--CAD.zip
(TF451T) = TF_VG_451T-Stick-Center--CAD.zip

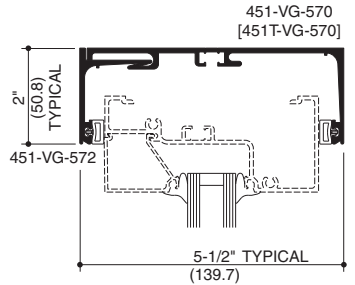

STANDARD HEAD COMPENSATING RECEPTOR

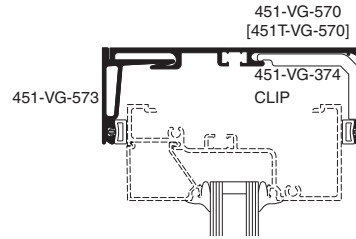

HEAVY WEIGHT HEAD COMPENSATING RECEPTOR

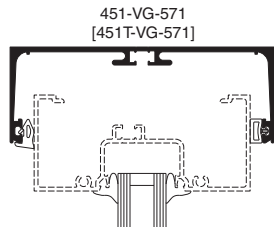

ONE PIECE HEAD COMPENSATING RECEPTOR

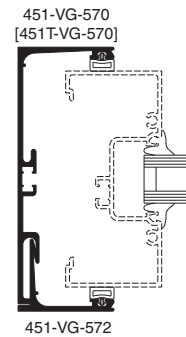

JAMB COMPENSATING RECEPTOR

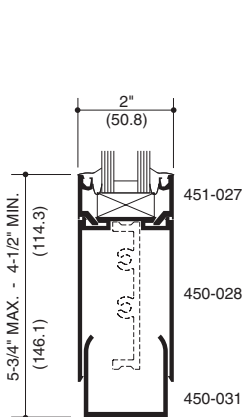

***NARROW SIDELITE BASE**

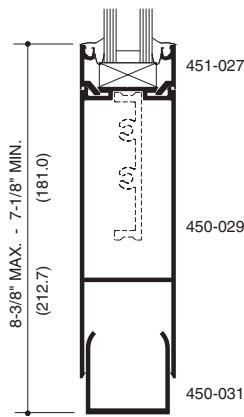

***NARROW SIDELITE BASE**

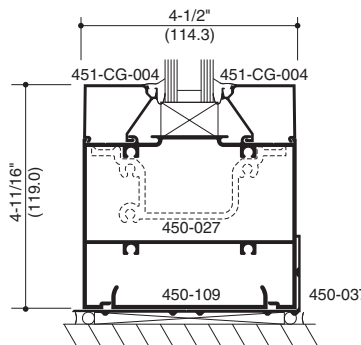

SIDELITE BASE

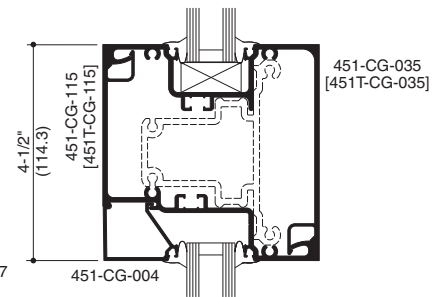

4-1/2" x 4-1/2" HORIZONTAL

SIDELITE BASES ARE NON-THERMAL APPLICATIONS

*NARROW SIDELITE BASES REQUIRE THE USE OF NON-THERMAL 2-PIECE VERTICALS ONLY.

NOTE: SIDELITE BASES SHOWN ARE FOR USE WITH SCREW SPLINE AND SHEAR BLOCK SYSTEMS ONLY.

Laws and building and safety codes governing the design and use of glazed entrance, window, and curtain wall products vary widely. Kawneer does not control the selection of product configurations, operating hardware, or glazing materials, and assumes no responsibility therefor.

Kawneer reserves the right to change configuration without prior notice when deemed necessary for product improvement.
© Kawneer Company, Inc., 2012

SCALE 3" = 1'-0"

CAD Details - ENTRANCE

(TF451) = TF_VG_451_Ent-Center--CAD.zip

(TF451T) = TF_VG_451T_Ent-Center--CAD.zip

TRIFAB® VG 451 FRAMING INCORPORATING KAWNEER® "190" DOORS.

DOOR FRAMING NON-THERMAL ONLY

NOTE: OTHER TYPES OF KAWNEER DOORS MAY BE USED WITH THIS FRAMING SYSTEM. SEE ENTRANCE DETAILS FOR ADDITIONAL INFORMATION.

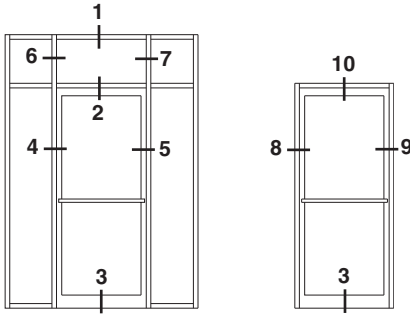

ELEVATIONS ARE NUMBER KEYED TO DETAILS

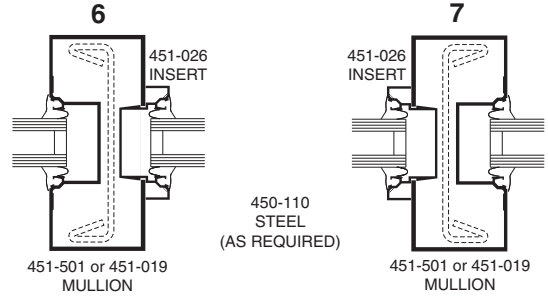

TRANSOM JAMBS

Transom area for both double or single acting doors with glass surround. Jambs above transom bar are routed out to accept glass holding insert with or without steel reinforcing.

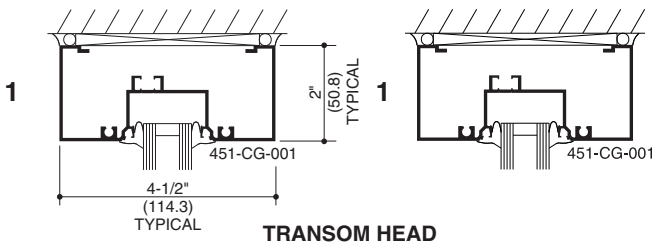

TRANSOM HEAD

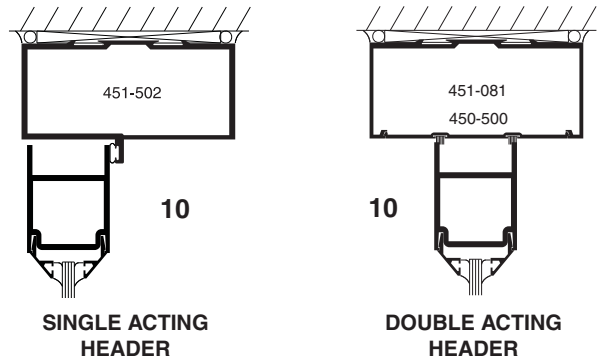

SINGLE ACTING HEADER

DOUBLE ACTING HEADER

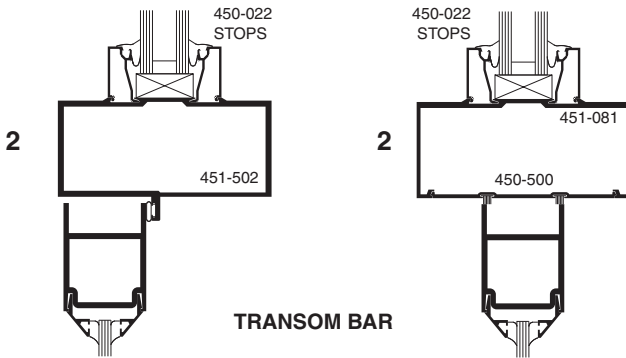

TRANSOM BAR

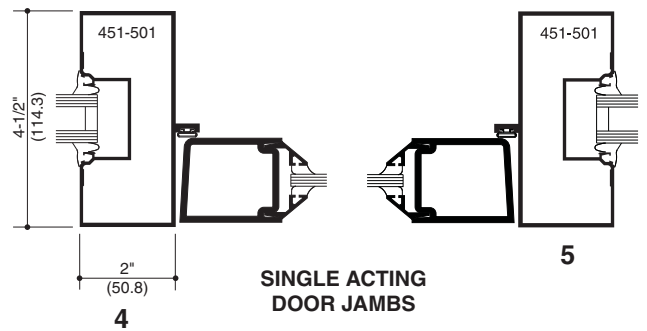

SINGLE ACTING DOOR JAMBS

5

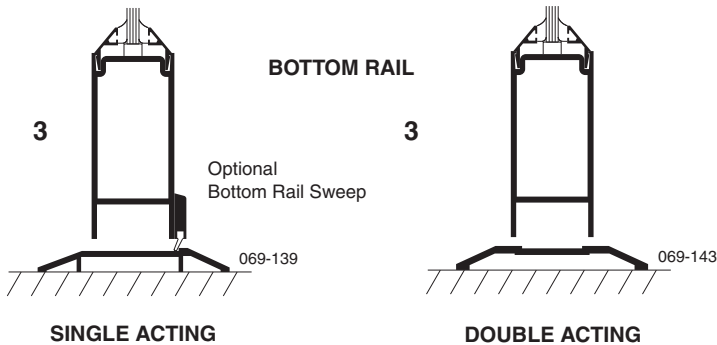

SINGLE ACTING

DOUBLE ACTING

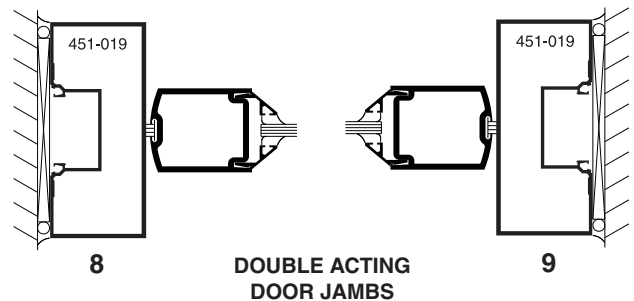

DOUBLE ACTING DOOR JAMBS

9

Laws and building and safety codes governing the design and use of glazed entrance, window, and curtain wall products vary widely. Kawneer does not control the selection of product configurations, operating hardware, or glazing materials, and assumes no responsibility therefor.

Kawneer reserves the right to change configuration without prior notice when deemed necessary for product improvement.
© Kawneer Company, Inc., 2012

Features

- 190 narrow stile has 2-1/8" (54) vertical stile, 2-1/4" (57.2) top and 3-7/8" (98.4) bottom rail
- 350 medium stile has 3-1/2" (88.9) vertical stile, 3-1/2" (88.9) top and 6-1/2" (165.1) bottom rail
- 500 wide stile has 5" (127) vertical stile, 5" (127) top and 6-1/2" (165.1) bottom rail
- Door is 1-3/4" (44.5) deep
- Dual moment welded corner construction
- Single or double acting
- Infills range from 1/4" (6.4) to 1" (25.4)
- Offset pivots, butt hinges, continuous geared hinge or center pivots
- MS locks or panic hardware
- Surface mounted or concealed closers
- Architects Classic push/pulls
- Adjustable astragal utilizing pile weathering with polymeric fin at meeting stiles
- Polymeric bulb weatherstripping in door frames
- Permanodic™ anodized finishes in seven choices
- Painted finishes in standard and custom choices

Optional Features

- Paneline™ exit device or Paneline™ EL exit device
- Wide variety of bottom rail and cross rail

Product Applications

- 190 narrow stile - engineered for moderate traffic in applications such as offices and stores
- 350 medium stile - provides extra strength for schools, institutions and other high traffic applications
- 500 wide stile - creates a monumental visual statement for banks, libraries or buildings that experience heavy traffic conditions

For specific product applications,
Consult your Kawneer representative.

SCALE 3" = 1' 0"

190 NARROW STILE

350 MEDIUM STILE

500 WIDE STILE

STANDARD LOCATIONS

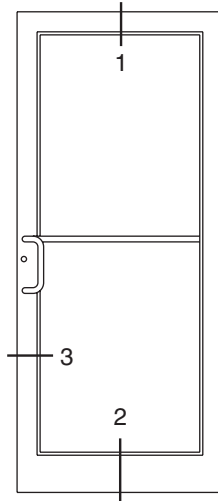
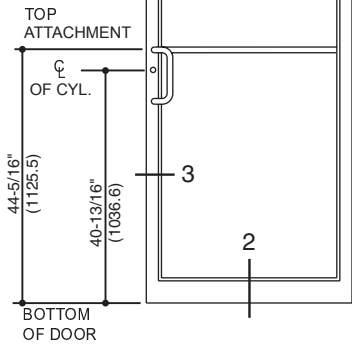

STANDARD LOCATIONS

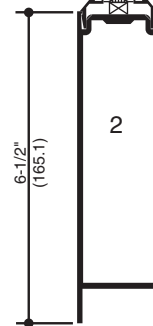
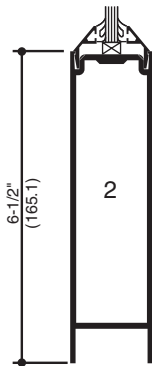
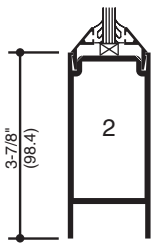
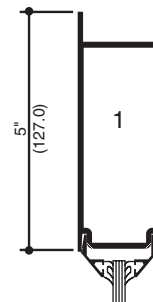
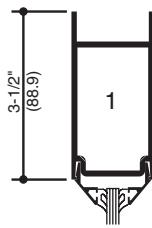
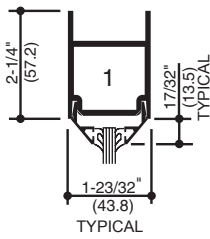
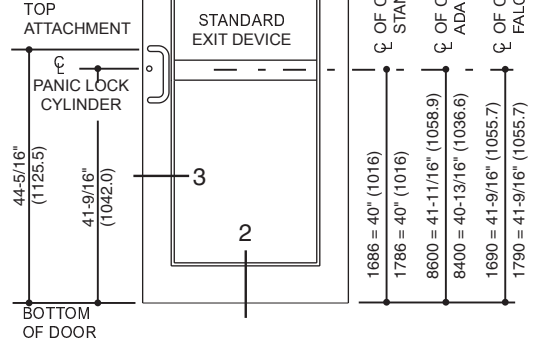

SINGLE ACTING



SINGLE ACTING



SINGLE ACTING

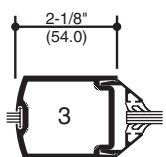

DOUBLE ACTING

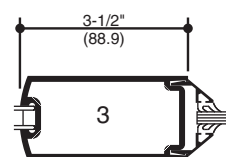

DOUBLE ACTING

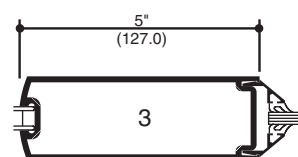

DOUBLE ACTING

Laws and building and safety codes governing the design and use of glazed entrance, window, and curtain wall products vary widely. Kawneer does not control the selection of product configurations, operating hardware, or glazing materials, and assumes no responsibility therefor.

Kawneer reserves the right to change configuration without prior notice when deemed necessary for product improvement.

© Kawneer Company, Inc., 2015

REFER TO HARDWARE SECTION FOR COMPLETE HARDWARE INFORMATION.

ARCHITECTS CLASSIC (PUSH PULL SETS)

SINGLE ACTING DOORS USE A PULL HANDLE AND PUSH BAR AS STANDARD
 DOUBLE ACTING DOORS USE CP PUSH BARS BACK TO BACK AS STANDARD.

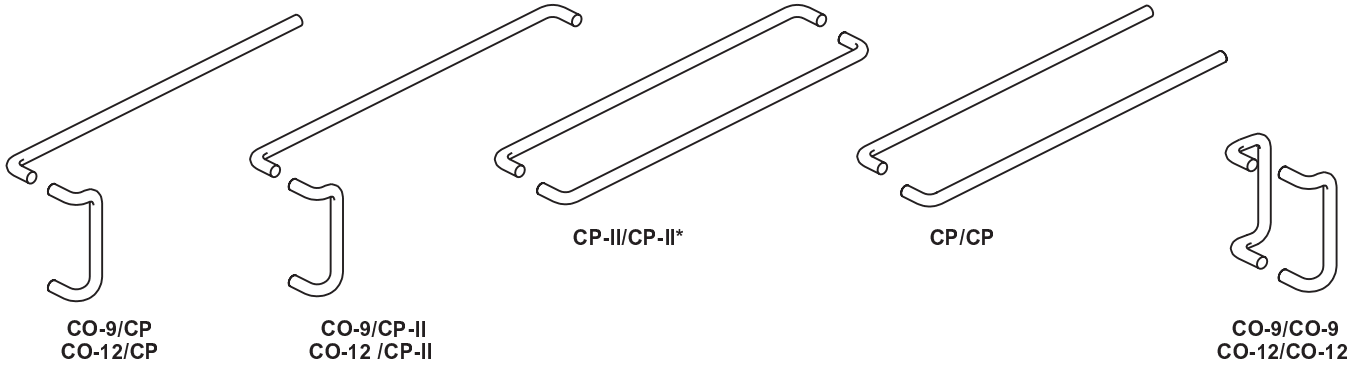

ARCHITECTS CLASSIC (COMPONENTS)

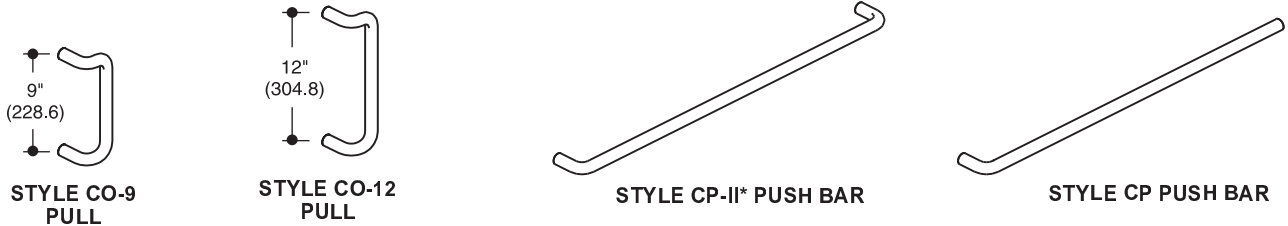

* CP-II PUSH BAR IS NOT TO BE USED FOR BACK TO BACK MOUNTING ON D/A DOORS.

EXIT DEVICES

KAWNEER PANELINE™ / PANELINE™ EL

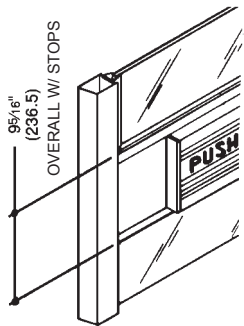

STYLE "CPN" PULL ON EXTERIOR OF DOOR

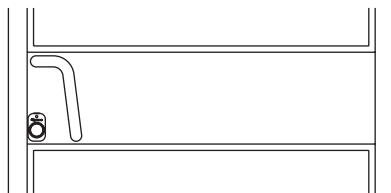

EXTERIOR VIEW OF 190 DOOR (350/500 SIMILAR)
 "CPN" PULL AND OPTIONAL CYLINDER GUARD SHOWN.

SEE PAGE 13 AND 14 FOR COMPLETE
 PANELINE™ INFORMATION

EXIT DEVICES AND PULLS

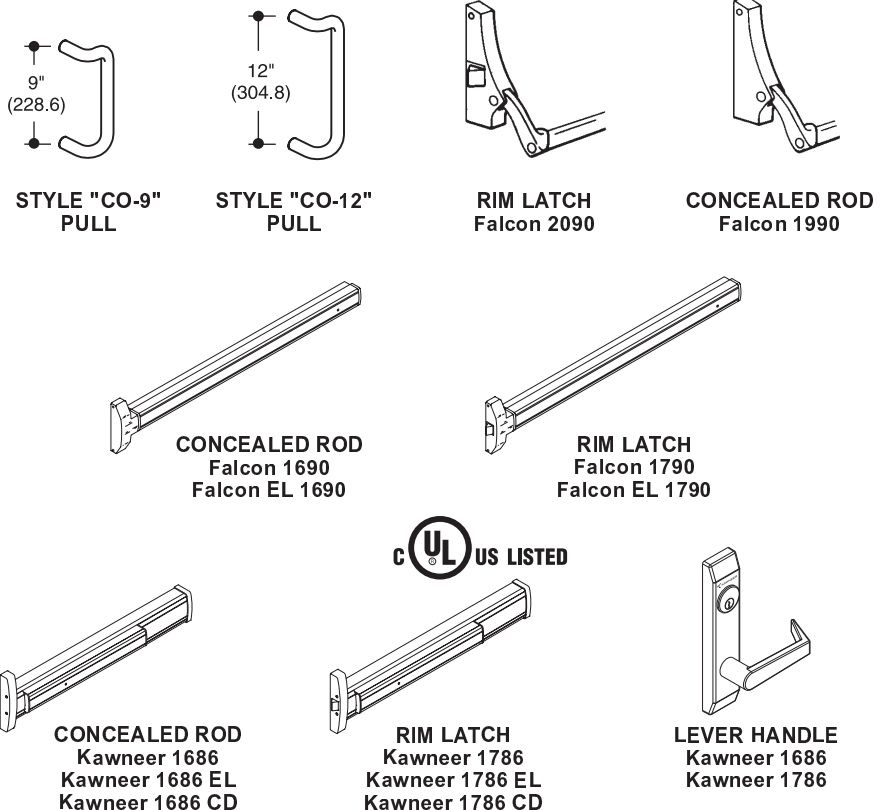

Laws and building and safety codes governing the design and use of glazed entrance, window, and curtain wall products vary widely. Kawneer does not control the selection of product configurations, operating hardware, or glazing materials, and assumes no responsibility therefor.

Kawneer reserves the right to change configuration without prior notice when deemed necessary for product improvement.
 © Kawneer Company, Inc., 2015

SCALE 3" = 1' 0"

HORIZONTAL / VERTICAL CROSS RAILS

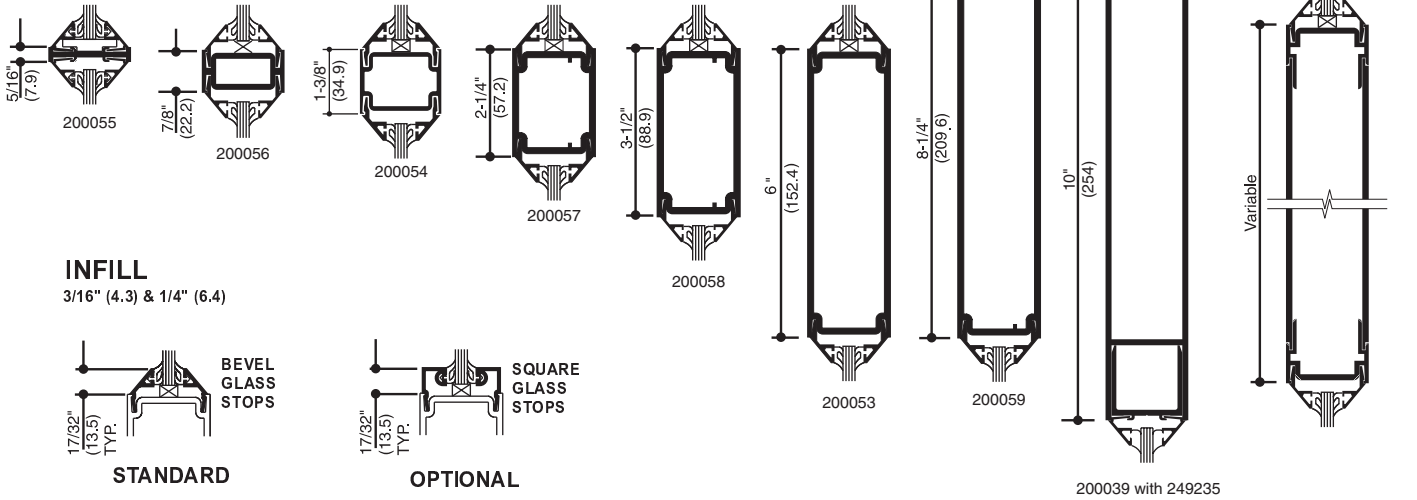

INFILL

3/16" (4.3) & 1/4" (6.4)



INFILL OPTIONS

5/16" (7.9) & 3/8" (9.5)

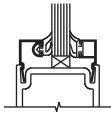

7/16" (11.1) & 1/2" (12.7)

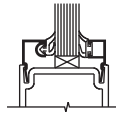

9/16" (14.3) & 5/8" (15.9)

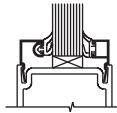

11/16" (17.5) & 3/4" (19.0)

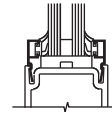

15/16" (23.8) & 1" (25.4)

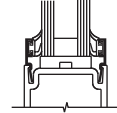

ACCESSORY ITEMS

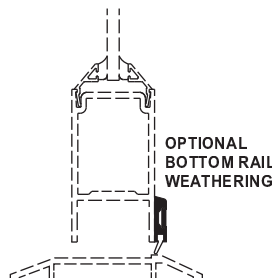
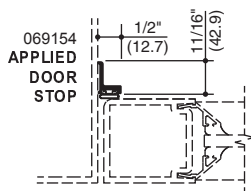
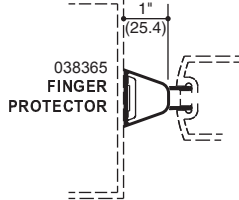
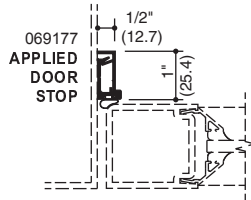

THRESHOLDS

APPLICATION

FOR SINGLE ACTING DOOR

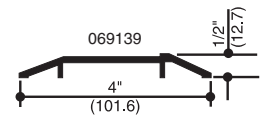

FOR CENTER HUNG CONCEALED CLOSER

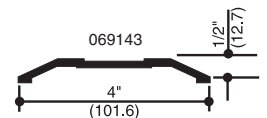

APPLIED STOP FOR SINGLE ACTING DOOR



FOR CENTER HUNG FLOOR CLOSERS

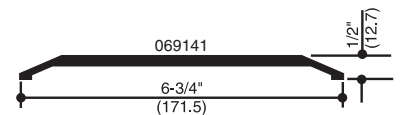

*SOME BUILDING CODES LIMIT THRESHOLD HEIGHT TO 1/2" (12.7) MAX.

Laws and building and safety codes governing the design and use of glazed entrance, window, and curtain wall products vary widely. Kawneer does not control the selection of product configurations, operating hardware, or glazing materials, and assumes no responsibility therefor.

Kawneer reserves the right to change configuration without prior notice when deemed necessary for product improvement.
© Kawneer Company, Inc., 2015

SCALE 3" = 1' 0"

STANDARD BOTTOM RAILS

Rail heights shown may be used on 190, 350, and 500 doors.

NOTE:

See Page 17 for available Horizontal Intermediate Members.

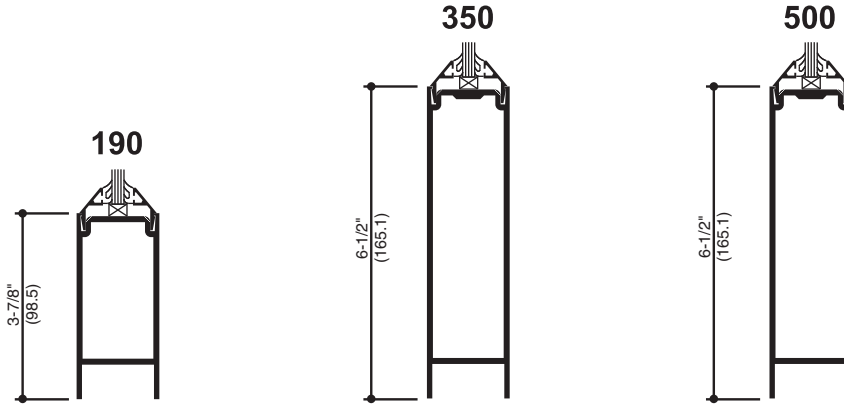

OPTIONAL BOTTOM RAILS

Rail heights shown may be used on 190, 350, and 500 doors. Custom heights available.

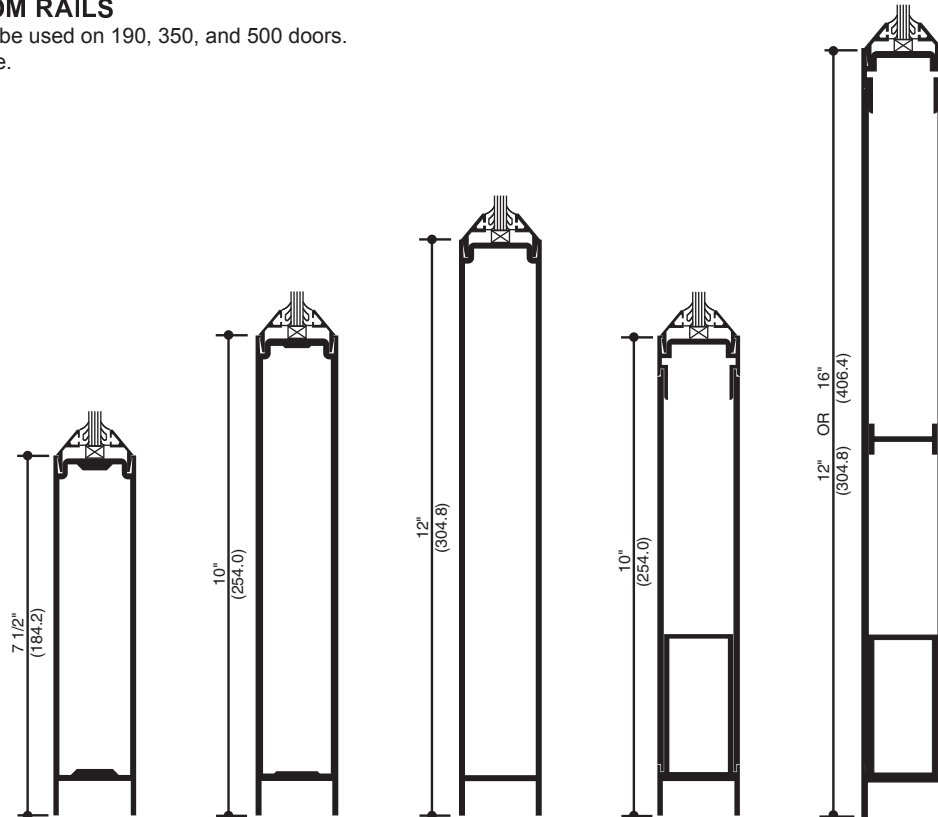

Laws and building and safety codes governing the design and use of glazed entrance, window, and curtain wall products vary widely. Kawneer does not control the selection of product configurations, operating hardware, or glazing materials, and assumes no responsibility therefor.

Kawneer reserves the right to change configuration without prior notice when deemed necessary for product improvement.
© Kawneer Company, Inc., 2015