

PRELIMINARY FLOOR PLAN -

SCALE - 1/2" = 1'-0"

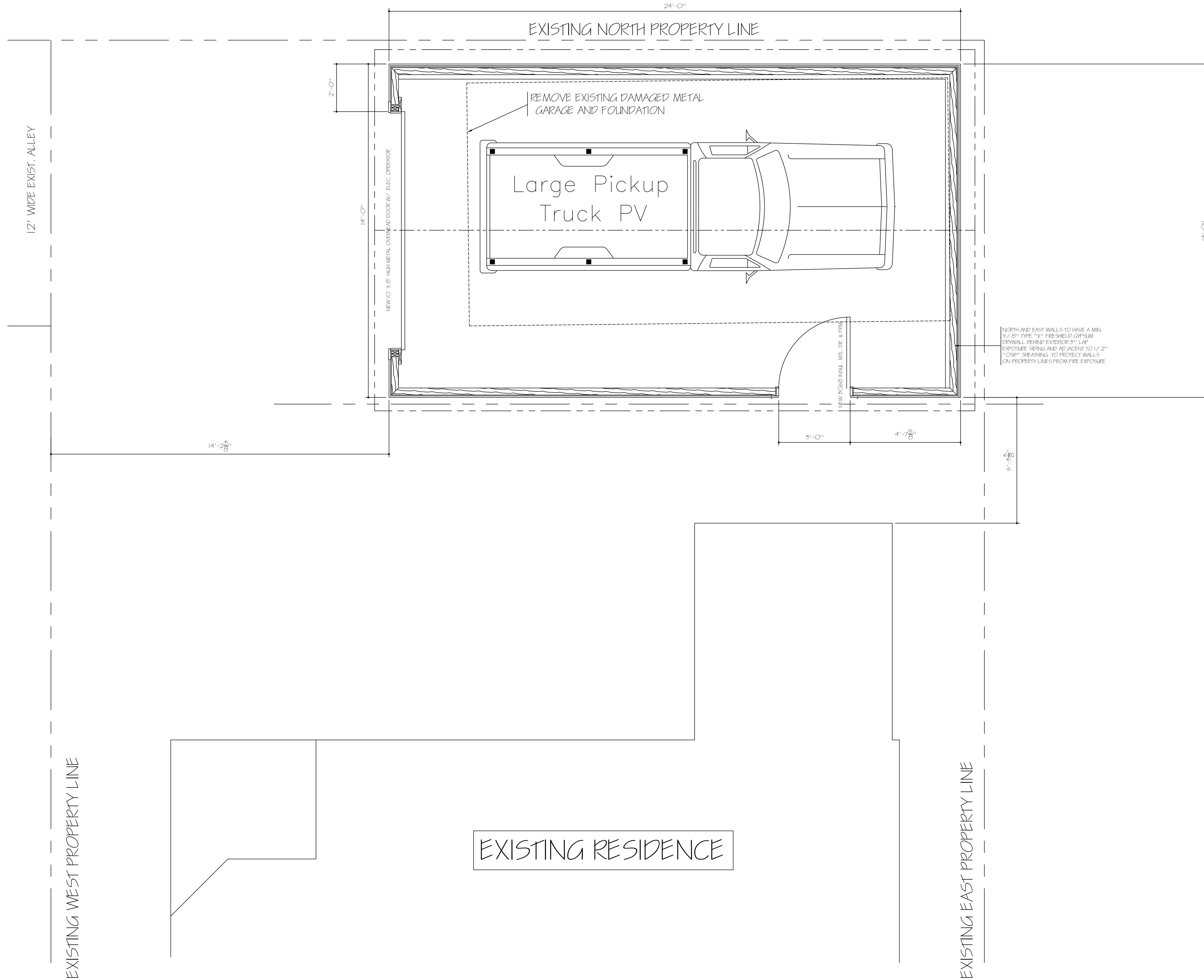
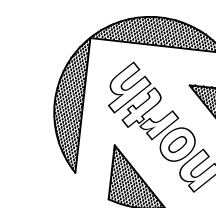

• COPYRIGHT NOTICE • - THESE DRAWINGS ARE COPYRIGHTED AND ARE SUBJECT TO COPYRIGHT PROTECTION AS AN ARCHITECTURAL WORK. UNDER SEC. 17, U.S.C. AS AMENDED DECEMBER 1990, AND KNOWN AS ARCHITECTURAL WORKS COPYRIGHT PROTECTION ACT OF 1990, THE PROTECTION INCLUDES BUT IS NOT LIMITED TO THE OVERALL FORM AS WELL AS THE ARRANGEMENT AND COMPOSITION OF SPACES AND ELEMENTS OF THE DESIGN UNDER SUCH PROTECTION. UNAUTHORIZED USE OF THE DOCUMENTS, WORK OR PROJECT REPRESENTED, CAN LEGALLY RESULT IN THE CESSION OF CONSTRUCTION OR BUILDING BEING SIZED AND/OR BUILDING COMPOSITION TO LUDWIG W. RIDDER DESIGN, INC.

NO.	REVISION	DATE
1	REVISE PER EXIST.	10/31/17
2	REVISE PER EXIST.	11/12/17
3	REVISE PER "OWNER"	11/18/17
4	REVISE PER "OWNER"	5/7/18

SHEET NAME	PRELIMINARY FLOOR PLAN
SCALE	1/2" = 1'-0"
DATE	OCTOBER 31, 2017
DRAWN BY	L. W. RIDDER
CHECKED BY	

LUDWIG W. RIDDER DESIGN, INC.
 ARCHITECTURAL DESIGN - CONSTRUCTION MANAGEMENT
 GENERAL CONTRACTOR * RESIDENTIAL * COMMERCIAL * INDUSTRIAL
 P.O. BOX 1060 - OCONOMOWOC, WI 53066-6060
 VOICE MAIL (262) 966-1840 - FAX (262) 966-1841

PROPOSED GARAGE for
MR. & MRS. AMINE BENBAZZA
 2118 E. KENILWORTH PLACE
 MILWAUKEE, WI 53202

PROJECT NAME & NO.
BENBAZZA GARAGE
26012

SHEET NAME & NO.
FLOOR PLAN
A - 1