



CITY OF MILWAUKEE
OFFICE OF THE CITY CLERK

Wednesday, April 28, 2021

COMMITTEE MEETING NOTICE

AD 04

MUSA, Nasser I, Agent
Serv Group LLC
4739 N Lake DR

Whitefish Bay, WI 53211

You are requested to attend a virtual hearing to be held on:

Tuesday, May 11, 2021 at 09:35 AM

Regarding: Your Food Dealer License Application as agent for "Serv Group LLC" for "Moosas" at 405 N 27th St.

This meeting will be held via GoToMeeting. Please  the enclosed best practices document for further instructions. The access code is <https://global.gotomeeting.com/join/820945093>. If you wish to call in, please call +1 (646) 749-3122 and use Access Code: 820-945-093.

There is a possibility that your application may be denied for one or more of the following reasons: The recommendation of the committee regarding the application shall be based on evidence presented at the hearing. Per MCO 85-2.7-4, probative evidence concerning whether or not a new license should be granted may be presented on the following subjects: whether or not the applicant meets the municipal requirements, the appropriateness of the location and premises where the licensed premises is to be located and whether use of the premises for the purposes or activities permitted by the license would tend to facilitate a public or private nuisance or create undesirable neighborhood problems such as disorderly patrons, unreasonably loud noise, litter, and excessive traffic and parking congestion. Probative evidence relating to these matters may be taken from the plan of operation submitted with the license application, if any, but shall not include the content of any music. Evidence regarding the fitness of the location of the premises to be maintained as the principal place of business, including but not limited to whether there is an overconcentration of businesses of the type for which the license is sought; whether the proposal is consistent with any pertinent neighborhood business or development plans, or the location's proximity to areas where children are typically present. The applicant's record in operating similarly licensed premises; and whether or not the applicant has been charged with or convicted of any felony, misdemeanor, municipal offense or other offense, the circumstances of which substantially relate to the activity to be permitted by the license being applied for or any other factor which reasonably relates to the public health, safety or welfare may also be considered. See attached police report or correspondence.

Notice for applicants with warrants or unpaid fines: Proof of warrant satisfaction or payment of fines must be submitted at the hearing on the above date and time. Failure to comply with this requirement may result in a delay of the granting/denial of your application.

Failure to attend this meeting may result in the denial of your license. Individual applicants and partnership applicants must attend or attend by an attorney. The agent or attorney for corporate or limited liability applicants must attend. If you wish to do so and at your own expense, you may be accompanied by an attorney of your choosing to represent you at this hearing.

You will be given an opportunity to speak on behalf of the application and to respond and challenge any charges or reasons given for the denial. No petitions can be accepted by the committee, unless the people who signed the petition attend the virtual hearing and are willing to testify. You may present witnesses under oath and you may also confront and cross-examine opposing witnesses under oath. If you have difficulty with the English language, you should request an interpreter attend the meeting with you, at your expense, so that you can answer questions and participate in your hearing.

PLEASE NOTE: Upon reasonable notice, efforts will be made to accommodate the needs of disabled individuals through sign language interpreters or other auxiliary aids. For additional information or to request this service, contact the Council Services Division ADA Coordinator at (414) 286-2998, Fax - (414) 286-3456, TDD - (414) 286-2025.

JIM OW CZARSKI, CITY CLERK

If you have questions regarding this meeting, please contact the staff assistant, Molly Kuether-Steele at (414) 286-2775 or molly.kuether-steele@milwaukee.gov.



LAW & CONSULTING, S.C.

April 12, 2021

Emil Ovbiagele
emil@ovblaw.com

[via Email]

City of Milwaukee – License Division

City Hall, Room 105

200 E. Wells St.

Milwaukee, WI 53202

Re: 405 N. 27th St – Serv Group LLC
Food Dealer Application

Dear License Division,

My office has been retained by Serv Group, LLC as it relates to their food dealer application for the restaurant located at 405 N. 27th, Milwaukee. We are in receipt of the correspondence dated March 31, 2021, and, on behalf of my client, please accept this letter as our appeal of the objection to their food dealer's license application. We request that this matter be immediately set for a hearing before the licensing committee.

Should you have any questions or concerns, please feel free to contact my office. Thanks for your attention to this matter.

Very Truly Yours,

OVB Law & Consulting, S.C.

/s/

Emil Ovbiagele, JD, MBA
Attorney

OEO

Ens.

cc: Client
Jim Owczarski (via email)
Alderman Robert Bauman (via email)

839 N. Jefferson St.
414. 585. 0588 (office)

Suite 502
ovblaw.com

Milwaukee, WI 53202
414. 255. 3031 (fax)



Wednesday, April 28, 2021



Notice of Public Hearing

blank
notice

MUSA, Nasser I, Agent
Moosas at 405 N 27th St
Food Dealer License Application

Tuesday, May 11, 2021 at 9:35 AM

To whom it may concern:

The above application has been made by the above named applicant(s). This requires approval from the Licenses Committee and the Common Council of the City of Milwaukee. The hearing before the Licenses Committee will take place virtually on 5/11/2021 at 9:35 AM. This is a public hearing. Those wishing to view the proceeding are able to do so via the City Channel – Channel 25 on Spectrum Cable – or on the Internet at <http://city.milwaukee.gov/citychannel>. Those wishing to provide oral testimony will be asked to do so by phone or internet and are asked to contact the staff assistant, Molly Kuether-Steele at (414) 286-2775 or molly.kuether-steele@milwaukee.gov for necessary information. Please make such requests no later than one business day prior to the start of the meeting. You are not required to attend the hearing, but please see the information below if you would like to provide testimony. Once the Licenses Committee makes its recommendation, this recommendation is forwarded to the full Common Council for approval at its next regularly scheduled hearing.

Important details for those wishing to provide information for the Licenses Committee to consider when making its recommendation:

1. The license application is scheduled to be heard at the above time. Due to other hearings running longer than scheduled, you may have to wait some time to provide your testimony.
2. You must testify as to matters that you have personally experienced or seen. (You cannot provide testimony for your neighbor, parent or anyone else; this is considered hearsay and cannot be considered by the committee.)
3. No letters or petitions can be accepted by the committee (unless the person who wrote the letter or the persons who signed the petition are willing to testify).
4. Persons opposed to the license application are given the opportunity to testify first; supporters may testify after the opponents have finished.
5. When you are called to testify, you will be sworn in and asked to give your name, and address. (If your first and/or last names are uncommon please spell them.)
6. You may then provide testimony.
 - a. Include only information relating to the above license application.
 - b. Include only information you have personally witnessed or seen.
 - c. Provide concise and relevant information detailing how this business has affected or may affect the peaceful enjoyment of your neighborhood.
 - d. If by the time you have the opportunity to testify, the information you wish to share has already been provided to the committee, you may state that you agree with the previous testimony. Redundant or repetitive testimony will not assist the committee in making its recommendation.
7. After giving your testimony, the members of the Licenses Committee and the licensee may ask questions regarding the testimony you have given or other factors relating to the license application.
8. Business Competition is not a valid basis for denial or non-renewal of a license.

Please Note: If you have submitted an objection to the above application your objection cannot be considered by the committee unless you personally testify at the hearing.

OCCUPANT	MAIL ADDRESS	CITY, STATE ZIP
CURRENT OCCUPANT	439 N 28TH ST	MILWAUKEE, WI 53208
CURRENT OCCUPANT	436 N 28TH ST	MILWAUKEE, WI 53208
CURRENT OCCUPANT	418 N 28TH ST	MILWAUKEE, WI 53208
CURRENT OCCUPANT	454 N 28TH ST 1	MILWAUKEE, WI 53208
CURRENT OCCUPANT	450 N 28TH ST	MILWAUKEE, WI 53208
CURRENT OCCUPANT	454 N 28TH ST 2	MILWAUKEE, WI 53208
CURRENT OCCUPANT	412 N 28TH ST	MILWAUKEE, WI 53208
CURRENT OCCUPANT	427 N 28TH ST	MILWAUKEE, WI 53208
CURRENT OCCUPANT	423 N 28TH ST	MILWAUKEE, WI 53208
CURRENT OCCUPANT	436A N 28TH ST	MILWAUKEE, WI 53208
CURRENT OCCUPANT	402 N 28TH ST	MILWAUKEE, WI 53208
CURRENT OCCUPANT	437 N 28TH ST	MILWAUKEE, WI 53208
CURRENT OCCUPANT	426 N 28TH ST	MILWAUKEE, WI 53208
CURRENT OCCUPANT	454A N 28TH ST	MILWAUKEE, WI 53208
CURRENT OCCUPANT	2734 W ST PAUL AVE	MILWAUKEE, WI 53208
CURRENT OCCUPANT	2732 W ST PAUL AVE	MILWAUKEE, WI 53208
blank	notice	

Total Records: 16

Radius: 250.0 feet and Center of Circle: 405 N 27th St



BUSINESS LICENSE PLAN OF OPERATION

ccl-busplan 5/12/2020

Office of the City Clerk License Division
200 E. Wells St. Room 105, Milwaukee, WI 53202
(414) 286-2238 www.milwaukee.gov/license e-mail address: license@milwaukee.gov

1. Type of Business

Applying for: Extended Hours (12AM to 5AM) - If a food establishment, check all that apply: Delivery Drive Thru Dining Room
 Self Service Laundry Massage Establishment Filling Station
 Other (supplemental application for specific license also required)

Provide a detailed description of the type of business you plan on operating:

Walk up ordering. To go only, fast food.

Do you have any experience operating this type of business? No Yes If yes, explain: 3 years a moose's 16 years a Casablanca Manager.

2. Business Operations

- a. Proposed Opening Date: Dec 10th 2020
- b. Is this premise under construction? No Yes If yes, list estimated completion date: _____
- c. Is this a franchise? No Yes
- d. Is this premises currently licensed? No Yes If yes, list type of license: _____
- e. Is the current licensee operating? No Yes If no, list date closed: _____
- f. Do you have future plans for other businesses, licenses or permits at this location? No Yes
If yes, explain: _____
- g. Have you previously held an Extended Hours License in Milwaukee? No Yes
If yes, list address(es): _____
- h. Are other businesses operating in the same building? No Yes If yes, describe: BP Gas Station

3. Litter & Noise

- a. How are grounds kept clean? Sweep Pressure Wash Pick Up Litter Other: _____
- b. How often will grounds be cleaned? Daily Weekly As Needed Monthly Other: _____
- c. Grounds cleaned by: Licensee Building Owner Employees Hired Maintenance Other: _____
- d. How are noise issues prevented and/or addressed? Security Manager approaches customer(s) Call Police
 Signs Posted Other: _____
- e. Will a sound amplification system be used? No Yes If yes, describe: _____

4. Smoking & Sanitation

- a. Are there designated outdoor smoking areas? No Yes If yes, describe: _____
- b. Number of Garbage Cans: Inside: 6 Locations: By Sinks and Grill
Outside: 4 Locations: Dumpsters & By Doors
- c. Is a crowd control barrier used? No Yes If yes, describe: _____
- d. How many restrooms are on the premises? 2
- e. Name of solid waste contractor: Advanced Disposal Waste Management Other: _____

5. Security

- a. Are there onsite parking spaces? No Yes If yes, how many? 14 and describe the parking security plan: _____
- b. Is there a loading zone? No Yes If yes, describe the loading area security plan: _____
- c. Will you have security personnel on premise? No Yes If yes, how many? _____ and answer the following:
 What are their responsibilities? _____
 Is security equipment used? No Yes If yes, describe _____
 List their licensing, certification, or training credentials _____
- d. Will there be security cameras? No Yes If yes, how many? 11 and list locations: 2 By Front Door
6 By Pumps 3 inside
- e. Will searches/identification checks be done upon entry? No Yes If yes, describe _____

6. Percentage of Sales (must total 100%)

Alcohol <u>0</u> %	Food <u>100</u> %	Secondhand Merchandise <u>0</u> %	Precious Metals & Gems <u>0</u> %
Entertainment <u>0</u> %	Cigarettes <u>0</u> %	Personal Services (such as tattoo, body piercing, salon, tailor, tanning, etc.) <u>0</u> %	Other <u>0</u> % Describe: <u>0</u>
Pawnbroker Activity <u>0</u> %	Salvaged Materials <u>0</u> % (such as scrap metal)		

7. Businesses/Licenses on the Premises (check all that apply):

Type 1

- Full Service Restaurant
 Cafe/Coffee Shop
 Deli or Fast Food Restaurant
 Private/Fraternal/Veterans Club
 Night Club
 Tavern
 Cocktail Lounge
 Teen Club
 Banquet Hall
 Sports Facility
 Bowling Alley
 Hotel/Motel: Number of Floors: _____
 Number of Rooms: _____
 Rooming House: Number of Floors: _____
 Number of Rooms: _____

Type 2

- Liquor Store
 Corner Store
 Supermarket
 Convenience Store
 Gas Station
 Amusement/Phonograph Distributor
 Recycling, Salvage or Towing
 Used Car Dealer
 Personal Service Establishment
 (such as tattoo business, hair salon, tailor, etc.)
 Recording Studio

What other licenses/permits will you hold at this location? (check all that apply)

- Occupancy Permit
 Cigarette & Tobacco
 Gas Station
 Extended Hours
 Class "B" Tavern
 Weights & Measures
 Secondhand Dealer
 Precious Metal & Gem
 Other: _____

8. Legal Capacity (only if a Type 1 premises in #7 above)

Capacity 65 (Call the Milwaukee Development Center at 414-286-8211 if you have questions.)



APPLICATION AMENDMENT

Office of the City Clerk License Division
200 E. Wells Street, Room 105, Milwaukee, WI 53202 (414) 286-2238

Date: 4/16/21

To the License Division of the City of Milwaukee:

I, NASSER Musa Serv Group LLC, wish to amend my answer(s) on the application for a

Food Dealer license at 405 N 27th St Milwaukee, WI

by adding or amending the following information (complete only those sections being amended):

1. Answer to Question(s) # 15 should be: change of hours
2. Agent should be (full legal name): _____ Also complete 3, 4, 5 & 6
3. Date of birth should be: _____
4. Home address should be (include city/state/zip): _____
5. Phone number should be (include area code): _____
6. Driver's License Number/State ID Number should be: _____
7. Corporation/LLC name should be (full legal name): _____
8. Business name should be: _____
9. Premises address should be (include city/state/zip): _____
10. Business phone number should be (include area code): _____
11. Mailing address should be (include city/state/zip): _____
12. Email address should be: _____
13. Recycling/Salvaging/Towing: Location where vehicle will be parked should be (include city/state/zip): _____
14. Class B Tavern: Age Distinction should be: _____
15. Other: Change hours TO 11a.m. open and closing 9pm Monday - Sunday

(Check with the License Division before submitting "Other" amendments using this form.)

[Signature]
Signature of Licensee (individual, Partner, or Agent of Corp/LLC)

Office Use Only: Application #: FREST 319465 Date: 4/20/2021 Initials: CR To LC: _____
LC Email: MPD NS HD Initials: _____

9. Premises Description

- a. Identify all area(s) of the premises that will be used in operating this business (include areas used only for storage):
 1st Floor 2nd Floor Basement Storage Patio Beer Garden Sidewalk Café Deck Rooftop
 Other: Describe: _____
- b. Describe Location: Major Thoroughfare Secondary Street Other: _____
- c. Nearest Major Cross Street: St. Paul
- d. Describe Building: Free Standing Building Strip Mall Other: inside Gas Station
- e. Describe Premises Structure: Single Story Multi-Story - # of Stories _____ Other: _____
- f. Describe Surrounding Area: Commercial Residential Industrial Other: _____
- g. Building Owner Name: Rick Walia Phone Number: 414-322-2475
 Building Owner Address: 405 N 27th St Milwaukee, WI 53211

10. Hours of Operation & Customers

Will customers be entering the premises? No Yes

Day of the Week	Proposed Hours of Operation:		Estimated Number of Customers expected each day	Potential Age Range of Customers	Class B Tavern Applicant Only: Age Restriction (If none, write 'None')
	Open Time (include a.m. or p.m.)	Close Time (include a.m. or p.m.)			
Sunday	11am - 10am	10 PM	50	18-55 16-25	
Monday	11am	10 PM	50	18-55	
Tuesday	11am	10 PM	50	18-55	
Wednesday	11am	10 PM	50	18-55	
Thursday	11am	10 PM PM	50	18-55	
Friday	11am	11 PM	85	18-55	
Saturday	11am	11 PM	85	18-55	

An Extended Hours Establishment License is required for any convenience store, filling station, personal service establishment (such as tattoo, body piercing, salon, tailor, tanning, etc.), recording studio or restaurant which is open between the hours of 12:00 a.m. and 5:00 a.m.

Alcohol Establishments Class A: 8:00 am to 9:00 pm Sunday thru Saturday
 Permitted Hours of Operation: Class B: 6:00 am to 2:00 am Sunday thru Thursday, 6:00 am to 2:30 am Friday & Saturday

Entertainment Outdoor Closing Hours: 10:00pm Sunday-Thursday; 12:00am Friday & Saturday; unless a different time, either earlier or later, is established by the Common Council in its approval of the licensee's plan of operation.

11. Signature(s)

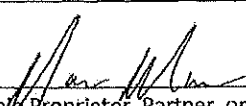
 Signature of Sole Proprietor, Partner, or 20% or more Shareholder
 (If there are no 20% or more shareholders,
 Corporate Officer-print name/title and sign)

 Signature of additional partner or 20% or more shareholder

See Application Information for a complete list of all required application forms.



FOOD DEALER LICENSE PLAN OF OPERATION

ccl-foodplan 2/28/19

OFFICE OF THE CITY CLERK, LICENSE DIVISION
CITY HALL, 200 E. WELLS ST, ROOM 105, MILWAUKEE, WI 53202
(414) 286-2238 • license@milwaukee.gov • www.milwaukee.gov/license

Legal Entity Name: **Serv Group, LLC**

Premises Address: **405 N 27th st Milwaukee, WI 53208**

SECTION 1 TYPE OF BUSINESS

What will be the majority of your food sales? (check one)

Restaurant Items (meals):
MEALS include, but are not limited to, chicken, ribs, sandwiches, roasted corn, baked potatoes, hot dogs, brats, tacos, nachos w/ cheese and meat, French fries, cooked or deep fried vegetables/fruit, cooked cheese curds, corn dogs, egg rolls, salads.

Retail Items (snacks and beverages):
RETAIL items include, but are not limited to, ice cream/soft serve, lemonade, snow cones, coffee, espresso, cappuccino, tea, fruit juice, smoothies, candy, dispensed soda, fruit cups, bakery, cookies, kettle corn, cotton candy, funnel cakes, fritters, tortilla chips w/ cheese.

Will it be a convenience store? Yes No

A convenience store contains less than 5,000 square feet of retail space and has, as its primary business, the sale of basic food items and in addition, sells household products or is a filling station that sells basic food items and household products.

- Bed & Breakfast
- Micro Market

All Applicants: Submit a menu or a list of food items that will be sold.

Will any wholesale business be done? No Yes If yes, what percentage of food sales will be wholesale?

Less than 25%

25% or More AND:

Restaurant items (meals) will be sold – Complete this application and also contact DATCP.

NO restaurant items (meals) will be sold - Do NOT complete this application. Contact DATCP only.

SECTION 2 FOOD PROCESSING

Will any food processing be done? No Yes

Processing is defined as assembling, grinding, cutting, mixing, baking, coating, stuffing, packing, bottling, grilling, canning, extracting, fermenting, distilling, pickling, freezing, drying, smoking, or packaging.

SECTION 3 FOOD REQUIRING TEMPERATURE CONTROL

Will any food that requires temperature control be sold? No Yes
(includes dairy products such as milk, cheese, and ice cream, fish, shellfish, meat, poultry)

Chicken / Burgers / custard/ fries

If yes, list the types of food items: _____

SECTION 4 DETAILS OF OPERATION

Will you have seating on site for dining? No Yes

Will you be doing any catering? No Yes

Will you be doing any delivery? No Yes

Will you have outdoor activities? No Yes - Check all that apply: Bar Cooking/Grilling Dining

Will you have a drive thru window? No Yes - Are hours different from inside? No Yes
 If Yes, provide drive thru hours: _____

Will scales or barcode scanners be used? No Yes - You must also apply for a Weights & Measures License.

SECTION 5 ADDITIONAL SITES

Where will food be prepared and/or sold?

At a single site At multiple sites: How many? _____ (for example, a hotel with several dining rooms or bars)

If multiple sites, attach a Food Dealer Additional Site Addendum (ccl-foodadd) for each additional site.

SECTION 6 CONSTRUCTION OR CHANGES

Are you planning any construction, remodeling or equipment changes?

No If No, SKIP to Section 8

Yes If Yes, check all that apply: New construction of a building Renovation or remodeling
 Construction changes to existing building Equipment changes only

Provide a brief description of the changes: _____

Start date: _____

Name, Address & Phone Number of Architect: _____

Name, Address & Phone Number of Contractor: _____

SECTION 7 ALCOHOL BEVERAGES

Are you applying for an alcohol beverage license?

No If No, SKIP to Section 8

Yes If YES, if your food license is approved prior to the alcohol license, when do you want the food license issued?
 Immediately At the same time as the alcohol license

SECTION 8 ACKNOWLEDGEMENTS & SIGNATURE

You must initial each item confirming your understanding:

NM I understand the Health Department must conduct an inspection and advise the License Division of their approval before the license may be issued.

NM I understand I must obtain an occupancy permit from the Department of Neighborhood Services and an inspection may be required. Neighborhood Services must advise the License Division of their approval before the license may be issued.

NM I understand the district alderperson will review and either support or object to my application. If he/she objects, I may appeal and be scheduled to appear before the Licenses Committee. The Licenses Committee will then make a recommendation to the Common Council. The Common Council must grant the license before it may be issued.

NM I understand proof of payment for all license fees must be on file in the License Division before the license may be issued and the license must be issued and posted in my establishment prior to opening for business.

Nm I will not operate my food business until the license has been issued and posted in the establishment.

Signature of Sole Proprietor, Partner, or 20% Shareholder: Har Man

Signature of Additional Partner: _____

MOOSAS MENU

HAMBURGER 5.95

CHEESEBURGER 6.95

IMPOSSIBLE BURGER 8.95

GRILLED CHEESE 4.95

FRIED CHICKEN & FRIES 6 PC 8.95

HOT DOG. 3.95

BRAT. 5.95

WALKING TACO 7.95

WINGS 6PC 7.95

BUFFALO CHICKEN SANDWICH 8.95

CHICKEN TENDER 6 PC. 8.95

CHEESE CURDS 7.95

FIRES 3.95

ONION RINGS 5.95

PREZTEL STICK & CHEESE 5.95

CUSTARD

SHAKES

BANNA SPLITS

SUNDAYS

10/16/2020

St Paul

- Trash (East)
- Parking Seat (11)
- Handicap parking (3)

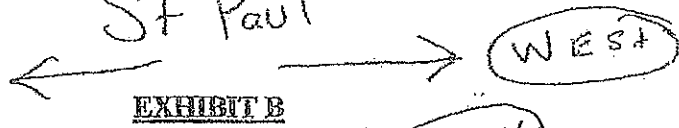

Location of Premises
1st Floor

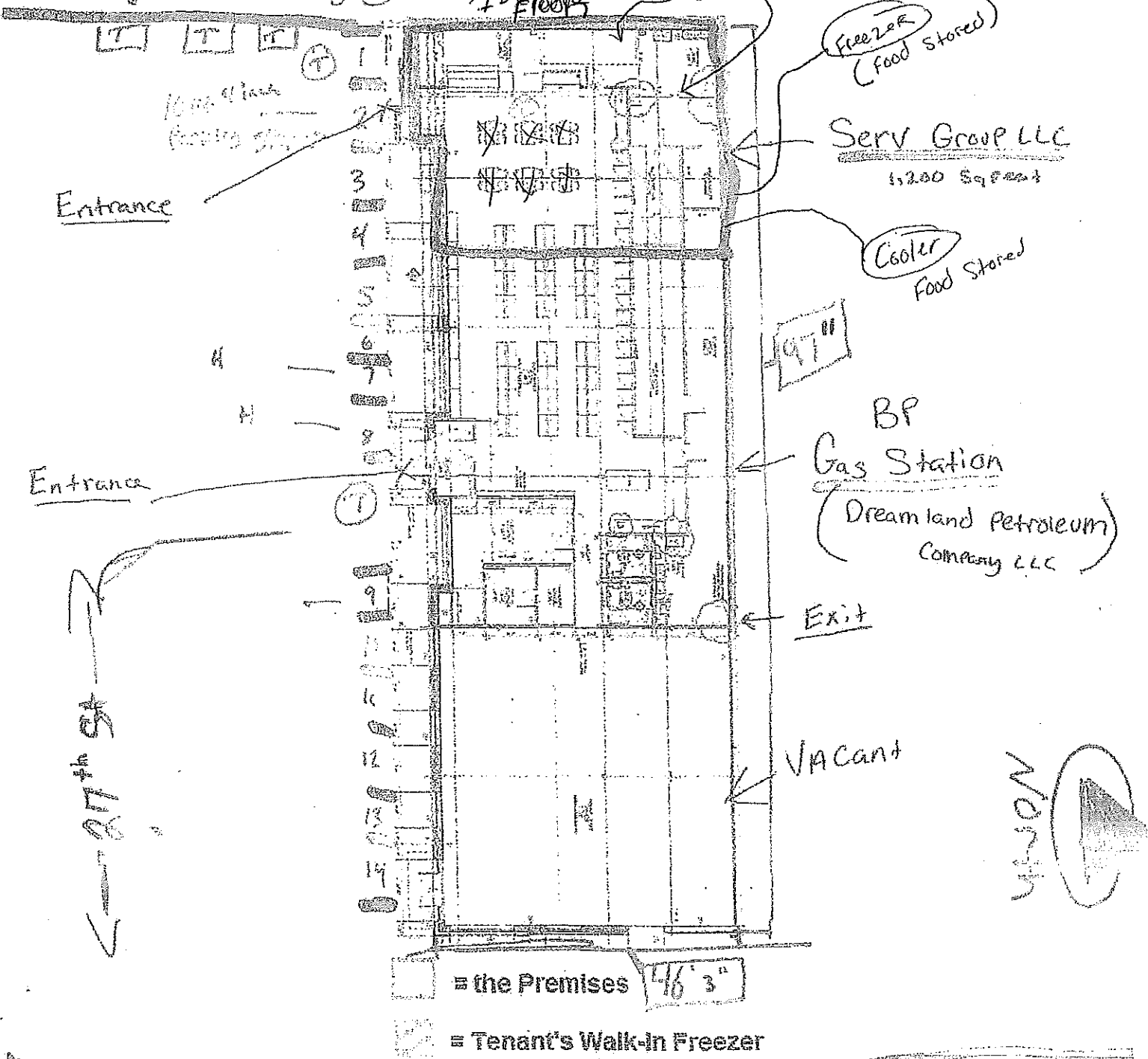

Serv Group LLC
1200 Sq Feet

Entrance

Cooler
Food Stored

BP
Gas Station
(Dreamland Petroleum Company LLC)

Exit

VACANT

the Premises 46' 3"

Tenant's Walk-In Freezer

405 N 27th St
Milwaukee, WI 53208

Serv Group, (Entity) LLC
Nasser Mousa (Agent)
DGA MOUSA S (Trademark)