

CURRENT
110 W Brown St
Existing Rear
Porch Re-Build

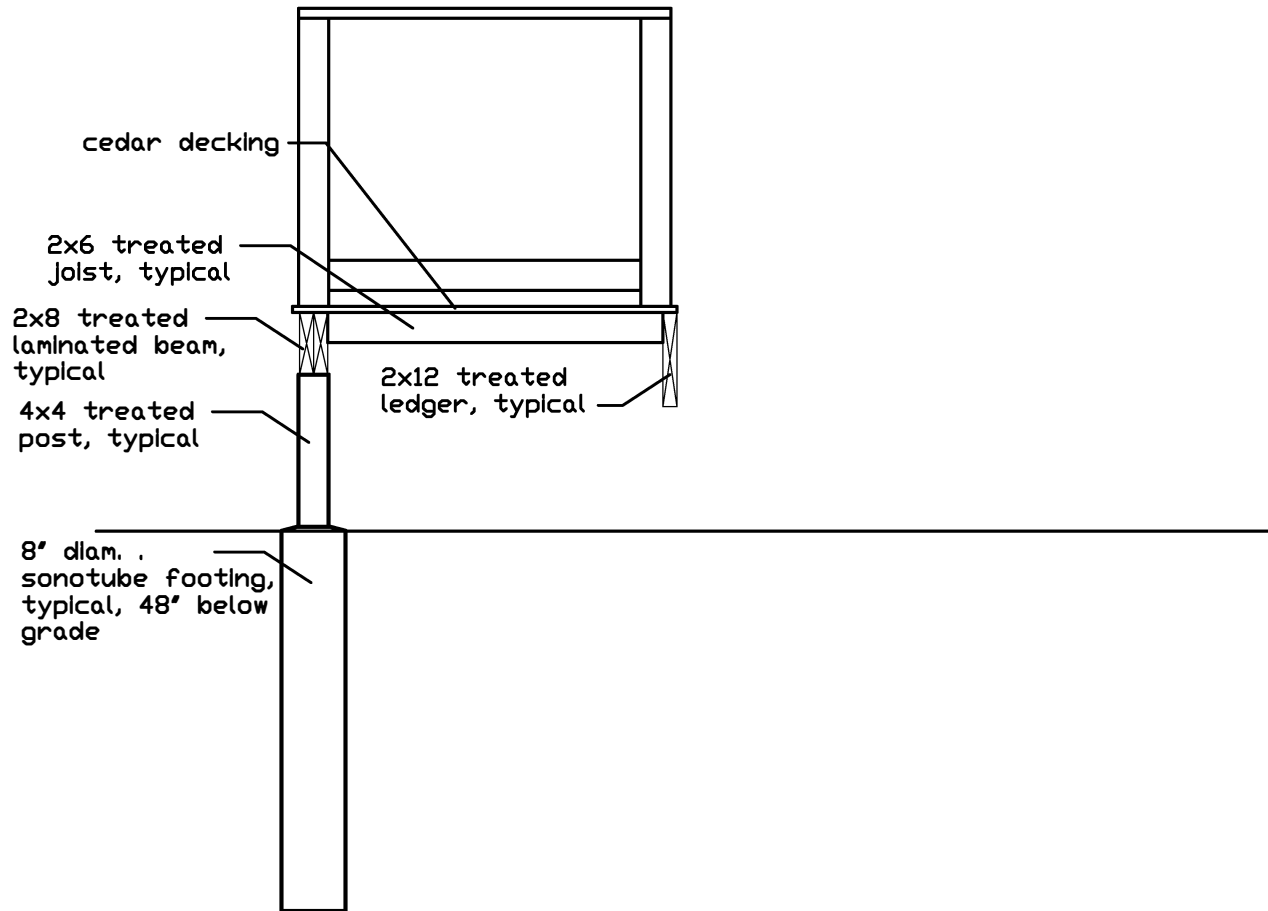

Elevation Looking
East Towards
Side of Porch

-Structure
 $\frac{1}{2}'' = 1'-0''$

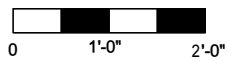

CURRENT
 110 W Brown St
 Existing Rear
 Porch Re-Build

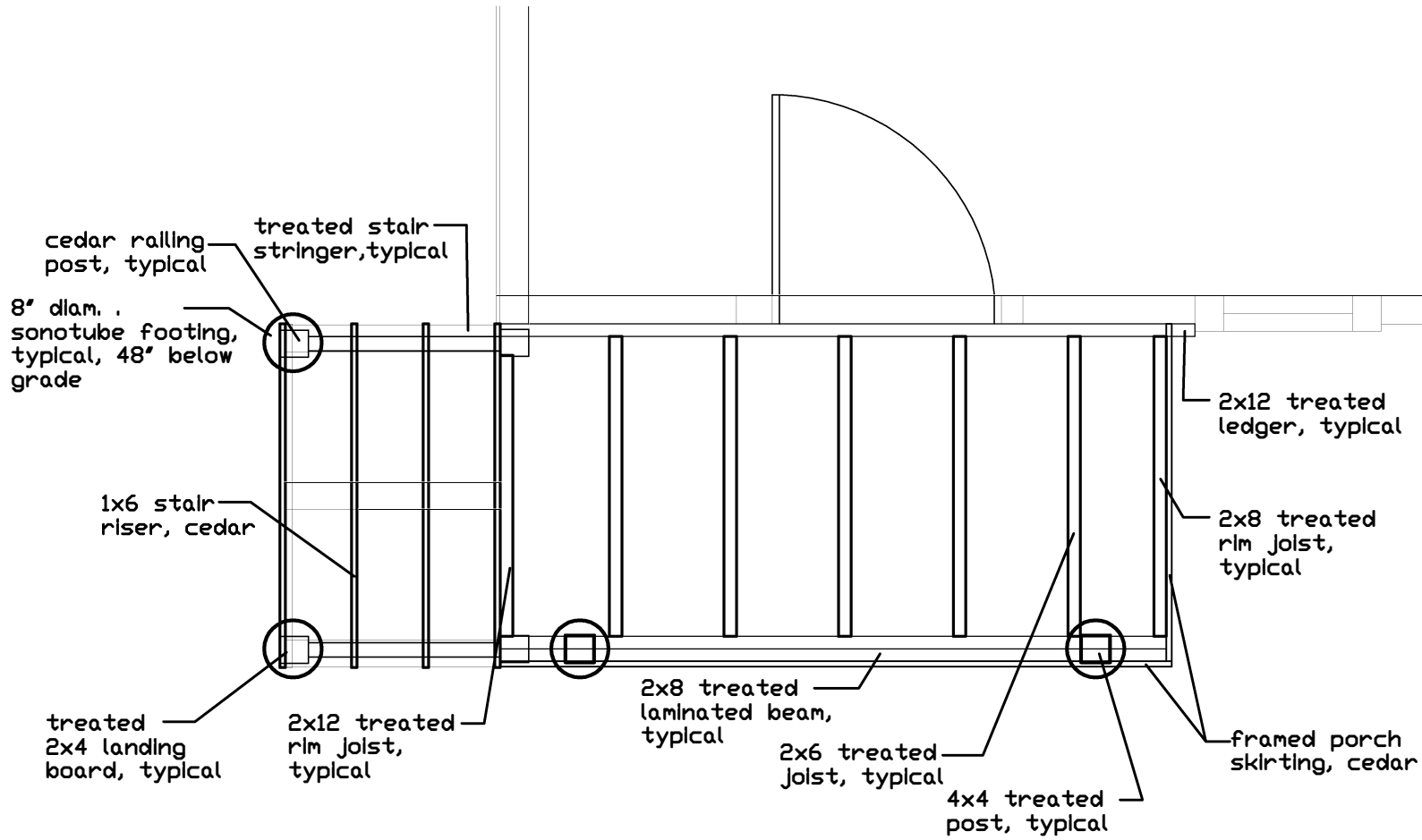

Plan View

-Framing

1/2" = 1'-0"

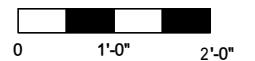

CURRENT
110 W Brown St
Existing Rear
Porch Re-Build

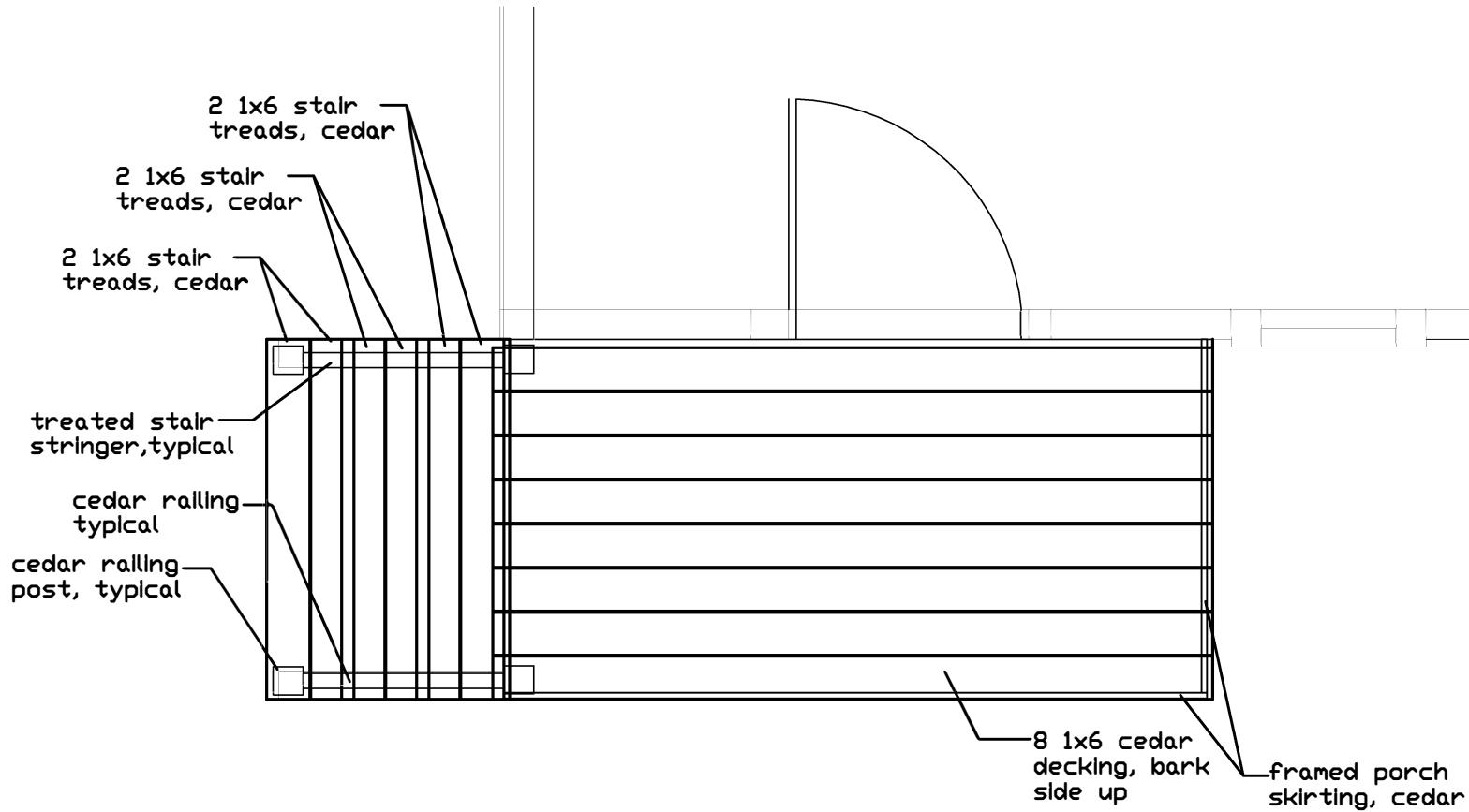

Plan View

-Decking
 $\frac{1}{2}'' = 1'-0''$

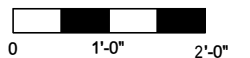

CURRENT
110 W Brown St
Existing Rear
Porch Re-Build

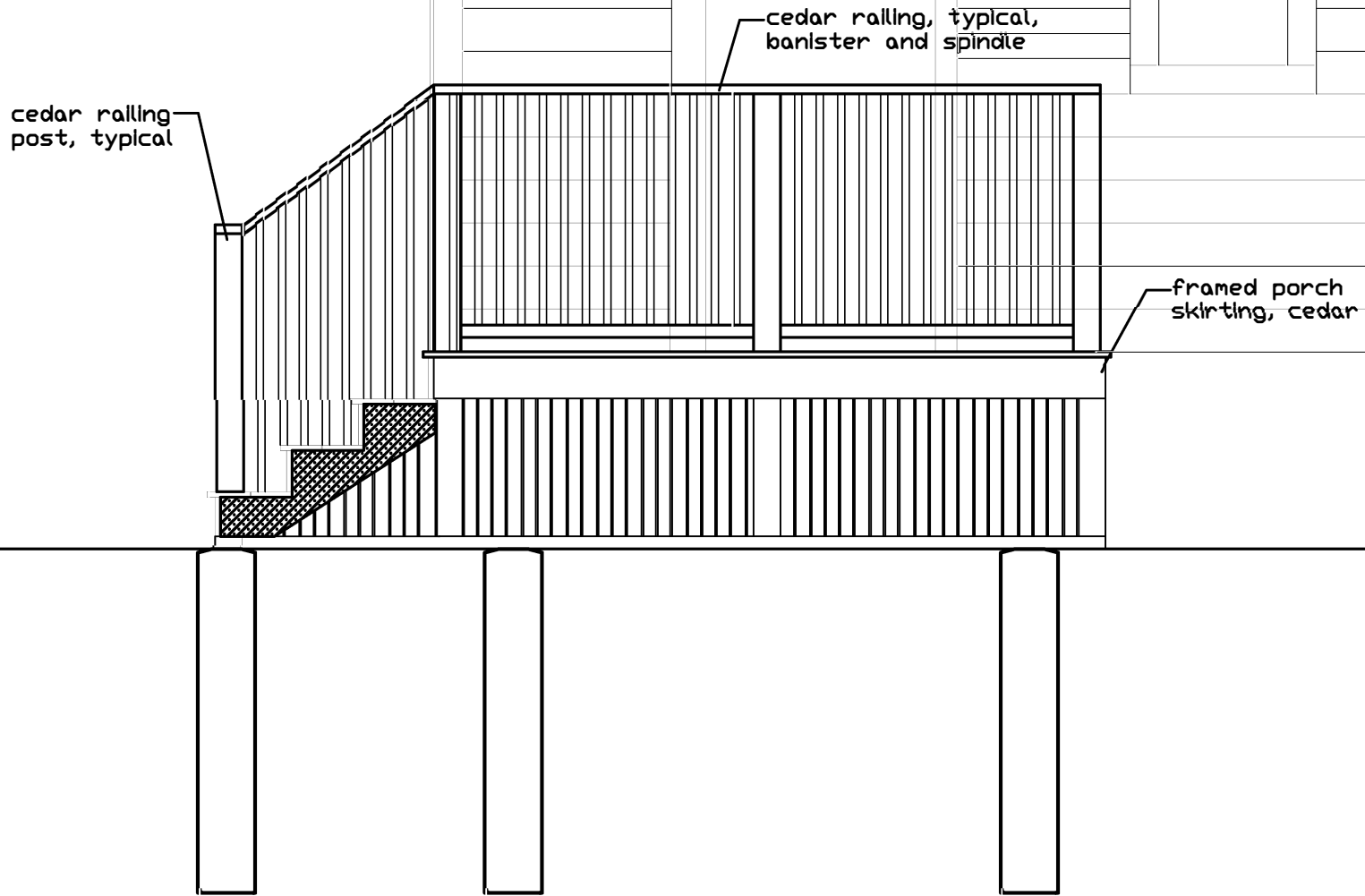

Elevation Looking
South Towards
Rear of Home

-Railing & Skirting
 $\frac{1}{2}'' = 1'-0''$

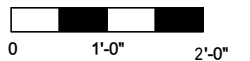

CURRENT

110 W Brown St
Existing Rear
Porch Re-Build

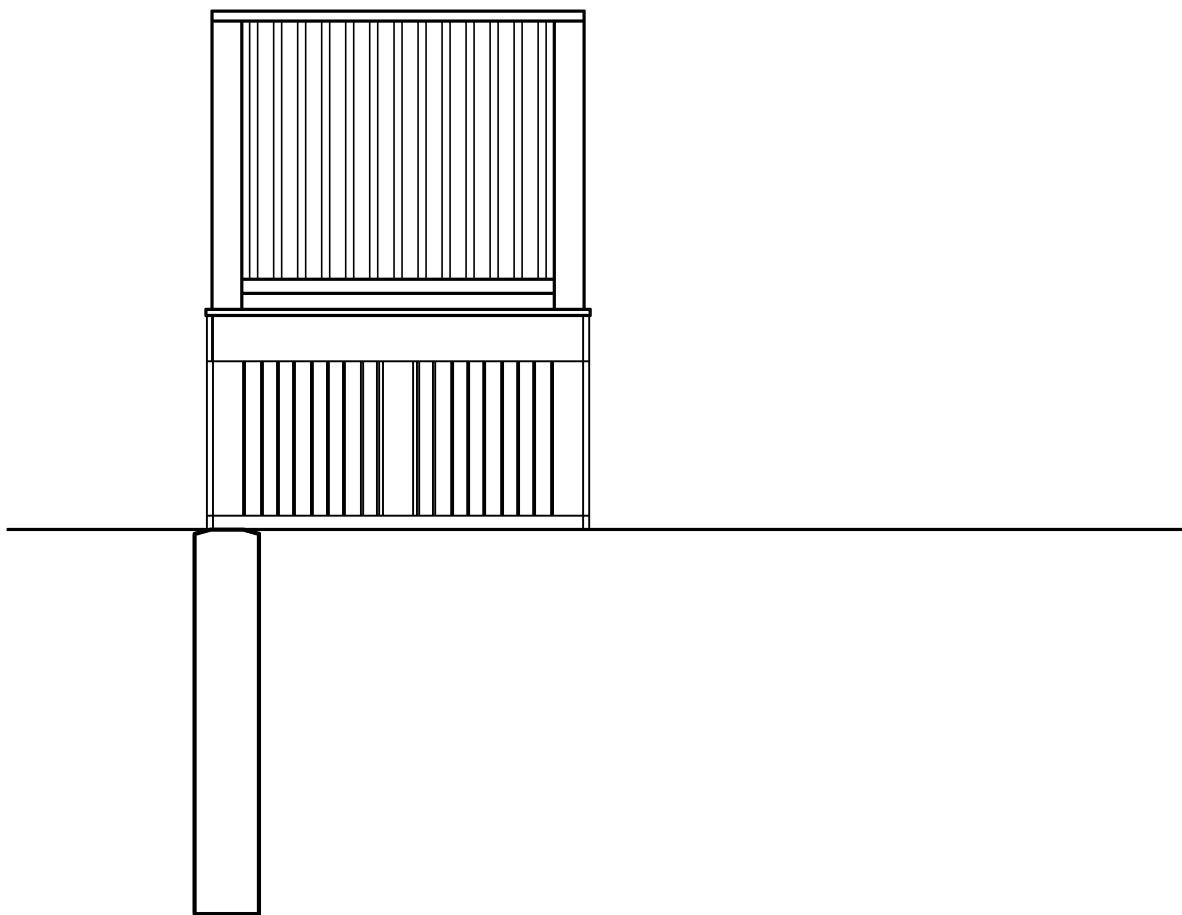

Elevation Looking
East Towards
Side of Porch

-Railing & Skirting

$\frac{1}{2}$ " = 1'-0"

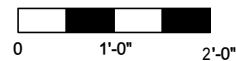

Beam Assembly Detail

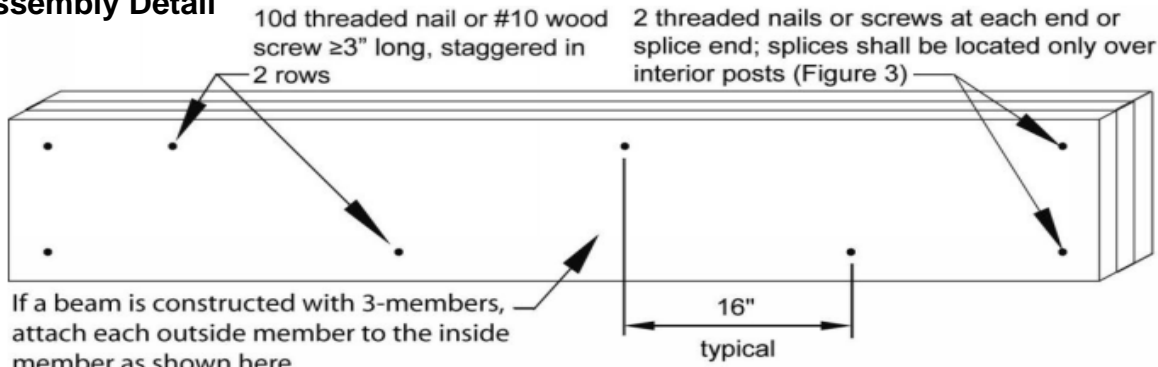

If a beam is constructed with 3-members, attach each outside member to the inside member as shown here.

Joist-to-Beam Detail

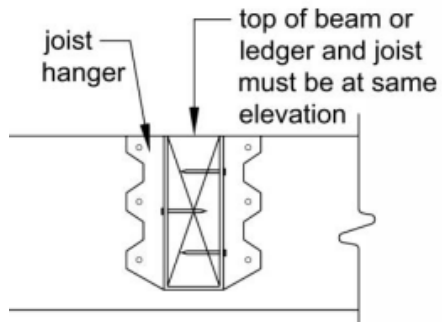

Joist Hanger Detail

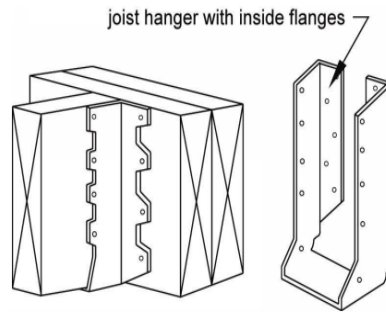

Post-to-Beam Post Cap Attachment Detail

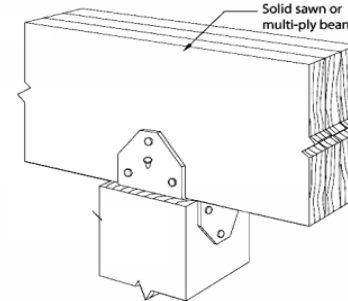

Rim Joist Connection Detail

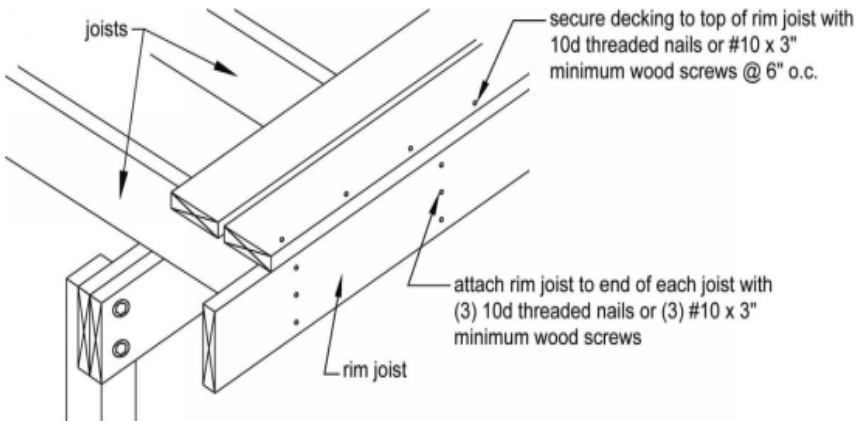

Footing Detail

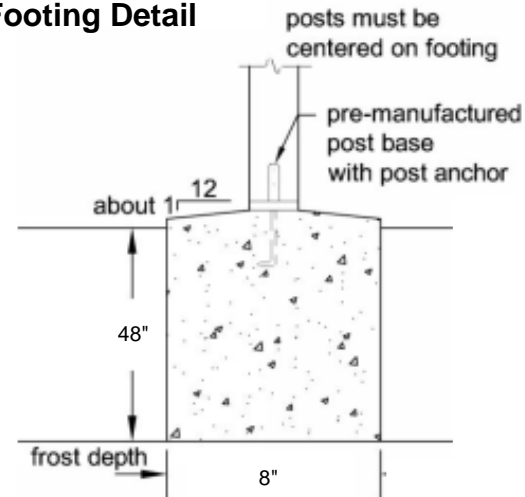

CURRENT
110 W Brown St
Existing Rear
Porch Re-Build

Details

NTS

Ledger Connection Detail

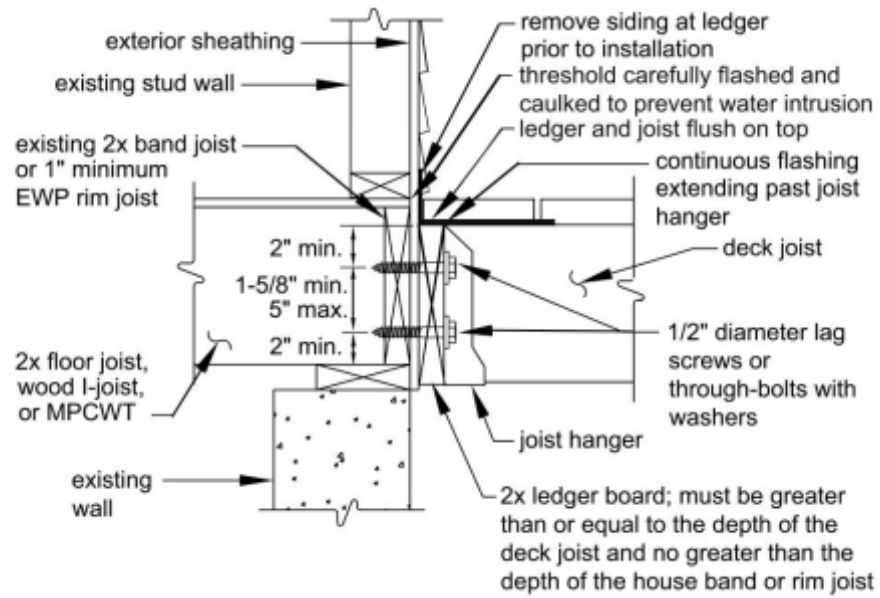

CURRENT

110 W Brown St
Existing Rear
Porch Re-Build

Details

NTS