

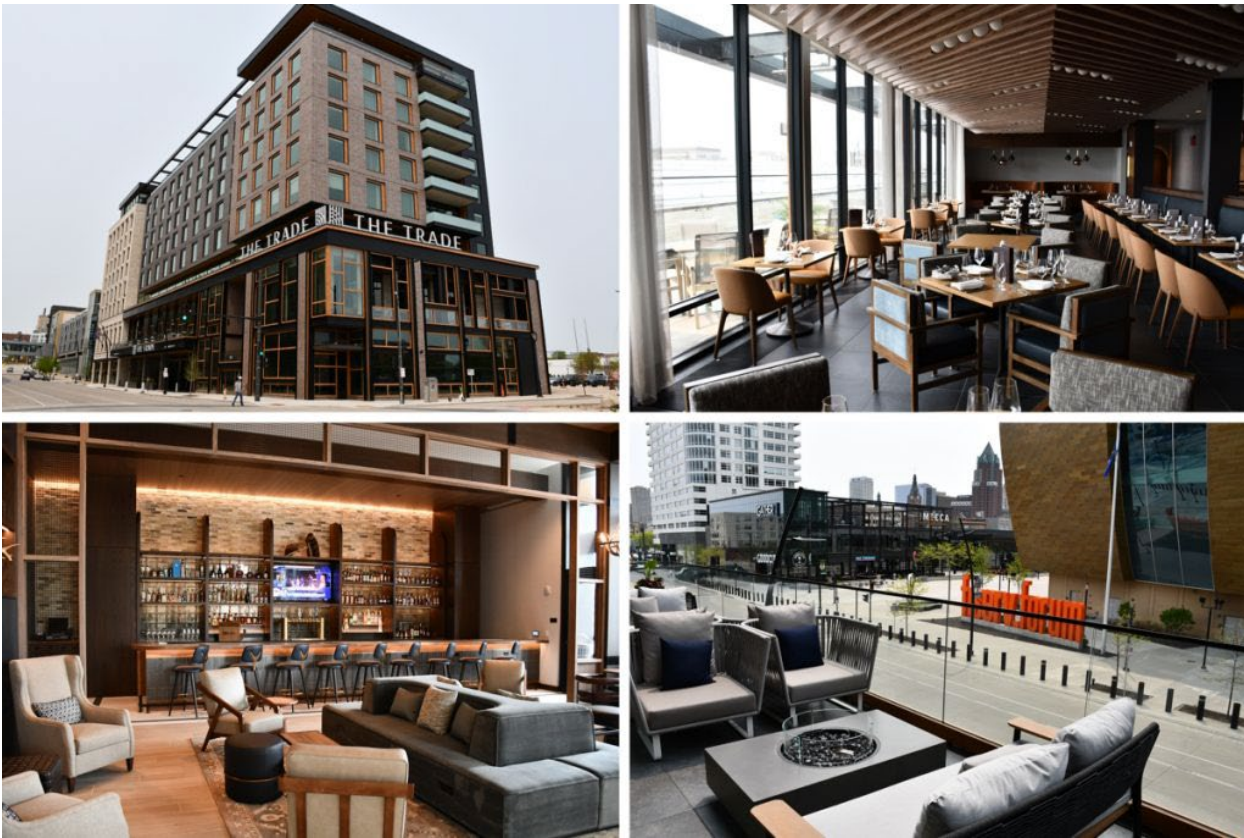

## See the 2024 Mayor’s Design Awards Winners

20 projects big and small are named best of the best in Milwaukee design

By [Jeramey Jannene](#) - May 17th, 2024 03:45 pm



*The Trade hotel. Photos by Jeramey Jannene.*

The City of Milwaukee is recognizing the best in design through its 27th annual Mayor’s Design Awards.

A total of 20 projects are being recognized, including [one building](#) that was previously described as “the quintessential definition of blight.”

An in-person ceremony to recognize the winners is being held Friday evening at the [UW-Milwaukee School of Architecture and Urban Planning](#). Mayor [Cavalier Johnson](#) is leading the ceremony.

Administered by the [Department of City Development](#), the awards program began under Mayor [John Norquist](#) and was continued by Mayor [Tom Barrett](#). The 2024 awards are the third under Johnson.

### Neighborhood Renaissance

The following projects are Growing Milwaukee by providing a wide range of new opportunities for City living that strengthen neighborhoods and enhance the quality of life for residents

- [Milwaukee Habitat for Humanity](#) – Affordable Homeownership Initiative – [Harambee](#) and [Midtown](#) neighborhoods – [Quorum Architects](#) and Milwaukee Habitat – [Prior Coverage](#)
- [Walnut Circle & Josey Heights](#) – N. 20th and W. Walnut streets and N. 12th and W. Lloyd streets – [Emem Group](#) – [Prior Coverage](#)
- [McKinley School Lofts](#) – 1320 N. 21st St. – Quorum Architects and [Gorman & Company](#) – [Prior Coverage](#)
- Maple & Hickory at [Westlawn Gardens](#) – [6014 W. Sheridan Ave.](#) and [6405 W. Sheridan Ave.](#) – [Housing Authority of the City of Milwaukee](#), [Eppstein Uhen Architects](#), [raSmith](#), [Torti Gallas + Partners](#)
- [Nova](#) – 1237 N. Van Buren St. – [New Land Enterprises](#), [Korb + Associates Architects](#) and [Catalyst Construction](#) – [Prior Coverage](#)

**Milwaukee Habitat for Humanity - Affordable Homeownership Initiative**

- 30 Affordable Homeownership Opportunities
- Sold to First-Time Home Buyers Earning Below Median Income

Address: Harambee and Midtown Neighborhoods  
Aldermanic District: 6, 15  
Involved: Milwaukee Habitat for Humanity, Quorum Architects

27th Annual Mayor's Design

**Walnut Circle Josey Heights**

- Design and Build
- 3 Designs
- \$30,000 Forgivable Loan

Addresses: N. 20th St & W. Walnut St & W. Lloyd St  
Aldermanic District: 15  
Involved: Emem Group

27th Annual Mayor's Design

**McKinley School Lofts**

- Former School Built in 1880s
- Adaptive Reuse
- 39 Affordable Units
- Preference Given to Veterans

Address: 1320 N 21st St  
Aldermanic District: 15  
Involved: Quorum Architects, Gorman & Company

27th Annual Mayor's Design

**Maple & Hickory at Westlawn Gardens**

- Maple - 44 Units of Affordable Housing
- Hickory - 18 Units of Affordable Housing
- Platinum LEED

Address: 6405 & 6014 W. Sheridan Ave  
Aldermanic District: 2  
Involved: H.A.C.M., Travaux, Inc., E.U.A., National, P.N.C., Torti Gallas + Partners

27th Annual Mayor's Design

**NOVA**

- 251-Unit Apartment Building
- 2-Story Commercial Space
- 2-Story Townhomes

Address: 1237 N. Van Buren St  
Aldermanic District: 4  
Involved: New Land Enterprises, Korb + Associates Architects, Catalyst Construction

27th Annual Mayor's Design

## Places & Spaces

The following projects have found unique opportunities to contribute to their neighborhoods by making our streets and public spaces more attractive and engaging, and creating meaningful community spaces for all to enjoy

- Cohort 5 Green and Healthy Schools – [Frederick J. Gaenslen School](#), [Milwaukee German Immersion School](#), [Richard Kluge Creative Arts School](#), [Alexander Mitchell Integrated Arts School](#), [Riley Dual Language Montessori School](#) – [Reflo](#), [Milwaukee Public Schools](#), [SmithGroup](#), Aqualis, [Community Design Solutions](#) and [Milwaukee Metropolitan Sewerage District](#) – [Prior Coverage](#)
- [Lakefront Brewery](#) Riverwalk Improvements – [1872 N. Commerce St.](#) – [The Kubala Washatko Architects](#), [Spire Engineering](#) and J.H. Findorff & Son – [Prior Coverage](#)
- Muskego Way Bollards – S. 24th and W. Mitchell streets – La Familia de Arte, [Muskego Way Forward](#)
- Garden Block Revitalization Project – S. 6th St. and W. Howard Ave. – [Garden District Neighborhood Association](#)



### Muskego Way Bollards

- Non-Profit Employs Families to Create Ceramics and Installations
- Used to Connect the Community
- Used to Increase Pedestrian Safety

Address: 374th St & W Mitchell St  
Aldermanic District: 8  
Involved: La Familia de Arte, Muskego Forward, Joy Engine, Bader Philanthro Milwaukee Foundation, Herzfeld Four

27th Annual Mayor's Design



### Garden Block Revitalization Project

- Mowing, Trimming, and Removal Weeds
- Planted 800+ Flowers
- Butterfly Gardens
- Public Art

District Neighborhood Association would like to

Jeff Ottosen, Isabel Alvarez, Rachel Parnan, Day Houston, Mark Frank, Troy Bress, Angela Mitchell, Reed Bryan Green, Hira Wilschick, Mike Adams, Steve Lyarik, Sherry Duffy, Sandy Dunek, Mikowski, Jason Hees, Casey Koppacki, Laura Koppacki, Gregg Lett, Clara Rivera, Bennett Rucka, Nancy Turner, Andrea Zipp, Scott Spier, Jack Eckstein

Address: 5 6th St & W Howard Ave  
Aldermanic District: 18  
Involved: Garden District Neighborhood Association

27th Annual Mayor's Design



### Cohort 5 Green and Healthy Schools

- Schools: Frederick J. Gaenslen, Milwaukee German Immersion, KI Alexander Mitchell Integrated Arts Riley Dual-Language Montessori
- Conversion of Asphalt Schoolyards: Publicly Accessible Green Spaces

Addresses: Various  
Aldermanic Districts: 2, 3, 5, 8, 12  
Involved: Defeo, MPO, Smith Group, Community Design Solutions, MHD

27th Annual Mayor's Design



### Lakefront Brewery Riverwalk Improvement

- Outdoor Beer Garden
- Seasonal Restrooms
- Outdoor Balcony
- New Stairs to Riverwalk

Address: 1872 N Commerce St  
Aldermanic District: 6  
Involved: TKWA, Spire Engineering

27th Annual Mayor's Design

## Vibrant Corridors

The following projects are revitalizing Milwaukee's commercial corridors by constructing or restoring their properties in a pedestrian-friendly way that activates the public realm and adds to the vibrancy and diversity of the City's commercial districts

- Who's On Layton – [512 W. Layton Ave.](#) – [Cream City Concepts](#), [ADK Design](#), [RINKA](#), [ConnecTech](#), [Jimmy Cha Cha](#) – [Prior Coverage](#)
- Ground 59 – [2159 S. Kinnickinnic Ave.](#) – [Dan Beyer Architects](#), JTT Commercial, [Kelly Construction & Design](#) – [Prior Coverage](#)
- [Mitchell Street Arts \(MiSA\)](#) – [710 W. Historic Mitchell St.](#) – [Rew Gordon](#), [HGA](#) – [Prior Coverage](#)
- [Denizen MKE](#) – [4227 W. Vliet St.](#) – [Amber Bricco](#), [Rachael Flood](#), Vision Architects & Engineers, Sawfish General Contracting, [Milwaukee Economic Development Corporation](#), Spring Bank – [Prior Coverage](#)
- [Buffalo Boss](#) – [540 N. 27th St.](#) – [Taj Pearsall](#), HGA, [Near West Side Partners](#), Milwaukee Economic Development Corporation, Craftsman Restoration Guild – [Prior Coverage](#)
- The Connector Building – [274 E. Keefe Ave.](#) – [Riverworks Development Corporation](#), [Stephen Perry Smith Architects](#), [Jordan's Construction Services](#) – [Prior Coverage](#)



### Who's On Layton

- Four Season Patio
- Up to 100 Guests
- Gianni Antetokounmpo Mural

Address: 512 W Layton Ave  
Aldermanic District: 13  
Involved: Cream City Concepts, ADK ConnecTech, Jimmy Cha Cha

27th Annual Mayor's Design



### Ground 59

- Former Vacant Lot
- Adds Three New Asian-Themed Restaurants
- New Outdoor Spaces
- Addition of a Walkway Connecting Robinson Ave and Kinnickinnic Av

Address: 2159 S Kinnickinnic Ave  
Aldermanic District: 14  
Involved: Dan Beyer Architects, JTT Commercial LLC, Kelly Construction

27th Annual Mayor's Design

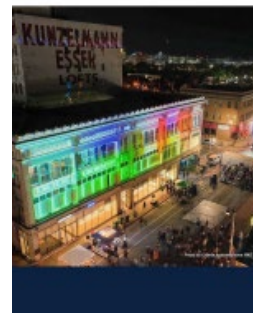

### Mitchell Street Arts (MiSA)

- Long-Vacant Retail Storefront
- Community Arts Space

Address: 710 W Historic Mitchell St  
Aldermanic District: 12  
Involved: Rew Gordon, HGA

27th Annual Mayor's Design



### Denizen MKE

- Long-Vacant Property
- Complete Remodel
- Event Space

Address: 4227 W. Vliet St.  
Aldermanic District: 10  
Involved: Amber Brisco, Rachael F. Architects & Engineers, NSWSP, Sav General Contracting, MEDC, Sprink

27th Annual Mayor's Design



### Buffalo Boss

- Vacant for 15+ Years
- Renovation
- Limited Food Options in the Area

Address: 540 N. 27th St.  
Aldermanic District: 4  
Involved: Taj Pearsall, HGA, NWSP, Craftsmen Restoration Guild

27th Annual Mayor's Design



### The Connecto Building

- Vacant Property along Beerline Tr
- Kuumba Juice and Coffee
- Trail Programming and Gathering Space

Address: 274 E. Keeble Ave.  
Aldermanic District: 8  
Involved: Riverworks Development Corporation, Stephen Perry Smith, Jordani's Construction Services

27th Annual Mayor's Design

## Urbanism Redefined

The following projects have made extraordinary contributions to the City's built environment by constructing or restoring places that repair, restore, or enhance the urban fabric, expand opportunities for education or employment, and facilitate social connections; while raising the bar for major development and contemporary architecture in the City.

- UW-Milwaukee Student Union – [2200 E. Kenwood Blvd.](#) – J.H. Findorff & Son, HGA, Ring & DuChateau, OTIE, UW System Board of Regents, UWM Students, [State Building Commission](#)
- [Marquette University O'Brien Hall](#) – [1530 W. Wisconsin Ave.](#) – BNIM, [Workshop Architects](#), J.H. Findorff & Son – [Prior Coverage](#)
- [Wgema Campus Plan + Renovation](#) – 3215 W. State St. – Potawatomi Ventures, Quorum Architects, [Greenfire Management Services](#), Ring & DuChateau, [Pierce Engineers](#), Payne + Dolan
- [Milwaukee Tool](#) – 551 N. 5th St. – Stephen Perry Smith Architects, [Mortenson Construction](#) – [Prior Coverage](#)
- The Trade – [420 W. Juneau Ave.](#) – [North Central Group](#), Gary Brink & Associates, J.H. Findorff & Son, Pierce Engineers, Kapur & Associates – [Prior Coverage](#)



### UW-Milwaukee Student Union

- Fixed Internal Circulation
- Interior and Exterior Design Update

Address: 2200 E. Kenwood Blvd.  
Aldermanic District: 3  
Involved: Findorff, HGA, Ring & DuChateau, UW System Board of Regents, UWM Students, State Building Commission

27th Annual Mayor's Design

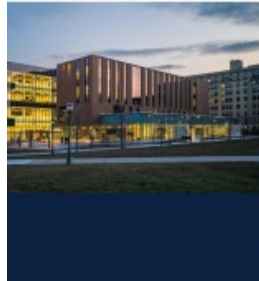

### Marquette University O'Brien Hall

- Home to Marquette's College of Business Administration
- Designed for Maximum Flexibility
- Largest Fully Donor-Funded Project

Address: 1530 W. Wisconsin Ave.  
Aldermanic District: 4  
Involved: BNIM, Workshop Architects

27th Annual Mayor's Design



### Wgema Campus Plan + Renovation

- Plan for Rehabilitation and Reuse: Concordia College
- Native American Cultural Center, Campus Dining, Offices, Health and Wellness Facility

Address: 3215 W. State St.  
Aldermanic District: 4  
Involved: Potawatomi Ventures, Quorum Architects, Greenfire Management Services, Ring & DuChateau, Pierce Engineers, Dolan

27th Annual Mayor's Design

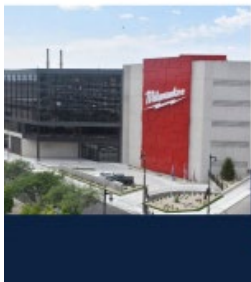

### Milwaukee Tool

- Conversion of 1978 Office and Parking Garage
- +1,200 Jobs to Milwaukee

Address: 551 N. 5th St.  
Aldermanic District: 4  
Involved: Stephen Perry Smith Architects, Mortenson

27th Annual Mayor's Design

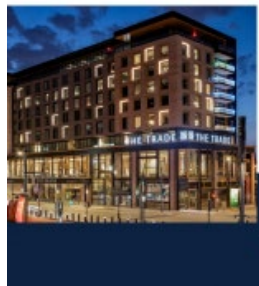

### The Trade

- Official Hotel of the Deer District
- 207 Rooms
- Rooftop Restaurant
- Cream City Brick

Address: 420 W. Juneau Ave.  
Aldermanic District: 6  
Involved: NCG Hospitality, CBA, Pierce Engineers, Kapur & Associates

27th Annual Mayor's Design



# Maple & Hickory at Westlawn Gardens



- Maple - 44 Units of Affordable Housing
- Hickory - 18 Units of Affordable Housing
- Platinum LEED



Address: 6405 & 6014 W Sheridan Ave  
Aldermanic District: 2  
Involved: HACM, Travaux, Inc., EUA, R. A. Smith National, PNC, Torti Gallas + Partners

27th Annual Mayor's Design Awards