

PROJECT ID: 2185-09-70  
WITH: N/A

COUNTY: MILWAUKEE

ORDER OF SHEETS

Page 1	Title
Page 2	General Notes
Page 3-4	Typical Sections
Page 5-9	Construction Details
Page 10	Removal Plan
Page 11	Plan Details
Page 12-13	Combined Sewer
Page 14	Detour Plan
Page 15	Alignment Overview
Page 16	Plan and Profile
Page 17-32	Cross Sections

TOTAL SHEETS = 32

PLAN OF PROPOSED IMPROVEMENT  
**C MILWAUKEE/KOMATSU MINING**  
 S. KINNICKINNIC AVE N/S OF RR BRIDGE  
**STH 32**  
 MILWAUKEE COUNTY

PROJECT NUMBER  
**2185-09-70**



60% SUBMITTAL  
 NOVEMBER 23, 2021

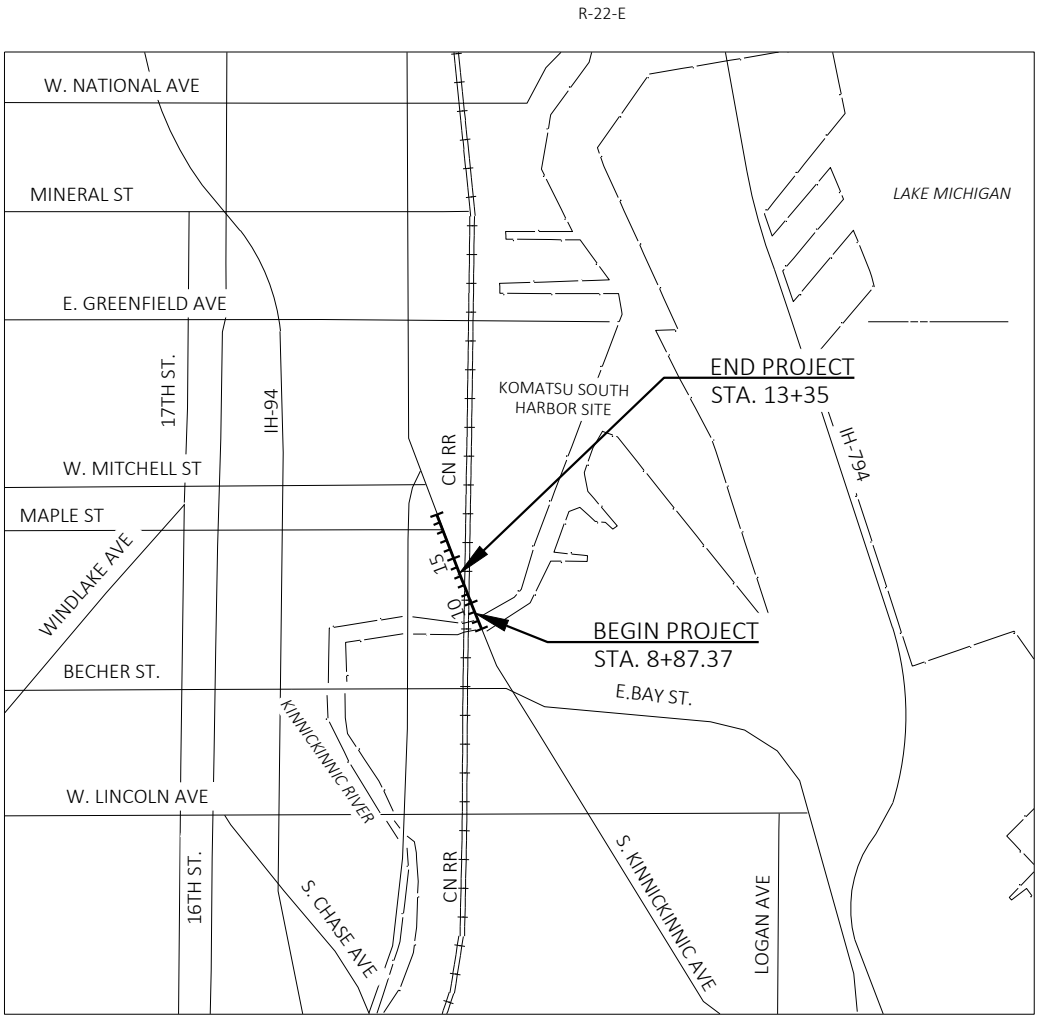

CONVENTIONAL SYMBOLS

PLAN	PROFILE
CORPORATE LIMITS	GRADE LINE
PROPERTY LINE	ORIGINAL GROUND
LOT LINE	MARSH OR ROCK PROFILE (To be noted as such)
LIMITED HIGHWAY EASEMENT	SPECIAL DITCH
EXISTING RIGHT OF WAY	GRADE ELEVATION
PROPOSED OR NEW R/W LINE	CULVERT (Profile View)
SLOPE INTERCEPT	UTILITIES
REFERENCE LINE	ELECTRIC
EXISTING CULVERT	FIBER OPTIC
PROPOSED CULVERT (Box or Pipe)	GAS
COMBUSTIBLE FLUIDS	SANITARY SEWER
MARSH AREA	STORM SEWER
WOODED OR SHRUB AREA	TELEPHONE
	WATER
	UTILITY PEDESTAL
	POWER POLE
	TELEPHONE POLE

LAYOUT  
 SCALE 0 2000-FT  
 TOTAL NET LENGTH OF CENTERLINE = 0.085 MI

HORIZONTAL POSITIONS SHOWN ON THIS PLAN ARE WISCONSIN COUNTY COORDINATES, MILWAUKEE COUNTY, NAD83 (2011), IN U.S. SURVEY FEET. VALUES ARE GRID COORDINATES, GRID BEARINGS, AND GRID DISTANCES. GRID DISTANCES MAY BE USED AS GROUND DISTANCES.

VERTICAL DATUM - CITY OF MILWAUKEE (NGVD26 - 580.603)

ACCEPTED FOR CITY OF MILWAUKEE  
 \_\_\_\_\_  
 (Date) (Signature & Title of Official)

ORIGINAL PLANS PREPARED BY  
**GRAEF** 125 S. 84TH STREET, SUITE 401  
 MILWAUKEE, WI 53214

PREPARED BY  
 Surveyor \_\_\_\_\_  
 Designer \_\_\_\_\_

CAPITAL \_\_\_\_\_  
 GRAEF \_\_\_\_\_

E

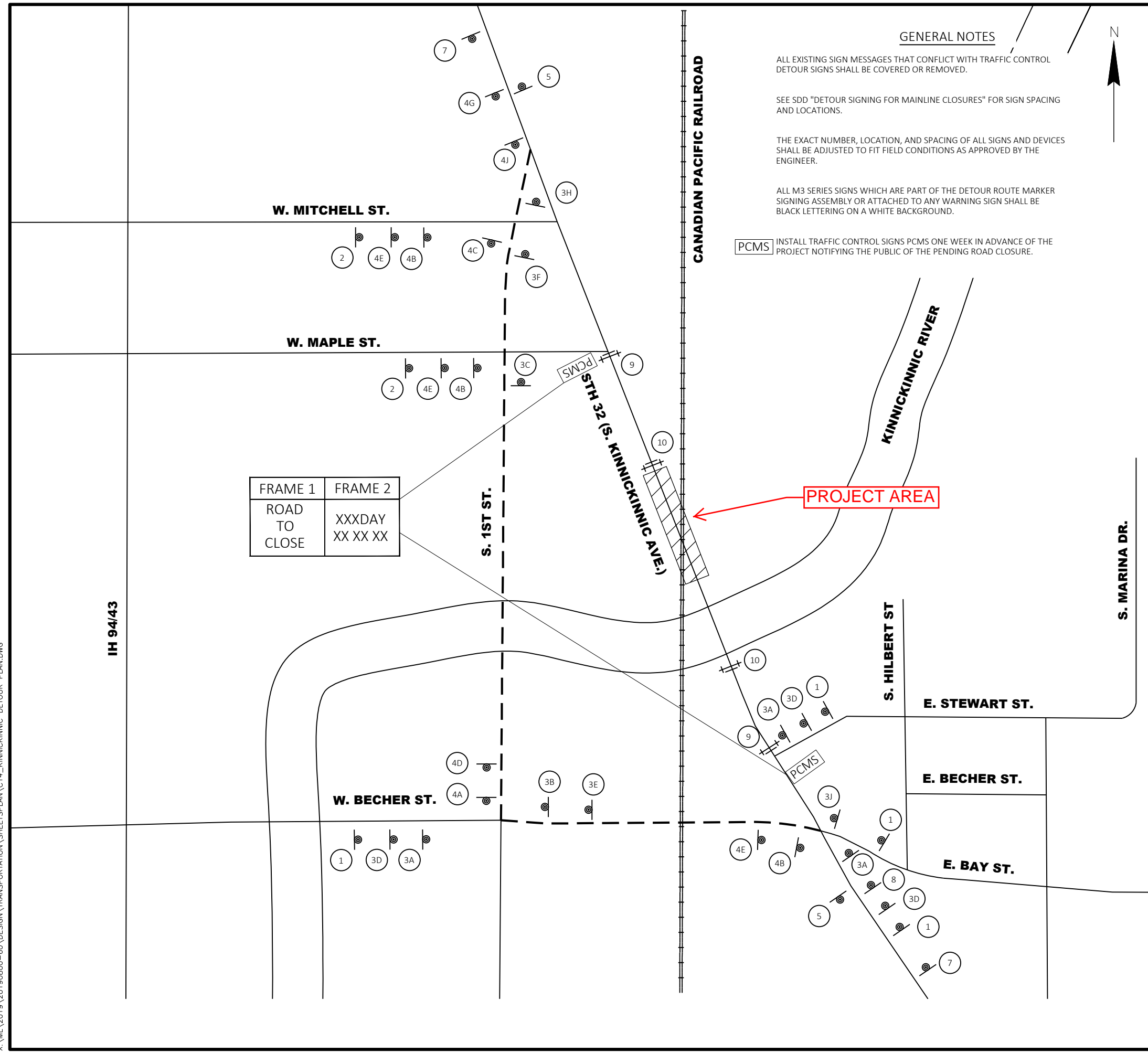

FRAME 1	FRAME 2
ROAD TO CLOSE	XXXDAY XX XX XX

**GENERAL NOTES**

ALL EXISTING SIGN MESSAGES THAT CONFLICT WITH TRAFFIC CONTROL DETOUR SIGNS SHALL BE COVERED OR REMOVED.

SEE SDD "DETOUR SIGNING FOR MAINLINE CLOSURES" FOR SIGN SPACING AND LOCATIONS.

THE EXACT NUMBER, LOCATION, AND SPACING OF ALL SIGNS AND DEVICES SHALL BE ADJUSTED TO FIT FIELD CONDITIONS AS APPROVED BY THE ENGINEER.

ALL M3 SERIES SIGNS WHICH ARE PART OF THE DETOUR ROUTE MARKER SIGNING ASSEMBLY OR ATTACHED TO ANY WARNING SIGN SHALL BE BLACK LETTERING ON A WHITE BACKGROUND.

**PCMS** INSTALL TRAFFIC CONTROL SIGNS PCMS ONE WEEK IN ADVANCE OF THE PROJECT NOTIFYING THE PUBLIC OF THE PENDING ROAD CLOSURE.

**LEGEND**

- DETOUR ROUTE
- WORK ZONE
- SIGN ON PERMANENT SUPPORT
- TYPE III BARRICADE WITH ATTACHED SIGN AND TWO TYPE A LIGHTS
- PORTABLE CHANGEABLE MESSAGE SIGN

- 1 NORTH M3-1 24"x12" M1-6B 24"x24"
- 2 SOUTH M3-3 24"x12" M1-6B 24"x24"
- 3 DETOUR AHEAD M4-8 24"x12" M3-1 24"x12" M1-6B 24"x24"
- 4 DETOUR AHEAD M4-8 24"x12" M3-3 24"x12" M1-6B 24"x24"
- 5 END DETOUR M4-8A 24"x18" M1-6B 24"x24"
- 6 DETOUR AHEAD M4-8 24"x12" M3-3 24"x12" M1-6B 24"x24"
- 7 ROAD CLOSED AHEAD M4-8A 24"x18" M1-6B 24"x24"
- 8 ROAD CLOSED 500 FT M4-8A 24"x18" M1-6B 24"x24"
- 9 ROAD CLOSED 0.1 MILES AHEAD LOCAL TRAFFIC ONLY R11-3 60"x30"
- 10 ROAD CLOSED R11-2 48"x30"

- A M6-1 21"x21"
- B M6-1 21"x21"
- C M6-1 21"x21"
- D M5-1L 21"x21"
- E M5-1R 21"x21"
- F M5-2L 21"x21"
- G M5-2R 21"x21"
- H M6-2 21"x21"
- J M6-2 21"x21"

PLOT SCALE : 1 IN:10 FT



Graef-USA Inc.  
275 W. Wisconsin Avenue, Suite 300  
Milwaukee, WI 53203  
414 / 259 1500  
414 / 259 0037 fax  
[www.graef-usa.com](http://www.graef-usa.com)



**PROJECT TITLE:**  
PROJECT ID: 2185-09-70  
C MILWAUKEE/KOMATSU MINING  
S. KINNICKINNIC AVE. N/S OF RR BRIDGE  
STH. 32  
MILWAUKEE COUNTY

**ISSUE:**

**PROJECT INFORMATION:**  
PROJECT NUMBER: 2185-09-70  
DATE: 11/23/2021  
DRAWN BY: BJB  
CHECKED BY: ACO  
APPROVED BY: SJF  
SCALE: N.T.S.

**SHEET TITLE:**  
DETOUR PLAN

**SHEET NUMBER:**